



**DEPARTMENT OF PUBLIC WORKS
CITY ENGINEERING DIVISION**

Coleman A. Young Municipal Center
2 Woodward Ave., Suite 601
Detroit, Michigan 48226

Phone 313•224•3949 TTY: 711
Fax 313•224•3471
www.detroitmi.gov

April 30, 2026

Honorable City Council:

RE: Petition No. x2026-082 – Greektown Neighborhood Partnership, request for multiple encroachments within the Monroe St. right-of-way, from Randolph St., east to the I-375 Service Drive for non-standard items.

Petition No. x2026-082 – Greektown Neighborhood Partnership, request for multiple encroachments within the Monroe St., 50 ft. wide, right-of-way, from Randolph St. east to the I-375 Service Drive for non-standard items.

The petition was referred to the City Engineering Division – DPW for investigation and report. This is our report.

The request was approved by the Solid Waste Division – DPW, and City Engineering Division – DPW. Traffic Engineering Division

Detroit Water and Sewerage Department (DWSD) reports being involved, but they have no objection provided the DWSD encroachment provisions are followed. The DWSD provisions have been made a part of the resolution.

All other involved City Departments, including the Public Lighting Authority and Public Lighting Department; also privately owned utility companies have reported no objections to the encroachment. Provisions protecting all utility installations are part of the attached resolution.

I am recommending adoption of the attached resolution.

Respectfully submitted,

Richard Doherty, P.E., City Engineer
City Engineering Division – DPW

Cc: Ron Brundidge, Director, DPW
Mayor's Office – City Council Liaison



**DEPARTMENT OF PUBLIC WORKS
CITY ENGINEERING DIVISION**

Coleman A. Young Municipal Center
2 Woodward Ave., Suite 601
Detroit, Michigan 48226

Phone 313•224•3949 TTY: 711
Fax 313•224•3471
www.detroitmi.gov

COUNCIL MEMBER _____

RESOLVED, that the Department of Public Works, City Engineering Division is hereby authorized and directed to issue permits to Greektown Neighborhood Partnership, or their assigns to install and maintain multiple encroachments within Monroe St, further described as: Land in the City of Detroit, Wayne County, Michigan;

Lying northerly of and adjacent to lots 1 through 7 and lying southerly of and adjacent to lots 11 through 17 of “Plan of Part of the Brush Farm” as recorded in Liber 7, Page 224 of Plats, Wayne County Records.

Lying northerly of and adjacent to lots 127 through 134 and lying southerly of and adjacent to lots 135 through 142 of “A Plat of a Part of the L. Beaubien Farm” as recorded in Liber 6, Page 475 of Plats, Wayne County Records.

Lying northerly of and adjacent to lots 1 through 4, lot 18, and lots 7 through 9, also lying southerly of and adjacent to lots 1 through 9 of “Plat of the Antoine Beaubien Farm” as recorded in Liber 27, Page 197 of Plats, Wayne County Records.

Lying Northerly of and adjacent to lots 3 and 4, also lying southerly of and adjacent to lots 3 and 4 of “Plat of the Antoine Beaubien Farm” as recorded in Liber 27, Page 197 of Plats, Wayne County Records.

Lying easterly of and adjacent to lots 4, 14, and 4, also lying westerly of and adjacent to lots 3, 15, and 3 of “Plan of Part of the Brush Farm” as recorded in Liber 7, Page 224 of Plats, Wayne County Records.

Lying easterly of and adjacent to lots 131 and 138, also lying westerly of and adjacent to lots 130 and 139 of “A Plat of a Part of the L. Beaubien Farm” as recorded in Liber 6, Page 475 of Plats, Wayne County Record.

Lying easterly of and adjacent to lots 17, 18 and, 5, and also lying westerly and adjacent to lots 4 and 4 of “Plat of the Antoine Beaubien Farm” as recorded in Liber 27, Page 197 of Plats, Wayne County Records.

The encroachments include the following:

- Granite Paving
- Granite Pavers, Pedestrian
- Granite Pavers, Vehicular
- Tile Type 1, Guideway



**DEPARTMENT OF PUBLIC WORKS
CITY ENGINEERING DIVISION**

Coleman A. Young Municipal Center
2 Woodward Ave., Suite 601
Detroit, Michigan 48226

Phone 313•224•3949 TTY: 711
Fax 313•224•3471
www.detroitmi.gov

- Tile Type 2, Detectable Warning
- Tile Type 3, Contrast Strip
- Stone Planter Curb and Plantings
- Bollards
- Bollards, Fixed
- Bollards, Removable
- Bollards, Removable Receptacle
- Fencing
- Fence, Type 1
- Light Poles and attachments
- Tree grates and Trees
- Soil Cell System
- Irrigation System
- Bike Racks
- Event Power
- Handholes, ground boxes, conduit and wire for the non-PLA electrical system

RESOLVED, that the Director of the Department of Public Works, or his or her designee, is authorized to execute any document or documents necessary or convenient to make and incorporate technical amendments, corrections, or other minor changes to any document or documents necessary or convenient in furtherance of or to effectuate the action or transaction hereby approved, including the legal description of any property described herein, in the event there are any scrivener's errors, mistakes of fact, or changes in circumstances, or as may be required to correct minor inaccuracies, or are necessitated by unforeseen circumstances or technical matters, provided that the changes do not materially alter the substance or terms of the action or transaction hereby approved;"

PROVIDED, that if there is any cost for the removing and/or rerouting of any utility facilities, it shall be done at the expense of the petitioner and/or property owner; and be it further

PROVIDED, that access is maintained to all fire department connections, and be it further

PROVIDED, that by approval of this petition the Detroit Water and Sewerage Department (DWSD) does not waive any of its rights to its facilities located in the right-of-way, and at all times, DWSD, its agents or employees, shall have the right to enter upon the right-of-way to maintain, repair, alter, service, inspect, or install its facilities. All costs incident to the damaging, dismantling, demolishing, removal and replacement of structures or other improvements herein permitted and incurred in gaining access to DWSD's facilities for maintenance, repairing, alteration, servicing or inspection caused by the encroachment shall be borne by the petitioner. All



**DEPARTMENT OF PUBLIC WORKS
CITY ENGINEERING DIVISION**

Coleman A. Young Municipal Center
2 Woodward Ave., Suite 601
Detroit, Michigan 48226

Phone 313•224•3949 TTY: 711
Fax 313•224•3471
www.detroitmi.gov

costs associated with gaining access to DWSD's facilities, which could normally be expected had the petitioner not encroached into the right-of-way, shall be borne by DWSD; and be it further

PROVIDED, that all construction performed under this petition shall not be commenced until after (5) days written notice to DWSD. Seventy-two (72) hours' notice shall also be provided in accordance with P.A. 53 1974, as amended, utilizing the MISS DIG one call system; and be it further

PROVIDED, that construction under this petition is subject to inspection and approval by DWSD forces. The cost of such inspection shall, at the discretion of DWSD, be borne by the petitioner; and be it further

PROVIDED, that if DWSD facilities located within the right-of-way shall break or be damaged as the result of any action on the part of the petitioner, then in such event the petitioner agrees to be liable for all costs incident to the repair, replacement or relocation of such broken or damaged DWSD facilities; and be it further

PROVIDED, that the petitioner shall hold DWSD harmless for any damages to the encroaching device constructed or installed under this petition which may be caused by the failure of DWSD's facilities; and be it further

PROVIDED, Greektown Neighborhood Partnership or their assigns shall apply to the Buildings and Safety Engineering Department for a building permit prior to any construction. Also, if it becomes necessary to open cut public streets, bore, jack, occupy or barricade city rights-of-way for maintenance of encroachments such work shall be according to detail permit application drawings submitted to the City Engineering Division – DPW prior to any public right-of-way construction; and further

PROVIDED, that the necessary permits shall be obtained from the City Engineering Division – DPW and the Buildings and Safety Engineering Department. The encroachments shall be constructed and maintained under their rules and regulations; and further

PROVIDED, that all cost for the construction, maintenance, permits and use of the encroachments shall be borne by Greektown Neighborhood Partnership or their assigns, and further

PROVIDED, that all costs incurred by privately owned utility companies and/or city departments to alter, adjust, and/or relocate their existing utility facilities located in close proximity to the encroachments shall be borne by Greektown Neighborhood Partnership or their assigns. Should damages to utilities occur Greektown Neighborhood Partnership or their assigns shall be liable for



**DEPARTMENT OF PUBLIC WORKS
CITY ENGINEERING DIVISION**

Coleman A. Young Municipal Center
2 Woodward Ave., Suite 601
Detroit, Michigan 48226

Phone 313•224•3949 TTY: 711
Fax 313•224•3471
www.detroitmi.gov

all incidental repair costs and waives all claims for damages to the encroaching installations; and further

PROVIDED, that no other rights in the public streets, alleys or other public place shall be considered waived by this permission which is granted expressly on the condition that said encroachments shall be removed at any time when so directed by the City Council, and the public property affected shall be restored to a condition satisfactory to the City Engineering Division – DPW; and further

PROVIDED, that Greektown Neighborhood Partnership or their assigns shall file with the Department of Public Works – City Engineering Division an indemnity agreement in form approved by the Law Department. The agreement shall save and protect the City of Detroit from any and all claims, damages or expenses that may arise by reason of the issuance of the permits and the faithful or unfaithful performance of Greektown Neighborhood Partnership or their assigns of the terms thereof. Further, Greektown Neighborhood Partnership or their assigns shall agree to pay all claims, damages or expenses that may arise out of the use, repair and maintenance of the proposed encroachments; and further

PROVIDED, that construction of the encroachments shall constitute acceptance of the terms and conditions as set forth in this resolution; and be it further

PROVIDED, this resolution is revocable at the will, whim or caprice of the City Council, and Greektown Neighborhood Partnership acquires no implied or other privileges hereunder not expressly stated herein; and further

PROVIDED, that the encroachment permits shall not be assigned or transferred without the written approval of the City Council; and be it further

PROVIDED, that the City Clerk shall within 30 days record a certified copy of this resolution with the Wayne County Register of Deeds.

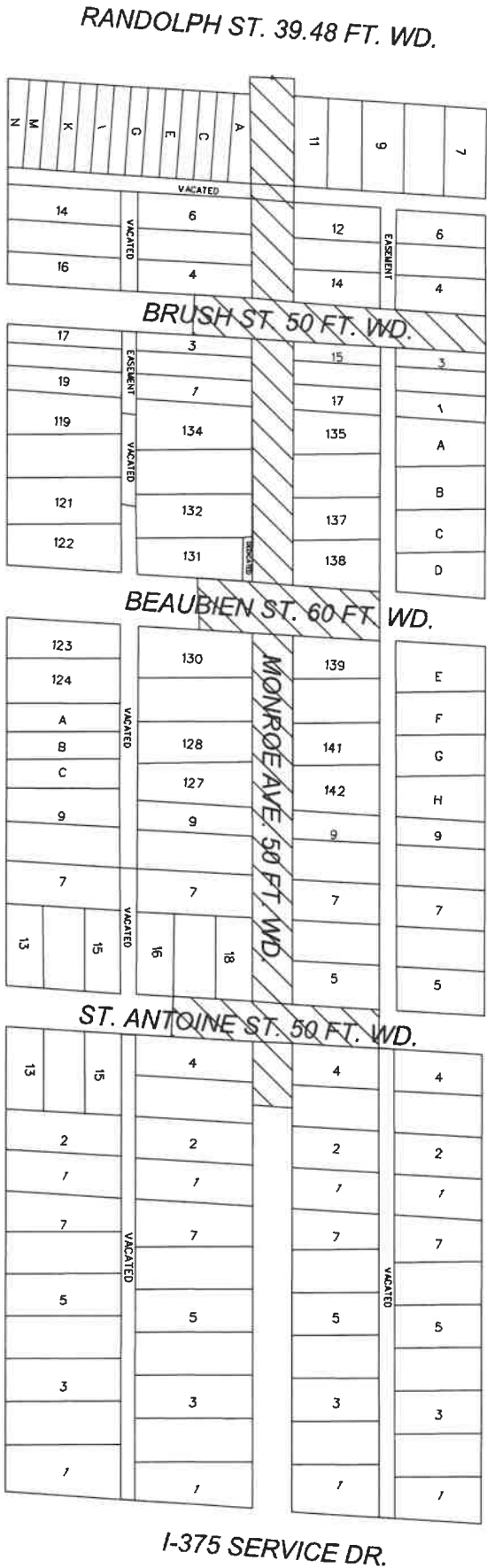

(FOR OFFICE USE ONLY)

CARTO 28 A

DRAWN BY	LC
DATE	04/28/2026
CHECKED	AP
APPROVED	GE

**REQUEST ENCROACHMENT
 INTO MONROE STREET FROM
 RANDOLPH ST. TO I-75**

CITY OF DETROIT	
CITY ENGINEERING DIVISION	
MAPS & RECORDS BUREAU	
JOB NO.	25-19
DRWG. NO.	25-19_00

MAP-25-19







MACOMB ST. 50 FT. WD.

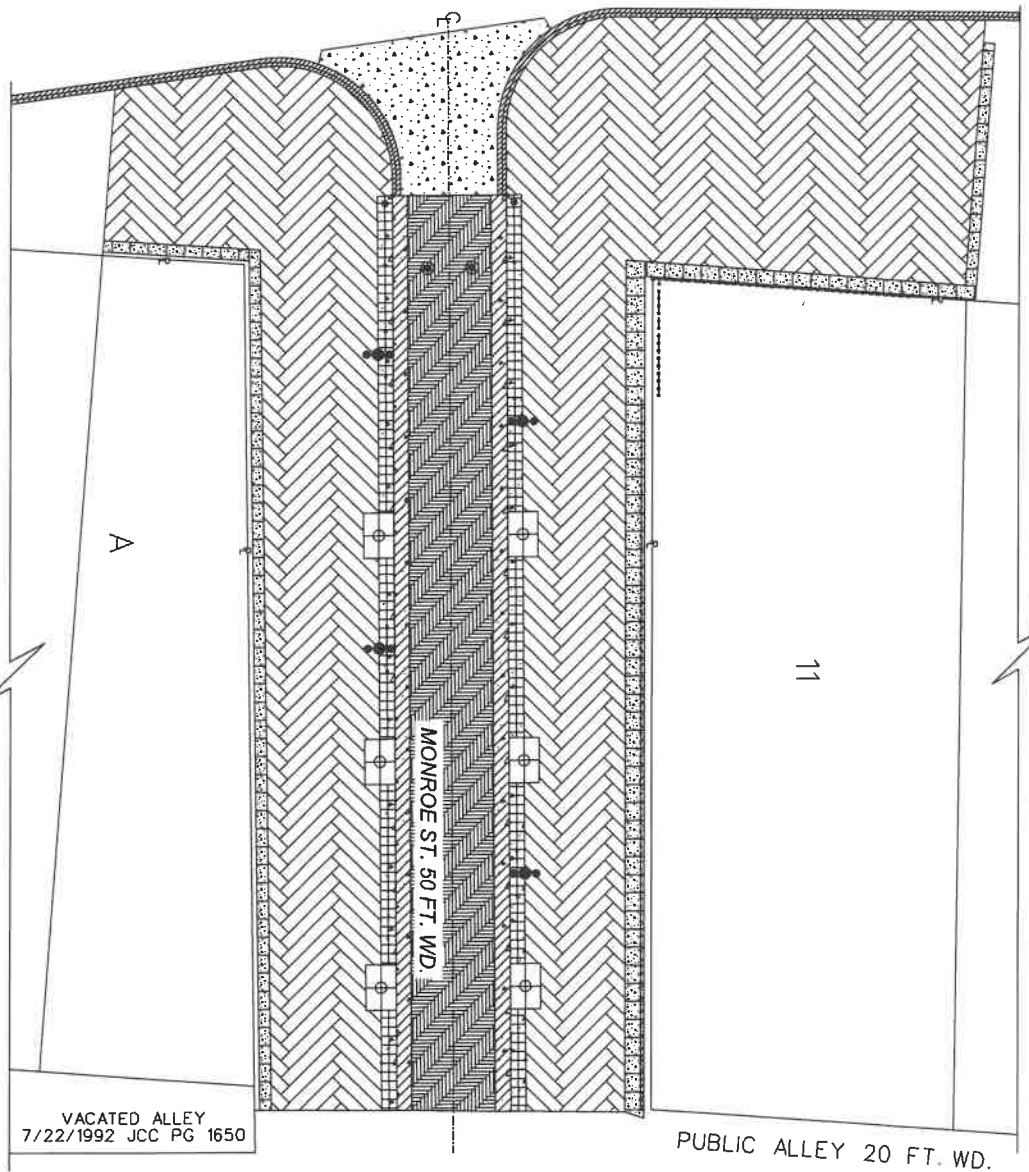

AREA 1B

RANDOLPH ST. 39.48 FT. WD.



-  GRANITE PAVER, PEDESTRIAN
-  GRANITE PAVER, VEHICULAR
-  CONC. PAVT. MISC. REINF. 6 INCH, MODIFIED
-  CONC. PAVT. MISC. REINF., VALLEY GUTTER
-  TILE TYPE 1, GUIDE WAY
-  TILE TYPE 3, CONTRAST STRIP

(FOR OFFICE USE ONLY)



CARTO 28 A

VACATED ALLEY
7/22/1992 JCC PG 1650

PUBLIC ALLEY 20 FT. WD.

DRAWN BY	LC
DATE	12-18-2025
CHECKED	AP/TS
APPROVED	GE

REQUEST ENCROACHMENT INTO
 MONROE STREET FROM RANDOLPH ST. TO I-75
 (GREEKTOWN CORRIDOR)

CITY OF DETROIT
 CITY ENGINEERING DIVISION
 MAPS & RECORDS BUREAU

JOB NO. 25-19

DRWG. NO. 25-19_01B



AREA 2A

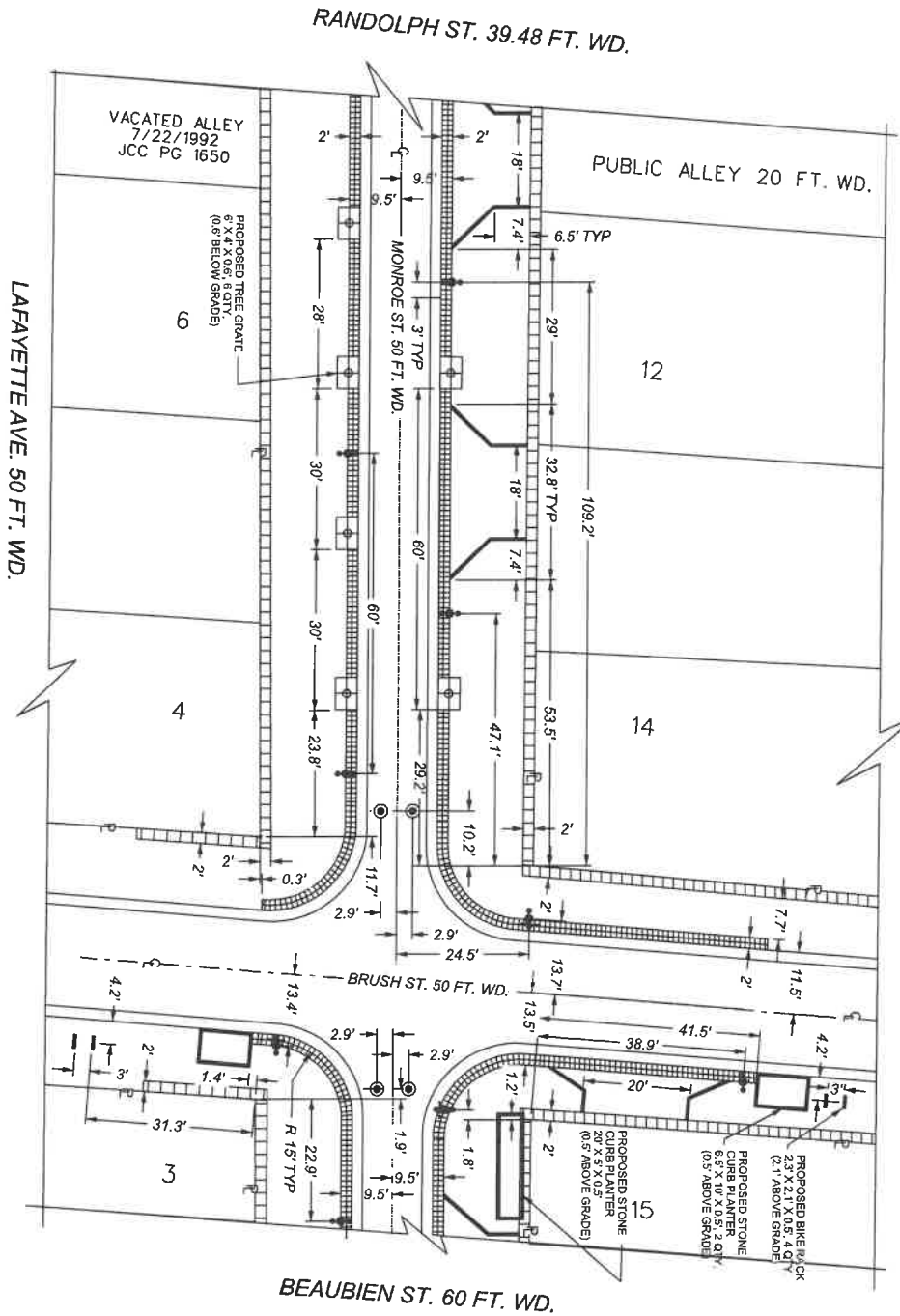

- REQUEST ENCROACHMENT (FOR BIKE RACK)
- REQUEST ENCROACHMENT (FOR TREE GRATE)
- REQUEST ENCROACHMENT (FOR LIGHT POLE)
- REQUEST ENCROACHMENT (FOR BOLLARD), REMOVABLE (REF. PLATE)
- REQUEST ENCROACHMENT (FOR FIXED BOLLARD)
- REQUEST ENCROACHMENT (FOR STONE PLANTER CURB, SIZES/SHAPES VARY)

(FOR OFFICE USE ONLY)



CARTO 28 A

DRAWN BY	LC
DATE	12-18-2025
CHECKED	AP/TS
APPROVED	GE

REQUEST ENCROACHMENT INTO
MONROE STREET FROM RANDOLPH ST. TO I-75
(GREEKTOWN CORRIDOR)

CITY OF DETROIT
CITY ENGINEERING DIVISION
MAPS & RECORDS BUREAU

JOB NO. 25-19

DRWG. NO. 25-19_02A

AREA 2B

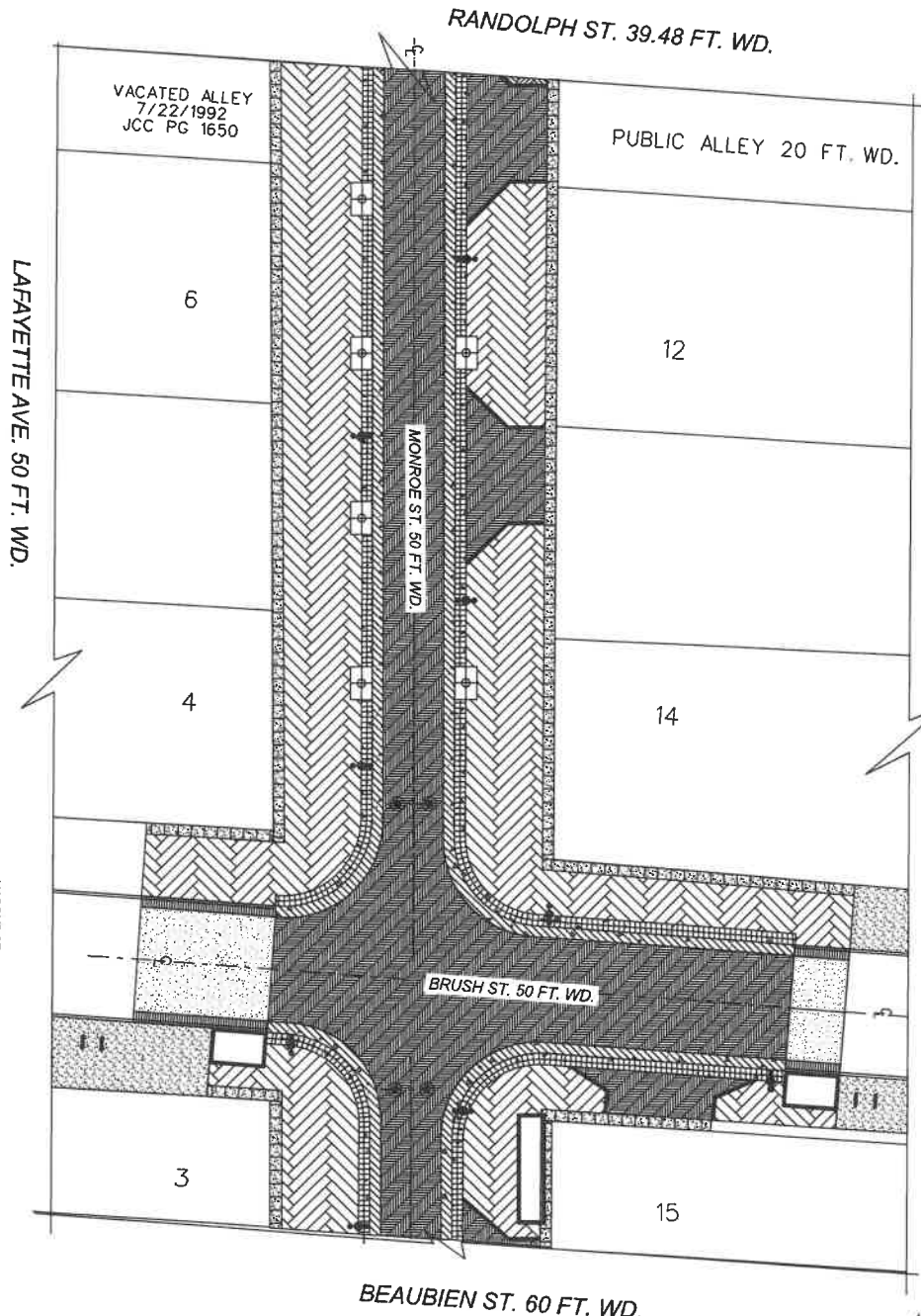

- REQUEST ENCROACHMENT (FOR CONCRETE PAVEMENT MISC, NONREINF. 6 INCH, MODIFIED)
- REQUEST ENCROACHMENT (FOR GRANITE PAVEMENT, PEDESTRIAN)
- REQUEST ENCROACHMENT (FOR CURB AND GUTTER, CONC)
- REQUEST ENCROACHMENT (FOR CONC PAVT, MISC, REINF. 8 INCH)
- REQUEST ENCROACHMENT (FOR CONC PAVT, MISC, REINF. VALLEY GUTTER)
- REQUEST ENCROACHMENT (FOR GRANITE PAVEMENT, VEHICULAR)
- REQUEST ENCROACHMENT (FOR TILE TYPE 1, GUIDE WAY)
- REQUEST ENCROACHMENT (FOR TILE TYPE 2, DETECTABLE WARNING)

(FOR OFFICE USE ONLY)

CARTO 28 A







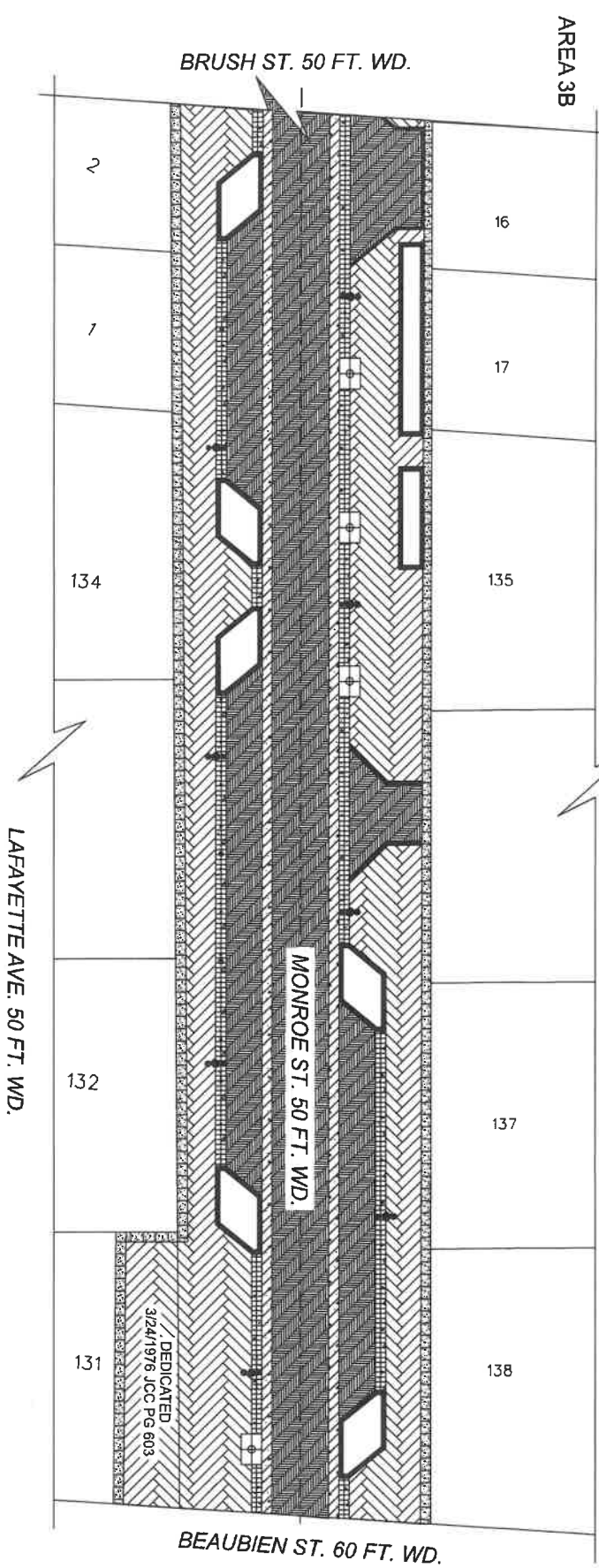

DRAWN BY	LC
DATE	12-18-2025
CHECKED	AP/TS
APPROVED	GE

**REQUEST ENCROACHMENT INTO
MONROE STREET FROM RANDOLPH ST. TO I-75
(GREEKTOWN CORRIDOR)**

CITY OF DETROIT CITY ENGINEERING DIVISION MAPS & RECORDS BUREAU	
JOB NO.	25-19
DRWG. NO.	25-19_02B



-  - REQUEST ENCROACHMENT (FOR CONCRETE PAVEMENT MISC. NONREINF. 6 INCH, MODIFIED)
-  - REQUEST ENCROACHMENT (FOR GRANITE PAVEMENT, PEDESTRIAN)
-  - REQUEST ENCROACHMENT (FOR TILE TYPE 1, GUIDE WAY)
-  - REQUEST ENCROACHMENT (FOR TILE TYPE 2, DETECTABLE WARNING)
-  - REQUEST ENCROACHMENT (FOR CONC PAVT, MISC. REINF. VALLEY GUTTER)
-  - REQUEST ENCROACHMENT (FOR GRANITE PAVEMENT, VEHICULAR)

(FOR OFFICE USE ONLY)

CARTO 28 A

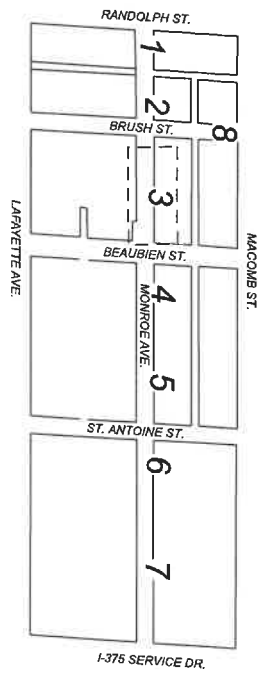

DRAWN BY	LC
DATE	12-18-2025
CHECKED	AP/TS
APPROVED	GE

**REQUEST ENCROACHMENT INTO
MONROE STREET FROM RANDOLPH ST. TO I-75
(GREEKTOWN CORRIDOR)**

CITY OF DETROIT CITY ENGINEERING DIVISION MAPS & RECORDS BUREAU	
JOB NO.	25-19
DRWG. NO.	25-19_03B

AREA 4A

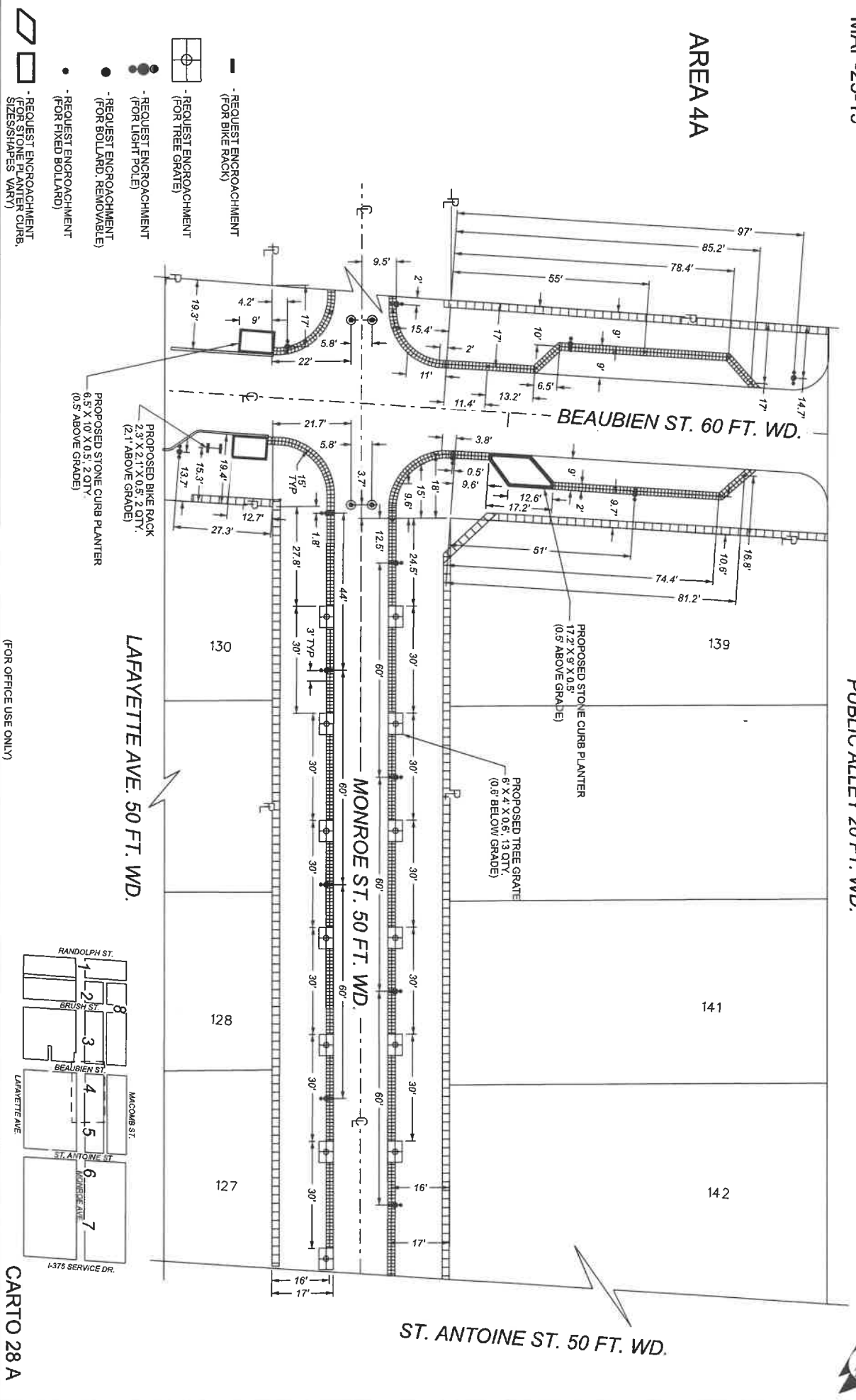

DRAWN BY LC
 DATE 12-18-2025
 CHECKED AP/PTS
 APPROVED GE

**REQUEST ENCROACHMENT INTO
 MONROE STREET FROM RANDOLPH ST. TO I-75
 (GREEK TOWN CORRIDOR)**

CITY OF DETROIT
 CITY ENGINEERING DIVISION
 MAPS & RECORDS BUREAU

JOB NO. 25-19
 DRWG. NO. 25-19_04A

CARTO 28 A

AREA 4B

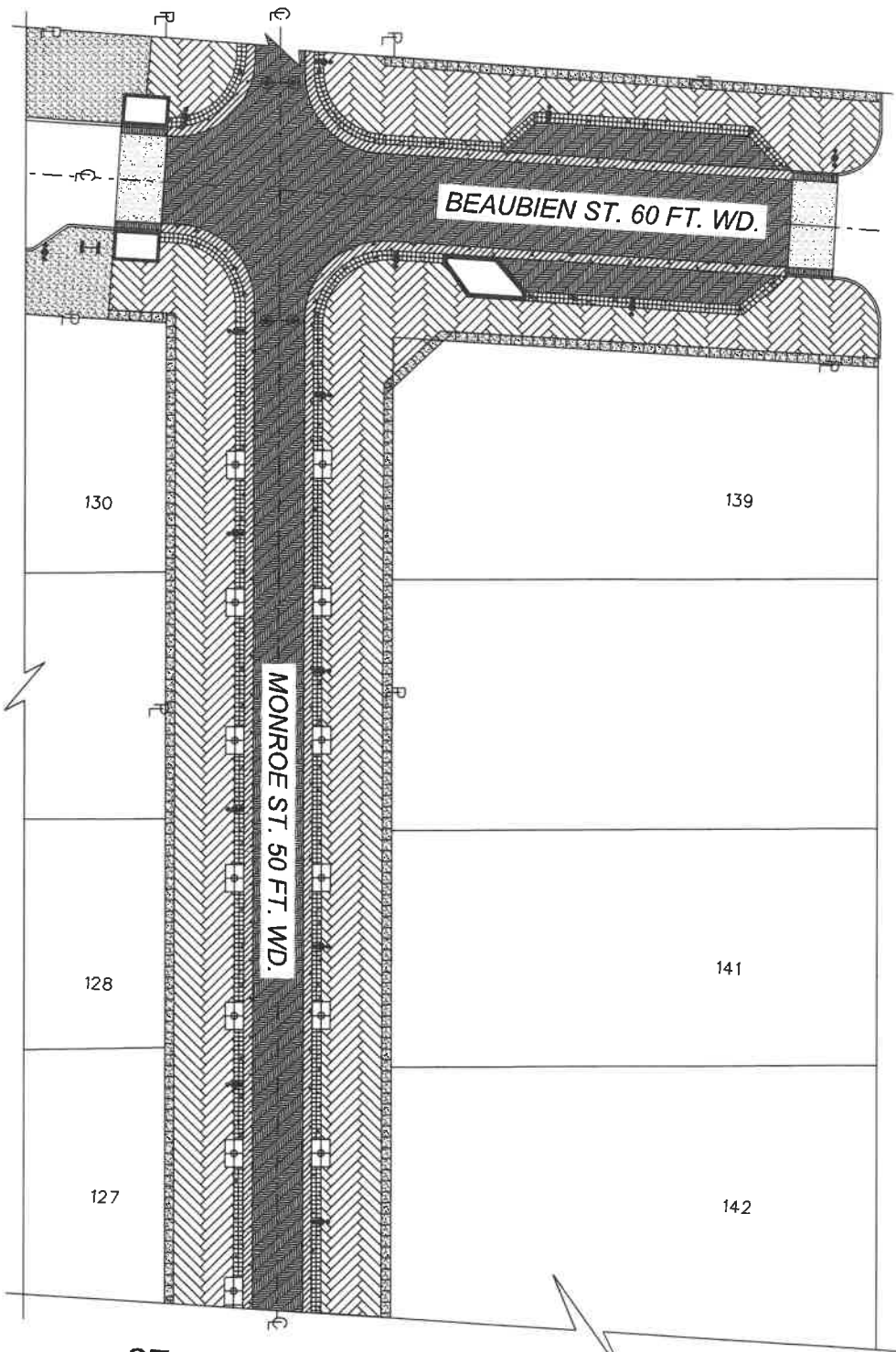

- REQUEST ENCROACHMENT (FOR CONCRETE PAVEMENT MISC. NONREINF. 6 INCH, MODIFIED)
- REQUEST ENCROACHMENT (FOR GRANITE PAVEMENT, PEDESTRIAN)
- REQUEST ENCROACHMENT (FOR CURB AND GUTTER, CONC)
- REQUEST ENCROACHMENT (FOR CONC PAVT, MISC. REINF. 8 INCH)
- REQUEST ENCROACHMENT (FOR TILE TYPE 1, GUIDE WAY)
- REQUEST ENCROACHMENT (FOR TILE TYPE 2, DETECTABLE WARNING)
- REQUEST ENCROACHMENT (FOR CONC PAVT, MISC. REINF. VALLEY GUTTER)
- REQUEST ENCROACHMENT (FOR GRANITE PAVEMENT, VEHICULAR)

(FOR OFFICE USE ONLY)







CARTO 28 A

DRAWN BY	LC
DATE	12-18-2025
CHECKED	AP/TS
APPROVED	GE

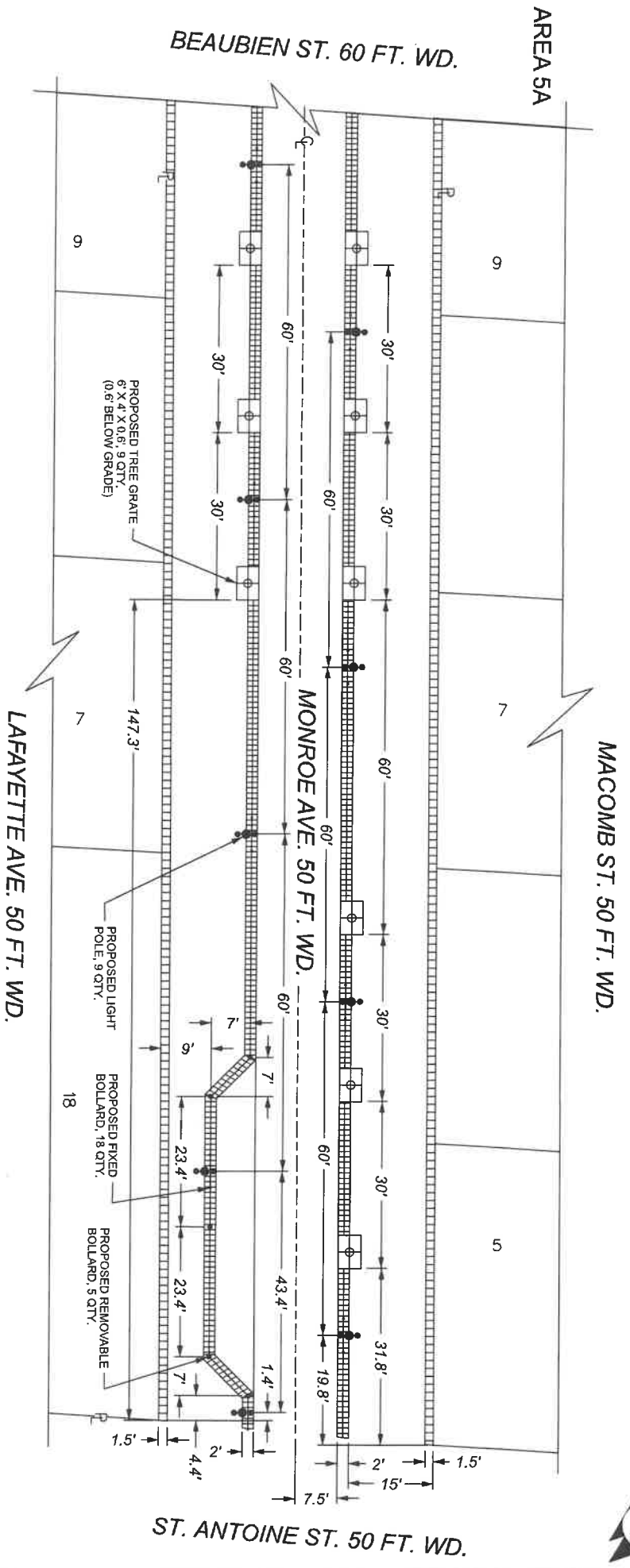
**REQUEST ENCROACHMENT INTO
MONROE STREET FROM RANDOLPH ST. TO I-75
(GREEKTOWN CORRIDOR)**

CITY OF DETROIT CITY ENGINEERING DIVISION MAPS & RECORDS BUREAU	JOB NO.	25-19
	DRWG. NO.	25-19_04B



- 
 - REQUEST ENCROACHMENT (FOR TREE GRATE)
- 
 - REQUEST ENCROACHMENT (FOR LIGHT POLE)
- 
 - REQUEST ENCROACHMENT (FOR BOLLARD, REMOVABLE)
- 
 - REQUEST ENCROACHMENT (FOR FIXED BOLLARD)



(FOR OFFICE USE ONLY)

CARTO 28 A

DRAWN BY	LC
DATE	12-18-2025
CHECKED	AP/T/S
APPROVED	GE

**REQUEST ENCROACHMENT INTO
MONROE STREET FROM RANDOLPH ST. TO I-75
(GREEKTOWN CORRIDOR)**

CITY OF DETROIT CITY ENGINEERING DIVISION MAPS & RECORDS BUREAU	JOB NO.	25-19
	DRWG. NO.	25-19_05A





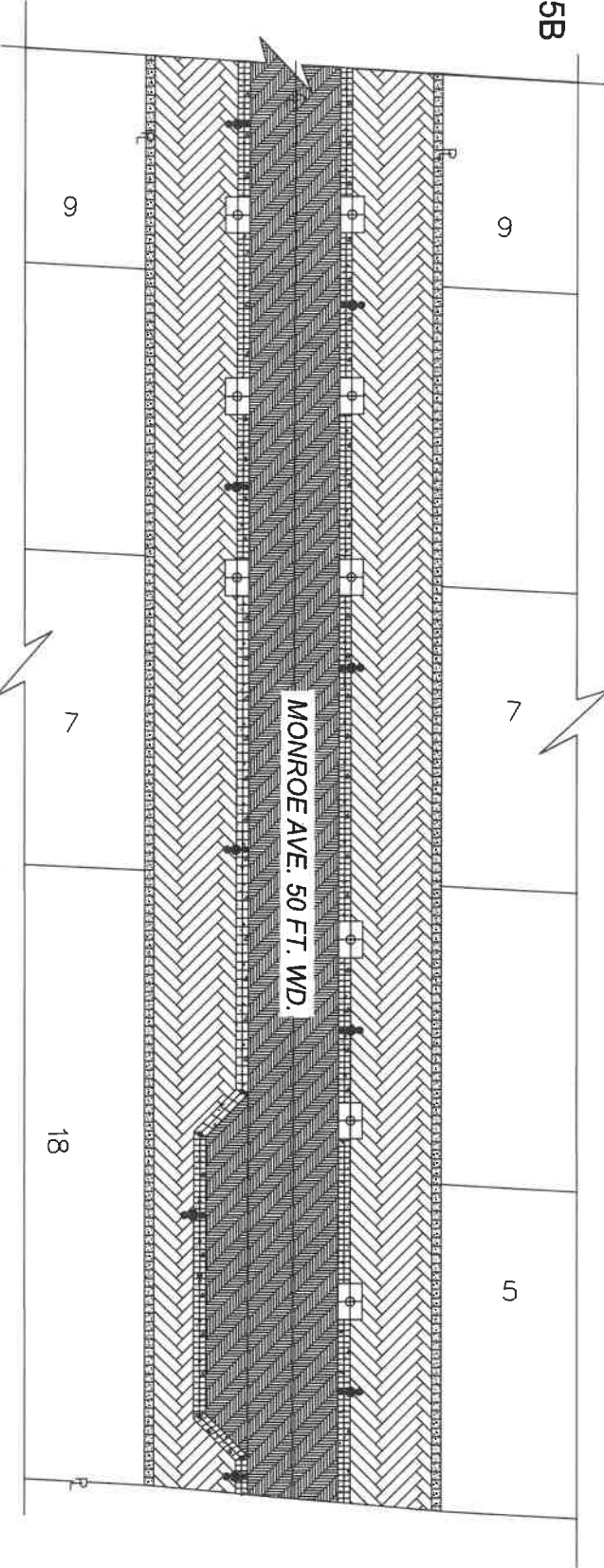

BEAUBIEN ST. 60 FT. WD.

AREA 5B

LAFAYETTE AVE. 50 FT. WD.



-  - REQUEST ENCROACHMENT (FOR TILE TYPE 1, GUIDE WAY)
-  - REQUEST ENCROACHMENT (FOR TILE TYPE 2, DETECTABLE WARNING)
-  - REQUEST ENCROACHMENT (FOR GRANITE PAVEMENT, PEDESTRIAN)
-  - REQUEST ENCROACHMENT (FOR GRANITE PAVEMENT, VEHICULAR)

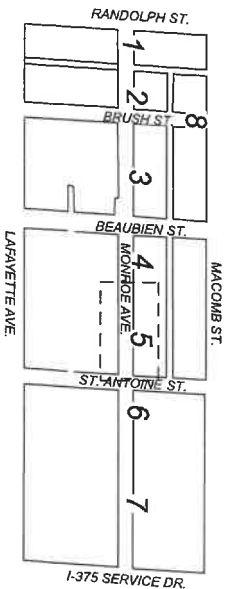

(FOR OFFICE USE ONLY)

CARTO 28 A

DRAWN BY	LC
DATE	12-18-2025
CHECKED	AP/T/S
APPROVED	GE

**REQUEST ENCROACHMENT INTO
MONROE STREET FROM RANDOLPH ST. TO I-75
(GREEKTOWN CORRIDOR)**

**CITY OF DETROIT
CITY ENGINEERING DIVISION
MAPS & RECORDS BUREAU**

JOB NO. 25-19

DRWG. NO. 25-19_05B

MACOMB ST. 50 FT. WD.

PROPOSED BIKE RACK
2.3' X 2.1' X 0.5', 4 QTY.
(2.1' ABOVE GRADE)

PROPOSED STONE PLANTER CURB
8' X 10' X 0.5', 2 QTY.
(0' TO 0.5' ABOVE GRADE)

AREA 6A

BEAUBIEN ST. 60 FT. WD.

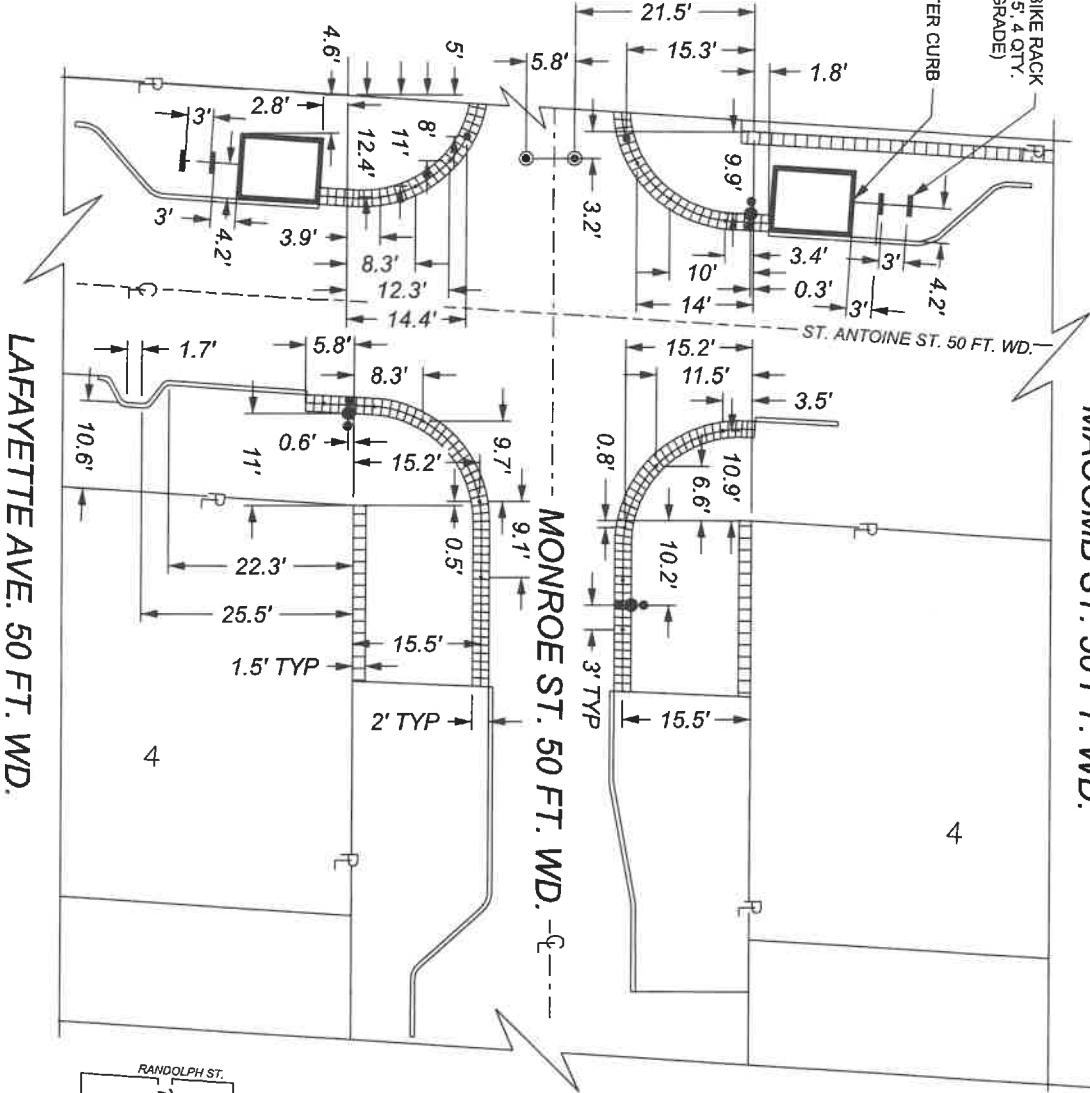

S. I-375 SERVICE DRIVE

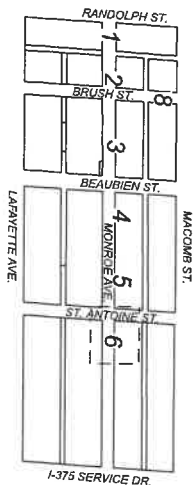

- REQUEST ENCROACHMENT (FOR BIKE RACK)
- REQUEST ENCROACHMENT (FOR TREE GRATE)
- REQUEST ENCROACHMENT (FOR LIGHT POLE)
- REQUEST ENCROACHMENT (FOR BOLLARD, REMOVABLE)
- REQUEST ENCROACHMENT (FOR FIXED BOLLARD)
- REQUEST ENCROACHMENT (FOR STONE PLANTER CURB, SIZES/SHAPES VARY)

(FOR OFFICE USE ONLY)

CARTO 28 A

DRAWN BY	LC
DATE	12-18-2025
CHECKED	AP/TJS
APPROVED	GE

REQUEST ENCROACHMENT INTO
MONROE STREET FROM RANDOLPH ST. TO I-75
(GREEKTOWN CORRIDOR)

CITY OF DETROIT
CITY ENGINEERING DIVISION
MAPS & RECORDS BUREAU

JOB NO. 25-19

DRWG. NO. 25-19_06A





AREA 6B

BEAUBIEN ST. 60 FT. WD.

ST. ANTOINE ST. 50 FT. WD.

MONROE ST. 50 FT. WD.

S. I-375 SERVICE DRIVE

LAFAYETTE AVE. 50 FT. WD.

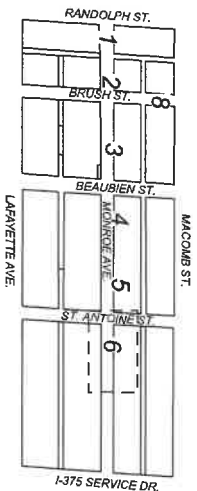
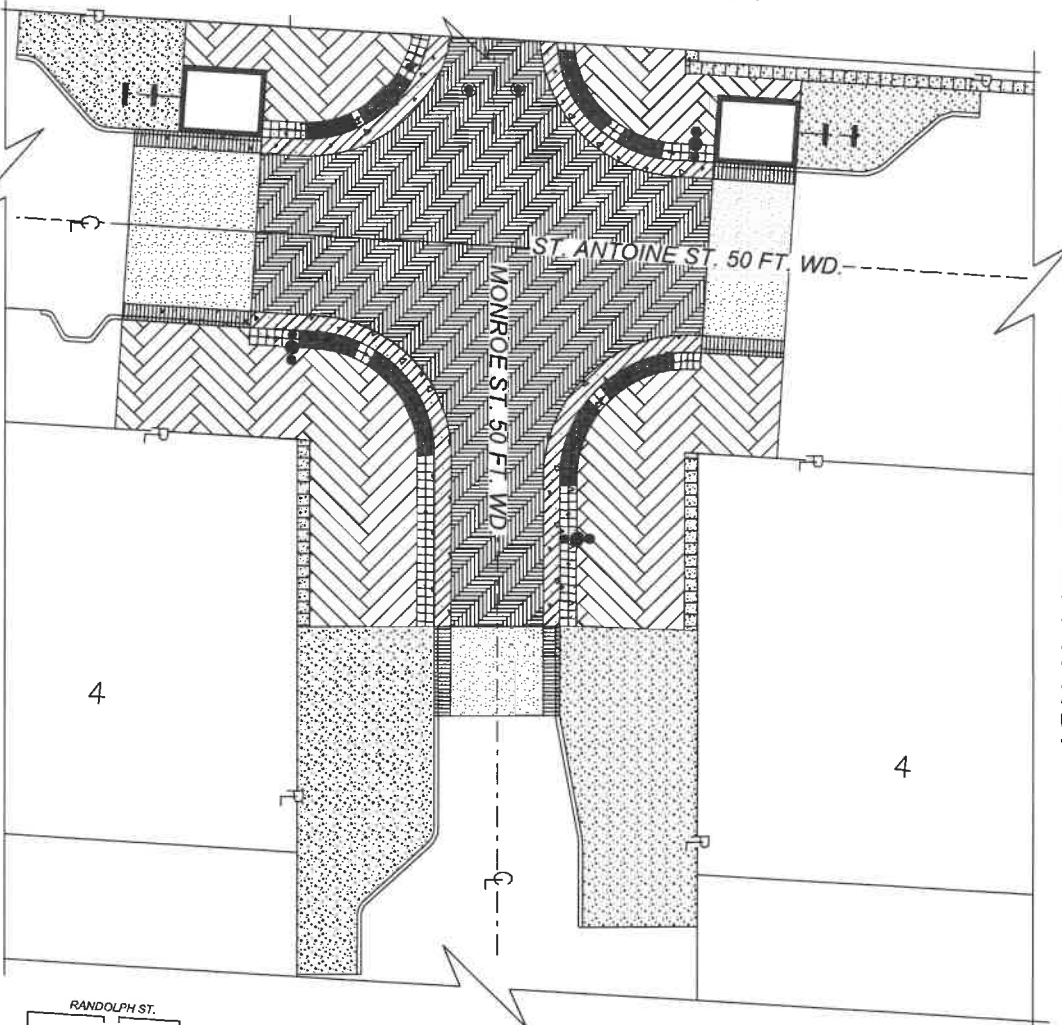

- REQUEST ENCROACHMENT (FOR TILE TYPE 1, GUIDE WAY)
- REQUEST ENCROACHMENT (FOR TILE TYPE 2, DETECTABLE WARNING)
- REQUEST ENCROACHMENT (FOR CONCRETE PAVEMENT MISC. NONREINF., 6 INCH, MODIFIED)
- REQUEST ENCROACHMENT (FOR GRANITE PAVEN, PEDESTRIAN)
- REQUEST ENCROACHMENT (FOR CURB AND GUTTER, CONC)
- REQUEST ENCROACHMENT (FOR CONC PAVT. MISC. REINF. 8 INCH)
- REQUEST ENCROACHMENT (FOR CONC PAVT. MISC. REINF. VALLEY GUTTER)
- REQUEST ENCROACHMENT (FOR GRANITE PAVEN, VEHICULAR)

(FOR OFFICE USE ONLY)

CARTO 28 A

DRAWN BY	LC
DATE	12-18-2025
CHECKED	AP/TS
APPROVED	GE

**REQUEST ENCROACHMENT INTO
MONROE STREET FROM RANDOLPH ST. TO I-75
(GREEKTOWN CORRIDOR)**

CITY OF DETROIT
CITY ENGINEERING DIVISION
MAPS & RECORDS BUREAU

JOB NO. 25-19

DRWG. NO. 25-19_06B