

**SANTA MARIA AVE. 50 FT. WD.**

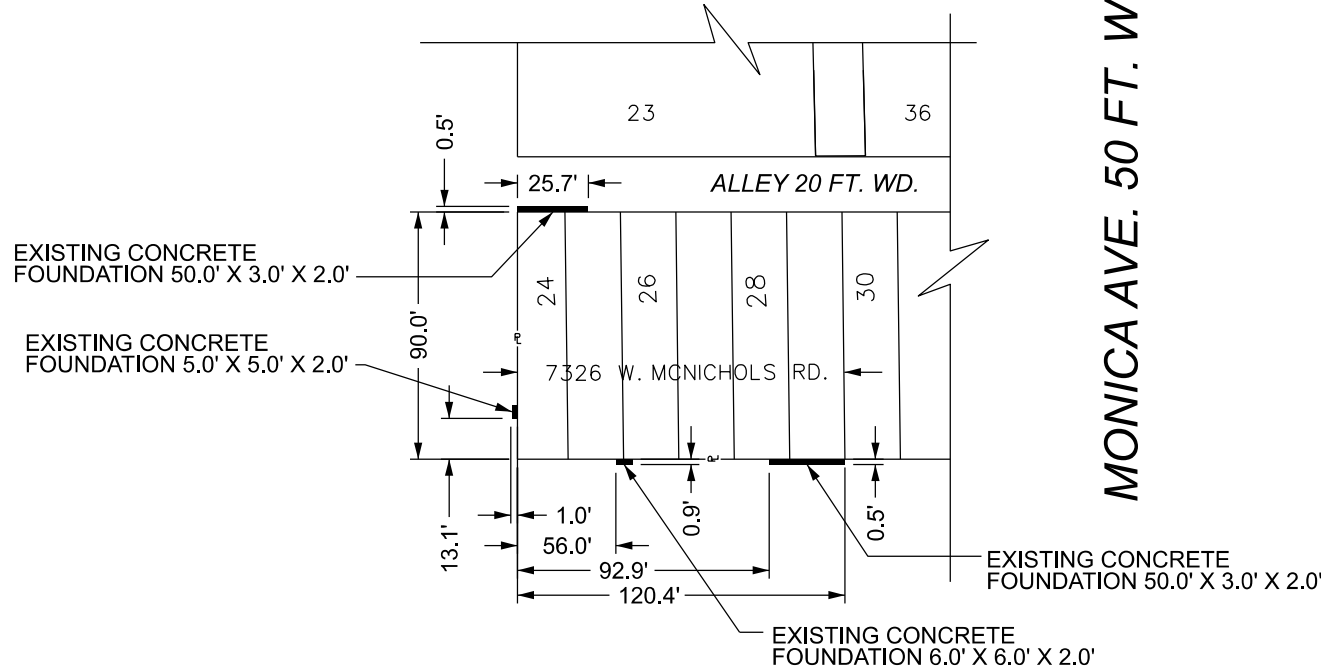

**PRAIRE AVE. 50 FT. WD.**



**MONICA AVE. 50 FT. WD.**

**W. McNICHOLS RD. 66 FT. WD.**

**SANTA MARIA AVE.**

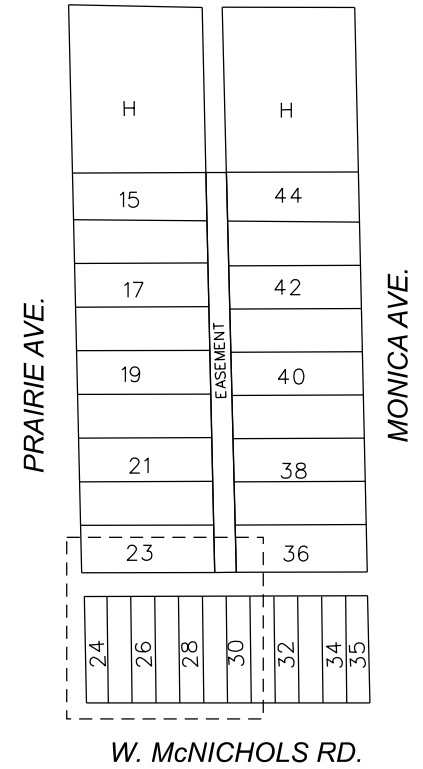

**NOTE:**

ALL EXISTING (50.0' X 3.0' X 2.0') CONCRETE FOUNDATION HAS A MAX 0.5' ENCROACHMENT GRADUALLY DECREASES TO 0.0' AS THE ENCROACHMENT MOVES ALONG THE PROPERTY LINE THE PROPERTY LINE IS NOT ORTHOGONAL

**■** - REQUEST ENCROACHMENT (FOR CONCRETE FOUNDATION)

(FOR OFFICE USE ONLY)

CARTO 89 F

<b>DRAWN BY</b>	AP
<b>DATE</b>	03/10/2026
<b>CHECKED</b>	LC
<b>APPROVED</b>	GE

**REQUEST ENCROACHMENTS INTO THE EAST/WEST ALLEY, 20 FT. WD., PRAIRE AVE. 50 FT. WD., AND W. McNICHOLS RD. 66 FT. WD. AT 7326 W. McNICHOLS RD.**

<b>CITY OF DETROIT</b>	
CITY ENGINEERING DIVISION MAPS & RECORDS BUREAU	
<b>JOB NO.</b>	25-117
<b>DRWG. NO.</b>	