

# City of Detroit

Janice M. Winfrey  
City Clerk

OFFICE OF THE CITY CLERK

Andre P. Gilbert II  
Deputy City Clerk

## DEPARTMENT PETITION REFERENCE COMMUNICATION

*To: The Department or Commission Listed Below*

*From: Janice M Winfrey, Detroit City Clerk*

---

The following petition is herewith referred to you for report and recommendation to the City Council.

In accordance with that body's directive, kindly return the same with your report in duplicate within four (4) weeks.

---

Petition No.	2026-013
Name of Petitioner	DD Metro LLC
Description of Petition	Petition request a vacation with the reserve of a utility easement part of Auburn Ave., lying southerly of Glendale Ave.
Type of Petition	<b>Alley Vacation/Encroachment/Utility Vacation</b>
Submission Date	02/05/26
Concerned Departments	Media Services, Building & Safety Engineering, Police Department, Fire Department, Municipal Parking Department, Transportation Department, Health Department, General Services Department
Petitioner Contact	Kevin McDonald / Daniel DiLegge 12810 Auburn St. Detroit, MI 48223 (Ph) 586-405-5751 or (Ph) 810-560-3984 <a href="mailto:ddillegge@dvmutilities.com">ddillegge@dvmutilities.com</a> or <a href="mailto:kmcdonald@dvmutilities.com">kmcdonald@dvmutilities.com</a>



**CITY OF DETROIT  
DEPARTMENT OF PUBLIC WORKS  
CITY ENGINEERING DIVISION**

**COLEMAN A. YOUNG MUNICIPAL CENTER  
2 WOODWARD AVE. SUITE 601  
DETROIT, MICHIGAN 48226  
PHONE: (313) 224-3949 TTY: 711  
WWW.DETROITMI.GOV**

---

To: Clerk's Office  
From: The Department of Public Works  
City Engineering Division  
MapsandRecordsBureau@DetroitMI.Gov  
(313) 224-3970

Petitioner:  
DD Metro LLC  
6045 Sims Dr., Ste 2  
Sterling Heights, MI 48313

On behalf of the above-mentioned petitioner the Department of Public Works: City Engineering Division is submitting a petition request for the below mentioned action. The petitioner has received a project consultation from the Department of Public Works: City Engineering Division and has been advised the following:

Type of action recommended:

Petition to request for a vacation with the reserve of a utility easement part of Auburn Ave., lying southerly of Glendale Ave.

Georgine Gersdorff  
Manager II  
Department of Public Works  
City Engineering Division  
313-224-3985



CITY OF DETROIT  
DEPARTMENT OF PUBLIC WORKS  
CITY ENGINEERING DIVISION

COLEMAN A. YOUNG MUNICIPAL CENTER  
2 WOODWARD AVE. SUITE 601  
DETROIT, MICHIGAN 48226  
PHONE: (313) 224-3949 TTY: 711  
WWW.DETROITMI.GOV

---

**Daniel Dilegge**

12810 Auburn St

Detroit, MI 48223

586-405-5751 or 810-560-3984

[ddillegge@dvmutilities.com](mailto:ddillegge@dvmutilities.com) or [kmcdonald@dvmutilities.com](mailto:kmcdonald@dvmutilities.com)

12-29-2025

City of Detroit

Department of Public Works, City Engineering Division

**Re: Maintain Existing Gate at Glendale Street & Auburn Street**

Dear Georgine,

The gate in question has been in continuous use since 2009, as confirmed by historical aerial imagery available through Google Earth. For more than fifteen years, the gate has existed without issue and has become an established feature of the area. During this time, it has served an important purpose in controlling access, improving safety, and discouraging unauthorized use of the roadway.

Thank you for your time and consideration of this request.

Sincerely,

Kevin McDonald on behalf of Daniel DiLegge



**CITY OF DETROIT**  
**DEPARTMENT OF PUBLIC WORKS**  
**CITY ENGINEERING DIVISION**

**COLEMAN A. YOUNG MUNICIPAL CENTER**  
**2 WOODWARD AVE. SUITE 601**  
**DETROIT, MICHIGAN 48226**  
**PHONE: (313) 224-3949 TTY: 711**  
**WWW.DETROITMI.GOV**

**This is the gate that has been in place since 2009 verified by Google Earth.**



**Satellite view of the intersection of Glendale & Auburn St.**



**CITY OF DETROIT**  
**DEPARTMENT OF PUBLIC WORKS**  
**CITY ENGINEERING DIVISION**

**COLEMAN A. YOUNG MUNICIPAL CENTER**  
**2 WOODWARD AVE. SUITE 601**  
**DETROIT, MICHIGAN 48226**  
**PHONE: (313) 224-3949 TTY: 711**  
**WWW.DETROITMI.GOV**

MAP-25-128

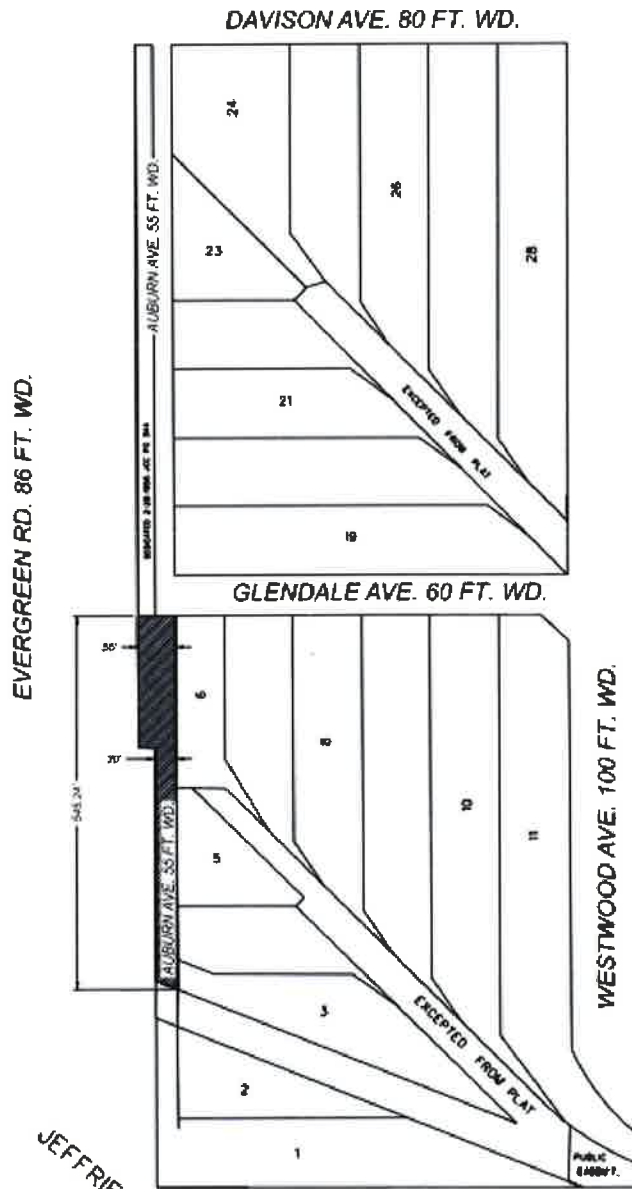

**JEFFRIES FREEWAY**

-REQUEST VACATION WITH EASEMENT

(FOR OFFICE USE ONLY)

CARTO 111 A

<b>DRAWN BY</b>	LC
<b>DATE</b>	01/16/2026
<b>CHECKED</b>	AP/TS
<b>APPROVED</b>	GE

**REQUEST VACATION WITH EASEMENT  
 OF AUBURN AVE.  
 BETWEEN GLENDALE AVE. AND  
 THE JEFFRIES FWY. (I-96)**

<b>CITY OF DETROIT</b>	
CITY ENGINEERING DIVISION	
MAPS & RECORDS BUREAU	
<b>JOB NO.</b>	25-128
<b>DRWG. NO.</b>	