

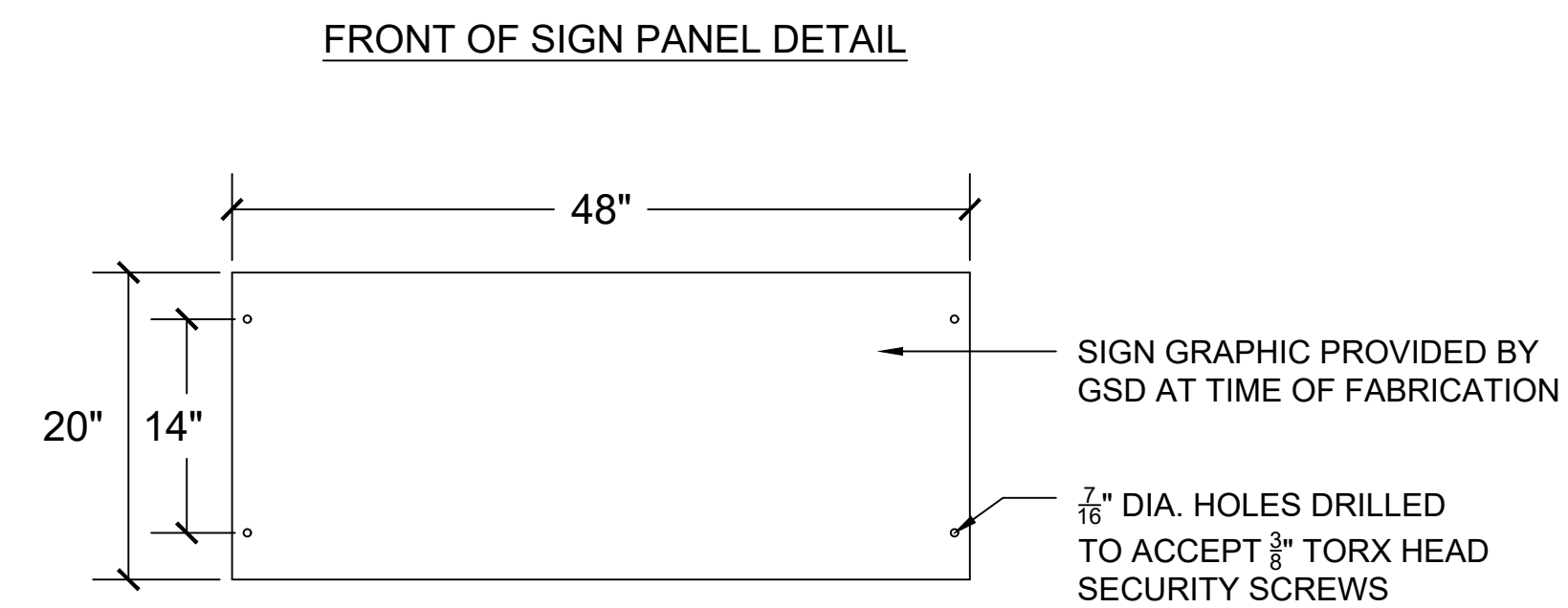

### MOUNTING PLATE DETAIL

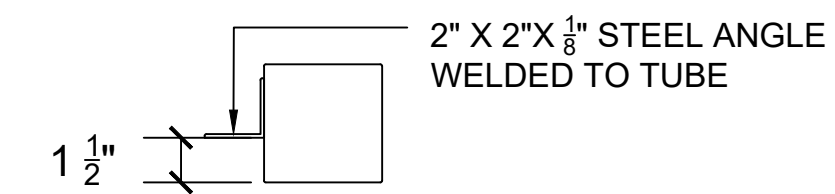

- GENERAL SERVICES DEPARTMENT**  
**LANDSCAPE DESIGN UNIT**  
18100 MEYERS RD, DETROIT MI 48235  
PH: (313) 628-0900 FAX: (313) 628-0927

1. DO NOT SCALE OFF THE DRAWINGS, DETAILS ARE NOT TO SCALE.
2. CHECK ALL MANUFACTURER'S SPECIFICATIONS AND DRAWINGS FOR FURTHER DETAILED INFORMATION.
3. CONTRACTOR TO SUPPLY AND APPLY LOCK TIGHT OR OTHER APPROVED TIGHT DETERRENT PRODUCT TO ALL SITE AMENITIES WHERE APPLICABLE.
4. ALL BOLTS SHALL BE CUT OR SAWED SO THERE IS A MAXIMUM OF 3 THREADS VISIBLE.
5. IF NOT SUPPLIED BY THE MANUFACTURER ALL HARDWARE SHALL BE PURCHASED AND INSTALLED (STAINLESS STEEL) BY THE CONTRACTOR.
6. ALL SITE AMENITIES SHALL BE LAYED OUT AND APPROVED BY THE CITY REPRESENTATIVE PRIOR TO INSTALLATION.
7. ALL SUBGRADES SHALL BE COMPACTED TO 95%.
8. CALL MISS DIG 72 HOURS (3 WORKING DAYS) PRIOR TO ANY CONSTRUCTION OR EXCAVATION TO MARK ALL UTILITIES. (800) 482-7171

PROJECT NAME:

**PROJECT NAME**

DRAWN:	APPROVED:
CHECKED:	SCALE:
ISSUED FOR	DATE
	1/15/2020

**SHEET TITLE:**

## PARK SIGN DETAILS CONTD

FOR FILE PROJ #: PROP #: XXX DIST #: X	SHEET  <b>L5.22</b>
---	---------------------------