

From: Rick Nelson <richard.nelson@dteenergy.com>
Sent: Friday, June 13, 2025 9:43 AM
To: Colby Toney <colby.toney@telecadeng.com>
Cc: Rebecca L Leppan <rebecca.pickler@dteenergy.com>
Subject: RE: [EXTERNAL] Fw: 24265 review of angle pole in Detroit

Colby,

This pole id denied due to it being an angle pole which excludes the antenna installation. There may be other candidates in the area, but they are probably excluded due to your RF connectivity.

Rick

From: Colby Toney
Sent: Thursday, June 5, 2025 11:58:21 AM
To: Rick Nelson <richard.nelson@dteenergy.com>
Cc: Breana Hughes <breana.smith@telecadeng.com>; Nick Guthrie <nick.guthrie@telecadeng.com>
Subject: 24265 review of angle pole in Detroit

Rick,

As discussed, please see the attached package for an angle pole in Detroit. May I ask that you provide a denial letter with your title with DTE included so I can pass along to Detroit? Thanks for your help here sir.

Thanks,



Colby Toney

TeleCAD Wireless Site Design, Inc.

1961 Northpoint Boulevard,

Suite 130

Hixson, TN 37343

C: (706) 313-3461

Email: colby.toney@telecadeng.com

This email and any files transmitted with it are confidential and intended solely for the use of the individual or entity to whom they are addressed. If you have received this email in error please notify the system manager. This message may contain confidential information and is intended only for the individual named. If you are not the named addressee you should not disseminate, distribute or copy this e-mail. Please notify the sender immediately by e-mail if you have received this e-mail by mistake and delete this e-mail from your system. If you are not the intended recipient you are notified that disclosing, copying, distributing or taking any action in reliance on the contents of this information is strictly prohibited. No employee or agent is authorized to conclude any binding agreement on behalf of TeleCAD Wireless Site Design, Inc. with another party by email without express written confirmation of TeleCAD CEO.



Email Permit package to:
JU_permit@dteenergy.com

Permit # _____

Service Area _____

Date Rec'd _____

Application/Notification for Attachment Permit (PL 175)
(Overhead) 963-2410 06-19

Customer Information**Att. Party/Joint User:** _____

Address: _____ City/State/Zip: _____

Contact Person: _____ Company: _____ Phone: _____

Customer's Internal Project Number: _____

Date Permit Submitted: _____**Project Information:****New Cable Construction** ☐ **Cable Overlash** ☐ **Power Supply/Camera Tap** ☐ **New Antenna** ☐ **Antenna Upgrade/Maint.** ☐**Map Section:** _____ **City:** _____ **No. of Poles (if applicable):** _____**Cable Information:**

Cable Information: Strand Size: _____ Cable O.D.: _____ Cable Weight: _____

Tension at 60 F Ambient Temp: _____ Tension under NESC Heavy Loaded Conditions: _____

Total # of Cables: _____

Power Supply / Camera Information: **Overhead Tap** ☐ **Underground Tap** ☐

Make: _____ Model Type: _____ Input Watts: _____

Address (street number/name): _____

Transformer Number (If Underground): _____

Antenna Information: **Antenna upgrade** ☐ **Antenna Maintenance** ☐ **Equipment Modification** ☐

Make: _____ Model Type: _____ Input Watts: _____

Address (street number/name): _____

The following items must be included with this Attachment request:

- **DTE outside sales product map with requested pole attachments and GLN numbers circled and numbered sequentially**
- **RF (EME Study) Form, engineering drawings and equipment specification sheet if applicable**

The granting of this permit does not, in any way, grant possessory interest to use public or private property. The Grantee (attaching party) is solely responsible for obtaining all necessary rights of ways, easements, permits, consents or approvals, either public or private. Permission is hereby granted to make a single attachment on _____ (number) of DTE poles within 6 months of the date this permit is granted, as specified on Exhibit 2-2, by XY coordinate. Billing for pole rental begins once the permission is granted to attach to the pole. Billing for power supplies begins when the power supply is energized. The installation of all pole attachments must conform to DTE construction standards and NESC rules and regulations. This permit must be on site during construction. Grantee's failure to produce a permit when requested, by a DTE employee or its representative, will result in an immediate job shut down until an approved permit can be produced. Grantee must send written notification to DTE that pole attachments have been made, within ten days of completion of construction. Grantee will be required to correct any violations of construction standards within thirty days. Grantee is required to maintain the approved permit on file and must produce upon request by DTE.

Permit to attach issued to Grantee By: _____ (Signature)**Date:** _____**Post Inspection Completed:** _____ (Signature)**Work approved by:** _____ (Print Name)**Date:** _____**Permit Issued:** _____ (Date) _____



Application/Notification for Attachment Permit (PL-175) (Overhead)

EXHIBIT 2-2

Email Permit Package to:
JU_permit@dteenergy.com

Permit # _____
Service Center _____

Enter the X and Y Coordinates off Outside Sales Product Map from the pole you have circled in red. Do not fill in the Attachment Height or Position on Pole. DTE will indicate the attachment height and position on pole on the returned permit for Joint Use construction.

	X Coordinate	Y Coordinate	Attachment Height		X Coordinate	Y Coordinate	Attachment Height
1				41			
2				42			
3				43			
4				44			
5				45			
6				46			
7				47			
8				48			
9				49			
10				50			
11				51			
12				52			
13				53			
14				54			
15				55			
16				56			
17				57			
18				58			
19				59			
20				60			
21				61			
22				62			
23				63			
24				64			
25				65			
26				66			
27				67			
28				68			
29				69			
30				70			
31				71			
32				72			
33				73			
34				74			
35				75			
36				76			
37				77			
38				78			
39				79			
40				80			

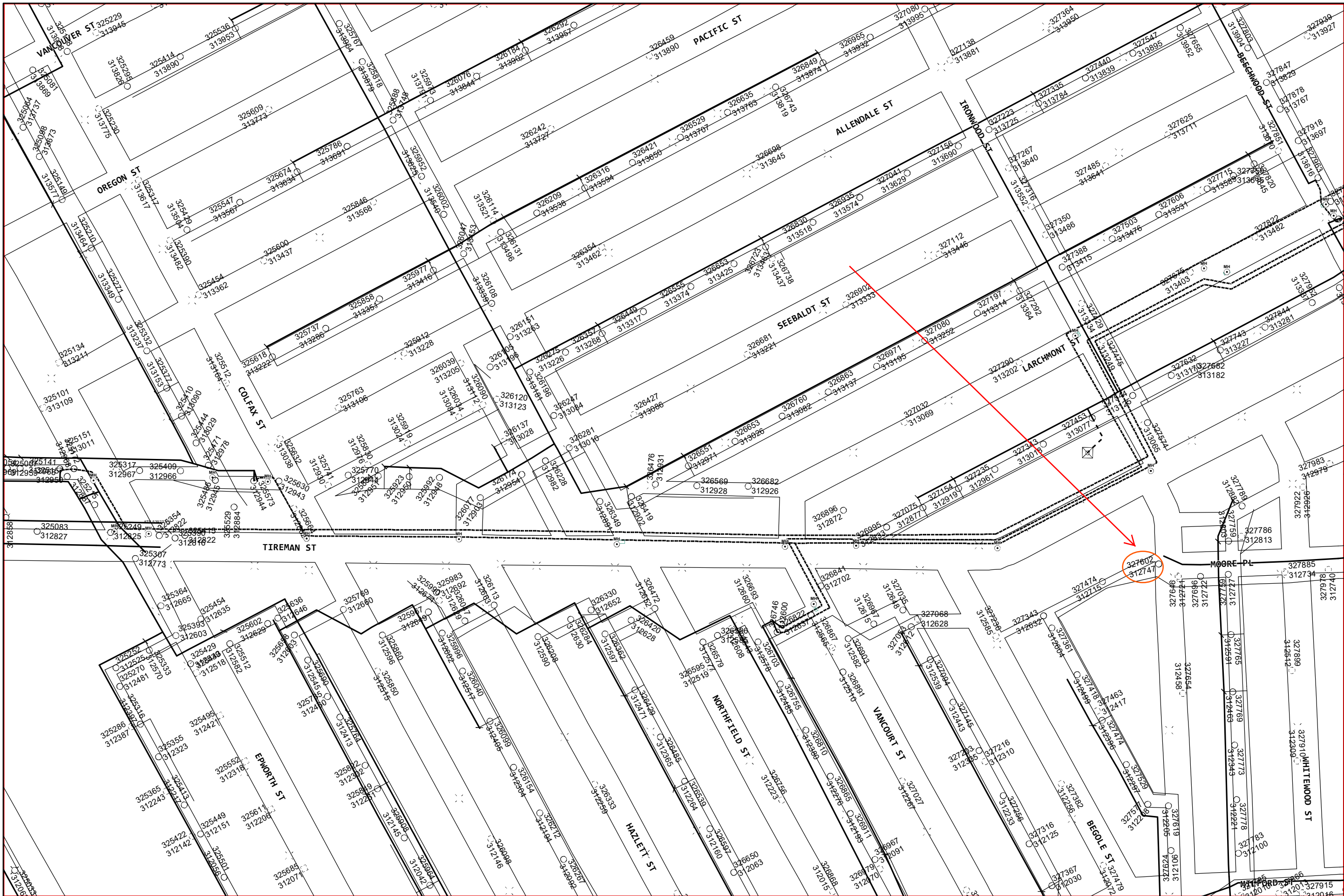

DTE ELECTRIC FACILITY MAP

COPYRIGHT 2025 DTE ENERGY - ALL RIGHTS RESERVED. NOT FOR SALE OR REPRODUCTION WITHOUT WRITTEN PERMISSION.
PROPRIETARY INFORMATION - FOR INTERNAL USE ONLY. THE INFORMATION AND FACILITY LOCATIONS ARE FOR REFERENCE ONLY. FIELD VERIFICATION REQUIRED.
CALL MISS DIG 3 DAYS BEFORE YOU DIG.

0 100 200 Feet Map #:325-312

4/1/2025

Pole View

