



Central Services Facility

313-267-8000 • detroitmi.gov/DWSD

Date:

- ☐ Outright Vacation
- ☐ Conversion to Easement

- ☐ Dedication
- ☐ Encroachment

☐ Berm Use

☐ Temporary Closing

☐ Approved Subject to Attached Provisions

☐ Not Approved

☐ Revise and Resubmit

--

	Name	Title	Signature	Date
Reviewed by:			Mohammad Siddique	
Approved by:			Mohammad Siddique For Syed Ali	

PROVISIONS FOR ENCROACHMENT

1. By approval of this petition the Detroit Water and Sewerage Department (DWSD) does not waive any of its rights to its facilities located in the right of way, and at all time, DWSD, its agents or employees, shall have the right to enter upon the right of way to maintain, repair, alter, service, inspect, or install its facilities. All costs incident to the damaging, dismantling, demolishing, removal and replacement of structures or other improvements herein permitted and incurred in gaining access to DWSD's facilities for maintenance, repairing, alteration, servicing, or inspection by DWSD shall be borne by the petitioner. All costs associated with gaining access to DWSD's facilities, which could normally be expected had the petitioner not encroached into the right of way shall be borne by DWSD.
2. All construction performed under this petition shall not be commenced until after five (5) days written notice to DWSD. Seventy-two (72) hour notice shall also be provided in accordance with P.A. 53 1974, as amended, utilizing the MISS DIG one call system.
3. Construction under this petition is subject to inspection and approval by DWSD. The cost of such inspection shall, at the discretion of DWSD, be borne by the petitioner.
4. DWSD prohibits the use of heavy construction equipment or the storage of building material directly over or near DWSD facilities. DWSD also prohibits the use of cranes and balls or hydraulic rams for pavement removal where DWSD facilities are involved. If the water main or sewer facilities are broken or damaged as a result of any action on the part of the contractor, the contractor shall be liable for all costs incidental to the repair of such broken or damaged water main or sewer facilities. If DWSD facilities located within the street shall break or be damaged as the result of any action on the part of the petitioner, then in such event the petitioner agrees to be liable for all costs incident to the repair, replacement or relocation of such broken or damaged DWSD facilities.
5. The petitioner shall hold DWSD harmless for any damage to the encroaching device constructed or installed under this petition, which may be caused by the failure of DWSD's facilities.
6. If at any time in the future the petitioner shall request removal and / or relocation of DWSD's facilities in the street being encroached upon, the petitioner agrees to pay all costs for such removal and/or relocation.
7. Prior to construction, Easement Encroachment Permit (EEP) should be obtained and the insurance required by the EEP should not expire until after completion of the construction.
8. For any proposed work that involves DWSD water mains and/or sewers, an approval and a permit is required from DWSD before commencement of work.
9. It is DWSD's requirement that any proposed utility crossing DWSD water mains and/or sewers perpendicularly must maintain a minimum of 18 inches vertical clearance. Any proposed utility running adjacent to DWSD water mains and/or sewers must maintain a minimum of 10 feet lateral clearance including any conduit and/or manholes walls. No utility is allowed to run along the top of the water main or/or sewer.
10. It is DWSD's requirement that no encroachment has a vertical clearance of less than 16 feet from the ground surface over DWSD water mains and/or sewers.



11444 Kaltz Ave. Warren, MI 48089
P: (586)759-2700 F: (586)759-2703
kdeters@metrodetroitsigns.com

DATE: 11/26/24
TO: City of Detroit Encroachment
FROM: Kevin Deters
Metro Detroit Signs
RE: Projecting sign for Piquette Flats at 411 Piquette
SGN2024-00140

Hello,

We are applying for an encroachment for an internally illuminated projecting sign on the southwest corner of the building. The sign projects 4 feet from the corner of the building. I have attached the site plan and a sealed drawing from an engineer for the sign.

Feel free to call me at (586)759-2700 if anything else is needed. Thank you for your assistance.

MAP-24-171

TROMBLY ST. 60 FT. WD.

VACATED
10/6/1941 JCC PG 2908



BRUSH ST. 60 FT. WD.

BEAUBIEN ST. 60 FT. WD.

4

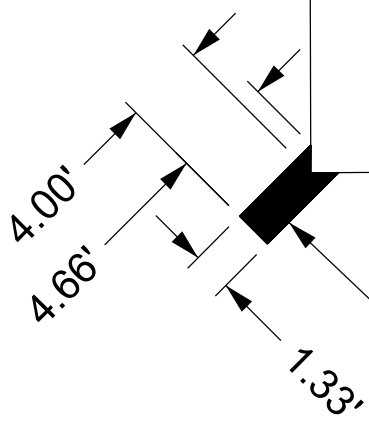

PIQUETTE ST. 80 FT. WD.

NEW BLADE SIGN
4.66' X 2.58' X 1.33'
17.42' TO 20' ABOVE GRADE



- REQUEST ENCROACHMENT
(For New Blade Sign)

(FOR OFFICE USE ONLY)

CARTO 31 F

B					
A					
DESCRIPTION		DRWN	CHKD	APPD	DATE
REVISIONS					
DRAWN BY		CHECKED		TS / LC	
AP					
DATE		APPROVED		GE	
12-02-2024					

**REQUEST ENCROACHMENT
INTO PIQUETTE ST. AND BRUSH ST.
AT 411 PIQUETTE ST.**

CITY OF DETROIT	
CITY ENGINEERING DIVISION	
SURVEY BUREAU	
JOB NO.	24-171
DRWG. NO.	

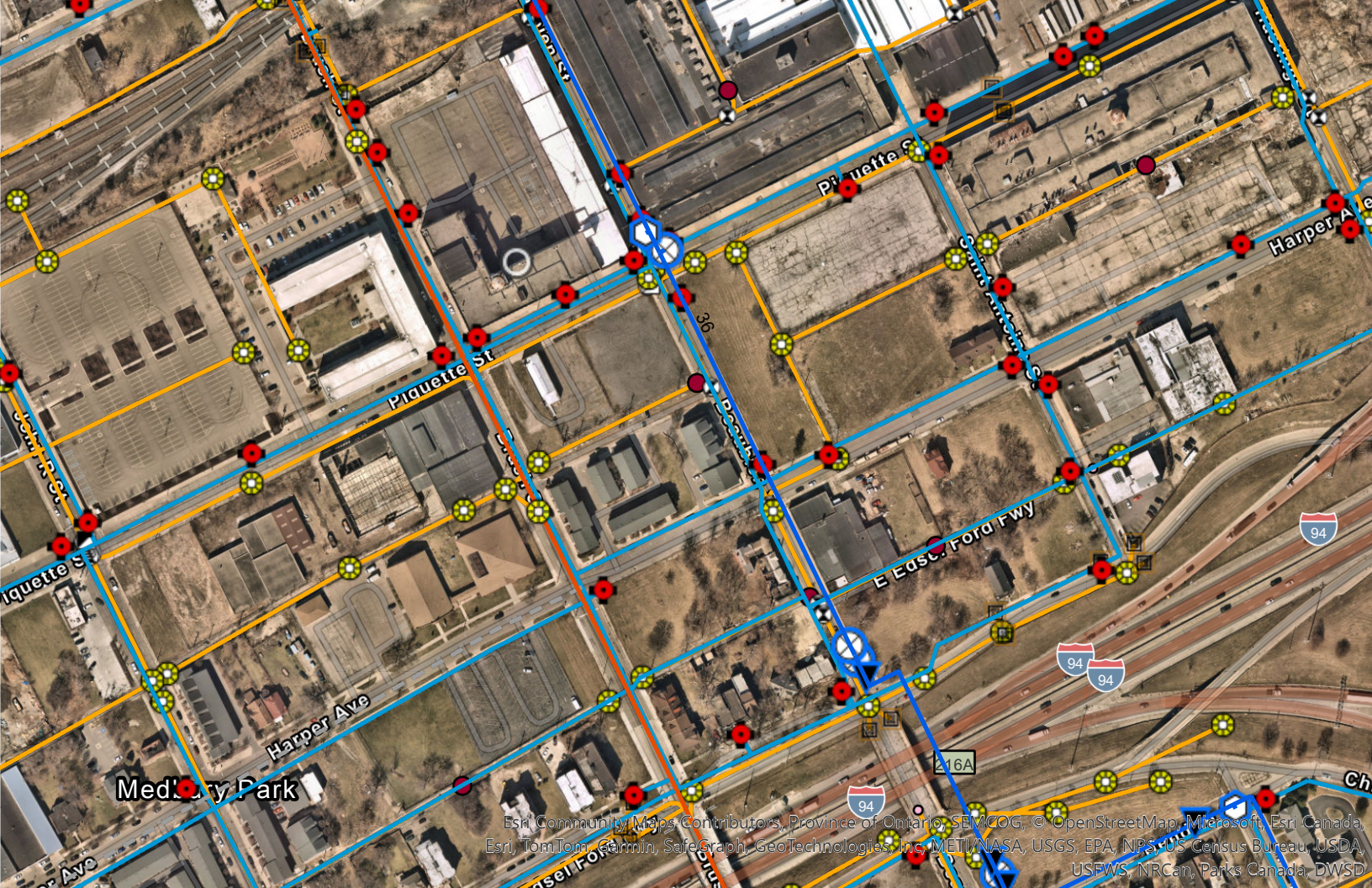





Google Maps

411 Piquette
Site Plan

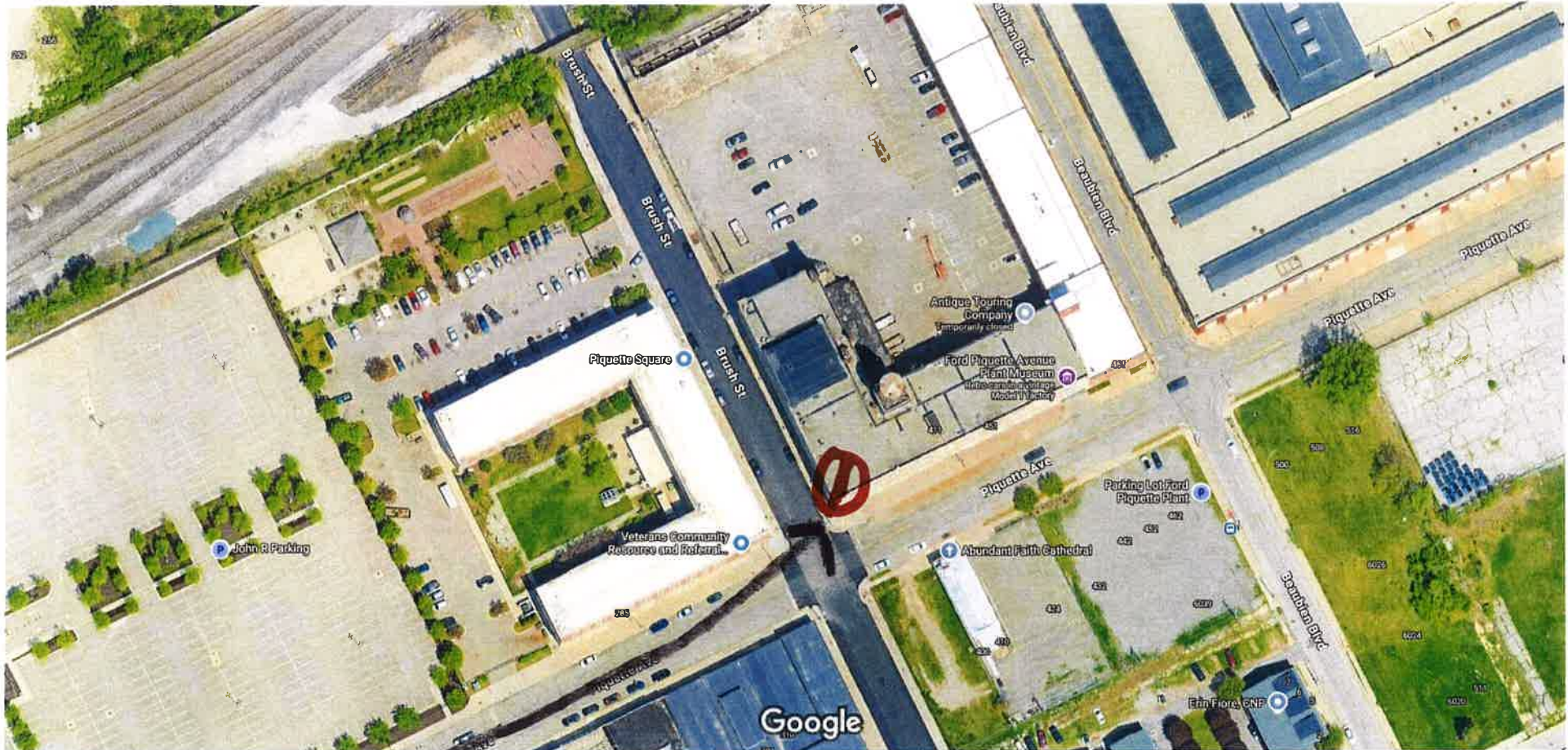

Imagery ©2024 Airbus, Maxar Technologies, Map data ©2024 Google 50 ft



= Projecting sign at SW corner of the building
— Sign projects 4 feet from the corner of the building

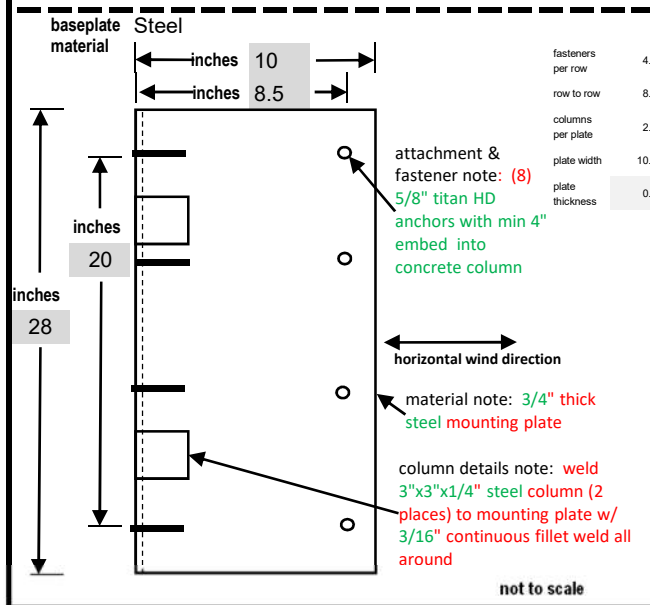
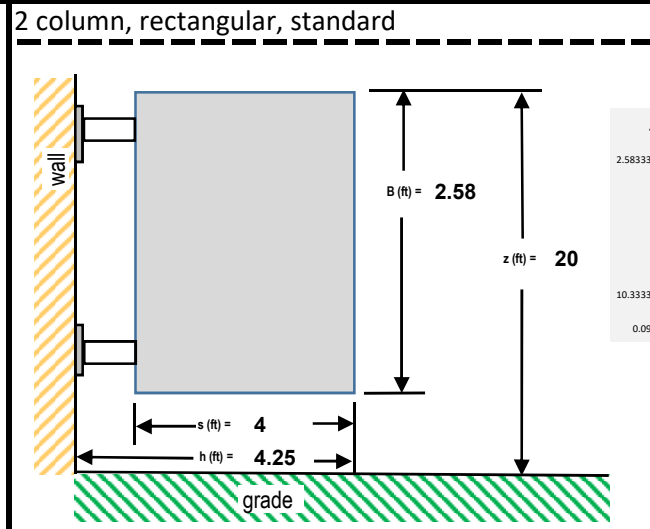
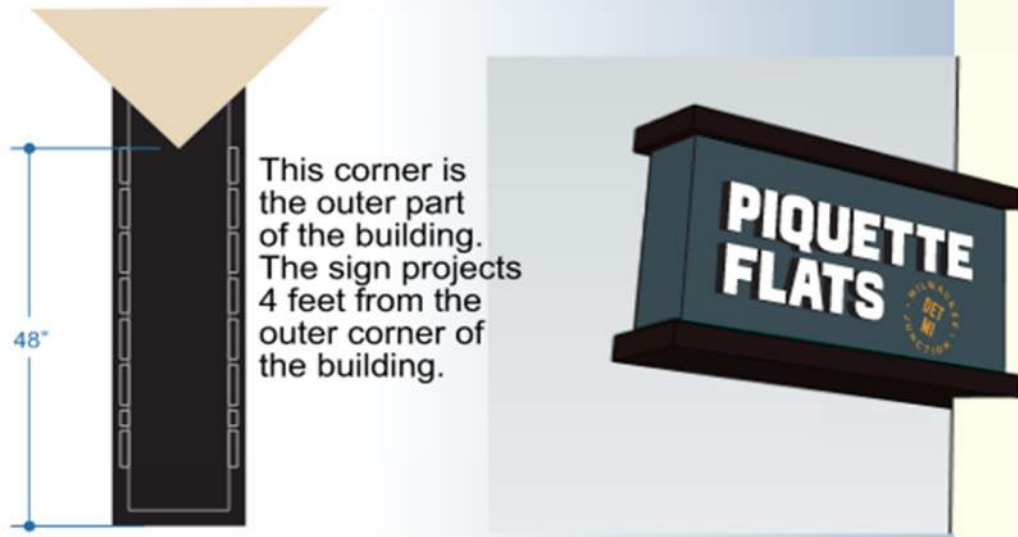

ASCE 7-10

at corner	Sign proximity to corner or on awning	K _{zt} =	4.0
-----------	---------------------------------------	-------------------	-----

2 number of attachment columns (usually 1 column per mounting plate)

* distance from wall to centroid location; Risk Category II windspeeds from ASCE Figure 26.5-1B, MRI = 700 years; Risk Category III windspeeds from ASCE Figure 26.5-1C, MRI = 1700 years; Section modulus required = moment per column / ((material ksi) / 0.6 safety factor).

column thickness (in) = 0.25

- Sign manufacturer/installer's design, detailing, fabrication, and erection shall conform to the following specifications: Building Code, ASTM specifications, ACI-318 for reinforced concrete, American Welding Society Code for Welding in Building Construction, AISC Specification for Design, Fabrication, and Erection of Structural Steel for Buildings.
- Wall material specifications for attachment only (building design and structure is by others):
 - CMU shall be 8" ASTM C90 with fasteners in 1.25" face shell
 - Wood framing shall be 2x4 SPF, 0.42 s. g. w/ fasteners in mid 1/2" of 1.5" edge.
 - Cold Formed steel framing shall be 0.033", 36 ksi with fasteners in flange.
 - Wood Structural Sheathing shall be 7/16" OSB or plywood.
 - Concrete shall be 3000 psi min compressive strength.
- Contractor shall verify all wall materials and construction, dimensions, and conditions in the field before erection, and notify the engineer of any discrepancies.
- Fasteners (all allowable loads are per allowable stress design):
 - $\geq 3/8"$ A307 STEEL THROUGH BOLTS (CMU, concrete, frame) (as specified in detail)
 - For solid walls, install w/ nut and 3x3x1/4" washer on back of wall
 - For frame walls, install with 2x6 syp #2, 2x2 angle, or 1.5" unistrut continuous blocking on back of wall (continuous blocking must extend past the end of the sign to the next framing member)
 - Allowable tension load = 500 lb.

In fact, materials and construction of existing walls is not known at the time of this seal; for this reason various attachment options for various wall construction types are specified.

386-754-5419

MIPE-6201060322



This seal for structural engineering
(Attachment ONLY)

SCOPE OF WORK: Establishes minimum structural requirements for attachment of generic signs to wall based on stated (not verified) wind & gravity loads and size & shape, based on sign installer's drawing, attached.

NOTE: THIS SIGN IS ADDING LOAD TO THE EXISTING BUILDING. IT IS THE RESPONSIBILITY OF THE SIGN INSTALLER TO HAVE THE BUILDING DESIGNER VERIFY THAT THE BUILDING CAN SUPPORT THE ADDITIONAL SIGN LOADS, BOTH WEIGHT AND WIND.

Piquette Flats

411 Piquette
Detroit, MI

METRO SIGNS & LIGHTING

JOB # 24168

BLADE SIGN

2 Columns, attached to wall