



**DEPARTMENT OF PUBLIC WORKS  
CITY ENGINEERING DIVISION**

Coleman A. Young Municipal Center  
2 Woodward Ave., Suite 601  
Detroit, Michigan 48226

Phone 313•224•3949 TTY: 711  
Fax 313•224•3471  
www.detroitmi.gov

December 17, 2024

Honorable City Council:

**RE: Petition No. x2024-412 – Downtown Detroit Partnership request for a vacation, with reserve of a utility easement into Campus Martius Park, bounded by Woodward Ave., Michigan Ave., Fort St., Monroe Ave., and Cadillac Square.**

Petition No. x2024-412 – Downtown Detroit Partnership request for a vacation, with reserve of a utility easement into Campus Martius Park, bounded by Woodward Ave., 190 ft. wide, Michigan Ave., 100 ft. wide, Fort St., 100 ft. wide, Monroe Ave., 120 ft. wide, and Cadillac Square, 200 ft. wide.

The petition was referred to the City Engineering Division – DPW for investigation (utility review) and report. This is our report.

The request was approved by the Solid Waste Division – DPW, and Traffic Engineering Division – DPW, and City Engineering - DPW. Detroit Water and Sewerage Department (DWSD) has no objection provided certain provisions are met. The DWSD provisions are a part of the attached resolution. All other involved City Departments, and privately owned utility companies have reported no objections. Provisions protecting utility installations are part of the attached resolution.

I am recommending adoption of the attached resolution.

Respectfully submitted,

Richard Doherty, P.E. City Engineer  
City Engineering Division – DPW

Cc: Ron Brundidge, Director, DPW  
Mayor's Office – City Council Liaison

BY COUNCIL MEMBER \_\_\_\_\_

**RESOLVED**, Campus Martius Park, 164.00 ft. wide, and 379.98 ft. in length, further described as land in the City of Detroit, Wayne County, Michigan being:

Campus Martius Park, 164.00' in width with a length of 379.98', bounded by Woodward Ave., 190 ft. wide, Michigan Ave., 100 ft. wide, Fort St., 100 ft. wide, Monroe Ave., 120 ft. wide and Cadillac Square 200 ft. wide. Said Campus Martius shall be 58.84' south of the north public right-of-way, 56.22' west from the east public right-of-way north of Cadillac Square, 55.39' west from the east public right-of-way south of Cadillac Square, 69.00' north of the south public right-of-way, 52.56' east of the west public right-of-way south of Michigan Avenue, and 85.64' east of the west public right-of-way north of Michigan Avenue of the "Plat of Section 8 Governor and Judges Plan" as recorded in Liber 34 Page 543, "Plat of Section 6 Governor and Judges Plan" as recorded in Liber 34 Page 545, "Plat of Lots 45 & 46 Section 6 Governor and Judges Plan" as recorded in Liber 1 Page 68, and "Plat of Part of Section 1 Governor & Judges Plan" as recorded in Liber 9 Pages 424-425 of Plats, Wayne County Records. Said Campus Martius Park shall retain an 8' wide public sidewalk around the entirety of the perimeter.

Be and the same is hereby vacated as public right-of-way and converted into a private easement for public utilities of the full width of the right-of-way, which easement shall be subject to the following covenants and agreements, uses, reservations and regulations, which shall be observed by the owners of the lots abutting on said right-of-way and by their heirs, executors, administrators and assigns, forever to wit:

First, said owners hereby grant to and for the use of the public an easement or right-of-way over said vacated public right of way herein above described for the purposes of maintaining, installing, repairing, removing, or replacing public utilities such as water mains, sewers, gas lines or mains, telephone, electric light conduits or poles or things usually placed or installed in a public right-of-way in the City of Detroit, with the right to ingress and egress at any time and over said easement for the purpose above set forth.

Second, said utility easement or right-of-way in and over said vacated right of way herein above described shall be forever accessible to the maintenance and inspection forces of the utility companies, or those specifically authorized by them, for the purpose of inspecting, installing, maintaining, repairing, removing, or replacing any sewer, conduit, water main, gas line or main, telephone or light pole or any utility facility placed or installed in the utility easement or right-of-way. The utility companies shall have the right to cross or use the driveways and yards of the adjoining properties for ingress and egress at any time to and over said utility easement with any necessary equipment to perform the above mentioned task, with the understanding that the utility companies, other than that specifically prohibited by this resolution, shall restore the easement surface to a satisfactory condition,

Third, said owners for their heirs and assigns further agree that no buildings or structures of any nature whatsoever including, but not limited to, concrete slabs or driveways, retaining or partition walls (except necessary line fences or gates), shall be built or placed upon said easement, nor change of surface grade made, without prior approval of the City Engineering Division – DPW,

Fourth, that if the owners of any lots abutting on said vacated right of way shall request the removal and/or relocation of any existing poles or other utilities in said easement; such owners shall pay all costs incidental to such removal and/or relocation, unless such charges are waived by the utility owners,

Fifth, that if any utility located in said property shall break or be damaged as a result of any action on the part of said owners or assigns (by way of illustration but not limitation) such as storage of excessive weights of materials or construction not in accordance with Section 3, mentioned above, then in such event said owners or assigns shall be liable for all costs incidental to the repair of such broken or damaged utility; and

PROVIDED, that whereas the vacated right-of-way described in this resolution is platted within the “Governor and Judges Plat”, the City of Detroit Planning and Development Department is hereby authorized to deed the vacated portion of the described right of way to the General Services Department: Parks and Recreation, or their assigns, and further

PROVIDED, that property owners maintain for DTE Energy, full access to their facilities at all times (i.e. gated access with DTE locks at all ends of the easement) and that free and easy access to the DTE facilities is reserved for DTE equipment, including the use of backhoes, bull dozers, cranes or pipe trucks, and other heavy construction equipment, as necessary for the alteration or repair of DTE facilities, and further

PROVIDED, that an easement, the full width of the existing right-of-way, is reserved for the Detroit Water and Sewage Department for the purpose of installing, maintaining, repairing, removing, or replacing any sewers, water mains, fire hydrants and appurtenances, with the right of ingress and egress at any time to, and over said easement for the purpose above set forth; and be it further

PROVIDED, that free and easy access to the sewers, water mains, fire hydrants and appurtenances within the easement is required for the Detroit Water and Sewerage Department equipment including the use of backhoes, bull dozers, cranes or pipe trucks, and other heavy construction equipment, as necessary for the alteration or repair of the sewer or water main facilities; and be it further

PROVIDED, that the Detroit Water and Sewerage Department retains the right to install suitable permanent main location guide post over its water mains at reasonable intervals and at points deflection; and be it further

PROVIDED, that said owners of the adjoining property, for themselves, their heirs and assigns, agree that no building or structure of any nature whatsoever, including porches, patios, balconies,

etc., shall be built upon said easement without prior written approval and agreement with the Detroit Water and Sewerage Department; and be it further

PROVIDED, that if any time in the future, the owners of any lots abutting on said vacated right of way shall request the removal and/or relocation of the aforementioned utilities in said easement, such owners shall pay all costs incident to such removal and/or relocation. It is further provided that if sewers, water mains, and/or appurtenances in said easement shall break or be damaged as a result of any action on the part of the owner, or assigns, then in such event, the owner or assigns shall be liable for the costs incident to the repair of such broken or damaged sewers and water mains, and shall also be liable for all claims for damages resulting from his action and be it further

PROVIDED, that if it becomes necessary to remove the paved right of way returns at the entrances such removal and construction of the new curb and sidewalk shall be done under city permit and inspection according to City Engineering Division – DPW specification with all costs borne by the abutting owner(s), their heirs or assigns; and further

PROVIDED, that the City Clerk shall within 30 days record a certified copy of this resolution with the Wayne County Register of Deeds.

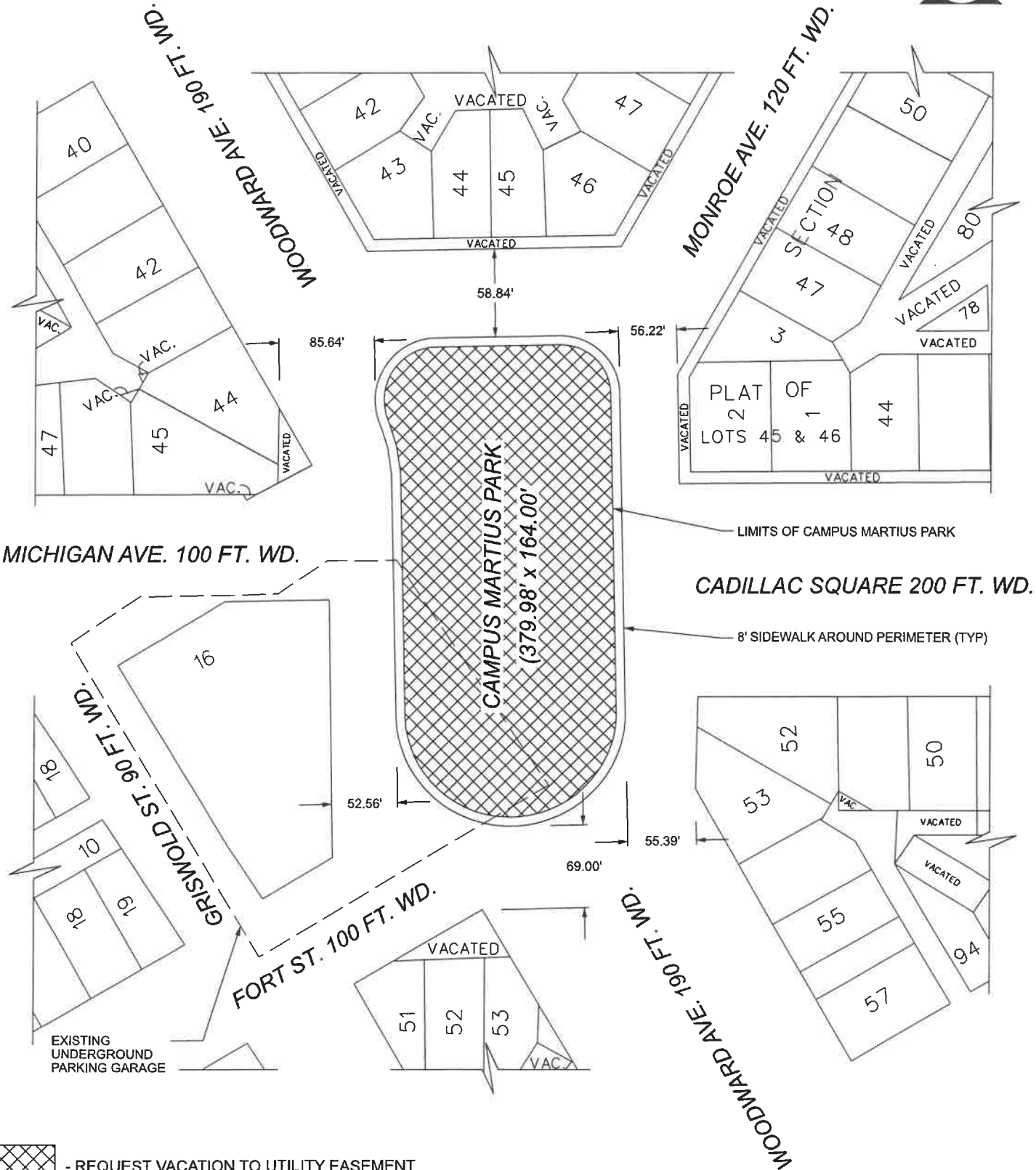

 - REQUEST VACATION TO UTILITY EASEMENT

(FOR OFFICE USE ONLY)

CARTO 28 A B E F

REQUEST VACATION TO UTILITY  
EASEMENT INTO CAMPUS MARTIUS  
PARK BOUNDED BY  
WOODWARD AVE., MICHIGAN AVE.,  
FORT ST., MONROE ST., AND  
CADILLAC SQUARE

CITY OF DETROIT  
CITY ENGINEERING DIVISION  
SURVEY BUREAU

JOB NO. 24-168

DRWG. NO.

<b>B</b>					
<b>A</b>					
DESCRIPTION		DRWN	CHEK	APPD	DATE
REVISIONS					
DRAWN BY	TS	CHECKED	LC/AP		
DATE	11-21-2024	APPROVED	GG		