



**CITY OF DETROIT
DEPARTMENT OF PUBLIC WORKS
CITY ENGINEERING DIVISION**

**COLEMAN A. YOUNG MUNICIPAL CENTER
2 WOODWARD AVE. SUITE 601
DETROIT, MICHIGAN 48226
PHONE: (313) 224-3949 TTY: 711
WWW.DETROITMI.GOV**

To: Clerk's Office
From: The Department of Public Works
City Engineering Division
MapsandRecordsBureau@DetroitMI.Gov
(313) 224-3970

Petitioner:
Left Field 2020 LDHA LLC
20250 Harper Ave
Detroit, MI 48225

On behalf of the above-mentioned petitioner the Department of Public Works: City Engineering Division is submitting a petition request for the below mentioned action. The petitioner has received a project consultation from the Department of Public Works: City Engineering Division and has been advised the following:

Type of action recommended:

Petition to request encroachment into the easterly portion of Cochrane Ave. for stair access and a concrete slab for a new construction.

Georgine Gersdorff
Manager II
Department of Public Works
City Engineering Division
313-224-3985



CITY OF DETROIT
DEPARTMENT OF PUBLIC WORKS
CITY ENGINEERING DIVISION

COLEMAN A. YOUNG MUNICIPAL CENTER
2 WOODWARD AVE. SUITE 601
DETROIT, MICHIGAN 48226
PHONE: (313) 224-3949 TTY: 711
WWW.DETROITMI.GOV

St. Clair Construction

Left Field
Encroachment Petition

Daniel Osborne
St. Clair Construction Company
20250 Harper Avenue
Detroit, Michigan 48225

September 11, 2024

Subject: Encroachment Petition for 2610 Cochrane

City of Detroit:

St. Clair Construction is the General Contractor of the Left Field project located at 2610 Cochrane – which is a multi-family housing project. We have been operating under Right of Way permit ENG-22-1638 and building permits BLD2021-03642 and BLD2022-03368.

Two sides of the building have a zero setback (Cochrane St. and W. Fisher Fwy). On the Cochrane St. side of the building, the approved plans show five stairways (shared between 10 living units) and a concrete pad for an emergency exit.

We are petitioning to locate these stairs, concrete pad and associated landscaping in the right of way. This would be a permanent encroachment.

Thank you,

Daniel Osborne
Project Manager
St. Clair Construction



CITY OF DETROIT
DEPARTMENT OF PUBLIC WORKS
CITY ENGINEERING DIVISION

COLEMAN A. YOUNG MUNICIPAL CENTER
2 WOODWARD AVE. SUITE 601
DETROIT, MICHIGAN 48226
PHONE: (313) 224-3949 TTY: 711
WWW.DETROITMI.GOV

MAP-24-141

FISHER FREEWAY I-75

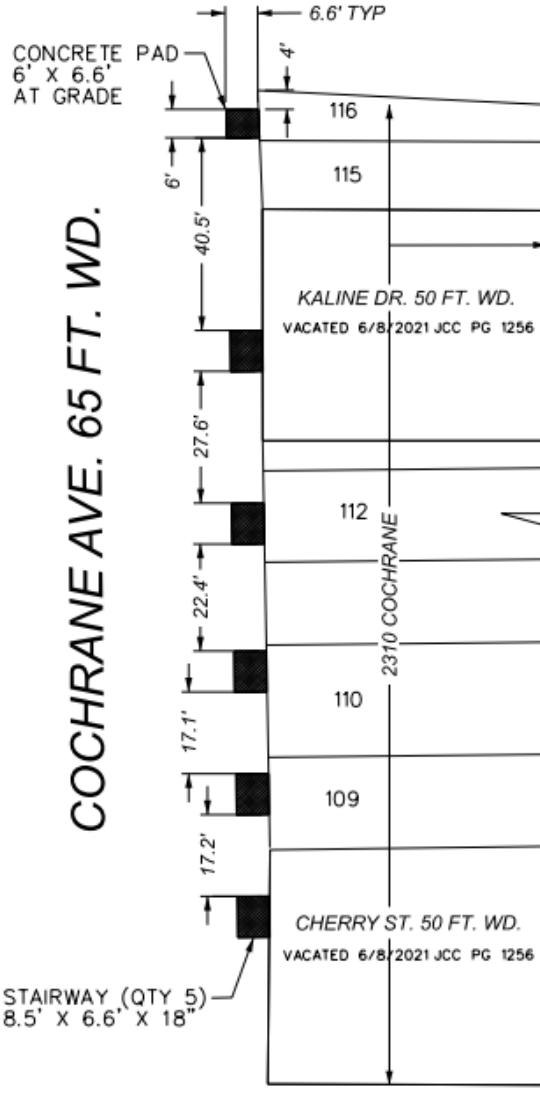

COCHRANE AVE. 65 FT. WD.

TRUMBULL AVE. 100 FT. WD.

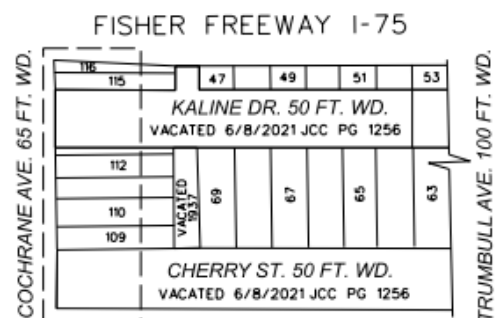

■ - REQUEST ENCROACHMENT
(FOR FIVE STAIRWAYS AND ONE CONCRETE PAD)

(FOR OFFICE USE ONLY)

CARTO 29 D

B					
A	DESCRIPTION	DATE	CHKD	APPR	DATE
	REVISIONS				
	DRAWN BY LC	CHECKED	AP		
	DATE 09-16-2024	APPROVED	RW		

REQUEST ENCROACHMENT ONTO
COCHRANE AVE.
AT 2310 COCHRANE AVE.
BETWEEN CHERRY ST. AND I-75 SERVICE DR.

CITY OF DETROIT CITY ENGINEERING DIVISION SURVEY BUREAU	
JOB NO.	24-141
DRWG. NO.	