

15" HDPE STM, 68 LFT
10.6' BELOW GRADE

15" HDPE STM, 37 LFT
4.7' BELOW GRADE

FISHER FREEWAY I-75

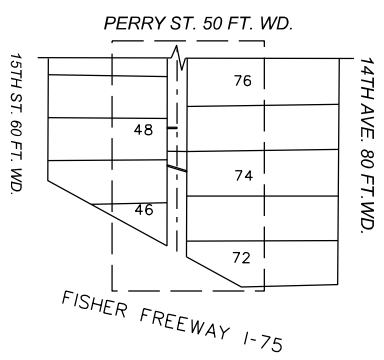

- REQUEST ENCROACHMENT (FOR BELOW GRADE STORM SEWER CROSSING)
- HEAVY DUTY CONCRETE PAVEMENT AREA

(FOR OFFICE USE ONLY)

CARTO 19 F

B					
A					
DESCRIPTION		DRWN	CHKD	APPD	DATE
REVISIONS					
DRAWN BY	LC	CHECKED		AP	
DATE	09-25-2024	APPROVED		RW	

**REQUEST ENCROACHMENT
INTO THE ALLEY BOUNDED BY
14TH ST., PERRY ST., 15TH ST.,
AND FISHER FWY. I-75 SERVICE DR.**

CITY OF DETROIT CITY ENGINEERING DIVISION SURVEY BUREAU	
JOB NO.	24-145
DRWG. NO.	