



CITY OF DETROIT  
DEPARTMENT OF PUBLIC WORKS  
CITY ENGINEERING DIVISION

COLEMAN A. YOUNG MUNICIPAL CENTER  
2 WOODWARD AVE. SUITE 601  
DETROIT, MICHIGAN 48226  
PHONE: (313) 224-3949 TTY: 711  
WWW.DETROITMI.GOV

---

To: Clerk's Office  
From: The Department of Public Works  
City Engineering Division  
MapsandRecordsBureau@DetroitMI.Gov  
(313) 224-3970

Petitioner:  
Detroit & Northern LLC  
1133 Griswold Street  
Detroit, MI, 48226

On behalf of the above-mentioned petitioner the Department of Public Works: City Engineering Division is submitting a petition request for the action below. The petitioner has received a project consultation from the Department of Public Works: City Engineering Division and has been advised the following:

Type of action recommended:

Detroit & Northern LLC request for various encroachments; at grade trench drain, below grade pipe, balcony, below grade storm pipe, existing vault, and above grade building elements into the east-west public alley and Griswold St. right-of-way.

Raven Wright  
Supervisor of Maps & Records  
Department of Public Works  
City Engineering Division  
313-224-3985



**CITY OF DETROIT**  
**DEPARTMENT OF PUBLIC WORKS**  
**CITY ENGINEERING DIVISION**

**COLEMAN A. YOUNG MUNICIPAL CENTER**  
**2 WOODWARD AVE. SUITE 601**  
**DETROIT, MICHIGAN 48226**  
**PHONE: (313) 224-3949 TTY: 711**  
**[WWW.DETROITMI.GOV](http://WWW.DETROITMI.GOV)**

---



**CITY OF DETROIT**  
**DEPARTMENT OF PUBLIC WORKS**  
**CITY ENGINEERING DIVISION**

**COLEMAN A. YOUNG MUNICIPAL CENTER**  
**2 WOODWARD AVE. SUITE 601**  
**DETROIT, MICHIGAN 48226**  
**PHONE: (313) 224-3949 TTY: 711**  
**WWW.DETROITMI.GOV**



May 18, 2023

Honorable Detroit City Council  
 City of Detroit City Clerk  
 200 Coleman A. Young Municipal Center  
 2 Woodward Avenue  
 Detroit, Michigan 48226

RE: Giffels Webster - Petition requesting encroachments of public rights-of-way.

Giffels Webster, 28 W. Adams, Suite 1200, Detroit, Michigan 48226 on behalf of Detroit & Northern LLC, 401 S Washington sq, Suite 102, Lansing, Michigan, respectfully requests the following encroachments into the public rights-of-way in the block bounded by Griswold Street, Michigan Avenue, State Street, Washington Boulevard:

- Proposed above ground encroachment for a balcony from 117.00 feet above grade to 122.75 feet above grade extending into the Griswold Street and Public Alley right-of-way.

See referenced Exhibit for details.

Limits of the requested encroachments can be found in the attachment, enclosed herein.

If you should have any questions, please do not hesitate to contact me at (P) 313.962.4442 (M) 508.654.7945 or at leons@giffelswebster.com.

Respectfully,

Leon Evans P.E.,  
 Project Manager  
 Giffels Webster

28 W. Adams, Suite 1200 | Detroit, Michigan 48226 | Phone (313) 962-4442 | Fax (313) 962-5066



May 18, 2023

Honorable Detroit City Council  
 City of Detroit City Clerk  
 200 Coleman A. Young Municipal Center  
 2 Woodward Avenue  
 Detroit, Michigan 48226

RE: Giffels Webster - Petition requesting encroachments of public rights-of-way.

Giffels Webster, 28 W. Adams, Suite 1200, Detroit, Michigan 48226 on behalf of Detroit & Northern LLC, 401 S Washington sq, Suite 102, Lansing, Michigan, respectfully requests the following encroachments into the public rights-of-way in the block bounded by Griswold Street, Michigan Avenue, State Street, Washington Boulevard:

- Proposed below ground encroachment for an existing vault from 0 feet to 13.5 feet below grade into Griswold Street right-of-way.

See the referenced Exhibit for details.

Limits of the requested encroachments can be found in the attachment, enclosed herein.

If you should have any questions, please do not hesitate to contact me at (P) 313.962.4442 (M) 508.654.7945 or at leons@giffelswebster.com.

Respectfully,

Leon Evans P.E.,  
 Project Manager  
 Giffels Webster

28 W. Adams, Suite 1200 | Detroit, Michigan 48226 | Phone (313) 962-4442 | Fax (313) 962-5066



May 24, 2023

Honorable Detroit City Council  
 City of Detroit City Clerk  
 200 Coleman A. Young Municipal Center  
 2 Woodward Avenue  
 Detroit, Michigan 48226

RE: Giffels Webster - Petition requesting encroachments of public rights-of-way.

Giffels Webster, 28 W. Adams, Suite 1200, Detroit, Michigan 48226 on behalf of Detroit & Northern LLC, 401 S Washington sq, Suite 102, Lansing, Michigan, respectfully requests the following encroachments into the public rights-of-way in the block bounded by Griswold Street, Michigan Avenue, State Street, Washington Boulevard:

- Proposed at grade encroachment for a trench drain into Griswold Street right-of-way.
- Proposed below grade encroachment for a storm pipe into Griswold Street right-of-way.

See the referenced Exhibit for details.

Limits of the requested encroachments can be found in the attachment, enclosed herein.

If you should have any questions, please do not hesitate to contact me at (P) 313.962.4442 (M) 508.654.7945 or at leons@giffelswebster.com.

Respectfully,

Leon Evans P.E.,  
 Project Manager  
 Giffels Webster

28 W. Adams, Suite 1200 | Detroit, Michigan 48226 | Phone (313) 962-4442 | Fax (313) 962-5066



July 31, 2023

Honorable Detroit City Council  
 City of Detroit City Clerk  
 200 Coleman A. Young Municipal Center  
 2 Woodward Avenue  
 Detroit, Michigan 48226

RE: Giffels Webster - Petition requesting encroachments of public rights-of-way.

Giffels Webster, 28 W. Adams, Suite 1200, Detroit, Michigan 48226 on behalf of Detroit & Northern LLC, 401 S Washington sq, Suite 102, Lansing, Michigan, respectfully requests the following encroachments into the public rights-of-way in the block bounded by Griswold Street, Michigan Avenue, State Street, Washington Boulevard:

- Proposed above ground encroachment for building elements from 0.00 feet above grade to 7.00 feet above grade (approx.) extending into the Griswold Street and Public Alley right-of-way.
  - These building elements shall include a GFRP or GFRP cladding material on the existing columns, and a granite base at the sidewalk level, to cover them for aesthetic purposes and for making the building watertight.
- Proposed above ground encroachment for building elements from 21.00 feet above grade to 23.00 feet above grade extending into the Griswold Street and Public Alley right-of-way.
  - These building elements shall include a GFRP/GFRP water table projection.
- Proposed above ground encroachment for building elements from 93.00 feet above grade to 97.00 feet above grade extending into the Griswold Street and Public Alley right-of-way.
  - These building elements shall include a balcony with GFRP/GFRP cladding and guardrail made from glass and metal.

See referenced Exhibits for details.

Limits of the requested encroachments can be found in the attachment, enclosed herein.

If you should have any questions, please do not hesitate to contact me at (P) 313.962.4442 or at leons@giffelswebster.com.

Respectfully,

Leon Evans, PE  
 Project Manager

28 W. Adams, Suite 1200 | Detroit, Michigan 48226 | Phone (313) 962-4442 | Fax (313) 962-5066



CITY OF DETROIT  
DEPARTMENT OF PUBLIC WORKS  
CITY ENGINEERING DIVISION

COLEMAN A. YOUNG MUNICIPAL CENTER  
2 WOODWARD AVE. SUITE 601  
DETROIT, MICHIGAN 48226  
PHONE: (313) 224-3949 TTY: 711  
WWW.DETROITMI.GOV



January 18, 2022

Honorable Detroit City Council  
C/o Detroit City Clerk  
200 Coleman A. Young Municipal Center  
2 Woodward Avenue  
Detroit, Michigan 48226

RE: Giffels Webster - Petition requesting encroachments of public rights-of-way.

Giffels Webster, 28 W. Adams, Suite 1200, Detroit, Michigan 48226 on behalf of 1145 Griswold Street LLC, 401 S Washington sq. Suite 102, Lansing, Michigan, respectfully requests the following encroachments into the public rights-of-way in the block bounded by Griswold Street, Michigan Avenue, State Street, Washington Boulevard:

- Proposed above ground encroachment for a canopy from 9.9 feet above grade to 11.6 feet above grade extending 8.4 feet into the Griswold Street right-of-way.
- Proposed above grade encroachment for a canopy 9.4 feet above grade to 12.8 feet above grade extending 7.6 feet into the State Street right-of-way.

Limits of the requested encroachments can be found in the attachment, enclosed herein.

If you should have any questions, please do not hesitate to contact me at (P) 313.962.4442 (M) 508.654.7845 or at [levans@giffelswebster.com](mailto:levans@giffelswebster.com).

Respectfully,

Leon Evans P.E.,  
Project Manager  
Giffels Webster



**CITY OF DETROIT**  
**DEPARTMENT OF PUBLIC WORKS**  
**CITY ENGINEERING DIVISION**

**COLEMAN A. YOUNG MUNICIPAL CENTER**  
**2 WOODWARD AVE. SUITE 601**  
**DETROIT, MICHIGAN 48226**  
**PHONE: (313) 224-3949 TTY: 711**  
**[WWW.DETROITMI.GOV](http://WWW.DETROITMI.GOV)**

---



CITY OF DETROIT  
 DEPARTMENT OF PUBLIC WORKS  
 CITY ENGINEERING DIVISION

COLEMAN A. YOUNG MUNICIPAL CENTER  
 2 WOODWARD AVE. SUITE 601  
 DETROIT, MICHIGAN 48226  
 PHONE: (313) 224-3949 TTY: 711  
 WWW.DETROITMI.GOV

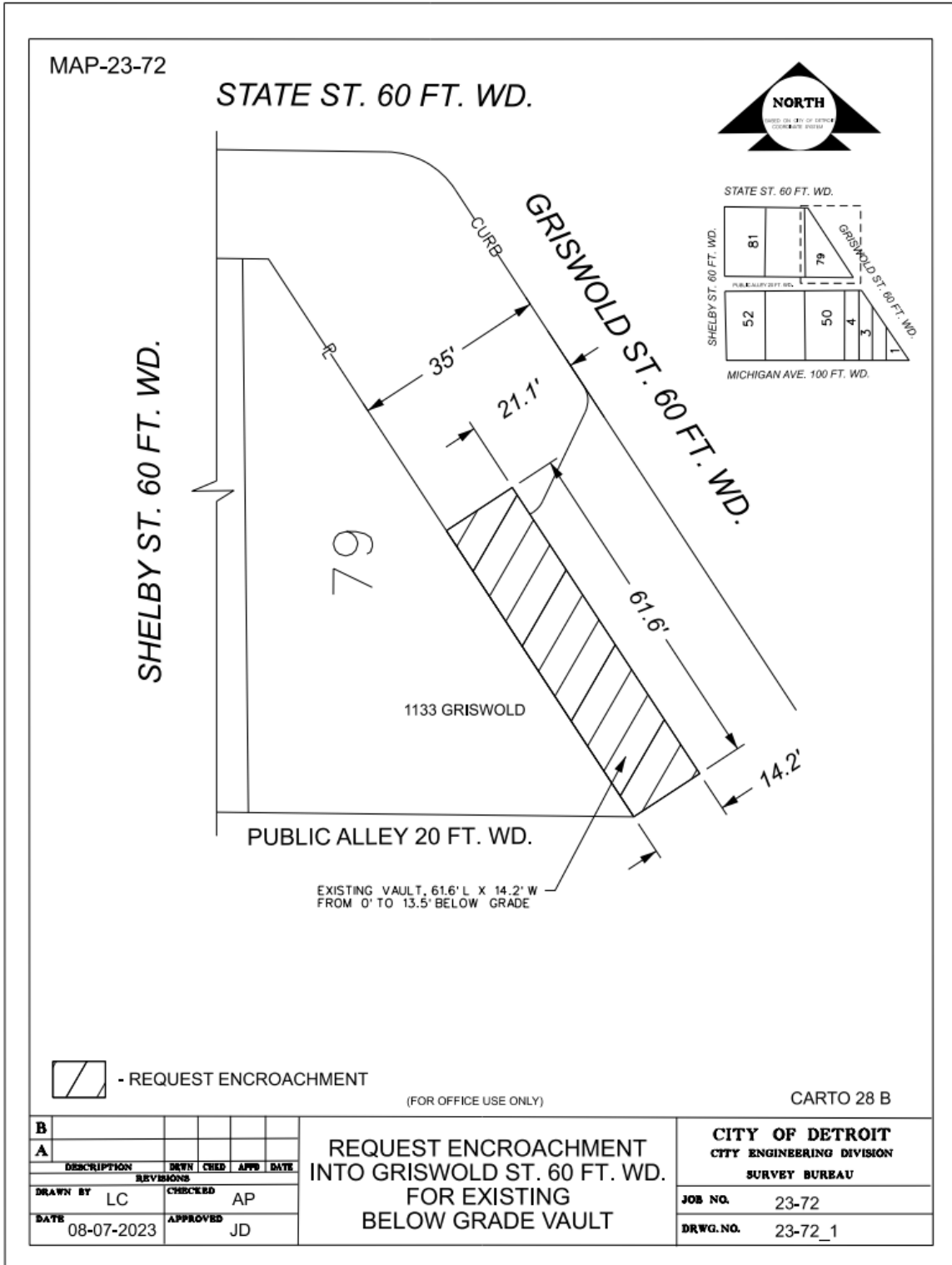



CITY OF DETROIT  
 DEPARTMENT OF PUBLIC WORKS  
 CITY ENGINEERING DIVISION

COLEMAN A. YOUNG MUNICIPAL CENTER  
 2 WOODWARD AVE. SUITE 601  
 DETROIT, MICHIGAN 48226  
 PHONE: (313) 224-3949 TTY: 711  
 WWW.DETROITMI.GOV

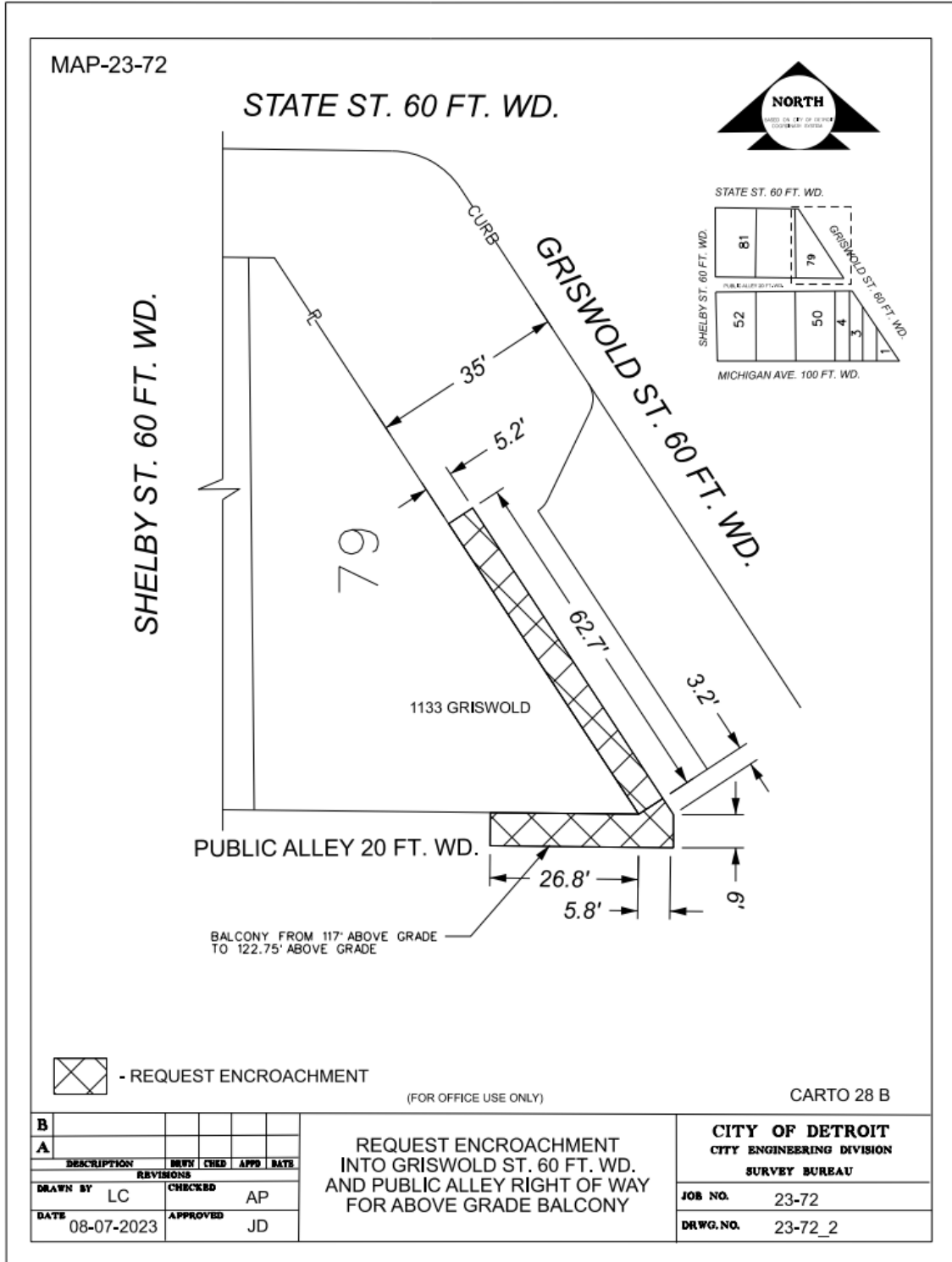



**CITY OF DETROIT  
DEPARTMENT OF PUBLIC WORKS  
CITY ENGINEERING DIVISION**

**COLEMAN A. YOUNG MUNICIPAL CENTER  
2 WOODWARD AVE. SUITE 601  
DETROIT, MICHIGAN 48226  
PHONE: (313) 224-3949 TTY: 711  
WWW.DETROITMI.GOV**

---





CITY OF DETROIT  
 DEPARTMENT OF PUBLIC WORKS  
 CITY ENGINEERING DIVISION

COLEMAN A. YOUNG MUNICIPAL CENTER  
 2 WOODWARD AVE. SUITE 601  
 DETROIT, MICHIGAN 48226  
 PHONE: (313) 224-3949 TTY: 711  
 WWW.DETROITMI.GOV

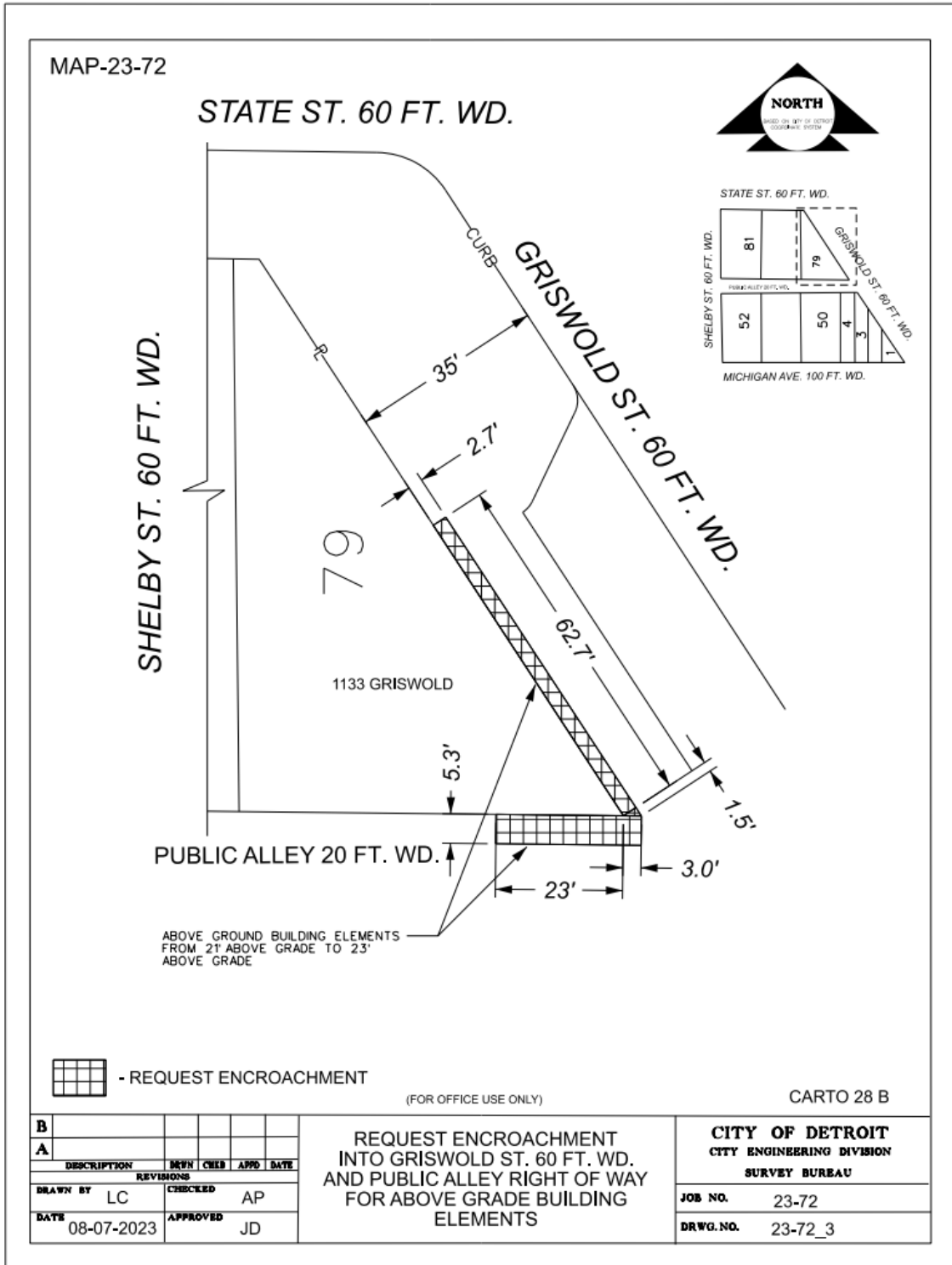



**CITY OF DETROIT**  
**DEPARTMENT OF PUBLIC WORKS**  
**CITY ENGINEERING DIVISION**

**COLEMAN A. YOUNG MUNICIPAL CENTER**  
**2 WOODWARD AVE. SUITE 601**  
**DETROIT, MICHIGAN 48226**  
**PHONE: (313) 224-3949 TTY: 711**  
**[WWW.DETROITMI.GOV](http://WWW.DETROITMI.GOV)**

---

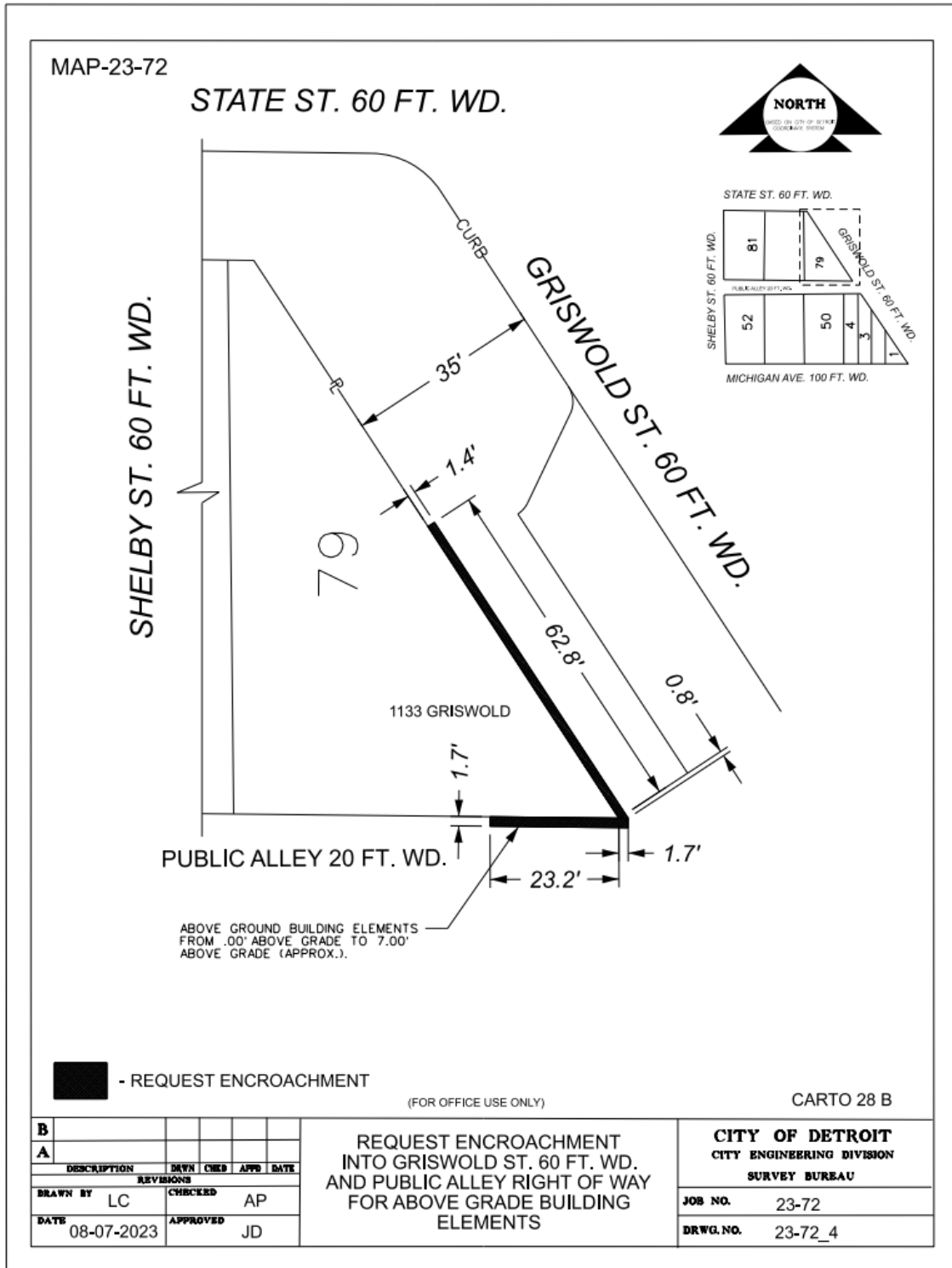



**CITY OF DETROIT**  
**DEPARTMENT OF PUBLIC WORKS**  
**CITY ENGINEERING DIVISION**

**COLEMAN A. YOUNG MUNICIPAL CENTER**  
**2 WOODWARD AVE. SUITE 601**  
**DETROIT, MICHIGAN 48226**  
**PHONE: (313) 224-3949 TTY: 711**  
**[WWW.DETROITMI.GOV](http://WWW.DETROITMI.GOV)**

---



CITY OF DETROIT  
 DEPARTMENT OF PUBLIC WORKS  
 CITY ENGINEERING DIVISION

COLEMAN A. YOUNG MUNICIPAL CENTER  
 2 WOODWARD AVE. SUITE 601  
 DETROIT, MICHIGAN 48226  
 PHONE: (313) 224-3949 TTY: 711  
 WWW.DETROITMI.GOV

MAP-23-72

STATE ST. 60 FT. WD.



SHELBY ST. 60 FT. WD.

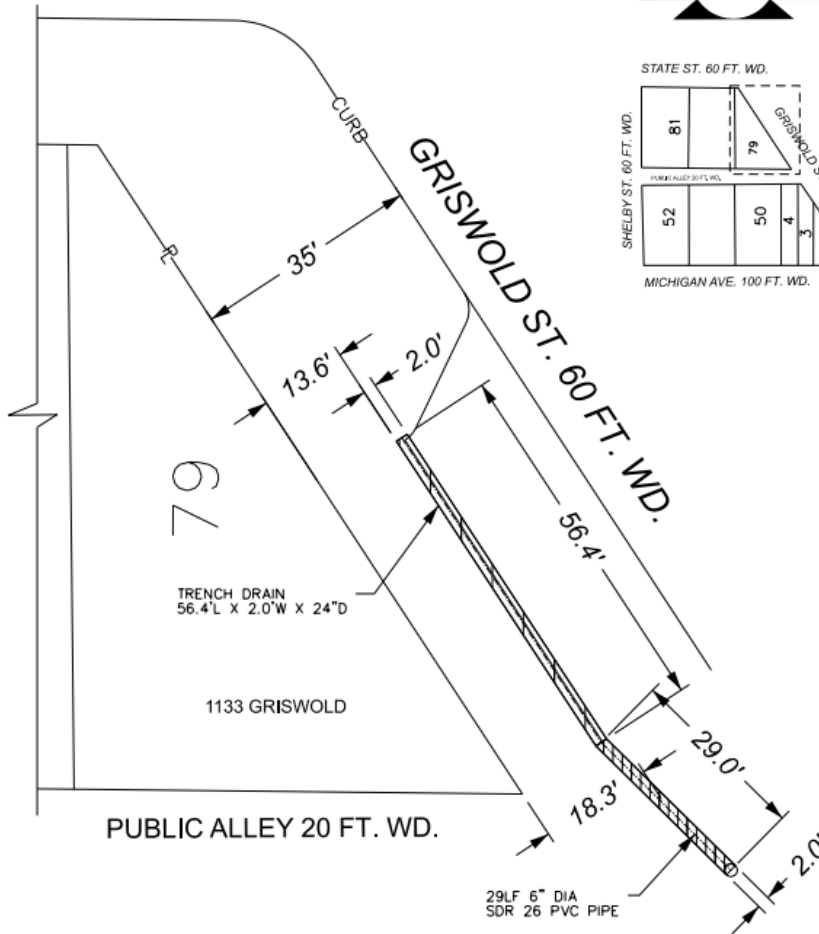

- REQUEST ENCROACHMENT  
 (AT GRADE TRENCH DRAIN 65.4'L X 2.0'W X 24"D)

- REQUEST ENCROACHMENT  
 (BELOW GRADE STORM PIPE 29.0'L X 2.0'W X 3.0'D)

(FOR OFFICE USE ONLY)

CARTO 28 B

<b>B</b>					
<b>A</b>					
	DESCRIPTION	DATE	CHKD	APPD	DATE
	REVISIONS				
	DRAWN BY	LC	CHECKED	AP	
	DATE	08-07-2023	APPROVED	JD	

REQUEST ENCROACHMENT  
 INTO GRISWOLD ST. 60 FT. WD.  
 FOR AT AND BELOW GRADE  
 STREET ELEMENTS

CITY OF DETROIT  
 CITY ENGINEERING DIVISION  
 SURVEY BUREAU

JOB NO. 23-72  
 DRWG. NO. 23-72\_5



**CITY OF DETROIT**  
**DEPARTMENT OF PUBLIC WORKS**  
**CITY ENGINEERING DIVISION**

**COLEMAN A. YOUNG MUNICIPAL CENTER**  
**2 WOODWARD AVE. SUITE 601**  
**DETROIT, MICHIGAN 48226**  
**PHONE: (313) 224-3949 TTY: 711**  
**[WWW.DETROITMI.GOV](http://WWW.DETROITMI.GOV)**

---