

Janice M. Winfrey
City Clerk

City of Detroit
OFFICE OF THE CITY CLERK

Andre P. Gilbert II
Deputy City Clerk

DEPARTMENT PETITION REFERENCE COMMUNICATION

To: The Department or Commission Listed Below

From: Janice M Winfrey, Detroit City Clerk

The following petition is herewith referred to you for report and recommendation to the City Council.

In accordance with that body's directive, kindly return the same with your report in duplicate within four (4) weeks.

Petition No.	2024-188
Name of Petitioner	Detroit Art, Culture, and Entrepreneurship
Description of Petition	Petition for encroachment into the east-west alley bounded by Hartwell Ave. and Snowden Ave. for the purpose of installing arts alley streetscape.
Type of Petition	Alley Vacation/Encroachment/Utility Vacation
Submission Date	06/18/2024
Concerned Departments	Media Services, Building & Safety Engineering, Police Department, Fire Department, Municipal Parking Department, Transportation Department, Health Department, General Services Department
Petitioner Contact	Zachary Hampton, P.E. OHM Advisors Project Engineer 1145 Griswold Street, Suite 200 Detroit, MI, 48226 (P): (313) 481-1253 Zachary.hampton@ohm-advisors.com



CITY OF DETROIT
DEPARTMENT OF PUBLIC WORKS
CITY ENGINEERING DIVISION

COLEMAN A. YOUNG MUNICIPAL CENTER
2 WOODWARD AVE. SUITE 601
DETROIT, MICHIGAN 48226
PHONE: (313) 224-3949 TTY: 711
WWW.DETROITMI.GOV

To: Clerk's Office
From: The Department of Public Works
City Engineering Division
MapsandRecordsBureau@DetroitMI.Gov
(313) 224-3970

Petitioner:
Detroit Art, Culture, and Entrepreneurship
2 Woodward Ave.
Detroit, MI, 48226

On behalf of the above-mentioned petitioner the Department of Public Works: City Engineering Division is submitting a petition request for the action below. The petitioner has received a project consultation from the Department of Public Works: City Engineering Division and has been advised the following:

Type of action recommended:

Petition for encroachment into the east-west alley bounded by Hartwell Ave. and Snowden Ave. for the purpose of installing arts alley streetscape.

Raven Wright
Supervisor of Maps and Records
Department of Public Works
City Engineering Division
313-224-3985



CITY OF DETROIT
DEPARTMENT OF PUBLIC WORKS
CITY ENGINEERING DIVISION

COLEMAN A. YOUNG MUNICIPAL CENTER
2 WOODWARD AVE. SUITE 601
DETROIT, MICHIGAN 48226
PHONE: (313) 224-3949 TTY: 711
WWW.DETROITMI.GOV



April 20, 2023

Coleman A. Young Municipal Center
City of Detroit Department of Public Works
City Engineering Division
2 Woodward Ave, Suite 601
Detroit, MI 48226

Re: Hartwell-Snowden Arts Alley: Encroachment Petition Cover Letter
MAP-23-45

On behalf of Detroit Art, Culture, and Entrepreneurship, OHM Advisors is writing this cover letter in response to the comments received by the City of Detroit's Department of Public Works in regard to the upcoming Arts Alleys project. The proposed Hartwell-Snowden Arts Alley streetscape is located within the alley south of Santa Maria, between Hartwell and Snowden Ave from the alley north of McNichols Rd to Santa Maria Ave.

Within the alley right of way (ROW), some of the existing trees will be removed or trimmed and a two-track concrete section will be constructed. Outside of the ROW, some fencing is planned for replacement and a public sidewalk will be constructed through the property at 17199 Snowden St from the alley to Street. This will function as an emergency exit for alley users. Other improvements include Arts Alley signage, waste bins, concrete planters and a 42" steel gate. We are also proposing improvements to the drainage system through storm catch basins and underdrain. The City of Detroit's office of Art, Culture, and Entrepreneurship (ACE) within the City of Detroit's General Services Department will be the owner of the above-referenced Encroachments. ACE will also be responsible for the maintenance and upkeep of these encroachments.

Please contact me with any questions at 313-481-1253 or via e-mail at Zachary.hampton@ohm-advisors.com.

Sincerely,
OHM Advisors

Zachary Hampton, P.E.
Project Engineer

cc: Jack Russo, Project Manager, Detroit ACE
Kareem Srour, Project Manager, Detroit ACE
File



**CITY OF DETROIT
DEPARTMENT OF PUBLIC WORKS
CITY ENGINEERING DIVISION**

**COLEMAN A. YOUNG MUNICIPAL CENTER
2 WOODWARD AVE. SUITE 601
DETROIT, MICHIGAN 48226
PHONE: (313) 224-3949 TTY: 711
WWW.DETROITMI.GOV**



CITY OF DETROIT
 DEPARTMENT OF PUBLIC WORKS
 CITY ENGINEERING DIVISION

COLEMAN A. YOUNG MUNICIPAL CENTER
 2 WOODWARD AVE. SUITE 601
 DETROIT, MICHIGAN 48226
 PHONE: (313) 224-3949 TTY: 711
 WWW.DETROITMI.GOV

MAP-23-45

SANTA MARIA AVE. 50 FT. WD.



HARTWELL AVE. 60 FT. WD.

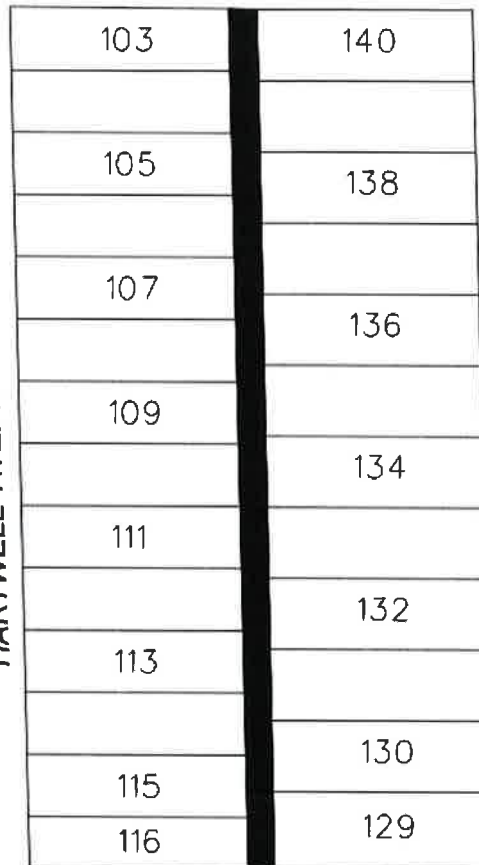

SNOWDEN AVE. 60 FT. WD.

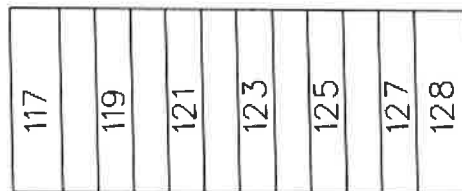

W MC NICHOLS RD. 86 FT. WD.

- REQUEST ENCROACHMENT AREA
 (FOR ARTS ALLEY STREETSCAPE)

(FOR OFFICE USE ONLY)

CARTO 86 F

B												
A												
	DESCRIPTION	DATE	BY	CHKD	APPD	DATE	REQUEST ENCROACHMENT INTO THE NORTH/SOUTH ALLEY 16 FT. WD. IN THE BLOCK BOUNDED BY SANTA MARIA AVE., HARTWELL AVE., MCNICHOLS RD., AND SNOWDEN AVE.					
	REVISIONS									CITY OF DETROIT CITY ENGINEERING DIVISION SURVEY BUREAU		
	DRAWN BY	LC	CHECKED	AP/TS						JOB NO. 23-45		
	DATE	06-11-2024	APPROVED	RW						DRWG. NO. 01		

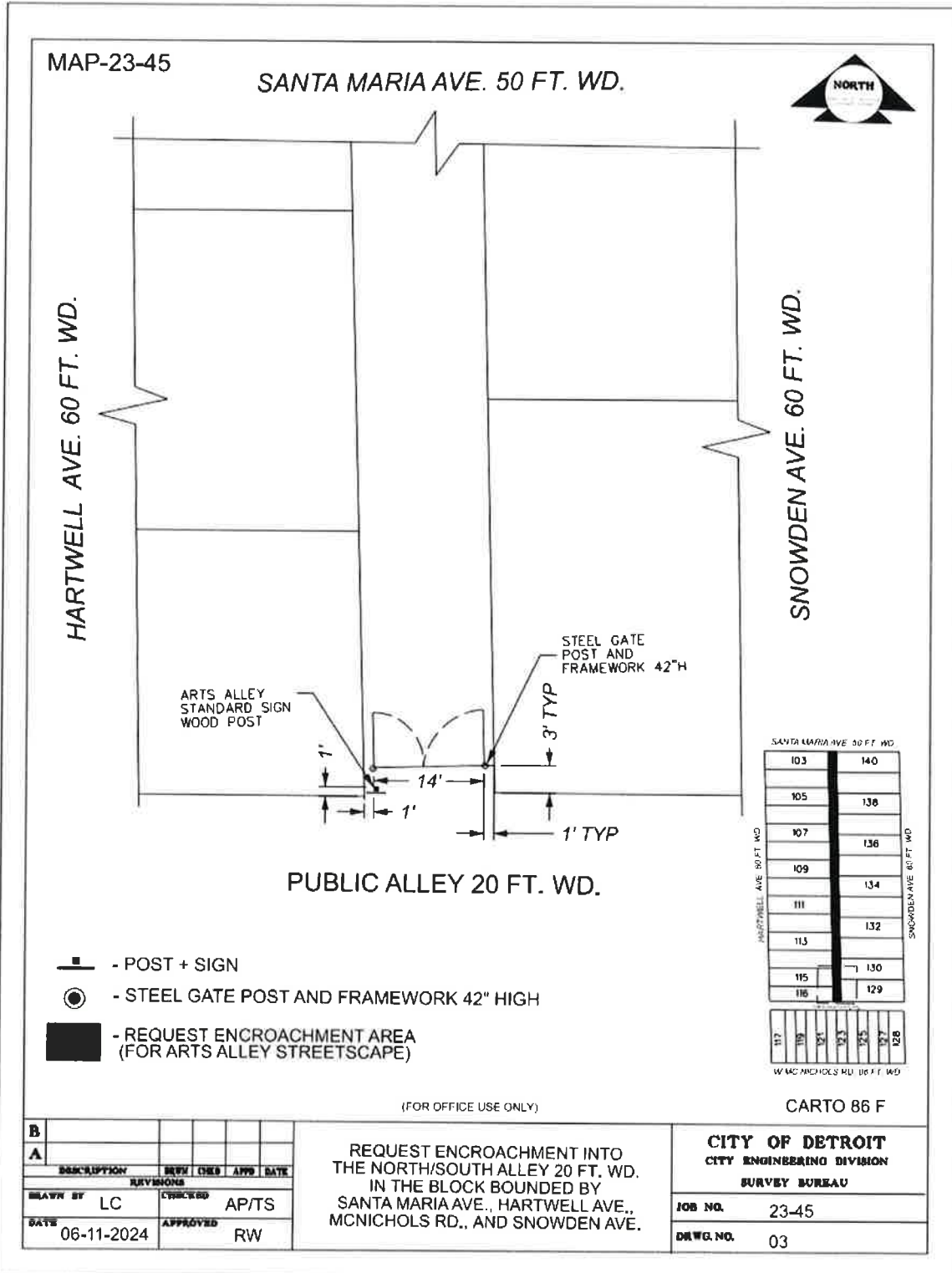



MAP-23-45

SANTA MARIA AVE. 50 FT. WD.

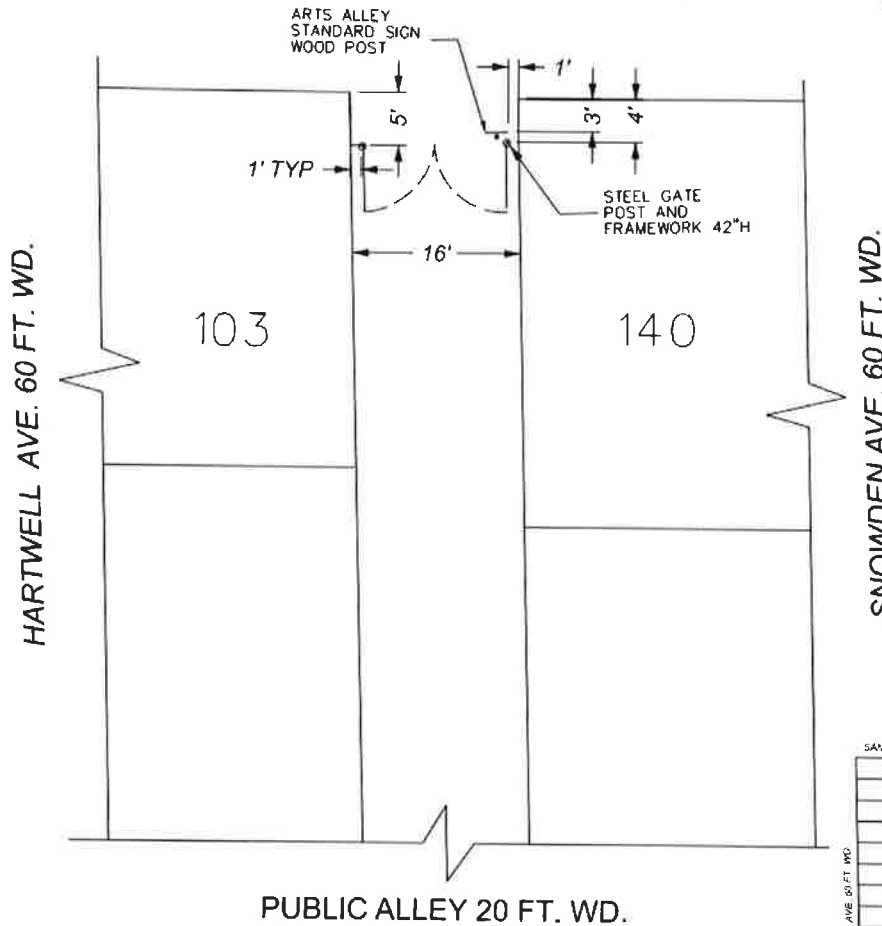

SANTA MARIA AVE. 50 FT. WD.	
103	140
105	138
107	136
109	134
111	132
113	130
115	129
117	
119	
121	
123	
125	
127	
128	

- - POST + SIGN
- - STEEL GATE POST AND FRAMEWORK 42" HIGH
- - REQUEST ENCROACHMENT AREA (FOR ARTS ALLEY STREETScape)

(FOR OFFICE USE ONLY)

CARTO 86 F

B											
A											
DESCRIPTION		REV	CHKD	APP	DATE	REQUEST ENCROACHMENT INTO THE NORTH/SOUTH ALLEY 20 FT. WD. IN THE BLOCK BOUNDED BY SANTA MARIA AVE., HARTWELL AVE., MCNICHOLS RD., AND SNOWDEN AVE.					
DRAWN BY		REVISIONS		CHECKED						AP/TS	
DATE		APPROVED		RW							
06-11-2024								CITY OF DETROIT CITY ENGINEERING DIVISION SURVEY BUREAU			
								JOB NO. 23-45 DRWG. NO. 02			

CITY OF DETROIT

ART ALLEYS - PHASE 1

HARTWELL-SNOWDEN
WAYNE COUNTY, MICHIGAN

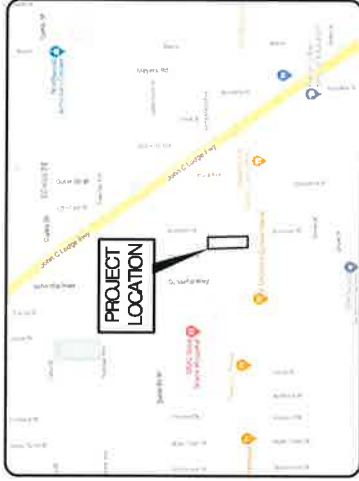
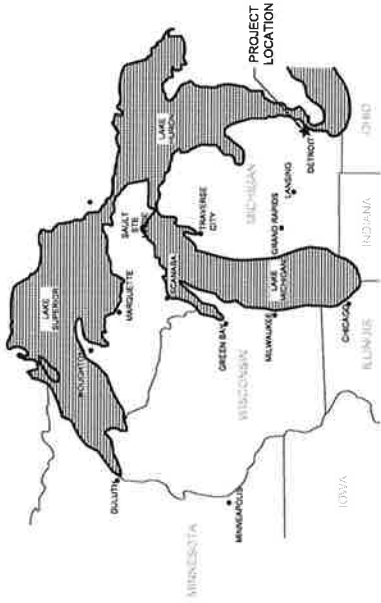

OWNER:
GENERAL SERVICES DEPARTMENT
CONTACT: ROCKELLE BLUM
115 ERSKINE STREET,
DETROIT, MI 48201
313-489-5265

ENGINEER:
OHM ADVISORS, INC.
115 ERSKINE STREET, RE
115 ERSKINE STREET, SUITE 200
DETROIT, MICHIGAN 48226
PATRICK.DROZD@OHM-ADVISORS.COM



UTILITY PROVIDERS

SANITARY/WATER AND SEWERAGE
DETROIT WATER AND SEWERAGE
735 RANDOLPH STREET
DETROIT, MI 48202
PHONE: 313-267-8000
EMAIL: KENDSHA.DAVIDSON@DETROITMI.GOV

ELECTRICITY
DETROIT EDISON
ONE ENERGY PLAZA, 519 SB
DETROIT, MI 48226
PHONE: 313-267-5632
EMAIL: DSGEN@MISSEDIG@TEENERGY.COM

TELEPHONE
54 N. MILL ST. 4TH FLOOR
PONTIAC, MI 48342
EMAIL: LD215@ATT.COM
CONTACT: HEATHER VALLE-KNOBLAUCH

CABLE
COMCAST
25625 TELEGRAPH
PONTIAC, MI 48304
PHONE: 248-809-2715
EMAIL: CRAIG_FUDAS@CABLE.COMCAST.COM
CONTACT: CRAIG FUDAS

SHEET INDEX	
SHEET	ISSUE
01	CONTRACT ADMINISTRATION
02	GENERAL NOTES
03	PROPOSED WORK
04	ART ALLEYS - PHASE 1
05	ART ALLEYS - PHASE 1
06	ART ALLEYS - PHASE 1
07	ART ALLEYS - PHASE 1
08	ART ALLEYS - PHASE 1
09	ART ALLEYS - PHASE 1
10	ART ALLEYS - PHASE 1
11	ART ALLEYS - PHASE 1
12	ART ALLEYS - PHASE 1
13	ART ALLEYS - PHASE 1
14	ART ALLEYS - PHASE 1
15	ART ALLEYS - PHASE 1
16	ART ALLEYS - PHASE 1
17	ART ALLEYS - PHASE 1
18	ART ALLEYS - PHASE 1
19	ART ALLEYS - PHASE 1
20	ART ALLEYS - PHASE 1
21	ART ALLEYS - PHASE 1
22	ART ALLEYS - PHASE 1
23	ART ALLEYS - PHASE 1
24	ART ALLEYS - PHASE 1
25	ART ALLEYS - PHASE 1
26	ART ALLEYS - PHASE 1
27	ART ALLEYS - PHASE 1
28	ART ALLEYS - PHASE 1
29	ART ALLEYS - PHASE 1
30	ART ALLEYS - PHASE 1
31	ART ALLEYS - PHASE 1
32	ART ALLEYS - PHASE 1
33	ART ALLEYS - PHASE 1
34	ART ALLEYS - PHASE 1
35	ART ALLEYS - PHASE 1
36	ART ALLEYS - PHASE 1
37	ART ALLEYS - PHASE 1
38	ART ALLEYS - PHASE 1
39	ART ALLEYS - PHASE 1
40	ART ALLEYS - PHASE 1
41	ART ALLEYS - PHASE 1
42	ART ALLEYS - PHASE 1
43	ART ALLEYS - PHASE 1
44	ART ALLEYS - PHASE 1
45	ART ALLEYS - PHASE 1
46	ART ALLEYS - PHASE 1
47	ART ALLEYS - PHASE 1
48	ART ALLEYS - PHASE 1
49	ART ALLEYS - PHASE 1
50	ART ALLEYS - PHASE 1

BID PLANS
OHM PROJECT NO. 7522-20-0010
DATE/ISSUE: 05/18/2023



Issued by the Civil Plans Staff
Under the Supervision of

WATER & SEWER UTILITY SYMBOLS

MISCELLANEOUS UTILITY SYMBOLS

MISCELLANEOUS SYMBOLS

UTILITY PATTERN

REMOVAL LEGEND

- EXISTING**
- STORM MANHOLE
 - SQUARE CATCH BASIN
 - ROUND CATCH BASIN
 - CONVERT
 - CHUNKET W/0 END SECTION
 - CHUNKET W/END SECTION
 - SAWTOOTH MANHOLE
 - CLEAN OUT
 - GATE VALVE & WELL
 - GATE VALVE & BOX
 - WATER STOP BOX
 - FIRE HYDRANT
 - METER PIT
 - METER
 - SPRINKLER HEAD
 - IRRIGATION VALVE
- PROPOSED**
- STORM MANHOLE
 - INLET/CATCH BASIN
 - CHUNKET END SECTION
 - SAWTOOTH MANHOLE
 - GATE VALVE & WELL
 - GATE VALVE & BOX
 - HOPPING SLEEVE VALVE & BOX
 - HOPPING SLEEVE VALVE & BOX
 - FIRE HYDRANT
 - WATER SERVICE CONNECTION
 - METER PIT
 - ELECTRIC CABINET
 - WATER HYDRANT
 - CLEAN OUT

- EXISTING**
- CLIP WIRE
 - CLIP POLE
 - UTILITY POLE
 - UTILITY POLE W/LIGHT
 - LIGHT/RECORD LAMP POLE
 - FLOOD LIGHT
 - GAS VALVE
 - GAS TAP
 - GAS METER
 - GAS RISER
 - TRANSIT SIGNAL
 - PEDESTRIAN RISER
 - TRANSFORMER PAD
 - PRIVATE UTILITY MANHOLE
 - RAILROAD CROSSING
 - ELECTRIC METER
 - PHONE BOOTH
 - TRANSIT SIGNAL CONTROLLER
 - HAND HOLE
 - ELECTRIC RISER
 - TELEPHONE RISER
 - CABLE TV RISER
 - MONITORING WELL
 - UNDERGROUND MARKER
- PROPOSED**
- AGGREGATE TRUNCING MAT
 - INLET FILTER (PAVEMENT)
 - UNITS OF RESISTANCE

- EXISTING**
- RFPAP
 - SON
 - FLOW DIRECTION
 - STUMP
 - WETLAND
 - CONIFEROUS TREE
 - DECIDUOUS TREE
 - CONIFEROUS SHRUB
 - DECIDUOUS SHRUB
 - SOIL BORING
 - SECTION CORNER
 - MONUMENT
 - IRON ROD/TIPE
 - PK VAL
 - BENCHMARK
 - TRIMMERS POINT
 - VAL/INDICATOR BOX
 - FLAG POLE
 - POST
- PROPOSED**
- MANHOLE OR IN-MANHOLE UTILITY
 - CAUTION - CRITICAL UNDERGROUND UTILITY
 - USED WITH UNDERGROUND GAS & ELECTRICAL LINES
 - USED WITH TELEPHONE & FIBER OPTIC LINES
 - PROPOSED CONCRETE PAVEMENT

- EXISTING**
- ELECTRICAL
 - CABLE/TELEPHONE
 - CABLE/TELEPHONE
 - FIBER OPTIC
 - WATER
 - SEWER
 - STORM
- PROPOSED**
- STORM/SEWER/WATER
 - PRIMARY UTILITY WILL HAVE A CONTINUOUS LINE STYLE WITH THE EXISTING UTILITY LINES AND RESPECTIVE EXISTING UTILITY LINE STYLE
- 10" = OVERHEAD, 1/8" = UNDERGROUND
- ROW PATTERN**
- ROW
 - SECTION
 - PROPERTY/PARCEL
 - ROW

- REMOVAL LEGEND**
- SEMI-FULL REMOVAL
 - HWK SURFACE REMOVAL
 - PAVEMENT REMOVAL
 - COLD MILLING HWK SURFACE
 - HWK BASE COURSE AND SHIPPING
 - EXCAVATION, LATH, MODIFIED
 - CURB AND CUTTER, REM
 - HEAVY BRUSH, REM
 - SAVAGE
 - BULKHEAD
 - ABANDON
 - REMOVE
 - ADJUST
 - RELOCATE
 - RECONSTRUCT
 - REMOVE BY OTHERS
 - ADJUST BY OTHERS
 - RELOCATE BY OTHERS

REAL ESTATE SYMBOLS

EROSION CONTROL PLAN

PROPOSED PAVEMENT TREATMENT LEGEND

TOPO PATTERN

IF NECESSARY FOR CLARITY

- REAL ESTATE SYMBOLS**
- CONTIGUOUS PROPERTY SYMBOL
 - PARCEL NUMBER BOX
 - NO ROW IMPACTS

- EROSION CONTROL PLAN**
- AGGREGATE TRUNCING MAT
 - INLET FILTER (PAVEMENT)
 - UNITS OF RESISTANCE

- PROPOSED PAVEMENT TREATMENT LEGEND**
- PROPOSED CONCRETE PAVEMENT
 - EXPOSED AGGREGATE
 - PAVEMENT REMOVAL
 - COLD MILLING HWK SURFACE
 - HWK BASE COURSE AND SHIPPING
 - EXCAVATION, LATH, MODIFIED

- TOPO PATTERN**
- EXISTING
 - PROPOSED
 - HEDGE/TREE
 - FENCE
 - SUBSIGNAL
 - CENTERLINE OF DITCH
 - RAILROAD
 - WETLAND/EDGE OF WATER
 - GROUND LIMIT (SLOPE STAKE)
 - CENTERLINE OF DITCH
 - CURBSIDE
 - FENCE

- IF NECESSARY FOR CLARITY**
- SAVAGE
 - BULKHEAD
 - ABANDON
 - CLEANING
 - REMOVE
 - RELOCATE
 - RECONSTRUCT
 - RELOCATE BY OTHERS
 - ADJUST BY OTHERS
- SPECIAL LEGEND**
- PROPOSED AGGREGATE PAVEMENT
 - PROPOSED ALTERNATING JAWN MAX #1
 - PROPOSED ALTERNATING JAWN MAX #2

LEGEND
CITY OF DETROIT
ART ALLEYS - PHASE 1

1" = 100'

1" = 200'

1" = 300'

1" = 400'

1" = 500'

1" = 600'

1" = 700'

1" = 800'

1" = 900'

1" = 1000'

GENERAL NOTES

UTILITIES

SEE SPECIFICATIONS AND UTILITY AGREEMENTS FOR THE PROTECTION OF EXISTING UTILITIES AND IN CONFORMANCE WITH PUBLIC ACT 174 OF 2003, THE CONTRACTOR SHALL CONTACT MISS DIG SYSTEM, INC. BY PHONE ADDRESS OR GTE MISSISSAUGA, A DIVISION OF GTE, AT THE ADDRESS LISTED IN THE GENERAL CONDITIONS, EXCLUDING WEEKENDS AND HOLIDAYS.

THE EXISTING UTILITIES SHOWN ON THESE PLANS REPRESENT THE BEST INFORMATION AVAILABLE AS OBTAINED ON OUR SURVEYS. THIS INFORMATION DOES NOT RELIEVE THE CONTRACTOR OF THE RESPONSIBILITY TO BE SATISFIED AS TO ITS ACCURACY AND THE LOCATION OF EXISTING UTILITIES.

BENCHMARK ELEVATIONS

BENCHMARK ELEVATIONS SHOWN ON THESE PLANS ARE BASED ON NAD 83.

PROPERTY CORNERS

ANY PROPERTY CORNERS WITHIN THE FRONT OR BACK SLOPE SHALL BE STAKED AND PROTECTED BY REDBOND. THE REPLACEMENT OF ANY PROPERTY CORNERS THAT ARE DAMAGED OR DESTROYED DURING CONSTRUCTION SHALL BE THE PROPERTY OWNER'S RESPONSIBILITY. THE CONTRACTOR SHALL ESTABLISH A BOUNDARY LINE WITH THE PROPERTY CORNERS WILL BE PERFORMED BY A MICHIGAN LICENSED PROFESSIONAL SURVEYOR AT THE CONTRACTOR'S EXPENSE.

UTILITY NOTES

- UNLESS SPECIFICALLY NOTED FOR REMOVAL ON THE CONSTRUCTION PLANS, ALL BENCHMARKS, DRIVEWAYS, DRIVEWAYS AND ABOVE GROUND UTILITIES DAMAGED OR DESTROYED DURING CONSTRUCTION SHALL BE REMOVED AND REPLACED, INCIDENTAL TO THE COST OF CONSTRUCTION, AT NO EXPENSE TO THE OWNER.
- EXISTING WATER MAINS, GAS MAINS AND UNDERGROUND TELEPHONE, ELECTRIC AND CABLE TELEVISION CONDUITS AND/OR LINES ARE SHOWN ONLY IN THE PLAN VIEW OF THE CONSTRUCTION DRAWINGS. THE EXACT DEPTH OF THESE UTILITIES IS UNKNOWN AND THEREFORE, NO ATTEMPT HAS BEEN MADE TO SHOW SUCH UTILITIES EXCEPT FOR PROTECTING THESE UTILITIES WHICH ARE NOT WITHIN THE SPACE OCCUPIED BY COMPLETE PIPES OR STRUCTURES THAT ARE A PART OF THIS CONTRACT. DURING CONSTRUCTION, IF DAMAGED OR DESTROYED, THE CONTRACTOR SHALL BE RESPONSIBLE FOR THE COSTS TO REPAIR OR REPLACE THEM AT NO ADDITIONAL EXPENSE TO THE OWNER.
- THE CONTRACTOR SHALL PROTECT EXISTING STORM, WATER MAIN, COMBINED SEWER, GAS, TELEPHONE, AND CABLE TELEVISION UTILITIES, AND ALL OTHER UTILITIES THAT ARE NOT TO BE DAMAGED OR DESTROYED DURING CONSTRUCTION. ANY UTILITY, WHICH IS TO REMAIN IN SERVICE, THAT IS DAMAGED OR DESTROYED DURING CONSTRUCTION SHALL BE REPLACED BY THE CONTRACTOR AT NO ADDITIONAL EXPENSE TO THE OWNER.
- PRIOR TO CONSTRUCTION, THE CONTRACTOR SHALL EXPOSE EXISTING UTILITIES AT POINTS OF POSSIBLE CONFLICT SO THAT THESE CONFLICTS CAN BE RESOLVED.
- CONTRACTOR TO COORDINATE ALL EXISTING GAS MAIN AND SERVICE LEAD CONFLICTS WITH OTE GAS AT LEAST 3 WORKING DAYS PRIOR TO RELLOCATION. PLEASE CONTACT BASIL DIASWATTI (248) 632-4638 TO SCHEDULE RELLOCATION.
- REPAIRS TO ANY UTILITIES THAT ARE DAMAGED OR DESTROYED DURING CONSTRUCTION SHALL BE BACKFILLED WITH CLEAN SAND, SANDER OUTLETS OF THE ROAD INFLUENCE MAY BE BACKFILLED WITH CLEAN JOB EXCAVATED MATERIAL.
- ALL STORM SEWER CONSTRUCTION FOR THIS PROJECT SHALL BE CLASS IN C76 REINFORCED CONCRETE UNLESS NOTED OTHERWISE ON THE PLANS.

TRASH SERVICES

DURING CONSTRUCTION, THE CONTRACTOR SHALL MAINTAIN ACCESS TO TRASH PICKUP AREAS WHENEVER POSSIBLE. IF THIS IS NOT POSSIBLE DUE TO ACTIVE CONSTRUCTION, IMPASSIBLE GRADE, CONCRETE CURB OR OTHER CONSTRUCTION, THE CONTRACTOR SHALL PROVIDE TRASH PICKUP SERVICE FOR AN ALTERNATIVE PICKUP LOCATION AT NO ADDITIONAL COST TO THE OWNER.

WORK ON PRIVATE PROPERTY

AS PART OF THIS PROJECT, WORK WILL BE REQUIRED ON PRIVATE OWNER PROPERTY. BEFORE ANY WORK IS COMMENCED ON PRIVATE PROPERTY, IT IS THE RESPONSIBILITY OF THE CONTRACTOR TO OBTAIN WRITTEN PERMISSION FROM THE PROPERTY OWNER. PROPERTY OWNER DIRECTLY UNLESS TOLD TO DO SO BY FACE. WHILE WORK IS UNDERWAY, THE CONTRACTOR SHALL ENSURE THAT ACCESS TO THE PROPERTY IS MAINTAINED. ONCE WORK IS COMPLETE, THE CONTRACTOR SHALL NOTIFY THE PROPERTY OWNER THAT WORK IS COMPLETE.

SAWCUTS

THE CONTRACTOR SHALL SAWCUT FULL DEPTH, THE EXISTING CONCRETE AND/OR PAVEMENT AND DRIVEWAYS TO THE LIMITS OF PROPOSED CONSTRUCTION TO MAKE A NEAT AND SMOOTH CONNECTION TO THE EXISTING PAVEMENT OR DRIVEWAY AS SHOWN ON THE PLANS. SAWCUTS SHALL BE REINFORCED WITH REBAR. SAWCUTS SHALL BE CONSIDERED AS HAVING BEEN INCLUDED IN THE CONTRACT UNIT PRICE BID FOR OTHER REMOVAL ITEMS.

OPEN EXCAVATIONS

THE PLACEMENT OF PROTECTIVE FENCING AROUND ALL OPEN EXCAVATIONS IS REQUIRED. THIS WILL NOT BE PAID FOR SEPARATELY, BUT WILL BE CONSIDERED AS HAVING BEEN INCLUDED IN THE CONTRACT UNIT PRICE BID FOR MOBILIZATION.

REMOVING PAVEMENTS

THE CONTRACTOR SHALL CONDUCT PAVEMENT REMOVAL OPERATIONS SO THAT THE STREETS AND DRIVEWAYS ARE REMOVED IMMEDIATELY AHEAD OF THE GRADING OPERATIONS. TRAFFIC IN A TIMELY FASHION. THE PAVEMENT FOR REMOVING PAVEMENT SHALL FOLLOW THE PRICE AND PAYMENT SCHEDULE. THE CONTRACTOR SHALL BE RESPONSIBLE FOR THE REMOVAL AND REPAIR OF PAVEMENT REMOVAL ARE ESTIMATED AND THE EXACT MEASUREMENT AND PAYMENT WILL BE VERIFIED DURING CONSTRUCTION. REFER TO THE PAVEMENT CORES LOCATED IN THE ORIGINAL PLANS.

PAVEMENT MARKINGS

PAVEMENT MARKINGS SHALL BE WITHNESSED AND REPAIRED AS AND WHEN IMPACTED BY CONSTRUCTION. TEMPORARY MARKINGS SHALL BE PLACED BY THE CONTRACTOR AND REPLACED WITH PERMANENT MARKINGS AT NO ADDITIONAL EXPENSE TO THE OWNER.

PIPE MATERIAL

UNLESS OTHERWISE NOTED, ALL STORM SEWER SHALL BE CLASS IN C76 REINFORCED CONCRETE.

MISCELLANEOUS

AUDITORIAL SURVEY: AN AUDITORIAL SURVEY OF THE PROJECT CONDITIONS IS REQUIRED PRIOR TO CONSTRUCTION. THE CONTRACTOR SHALL BE RESPONSIBLE FOR THE COST OF THE SURVEY. VISUAL INSPECTIONS SHALL BE PROVIDED BY THE CONTRACTOR AT THE PRE-CONSTRUCTION MEETING.

PROPERTY OWNERS: PROPERTY OWNERS SHOWN ON THE PLANS ARE FOR INFORMATION ONLY AND THEIR ACCURACY IS NOT GUARANTEED.

ADJUSTING MONUMENT BOXES: ALL GOVERNMENT CORNERS ON THIS PROJECT SHALL BE PRESERVED, WHETHER SHOWN OR NOT. IT MAY BE NECESSARY TO PLACE OR ADJUST MONUMENT BOXES, AS REQUIRED.

SOIL BORINGS: THE SOIL BORING ON THE CONSTRUCTION SHEETS REPRESENT POINT INFORMATION FOR THE CONTRACTOR'S REFERENCE ONLY. THE CONTRACTOR SHALL VERIFY THAT THE CONDITIONS ARE THE SAME AT LOCATIONS OTHER THAN THE EXACT LOCATION OF THE BORING.

CONSTRUCTION: ALL CONSTRUCTION SHALL CONFORM TO THE CURRENT STANDARDS AND SPECIFICATIONS OF THE CITY OF DETROIT.

UNDERGROUND CONFLICTS: THE CONTRACTOR SHALL EXPOSE EXISTING UTILITY SERVICES, SANITARY SEWERS, WATER MAIN AND PRIVATE UTILITIES TO VERIFY EXISTING ELEVATIONS BEFORE COMMENCING WORK ON A PROPOSED STORM SEWER OR WATER MAIN THAT IS TO CROSS OTHER UTILITIES. THE CONTRACTOR SHALL PROVIDE EXPANDED UTILITY EDUCATION UNLESS OTHERWISE NOTED BY THE ENGINEER.

STREET SIGNS: THE CONTRACTOR SHALL SALVAGE AND RESET SIGNS WITHIN THE WORK ZONE. ALL SIGNS NOT REUSED IN THE PROJECT SHALL BE REMOVED AND DISPOSED OF BY THE CONTRACTOR.

UTILITY CROSSINGS AT DRIVEWAYS: ALL UTILITY CROSSINGS AT DRIVEWAYS SHALL BE BACKFILLED IMMEDIATELY FOLLOWING PIPE INSTALLATION TO MAKE THESE DRIVEWAYS ACCESSIBLE.

INCIDENTAL ITEMS: ANY ITEMS OF WORK INDICATED AS INCIDENTAL OR INCLUDED SHALL BE CONSIDERED AS PART OF THE PROJECT WORK AND SHALL BE COMPLETED AT NO ADDITIONAL EXPENSE TO THE CONTRACTOR. THE CONTRACTOR SHALL BE RESPONSIBLE FOR THE PROVISION OF ALL EQUIPMENT THAT MAY NOT BE SPECIFICALLY LISTED IN THE BIDDING FORM OR THE DRAWINGS OR SPECIFICATIONS, BUT WHICH ARE NECESSARY TO COMPLETE THE WORK.

SOILS AND EARTHWORK

- SOIL INVESTIGATIONS HAVE NOT BEEN PERFORMED FOR THIS PROJECT. PRELIMINARY LOAD-BEARING VALUES TO BE IN ACCORDANCE WITH MICHIGAN BUILDING CODE TABLE 1906.3. UNLESS NOTED OTHERWISE, FOUNDATION DESIGN SHALL BE BASED ON A SOIL BEARING CAPACITY OF 3,000 PSF.
- SPECIAL DESIGN AND CONSTRUCTION PROVISIONS FOR THIS PROJECT'S FOUNDATIONS
- INCLUDE IN THE WORK PROVIDING ALL EQUIPMENT, MATERIALS, AND QUALIFIED LABOR NECESSARY FOR EXCAVATION, SHORING, Dewatering SYSTEMS, BACKFILL, AND COMPACTION OF SOILS AS REQUIRED TO CONSTRUCT STRUCTURES TO THE LINE AND GRADE AS SHOWN ON THE PLANS.
- TELEPHONE 1-800-442-7171 NOT LOCATED UTILITIES. THE CONTRACTOR SHALL TO EXCAVATING IN THE VICINITY OF UTILITY LINES. ALL WELLS NOT PARTICIPATING MEMBERS WILL THIS BE ROUTINELY NOTIFIED. THIS DOES NOT RELIEVE THE CONTRACTOR OF THE RESPONSIBILITY OF NOTIFYING OWNERS WHO MAY NOT BE NOTIFIED BY ROUTING TO THE CITY OF DETROIT.
- EXCAVATE TO ELEVATIONS AND DIMENSIONS SHOWN ON THE PLANS WITHIN A TOLERANCE OF 10.10 FEET EXCAVATE BY HAND TO FINAL GRADE FOR FOOTINGS ENCLOSED AT SUB-ELEVATION. UNDESIRABLE BEARING MATERIALS ARE TO BE REMOVED AND REPLACED WITH GRANULAR MATERIALS AS DIRECTED BY ENGINEER.
- UNSATISFACTORY SOIL MATERIALS ARE DEFINED AS GRANULAR MATERIALS CLASSIFIED AS GW, GP, GM, SW, SP, SW-SM, SP-SM, OR SM BY THE UNIFIED SOIL CLASSIFICATION SYSTEM. UNDESIRABLE BEARING MATERIALS ARE DEFINED AS MATERIALS HAVING NO MORE THAN 10% FINER THAN THE MAXIMUM PERMISSIBLE SIZE.
- SO, ML, MH, CL, CH, OL, AND PT BY THE UNIFIED SOIL CLASSIFICATION SYSTEM. UNDESIRABLE BEARING MATERIALS ARE DEFINED AS MATERIALS HAVING MORE THAN 10% FINER THAN THE MAXIMUM PERMISSIBLE SIZE.
- UNDESIRABLE BEARING MATERIALS ARE DEFINED AS MATERIALS HAVING MORE THAN 10% FINER THAN THE MAXIMUM PERMISSIBLE SIZE.
- UNDESIRABLE BEARING MATERIALS ARE DEFINED AS MATERIALS HAVING MORE THAN 10% FINER THAN THE MAXIMUM PERMISSIBLE SIZE.
- UNDESIRABLE BEARING MATERIALS ARE DEFINED AS MATERIALS HAVING MORE THAN 10% FINER THAN THE MAXIMUM PERMISSIBLE SIZE.
- UNDESIRABLE BEARING MATERIALS ARE DEFINED AS MATERIALS HAVING MORE THAN 10% FINER THAN THE MAXIMUM PERMISSIBLE SIZE.
- UNDESIRABLE BEARING MATERIALS ARE DEFINED AS MATERIALS HAVING MORE THAN 10% FINER THAN THE MAXIMUM PERMISSIBLE SIZE.
- UNDESIRABLE BEARING MATERIALS ARE DEFINED AS MATERIALS HAVING MORE THAN 10% FINER THAN THE MAXIMUM PERMISSIBLE SIZE.
- UNDESIRABLE BEARING MATERIALS ARE DEFINED AS MATERIALS HAVING MORE THAN 10% FINER THAN THE MAXIMUM PERMISSIBLE SIZE.
- UNDESIRABLE BEARING MATERIALS ARE DEFINED AS MATERIALS HAVING MORE THAN 10% FINER THAN THE MAXIMUM PERMISSIBLE SIZE.

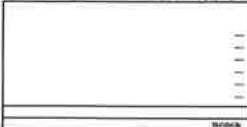

HARTWELL-SNOWDEN ARTS ALLEY

(IS FROM)

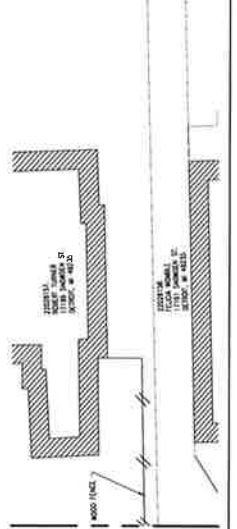
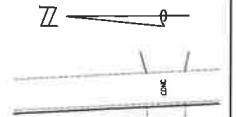
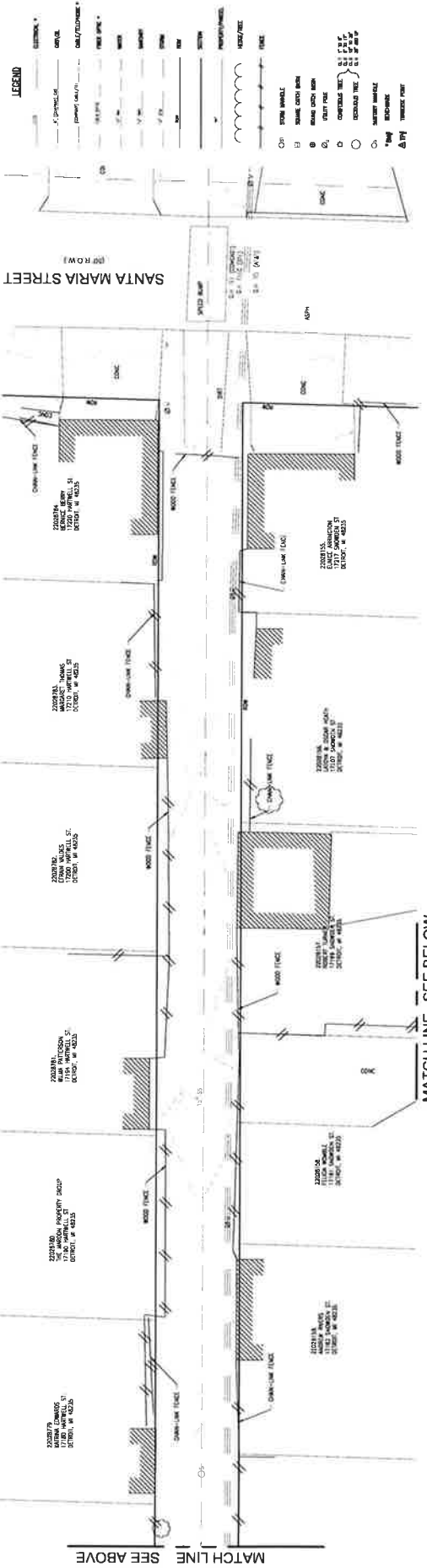
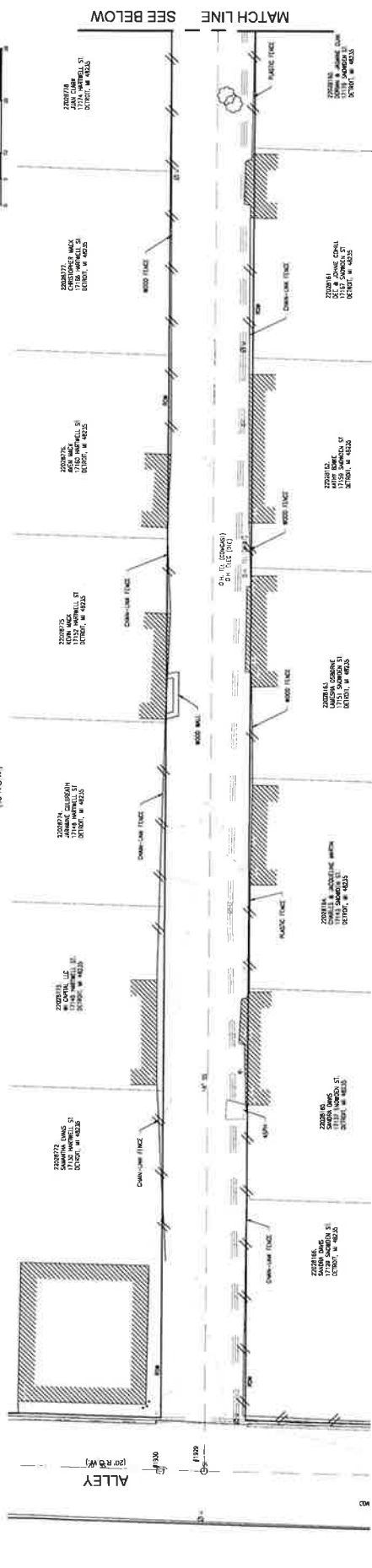
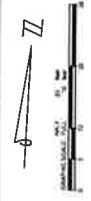

NO.	DATE	DESCRIPTION
1	10/25/16	ISSUED FOR PERMITS
2	11/01/16	ISSUED FOR PERMITS
3	11/01/16	ISSUED FOR PERMITS
4	11/01/16	ISSUED FOR PERMITS
5	11/01/16	ISSUED FOR PERMITS
6	11/01/16	ISSUED FOR PERMITS
7	11/01/16	ISSUED FOR PERMITS
8	11/01/16	ISSUED FOR PERMITS
9	11/01/16	ISSUED FOR PERMITS
10	11/01/16	ISSUED FOR PERMITS

EXISTING CONDITIONS / TOPOGRAPHIC SURVEY
 ART ALLEYS - PHASE 1
 CITY OF DETROIT

C4

811
 Know what's below
 Call before you dig.

MATCH LINE SEE ABOVE

MATCH LINE SEE BELOW

ALLEY (part R.O.W.)

SANTA MARIA STREET (part R.O.W.)

MATCH LINE SEE BELOW

MATCH LINE SEE ABOVE

HARTWELL-SNOWDEN ARTS ALLEY

SNOWDEN STREET
(89' R.O.W.)

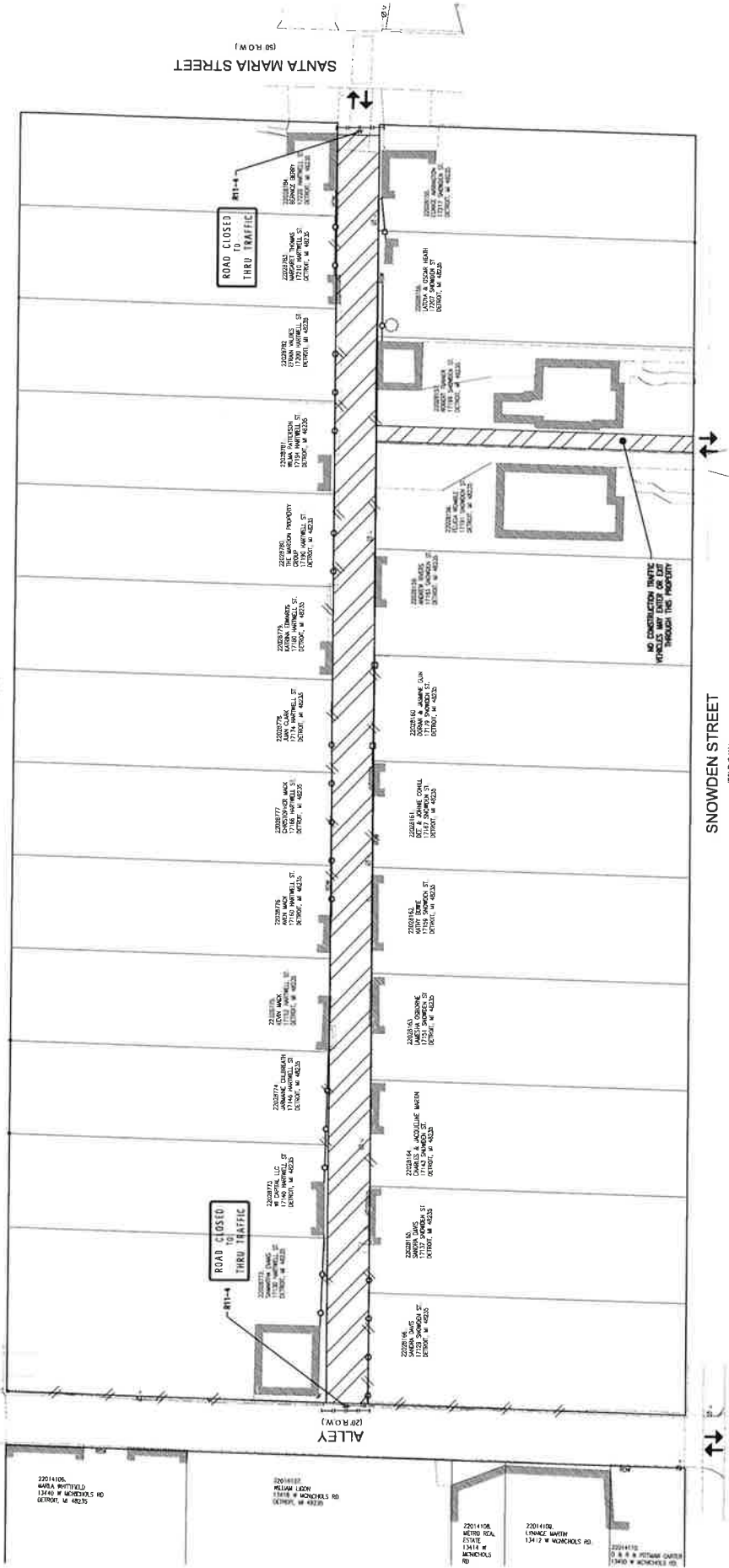

STAGING AND PROGRESS OF THE WORK

THE CONTRACTOR SHALL BE RESPONSIBLE FOR ERECTING AND MAINTAINING ALL STAGING AND PROGRESS OF THE WORK. THE CONTRACTOR SHALL BE PERMITTED TO USE THE LATEST VERSION OF THE MICHIGAN MANUAL FOR TRAFFIC CONTROL DEVICES. THE CONTRACTOR SHALL BE RESPONSIBLE TO CONSIDER ALL TRAFFIC CONTROL DEVICES ARE IN PLACE AND IN WORKING ORDER.

IF WORK IS REQUIRED WITHIN THE ROAD ROW, CLOSURES PER ADOPTED MICHIGAN TRAFFIC TYPICAL NO. 410 (A-M-T-R-A-F-W-S) SHALL BE IMPLEMENTED. ALL STAGING AREAS SHALL BE FULLY SIDEWALK CLOSURES & DETOURS SHALL BE IMPLEMENTED.

STAGING AREAS

AS PART OF THIS PROJECT, STAGING AREAS MAY BE USED TO STORE AND USE FOR THE STORAGE OF AGGREGATES, EXCAVATED MATERIALS, PIPE, EQUIPMENT. ALL STAGING AREAS SHALL BE PERMITTED BY THE USE OF OTHER PROPERTY WITHIN OR AROUND THE PROJECT AREA WILL REQUIRE WRITTEN APPROVAL FROM THE PROPERTY OWNER.

TRAFFIC CONTROL

THE CONTRACTOR SHALL BE RESPONSIBLE FOR ERECTING AND MAINTAINING ALL TRAFFIC CONTROL DEVICES. THE CONTRACTOR SHALL BE PERMITTED TO USE THE LATEST VERSION OF THE MICHIGAN MANUAL FOR TRAFFIC CONTROL DEVICES. THE CONTRACTOR SHALL BE RESPONSIBLE TO CONSIDER ALL TRAFFIC CONTROL DEVICES ARE IN PLACE AND IN WORKING ORDER.

LEGEND

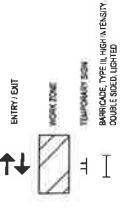

LEGEND

ENTRY/EXIT
WORK ZONE
TEMPORARY SIGN
DOUBLE SIDE LIGHT



Know what's below.
Call before you dig.

NOTE: STAGING AND CONSTRUCTION SIGNAGE TO BE PRESENT DURING CONSTRUCTION ONLY.

OHM
ARCHITECTS ENGINEERS PLANNERS
1140 Grand Blvd 200
Detroit, MI 48226
P 313.487.1150
OHM-DESIGN.COM

Detroit
The City Culture City

livingLAB
Detroit



CITY OF DETROIT
ART ALLEYS - PHASE 1
ACCESS AND STAGING PLAN

HARTWELL-SNOWDEN ARTS ALLEY

(SEE PLAN)

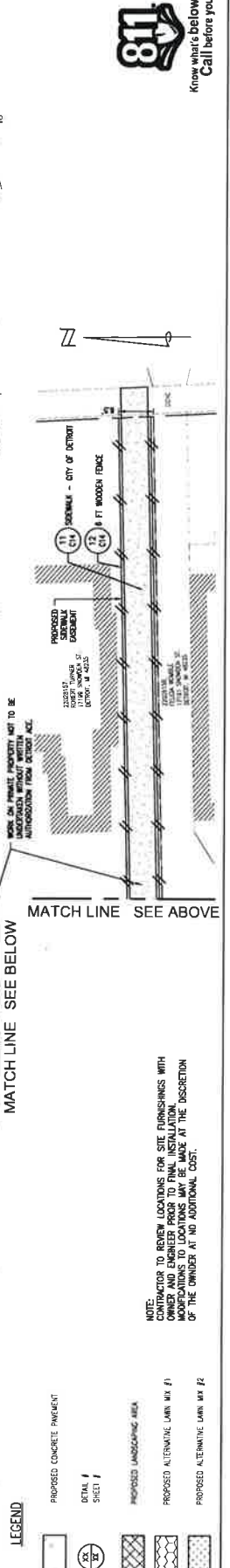
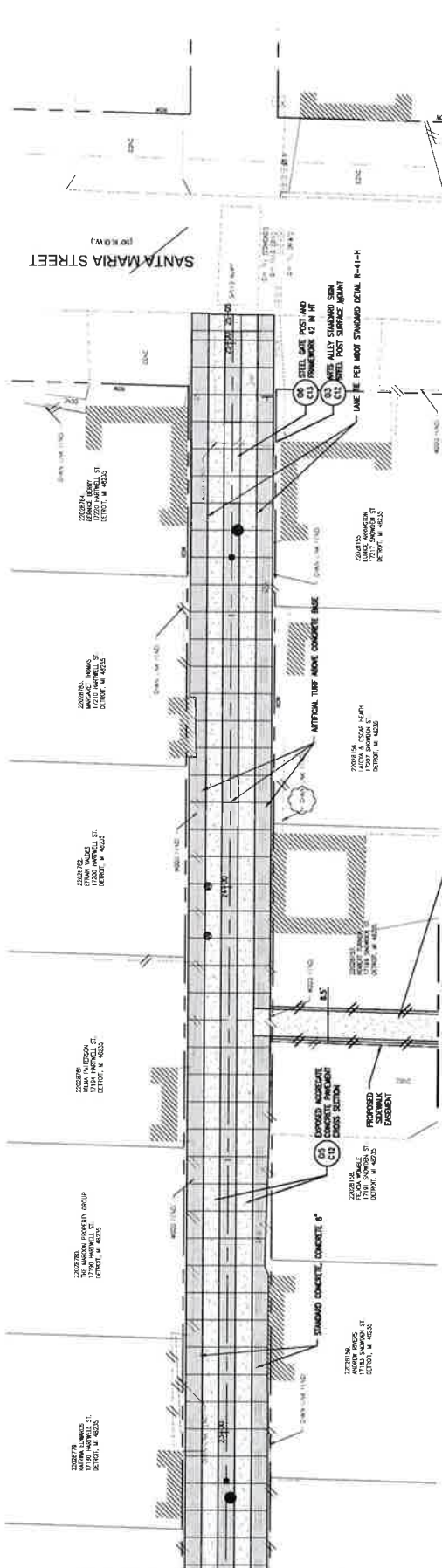
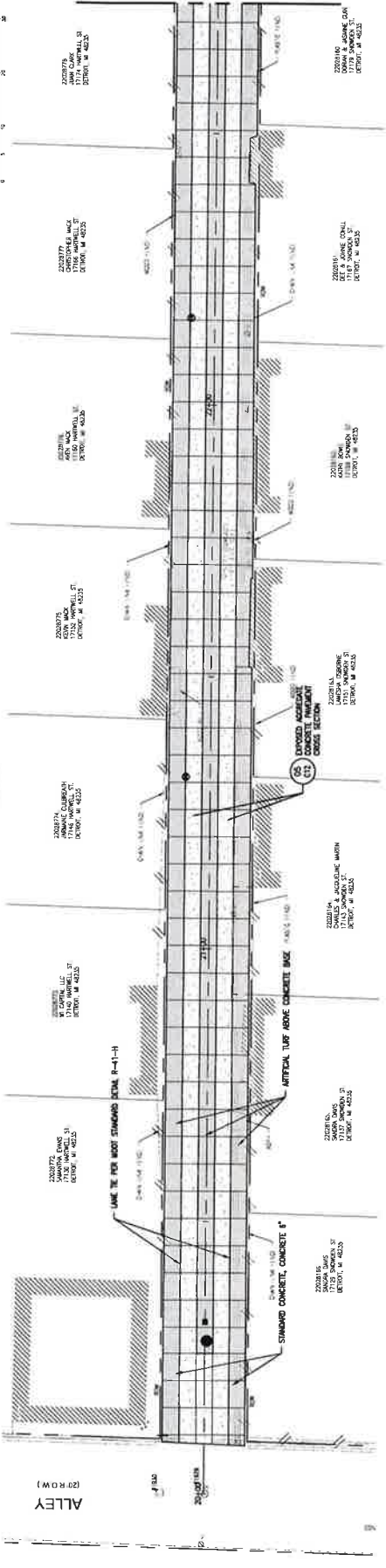

- LEGEND**
- PROPOSED CONCRETE FINISHMENT
 - DETAIL / SHEET
 - PROPOSED LANDSCAPING AREA
 - PROPOSED ALTERNATIVE LANE W/ 8"
 - PROPOSED ALTERNATIVE LANE W/ 8"

NOTE: CONTRACTOR TO REVIEW LOCATIONS FOR SITE FURNISHINGS WITH OWNER AND ENGINEER PRIOR TO FINAL INSTALLATION. MODIFICATIONS TO LOCATIONS MAY BE MADE AT THE DISCRETION OF THE OWNER AT NO ADDITIONAL COST.

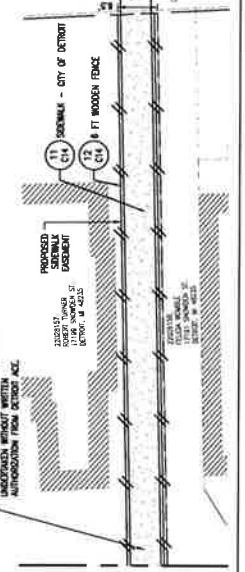

OHM
ARCHITECT-DRAWER NUMBER
1145 Grand St, 200
Detroit, MI 48226
313.221.1125
OHMARCHITECTS.COM

Detroit
Michigan's Official City Logo

livingLAB
Architecture + Urban Planning

CITY OF DETROIT
DEPARTMENT OF PUBLIC WORKS

CITY OF DETROIT
DEPARTMENT OF PUBLIC WORKS

CITY OF DETROIT
ART ALLEYS - PHASE 1
SITE LAYOUT PLAN



Know what's below.
Call before you dig.



CITY OF DETROIT
ART ALLEYS - PHASE 1
GRADING PLAN

C9

HARTWELL-SNOWDEN ARTS ALLEY
(SEE ROW)

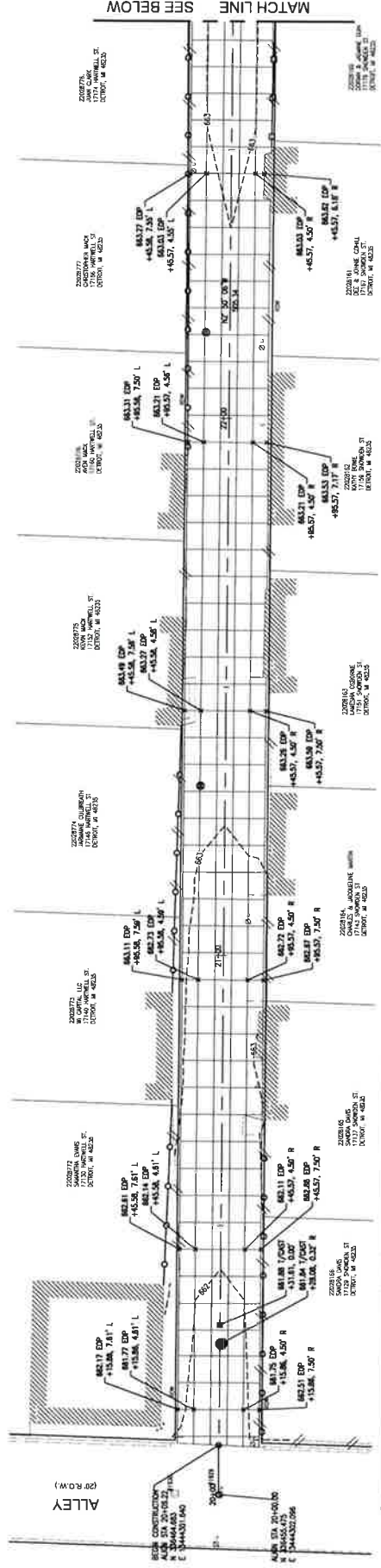
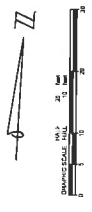

SEE BELOW
MATCH LINE

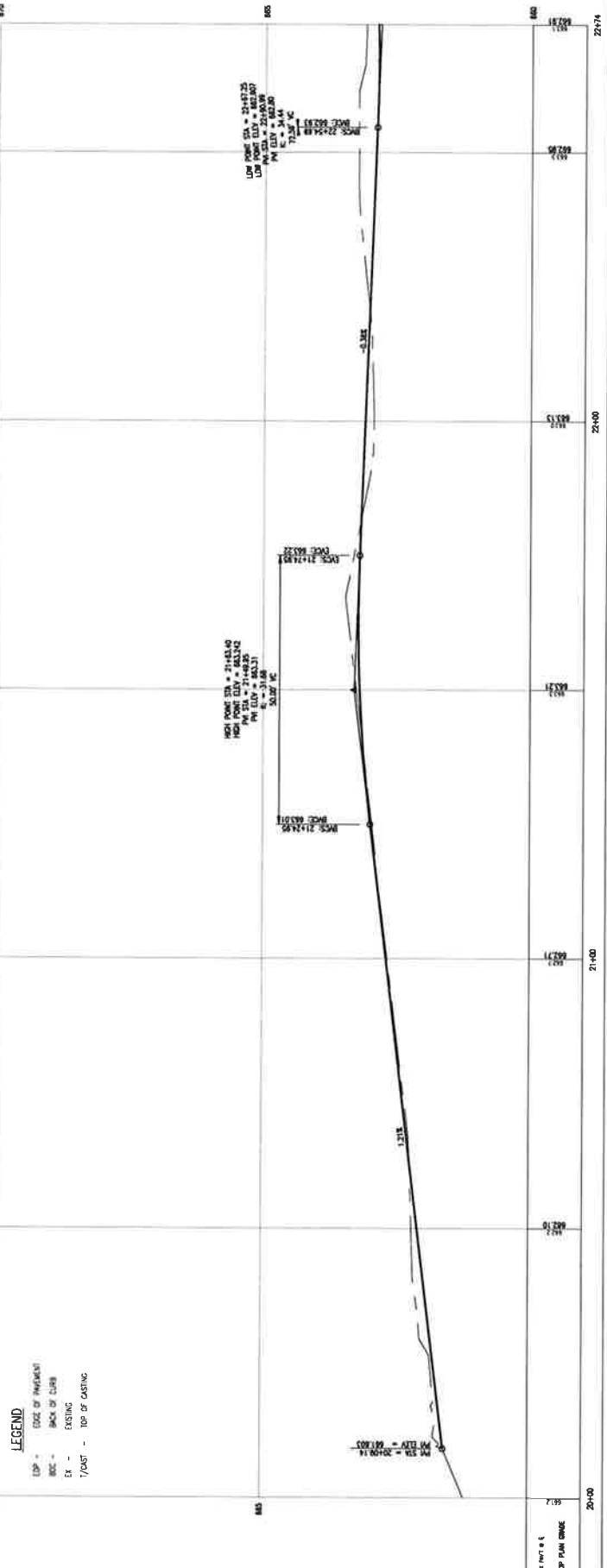

- LEGEND**
- EXP = EDGE OF PAVEMENT
 - BC = BACK OF CURB
 - EX = EXISTING
 - 7/0&T = TOP OF CASTING

15' X 11' SHEET
PREP PLAN SHEET

20+00 21+00 22+50

HARTWELL-SNOWDEN ARTS ALLEY (E.P.A.W.)



CITY OF DETROIT
ART ALLEYS - PHASE 1
GRADING PLAN

C10

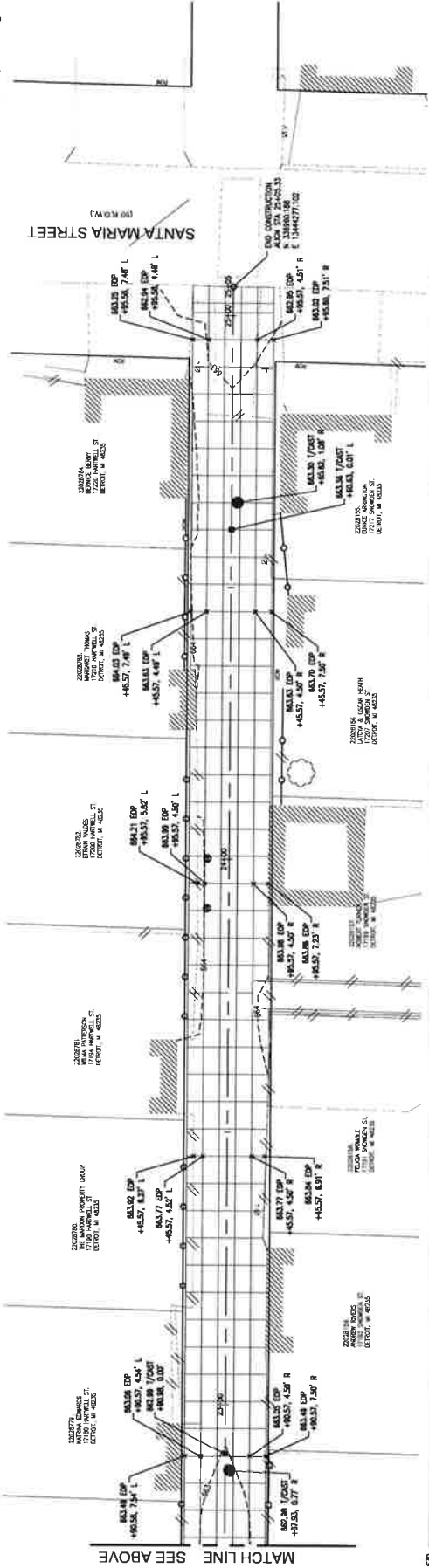

- LEGEND**
- EDP = EDGE OF PAVEMENT
 - B/C = BACK OF CURB
 - EA = EXISTING
 - 7/08T = TOP OF CASING

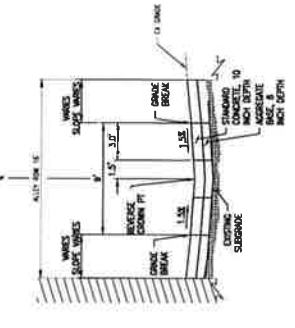

PROPOSED TYPICAL CROSS SECTION - SCHULZE

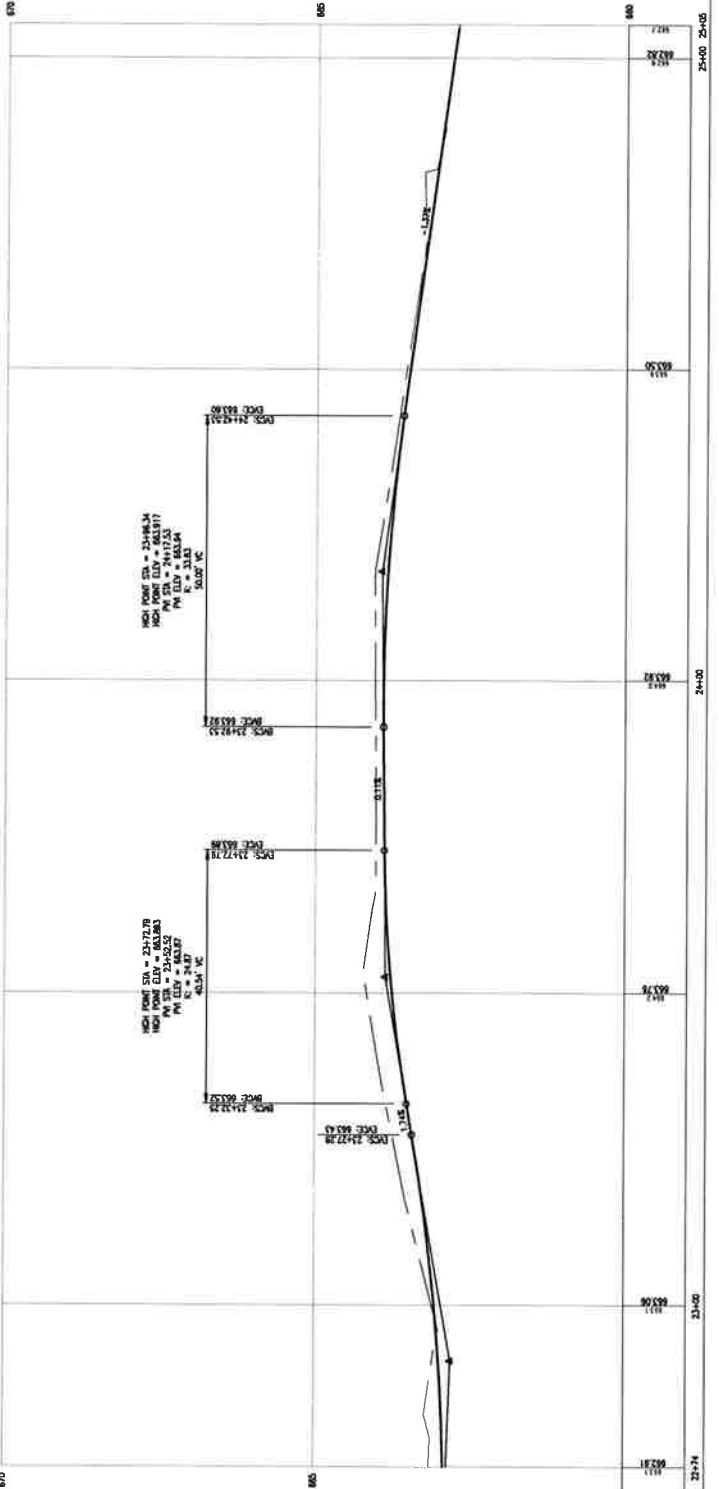

23+74 23+80 23+90 24+00 24+10 24+20 25+00 25+10



PRODUCT MODEL CHART

PRODUCT NO.	LENGTH	WIDTH	HEIGHT	WEIGHT
PLANTER A	36"	18"	24"	150 LB
PLANTER B	36"	18"	24"	150 LB
PLANTER C	36"	18"	24"	150 LB

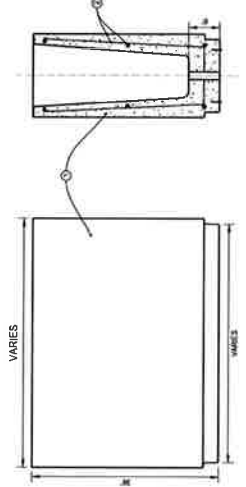
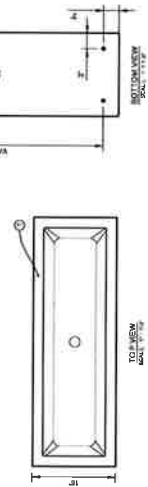

PRODUCT INFORMATION:
 MANUFACTURER: WILGAIL TILE SITE FURNISHES
 MODEL: CONCRETE PLANTER 57 RECTANGULAR
 COLOR: (SEE MODEL CHART FOR DETAILS)
 FINISH: (SEE MODEL CHART FOR DETAILS)
 INSTALLATION SURFACE: MOJAVI
 WEIGHT: (SEE MODEL CHART FOR SPECIFIC WEIGHT)
 WWW.WILGAILTILE.COM

- ① REINFORCER BEHIND WASH AT CONCRETE PLANTER AND WASH FINISH
- ② STEEL REINFORCEMENT
- ③ 7/8" TREADED INSERT (6) INCLUDED
- ④ 2" DRAIN HOLE

NOTES:
 1. PRODUCT IS SHIPPED FULLY ASSEMBLED. WEIGHT AND DIMENSIONS SHALL BE VERIFIED BY THE CONTRACTOR. PLANTER SHALL BE SURFACE MOUNTED.
 2. CONSTRUCTION PLANS FOR SPECIFIC FINISH, COLOR AND QUANTITIES SHALL BE PROVIDED BY THE CONTRACTOR TO MANUFACTURER.
 3. PRODUCT DATA SHEET, DETAILS AND DIMENSIONS SHALL BE PROVIDED TO THE CONTRACTOR FOR REVIEW AND APPROVAL PRIOR TO FABRICATION.

RECTANGULAR CONCRETE PLANTER
 NOT TO SCALE

- NOTES:**
1. STEEL BASE-PLATE SHALL BE 3/4" THICK (600 GAUGE), 11" X 11" SQUARE.
 2. STEEL SQUARE TUBE SHALL BE WELDED TO STEEL BASE PLATE AND FINISHED WITH POWDERCOAT FINISH PER SPECIFICATIONS. FINISH COLOUR TO BE SPECIFIED BY OWNER. CONTRACTOR SHALL SUBMIT SHOP DRAWINGS FOR REVIEW AND APPROVAL PRIOR TO FABRICATION.

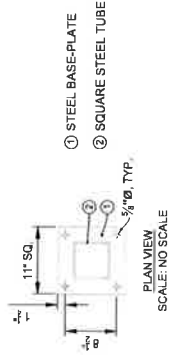

STEEL SURFACE MOUNT BOULARD BASE
 NOT TO SCALE

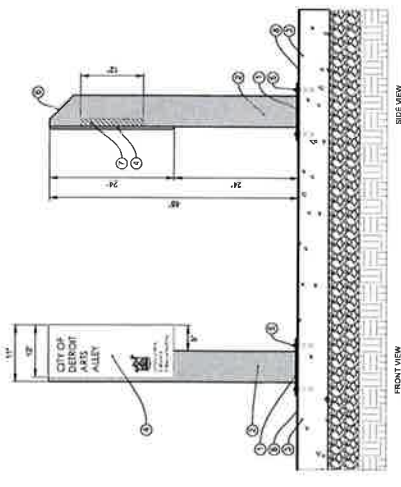

- NOTES:**
1. FINISH GRADE
 2. STEEL BASE-PLATE AND TUBING SHALL BE 3/4" THICK (600 GAUGE) MATCHING THE SAME SHAPE AND GAUGE AT THE POINT OF CONNECTION. WELDED SEAM SHALL BE GROUNDED TO A SMOOTH FINISH.
 3. BASE PLATE WELDED SEAM SHALL BE GROUNDED TO A SMOOTH FINISH.
 4. CONTRACTOR SHALL PREPARE AND SUBMIT SHOP DRAWINGS AND POST FABRICATION SHOP DRAWINGS FOR REVIEW AND APPROVAL PRIOR TO FABRICATION. CONTRACTOR TO VERIFY ORIENTATION OF SIGN FACE WITH OWNER'S REPRESENTATIVE PRIOR TO PLACEMENT.
 5. 1 1/2" SQ. BLACKENED STEEL BASE-PLATE 1/4" THICKENERS.
 6. 1 1/2" DIA. BLACKENED STEEL SQUARE TUBING 1/4" WALL THICKENERS.
 7. CONCRETE PAVEMENT (THICKNESS VARIES).
 8. CITY OF DETROIT STANDARD SURFACE SIGN MOUNT TO STEEL POST W/ANGLE BRACKET.
 9. 1 1/2" X 1 1/2" X 7/8" CONCRETE WEDGE ANCHORS 1/2" X 24".
 10. TOP ENCLOSED WITH ANGLE STEEL WELDED IN PLACE.
 11. 1 1/2" X 1 1/2" X 7/8" BLACKENED STEEL ANGLE BRACKET, TYPED TO STEEL POST.
 12. FINISH GRADE

ARTS ALLEY STANDARD SIGN STEEL POST SURFACE MOUNT
 NOT TO SCALE

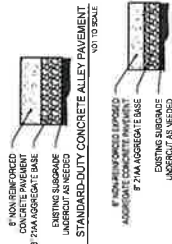

EXPOSED AGGREGATE CONCRETE PAVEMENT CROSS SECTION
 NOT TO SCALE

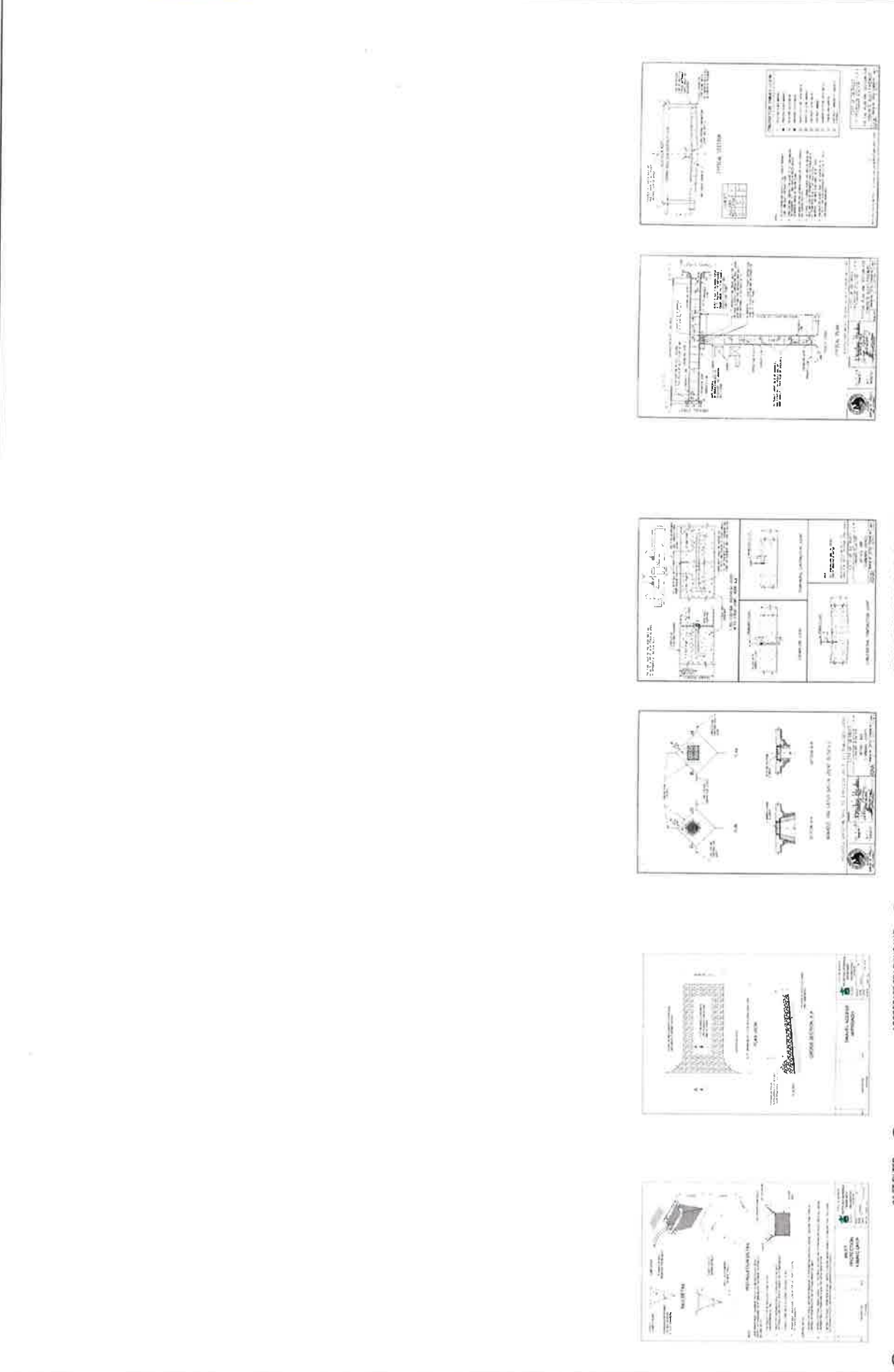

ALLEY PLAN AND SECTION - CITY OF DETROIT
 NOT TO SCALE

10

DETAIL AND STANDARD JOINTS - CITY OF DETROIT
 NOT TO SCALE

69

AGGREGATE TRACKING MAT
 NOT TO SCALE

80

81

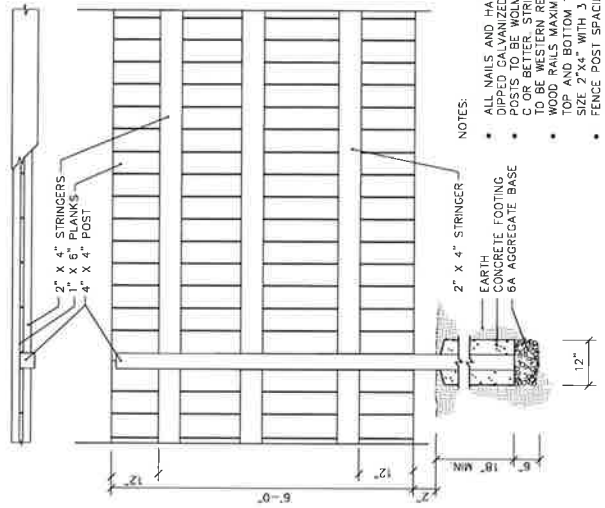
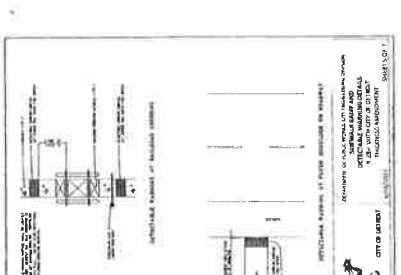
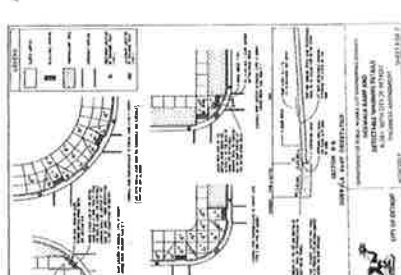
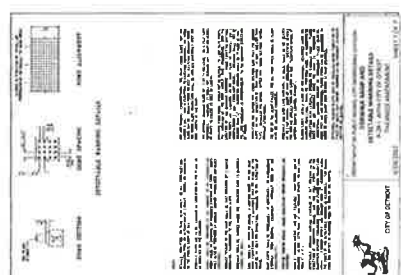
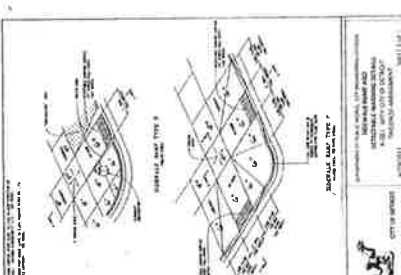
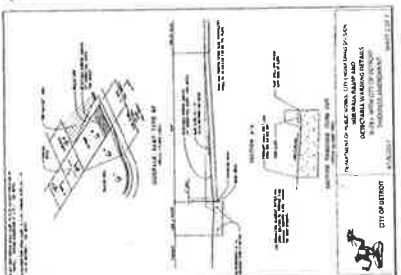
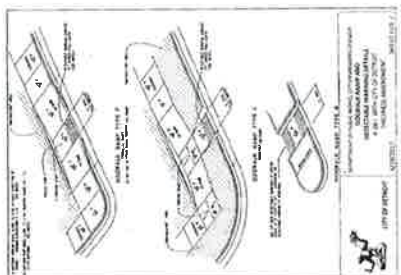
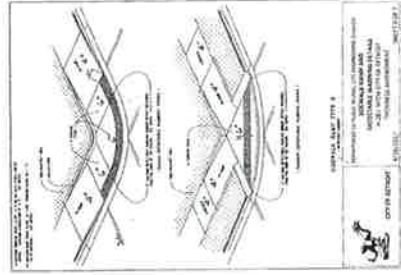

- NOTES:**
- ALL WALLS AND HARDWARE TO BE HOT DIPPED GALVANIZED
 - POSTS TO BE WOLMANIZED PINE GRADE C OR BETTER. STRINGERS AND PLANKS TO BE WESTERN RED CEDAR #1.
 - MAXIMUM DISTANCE FROM TOP RAILS TO BOTTOM RAILS SHALL BE 2' 1/4" WITH 3 RAILS REQUIRED.
 - FENCE POST SPACING MAXIMUM 8' O.C.

SEWALVA - CITY OF DETROIT
 NOTES

8 FT WOODEN FENCE
 NOTES

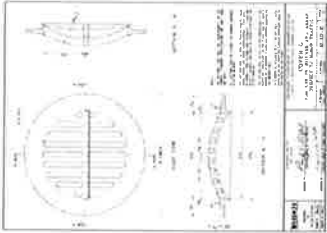

50 BEEHIVE CATCH-BASIN COVER
 NOT TO SCALE

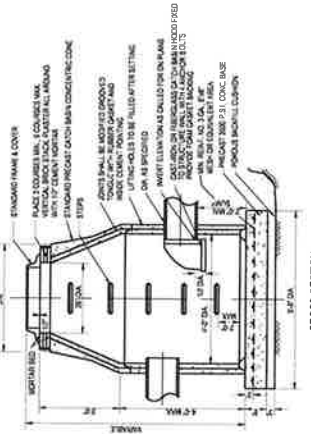

CROSS-SECTION
 CATCH BASIN

51 TRAPPED CATCH-BASIN
 NOT TO SCALE

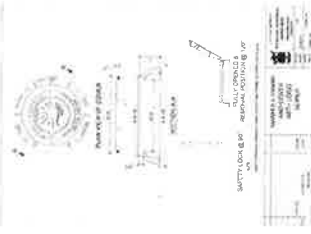

52 MANHOLE CASTING
 NOT TO SCALE

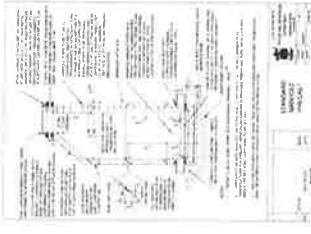

53 MANHOLE PRECAST
 NOT TO SCALE

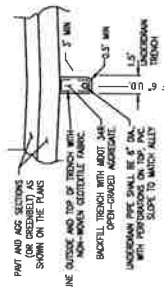

54 UNDERDRAIN TRENCH
 NOT TO SCALE

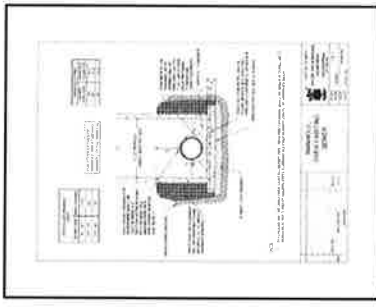

55 MANHOLE OVER EXISTING SEWER
 NOT TO SCALE

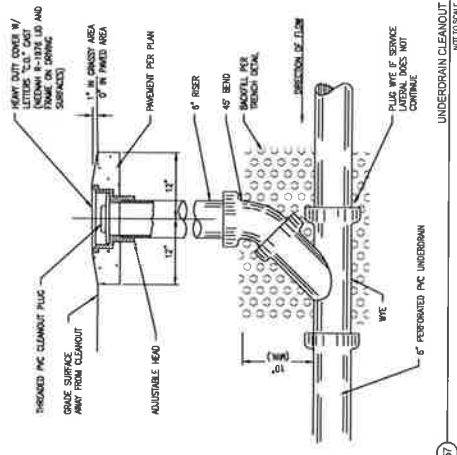

57 UNDERDRAIN CLEANOUT
 NOT TO SCALE

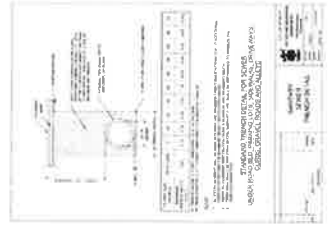

56 SANITARY TRENCH
 NOT TO SCALE



DATE	NO. & DATE	BY	CHKD	APP'D

CITY OF DETROIT
ART ALLEYS - PHASE 1
SITE LAYOUT PLAN

811
Know what's below.
Call before you dig.

SNOWDEN-HARTWELL ARTS ALLEY

(16' ROW)

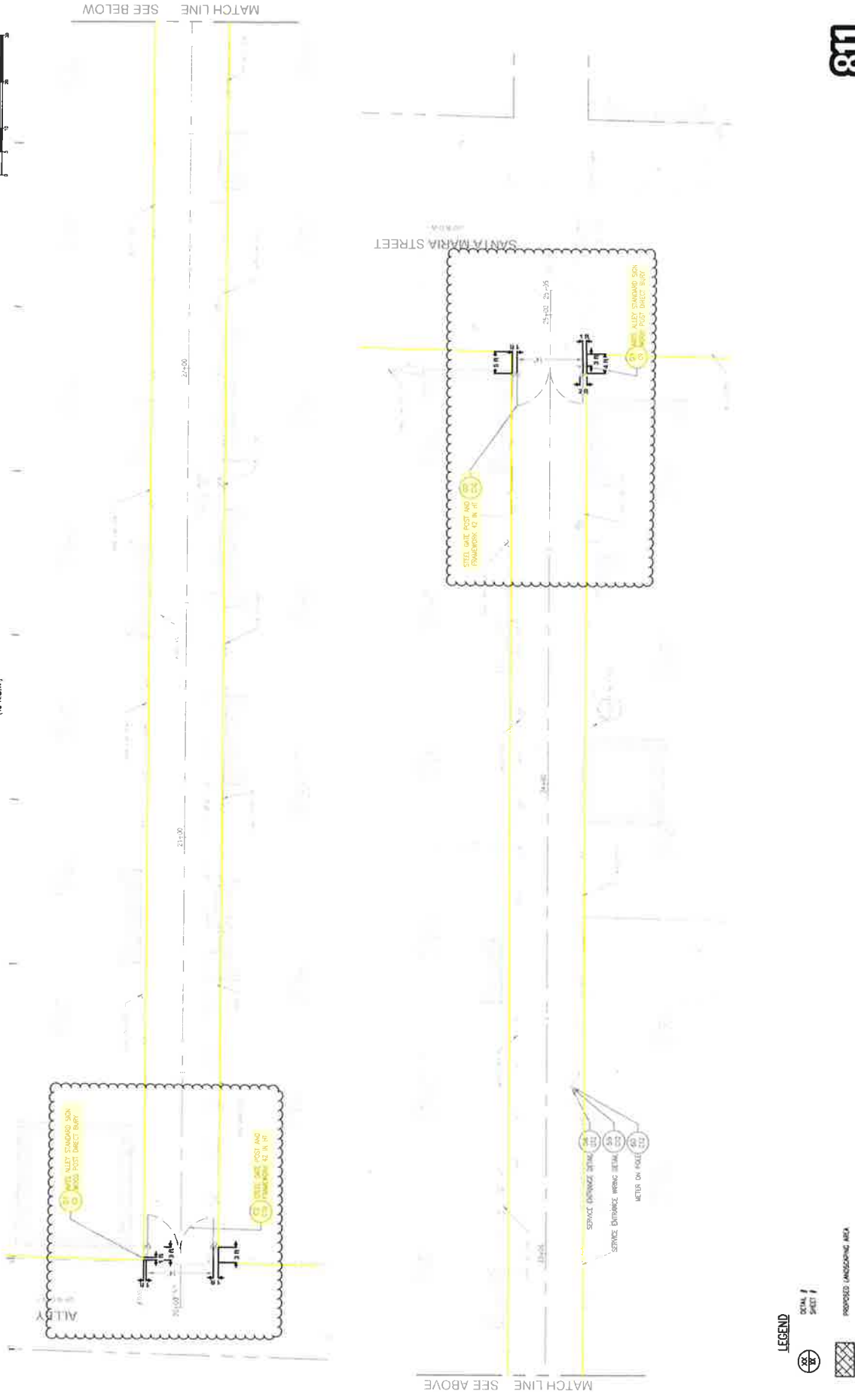
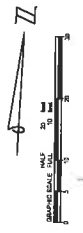

NOTE: CONTRACTOR TO REVIEW LOCATIONS FOR SITE FURNISHINGS WITH UTILITY COMPANIES AND PROVIDE INFORMATION TO LOCATIONS MAY BE MADE AT THE DISCRETION OF THE OWNER AT NO ADDITIONAL COST.

LEGEND

TOTAL SHEET

PROPOSED LANDSCAPING AREA

MATCH LINE SEE ABOVE

MATCH LINE SEE BELOW

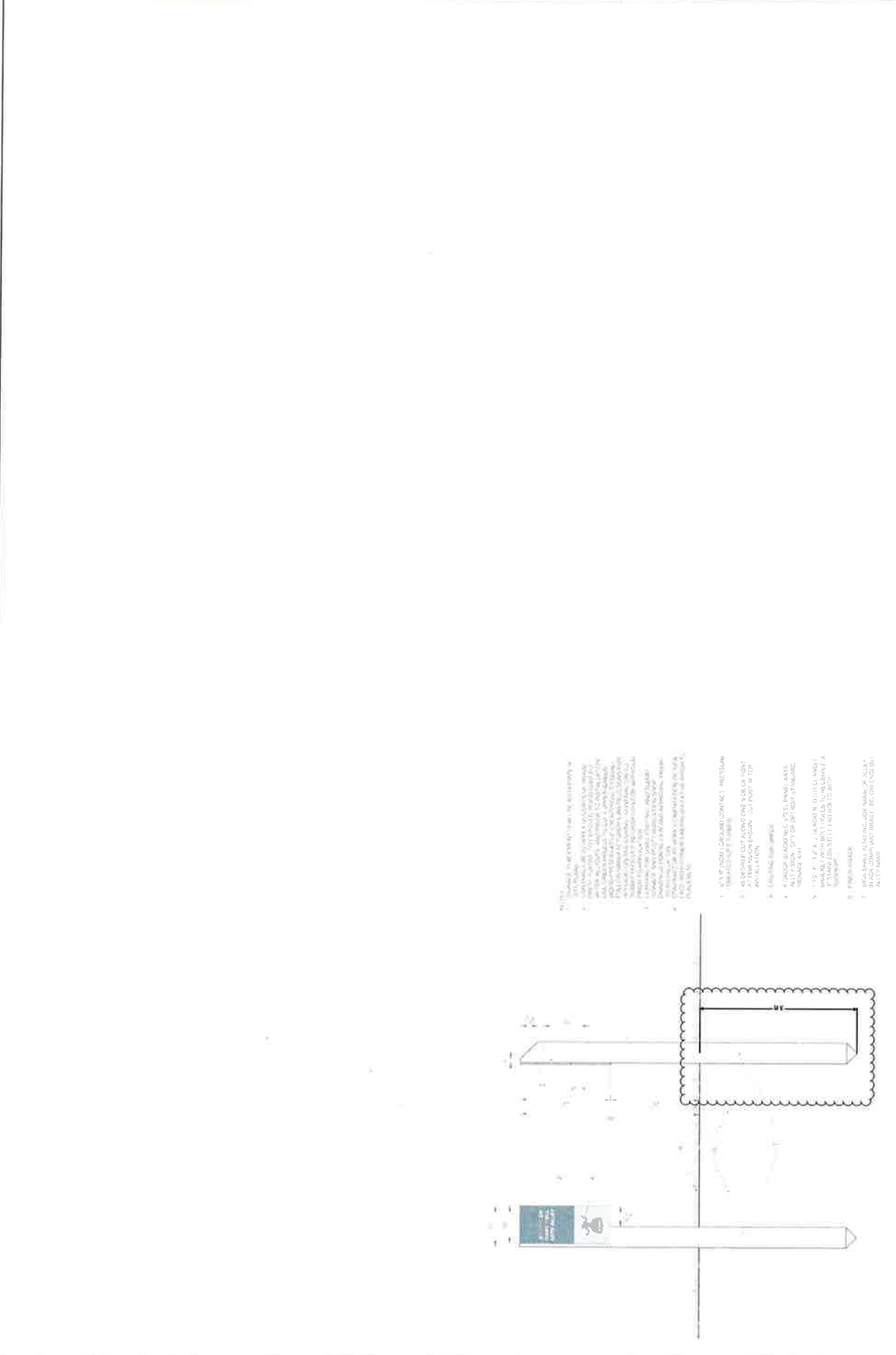

1. SUN WOOD POST AND CONTACT: PREISGARD
 2. SUN WOOD POST AND CONTACT: PREISGARD
 3. SUN WOOD POST AND CONTACT: PREISGARD
 4. SUN WOOD POST AND CONTACT: PREISGARD
 5. SUN WOOD POST AND CONTACT: PREISGARD
 6. SUN WOOD POST AND CONTACT: PREISGARD
 7. SUN WOOD POST AND CONTACT: PREISGARD
 8. SUN WOOD POST AND CONTACT: PREISGARD
 9. SUN WOOD POST AND CONTACT: PREISGARD
 10. SUN WOOD POST AND CONTACT: PREISGARD

- SUN WOOD POST AND CONTACT: PREISGARD
- SUN WOOD POST AND CONTACT: PREISGARD
- SUN WOOD POST AND CONTACT: PREISGARD
- SUN WOOD POST AND CONTACT: PREISGARD
- SUN WOOD POST AND CONTACT: PREISGARD
- SUN WOOD POST AND CONTACT: PREISGARD
- SUN WOOD POST AND CONTACT: PREISGARD
- SUN WOOD POST AND CONTACT: PREISGARD
- SUN WOOD POST AND CONTACT: PREISGARD
- SUN WOOD POST AND CONTACT: PREISGARD

ARTS ALLEY STANDARD SUN WOOD POST DIRECT BURY
 11/19/14