

MILLER RD. 60 FT. WD.

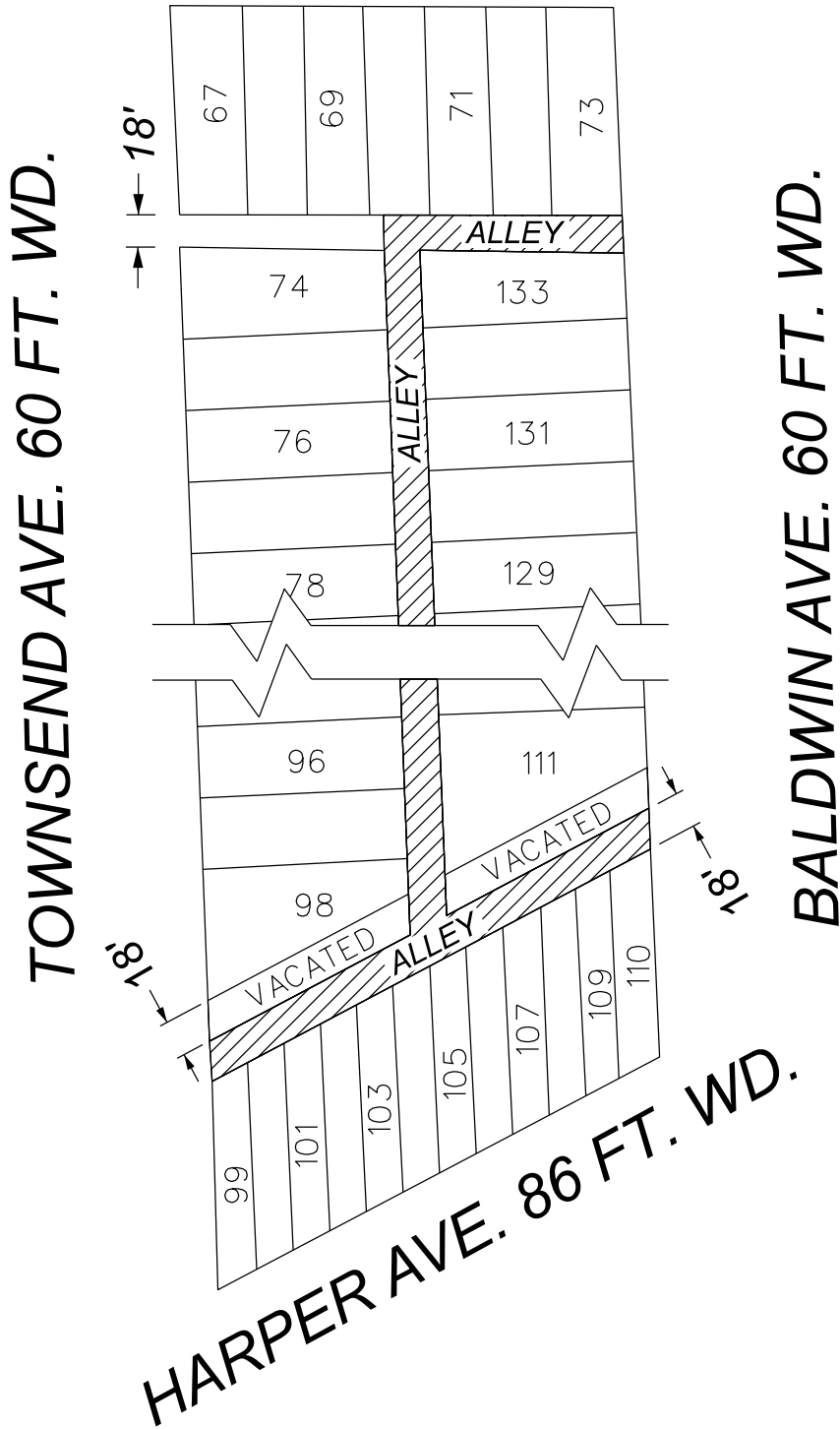

- REQUEST ENCROACHMENT
(NEW CONCRETE PAVEMENT, BOLLARDS, SIGNS, PET STATIONS,
AND ASSOCIATED WATER/POWER INFRASTRUCTURE IMPROVEMENTS)

(FOR OFFICE USE ONLY)

CARTO 49 B

B					
A					
DESCRIPTION	DRWN	CHKD	APPD	DATE	
REVISIONS					
DRAWN BY	TS	CHECKED	AP/LC		
DATE	05-30-2024	APPROVED	RW		

REQUEST ENCROACHMENT INTO
THE EAST/WEST ALLEY
AND NORTH/ SOUTH ALLEY,
18 FT. WD. IN THE BLOCK BOUNDED BY
BALDWIN AVE., HARPER AVE.,
TOWNSEND AVE., AND MILLER RD.

CITY OF DETROIT CITY ENGINEERING DIVISION SURVEY BUREAU	
JOB NO.	24-20
DRWG. NO.	01