

City of Detroit

Janice M. Winfrey
City Clerk

OFFICE OF THE CITY CLERK

Andre P. Gilbert II
Deputy City Clerk

DEPARTMENT PETITION REFERENCE COMMUNICATION

To: The Department or Commission Listed Below

From: Janice M Winfrey, Detroit City Clerk

The following petition is herewith referred to you for report and recommendation to the City Council.

In accordance with that body's directive, kindly return the same with your report in duplicate within four (4) weeks.

Petition No.	2024-138
Name of Petitioner	The Department of Public Works
Description of Petition	Please see request of proposed project which includes the activation of an existing alleyway for the creation of shared public spaces to celebrate neighborhoods and promote the installation of art. (Baily Parks Arts Alley)
Type of Petition	Alley Vacation/ Encroachment/ Utility Vacation
Submission Date	5/2/2024
Concerned Departments	Media Services, Buildings & Safety Engineering, Police Department, Fire Department, Municipal Parking Department, Transportation Department, Health Department; General Services Department,
Petitioner Contact	The Department of Public Works 313-224-3970



**CITY OF DETROIT
DEPARTMENT OF PUBLIC WORKS
CITY ENGINEERING DIVISION**

**COLEMAN A. YOUNG MUNICIPAL CENTER
2 WOODWARD AVE. SUITE 601
DETROIT, MICHIGAN 48226
PHONE: (313) 224-3949 TTY: 711
WWW.DETROITMI.GOV**

To: Clerk's Office
From: The Department of Public Works
City Engineering Division
MapsandRecordsBureau@DetroitMI.Gov
(313) 224-3970

Petitioner:
Buildings, Safety Engineering, and Environmental Department
2 Woodward Ave, Suite 601
Detroit, MI 48226

On behalf of the above-mentioned petitioner the Department of Public Works: City Engineering Division is submitting a petition request for the action below. The petitioner has received a project consultation from the Department of Public Works: City Engineering Division and has been advised the following:

The proposed project includes the activation of an existing alleyway for the creation of shared public spaces to celebrate neighborhoods and promote the installation of art. The improvements noted within this submittal include the infrastructure elements to renew the alleys; making them accessible and safe for pedestrians.

The scope of work necessary for this project will include the following:

- Alley vegetation clearing and disposal of debris.
- Drainage improvements with the installation of new catch basins and adjusting existing manholes to grade.
- Removal and replacement of the existing alleyway with concrete pavement including decorative elements.
- Creation of two plaza spaces out of decorative colored concrete.
- Installation of an amphitheater-style seating created out of an earthen mound on the adjacent property owned by the Bailey Park non-profit.
- Installation of solar powered lighting.
- Installation of a DTE electrical service.
- Installation of a water service.

Type of action recommended:



**CITY OF DETROIT
DEPARTMENT OF PUBLIC WORKS
CITY ENGINEERING DIVISION**

**COLEMAN A. YOUNG MUNICIPAL CENTER
2 WOODWARD AVE. SUITE 601
DETROIT, MICHIGAN 48226
PHONE: (313) 224-3949 TTY: 711
WWW.DETROITMI.GOV**

Raven Wright
Supervisor of Maps and Records
Department of Public Works
City Engineering Division
313-224-3985



CITY OF DETROIT
DEPARTMENT OF PUBLIC WORKS
CITY ENGINEERING DIVISION

COLEMAN A. YOUNG MUNICIPAL CENTER
2 WOODWARD AVE. SUITE 601
DETROIT, MICHIGAN 48226
PHONE: (313) 224-3949 TTY: 711
WWW.DETROITMI.GOV



February 20, 2024

Buildings, Safety Engineering, and Environmental Department
2 Woodward Ave, Suite 601
Detroit, MI 48226

Re: E-Plans Review for the Arts Alleys Project
Bailey Park Arts Alley

On behalf of the City of Detroit's Office of Art, Culture, and Entrepreneurship (ACE), OHM Advisors is submitting construction plans for review and approval by the various City Departments. The proposed project includes the activation of an existing alleyway for the creation of shared public spaces to celebrate neighborhoods and promote the installation of art. The improvements noted within this submittal include the infrastructure elements to renew the alleys; making them accessible and safe for pedestrians.

The scope of work necessary for this project will include the following:

- Alley vegetation clearing and disposal of debris.
- Drainage improvements with the installation of new catch basins and adjusting existing manholes to grade.
- Removal and replacement of the existing alleyway with concrete pavement including decorative elements.
- Creation of two plaza spaces out of decorative colored concrete.
- Installation of an amphitheater-style seating created out of an earthen mound on the adjacent property owned by the Bailey Park non-profit.
- Installation of solar powered lighting.
- Installation of a DTE electrical service.
- Installation of a water service.

Utility Easement Usage

In the early 2021, the existing public alley bounded by Charlevoix and Hunt Streets on the north/south and a residential alley to the west was vacated by request of the Bailey Park Non-profit, who owns & takes care of much of the adjacent property. Since that time, the alley ownership has reverted to adjacent private property owners. The property on the north, east and portions of the south are currently owner by the Bailey Non-profit. As part of the project design phase, ACE gained approval from the Bailey Park Non-profit as well as the adjacent property owners to implement the improvements in this project.

Throughout the alley, there are various locations where existing mature trees and/or utility poles affect the ability to install new concrete pavement. Through community engagement, it has been determined that the failed pavement in these areas should be replaced with turf grass or landscaping. To help ensure that utility companies have continued access through this space, a minimum pavement width of 15' will be maintained and the fencing will be held at the former property line.

This property will remain under private ownership under this arrangement. The improvements will be protected through the recoding of pedestrian ingress/egress easement. This will overlap the existing public utility easement which was recorded during the prior alley vacation.

OHM Advisors
1145 GRISWOLD STREET, SUITE 200
DETROIT, MICHIGAN 48226

T 313.481.1250

OHM-Advisors.com



**CITY OF DETROIT
DEPARTMENT OF PUBLIC WORKS
CITY ENGINEERING DIVISION**

**COLEMAN A. YOUNG MUNICIPAL CENTER
2 WOODWARD AVE. SUITE 601
DETROIT, MICHIGAN 48226
PHONE: (313) 224-3949 TTY: 711
WWW.DETROITMI.GOV**



Bailey Park Arts Alley: E-Plans Submission Cover Letter
February 20, 2024
Page: 2 of 2

Adjacent Improvements

The plans depict improvements on a number of adjacent properties. Specifically, there will be fencing improvements to better define the alleyway. In addition, two plazas will be constructed near the midpoint of the alley on Bailey Park Non-profit owned property to provide a performance space for residents.

Prior Development Team Meeting

This submission is a continuation of the process initiated last year that culminated in a Preliminary Plan Review meeting, held on November 20, 2023. The plans have included several changes from this initial plan set:

1. The proposed water service will no longer tap the water main within the alley, instead, per DWSID direction, it will tap off of the water main off of Hunt Street.
2. The existing failed concrete will be removed. As noted earlier, per resident feedback, a few small spaces on the edges will be retained as lawn or landscaping space. We note that this is not located above a DWSID sewer. Per direction received at the November 20, 2023, meeting, we understand this to be an allowable restoration given that the land is privately-owned. This green space will not be utilized for drainage as the proposed concrete alley will include catch basins to directly manage any runoff generated from the surface.

Questions and Review

The Arts Alley Projects are funded as part of the City of Detroit's ARPA Allotment which requires that the improvements are obligated no later than December 31, 2024. ACE appreciates any assistance in expediting reviews. If there are any questions, please contact me with any questions at 313-481-1253 or via e-mail at Zachary.hampton@ohm-advisors.com.

Sincerely,
OHM Advisors

Zachary Hampton, P.E.
Project Manager

cc: File



CITY OF DETROIT
DEPARTMENT OF PUBLIC WORKS
CITY ENGINEERING DIVISION

COLEMAN A. YOUNG MUNICIPAL CENTER
2 WOODWARD AVE. SUITE 601
DETROIT, MICHIGAN 48226
PHONE: (313) 224-3949 TTY: 711
WWW.DETROITMI.GOV

MAP-24-19



MCDUGALL AVE. 80 FT. WD.

CHARLEVOIX AVE. 50 FT. WD.

ELMWOOD AVE. 60 FT. WD.

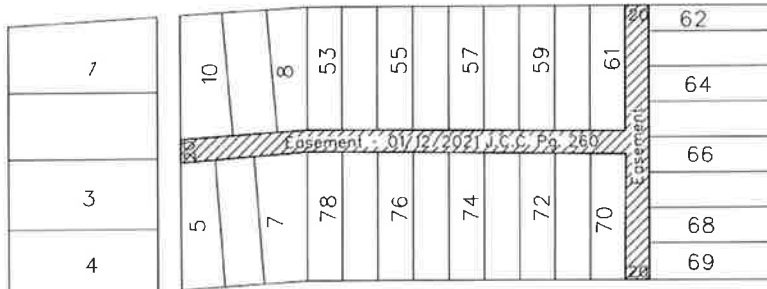

HUNT ST. 50 FT. WD.

- REQUEST ENCROACHMENT (NEW CONCRETE PAVEMENT, BENCHING, BOLLARDS, FENCING, SIGNS, ART PANELS, WALKING TIMELINE, KIOSK, ASSOCIATED STORM AND LANDSCAPING)

(FOR OFFICE USE ONLY)

CARTO 39 F

B				
A				
	DESCRIPTION	DATE	APPROVED	DATE
DRAWN BY	TS	CHECKED	LC	
DATE	2-23-2024	APPROVED	JD	

REQUEST ENCROACHMENT INTO THE EASTWEST ALLEY AND NORTH/SOUTH ALLEY, 20 FT. WD. IN THE BLOCK BOUND BY CHARLEVOIX AVE, MCDUGALL AVE, HUNT ST, AND ELMWOOD AVE.

CITY OF DETROIT
CITY ENGINEERING DIVISION
SURVEY BUREAU

JOB NO. 24-19

DRWG. NO.

CITY OF DETROIT ARTS ALLEY - PHASE II

BAILEY PARK
WAYNE COUNTY, MICHIGAN

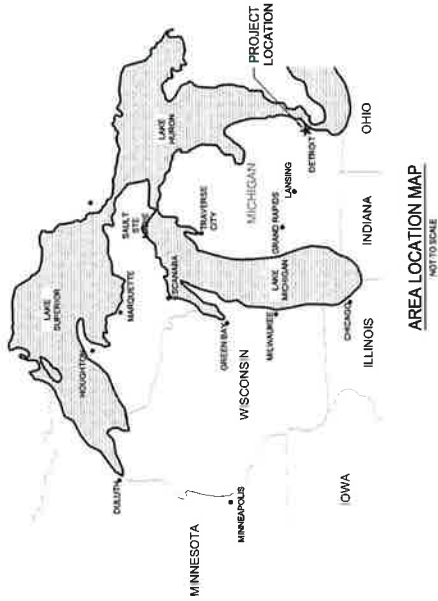

SAINTREX/ARTEP
2500 WALKUP AND SLM ROAD
735 PARKWOOD SQUARE
DETROIT, MI 48226-8800
PHONE : 313.963.8800
FAX : 313.963.8801
WWW.SAINTREX.COM

ELLIOTT/STAS
2500 WALKUP AND SLM ROAD
DETROIT, MI 48226-8800
PHONE : 313.963.8800
FAX : 313.963.8801
WWW.SAINTREX.COM

SAINTREX/ARTEP
2500 WALKUP AND SLM ROAD
DETROIT, MI 48226-8800
PHONE : 313.963.8800
FAX : 313.963.8801
WWW.SAINTREX.COM

SHEET INDEX

REVISION KEY
● NEW SHEET ○ NOT REVISION ▲ REVISION

SHEET TITLE	DATE	REVISION
1.0000	01/19/24	1.0000
1.0001	01/19/24	1.0001
1.0002	01/19/24	1.0002
1.0003	01/19/24	1.0003
1.0004	01/19/24	1.0004
1.0005	01/19/24	1.0005
1.0006	01/19/24	1.0006
1.0007	01/19/24	1.0007
1.0008	01/19/24	1.0008
1.0009	01/19/24	1.0009
1.0010	01/19/24	1.0010
1.0011	01/19/24	1.0011
1.0012	01/19/24	1.0012
1.0013	01/19/24	1.0013
1.0014	01/19/24	1.0014
1.0015	01/19/24	1.0015
1.0016	01/19/24	1.0016
1.0017	01/19/24	1.0017
1.0018	01/19/24	1.0018
1.0019	01/19/24	1.0019
1.0020	01/19/24	1.0020
1.0021	01/19/24	1.0021
1.0022	01/19/24	1.0022
1.0023	01/19/24	1.0023
1.0024	01/19/24	1.0024
1.0025	01/19/24	1.0025
1.0026	01/19/24	1.0026
1.0027	01/19/24	1.0027
1.0028	01/19/24	1.0028
1.0029	01/19/24	1.0029
1.0030	01/19/24	1.0030
1.0031	01/19/24	1.0031
1.0032	01/19/24	1.0032
1.0033	01/19/24	1.0033
1.0034	01/19/24	1.0034
1.0035	01/19/24	1.0035
1.0036	01/19/24	1.0036
1.0037	01/19/24	1.0037
1.0038	01/19/24	1.0038
1.0039	01/19/24	1.0039
1.0040	01/19/24	1.0040
1.0041	01/19/24	1.0041
1.0042	01/19/24	1.0042
1.0043	01/19/24	1.0043
1.0044	01/19/24	1.0044
1.0045	01/19/24	1.0045
1.0046	01/19/24	1.0046
1.0047	01/19/24	1.0047
1.0048	01/19/24	1.0048
1.0049	01/19/24	1.0049
1.0050	01/19/24	1.0050
1.0051	01/19/24	1.0051
1.0052	01/19/24	1.0052
1.0053	01/19/24	1.0053
1.0054	01/19/24	1.0054
1.0055	01/19/24	1.0055
1.0056	01/19/24	1.0056
1.0057	01/19/24	1.0057
1.0058	01/19/24	1.0058
1.0059	01/19/24	1.0059
1.0060	01/19/24	1.0060
1.0061	01/19/24	1.0061
1.0062	01/19/24	1.0062
1.0063	01/19/24	1.0063
1.0064	01/19/24	1.0064
1.0065	01/19/24	1.0065
1.0066	01/19/24	1.0066
1.0067	01/19/24	1.0067
1.0068	01/19/24	1.0068
1.0069	01/19/24	1.0069
1.0070	01/19/24	1.0070
1.0071	01/19/24	1.0071
1.0072	01/19/24	1.0072
1.0073	01/19/24	1.0073
1.0074	01/19/24	1.0074
1.0075	01/19/24	1.0075
1.0076	01/19/24	1.0076
1.0077	01/19/24	1.0077
1.0078	01/19/24	1.0078
1.0079	01/19/24	1.0079
1.0080	01/19/24	1.0080
1.0081	01/19/24	1.0081
1.0082	01/19/24	1.0082
1.0083	01/19/24	1.0083
1.0084	01/19/24	1.0084
1.0085	01/19/24	1.0085
1.0086	01/19/24	1.0086
1.0087	01/19/24	1.0087
1.0088	01/19/24	1.0088
1.0089	01/19/24	1.0089
1.0090	01/19/24	1.0090
1.0091	01/19/24	1.0091
1.0092	01/19/24	1.0092
1.0093	01/19/24	1.0093
1.0094	01/19/24	1.0094
1.0095	01/19/24	1.0095
1.0096	01/19/24	1.0096
1.0097	01/19/24	1.0097
1.0098	01/19/24	1.0098
1.0099	01/19/24	1.0099
1.0100	01/19/24	1.0100

OWNER
CITY OF DETROIT
1100 W. WALKUP AND SLM ROAD
DETROIT, MI 48226-8800
PHONE : 313.963.8800
FAX : 313.963.8801
WWW.CITYOFDETROIT.COM



100% PLANS
OHM PROJECT NO. 7508-23-0010
DATE/ISSUE: 01/19/24

Check That This Drawing Was Prepared Under My Direct Supervision



17481-184

WATER & SEWER UTILITY SYMBOLS

EXISTING

- 1" CWV W/IN
- 2" CWV W/IN
- 4" SQUARE CHECK BASIN
- BRAND LATCH BASIN
- CLUMPT
- CLUMPT W/IN END SECTION
- CLUMPT W/IN END SECTION
- SAWNEY MANHOLE
- 41141-041
- CALL VALVE & WELL
- CALL VALVE & BOX
- WATER STOP BOX
- FIRE HYDRANT
- WATER STOP
- WATER STOP
- TRAP & WALK
- BRIGHT VALVE

PROPOSED

- 1" CWV W/IN
- 2" CWV W/IN
- 4" CWV W/IN
- CLUMPT W/IN END SECTION
- CLUMPT W/IN END SECTION
- SAWNEY MANHOLE
- 41141-041
- CALL VALVE & WELL
- CALL VALVE & BOX
- WATER STOP BOX
- FIRE HYDRANT
- WATER STOP
- WATER STOP
- TRAP & WALK
- BRIGHT VALVE

MISCELLANEOUS UTILITY SYMBOLS

EXISTING

- 1" CWV W/IN
- 2" CWV W/IN
- 4" CWV W/IN
- CLUMPT W/IN END SECTION
- CLUMPT W/IN END SECTION
- SAWNEY MANHOLE
- 41141-041
- CALL VALVE & WELL
- CALL VALVE & BOX
- WATER STOP BOX
- FIRE HYDRANT
- WATER STOP
- WATER STOP
- TRAP & WALK
- BRIGHT VALVE

PROPOSED

- 1" CWV W/IN
- 2" CWV W/IN
- 4" CWV W/IN
- CLUMPT W/IN END SECTION
- CLUMPT W/IN END SECTION
- SAWNEY MANHOLE
- 41141-041
- CALL VALVE & WELL
- CALL VALVE & BOX
- WATER STOP BOX
- FIRE HYDRANT
- WATER STOP
- WATER STOP
- TRAP & WALK
- BRIGHT VALVE

MISCELLANEOUS SYMBOLS

EXISTING

- 1" CWV W/IN
- 2" CWV W/IN
- 4" CWV W/IN
- CLUMPT W/IN END SECTION
- CLUMPT W/IN END SECTION
- SAWNEY MANHOLE
- 41141-041
- CALL VALVE & WELL
- CALL VALVE & BOX
- WATER STOP BOX
- FIRE HYDRANT
- WATER STOP
- WATER STOP
- TRAP & WALK
- BRIGHT VALVE

PROPOSED

- 1" CWV W/IN
- 2" CWV W/IN
- 4" CWV W/IN
- CLUMPT W/IN END SECTION
- CLUMPT W/IN END SECTION
- SAWNEY MANHOLE
- 41141-041
- CALL VALVE & WELL
- CALL VALVE & BOX
- WATER STOP BOX
- FIRE HYDRANT
- WATER STOP
- WATER STOP
- TRAP & WALK
- BRIGHT VALVE

UTILITY PATTERN

EXISTING

- 1" CWV W/IN
- 2" CWV W/IN
- 4" CWV W/IN
- CLUMPT W/IN END SECTION
- CLUMPT W/IN END SECTION
- SAWNEY MANHOLE
- 41141-041
- CALL VALVE & WELL
- CALL VALVE & BOX
- WATER STOP BOX
- FIRE HYDRANT
- WATER STOP
- WATER STOP
- TRAP & WALK
- BRIGHT VALVE

PROPOSED

- 1" CWV W/IN
- 2" CWV W/IN
- 4" CWV W/IN
- CLUMPT W/IN END SECTION
- CLUMPT W/IN END SECTION
- SAWNEY MANHOLE
- 41141-041
- CALL VALVE & WELL
- CALL VALVE & BOX
- WATER STOP BOX
- FIRE HYDRANT
- WATER STOP
- WATER STOP
- TRAP & WALK
- BRIGHT VALVE

REMOVAL LEGEND

- 1" CWV W/IN
- 2" CWV W/IN
- 4" CWV W/IN
- CLUMPT W/IN END SECTION
- CLUMPT W/IN END SECTION
- SAWNEY MANHOLE
- 41141-041
- CALL VALVE & WELL
- CALL VALVE & BOX
- WATER STOP BOX
- FIRE HYDRANT
- WATER STOP
- WATER STOP
- TRAP & WALK
- BRIGHT VALVE

IF NECESSARY FOR CLARITY

- 1" CWV W/IN
- 2" CWV W/IN
- 4" CWV W/IN
- CLUMPT W/IN END SECTION
- CLUMPT W/IN END SECTION
- SAWNEY MANHOLE
- 41141-041
- CALL VALVE & WELL
- CALL VALVE & BOX
- WATER STOP BOX
- FIRE HYDRANT
- WATER STOP
- WATER STOP
- TRAP & WALK
- BRIGHT VALVE

LEGEND

PROJECT NUMBER: BAILEY PARK
 DRAWING NUMBER: ARTS ALLEY - PHASE II
 CITY OF DETROIT
 TRAIL NUMBER: Z-24
 CLIENT PROJECT: Z-24

PROJECT NUMBER: BAILEY PARK
 DRAWING NUMBER: ARTS ALLEY - PHASE II
 CITY OF DETROIT
 TRAIL NUMBER: Z-24
 CLIENT PROJECT: Z-24



livingLAB



DATE	REVISION	DESCRIPTION

CITY OF DETROIT
 ARTS ALLEY - PHASE II
 BAILEY PARK

C4

BAILEY PARK ARTS ALLEY

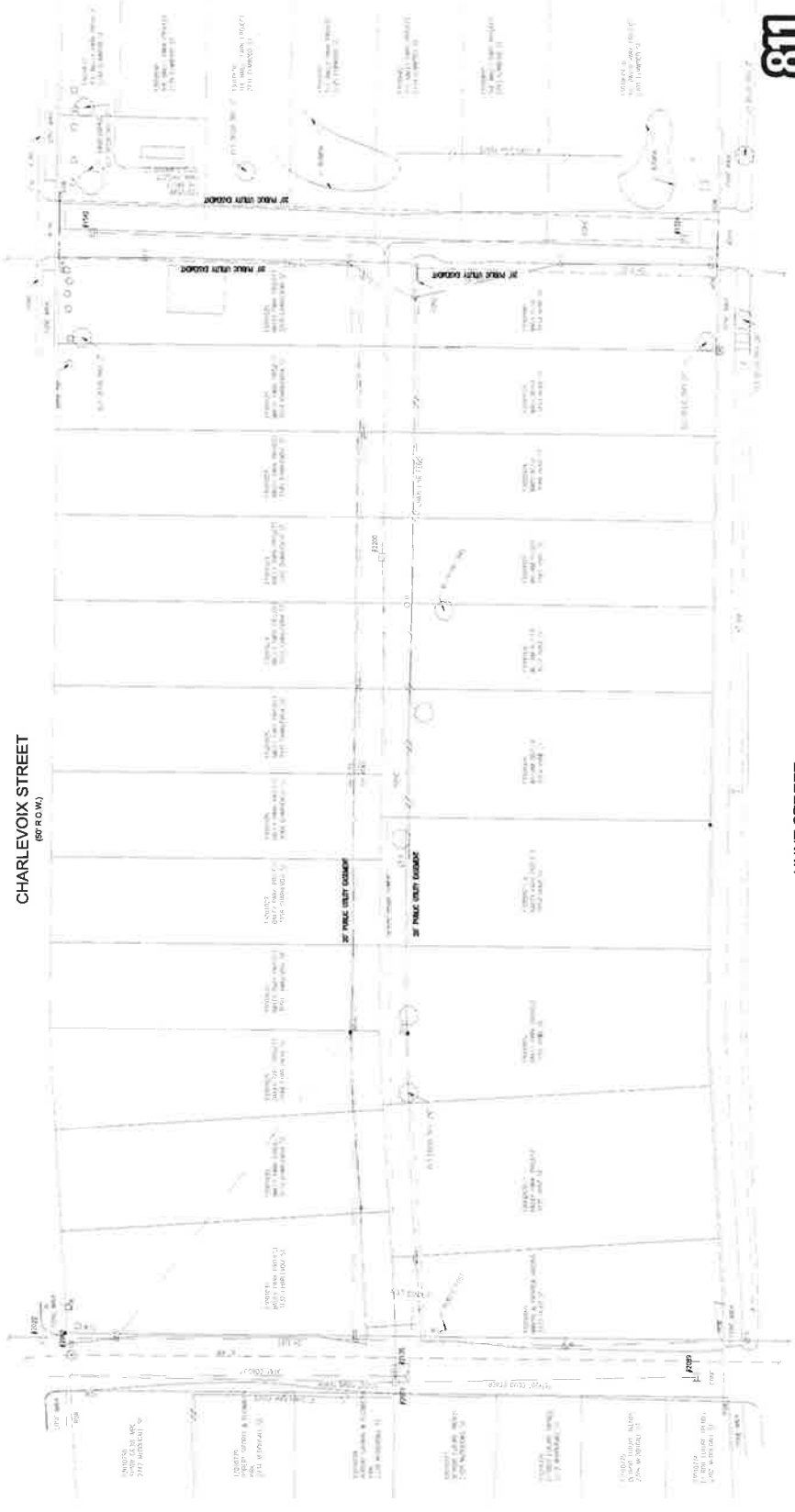

LEGEND

	20' PUBLIC UTILITY EASEMENT
	30' PUBLIC UTILITY EASEMENT
	40' PUBLIC UTILITY EASEMENT
	50' PUBLIC UTILITY EASEMENT
	60' PUBLIC UTILITY EASEMENT
	70' PUBLIC UTILITY EASEMENT
	80' PUBLIC UTILITY EASEMENT
	90' PUBLIC UTILITY EASEMENT
	100' PUBLIC UTILITY EASEMENT
	120' PUBLIC UTILITY EASEMENT
	150' PUBLIC UTILITY EASEMENT
	200' PUBLIC UTILITY EASEMENT
	300' PUBLIC UTILITY EASEMENT
	400' PUBLIC UTILITY EASEMENT
	500' PUBLIC UTILITY EASEMENT
	600' PUBLIC UTILITY EASEMENT
	700' PUBLIC UTILITY EASEMENT
	800' PUBLIC UTILITY EASEMENT
	900' PUBLIC UTILITY EASEMENT
	1000' PUBLIC UTILITY EASEMENT
	1200' PUBLIC UTILITY EASEMENT
	1500' PUBLIC UTILITY EASEMENT
	2000' PUBLIC UTILITY EASEMENT
	3000' PUBLIC UTILITY EASEMENT
	4000' PUBLIC UTILITY EASEMENT
	5000' PUBLIC UTILITY EASEMENT
	6000' PUBLIC UTILITY EASEMENT
	7000' PUBLIC UTILITY EASEMENT
	8000' PUBLIC UTILITY EASEMENT
	9000' PUBLIC UTILITY EASEMENT
	10000' PUBLIC UTILITY EASEMENT



BAILEY PARK ARTS ALLEY

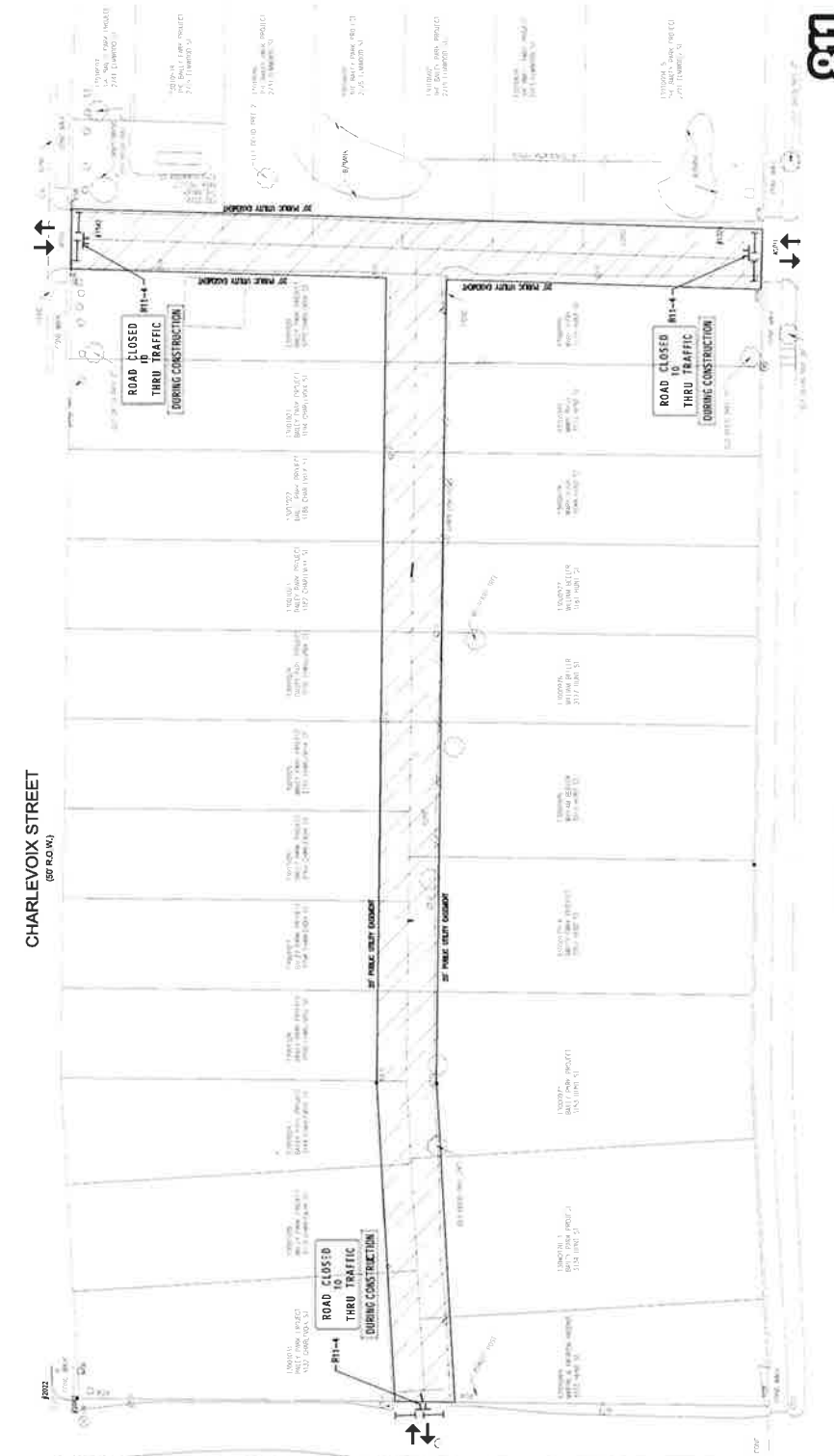

LEGEND
 ENTRY/EXIT
 WORK ZONE
 TEMPORARY SIGN
 BARROQUE TYPE II, HIGH INTENSITY, DOUBLE SIDED LIGHTED

STAGING AND PROGRESS OF THE WORK
 THE CONTRACTOR SHALL REVIEW ALL ASPECTS OF THE CONTRACT AND COORDINATE WORK PROGRESS WITH THE CITY OF DETROIT THROUGHOUT THE PROJECT. THIS INCLUDES A METHODOLOGICAL PROGRESSION OF THE WORK THAT LIMITS IMPACTS TO STREETS.

STAGING AREAS
 AS PART OF THIS PROJECT, STAGING AREAS MAY BE USED FOR THE STORAGE OF MATERIALS, EQUIPMENT, AND AGGREGATES, EXCAVATED MATERIALS, PIPE, AND OTHER ITEMS. THE CONTRACTOR SHALL BE RESPONSIBLE FOR PROVIDING ADDITIONAL SIGNAGE TO ADVISE THE PUBLIC OF THE PRESENCE OF ANY STAGING AREAS WITHIN THE PUBLIC RIGHT OF WAY. STAGING AREAS SHALL NOT IMPERE PEDESTRIAN OR VEHICULAR TRAFFIC PATTERNS OR BE OTHER PROPERTY WITHIN OR AROUND THE PUBLIC RIGHT OF WAY. STAGING AREAS SHALL BE RESTORED TO A CONDITION EQUIVALENT OR BETTER THAN CURRENT CONDITIONS.

TRAFFIC CONTROL
 THE CONTRACTOR SHALL BE RESPONSIBLE FOR ERECTING AND MAINTAINING ALL TRAFFIC CONTROL DEVICES. ALL TRAFFIC CONTROL DEVICES SHALL BE PERMITTED TO THE LATEST VERSION OF THE MICHIGAN MANUAL FOR URBAN TRAFFIC CONTROL. ALL TRAFFIC CONTROL DEVICES ARE TO BE IN PLACE AND IN WORKING ORDER AT ALL TIMES. IF WORK IS REQUIRED WITHIN THE ROAD ROW, CLOSURES PER NOT IMPLEMENTED. IF WORK AFFECTS THE SIDEWALK, FULL SIDEWALK CLOSURES & DEFOURS SHALL BE IMPLEMENTED.



BAILEY PARK ARTS ALLEY

CHARLEVOIX STREET
(50' R.O.W.)

HUNT STREET
(50' R.O.W.)

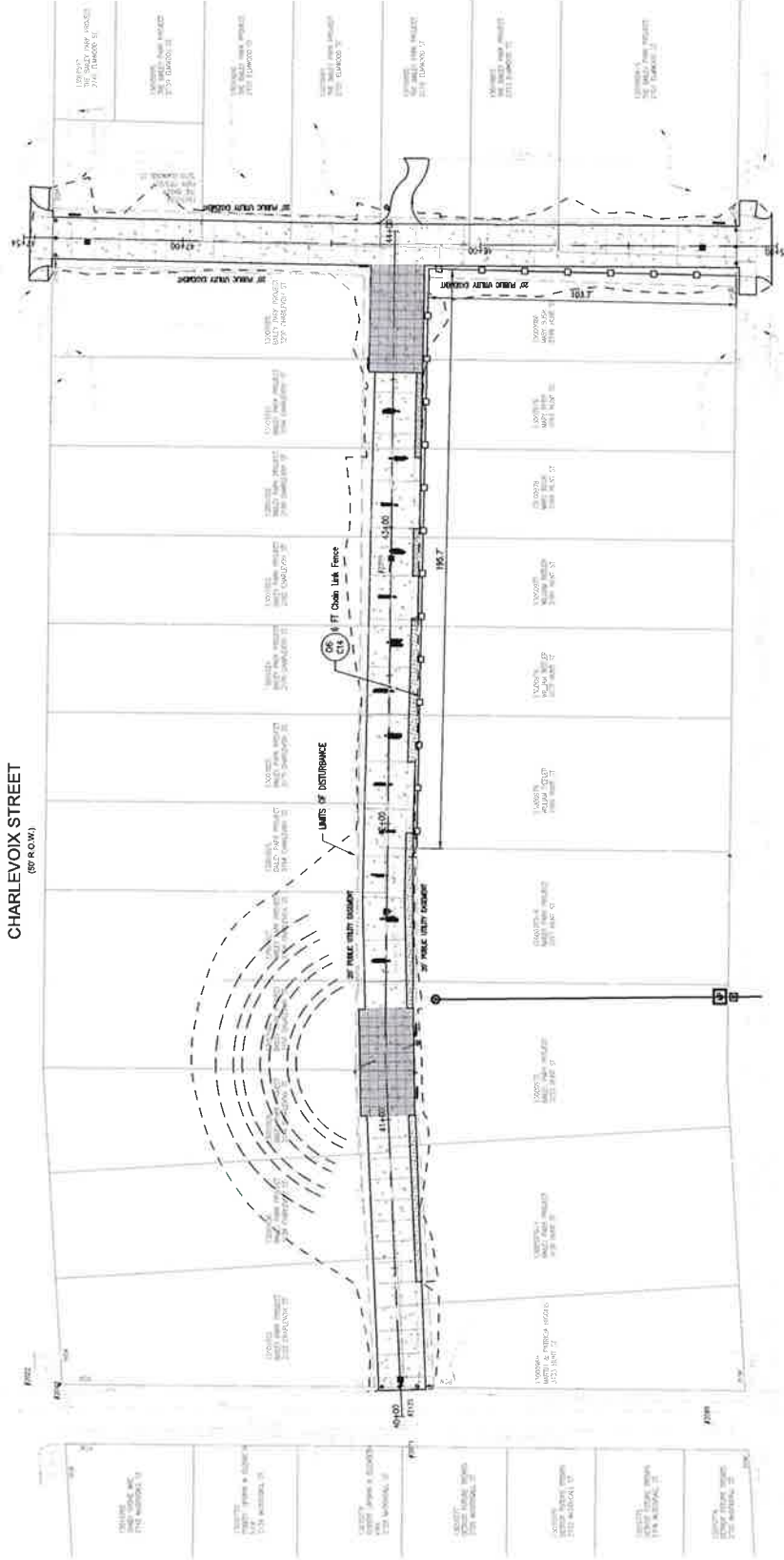

LEGEND

179 FT CHAIN LINK FENCE

50' CHAIN LINK FENCE

FENCING QUANTITIES

179 FT

289 FT



REVISION	DESCRIPTION	DATE

PROJECT NUMBER	DATE	PROJECT LEAD	CLIENT PROJECT NO.

CITY OF DETROIT
ARTS ALLEY - PHASE II
BAILEY PARK
SITE LAYOUT PLAN - FENCING



livingLAB



REVISION	DESCRIPTION	DATE

PROJECT NUMBER: PD 2016-014
 CLIENT PROJECT NO: 1516
 TITLE: ARTS ALLEY - PHASE II
 CITY OF DETROIT
 BAILEY PARK
 GRADING PLAN

C9



Know what's Below. Call before you dig.

BAILEY PARK ARTS ALLEY

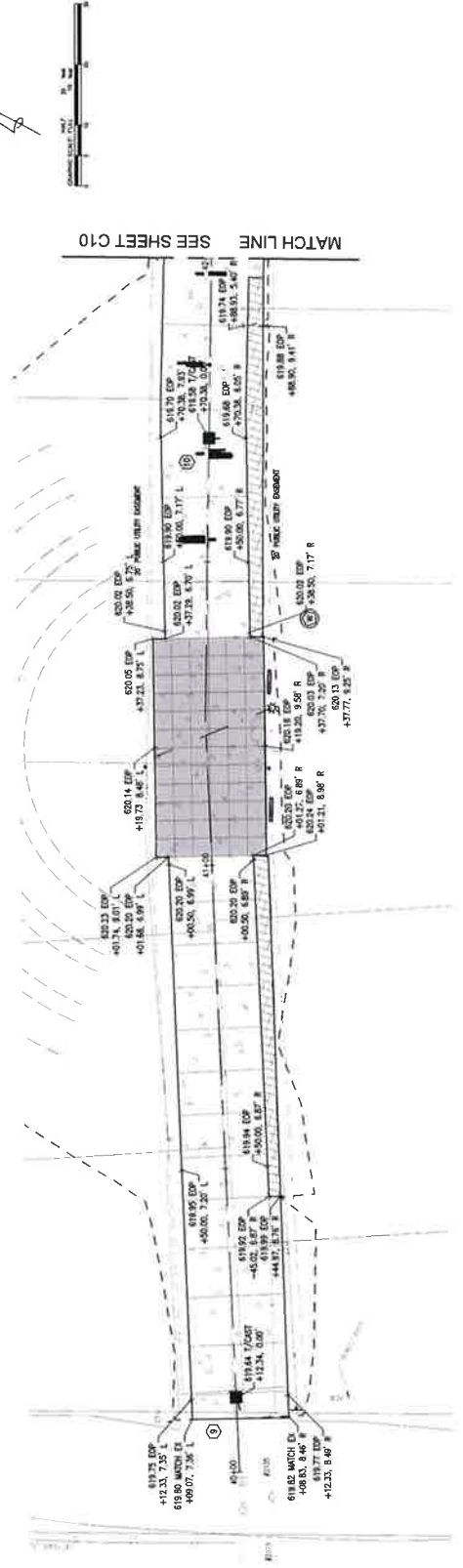

MATCH LINE SEE SHEET C10

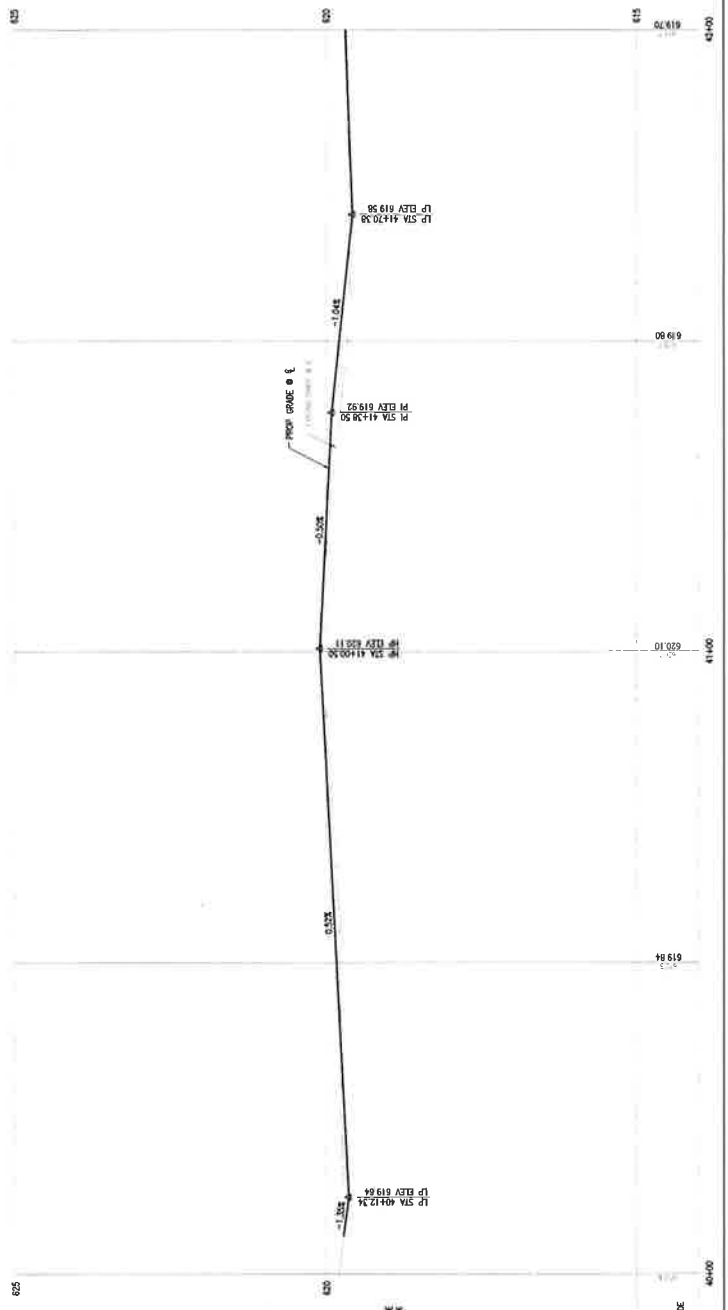
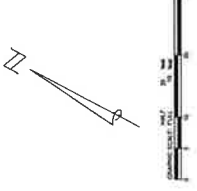

- LEGEND**
- 1.0' = 1.0'
 - 2.0' = 2.0'
 - 3.0' = 3.0'
 - 4.0' = 4.0'
 - 5.0' = 5.0'
 - 6.0' = 6.0'
 - 7.0' = 7.0'
 - 8.0' = 8.0'
 - 9.0' = 9.0'
 - 10.0' = 10.0'
 - 11.0' = 11.0'
 - 12.0' = 12.0'
 - 13.0' = 13.0'
 - 14.0' = 14.0'
 - 15.0' = 15.0'
 - 16.0' = 16.0'
 - 17.0' = 17.0'
 - 18.0' = 18.0'
 - 19.0' = 19.0'
 - 20.0' = 20.0'
 - 21.0' = 21.0'
 - 22.0' = 22.0'
 - 23.0' = 23.0'
 - 24.0' = 24.0'
 - 25.0' = 25.0'
 - 26.0' = 26.0'
 - 27.0' = 27.0'
 - 28.0' = 28.0'
 - 29.0' = 29.0'
 - 30.0' = 30.0'
 - 31.0' = 31.0'
 - 32.0' = 32.0'
 - 33.0' = 33.0'
 - 34.0' = 34.0'
 - 35.0' = 35.0'
 - 36.0' = 36.0'
 - 37.0' = 37.0'
 - 38.0' = 38.0'
 - 39.0' = 39.0'
 - 40.0' = 40.0'
 - 41.0' = 41.0'
 - 42.0' = 42.0'
 - 43.0' = 43.0'
 - 44.0' = 44.0'
 - 45.0' = 45.0'
 - 46.0' = 46.0'
 - 47.0' = 47.0'
 - 48.0' = 48.0'
 - 49.0' = 49.0'
 - 50.0' = 50.0'
 - 51.0' = 51.0'
 - 52.0' = 52.0'
 - 53.0' = 53.0'
 - 54.0' = 54.0'
 - 55.0' = 55.0'
 - 56.0' = 56.0'
 - 57.0' = 57.0'
 - 58.0' = 58.0'
 - 59.0' = 59.0'
 - 60.0' = 60.0'
 - 61.0' = 61.0'
 - 62.0' = 62.0'
 - 63.0' = 63.0'
 - 64.0' = 64.0'
 - 65.0' = 65.0'
 - 66.0' = 66.0'
 - 67.0' = 67.0'
 - 68.0' = 68.0'
 - 69.0' = 69.0'
 - 70.0' = 70.0'
 - 71.0' = 71.0'
 - 72.0' = 72.0'
 - 73.0' = 73.0'
 - 74.0' = 74.0'
 - 75.0' = 75.0'
 - 76.0' = 76.0'
 - 77.0' = 77.0'
 - 78.0' = 78.0'
 - 79.0' = 79.0'
 - 80.0' = 80.0'
 - 81.0' = 81.0'
 - 82.0' = 82.0'
 - 83.0' = 83.0'
 - 84.0' = 84.0'
 - 85.0' = 85.0'
 - 86.0' = 86.0'
 - 87.0' = 87.0'
 - 88.0' = 88.0'
 - 89.0' = 89.0'
 - 90.0' = 90.0'
 - 91.0' = 91.0'
 - 92.0' = 92.0'
 - 93.0' = 93.0'
 - 94.0' = 94.0'
 - 95.0' = 95.0'
 - 96.0' = 96.0'
 - 97.0' = 97.0'
 - 98.0' = 98.0'
 - 99.0' = 99.0'
 - 100.0' = 100.0'

NOTE:
 COORDINATE LAYOUT OF PAVING JOINTS
 TO MATCH ADJACENT SHEETS.
 CONTRACTOR SHALL SUBMIT JOINTING PLAN
 TO ENGINEER FOR APPROVAL PRIOR TO
 BEGINNING PAVING OPERATIONS

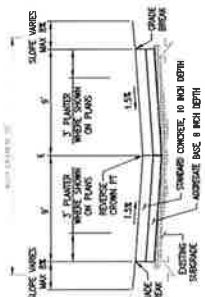

PROPOSED TYPICAL CROSS-SECTION
BAILEY PARK ARTS ALLEY



REVISION	DESCRIPTION	DATE

PROJECT NUMBER: PM 1306746
 PROJECT LEAD: CLEON FROST
 TITLE: GRADING PLAN
 CITY OF DETROIT
 ARTS ALLEY - PHASE II
 BAILEY PARK

C10



BAILEY PARK ARTS ALLEY

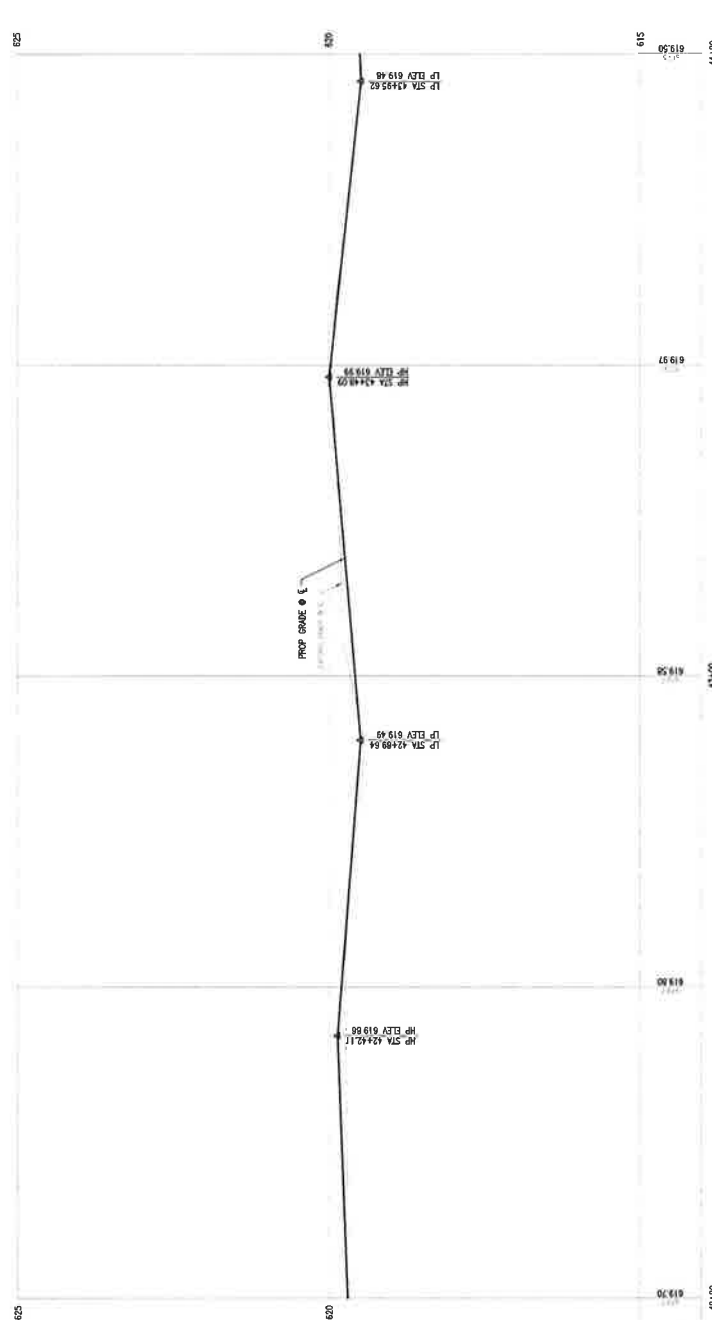
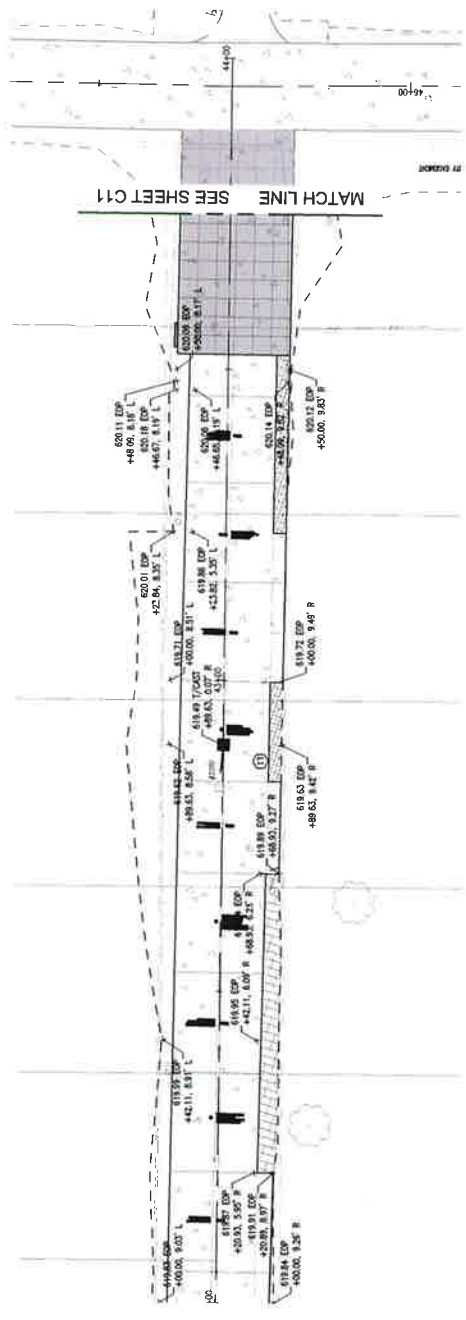
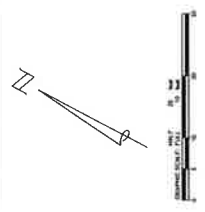

LEGEND

- PAVING JOINTS
- SURFACE FEATURES
- CURB
- SIDEWALK
- DRIVEWAY
- DRIVE
- DRIVEWAY
- DRIVE

NOTE:
 COORDINATE LAYOUT OF PAVING JOINTS WITH SURFACE FEATURES.
 VERIFY ALL SURFACE FEATURES AND ELEVATIONS WITH THE FIELD ENGINEER PRIOR TO BEGINNING PAVING OPERATIONS.

PROPOSED PAVING PLAN

DATE: 08/11/2020



LEGEND

NOTE: VERIFY LOCUS OF PAVING JOINTS WITH SURFACE ELEVATIONS. CONTRACTOR SHALL SUBMIT JOINTING PLAN TO ENGINEER FOR APPROVAL PRIOR TO BEGINNING PAVING OPERATIONS.

BAILEY PARK ARTS ALLEY

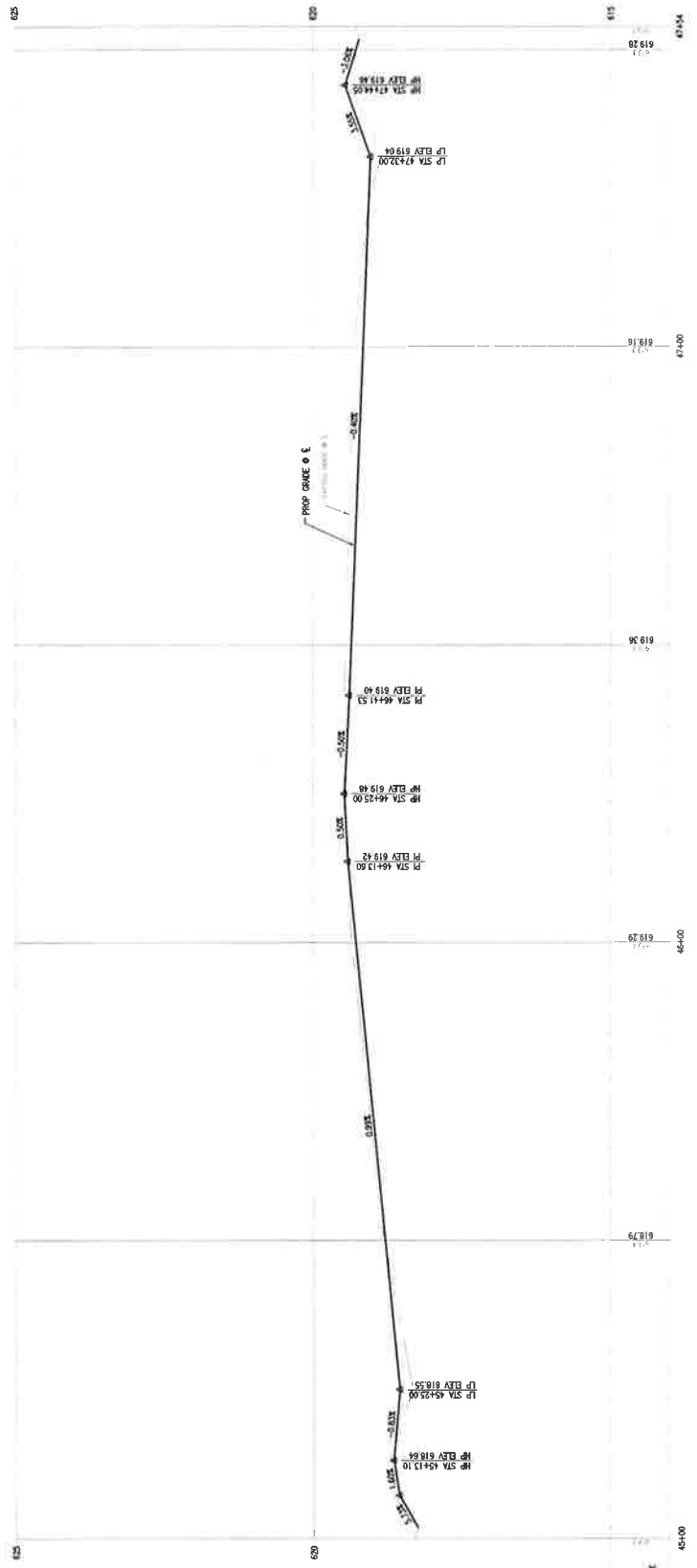
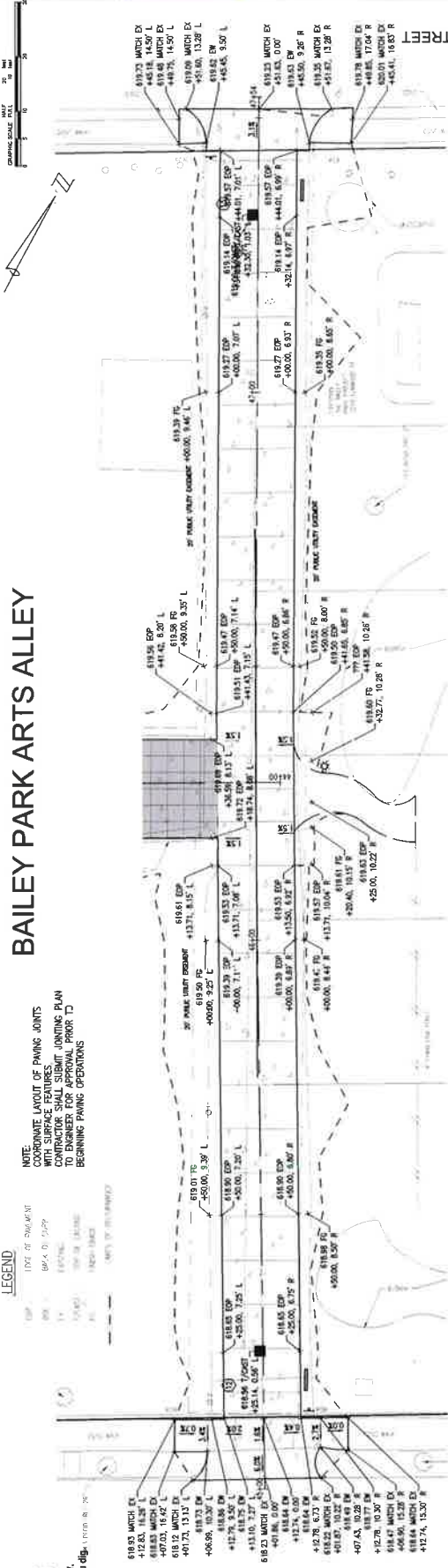

REVISION	DATE

PROJECT NUMBER: 14
 SHEET: 2/4
 CITY OF DETROIT
 ARTS ALLEY - PHASE II
 BAILEY PARK
 GRADING PLAN

C11



Know what's below.
Call before you dig.

BAILEY PARK ARTS ALLEY

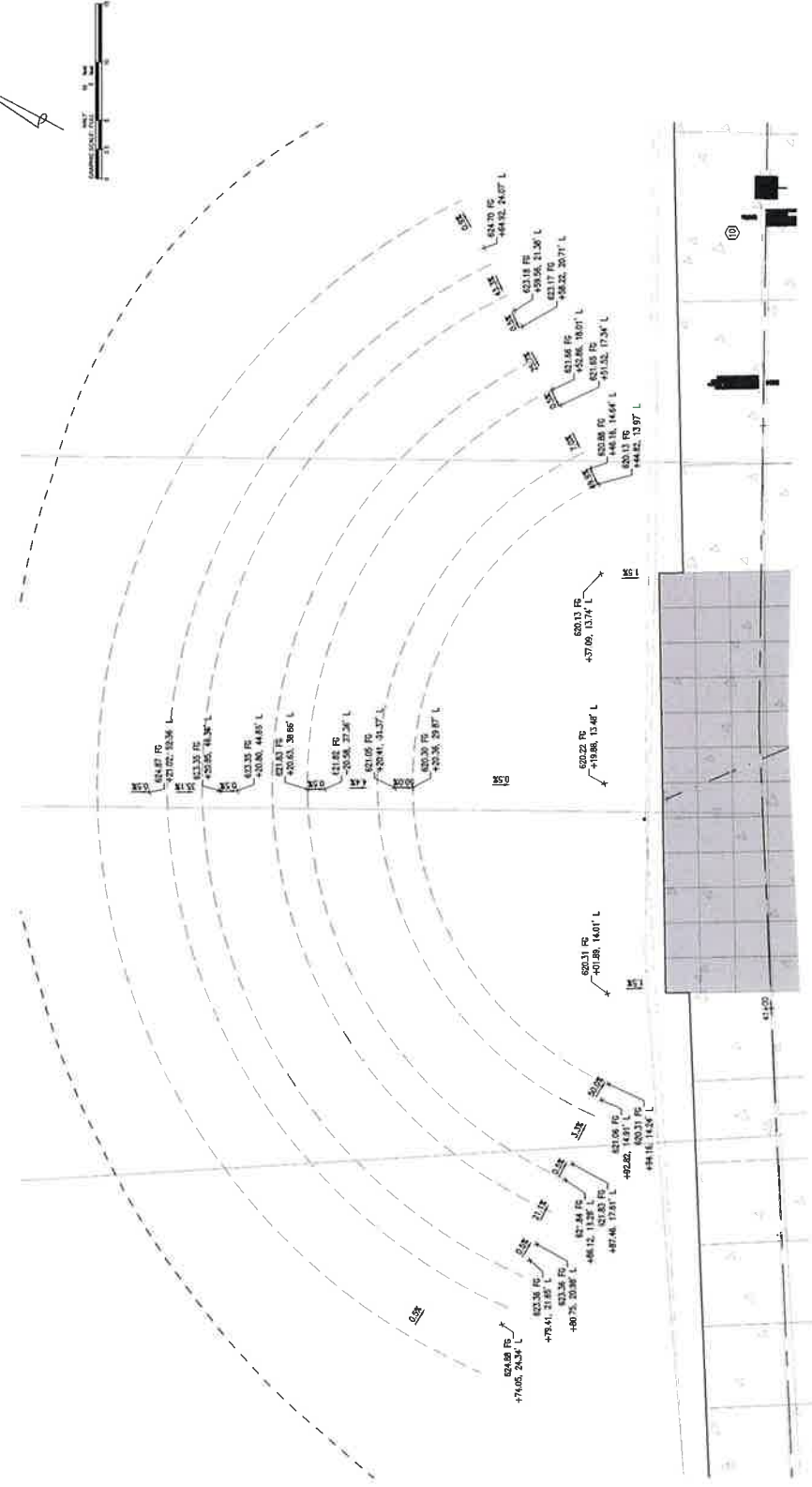

LEGEND

- 5/0" EDGE OF PAVING
- 5/0" BACK OF CURB
- 1/4" CURB
- 1/0" TOP OF CURB
- 1/0" FINISH GRADE
- 1" FINISH OF PAVING

NOTE:
COORDINATE LAYOUT OF PAVING JOINTS
WITH SURFACE FEATURES.
CONTRACTOR SHALL SUBMIT JOINING PLAN
TO SHOW HOW SURFACE FEATURES
BEGINNING PAVING OPERATIONS

02 STANDARD-DUTY CONCRETE ALLEY PAVEMENT
NET TO S&E

IF NON-REINFORCED
CONCRETE PAVEMENT
7' X 10' SURFACE AREA
EXISTING SURFACE
UNDERLAY AS NEEDED

03 COMMUNITY MUSEUM BOLLARD WOOD POST DIRECT BURIAL
NET TO S&E

PRODUCT INFORMATION:
MANUFACTURER: RELIANCE FOUNDRY
MODEL: R-7561 (REMOVABLE ANCHOR)
COLOR: CASTING IN NEW CONCRETE
FINISH: POLYESTER POWDERCOATED
INSTALLATION: REMOVABLE ANCHOR CASTING IN NEW CONCRETE
TEL: 877-786-3345
WWW.RELIANCE-FOUNDRY.COM

05 CAST IRON DECORATIVE BOLLARD REMOVABLE
NET TO S&E

PRODUCT INFORMATION:
MANUFACTURER: RELIANCE FOUNDRY
MODEL: R-7561 (REMOVABLE ANCHOR)
COLOR: CASTING IN NEW CONCRETE
FINISH: POLYESTER POWDERCOATED
INSTALLATION: REMOVABLE ANCHOR CASTING IN NEW CONCRETE
TEL: 877-786-3345
WWW.RELIANCE-FOUNDRY.COM

06 ARTS ALLEY STANDARD SIGN WOOD POST DIRECT BURIAL
NET TO S&E

NOTE:
1. STORAGE PLACEMENT SHALL BE AS SHOWN IN CONTRACTOR TO APPLY 2 COATS OF WOOD PRESERVATIVE TO ALL EXPOSED SURFACES AFTER ALL DETAILS ARE INSTALLED. USE GREEN PRODUCTS CO. COPPER-GREEN WOOD PRESERVATIVE FOR ALL DETAILS. FOLLOW MANUFACTURER'S INSTRUCTIONS FOR APPLICATION AND DRYING. CONTRACTOR TO PRIME TO APPLICATION. FINISH AND ASSEMBLY SHALL BE IN ACCORDANCE WITH THE DRAWINGS FOR REVIEW AND APPROVAL PRIOR TO FABRICATION AND INSTALLATION. CONTRACTOR TO VERIFY ORIENTATION OF SIGN PLACEMENT. REPRESENTATIVE PRIOR TO PLACEMENT.

07 ARTS ALLEY STANDARD SIGN WOOD POST DIRECT BURIAL
NET TO S&E

NOTE:
1. STORAGE PLACEMENT SHALL BE AS SHOWN IN CONTRACTOR TO APPLY 2 COATS OF WOOD PRESERVATIVE TO ALL EXPOSED SURFACES AFTER ALL DETAILS ARE INSTALLED. USE GREEN PRODUCTS CO. COPPER-GREEN WOOD PRESERVATIVE FOR ALL DETAILS. FOLLOW MANUFACTURER'S INSTRUCTIONS FOR APPLICATION AND DRYING. CONTRACTOR TO PRIME TO APPLICATION. FINISH AND ASSEMBLY SHALL BE IN ACCORDANCE WITH THE DRAWINGS FOR REVIEW AND APPROVAL PRIOR TO FABRICATION AND INSTALLATION. CONTRACTOR TO VERIFY ORIENTATION OF SIGN PLACEMENT. REPRESENTATIVE PRIOR TO PLACEMENT.

08 ARTS ALLEY STANDARD SIGN WOOD POST DIRECT BURIAL
NET TO S&E

NOTE:
1. STORAGE PLACEMENT SHALL BE AS SHOWN IN CONTRACTOR TO APPLY 2 COATS OF WOOD PRESERVATIVE TO ALL EXPOSED SURFACES AFTER ALL DETAILS ARE INSTALLED. USE GREEN PRODUCTS CO. COPPER-GREEN WOOD PRESERVATIVE FOR ALL DETAILS. FOLLOW MANUFACTURER'S INSTRUCTIONS FOR APPLICATION AND DRYING. CONTRACTOR TO PRIME TO APPLICATION. FINISH AND ASSEMBLY SHALL BE IN ACCORDANCE WITH THE DRAWINGS FOR REVIEW AND APPROVAL PRIOR TO FABRICATION AND INSTALLATION. CONTRACTOR TO VERIFY ORIENTATION OF SIGN PLACEMENT. REPRESENTATIVE PRIOR TO PLACEMENT.

09 ARTS ALLEY STANDARD SIGN WOOD POST DIRECT BURIAL
NET TO S&E

NOTE:
1. STORAGE PLACEMENT SHALL BE AS SHOWN IN CONTRACTOR TO APPLY 2 COATS OF WOOD PRESERVATIVE TO ALL EXPOSED SURFACES AFTER ALL DETAILS ARE INSTALLED. USE GREEN PRODUCTS CO. COPPER-GREEN WOOD PRESERVATIVE FOR ALL DETAILS. FOLLOW MANUFACTURER'S INSTRUCTIONS FOR APPLICATION AND DRYING. CONTRACTOR TO PRIME TO APPLICATION. FINISH AND ASSEMBLY SHALL BE IN ACCORDANCE WITH THE DRAWINGS FOR REVIEW AND APPROVAL PRIOR TO FABRICATION AND INSTALLATION. CONTRACTOR TO VERIFY ORIENTATION OF SIGN PLACEMENT. REPRESENTATIVE PRIOR TO PLACEMENT.

10 ARTS ALLEY STANDARD SIGN WOOD POST DIRECT BURIAL
NET TO S&E

NOTE:
1. STORAGE PLACEMENT SHALL BE AS SHOWN IN CONTRACTOR TO APPLY 2 COATS OF WOOD PRESERVATIVE TO ALL EXPOSED SURFACES AFTER ALL DETAILS ARE INSTALLED. USE GREEN PRODUCTS CO. COPPER-GREEN WOOD PRESERVATIVE FOR ALL DETAILS. FOLLOW MANUFACTURER'S INSTRUCTIONS FOR APPLICATION AND DRYING. CONTRACTOR TO PRIME TO APPLICATION. FINISH AND ASSEMBLY SHALL BE IN ACCORDANCE WITH THE DRAWINGS FOR REVIEW AND APPROVAL PRIOR TO FABRICATION AND INSTALLATION. CONTRACTOR TO VERIFY ORIENTATION OF SIGN PLACEMENT. REPRESENTATIVE PRIOR TO PLACEMENT.

1. 6" X 6" (NOM) GROUND CONTACT, PRESSURE TREATED S-P-F TIMBER
2. 45 DEGREE CUT ALONG ONE SIDE OF POST AND 45 DEGREE CUT POST AFTER INSTALLATION
3. EXISTING SUBGRADE
4. 1-1/2" X 1-1/2" X 7" BLACKENED STEEL ANGLE BRACKET WITH BOLT HOLES TO RECEIVE 1/2" X 1/2" X 1/2" ANGLE BRACKET AND SURFACE MOUNTING DISPLAY SIGN. ANGLE BRACKET ATTACHMENT AND SURFACE MOUNTING DISPLAY SIGN SHALL BE IN ACCORDANCE WITH THE DRAWINGS FOR REVIEW AND APPROVAL PRIOR TO FABRICATION AND INSTALLATION. CONTRACTOR TO VERIFY ORIENTATION OF SIGN PLACEMENT. REPRESENTATIVE PRIOR TO PLACEMENT.
5. 1-1/2" X 1-1/2" X 7" BLACKENED STEEL ANGLE BRACKET WITH BOLT HOLES TO RECEIVE 1/2" X 1/2" X 1/2" ANGLE BRACKET AND SURFACE MOUNTING DISPLAY SIGN. ANGLE BRACKET ATTACHMENT AND SURFACE MOUNTING DISPLAY SIGN SHALL BE IN ACCORDANCE WITH THE DRAWINGS FOR REVIEW AND APPROVAL PRIOR TO FABRICATION AND INSTALLATION. CONTRACTOR TO VERIFY ORIENTATION OF SIGN PLACEMENT. REPRESENTATIVE PRIOR TO PLACEMENT.
6. FINISH GRADE
7. SIGN SHALL ALSO INCLUDE NAME OF ALLEY IN ADA COMPLIANT BRAILLE BELOW ENGLISH ALLEY NAME

1. WALL MOUNTED DISPLAY CASE MODEL: SCB-WPLUS-248
2. DWP EDGE
3. 6" X 6" (NOM) WOOD POST ADJACENT TO DISPLAY CASE. SEE ALLEY WORK SIGN DETAIL FOR MORE INFORMATION
4. 6" X 6" (NOM) WOOD POST
5. 6" X 6" (NOM) WOOD CROSS MEMBER (TOP AND BOTTOM)
6. BREAK RESISTANT ACRYLIC WINDOW
7. FINISH GRADE
8. CONCRETE FOOTING
9. FOOT IN AGGREGATE BASE COMPACTED

1. ALUMINUM PANEL, 1/4" THICK, POWDER COATED TO ACCEPT ANY FINISHED GRAPHIC. COLOR TO BE SELECTED BY ARCHITECT.
2. 1/2" (MIN) GROUND CONTACT, PRESSURE TREATED S-P-F TIMBER
3. ANGLE CUT TOP END OF POST AT DIMENSION SHOWN
4. STEEL SURFACE MOUNT BOLLARD BASE FOR DETAILS TO ACCEPT 6" X 6" SQUARE WOOD POST. SEE STEEL SURFACE MOUNT BOLLARD BASE FOR DETAILS
5. (2) STAINLESS-STEEL THURBOLTS, 1/2" X 7"
6. 1/2" X 1-1/2" X 1-1/2" ANGLE BRACKET WITH 80 TUBES LAG BOLTS WITH WASHERS. OPPOSITE SIDE RIVETTED TO WALL PANEL. POINT AND DWP OF ALUMINUM PANEL.
7. FINISH GRADE
8. CONCRETE FRT. 18" DIA
- 9.

1. WALL MOUNTED DISPLAY CASE MODEL: SCB-WPLUS-248. EXTREME WEATHER SIGNAGE. LOCKING MECHANISM. BREAK RESISTANT WINDOW. FINISH: POLYESTER POWDERCOATED. COLOR: BULLETIN BOARD TURQUOISE. TYPE: FORGED BOARD. THICK: 1/4". WINDOW: BREAK RESISTANT ACRYLIC. INSTALLATION: WALL MOUNTED. WWW.DISPLAY248.COM
1. WALL MOUNTED DISPLAY CASE MODEL: SCB-WPLUS-248
2. DWP EDGE
3. 6" X 6" (NOM) WOOD POST ADJACENT TO DISPLAY CASE. SEE ALLEY WORK SIGN DETAIL FOR MORE INFORMATION
4. 6" X 6" (NOM) WOOD POST
5. 6" X 6" (NOM) WOOD CROSS MEMBER (TOP AND BOTTOM)
6. BREAK RESISTANT ACRYLIC WINDOW
7. FINISH GRADE
8. CONCRETE FOOTING
9. FOOT IN AGGREGATE BASE COMPACTED

1. WALL MOUNTED DISPLAY CASE MODEL: SCB-WPLUS-248. EXTREME WEATHER SIGNAGE. LOCKING MECHANISM. BREAK RESISTANT WINDOW. FINISH: POLYESTER POWDERCOATED. COLOR: BULLETIN BOARD TURQUOISE. TYPE: FORGED BOARD. THICK: 1/4". WINDOW: BREAK RESISTANT ACRYLIC. INSTALLATION: WALL MOUNTED. WWW.DISPLAY248.COM
1. WALL MOUNTED DISPLAY CASE MODEL: SCB-WPLUS-248
2. DWP EDGE
3. 6" X 6" (NOM) WOOD POST ADJACENT TO DISPLAY CASE. SEE ALLEY WORK SIGN DETAIL FOR MORE INFORMATION
4. 6" X 6" (NOM) WOOD POST
5. 6" X 6" (NOM) WOOD CROSS MEMBER (TOP AND BOTTOM)
6. BREAK RESISTANT ACRYLIC WINDOW
7. FINISH GRADE
8. CONCRETE FOOTING
9. FOOT IN AGGREGATE BASE COMPACTED

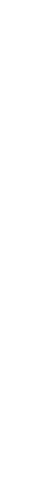
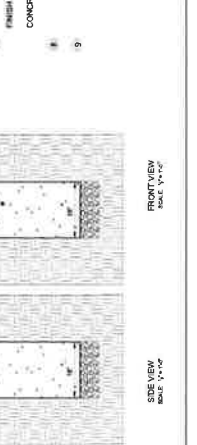
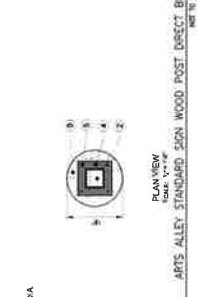
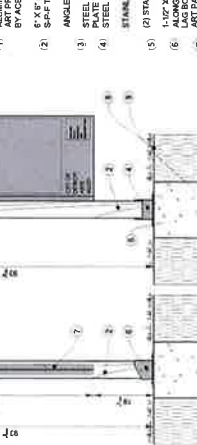
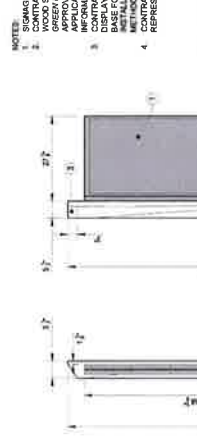
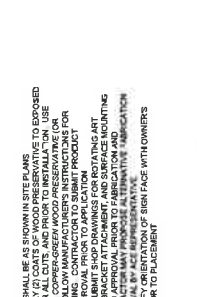
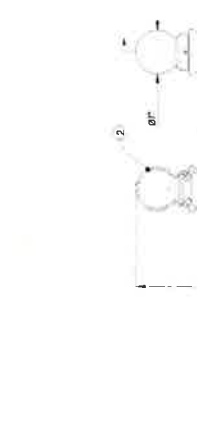
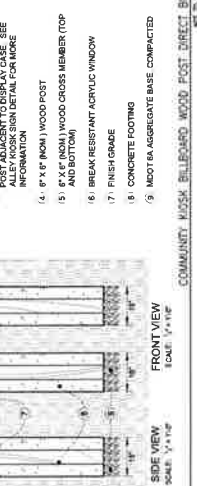



DATE	REVISION	DESCRIPTION

PROJECT NUMBER	PHASE	DATE

C15

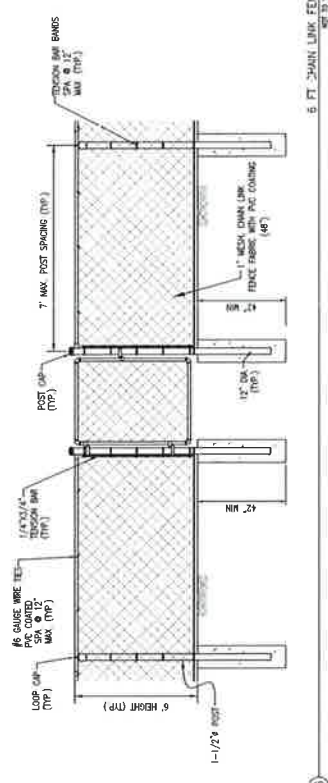
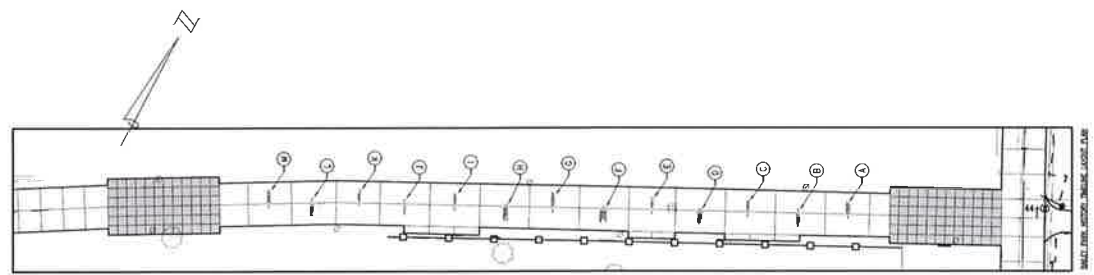

1700s	1800s	1900s	1930s	1960s	1960s
A	B	C	D	E	F
CENTRIES BEFORE LAFAYETTE PARK WAS BUILT, THE AREA WAS KNOWN AS 'SETTLERS BARRED THE AREA AND NAMED IT "BLACK BOTTOM" FOR ITS DARK, FERTILE SOIL.	BLACK BOTTOM WAS HOME TO IMMIGRANTS AND AFRICAN AMERICANS WHO TOOK TO THE AREA FOR ITS DARK, FERTILE SOIL.	AFRICAN AMERICANS MOVED NORTH TO DETROIT FOR JOBS DURING ITS INDUSTRIAL GROWTH.	PARADISE VALLEY (THE AFRICAN AMERICAN BUSINESS AND ENTERTAINMENT DISTRICT ADJACENT TO BLACK BOTTOM) BECAME A NIGHTLIFE HUB.	LAFAYETTE PARK AND 1375 REPLACED BLACK BOTTOM.	AFRICAN AMERICAN FAMILIES FROM BLACK BOTTOM MOVED TO THE MCKONIGHT/JUNIOR NEIGHBORHOOD WHERE YOU NOW STAND.
1930s	1960s	1960s	1960s	1960s	1960s
G	H	I	J	K	L
BLACK BOTTOM HAD THE HIGHEST CONCENTRATION OF AFRICAN AMERICANS IN DETROIT.	BLACK BOTTOM BECAME ONE OF THE MOST VIBRANT AFRICAN AMERICAN NEIGHBORHOODS IN DETROIT, ESPECIALLY ALONG HASTINGS STREET.	WITHIN 10 YEARS BLACK BOTTOM WAS GONE.	MANY WERE FORCED BY DISCRIMINATORY HOUSING PRACTICES TO SETTLE IN BLACK BOTTOM.	PARADISE VALLEY LURED FAMOUS JAZZ ENTERTAINERS TO PERFORM IN ITS NIGHTCLUBS AND THEATRES.	
1950s	2024				
M	N				
URBAN REDEVELOPMENT PROJECTS BEGAN DESTROYING BLACK BOTTOM, DISPLACING 140,000 RESIDENTS.	LAFAYETTE PARK AND 1375 REMAIN THE ONLY REMAINING PORTION OF PARADISE VALLEY NOW KNOWN AS COMERICA PARK AND FORD FIELD.				

MISCELLANEOUS DETAILS
BAILEY PARK
ARTS ALLEY - PHASE II
CITY OF DETROIT



livingLAB



REVISION	DATE	DESCRIPTION

PROJECT NUMBER: 000
 DRAWING TITLE: ALLEY DRIVEWAY
 CITY OF DETROIT
 ARTS ALLEY - PHASE II
 RALPH PARK
 MISCELLANEOUS DETAILS

C16

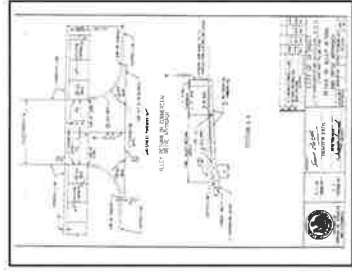
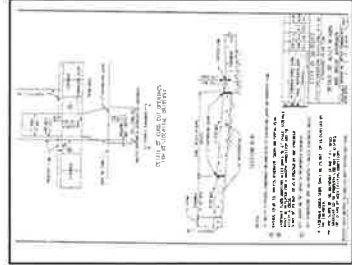
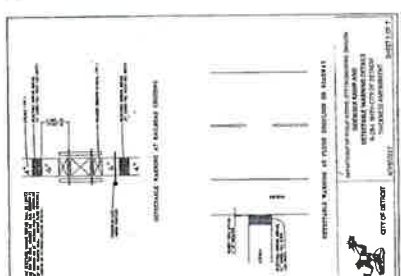
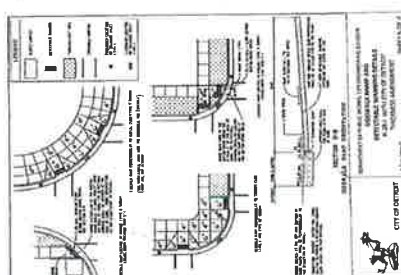
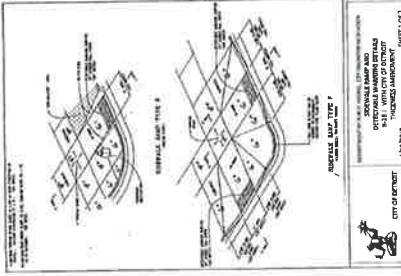
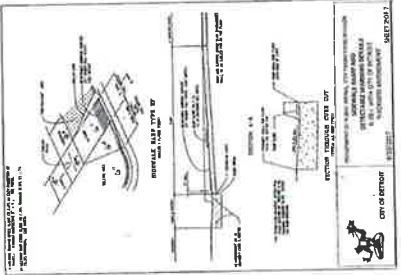
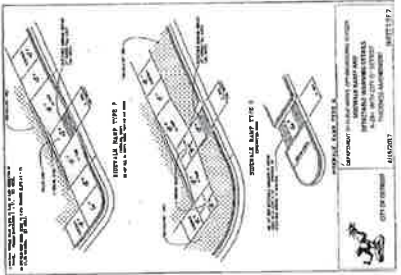
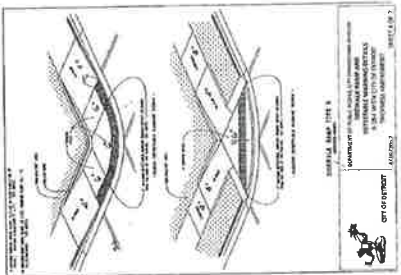

SIDEWALK - 000

01

ALLEY DRIVEWAY - 000

02

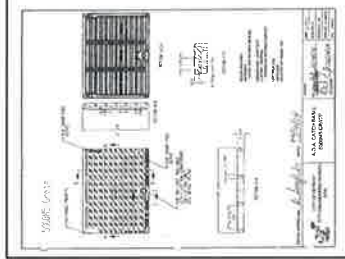
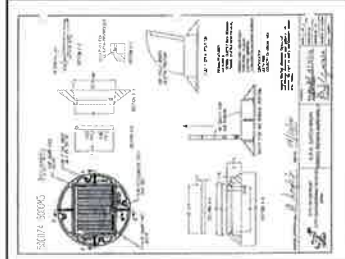

CATCH BASIN COVER - ADA
NOT TO SCALE

TRAPPED CATCH BASIN
NOT TO SCALE

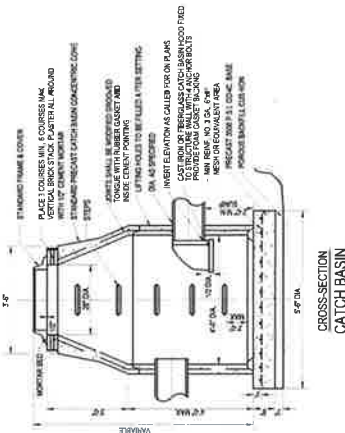

MANHOLE CASTING
NOT TO SCALE

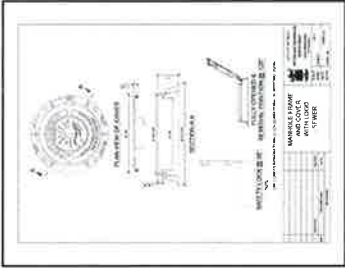

MANHOLE PRECAST
NOT TO SCALE

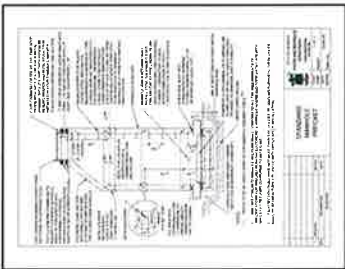

MANHOLE PRECAST
NOT TO SCALE



METER ON POLE
NOT TO SCALE

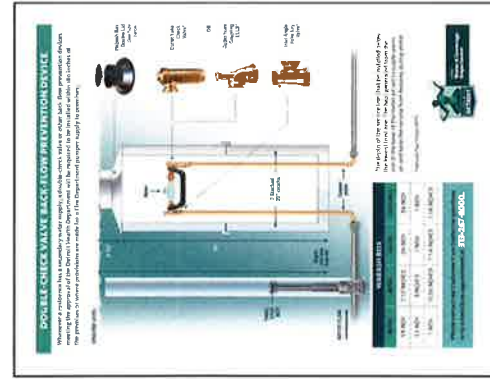
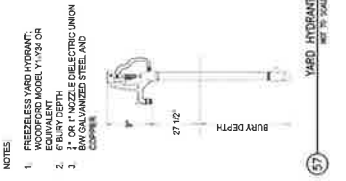

METER PIT DETAIL
NOT TO SCALE

WATER SERVICE CONNECTION
NOT TO SCALE

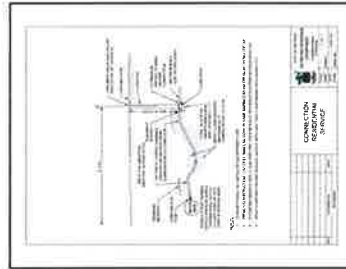

SANITARY TRENCH
NOT TO SCALE

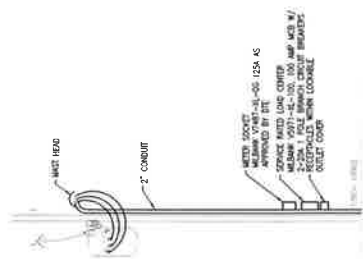
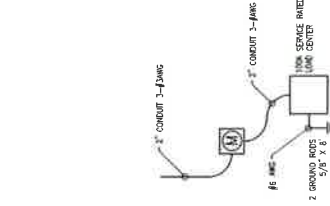
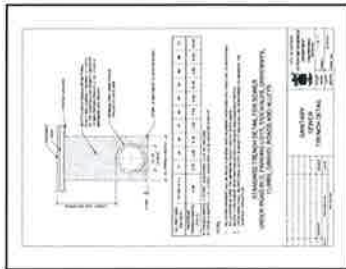

SERVICE ENTRANCE WIRING DETAIL
NOT TO SCALE

SERVICE ENTRANCE DETAIL
NOT TO SCALE