

WESTMINSTER AVE. 50 FT. WD.

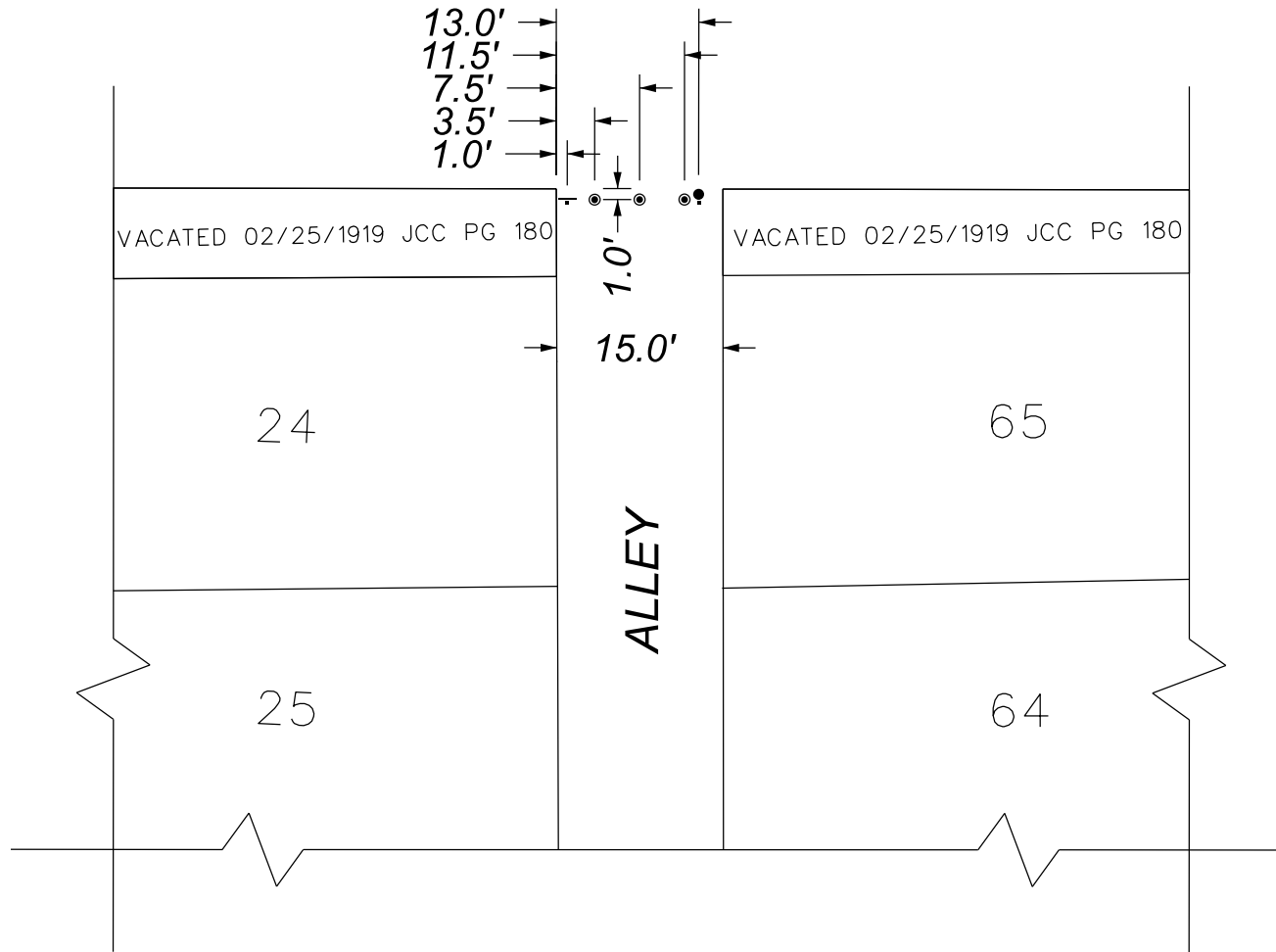

WESTMINSTER AVE.

OAKLAND AVE.

GOODWIN AVE.

24	65
26	63
28	61
30	59
32	57
34	55
36	53
38	51
40	49
42	47
44	45
1	51
3	49
5	47
6	46

OWEN AVE.

- - PET WASTE STATION (IN-GROUND)
- - ARTS ALLEY STANDARD SIGN (SURFACE MOUNT)
- ⊙ - CAST IRON DECORATIVE BOLLARD (SURFACE MOUNT - REMOVABLE)

(FOR OFFICE USE ONLY)

CARTO 42 C / 42 D

B					
A					
DESCRIPTION	DRWN	CHKD	APPD	DATE	
REVISIONS					
DRAWN BY	TS	CHECKED	AP/LC		
DATE	05-30-2024	APPROVED	RW		

REQUEST ENCROACHMENT INTO
THE NORTH/SOUTH ALLEY, 15 FT. WD.
IN THE BLOCK BOUNDED BY
GOODWIN AVE., OWEN AVE., OAKLAND AVE.,
AND WESTMINSTER AVE.

CITY OF DETROIT
CITY ENGINEERING DIVISION
SURVEY BUREAU

JOB NO. 24-17

DRWG. NO. 04