

WESTMINSTER AVE. 50 FT. WD.



→ ← 15'

OAKLAND AVE. 66 FT. WD.

GOODWIN AVE. 50 FT. WD.

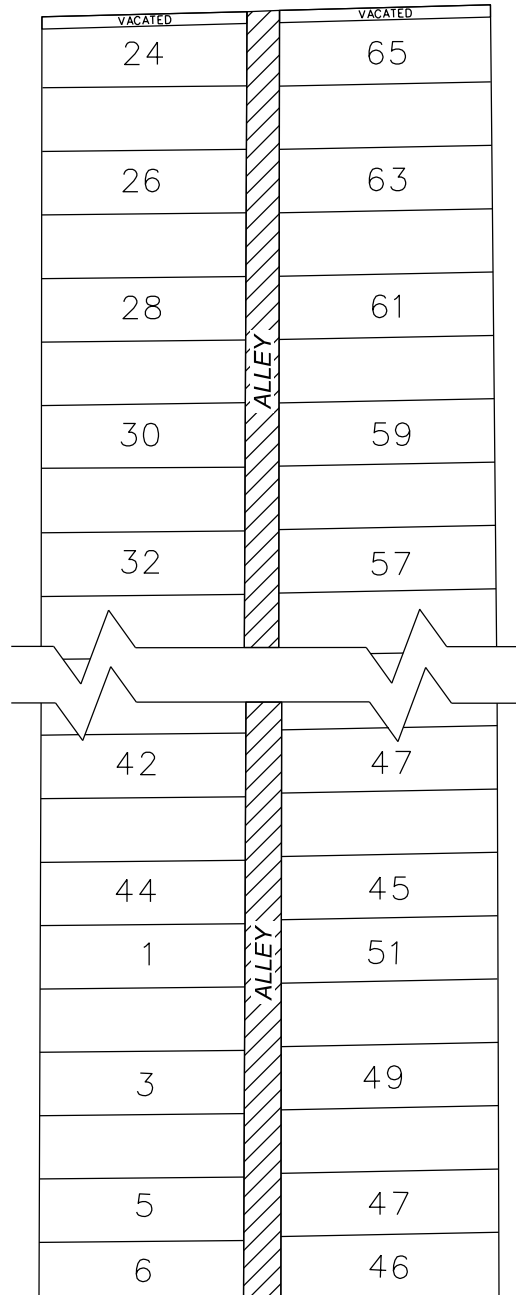

OWEN AVE. 60 FT. WD.



- REQUEST ENCROACHMENT
(NEW CONCRETE PAVEMENT, BOLLARDS, SIGNS, PET STATIONS,
AND ASSOCIATED WATER/POWER INFRASTRUCTURE IMPROVEMENTS)

(FOR OFFICE USE ONLY)

CARTO 42 C / 42 D

B					
A					
DESCRIPTION	DRWN	CHKD	APPD	DATE	
REVISIONS					
DRAWN BY	TS	CHECKED	AP/LC		
DATE	05-30-2024	APPROVED	RW		

REQUEST ENCROACHMENT INTO
THE NORTH/SOUTH ALLEY, 15 FT. WD.
IN THE BLOCK BOUNDED BY
GOODWIN AVE., OWEN AVE., OAKLAND AVE.,
AND WESTMINSTER AVE.

CITY OF DETROIT
CITY ENGINEERING DIVISION

SURVEY BUREAU

JOB NO. 24-17

DRWG. NO. 01