

GENERAL NOTES:

1. CONTRACTOR RESPONSIBLE FOR CONTACTING ALL UTILITIES IN THE RIGHT OF WAY WORK AREA. DO NOT PROCEED W/ RIGHT-OF-WAY WORK UNTIL THE APPROPRIATE APPROVALS ARE GRANTED.

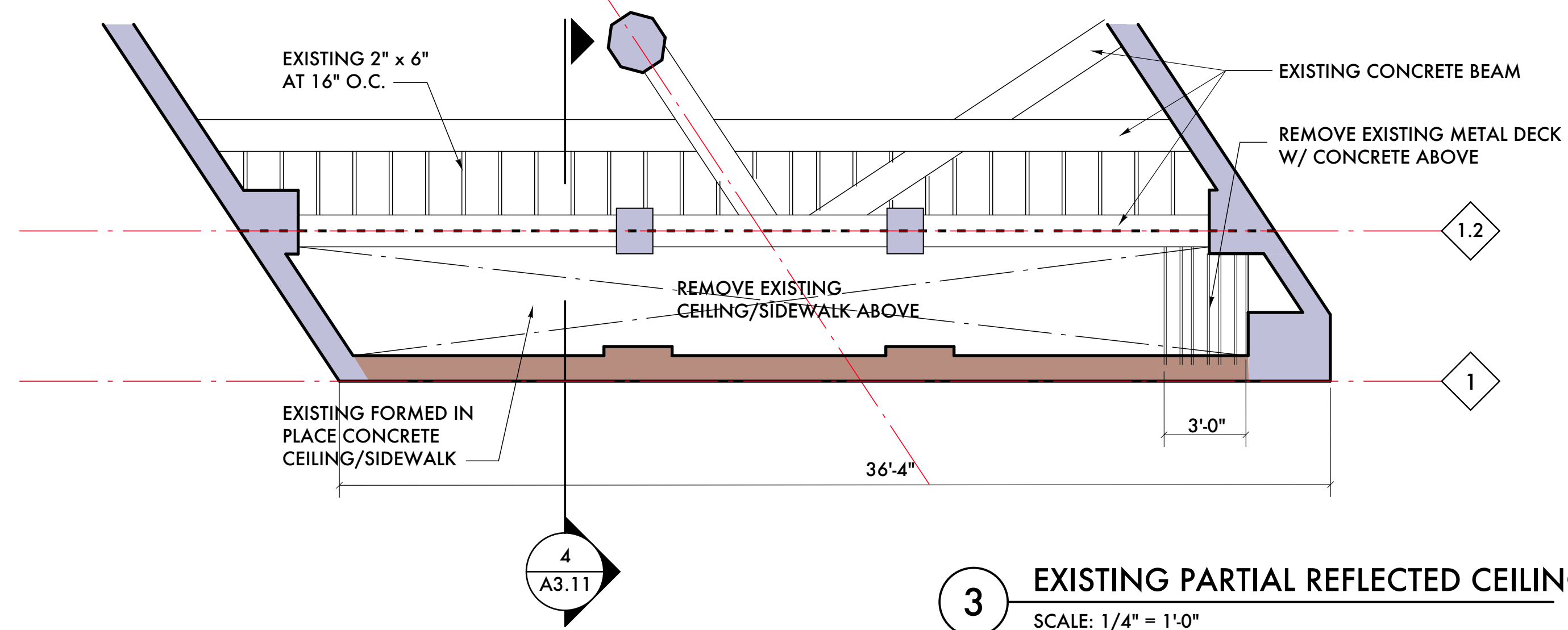

3 EXISTING PARTIAL REFLECTED CEILING PLAN
SCALE: 1/4" = 1'-0"

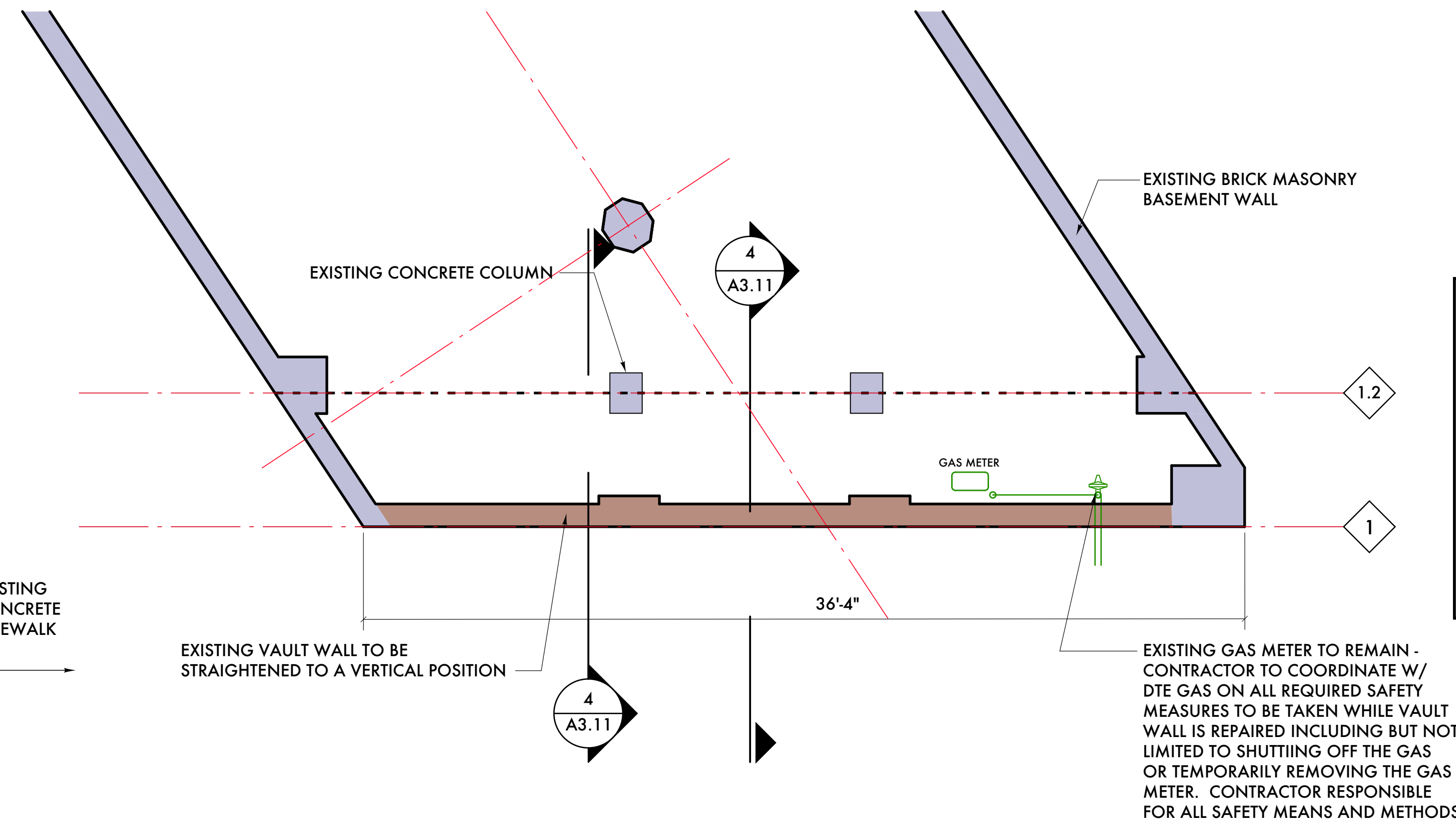

1 EXISTING PARTIAL BASEMENT PLAN
SCALE: 1/4" = 1'-0"

RIGHT OF WAY ENCROACHMENT:

1. THE ENCROACHMENT UNDERGROUND IS AN EXISTING ENCROACHMENT THAT HAS EXISTED SINCE THE BUILDING WAS CONSTRUCTED IN 1914.
2. THE SCOPE OF WORK IS TO REPAIR THE EXISTING BASEMENT VAULT WALL WHICH IS OUT OF PLUMB AND TO INSTALL A NEW CEILING ON THE EXISTING VAULT SPACE.

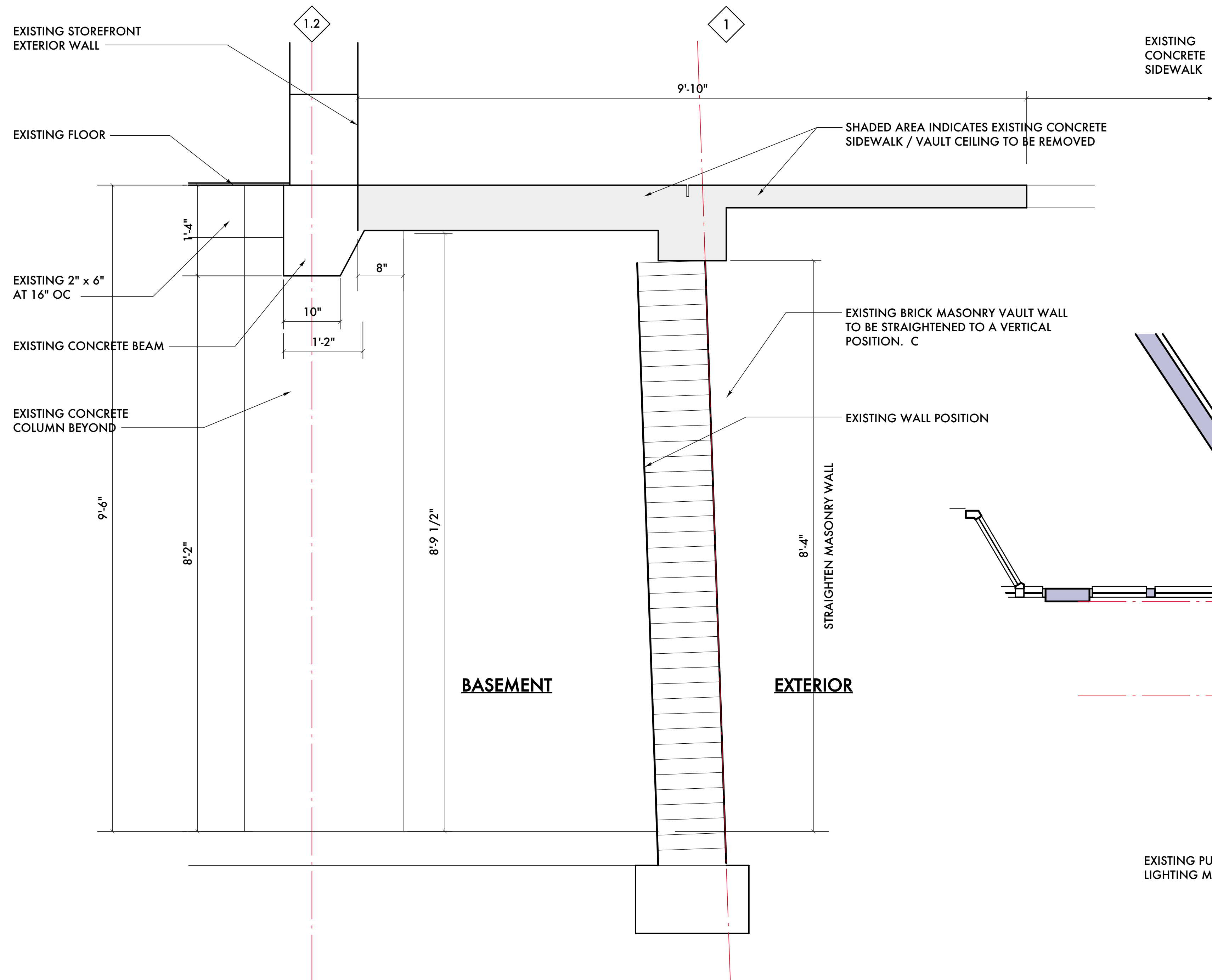

4 EXISTING SECTION AT VAULT
SCALE: 1" = 1'-0"

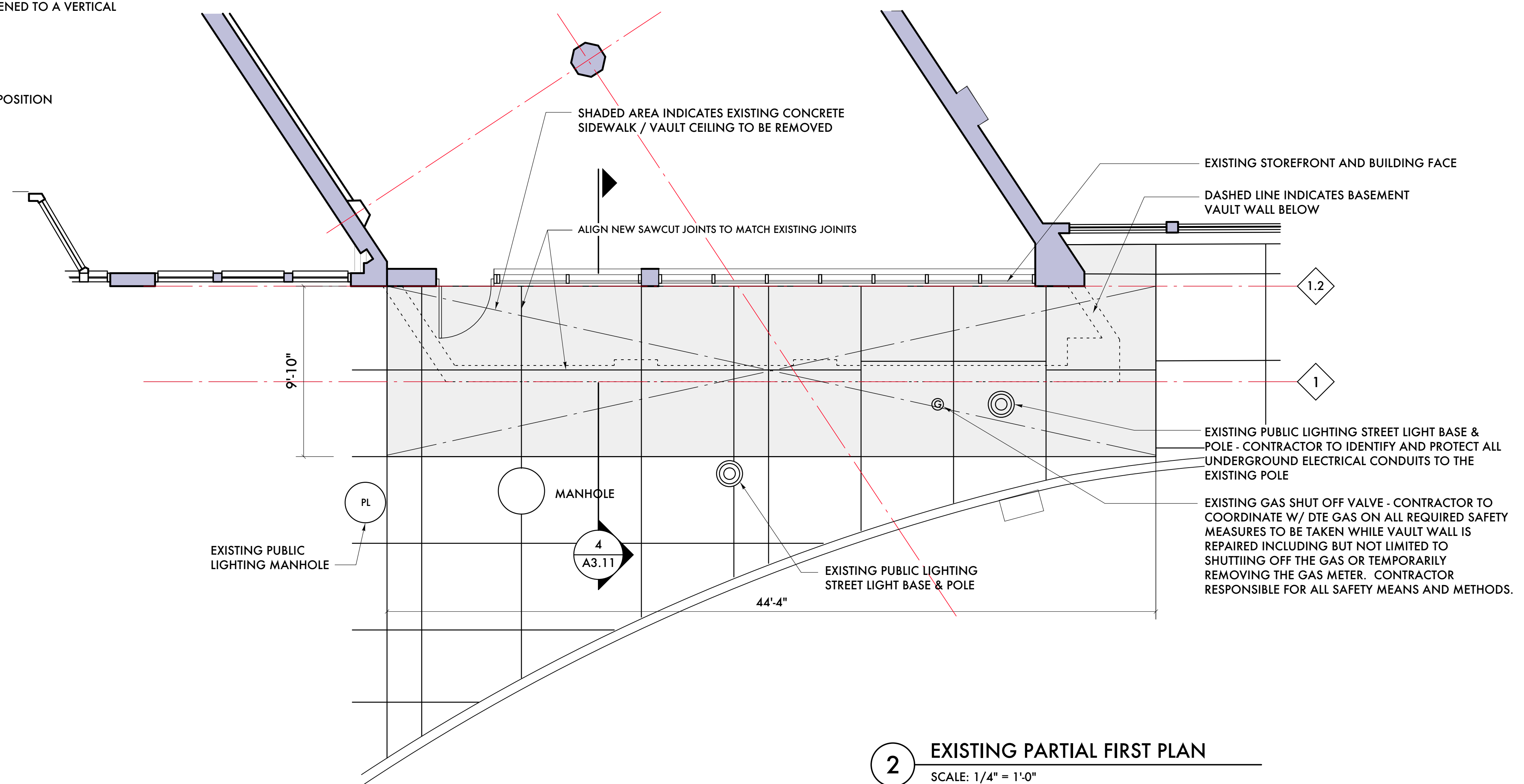

2 EXISTING PARTIAL FIRST PLAN
SCALE: 1/4" = 1'-0"



10/12/23 ADD #2 - Encroachment Permit
09/16/23 Owner Review
Date: Issued For:

Sidewalk Vault Repair

1427 Randolph Street
Detroit, Michigan 48226

studioONE : DETROIT

architectural
urban
interior DESIGN

350 Madison Avenue
4th Floor
Detroit, Michigan 48226
studioonedetroit.com
313.549.3790 (t)
jpb@ware-house.com

Project Number: 2023

Sheet Title:

EXISTING & DEMOLITION PARTIAL BASEMENT, 1ST FLOOR PLAN

Sheet Number:

S3.01