

**LEGEND:**

	CONCRETE PAVEMENT
	ASPHALT PAVEMENT
	GRAVEL
	WETLAND
	CONCRETE CURB AND GUTTER
	REVERSE GUTTER PAN
	SETBACK LINE
	SIGN LIGHTPOLE FENCE GUARD RAIL

- GENERAL NOTES:**
- THESE NOTES APPLY TO ALL CONSTRUCTION ACTIVITIES ON THIS PROJECT.
- ALL DIMENSIONS SHOWN ARE TO BACK OF CURB, FACE OF SIDEWALK, OUTSIDE FACE OF BUILDING, PROPERTY LINE, CENTER OF MANHOLE/CATCH BASIN OR CENTERLINE OF PIPE UNLESS OTHERWISE NOTED.
  - NO PARKING-FIRE LANE SIGNS SHALL BE POSTED ALONG ALL FIRE LANES AT 100' FOOT INTERVALS OR AS DIRECTED BY THE FIRE OFFICIAL.
  - REFER TO NOTES & DETAILS SHEET FOR ON-SITE PAVING DETAILS.
  - REFER TO NOTES & DETAILS SHEET FOR ON-SITE SIDEWALK RAMP DETAILS.

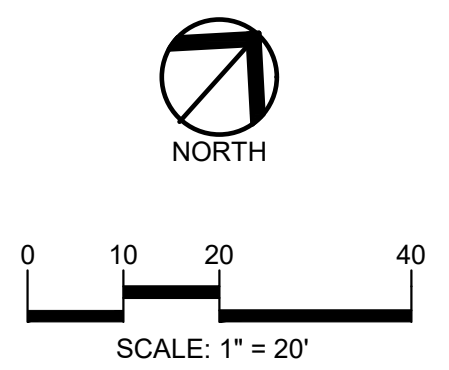

**SIDEWALK RAMP LEGEND:**

SIDEWALK RAMP TYPE R	Ⓡ	NO PARKING FIRE LANE SIGN	1
SIDEWALK RAMP TYPE F	Ⓢ	'STOP' SIGN	2
SIDEWALK RAMP TYPE P	Ⓟ	'BARRIER FREE PARKING' SIGN	3
SIDEWALK RAMP TYPE C	Ⓢ	'VAN ACCESSIBLE' SIGN	4
SIDEWALK RAMP TYPE D	Ⓣ	'CROSSWALK' SIGN	5
CURB DROP ONLY	Ⓧ	'DO NOT ENTER' SIGN	6
REFER TO LATEST MDOT R-28 STANDARD RAMP AND DETECTABLE WARNING DETAILS		'SIDEWALK ENDS' SIGN	7
		'NO PARKING LOADING ZONE' SIGN	8

REFER TO DETAIL SHEET FOR SIGN DETAILS



**CAUTION!!**  
THE LOCATIONS AND ELEVATIONS OF EXISTING UNDERGROUND UTILITIES AS SHOWN ON THIS DRAWING ARE ONLY APPROXIMATE. NO GUARANTEE IS EITHER EXPRESSED OR IMPLIED AS TO THE COMPLETENESS OR ACCURACY THEREOF. THE CONTRACTOR SHALL BE EXCLUSIVELY RESPONSIBLE FOR DETERMINING THE EXACT UTILITY LOCATIONS AND ELEVATIONS PRIOR TO THE START OF CONSTRUCTION.

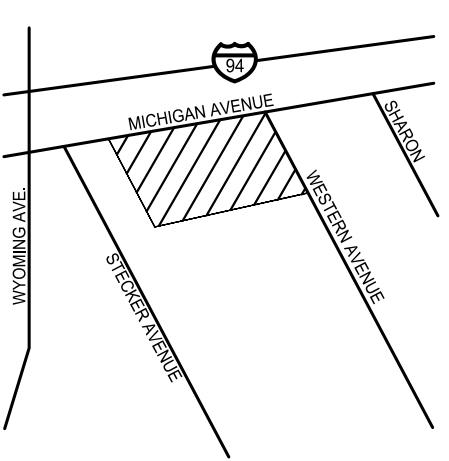

CLIENT  
**THE COLLABORATIVE**  
206 S. MAIN STREET, SUITE 231  
ANN ARBOR, MICHIGAN 48104

PROJECT TITLE  
**SER METRO DETROIT - YOUTH REENGAGEMENT CENTER**  
9215 MICHIGAN AVENUE  
CITY OF DETROIT, WAYNE COUNTY, MICHIGAN

**REVISIONS**

DESIGN DEVELOPMENT	4/14/2022
SITE PLAN REVIEW	5/25/2022
50% CDs	8/2/2022

ORIGINAL ISSUE DATE:  
APRIL 4, 2022

DRAWING TITLE  
**PRELIMINARY SITE PLAN**

PEA JOB NO.	2021-0460
P.M.	TD
DN.	BSH
DES.	BSH
DRAWING NUMBER:	

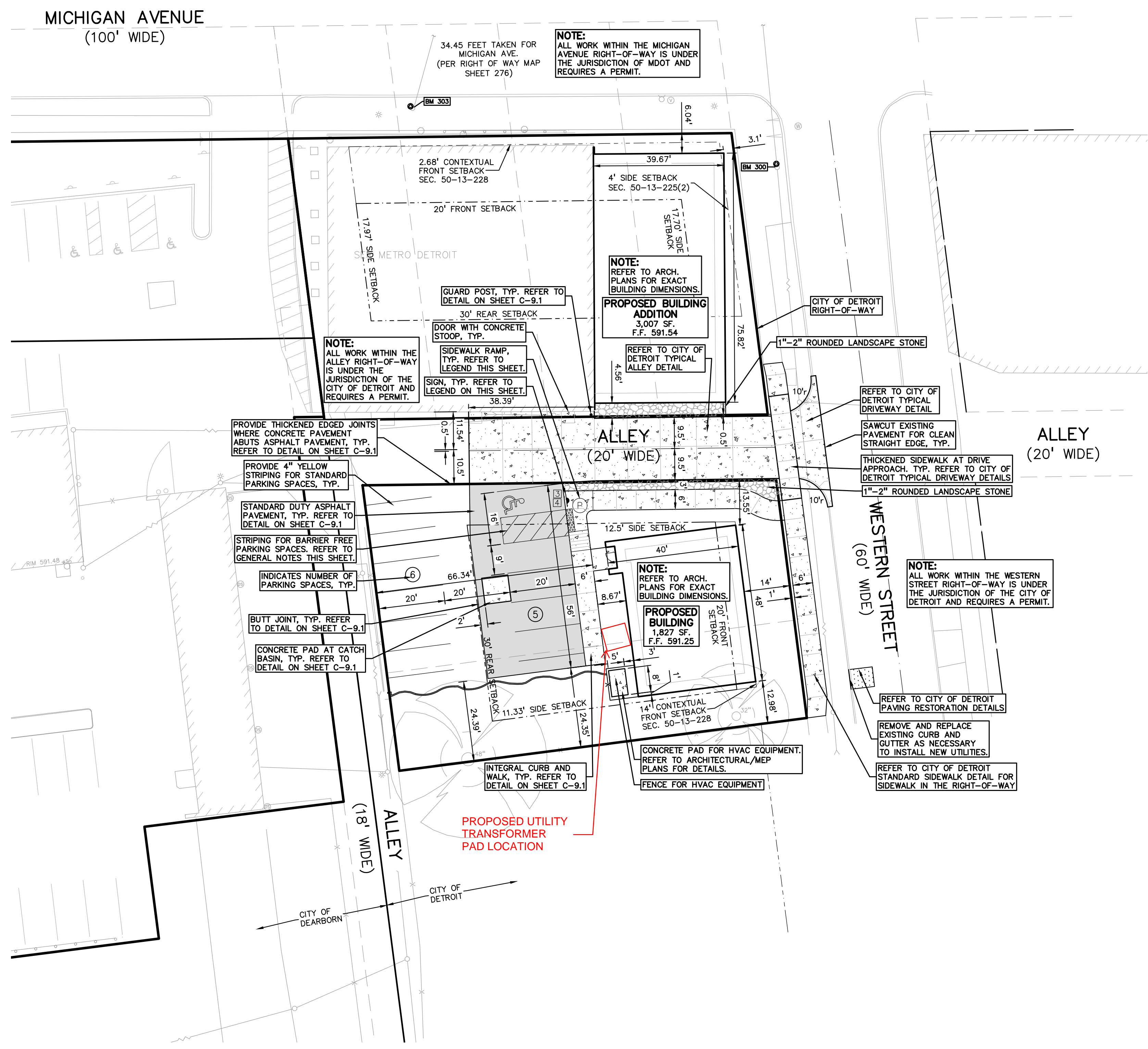

s:\PROJECTS\2021\2021-0460\_ser metro detroit\DMO\construction\C-3.0(04-21-2022).dwg