

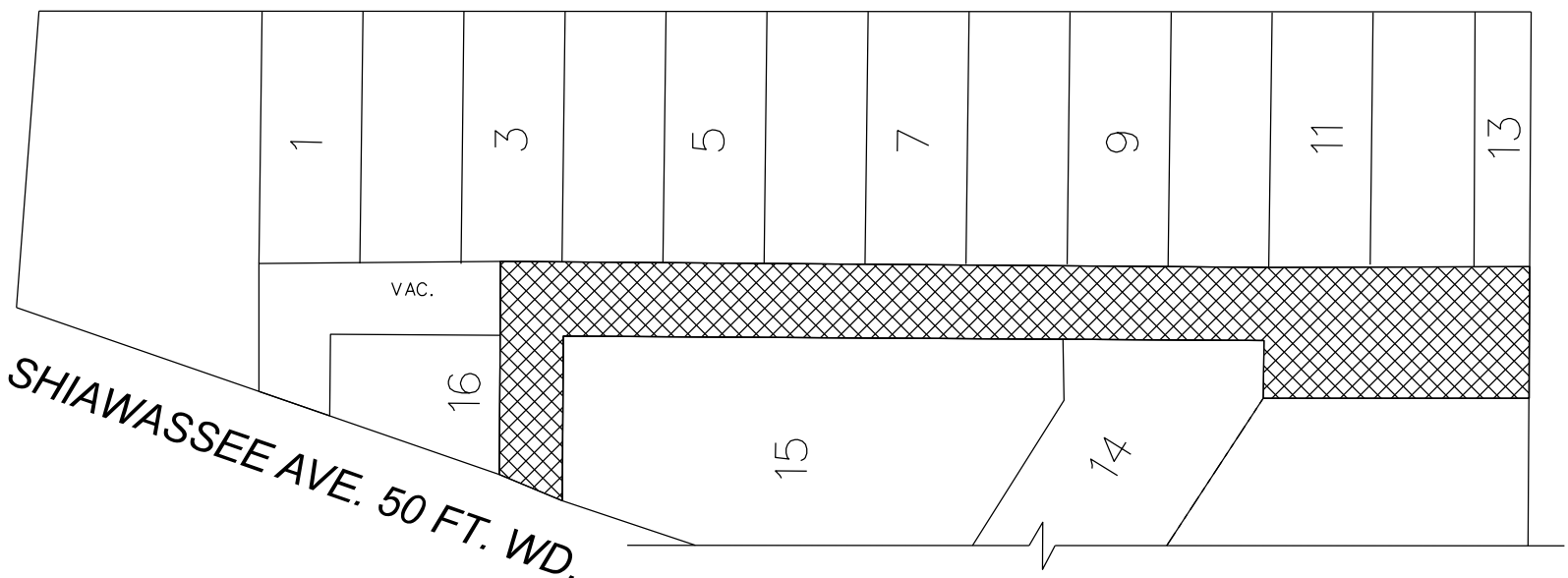

GRANDVIEW AVE. 60 FT. WD.

8 MILE RD. 204 FT. WD.



SHIAWASSEE AVE. 50 FT. WD.

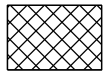

- REQUEST TEMPORARY CLOSURE

(FOR OFFICE USE ONLY)

CARTO 123 C

REQUEST TEMPORARY CLOSURE OF ALLEYS  
BOUNDED BY W. 8 MILE RD., GRANDVIEW AVE.,  
AND SHIAWASSEE AVE.

CITY OF DETROIT  
CITY ENGINEERING DIVISION  
SURVEY BUREAU

JOB NO. 23-95

DRWG. NO.

B					
A					
DESCRIPTION	DRWN	CHKD	APPD	DATE	
REVISIONS					
DRAWN BY	LC	CHECKED	AP		
DATE	09-28-2023	APPROVED	JD		