

City of Detroit

Janice M. Winfrey
City Clerk

OFFICE OF THE CITY CLERK

Andre P. Gilbert II
Deputy City Clerk

DEPARTMENT PETITION REFERENCE COMMUNICATION

To: The Department or Commission Listed Below

From: Janice M Winfrey, Detroit City Clerk

The following petition is herewith referred to you for report and recommendation to the City Council.

In accordance with that body's directive, kindly return the same with your report in duplicate within four (4) weeks.

Petition No.	2023-325
Name of Petitioner	Beverly Rodgers
Description of Petition	Petition to vacate, with reserve of a public utility easement, the east-west public alley bounded by Burlingame Street, Rosa Parks Blvd, Lawrence Street, and 14th Street.
Type of Petition	Alley Vacation/Encroachment/Utility Vacation
Submission Date	9/11/2023
Concerned Departments	Department of Public Works, Planning and Development Department, City Engineering Division
Petitioner Contact	Beverly Rodgers 1976 Lawrence Detroit, MI, 48206



**CITY OF DETROIT
DEPARTMENT OF PUBLIC WORKS
CITY ENGINEERING DIVISION**

**COLEMAN A. YOUNG MUNICIPAL CENTER
2 WOODWARD AVE. SUITE 601
DETROIT, MICHIGAN 48226
PHONE: (313) 224-3949 TTY: 711
WWW.DETROITMI.GOV**

**To: Clerk's Office
From: The Department of Public Works
City Engineering Division
MapsandRecordsBureau@DetroitMI.Gov
(313) 224-3970**

**Petitioner:
Beverly Rodgers
1976 Lawrence
Detroit, MI, 48206**

On behalf of the above-mentioned petitioner the Department of Public Works: City Engineering Division is submitting a petition request for the below mentioned action. The petitioner has received a project consultation from the Department of Public Works: City Engineering Division and has been advised the following:

Type of action recommended:

Petition to vacate, with reserve of a public utility easement, the east-west public alley bounded by Burlingame Street, Rosa Parks Blvd, Lawrence Street, and 14th Street.

**Jered Dean
Manager II
Department of Public Works
City Engineering Division
313-224-3985**

Ms. Beverly Rodgers

1976 Lawrence

Detroit, Michigan 48206

RavensRio@gmail.com

June 19, 2023

Detroit City Council
City Council Office 2
2 Woodward Avenue, Suite 1340
Detroit, Michigan 48226

Dear Detroit City Council Members,

My son, Bevan Morrison-Rodgers, the owner of 1976 Lawrence Street, in the city of Detroit, and I, also a resident of 1976 Lawrence, are petitioning the City of Detroit Council to request an easement of the residential alleyway between the streets of Lawrence (northside of the street) and Burlingame (southside of the street). We, as well as my neighbors on Lawrence, would like to take an easement of the alleyway. Bevan and I intend on extending a fence beyond the garage at the rear of our property to midway the alleyway and enclosing the area. The fence would have a gate to allow additional access to utilities if necessary.

I have advised my neighbors on the northside of Lawrence of my intent. They are in agreement and have signed a petition. Currently, most of Burlingame is a vacant lot. I spoke with the owner of the majority of the property who also resides on Lawrence (Cevone Smith) and he is also in agreement with my plans and has signed the petition for all the properties he owns on Lawrence and Burlingame Streets.

Bevan and I respectfully submit this application and petition for your review and consideration.

Thank you,



Ms. Beverly Rodgers
1976 Lawrence
Detroit, MI 48206
RavensRio@gmail.com
313-969-7095

Mr. Bevan Morrison-Rodgers
1976 Lawrence
Detroit, MI 48206
Bevan.MorrisonRodgers23@gmail.com
313-492-9824



BURLINGAME ST. 60 FT. WD.

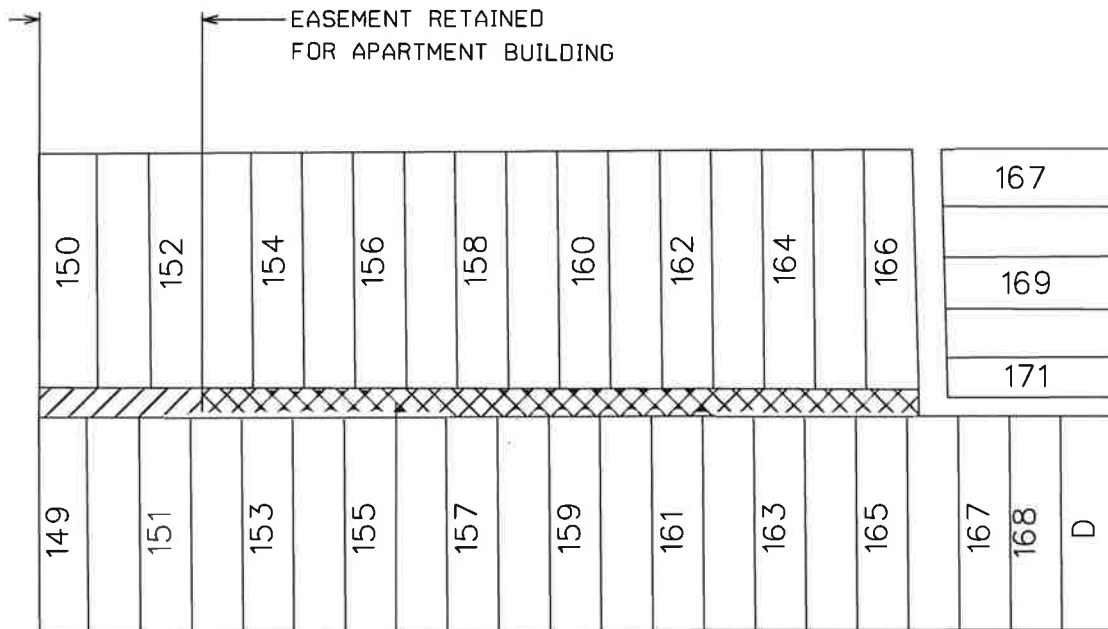

**ROSA PARKS BLVD.
(12TH ST.) 66 FT. WD.**

LAWRENCE ST. 60 FT. WD.



- VACATE AND CONVERSION TO UTILITY EASEMENT AND ACCESS EASEMENT



- VACATE AND CONVERSION TO UTILITY EASEMENT

(FOR OFFICE USE ONLY)

CARTO 23F

B					
A					
DESCRIPTION	DRWN	CHKD	APPD	DATE	
REVISIONS					
DRAWN BY	LS	CHECKED	LC		
DATE	06-23-2023	APPROVED	JD		

REQUEST TO OUTRIGHT VACATE A PORTION OF
EASEMENT ALLEYWAY BETWEEN
LAWRENCE ST. AND BURLINGAME ST.
VACATE WITH RESERVE FOR ADDITIONAL
EASEMENT RETAINED SOUTH OF
LOTS 150, 151, 152 OFF BURLINGAME ST.

CITY OF DETROIT
CITY ENGINEERING DIVISION
SURVEY BUREAU

JOB NO. 23-79

DRWG. NO.

City of Detroit

PUBLIC WORKS DEPARTMENT: CITY ENGINEERING DIVISION

Coleman A. Young Municipal Center - 6th Floor

We, the undersigned individuals owning property adjacent to the proposed right-of-way to be vacated have no objections to the request of the petitioner. This petition requires consent by 2/3 of the adjacent owners in residential areas. Commercial areas require 100% of adjacent owners to consent. Properties owned by a business or other entity must be signed by an authorized agent in order to be counted in this petition.

By signing this petition the property owner is confirming awareness of the following changes to their property:

- (1) Vacating the proposed street or alley will result in the property owner being allocated ownership of 1/2 of the street or alley (conditional to the design of the subdivision) and will cause the property assessment to be adjusted to include the increase in square footage.
- (2) Drainage fees to the property will be adjusted based on any added impervious surfaces added to the property. Please contact the Department of Water and Sewage for additional questions regarding rates.
- (3) Garages orientated toward the alley may no longer be accessible by the alley. Upon approval of this petition the alley will no longer be considered public. The property owner waves their right to access their property using the alley.

Commercial properties are subject to the conditions of their land use grant. Which may require permission from the Buildings and Safety Engineering and Environment Department or the Board of Zoning Appeals prior to changing the limits of their property.

PRINTNAME / ADDRESS / DATE SIGNED

Bevan Morrison-Rodgers 1976 Lawrence Detroit 5/27/2023

SIGNATURE



PRINTNAME / ADDRESS / DATE SIGNED

Cevone Smith 1944 + 1930 Lawrence (6) 1927 - 1981 Burlington 5/27/23

SIGNATURE



PRINT NAME / ADDRESS / DATE SIGNED

Monica Whalum 1966 Lawrence 5-27-23

SIGNATURE

Monica Whalum

PRINT NAME / ADDRESS / DATE SIGNED

Maurice Kendrick 1966 Lawrence 5-27-23

SIGNATURE

Maurice Kendrick

PRINT NAME / ADDRESS / DATE SIGNED

Timothy ALBERT 1990 Lawrence 5-27-23

SIGNATURE

Timothy Albert

PRINT NAME / ADDRESS / DATE SIGNED

Robert Turner 1980 Lawrence 5-5-23

SIGNATURE

Robert Turner III

PRINT NAME / ADDRESS / DATE SIGNED

Lawanda Polter 1990 Lawrence St 6-21-23

SIGNATURE

Lawanda Polter 1990 Lawrence St

PRINT NAME / ADDRESS / DATE SIGNED

SIGNATURE

PRINT NAME / ADDRESS / DATE SIGNED

SIGNATURE
