

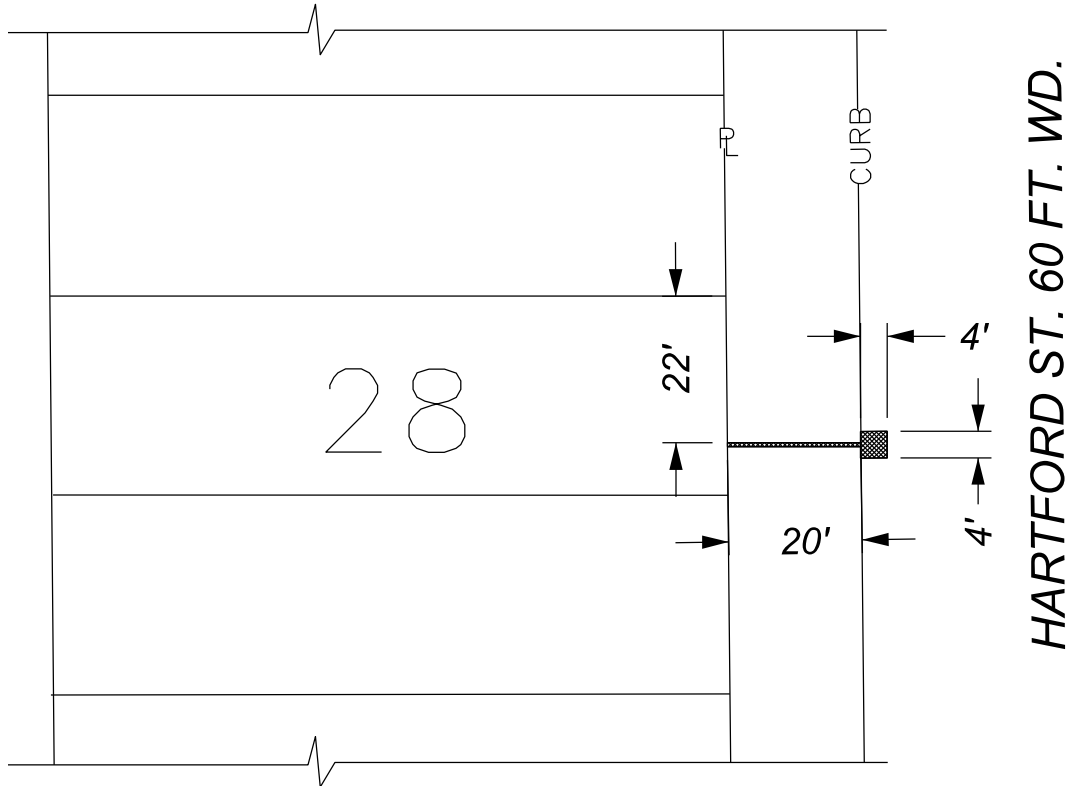

COBB PLACE 60 FT. WD.

PUBLIC ALLEY 15 FT. WD.



Mc GRAW AVE. 70 FT. WD.

COBB PLACE 60 FT. WD.

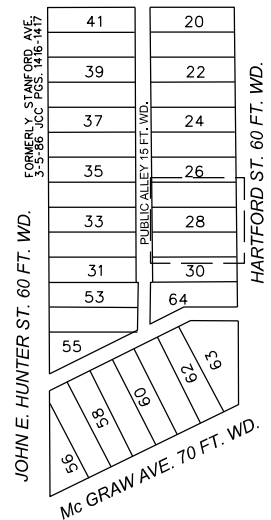

- REQUEST ENCROACHMENT
(For Stormwater Inlet/Catch Basin)

(FOR OFFICE USE ONLY)

CARTO 1415 F

B					
A					
REVISIONS					
DESCRIPTION	DRWN	CHKD	APPD	DATE	
DRAWN BY	LC	CHECKED		AP	
DATE	04-20-2023	APPROVED		JD	

REQUEST ENCROACHMENT
INTO HARTFORD ST.
AT 5651 HARTFORD ST. FOR
STORMWATER INLET/CATCH BASIN

CITY OF DETROIT CITY ENGINEERING DIVISION SURVEY BUREAU	
JOB NO.	23-47
DRWG. NO.	