

# MAP-22-6

## Petition No.x2022-79

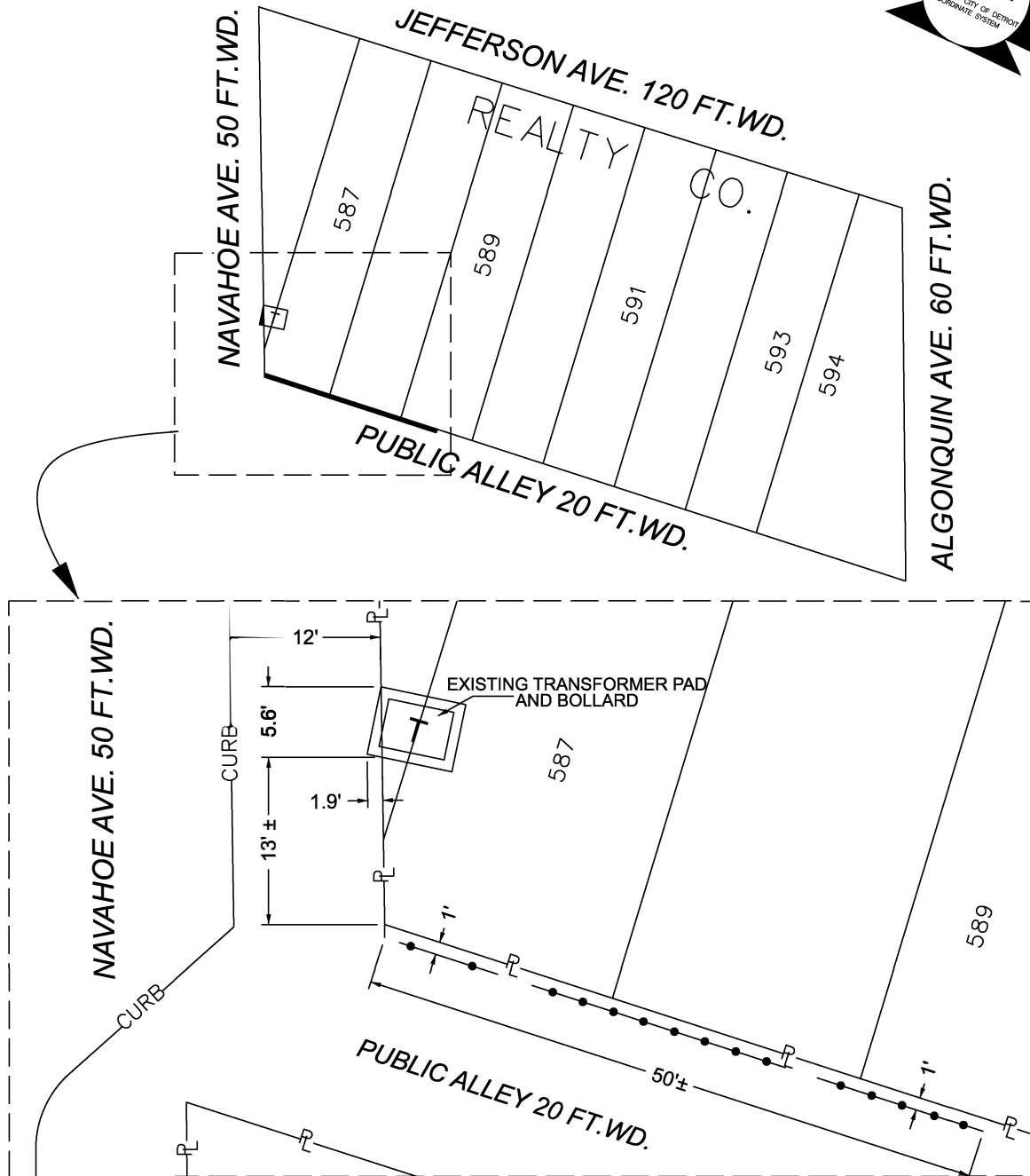

### LEGEND

- REQUEST ENCROACHMENT  
 \* The existing transformer pad and bollard.  
 \* The guard rail along the northerly part of the adjacent alley.
- STANDARD GUARD RAILS.  
 \* Approx. 36" above grade.  
 \* Buried depth of 36" for the frost line.

(FOR OFFICE USE ONLY)

CARTO 62 C

<b>B</b>					
<b>A</b>					
<b>DESCRIPTION</b>	<b>DRWN</b>	<b>CHKD</b>	<b>APPD</b>	<b>DATE</b>	
<b>REVISIONS</b>					
<b>DRAWN BY</b>	<b>SA</b>	<b>CHECKED</b>			
<b>DATE</b>	<b>02-16-2022</b>	<b>APPROVED</b>			
		<b>JD</b>			

**REQUEST ENCROACHMENT  
INTO NAVAHOE AVE.  
AT 12600 E. JEFFERSON AVE.**

**CITY OF DETROIT  
CITY ENGINEERING DIVISION  
SURVEY BUREAU**

**JOB NO. 01-01**

**DRWG. NO.**