

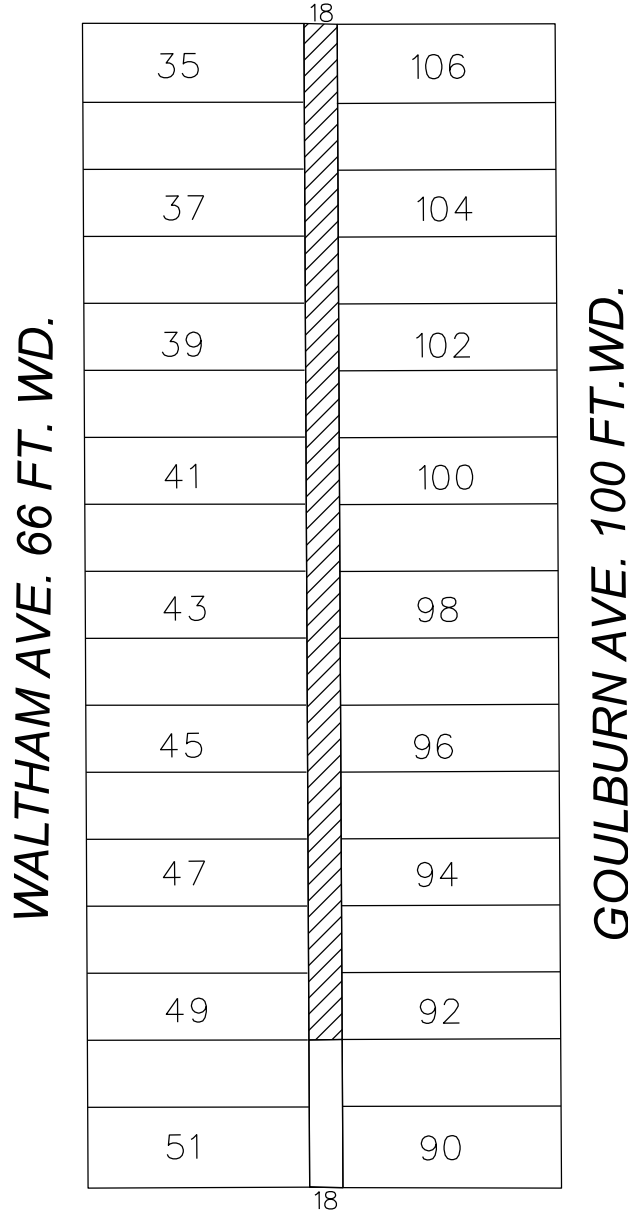

PINEWOOD AVE. 50 FT. WD.



LAPPIN AVE. 50 FT. WD.



- CONVERSION TO UTILITY EASEMENT

(FOR OFFICE USE ONLY)

CARTO 94 D

B					
A					
REVISIONS					
DESCRIPTION	DRWN	CHKD	APPD	DATE	
DRAWN BY	SA	CHECKED	JD		
DATE	10-18-2021	APPROVED			

CONVERSION TO UTILITY EASEMENT
 THE NORTH/SOUTH PUBLIC ALLEY, 18 FT. WD.
 IN THE BLOCK BOUND BY
 WALTHAM AVE., PINEWOOD AVE.,
 GOULBURN AVE. AND LAPPIN AVE.

CITY OF DETROIT
 CITY ENGINEERING DIVISION
 SURVEY BUREAU

JOB NO. 01-01

DRWG. NO.