

LOCATION MAP
NOT TO SCALE

IKE KIOSK - DOWNTOWN DETROIT
DET - 003 SHELBY & GRISWOLD
CITY OF DETROIT
WAYNE COUNTY, MI
PERMIT/CONSTRUCTION PLANS

FOR BID ONLY
PLANS NOT APPROVED BY CITY OF
DETROIT

10/08/2021

ike SMART CITY
 250 N HARTFORD AVE
 COLUMBUS, OHIO 43222
 PHONE: 614.589.0087

METRO ENGINEERING SOLUTIONS
 33900 SCHOOLCRAFT RD
 LIVONIA, MICHIGAN 48150
 PHONE: 734.483.1427 FAX: 734.483.3431
 www.metroes.net



October 7, 2021
 CONTRACTOR/AS-BUILT

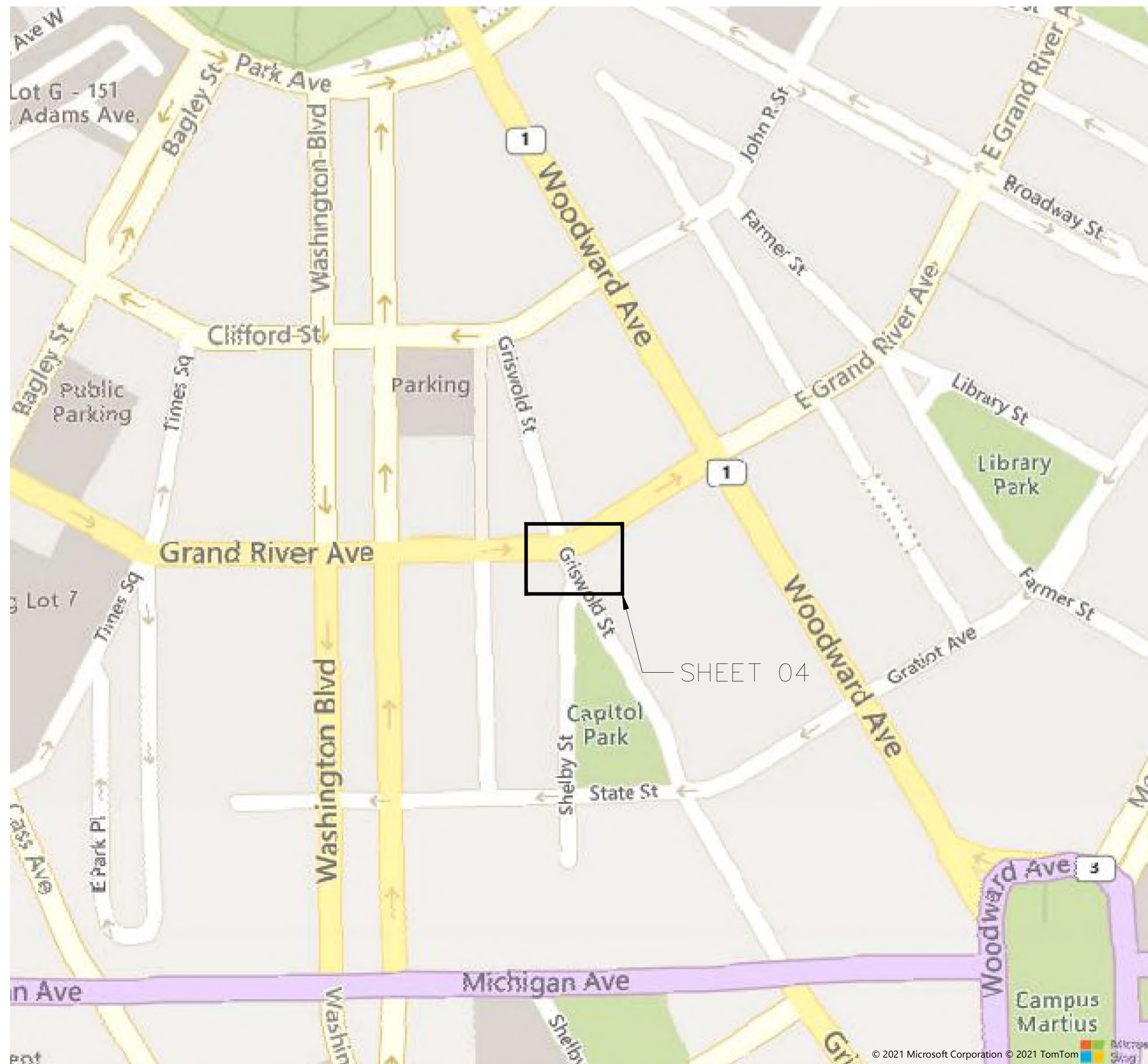

OWNER
 IKE SMART CITY
 250N HARTFORD AVE
 COLUMBUS, OH 43222
 CONTACT: HARDIN, MATTHEW
 PHONE: (614) 209-6400
 EMAIL: MHARDIN@IKESMARTCITY.COM

KIOSK MANUFACTURER
 DISPLAY DEVICE INC.
 21075 WESTGATE RD
 GOLDEN, CO 80403
 CONTACT: PERKINS, ERIC
 PHONE: (303)929-4071

ENGINEER
 METRO ENGINEERING SOLUTIONS
 33900 SCHOOLCRAFT RD
 LIVONIA, MI 48150
 CONTACT: GAMBLE, JUSTIN
 PHONE: (734)308-4886
 EMAIL: JGAMBLE@METROES.NET

DRAWING INDEX	
NO.	DESCRIPTION
01	TITLE
02	CITY OF DETROIT SPECS
03	PLAN VIEW
04	RESTORATION PLAN
05-06	IKE KIOSK SPECS
07	FOUNDATION SPECS
08	ADA SPECS
09	CONSTRUCTION NOTES
10-11	M.O.T.

REV.	DATE:	ISSUED FOR:

SITE NAME:
 DET-003
 SHELBY & GRISWOLD

JOB: 1035-21-1595_DS

DRAW DATE: 09/29/21

PLOT DATE: 10/7/21

DRAWN BY: JRG

TITLE: COVER

SHEET: 01 OF 11

K:\1035-IKE\1035-21-1595-IKE - Shelby & Griswold\DWG\1035-21-1595_DS.dwg; 10/7/2021 12:11 PM;

CONSTRUCTION SITE SAFETY IS THE RESPONSIBILITY OF THE CONTRACTOR. NEITHER THE OWNER NOR THE ENGINEER SHALL BE EXPECTED TO ASSUME ANY RESPONSIBILITY FOR SAFETY OF THE WORK, OF PERSONS ENGAGED IN THE WORK, OF ANY NEARBY STRUCTURES, OR OF ANY OTHER PERSONS.
 COPYRIGHT © 2021 METRO ENGINEERING SOLUTIONS; ALL RIGHTS RESERVED.

THE LOCATIONS OF EXISTING UNDERGROUND UTILITIES ARE SHOWN IN AN APPROXIMATE WAY ONLY AND HAVE NOT BEEN INDEPENDENTLY VERIFIED. THE CONTRACTOR SHALL DETERMINE THE EXACT LOCATION OF ALL EXISTING UTILITIES BEFORE COMMENCING WORK, AND AGREES TO BE FULLY RESPONSIBLE FOR ANY AND ALL DAMAGES WHICH MIGHT BE OCCASIONED BY THE CONTRACTOR'S FAILURE TO EXACTLY LOCATE AND PRESERVE ANY AND ALL UNDERGROUND UTILITIES.



K:\1035-IKE\1035-21-1595 IKE - Shelby & Griswold\DWG\1035-21-1595_DS.dwg; 10/7/2021 12:11 PM;

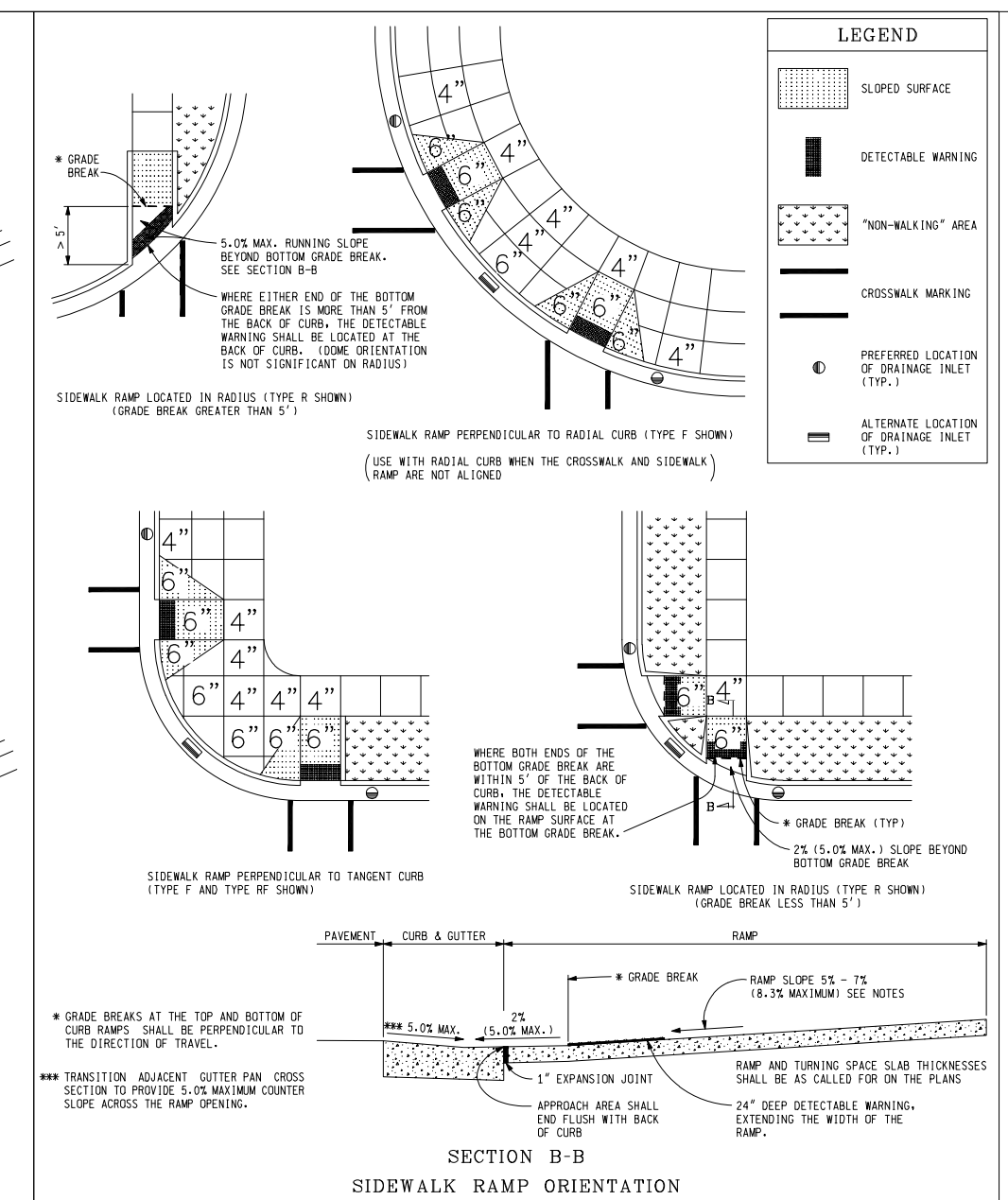
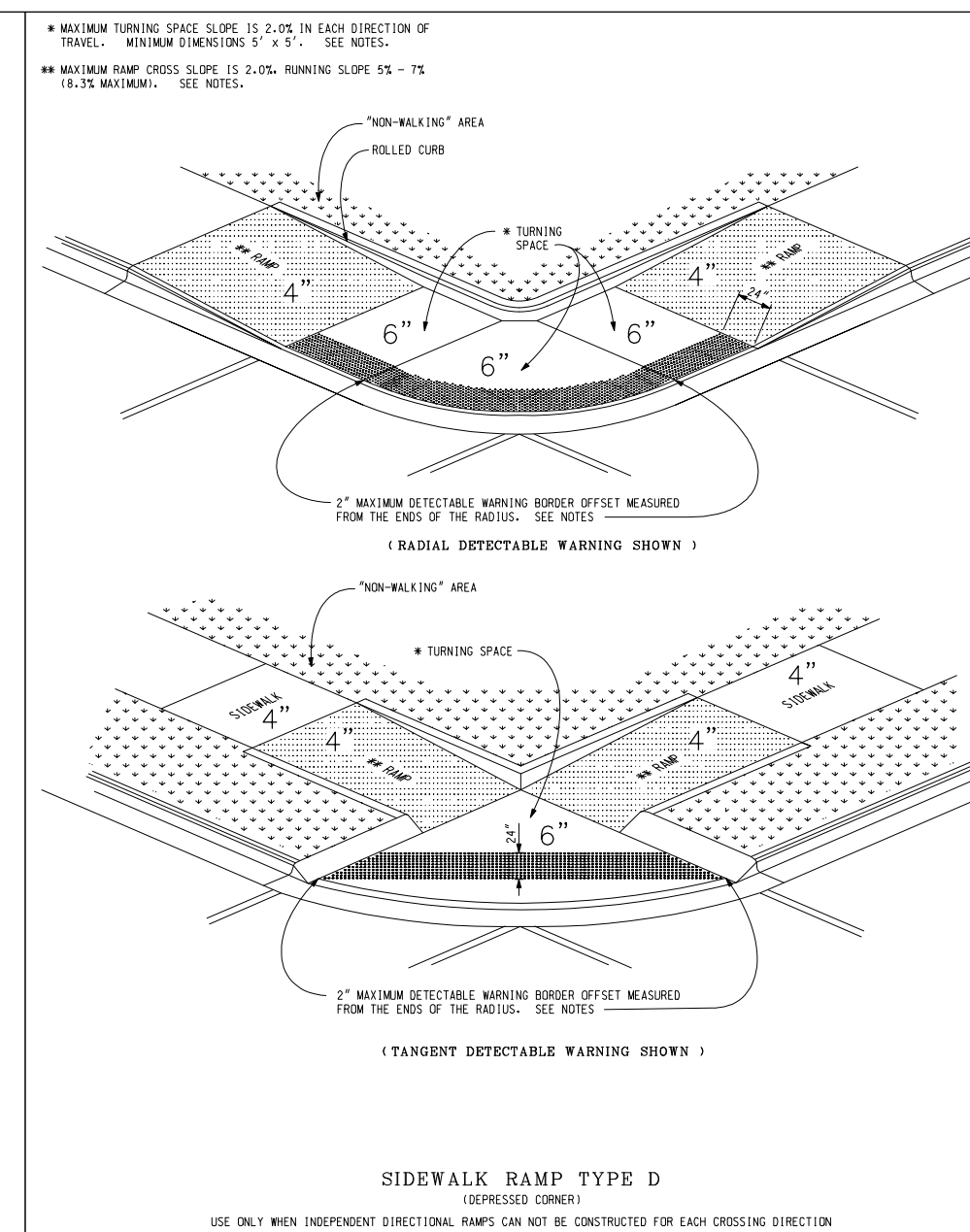
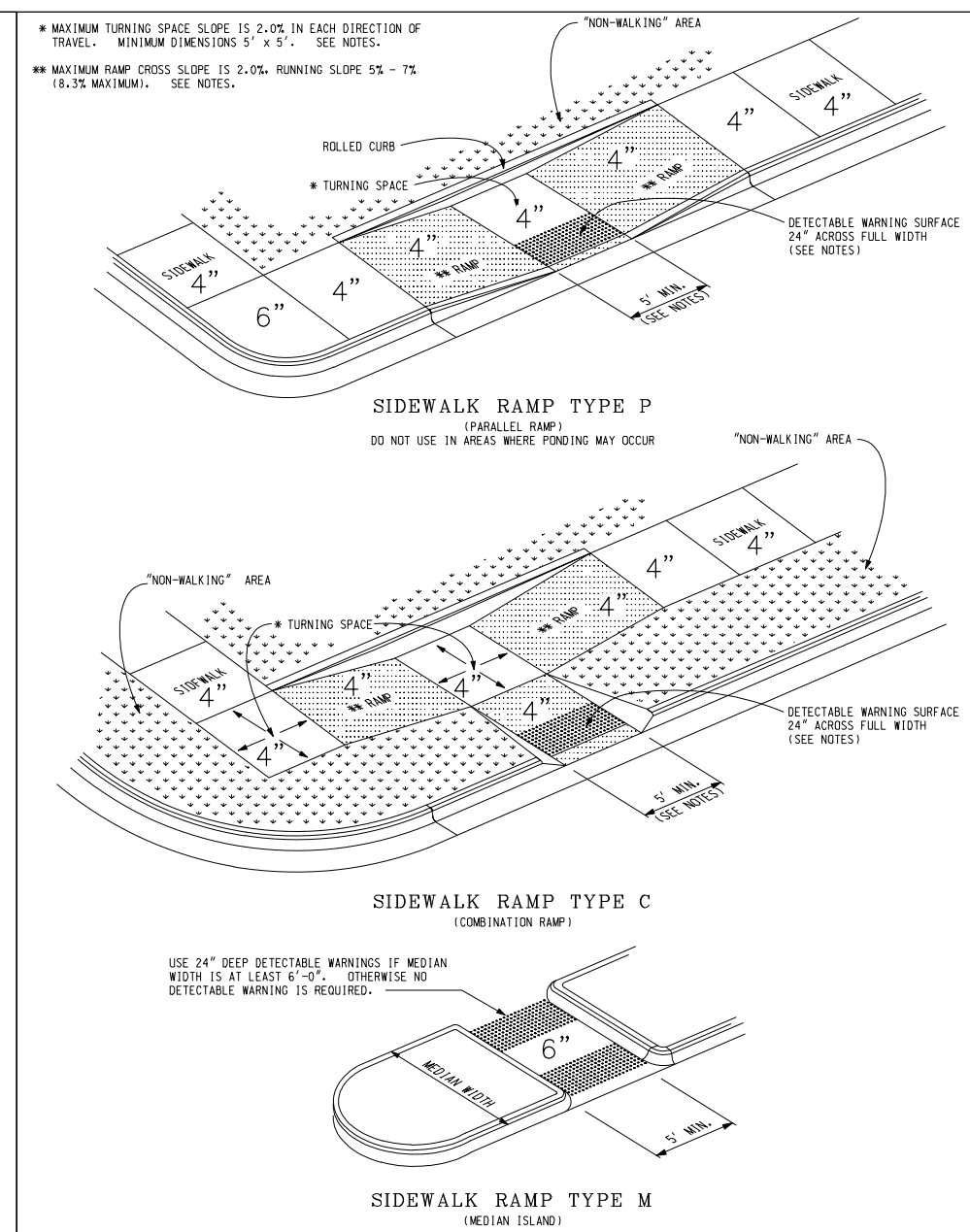
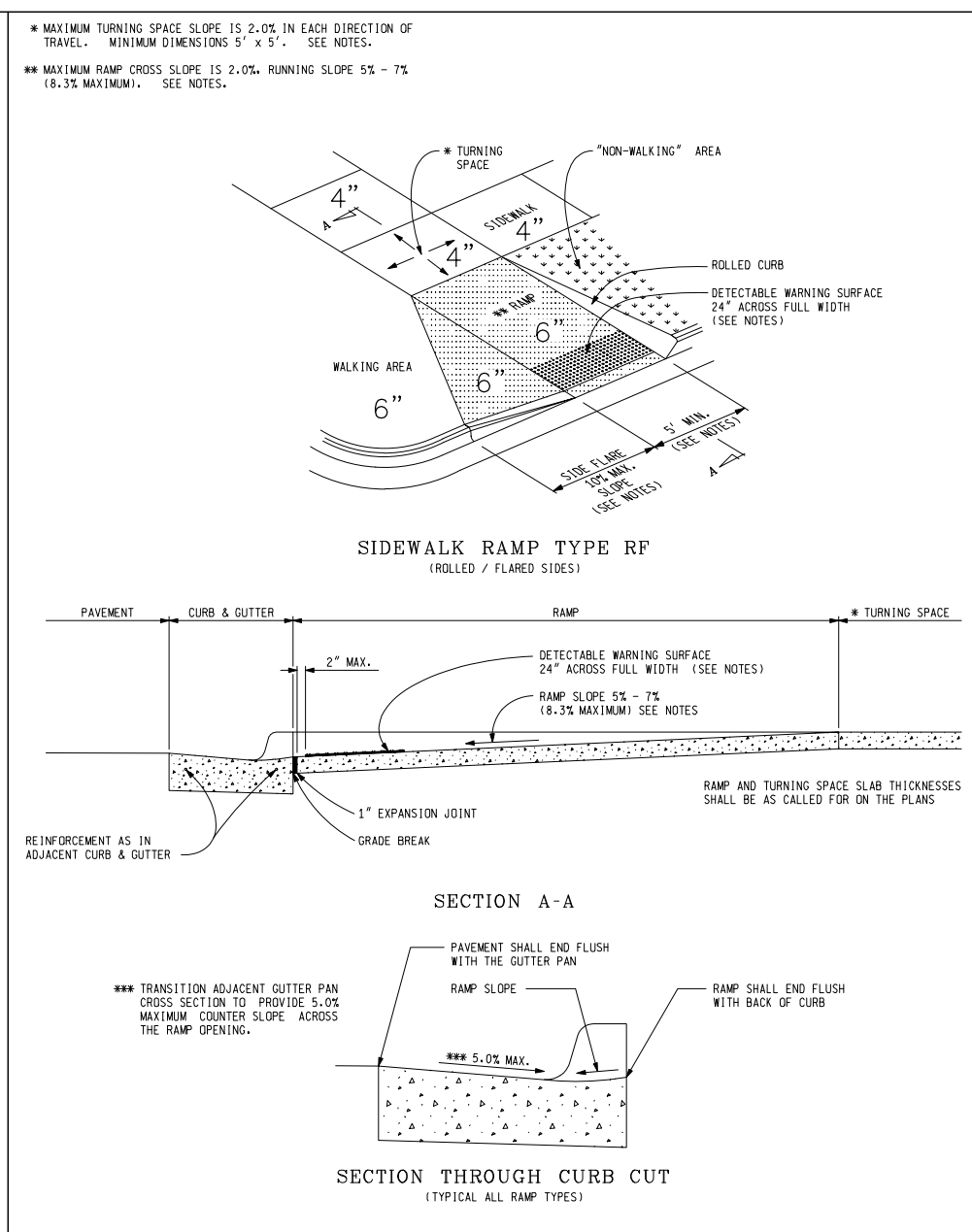
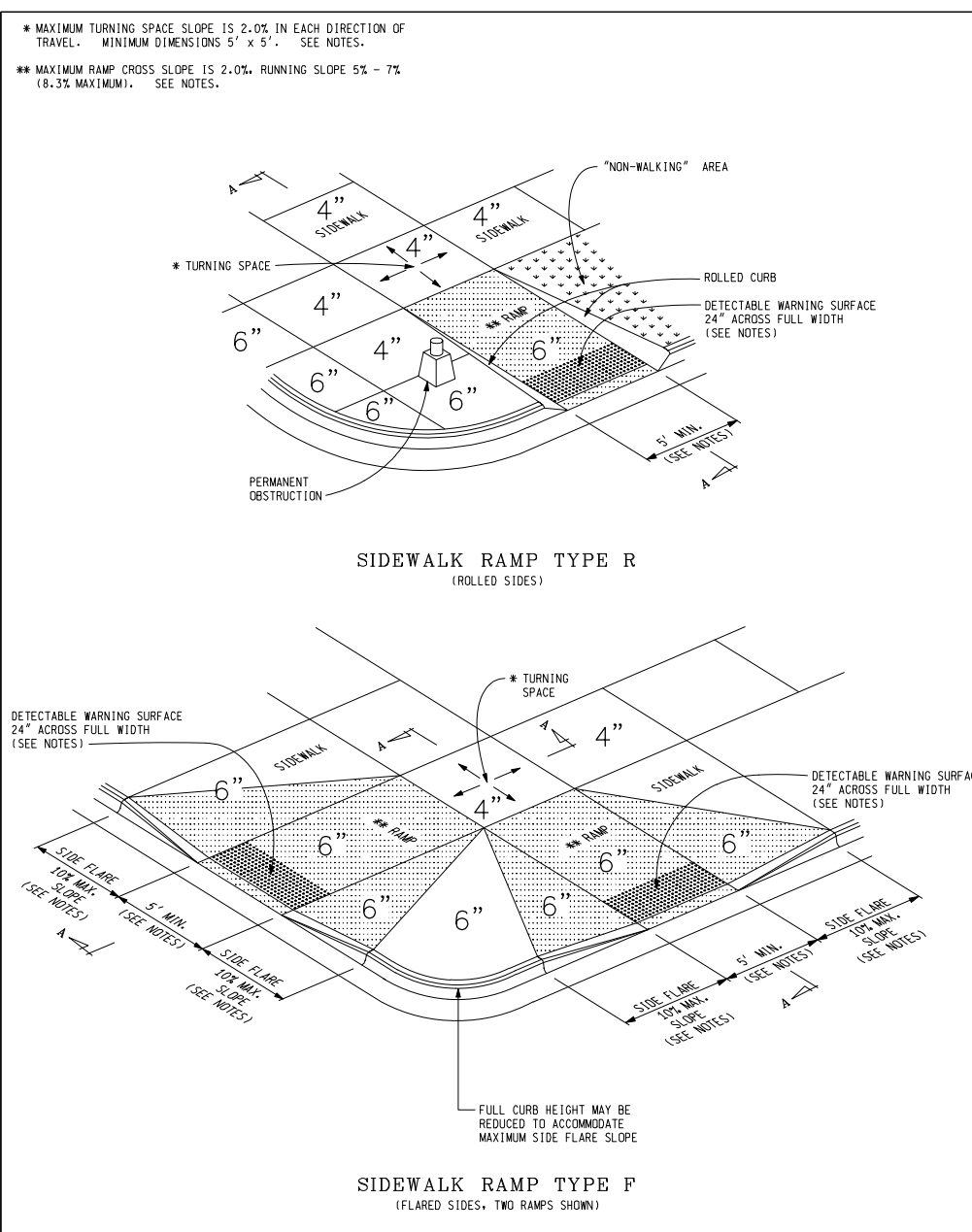

DEPARTMENT DIRECTOR MDOT PREPARED BY: DESIGN DIVISION DRAWN BY: J.S.L./J.L.C. CHECKED BY: J.S.L./J.L.C.	APPROVED BY: DIRECTOR, BUREAU OF FIELD SERVICES DIRECTOR, BUREAU OF HIGHWAY DESIGN	MICHIGAN DEPARTMENT OF TRANSPORTATION BUREAU OF HIGHWAY DEVELOPMENT STANDARD PLAN FOR SIDEWALK RAMP AND DETECTABLE WARNING DETAILS 9-30-2014 PLAN DATE 7-1-2014 PLAN DATE R-28-1 SHEET 1 OF 1
--	---	--

MICHIGAN DEPARTMENT OF TRANSPORTATION BUREAU OF HIGHWAY DEVELOPMENT STANDARD PLAN FOR SIDEWALK RAMP AND DETECTABLE WARNING DETAILS 9-30-2014 PLAN DATE 7-1-2014 PLAN DATE R-28-1 SHEET 2 OF 1
--

MICHIGAN DEPARTMENT OF TRANSPORTATION BUREAU OF HIGHWAY DEVELOPMENT STANDARD PLAN FOR SIDEWALK RAMP AND DETECTABLE WARNING DETAILS 9-30-2014 PLAN DATE 7-1-2014 PLAN DATE R-28-1 SHEET 3 OF 1
--

MICHIGAN DEPARTMENT OF TRANSPORTATION BUREAU OF HIGHWAY DEVELOPMENT STANDARD PLAN FOR SIDEWALK RAMP AND DETECTABLE WARNING DETAILS 9-30-2014 PLAN DATE 7-1-2014 PLAN DATE R-28-1 SHEET 4 OF 1
--

MICHIGAN DEPARTMENT OF TRANSPORTATION BUREAU OF HIGHWAY DEVELOPMENT STANDARD PLAN FOR SIDEWALK RAMP AND DETECTABLE WARNING DETAILS 9-30-2014 PLAN DATE 7-1-2014 PLAN DATE R-28-1 SHEET 6 OF 1
--

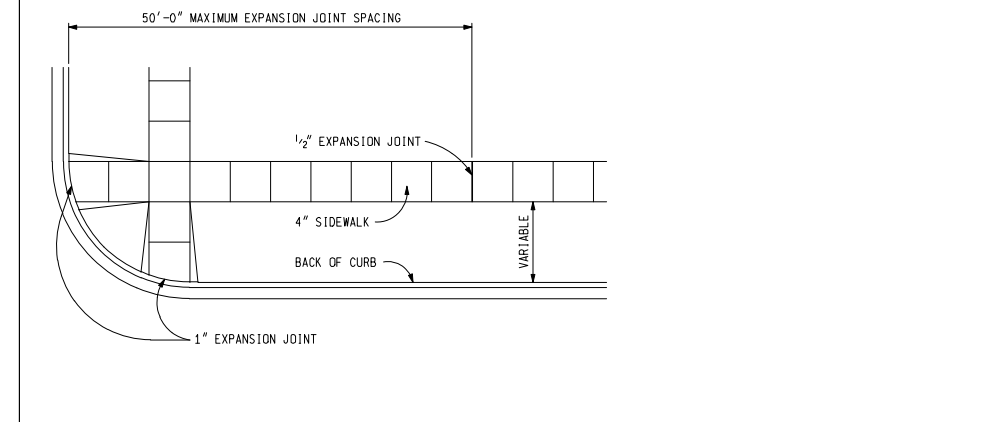
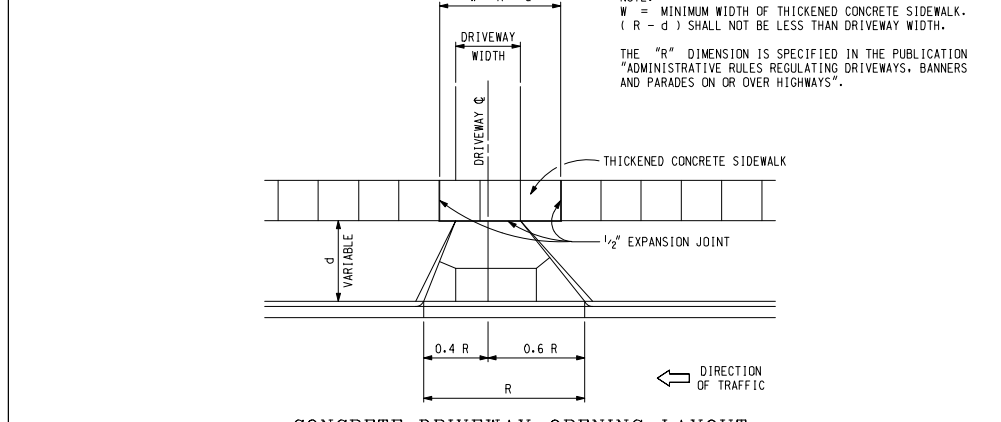
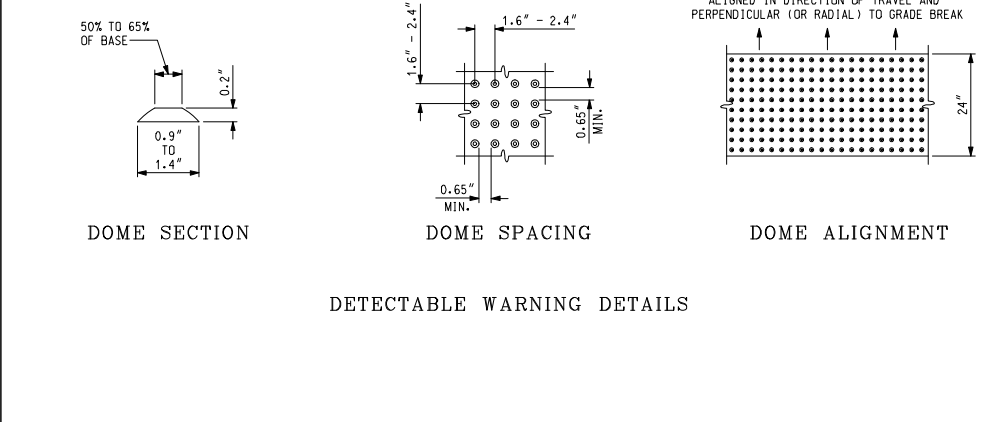

NOTES:

DETAILS SPECIFIED ON THIS PLAN APPLY TO ALL CONSTRUCTION, RECONSTRUCTION, OR ALTERATION OF STREETS, CURBS, OR SIDEWALKS ON THE PUBLIC FLOOR OF MAINTENANCE.

STREET RAMP TYPES ARE TO BE LOCATED AS SPECIFIED ON THE PLANS OR AS DIRECTED BY THE ENGINEER.

RAMP SHALL BE PROVIDED BY ALL CORNERS OF AN INTERSECTION WHERE THERE IS EXISTING OR PROPOSED SIDEWALK AND CURB. RAMPS SHALL ALSO BE PROVIDED AT INTERSECTIONS WHERE SIDEWALKS MEET AT CORNERS.

TRANSITION ADJUSTMENT GUTTER PAN CROSS SECTION TO PROVIDE 3.0% MAXIMUM GRADE SLOPE ACROSS THE RAMP OPENING.

TRANSITION ADJUSTMENT GUTTER PAN CROSS SECTION TO PROVIDE 3.0% MAXIMUM GRADE SLOPE ACROSS THE RAMP OPENING.

TRANSITION ADJUSTMENT GUTTER PAN CROSS SECTION TO PROVIDE 3.0% MAXIMUM GRADE SLOPE ACROSS THE RAMP OPENING.

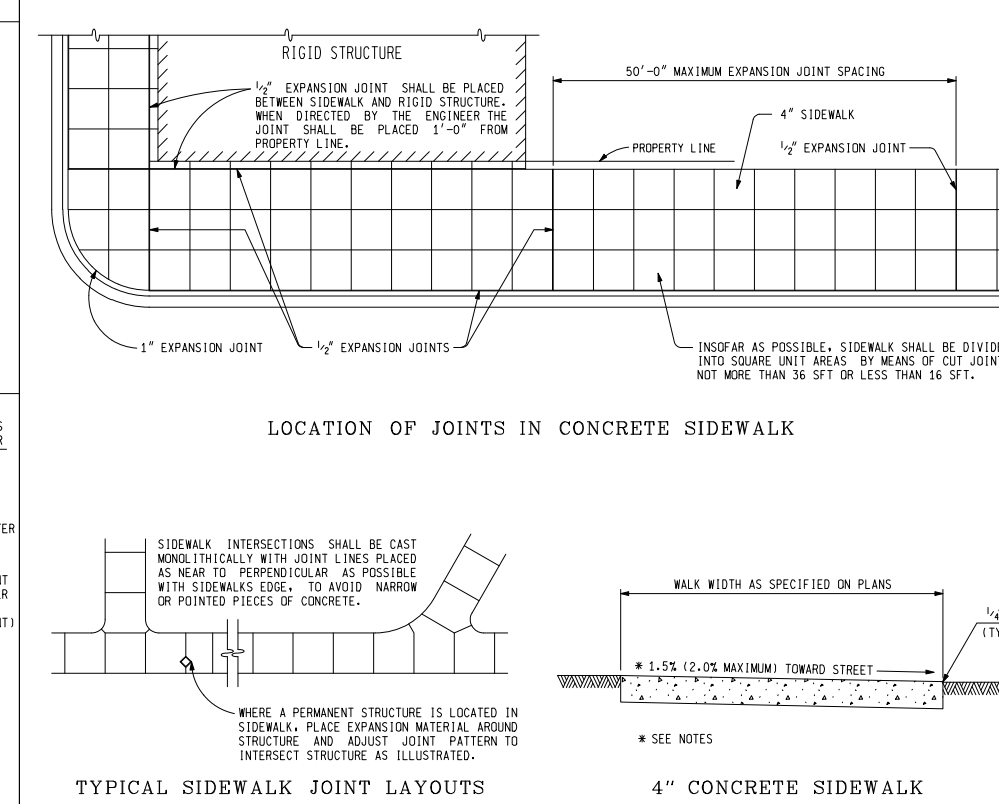
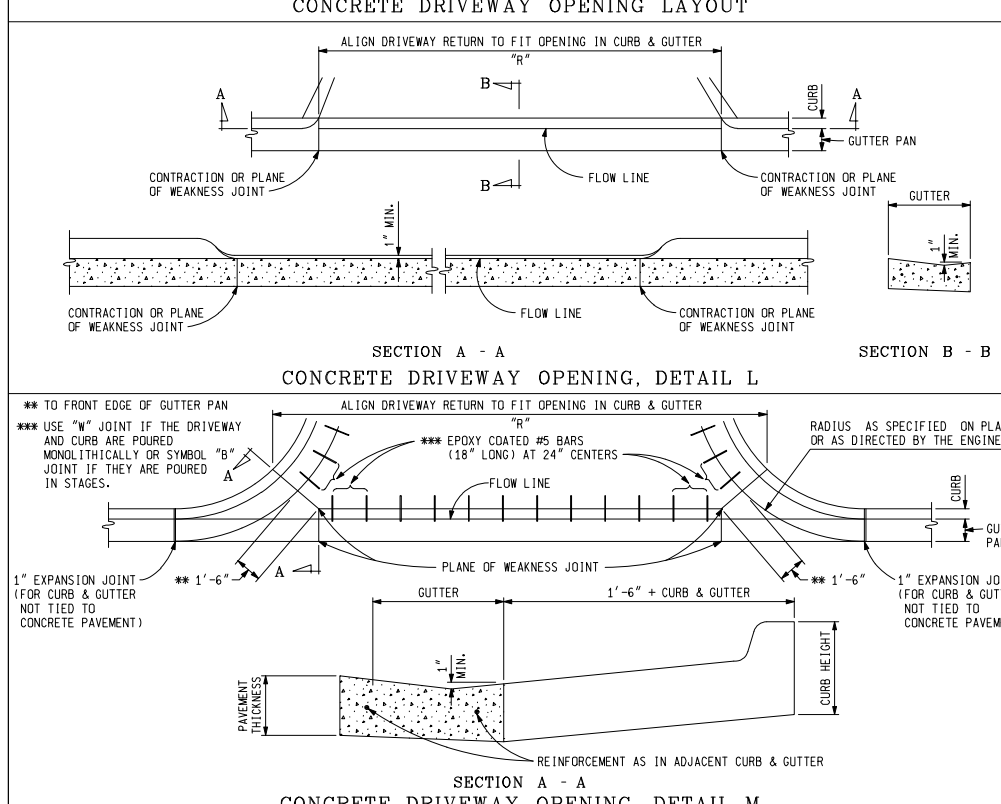

MICHIGAN DEPARTMENT OF TRANSPORTATION BUREAU OF HIGHWAY DEVELOPMENT STANDARD PLAN FOR SIDEWALK RAMP AND DETECTABLE WARNING DETAILS 9-30-2014 PLAN DATE 7-1-2014 PLAN DATE R-28-1 SHEET 1 OF 1
--

MICHIGAN DEPARTMENT OF TRANSPORTATION BUREAU OF HIGHWAY DEVELOPMENT STANDARD PLAN FOR DRIVEWAY OPENINGS & APPROACHES, AND CONCRETE SIDEWALK 9-30-2014 PLAN DATE 7-1-2014 PLAN DATE R-29-1 SHEET 2 OF 4

MICHIGAN DEPARTMENT OF TRANSPORTATION BUREAU OF HIGHWAY DEVELOPMENT STANDARD PLAN FOR DRIVEWAY OPENINGS & APPROACHES, AND CONCRETE SIDEWALK 9-30-2014 PLAN DATE 7-1-2014 PLAN DATE R-29-1 SHEET 3 OF 4

GENERAL CONSTRUCTION NOTES

A. SODDED AREAS THAT MAY BE DISTURBED DURING INSTALLATION ARE TO BE RESTORED WITH 3" OF QUALITY TOP SOIL, SEED AND MULCH.

B. MAINTAIN A MINIMUM 18" CLEARANCE FROM ALL EXISTING PUBLIC UTILITIES.

C. PROPOSED INSTALLATION TO BE PLACED AT A MINIMUM DEPTH OF 48", UNLESS OTHERWISE NOTED ON PLANS.

D. SIDEWALK REMOVAL NECESSARY ON THIS PROJECT TO BE ACCOMPLISHED IN KIND PER JURISDICTIONAL SPECIFICATIONS.

E. HARD SURFACE REMOVAL OF STREETS AND/OR DRIVEWAYS TO BE SAW CUT FULL DEPTH AND REPLACED IN KIND PER JURISDICTIONAL SPECIFICATIONS.

F. CONTRACTOR TO FIELD VERIFY ALL EXISTING UTILITY LOCATIONS, INVERTS AND GRADES PRIOR TO STARTING CONSTRUCTION.

G. EXCAVATIONS BELOW HARD SURFACES TO BE BACKFILLED WITH MDOT CLASS II GRANULAR MATERIAL IN 8" LAYERS, WELL COMPACTED TO 98% OF ITS MAXIMUM UNIT WEIGHT AT A MOISTURE CONTENT LESS THAN SATURATION.

H. TEST HOLES TO BE CONSTRUCTED AS A 12" CYLINDRICAL HOLE. SOIL TO BE REMOVED USING A VACUUM TRUCK. HOLE TO BE BACKFILLED USING A GRANULAR MATERIAL TO THE BOTTOM OF THE EXISTING PAVEMENT. PAVEMENT TO BE REPLACED IN KIND PER MDOT SPECIFICATIONS.

CITY OF DETROIT NOTES:

- NOTIFY THE CITY OF DETROIT ENGINEERING DEPARTMENT 24 HOURS PRIOR TO STARTING CONSTRUCTION.
- ANY OPEN EXCAVATIONS ARE TO BE STEEL PLATED. IF EXCAVATIONS ARE IN THE PAVEMENT, THE PLATES ARE TO BE SPIKED AND RAMPED WITH COLD PATCH. CONTACT THE CITY WITH LOCATION OF THE STEEL PLATE.
- CONCRETE ROADS THAT ARE OPEN CUT ARE TO BE BACK FILLED PER CITY SPECIFICATIONS AND RESTORED WITH AT LEAST 10" CONCRETE SUB BASE AND AT LEAST 2" MDOT HMA 4E3 AND 1.5" HMA 5E3, PER TYPICAL OPEN CUT DETAIL.
- IF A CORNER OF AN INTERSECTION MUST BE OPENED UP FOR CONSTRUCTION PURPOSES, THAT CORNER AND THE OTHER (3) ADJOINING CORNERS MUST BE RECONSTRUCTED PER MDOT SPECIFICATIONS R-29-1 C.E.D. MODIFIED. THIS WORK IS NECESSARY TO COMPLY WITH ADA REQUIREMENTS SET FORTH TO THE CITY OF DETROIT. CONTACT THE CITY OF DETROIT ENGINEERING DEPARTMENT TO INQUIRE ABOUT THE REQUIRED DEEP DETECTABLE PLATE TO BE USED AT THE SIDEWALK RAMPS.
- THE CITY OF DETROIT REQUIRES ALL CONCRETE WORK TO BE STAMPED WITH A CONTRACTORS IDENTIFICATION STAMP.
- SEE THE CITY OF DETROIT CONSTRUCTION SPECIFICATIONS MANUAL FOR STANDARDS THAT FIT YOUR SPECIFIC JOB NEEDS.

RESTORATION NOTES:

- PAVEMENT SHALL BE MILLED DOWN TO LOCATE NEAREST JOINTS, AT FULL LANE WIDTH.
- CONCRETE RESTORATION SHALL BE PERFORMED AT FULL DEPTH, JOINT TO JOINT, AND AT LEAST (1) LANE IN WIDTH.
- DOWEL ANCHORS SHALL BE INSTALLED AT 18" CENTERS TO TIE INTO EXISTING PAVEMENT.
- EXISTING ASPHALT SHALL BE MILLED DOWN TO CONCRETE BASE 1" BEYOND CONCRETE RESTORATION, AND 1" BEYOND THAT TO A DEPTH OF 1.5"
- RESTORATION OF ASPHALT SHALL BE PERFORMED IN 2 LIFTS.
 - FIRST LIFT SHALL CONSIST OF 2" OF MDOT 4E3 LEVELING MIX.
 - SECOND LIFT SHALL CONSIST OF 1.5" OF MDOT 5E3 SURFACING MIX, AND SHALL BRING RESTORATION TO GRADE.

ike SMART CITY

250 N HARTFORD AVE
COLUMBUS, OHIO 43222
PHONE: 614.589.0087

METRO ENGINEERING SOLUTIONS

33900 SCHOOLCRAFT RD
LIVONIA, MICHIGAN 48150
PHONE: 734.483.1427 FAX: 734.483.3431
www.metroes.net



October 7, 2021
CONTRACTOR / AS-BUILT

ISSUED FOR:	
DATE:	
REV:	
SITE NAME:	DET-003 SHELBY & GRISWOLD
JOB:	1035-21-1595_DS
DRAW DATE:	09/29/21
PLOT DATE:	10/7/21
DRAWN BY:	JRG
TITLE:	DETROIT SPEC
SHEET:	02 OF 11

CONSTRUCTION SITE SAFETY IS THE RESPONSIBILITY OF THE CONTRACTOR. NEITHER THE OWNER NOR THE ENGINEER SHALL BE EXPECTED TO ASSUME ANY RESPONSIBILITY FOR SAFETY OF THE WORK, OF PERSONS ENGAGED IN THE WORK, OF ANY NEARBY STRUCTURES, OR OF ANY OTHER PERSONS.

© 2021 METRO ENGINEERING SOLUTIONS; ALL RIGHTS RESERVED.

THE LOCATIONS OF EXISTING UNDERGROUND UTILITIES ARE SHOWN IN AN APPROXIMATE WAY ONLY AND HAVE NOT BEEN INDEPENDENTLY VERIFIED. THE CONTRACTOR SHALL DETERMINE THE EXACT LOCATION OF ALL EXISTING UTILITIES BEFORE COMMENCING WORK, AND AGREES TO BE FULLY RESPONSIBLE FOR ANY AND ALL DAMAGES WHICH MAY BE OCCASIONED BY THE CONTRACTOR'S FAILURE TO EXACTLY LOCATE AND PRESERVE ANY AND ALL UNDERGROUND UTILITIES.



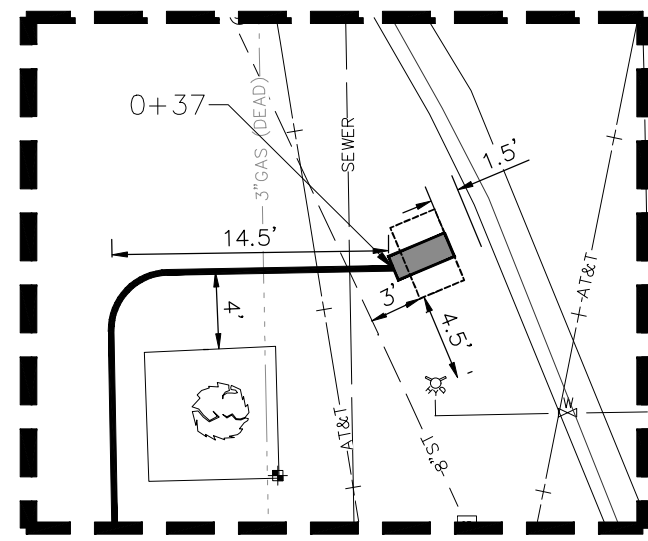

ENHANCED PLAN VIEW
SCALE 1"=10'

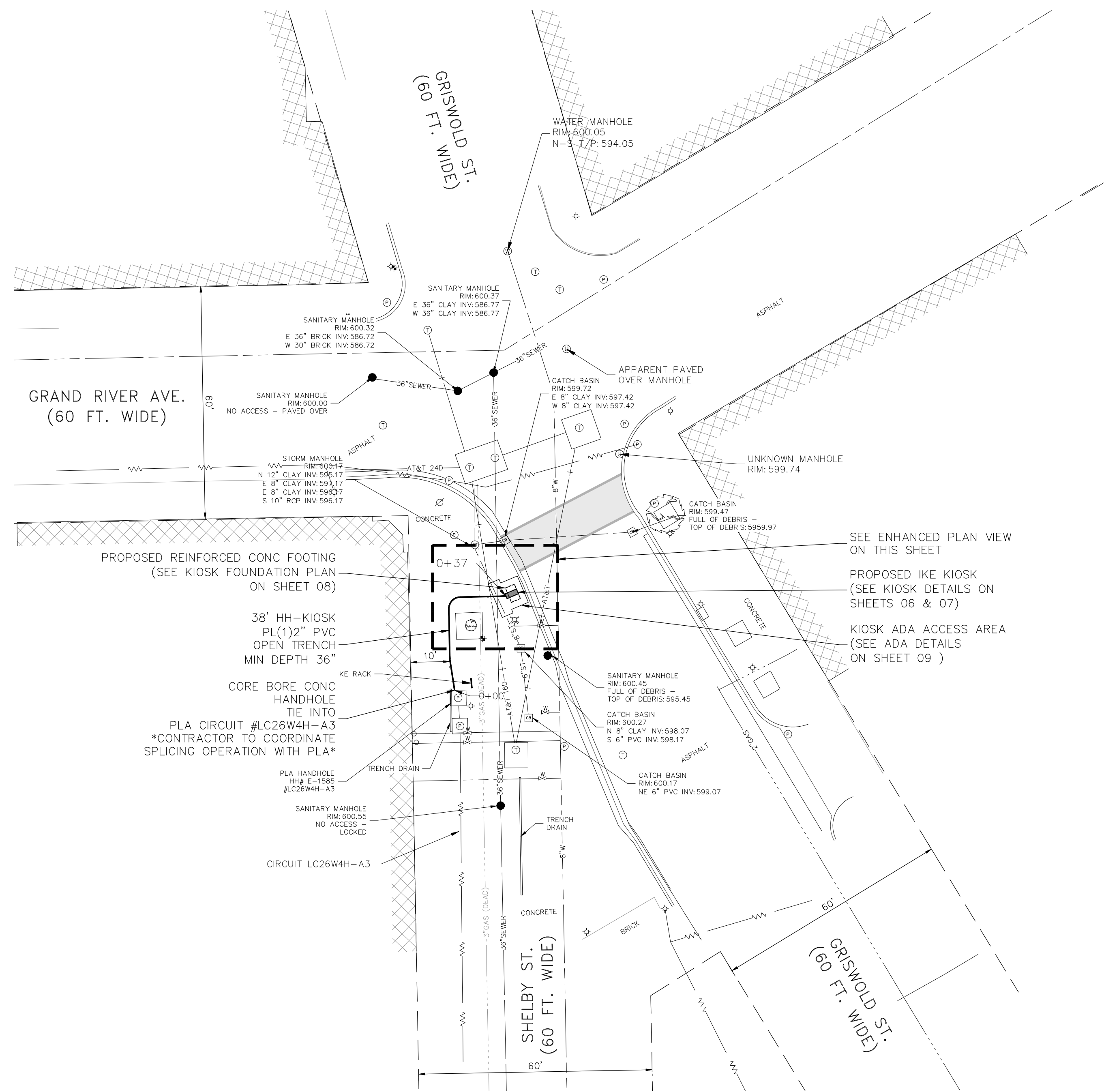

PLAN VIEW
SCALE 1"=20'

LEGEND

- X 656.5 EX. SPOT ELEVATION
- 652 EX. CONTOUR
- EX. WETLAND LIMITS
- - - EX. RIGHT OF WAY
- - - EX. EASEMENT LINE
- - - EX. DITCH
- EX. CURB/PAVEMENT
- ||||| EX. RR TRACK
- EX. FENCE
- EX. GRAVEL
- EX. GUARDRAIL
- EX. TREE LINE
- EX. WATER MAIN
- EX. WATER VALVE
- EX. HYDRANT
- EX. WATER MANHOLE
- EX. WELL
- EX. WATER METER
- EX. STORM SEWER
- EX. STORM INLET/CATCH BASIN
- EX. ROUND STORM CATCH BASIN
- EX. STORM MANHOLE
- EX. STORM END SECTION
- EX. SANITARY SEWER
- EX. SANITARY MANHOLE
- EX. UNDERGROUND GAS
- EX. GAS VALVE
- EX. OVERHEAD ELECTRIC
- EX. UNDERGROUND ELECTRIC
- EX. UNDERGROUND CABLE
- EX. UNDERGROUND TELE
- EX. TELEPHONE MANHOLE
- EX. ELECTRIC MANHOLE
- EX. ELECTRIC METER
- EX. GAS METER
- EX. LIGHT POLE
- EX. TRAFFIC SIGNAL BOX
- EX. UNIDENTIFIED MANHOLE
- EX. COMBO MANHOLE
- EX. TRAFFIC SIGNAL POLE
- EX. UTILITY POLE
- EX. GUY WIRE
- EX. TREE (CONIFEROUS)
- EX. TREE (DECIDUOUS)
- EX. UTILITY CABINET
- EX. SIGN
- EX. MAILBOX
- FOUND IRON PIPE
- FOUND IRON ROD
- FOUND PK NAIL
- FOUND CONC. MONUMENT
- SET IRON ROD
- SET MAG NAIL
- EX. SECTION CORNER
- PROP IKE UNDG INSTALL
- PROP IKE KIOSK & FOUNDATION

- IKE GENERAL NOTES**
- IT IS THE CONTRACTOR'S RESPONSIBILITY TO VERIFY ALL LOCATIONS, ELEVATIONS, AND DIMENSIONS OF ADJACENT AND/OR CONFLICTING UTILITIES SUFFICIENTLY IN ADVANCE OF CONSTRUCTION SO THAT ADJUSTMENTS CAN BE MADE TO PROVIDE ADEQUATE CLEARANCES. ANY DISCREPANCY FOUND SHALL BE BROUGHT TO THE OWNER AND ENGINEER BEFORE CONSTRUCTION HAS COMMENCED. THE CONTRACTOR SHALL PRESERVE AND PROTECT PUBLIC UTILITIES AT ALL TIMES DURING CONSTRUCTION. ANY DAMAGE TO UTILITIES RESULTING FROM CONTRACTOR'S OPERATIONS SHALL BE RESTORED AT THE CONTRACTOR'S EXPENSE.
 - ONCE THE FOUNDATION HAS BEEN LOCATED, THE CONTRACTOR SHALL RECEIVE SPOT-PAINT THE FOUR CORNERS OF THE FOUNDATION ON THE GROUND SURFACE FOR REVIEW BY THE OWNER. THE CONTRACTOR SHALL NOT EXCAVATE FOR THE FOUNDATION UNTIL AUTHORIZED BY THE OWNER'S REPRESENTATIVE.
 - EXISTING ROW LOCATIONS SHOWN ARE FOR REFERENCE ONLY. CONTRACTOR SHALL VERIFY RIGHT OF WAY LIMITS IN THE FIELD PRIOR TO COMMENCING CONSTRUCTION AND NOTIFY THE OWNER AND ENGINEER OF ANY CONFLICTS.
 - ALL AREAS DISTURBED DURING CONSTRUCTION SHALL BE RESTABILIZED PER THE PLANS. THE CONTRACTOR SHALL TAKE ALL NECESSARY PRECAUTIONS TO KEEP DRAINAGE AND SILT FROM WASHING ONTO ADJACENT PROPERTY OR CROSSING ADJACENT STREETS. CONTRACTOR SHALL IMMEDIATELY REMOVE SILT/DEBRIS THAT WASHES OFF-SITE OR INTO EXISTING STORM DRAIN SYSTEMS.
 - REFER TO OVERALL SITE PLAN FOR PAVEMENT REPAIR INFORMATION.
 - POWER TYPE: 120/240, 1P / INTERNET CONNECTION: 4GLTE.
 - THE CONTRACTOR AND/OR THE CONTRACTOR'S INDEPENDENTLY RETAINED EMPLOYEE OR STRUCTURAL DESIGN/GEOTECHNICAL/SAFETY/EQUIPMENT CONSULTANT, IF ANY, SHALL REVIEW THESE PLANS AND AVAILABLE GEOTECHNICAL INFORMATION AND THE ANTICIPATED INSTALLATION SITE(S) WITHIN THE PROJECT WORK AREA IN ORDER TO IMPLEMENT THE CONTRACTOR'S TRENCH EXCAVATION SAFETY PROTECTION SYSTEMS, PROGRAMS, AND/OR PROCEDURES FOR THE PROJECT DESCRIBED IN THE CONTRACT DOCUMENTS. THE CONTRACTOR'S IMPLEMENTATION OF THESE SYSTEMS, AND/OR PROCEDURES SHALL PROVIDE FOR ADEQUATE TRENCH EXCAVATION SAFETY PROTECTION THAT COMPLY WITH, AS A MINIMUM, OSHA STANDARDS FOR TRENCH EXCAVATIONS. SPECIFICALLY, THE CONTRACTOR AND/OR THE CONTRACTOR'S INDEPENDENTLY RETAINED EMPLOYEE OR SAFETY CONSULTANT SHALL IMPLEMENT A TRENCH SAFETY PROGRAM IN ACCORDANCE WITH OSHA STANDARDS GOVERNING THE PRESENCE AND ACTIVITIES OF INDIVIDUALS WORKING IN AND AROUND TRENCH EXCAVATION.
 - PROPOSED CONDUIT SHALL HAVE A MINIMUM OF 30 INCHES OF COVER AND SHALL MAINTAIN A MINIMUM CLEARANCE OF 12 INCHES FROM OTHER UTILITIES. IN CASE OF VERTICAL CONFLICT WITH EXISTING UTILITIES, THE CONTRACTOR MAY LOWER PROPOSED CONDUIT AT CROSSINGS TO MAINTAIN A 12 INCHES SEPARATION.
 - THE CONTRACTOR SHALL MAINTAIN 2 FEET OF CLEARANCE FROM ANY UNDERGROUND WATER OR SEWER INFRASTRUCTURE AND 4 FEET OF CLEARANCE FROM ANY ABOVE GROUND APPURTENANCES SUCH AS METERS, VALVE BOXES, MANHOLES, ETC.

- ADA NOTES**
- ALL CONSTRUCTION ACTIVITIES SHALL BE COMPLETED IN FULL COMPLIANCE WITH THE AMERICANS WITH DISABILITIES ACT (ADA).
 - PROPOSED CLEAR FLOOR OR GROUND SPACE IN FRONT OF THE PROPOSED KIOSK SHALL BE SLOPED A MAX OF 1.50% (+/-0.50%) IN ALL DIRECTIONS AWAY FROM THE KIOSK.
 - THE MINIMUM WHEELCHAIR PASSAGE WIDTH OR CLEAR SPACE WIDTH FOR SINGLE WHEELCHAIR PASSAGE SHALL BE 32" AT A POINT AND 36" CONTINUOUSLY PER PROWAG 2011 STANDARD SECTION R404 ([HTTPS://WWW.ACCESS-BOARD.GOV/GUIDELINES-AND-STANDARDS/STREETS-SIDEWALKS/PUBLIC-RIGHTS-OF-WAY](https://www.access-board.gov/guidelines-and-standards/streets-sidewalks-public-rights-of-way)).
 - THE MINIMUM CLEAR FLOOR OR GROUND SPACE IN FRONT OF PROPOSED KIOSK REQUIRED TO ACCOMMODATE A SINGLE, STATIONARY WHEELCHAIR AND OCCUPANT IS 30" BY 48". THE MINIMUM CLEAR FLOOR OR GROUND SPACE MAY BE POSITIONED FOR FORWARD OR PARALLEL APPROACH. CLEAR FLOOR OR GROUND SPACE FOR WHEELCHAIRS SHALL BE CENTERED ON THE ELEMENT IT SERVES AND MAY BE PART OF THE KNEE SPACE REQUIRED UNDER SOME OBJECTS.

- IKE KIOSK NOTE**
- INITIAL OPERATION FOR THE KIOSK WILL HAVE 4GLTE CONNECTION TO THE INTERNET

CONSTRUCTION SITE SAFETY IS THE RESPONSIBILITY OF THE CONTRACTOR. NEITHER THE OWNER NOR THE ENGINEER SHALL BE EXPECTED TO ASSUME ANY RESPONSIBILITY FOR SAFETY OF THE WORK, OF PERSONS ENGAGED IN THE WORK, OF ANY NEARBY STRUCTURES, OR OF ANY OTHER PERSONS.

THE LOCATIONS OF EXISTING UNDERGROUND UTILITIES ARE SHOWN IN AN APPROXIMATE WAY ONLY AND HAVE NOT BEEN INDEPENDENTLY VERIFIED. THE CONTRACTOR SHALL DETERMINE THE EXACT LOCATION OF ALL EXISTING UTILITIES BEFORE COMMENCING WORK, AND AGREES TO BE FULLY RESPONSIBLE FOR ANY AND ALL DAMAGES WHICH MIGHT BE OCCASIONED BY THE CONTRACTOR'S FAILURE TO EXACTLY LOCATE AND PRESERVE ANY AND ALL UNDERGROUND UTILITIES.

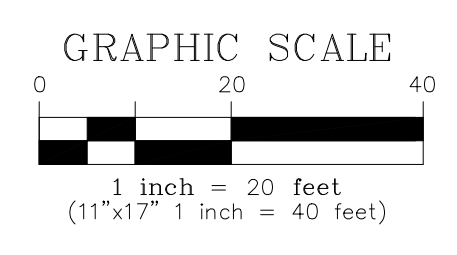

ike SMART CITY
250 N HARTFORD AVE
COLUMBUS, OHIO 43222
PHONE: 614.589.0087

METRO ENGINEERING SOLUTIONS
33900 SCHOOLCRAFT RD
LIVONIA, MICHIGAN 48150
PHONE: 734.483.1427 FAX: 734.483.3431
www.metroes.net



October 7, 2021
CONTRACTOR / AS-BUILT

REV.	DATE:	ISSUED FOR:

SITE NAME:
**DET-003
SHELBY & GRISWOLD**

JOB: 1035-21-1595_DS

DRAW DATE: 09/29/21

PLOT DATE: 10/7/21

DRAWN BY: JRG

TITLE: PLAN VIEW

SHEET: 03 OF 11

K:\1035-IKE\1035-21-1595 IKE - Shelby & Griswold\DWG\1035-21-1595_DS.dwg; 10/7/2021 12:11 PM;

K:\1035-IKE\1035-21-1595 IKE - Shelby & Griswold\DWG\1035-21-1595_DS.dwg; 10/7/2021 12:11 PM;

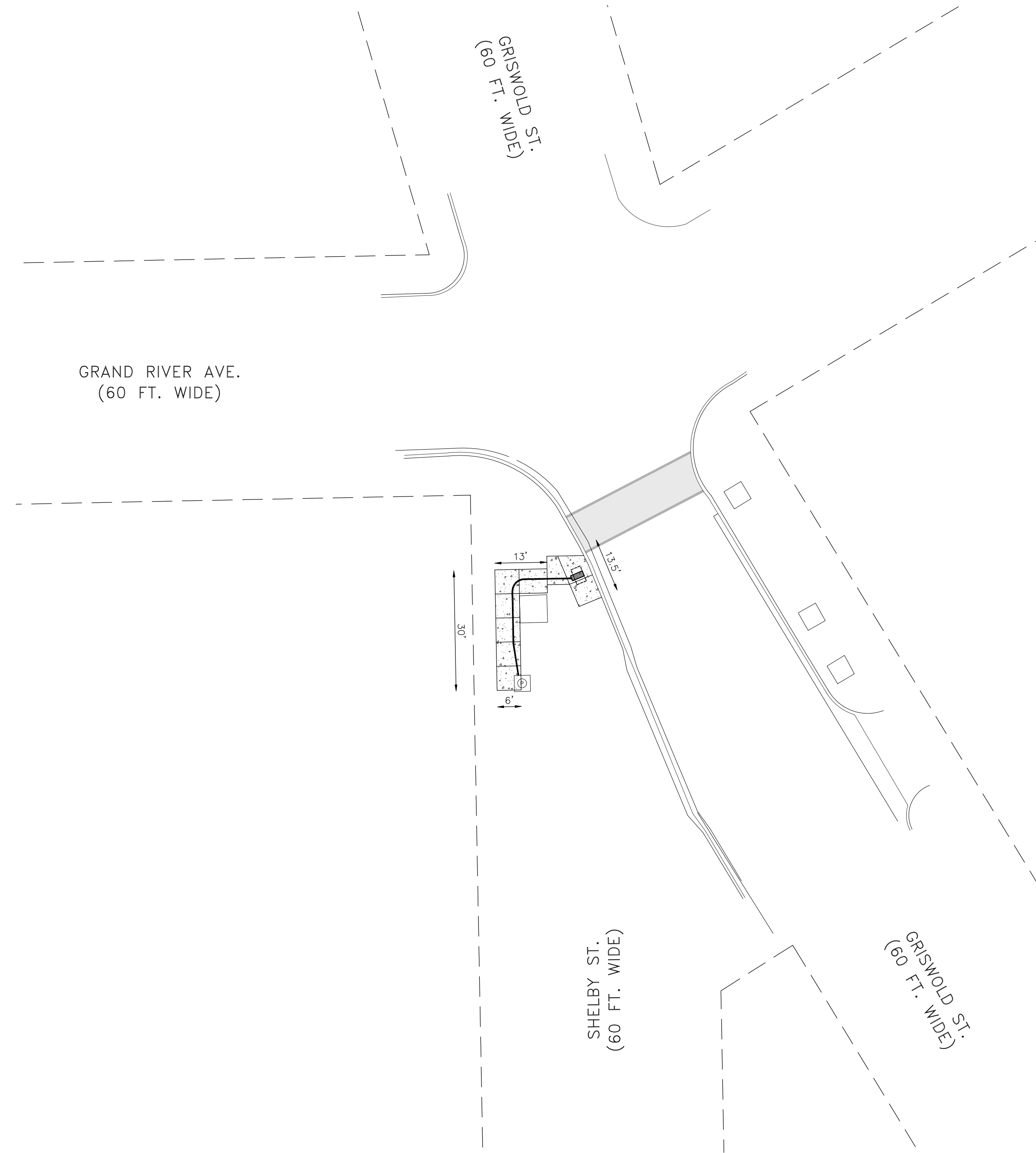





RESTORATION PLAN VIEW
SCALE 1"=20'

THE ADA RAMP SHALL BE RECONSTRUCTED IN ACCORDANCE WITH MDT STANDARD DETAIL R-29-L, CED MODIFIED, AS NEED

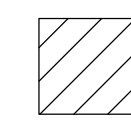
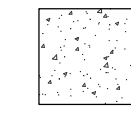
SIDEWALKS AND ENTRANCES TO BUILDINGS, REAL PROPERTY, AND THE LIKE SHALL NOT BE BLOCKED EXCEPT FOR SHORT DURATIONS (LESS THAN 10 MINUTES AT A TIME), ONLY IN COORDINATION WITH PROPERTY OWNERS / RESIDENTS. PEDESTRIAN ACCESS SHALL BE MAINTAINED AT ALL TIMES TO EACH PROPERTY. IT IS THE RESPONSIBILITY OF THE CONTRACTOR TO COORDINATE ALL NECESSARY SIDEWALK CLOSURES AT LEAST 24 HOURS IN ADVANCE WITH THE PROPERTY OWNERS / RESIDENT IN THE AFFECTED AREAS OF CONSTRUCTION.

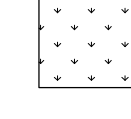
RESTORATION LEGEND & SUMMARY

-  CONCRETE SUB GRADE TO NEAREST JOINT
SAW CUT & REMOVE: 0 SQ FT
-  CONCRETE SIDEWALK REMOVE & REPLACE: 310 SQ FT
-  ASPHALT STREET SAW CUT & RESTORATION: 0 SQ FT
-  SOD RESTORATION: 0 SQ FT
-  CURB & OUTER RESTORATION: 0 LF FT

- RESTORATION NOTES:
1. RESTORE PAVEMENT MARKINGS AS REQUIRED
 2. RESTORE IN QUANTITIES SUFFICIENT TO ADHERE
 3. TO CITY OF DETROIT PAVEMENT SPECIFICATIONS.

CONSTRUCTION SITE SAFETY IS THE RESPONSIBILITY OF THE CONTRACTOR. NEITHER THE OWNER NOR THE ENGINEER SHALL BE EXPECTED TO ASSUME ANY RESPONSIBILITY FOR SAFETY OF THE WORK, OF PERSONS ENGAGED IN THE WORK, OF ANY NEARBY STRUCTURES, OR OF ANY OTHER PERSONS.
COPYRIGHT © 2021 METRO ENGINEERING SOLUTIONS; ALL RIGHTS RESERVED.

THE LOCATIONS OF EXISTING UNDERGROUND UTILITIES ARE SHOWN IN AN APPROXIMATE WAY ONLY AND HAVE NOT BEEN INDEPENDENTLY VERIFIED. THE CONTRACTOR SHALL DETERMINE THE EXACT LOCATION OF ALL EXISTING UTILITIES BEFORE COMMENCING WORK, AND AGREES TO BE FULLY RESPONSIBLE FOR ANY AND ALL DAMAGES WHICH MIGHT BE OCCASIONED BY THE CONTRACTOR'S FAILURE TO EXACTLY LOCATE AND PRESERVE ANY AND ALL UNDERGROUND UTILITIES.

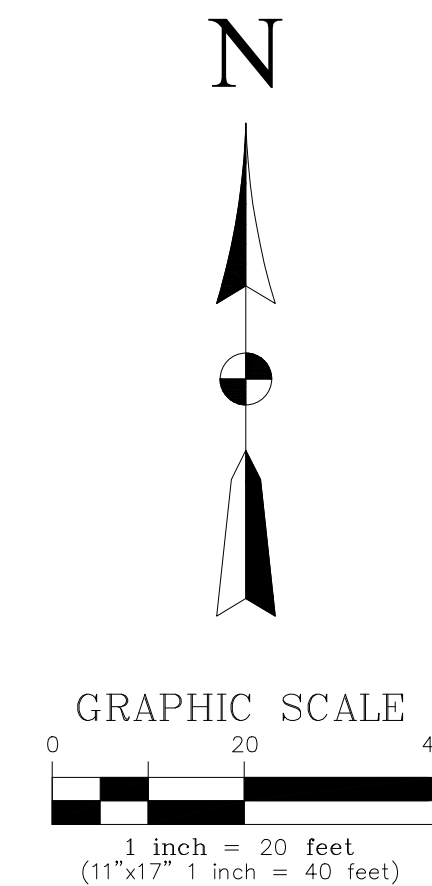

ike SMART CITY
250 N HARTFORD AVE
COLUMBUS, OHIO 43222
PHONE: 614.589.0087

METRO ENGINEERING SOLUTIONS
33900 SCHOOLCRAFT RD
LIVONIA, MICHIGAN 48150
PHONE: 734.483.1427 FAX: 734.483.3431
www.metroes.net



October 7, 2021
CONTRACTOR/AS-BUILT

ISSUED FOR:	DATE:	REV:

SITE NAME:
DET-003
SHELBY & GRISWOLD

JOB: 1035-21-1595_DS
DRAW DATE: 09/29/21
PLOT DATE: 10/7/21
DRAWN BY: JRG
TITLE: RESTORATION PLAN
SHEET: 04 OF 11

K:\1035-IKE\1035-21-1595 IKE - Shelby & Griswold\DWG\1035-21-1595_DS.dwg; 10/7/2021 12:11 PM;

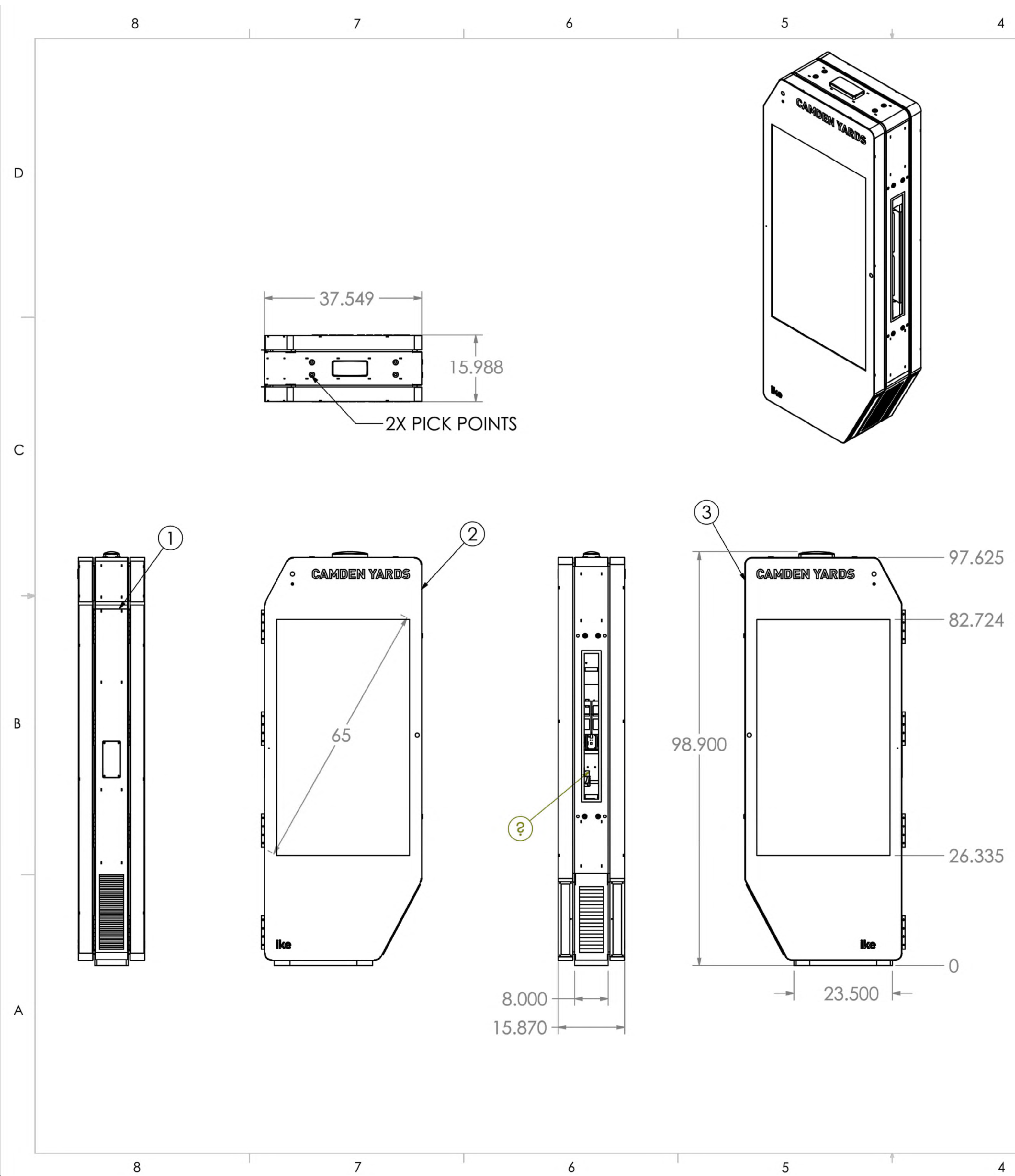

REVISIONS			
REV.	DESCRIPTION	DRAWN BY	DATE
A	INITIAL RELEASE	CCW	12/26/2017
B	MULTIPLE CHANGES MADE	CCW	6/26/2018

ITEM #	QTY	PART #	PURCHASED PART #	DESCRIPTION
1	1	8275-02311		PENTAGRAM/IKE KIOSK, CABINET ASSEMBLY
2	1	8275-02360		DOOR "A" ASSY
3	1	8275-02400		DOOR "B" ASSY
4	1	8412-00810		AIR CONDITIONER ASY 12K BTU/110V

UNLESS OTHERWISE SPECIFIED: DIMENSIONS ARE IN INCHES TOLERANCES: .XX = ± .020 .XXX = ± .010 .XXXX = ± .0050 ANGLE: ± .5° INTERPRET DRAWING PER Y14.100. DIMENSIONS AND TOLERANCES ARE IN ACCORDANCE WITH ASME Y14.5 - 2009. THIRD ANGLE PROJECTION DO NOT SCALE DRAWING	DRAWN BY CCW	DISPLAY DEVICES, INC GOLDEN, CO TITLE: PENTAGRAM/IKE KIOSK
	MATERIAL FINISH PROPRIETARY AND CONFIDENTIAL THE INFORMATION CONTAINED IN THIS DRAWING IS THE SOLE PROPERTY OF DISPLAY DEVICES, INC. ANY REPRODUCTION IN PART OR AS A WHOLE WITHOUT THE WRITTEN PERMISSION OF DISPLAY DEVICES, INC IS PROHIBITED.	
		REV B
		SCALE: 1:26

ike SMART CITY
 250 N HARTFORD AVE
 COLUMBUS, OHIO 43222
 PHONE: 614.589.0087

METRO ENGINEERING SOLUTIONS
 33900 SCHOOLCRAFT RD
 LIVONIA, MICHIGAN 48150
 PHONE: 734.483.1427 FAX: 734.483.3431
 www.metroes.net



October 7, 2021
 CONTRACTOR/AS-BUILT

REV.	DATE:	ISSUED FOR:

SITE NAME:
 DET-003
 SHELBY & GRISWOLD

JOB: 1035-21-1595_DS
 DRAW DATE: 09/29/21
 PLOT DATE: 10/7/21
 DRAWN BY: JRG
 TITLE: IKE KIOSK
 SHEET: 05 OF 11

CONSTRUCTION SITE SAFETY IS THE RESPONSIBILITY OF THE CONTRACTOR. NEITHER THE OWNER NOR THE ENGINEER SHALL BE EXPECTED TO ASSUME ANY RESPONSIBILITY FOR SAFETY OF THE WORK, OF PERSONS ENGAGED IN THE WORK, OF ANY NEARBY STRUCTURES, OR OF ANY OTHER PERSONS.
 COPYRIGHT © 2021 METRO ENGINEERING SOLUTIONS; ALL RIGHTS RESERVED.

THE LOCATIONS OF EXISTING UNDERGROUND UTILITIES ARE SHOWN IN AN APPROXIMATE WAY ONLY AND HAVE NOT BEEN INDEPENDENTLY VERIFIED. THE CONTRACTOR SHALL DETERMINE THE EXACT LOCATION OF ALL EXISTING UTILITIES BEFORE COMMENCING WORK, AND AGREES TO BE FULLY RESPONSIBLE FOR ANY AND ALL DAMAGES WHICH MIGHT BE OCCASIONED BY THE CONTRACTOR'S FAILURE TO EXACTLY LOCATE AND PRESERVE ANY AND ALL UNDERGROUND UTILITIES.



COMPONENTS LAYOUT

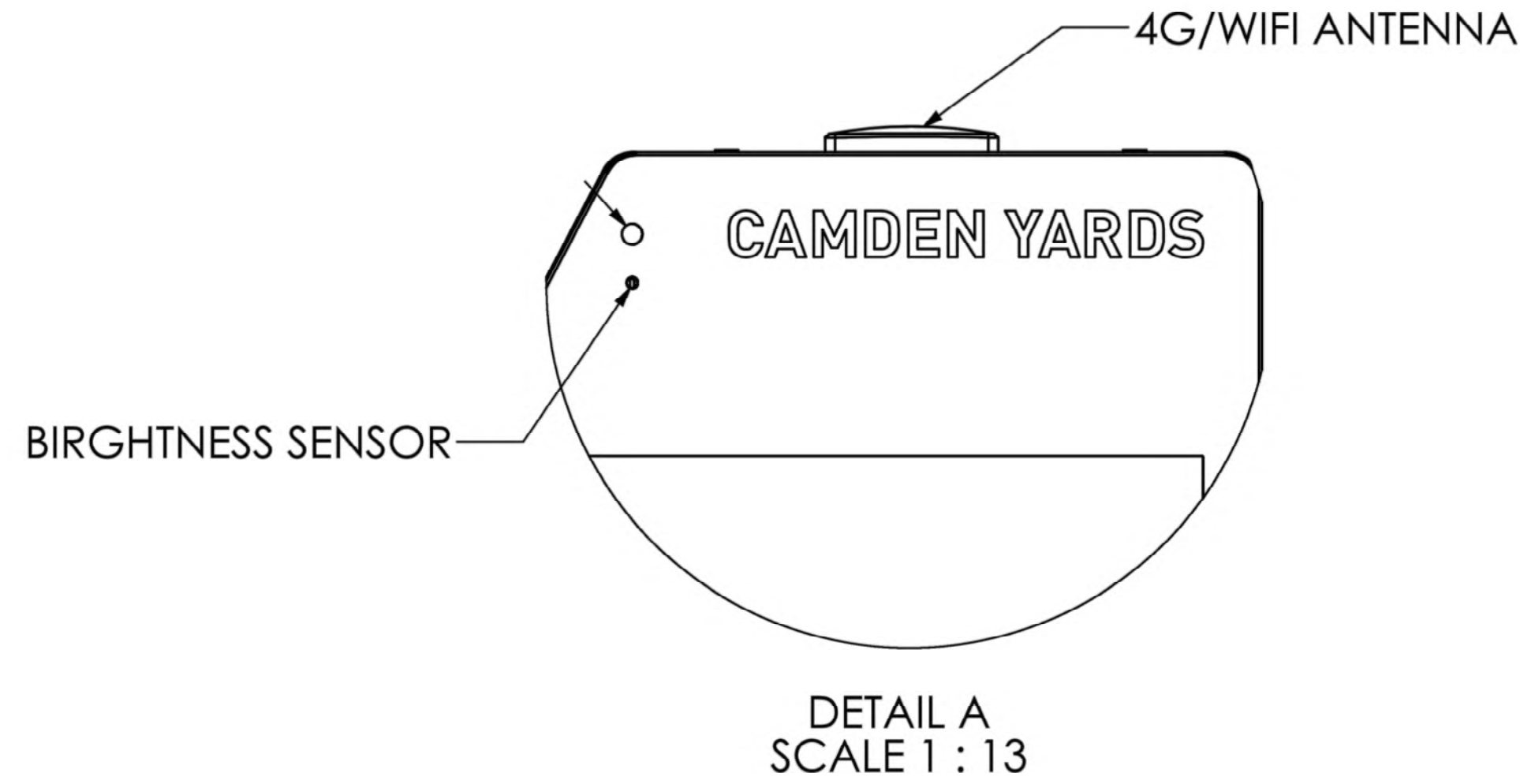
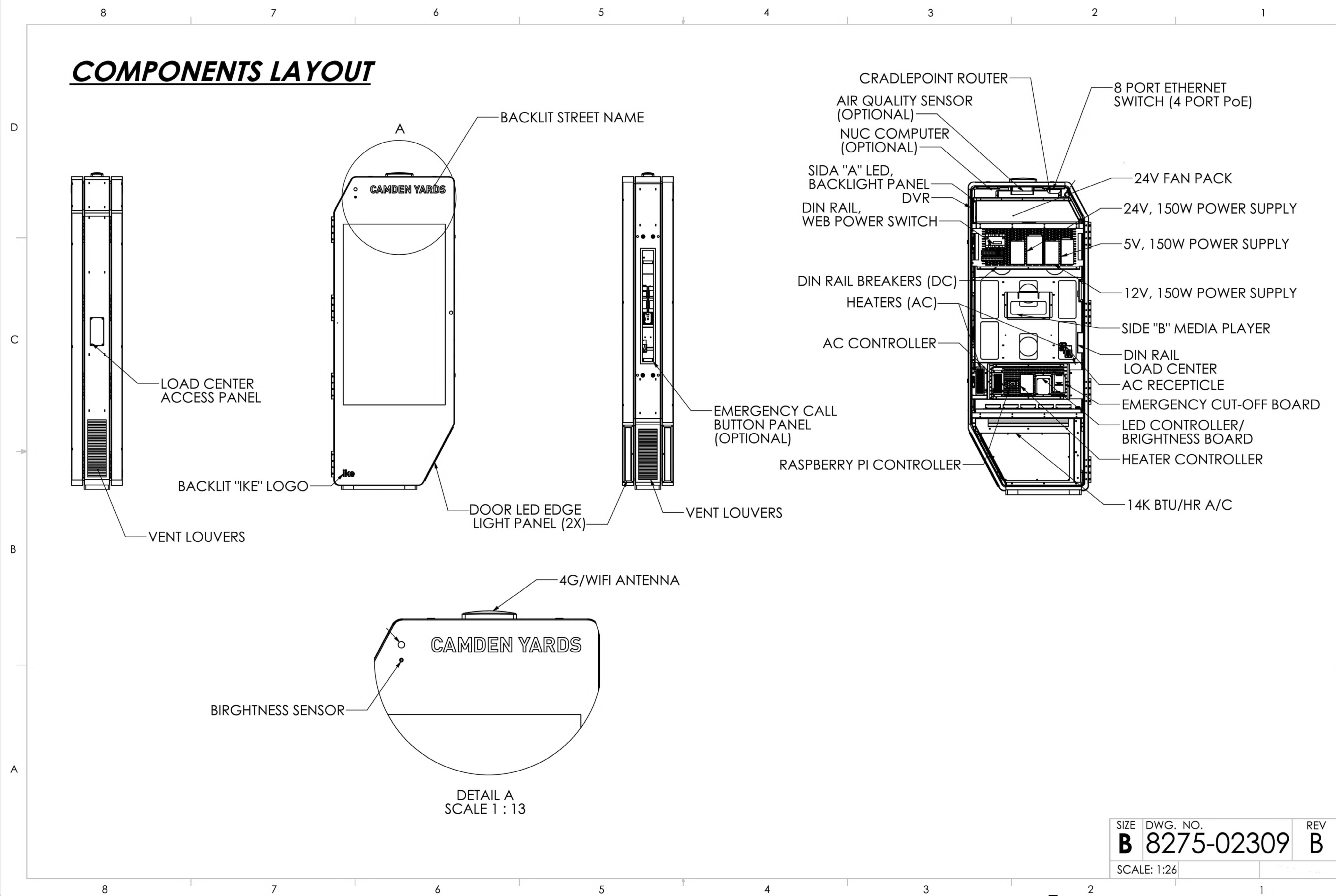

SIZE	DWG. NO.	REV
B	8275-02309	B
SCALE: 1:26		

ike SMART CITY
 250 N HARTFORD AVE
 COLUMBUS, OHIO 43222
 PHONE: 614.589.0087

METRO ENGINEERING SOLUTIONS
 33900 SCHOOLCRAFT RD
 LIVONIA, MICHIGAN 48150
 PHONE: 734.483.1427 FAX: 734.483.3431
 www.metroes.net



October 7, 2021
 CONTRACTOR/AS-BUILT

ISSUED FOR:	
DATE:	
REV:	

SITE NAME:
 DET-003
 SHELBY & GRISWOLD

JOB:	1035-21-1595_DS
DRAW DATE:	09/29/21
PLOT DATE:	10/7/21
DRAWN BY:	JRG
TITLE:	IKE KIOSK
SHEET:	06 OF 11

K:\1035-IKE\1035-21-1595_IKE - Shelby & Griswold\DWG\1035-21-1595_DS.dwg; 10/7/2021 12:11 PM;

CONSTRUCTION SITE SAFETY IS THE RESPONSIBILITY OF THE CONTRACTOR. NEITHER THE OWNER NOR THE ENGINEER SHALL BE EXPECTED TO ASSUME ANY RESPONSIBILITY FOR SAFETY OF THE WORK, OF PERSONS ENGAGED IN THE WORK, OF ANY NEARBY STRUCTURES, OR OF ANY OTHER PERSONS.
 COPYRIGHT © 2021 METRO ENGINEERING SOLUTIONS; ALL RIGHTS RESERVED.

THE LOCATIONS OF EXISTING UNDERGROUND UTILITIES ARE SHOWN IN AN APPROXIMATE WAY ONLY AND HAVE NOT BEEN INDEPENDENTLY VERIFIED. THE CONTRACTOR SHALL DETERMINE THE EXACT LOCATION OF ALL EXISTING UTILITIES BEFORE COMMENCING WORK, AND AGREES TO BE FULLY RESPONSIBLE FOR ANY AND ALL DAMAGES WHICH MIGHT BE OCCASIONED BY THE CONTRACTOR'S FAILURE TO EXACTLY LOCATE AND PRESERVE ANY AND ALL UNDERGROUND UTILITIES.



STRUCTURAL GENERAL NOTES

DESIGN LOADS & GOVERNING BUILDING CODE

- Code: Michigan Building Code (MBC) - 2015 Edition
- Kiosk: Dead Load = 700 lbs
- Wind: Nominal Design Wind Speed, V_{ASD} = 81 MPH (3-Second Gust)
Ultimate Design Wind Speed, V_{ULT} = 105 MPH (3-Second Gust)
Exposure = C
 $p = 27.7$ psf
- Seismic: Seismic Design Category = B
Risk Category = 1

GENERAL CONSTRUCTION NOTES

- The Structural Contract Documents are intended to be used in conjunction with the plans of all other disciplines working on the project. The contractor is responsible for the coordination of all required information.
- Modifications to the Structural Contract Documents due to conditions at the site that are unknown or concealed at the time of design do not fall within the original scope of work of the project. Required modifications shall be performed as additional services as outlined in the project contract. The Engineer shall be notified in writing by an (RFI) to provide recommendations for resolution of the modification requested.
- Dimensions and elevations indicated on the Structural Contract Documents shall be coordinated by the contractor with all other disciplines prior to the beginning of construction. Discrepancies shall be brought to the attention of Display Devices, Inc. and Anchor Engineering, Inc. Scaling of the Structural Contract Documents is not permitted.
- The contractor shall verify field conditions including existing utilities, sub-grade and above grade conditions which may interfere with construction and notify the applicable disciplines for modifications as required.
- In the event of discrepancies between project specifications, general notes, plans and details, the most stringent requirements shall apply unless approved in writing.

EXISTING CONSTRUCTION

- Preparation of the Structural Contract Documents is based on available existing construction documents and third-party site observations of exposed conditions. Actual field conditions exposed during construction and found to conflict with the Structural Contract Documents shall be brought to the attention of the Display Devices, Inc. and Anchor Engineering, Inc.
- Prior to the construction phase of the project, the contractor shall become familiar with the existing structure and all aspects that may influence the construction process.
- Owner and Anchor Engineering, Inc. shall be contacted in the event of uncovered elements found during the project that appear to be unsound or otherwise structurally deficient.

FOUNDATION DESIGN (Footings)

- The foundation design is based on conclusions & recommendations found in the geotechnical report project #03811252 provided by intertek psi dated August 19, 2021. All recommendations found in this report shall be followed, including site preparation. A copy of this soils report is available for review at the Structural Engineers office, the Architects office, or the job site trailer.
- Conventional Spread Footings:
 - a. Maximum Allowable Bearing Pressure..... 1,500 psf
 - b. Minimum Frost Depth..... 42"
- The site shall be prepared in accordance w/ the project geotechnical report prior to foundation construction.
- All footings shall be placed on adequate bearing stratum or to a min. depth as shown on the drawings, whichever is deeper.

REINFORCED CONCRETE

- Design is based on "Building Code Requirements for Reinforced Concrete" (ACI 318 - Latest Edition). Concrete work shall conform to "Specifications for Structural Concrete for Buildings" (ACI 301 - Latest Edition). Hot and cold weather shall be in conformance with ACI 305 and ACI 306 respectively.
- Structural concrete shall have minimum 28-day compressive strength of 4000 psi.
- Cement shall be Portland Cement as noted above, conforming to ASTM C150.
- Aggregate size shall not exceed $\frac{3}{4}$ "
- Chloride admixtures shall not be used.
- Concrete exposed to weather shall have a minimum air entrainment of $6 \pm 1\frac{1}{2}$ percent.
- Fly ash shall conform to ASTM specification C618, class C or class F. Fly ash shall not exceed 20% of the total weight of cementitious material.
- Reinforcing Bars shall conform to ASTM A615 or ASTM A706. All bars shall be Grade 60. Detailing, fabrication, and placement of reinforcing steel shall be in accordance with the "Manual of Standard Practice for Detailing Reinforced Concrete Structures (ACI 315 - latest ed.)".

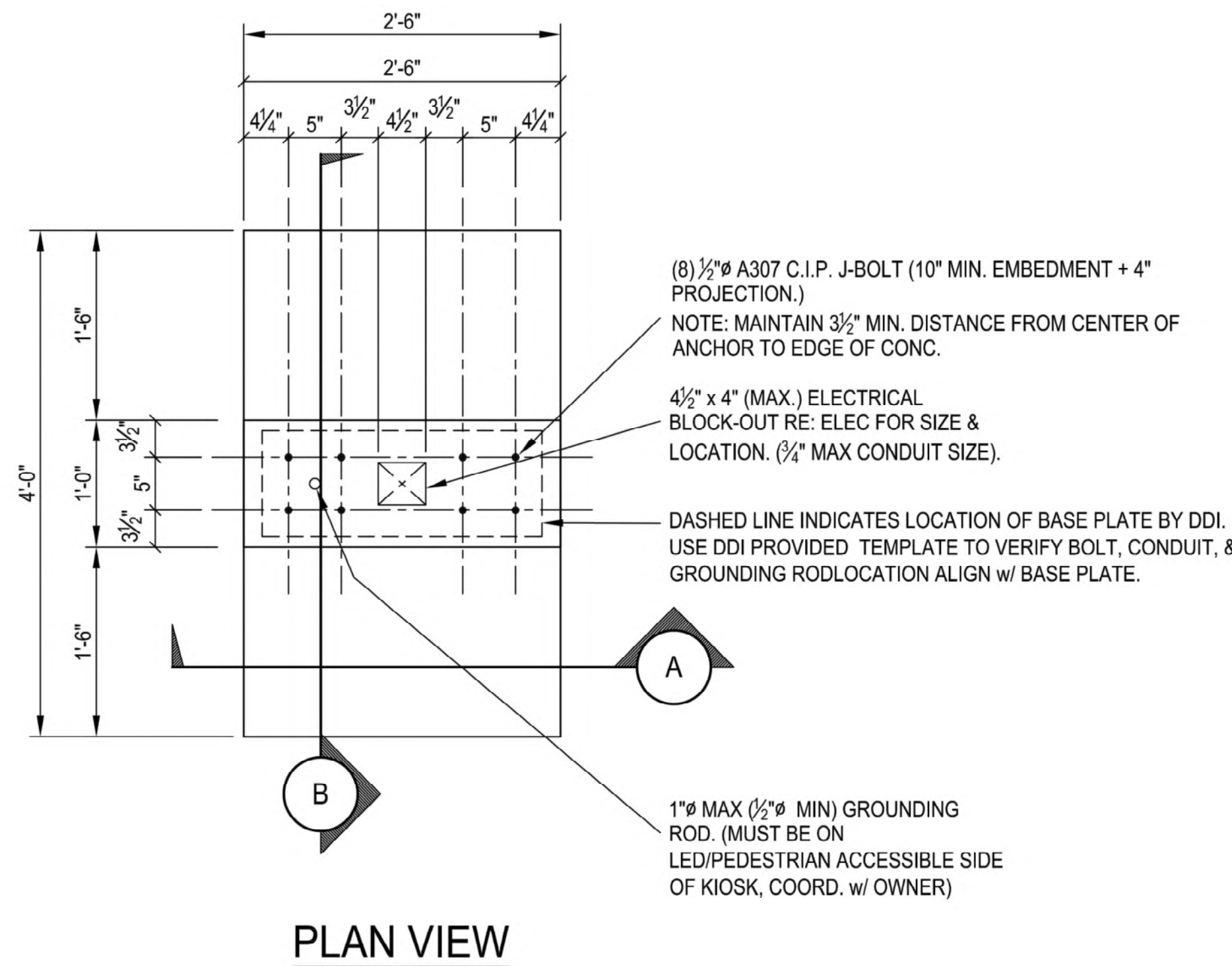

ADDRESS SCHEDULE	
KIOSK ID	ADDRESS
DET-001	LIBRARY ST & FARMER ST.
DET-003	SHELBY ST. & GRISWOLD ST.
DET-004	CADILLAC SQUARE & WOODWARD AVE
DET-005	WOODWARD & E. CONGRESS ST
DET-013	OUTER DRIVE W & LIVERNOIS AVE

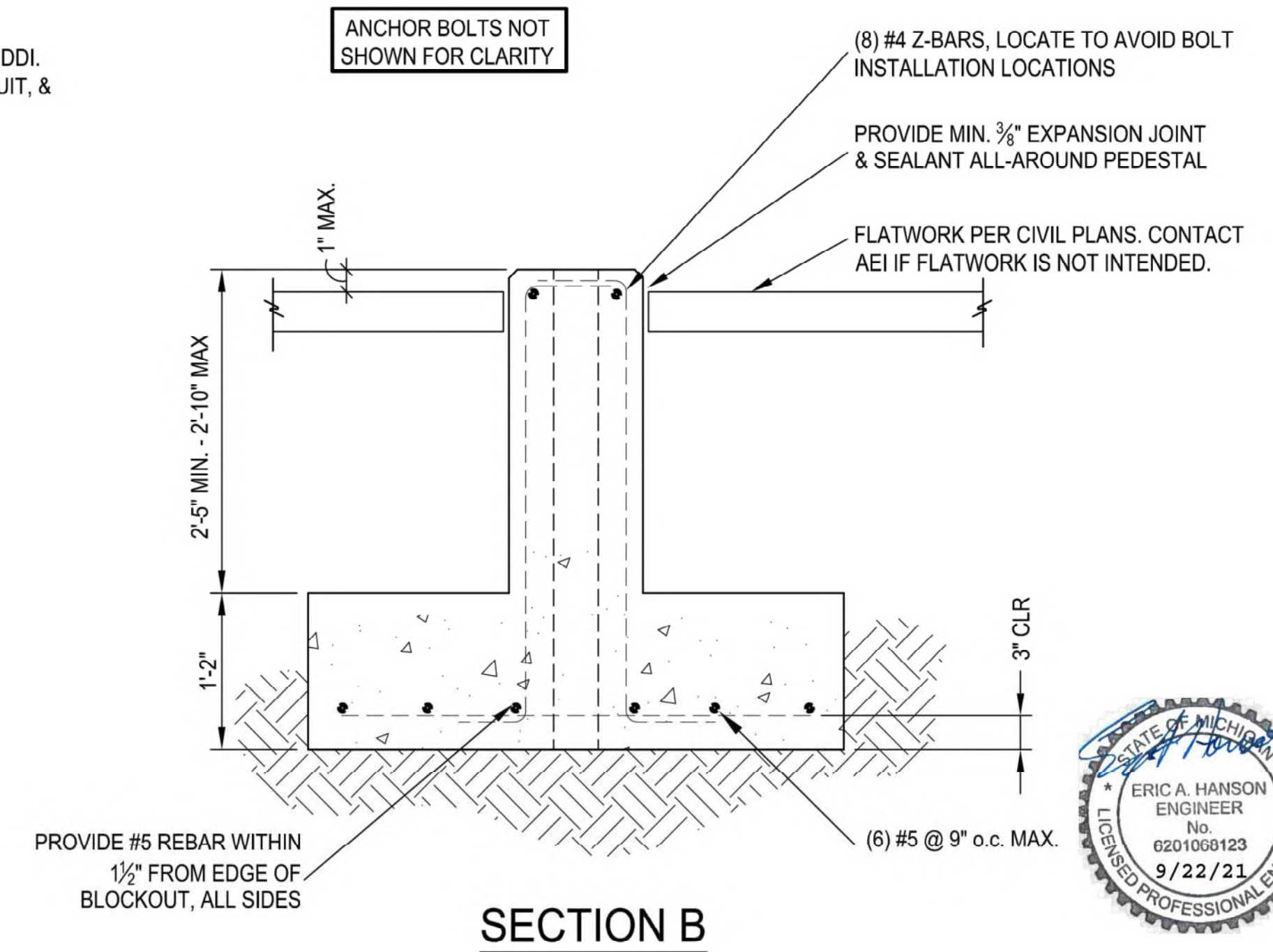
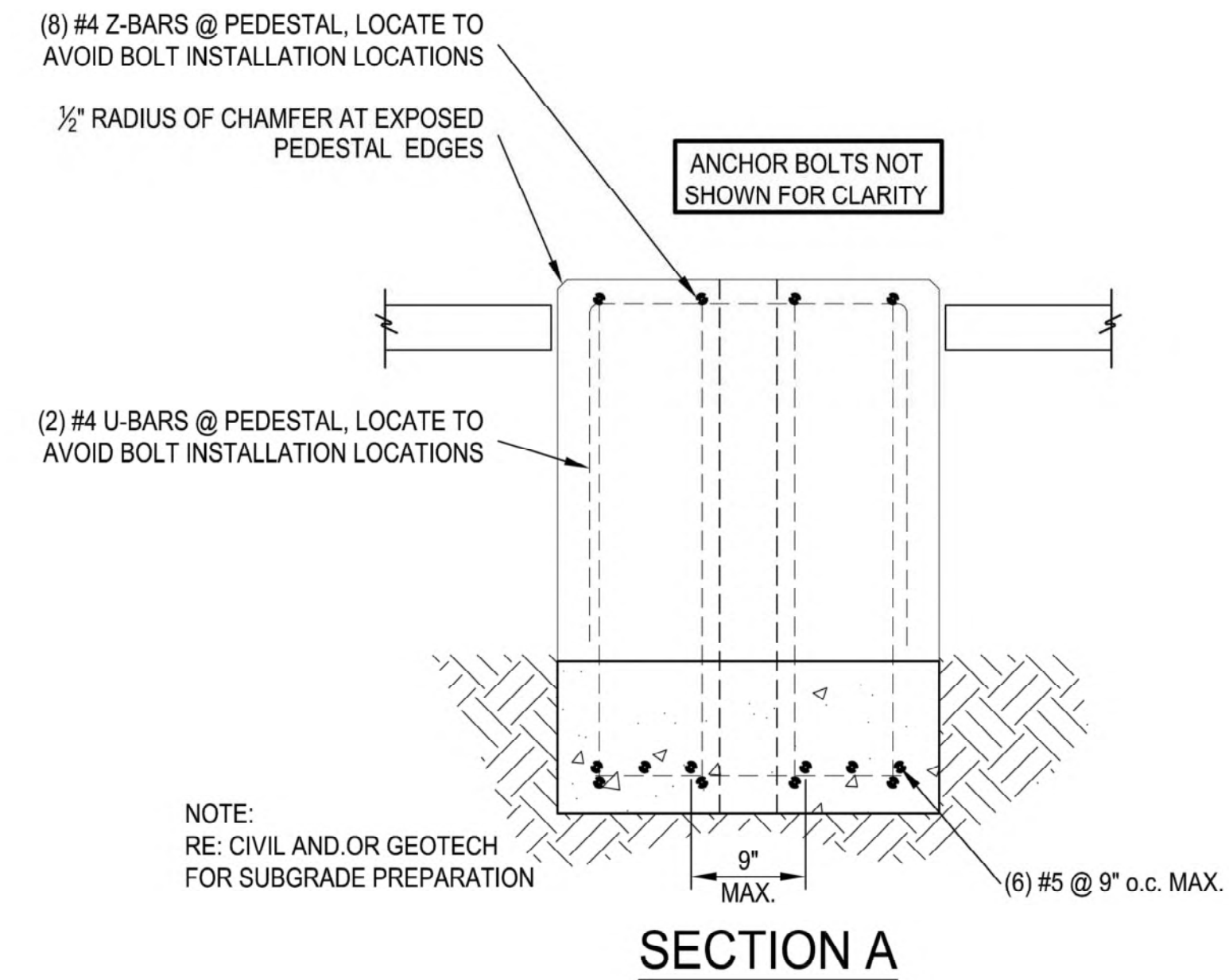

ISSUED FOR CONSTRUCTION
DATE: SEPTEMBER 22, 2021

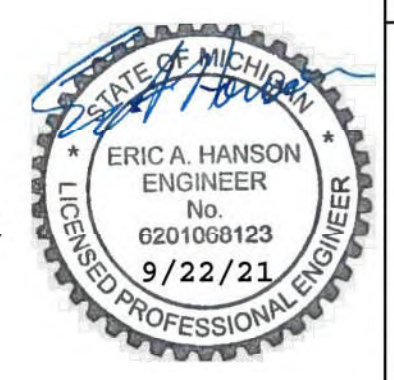

2535 17th Street
Denver, CO 80211
303-783-4797
anchoreng.com

ANCHOR ENGINEERING
STRUCTURAL ENGINEERS

CHM
DRAWN BY: EAH
CHECKED BY: EAH
APPROVED BY: EAH
PROJECT NO.: 180304
ISSUE DATE: 09/22/2019

Kimley-Horn
© 2018 KIMLEY-HORN AND ASSOCIATES, INC.

IKE KIOSK FOUNDATION

IKE SMART CITY - DETROIT, MI
CONSTRUCTION DOCUMENTS

S1.0

K:\1035-IKE\1035-21-1595-IKE - Shelby & Griswold\DWG\1035-21-1595_DS.dwg; 10/7/2021 12:11 PM;

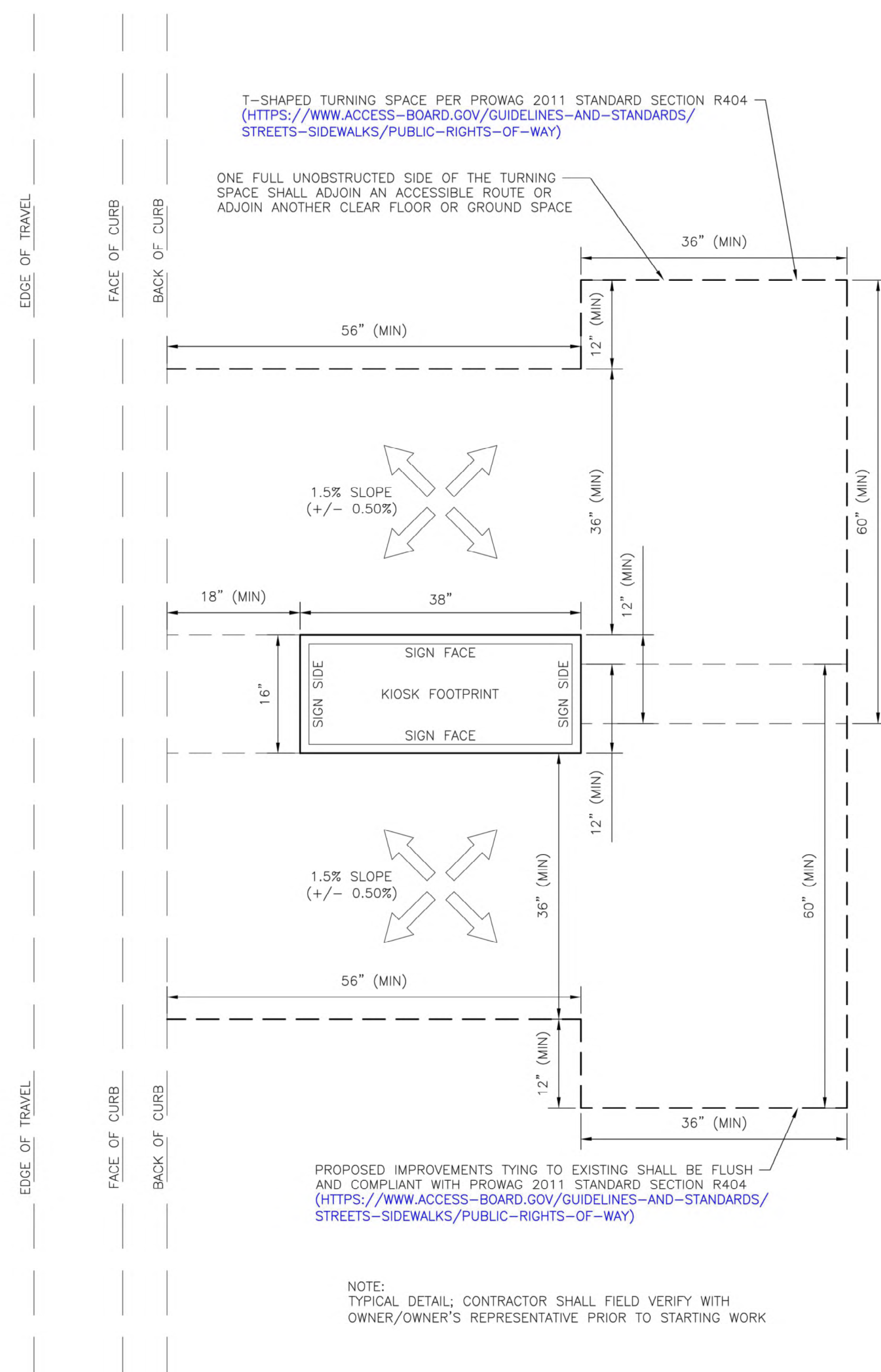

1 T-SHAPED TURNAROUND SPACE
SCALE: 1"=1'

DETAILS ON THIS SHEET PROVIDED BY IKE SMART CITY

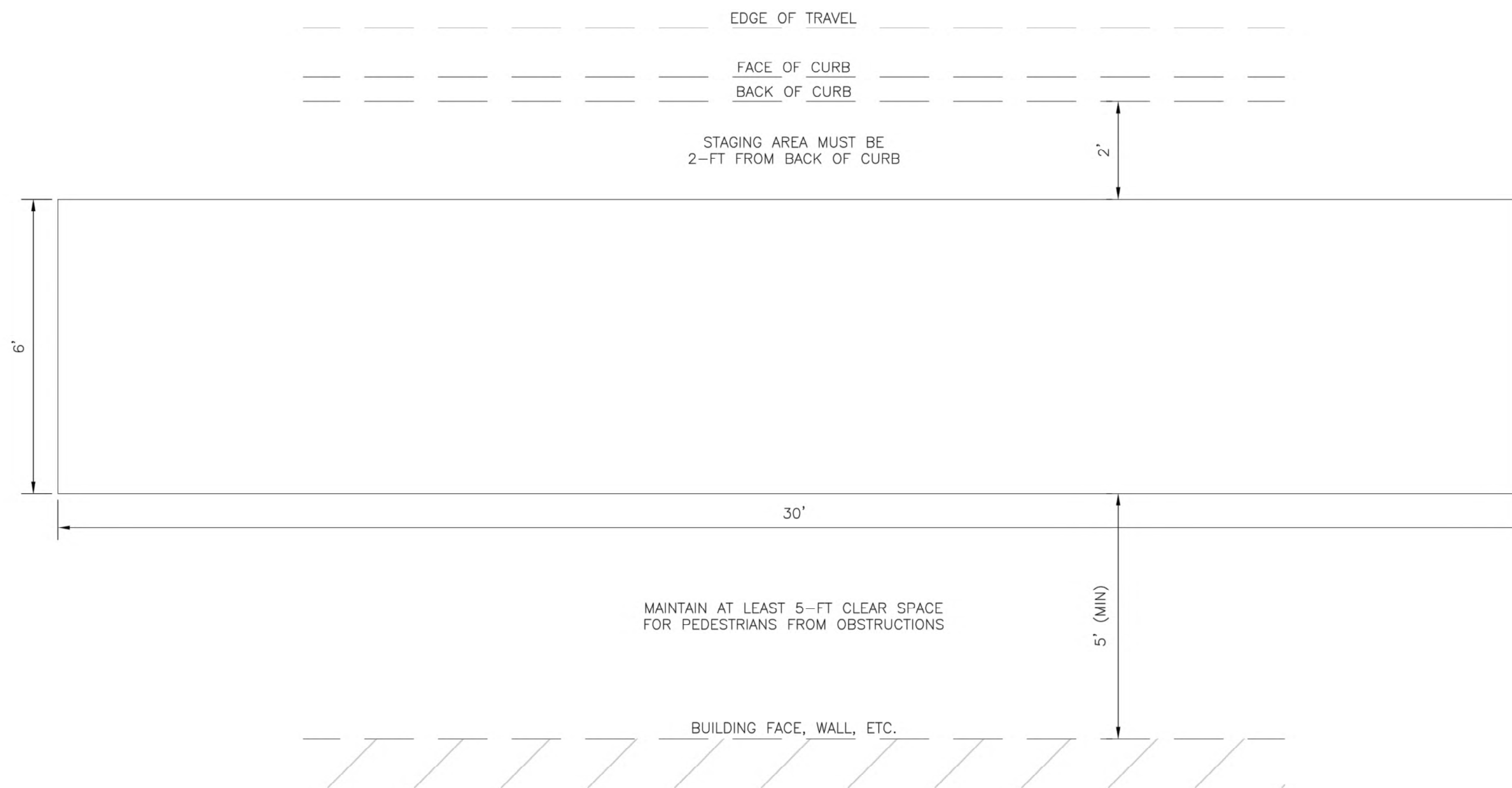

2 CONSTRUCTION STAGING AREA
SCALE: 1"=2'



October 7, 2021
CONTRACTOR/AS-BUILT

REV.	DATE	ISSUED FOR:

SITE NAME:
DET-003
SHELBY & GRISWOLD

JOB: 1035-21-1595_DS

DRAW DATE: 09/29/21

PLOT DATE: 10/7/21

DRAWN BY: JRG

TITLE: ADA SPEC

SHEET: 08 OF 11

K:\1035-IKE\1035-21-1595 IKE - Shelby & Griswold\DWG\1035-21-1595_DS.dwg; 10/7/2021 12:11 PM;

IKE CONSTRUCTION NOTES

1. THE SUBMISSION OF A BID BY THE CONTRACTOR IS NOTIFICATION THAT THE CONTRACTOR HAS TOTALLY FAMILIARIZED THEMSELVES WITH THE CONTRACT DOCUMENTS AND EXISTING SITE CONDITIONS AND HAS AGREED TO PROVIDE THE NECESSARY LABOR AND MATERIAL FOR THE COMPLETE INSTALLATION OF EACH SYSTEM IN A NEAT AND PROFESSIONAL MANNER IN ACCORDANCE WITH THE BEST PRACTICES OF THE INDUSTRY AND IN COMPLIANCE WITH ALL AUTHORITIES HAVING JURISDICTION.
2. THESE DRAWINGS ARE PRESENTED TO THE CONTRACTOR WITH THE UNDERSTANDING THAT THE CONTRACTOR IS AN EXPERT AND COMPETENT IN THE PREPARATION OF CONTRACT BID OF INFORMATION SUCH AS IS CONTAINED IN THESE DOCUMENTS. IT IS THE INTENT OF THE DRAWINGS AND SPECIFICATIONS TO CALL FOR FINISHED WORK, TESTED AND READY FOR OPERATION AND IN COMPLETE CONFORMANCE WITH APPLICABLE CODES, RULES, AND REGULATIONS. MINOR ITEMS NOT USUALLY SHOWN OR SPECIFIED, BUT MANIFESTLY NECESSARY FOR PROPER INSTALLATION AND OPERATION OF THE VARIOUS SYSTEMS SHALL BE INCLUDED IN THE WORK AND IN THE PROPOSAL THE SAME AS IF SPECIFIED OR SHOWN ON THE DRAWINGS. IF ANY DEPARTURES FROM THE DRAWINGS ARE DEEMED NECESSARY, DETAILS OF SUCH DEPARTURES AND THE REASONS THEREFORE SHALL BE SUBMITTED TO THE OWNER FOR APPROVAL. NO DEPARTURES SHALL BE MADE WITHOUT PRIOR APPROVAL.
3. THE CONTRACTOR SHALL VISIT THE SITE AND VERIFY ALL DIMENSIONS IN THE FIELD, AND SHALL ADVISE THE OWNER OF ANY DISCREPANCIES BEFORE PERFORMING THE WORK.
4. THE DRAWINGS INDICATE ARRANGEMENTS AND APPROXIMATE SIZES AND RELATIVE LOCATIONS OF PRINCIPAL APPARATUS, EQUIPMENT, DEVICES, AND SERVICES TO BE PROVIDED. DRAWINGS ARE DIAGRAMMATIC AND ARE A GRAPHIC REPRESENTATION OF CONTRACT REQUIREMENTS BASED ON THE INFORMATION PROVIDED BY THE MANUFACTURER IDENTIFIED IN THE EQUIPMENT SCHEDULE AT THE SCALE INDICATED.
5. LAYOUT OF EQUIPMENT INDICATED ON THE DRAWINGS SHALL BE CHECKED AND COMPARED AGAINST ALL DRAWINGS AND SPECIFICATIONS OF ALL TRADES AND EXACT LOCATIONS DETERMINED USING APPROVED SHOP DRAWINGS OF SUCH EQUIPMENT. WHERE PHYSICAL INTERFERENCES OCCUR, CONSULT WITH THE OWNER AND PREPARE DATED, DIMENSIONED DRAWINGS COORDINATED WITH ALL OTHER TRADES WORKING IN THIS AREA AND CORRECTING SUCH INTERFERENCE.
6. THE CONTRACTOR SHOULD SCHEDULE THEIR WORK IN ACCORDANCE WITH THE CONSTRUCTION SCHEDULE SO THAT ALL OF THEIR WORK CAN BE INSTALLED WITHOUT DELAYING THE PROJECT. ALL WORK RELATED TO SHUTDOWN OF EXISTING SERVICES SHALL BE PERFORMED AT THE HOURS DESIGNATED BY THE OWNER WITH ALL ASSOCIATED COSTS BORNE BY THE CONTRACTOR AT NO COST TO THE OWNER. PROVIDE ANY TEMPORARY FACILITIES REQUIRED TO PERMIT OWNER'S USE OF EXISTING FACILITIES AND SYSTEMS TO REMAIN UNDISTURBED. COORDINATE ALL WORK, INCLUDING ALL SHUTDOWNS THAT AFFECT SYSTEMS AND/OR PORTIONS OF THE BUILDING THAT MUST REMAIN IN OPERATION, WITH OWNER.
7. THE CONTRACTOR SHALL SECURE AND PAY ALL FEES, LICENSES, INSPECTIONS, AND PERMITS PERTAINING TO THE CONTRACT. SUBMIT TO OWNER DUPLICATE CERTIFICATES OF INSPECTION.
8. ALL EQUIPMENT SHALL BE INSTALLED IN STRICT COMPLIANCE WITH THE MANUFACTURER'S WRITTEN INSTRUCTIONS.
9. THE CONTRACTOR SHALL BE RESPONSIBLE FOR WORKMEN'S IDENTIFICATION AND BADGING, SAFETY AND FIRE PROTECTION, BARRICADES, WARNING SIGNS, TRASH REMOVAL, CUTTING AND PATCHING.
10. THE CONTRACTOR SHALL BE RESPONSIBLE FOR ALL RIGGING, HANDLING, AND PROTECTION OF MATERIALS. ALL EQUIPMENT AND MATERIALS SHALL BE NEW AND WITHOUT BLEMISH OR DEFECT. ALL EQUIPMENT INSTALLED SHALL BEAR THE LABEL OF AN APPROVED AGENCY.
11. THE CONTRACTOR SHALL PROVIDE LABOR TO RECEIVE, UNLOAD, STORE, PROTECT, AND TRANSFER TO POINT OF INSTALLATION FOR ALL FURNISHED ITEMS.
12. WHERE CONDUIT, CABLES, DUCTWORK, OR PIPING PASSES THROUGH FIRE RATED FLOORS OR WALLS, THE PENETRATION SHALL BE COMPLETELY SEALED WITH A FIRE STOP MATERIAL THAT IS UL LISTED AND ACCEPTED BY THE BUILDING DEPARTMENT AND FIRE DEPARTMENT AS BEING SUITABLE FOR THIS SERVICE. THIS MATERIAL SHALL BE INSTALLED IN ACCORDANCE WITH THE REQUIREMENTS OF THE MANUFACTURER TO MAINTAIN THE UL LISTED FIRE RATING OF THE PENETRATED WALL OR FLOOR.
13. THE CONTRACTOR SHALL BE RESPONSIBLE FOR ALL SLAB OPENINGS, WALL OPENINGS, BEAM PENETRATIONS, AND CORING AS IT RELATES TO THEIR WORK. THE CONTRACTOR SHALL SUBMIT SIZE AND LOCATION FOR REVIEW AND APPROVAL.
14. ALL EXTERIOR WALL OPENINGS SHALL BE SLEEVED, PROPERLY CAULKED, AND SEALED WITH A HIGH QUALITY SEALANT TO PREVENT INFILTRATION OF MOISTURE AND OUTSIDE AIR.
15. THE CONTRACTOR SHALL SUBMIT A SCHEDULE OF SUBMITTALS PRIOR TO SUBMITTING ANY SHOP DRAWINGS, ETC. TO BE SUBMITTED FOR THIS PROJECT, INCLUDING THE ANTICIPATED DATE OF EACH SUBMISSION. THE CONTRACTOR SHALL SUBMIT AN ELECTRONIC COPY OF THE COMPLETE SHOP DRAWINGS AND CATALOG CUTS, WIRING DIAGRAMS AND ASSOCIATED DATA TO THE OWNER FOR APPROVAL PRIOR TO PURCHASING EQUIPMENT OR STARTING ANY WORK. ANY WORK INSTALLED OR EQUIPMENT PURCHASED PRIOR TO RECEIPT OF OWNER APPROVED SHOP DRAWINGS THAT REQUIRES CHANGES SHALL BE REPLACED AT THE CONTRACTOR'S EXPENSE.
16. ALL WORK FURNISHED UNDER THE CONTRACT SHALL BE GUARANTEED AGAINST ANY AND ALL DEFECTS IN WORKMANSHIP AND/OR MATERIALS FOR A PERIOD OF NOT LESS THAN (1) YEAR FROM THE DATE OF FINAL ACCEPTANCE OF THE INSTALLATION, UNLESS NOTED OTHERWISE IN THE PROJECT SPECIFICATIONS, AND ANY DEFECTS OF WORKMANSHIP DEVELOPING DURING THIS PERIOD SHALL BE REMEDIED AND ANY DEFECTIVE MATERIAL REPLACED WITHOUT ADDITIONAL COST TO THE OWNER.
17. INSTALLED SYSTEMS SHALL OPERATE UNDER ALL CONDITIONS OF LOAD WITHOUT SOUND OR VIBRATION THAT IS OBJECTIONABLE TO THE OWNER, OBJECTIONABLE SOUND OR VIBRATION CONDITIONS DUE TO WORKMANSHIP SHALL BE CORRECTED IN AN APPROVED MANNER BY THE CONTRACTOR AT THE CONTRACTOR'S EXPENSE.
18. THE CONTRACTOR SHALL NOTIFY OWNER OF COMPLETION OF ALL WORK, INDICATING THE CONTRACTOR IS READY FOR THE OWNER TO PERFORM THE FINAL PUNCH LIST INSPECTION.
19. UPON COMPLETION OF ALL UNFINISHED OR FAULTY WORK NOTED IN THE OWNER'S FINAL PUNCH LIST, THE CONTRACTOR SHALL SUBMIT TO THE OWNER IN WRITING A LETTER OF COMPLETION CERTIFYING THAT ALL PUNCH LIST ITEMS HAVE BEEN COMPLETED AND ALL AS-BUILTS, MANUALS, ETC. HAVE BEEN SUBMITTED.
20. SHOULD A CONTRACTOR REQUIRE REMOVAL, RELOCATION, OR REROUTING OF ANOTHER TRADE'S WORK THAT IS NOT INDICATED ON DRAWINGS, THE CONTRACTOR REQUIRING SUCH WORK SHALL BE RESPONSIBLE FOR THAT WORK, AND PAY ALL REQUIRED COSTS.
21. ALL WORK INVOLVING ALTERATIONS TO EXISTING SYSTEMS, EQUIPMENT, AND MATERIALS SHALL BE REVIEWED WITH THE OWNER BEFORE BEGINNING WORK.
22. DEFINITION: UNLESS OTHERWISE NOTED, ALL WORK SPECIFIED HEREIN OR NOTED ON DRAWINGS, SHALL BE BY THE CONTRACTOR. THE TERM "PROVIDE" WHENEVER ENCOUNTERED ON DRAWINGS OR IN THESE SPECIFICATIONS, SHALL MEAN "FURNISH AND INSTALL."
23. CODES AND STANDARDS: ALL MATERIALS AND WORKMANSHIP SHALL COMPLY WITH THE CURRENT EDITION OF THE NATIONAL ELECTRICAL CODE, ALL APPLICABLE CODES, SPECIFICATIONS, LOCAL ORDINANCES, INDUSTRY STANDARDS, UTILITY COMPANY REGULATIONS, AND FIRE INSURANCE CARRIER'S REQUIREMENTS.
24. MATERIALS: ALL MATERIALS FURNISHED BY THIS CONTRACTOR, SHALL BE NEW AND BEAR THE LABEL OR LISTING OF A NATIONALLY RECOGNIZED INDEPENDENT TESTING LABORATORY.
25. OUTLET AND SWITCH BOXES: PROVIDE AND INSTALL OUTLET BOXES OF PROPER TYPE AND SIZE AS REQUIRED AT ALL OUTLETS WHERE SHOWN. SECURED FIRMLY IN PLACE AND SET TRUE AND SQUARE AND FLUSH WITH THE FINISHED SURFACE.
26. WIRING: WIRES SHALL BE COPPER WITH XHHW OR OTHER XLP INSULATION RATED FOR THE LOCATIONS IN WHICH THEY ARE INSTALLED. ALL RACEWAYS ARE SHOWN DIAGRAMMATICALLY, EXACT LOCATION TO BE DETERMINED ON THE JOB. THE CONTRACTOR SHALL ARRANGE ALL NEW CIRCUITS IN PANELS SO AS TO BALANCE THE LOAD ON ALL PHASES.
27. A TYPED DIRECTORY CARD SHALL BE PROVIDED IN EACH PANEL WITH ADDED CIRCUITS TO INDICATE THE LOADS ACTUALLY SERVED.
28. GROUNDING: SHALL BE IN STRICT ACCORDANCE WITH THE NATIONAL ELECTRICAL CODE ARTICLE 250. PROVIDE GROUND WIRES AS REQUIRED AND RESIZE CONDUIT IF NECESSARY.
29. DEMONSTRATION OF COMPLETE ELECTRICAL SYSTEMS: UPON COMPLETION OF THE WORK THE CONTRACTOR SHALL OBTAIN A CERTIFICATE OF APPROVAL FROM THE RESPECTIVE INSPECTION AGENCIES. THE CONTRACTOR SHALL NOTIFY AND MAKE ALL THE NECESSARY ARRANGEMENTS WITH THE INSPECTING AGENCY AND LOCAL AUTHORITIES SO THAT INSPECTION MAY BE CARRIED OUT AT THE PROPER TIME.

CONSTRUCTION SITE SAFETY IS THE RESPONSIBILITY OF THE CONTRACTOR. NEITHER THE OWNER NOR THE ENGINEER SHALL BE EXPECTED TO ASSUME ANY RESPONSIBILITY FOR SAFETY OF THE WORK, OF PERSONS ENGAGED IN THE WORK, OF ANY NEARBY STRUCTURES, OR OF ANY OTHER PERSONS.
 COPYRIGHT © 2021 METRO ENGINEERING SOLUTIONS; ALL RIGHTS RESERVED.

THE LOCATIONS OF EXISTING UNDERGROUND UTILITIES ARE SHOWN IN AN APPROXIMATE WAY ONLY AND HAVE NOT BEEN INDEPENDENTLY VERIFIED. THE CONTRACTOR SHALL DETERMINE THE EXACT LOCATION OF ALL EXISTING UTILITIES BEFORE COMMENCING WORK, AND AGREES TO BE FULLY RESPONSIBLE FOR ANY AND ALL DAMAGES WHICH MIGHT BE OCCASIONED BY THE CONTRACTOR'S FAILURE TO EXACTLY LOCATE AND PRESERVE ANY AND ALL UNDERGROUND UTILITIES.

ike SMART CITY

250 N HARTFORD AVE
 COLUMBUS, OHIO 43222
 PHONE: 614.589.0087

METRO ENGINEERING SOLUTIONS

33900 SCHOOLCRAFT RD
 LIVONIA, MICHIGAN 48150
 PHONE: 734.483.1427 FAX: 734.483.3431
 www.metroes.net



October 7, 2021

CONTRACTOR / AS-BUILT

REV.	DATE:	ISSUED FOR:							

SITE NAME:
 DET-003
 SHELBY & GRISWOLD

JOB: 1035-21-1595_DS

DRAW DATE: 09/29/21

PLOT DATE: 10/7/21

DRAWN BY: JRG

TITLE: CONST NOTES

SHEET: 09 OF 11

TraFFix Devices Inc. **ADA WALL™**

ADA WALL meets ADA Requirements

- MASH Tested, Passed, Eligible as Longitudinal Channelizing Device, TL-3.
- Two Step-N-Deploy Legs Make Deployment Quick, Easy and Safe
- Made of UV stabilized, high density polyethylene, the linkable ADA Walls quickly and easily link together in 6 foot sections to allow the contractor flexibility in creating a safe pedestrian pathway.
- Weighing only 23 lbs., the durable, yet lightweight design makes the ADA Wall easy to lift on and off the truck and easy to connect.
- The ten molded-in vertical windows reduce wind load, add strength and stability, and reduce overall weight of the ADA Wall. They also allow a guide dog to see what is on the other side of the wall.
- Two recessed areas measuring 8" wide x 53" long on each side of the ADA Wall accommodate reflective sheeting.
- Standard colors are orange and white. Custom colors also available upon request.
- The TraFFix ADA Wall can accommodate uneven surfaces to create a clear safe pedestrian pathway.

Blow Molded Connectors Provide Strength and Flexibility.

- MUNICIPAL PARKING WILL BE IMPEDED DURING THIS TEMPORARY TRAFFIC CONTROL MEASURE.
- PEDESTRIAN TRAVEL WILL BE IMPEDED DURING THIS TEMPORARY TRAFFIC CONTROL MEASURE.
- BUS TRAVEL WILL NOT BE IMPEDED DURING THIS TEMPORARY TRAFFIC CONTROL MEASURE.

CONSTRUCTION NOTE:

CONTRACTORS MUST PROVIDE SUPPORTING DOCUMENTS TO THE CITY ENGINEERING DIVISION TO SUBSTANTIATE THAT THE REQUESTOR HAS IN THEIR POSSESSION TO INSTALL AND MAINTAIN THE REQUIRED SIGNAGE, BARRICADES, ARROW BOARDS, ETC., FOR THE CLOSURE, PRIOR TO STARTING CONSTRUCTION.

THE CED RESERVES THE RIGHT TO MODIFY THE REQUIREMENTS, SHOULD IT BECOME NECESSARY TO ENSURE SAFETY OF VEHICULAR AND NON-VEHICULAR TRAFFIC AND EFFECTIVE TRAFFIC FLOW. THE REQUESTOR SHALL BE RESPONSIBLE FOR THE UPKEEP OF THE SIGNAGE, BARRICADES, ARROW BOARDS ETC., AT ALL TIMES DURING THE CLOSURE. REQUESTOR'S FAILURE FOR THE INSTALLATION AND IT'S MAINTENANCE WOULD RESULT IN REVOKING THE PERMITS OR OTHER CORRECTIVE MEASURES. ANY COST ASSOCIATED WITH THE CORRECTIVE MEASURES WILL BE CHARGED TO THE REQUESTOR.

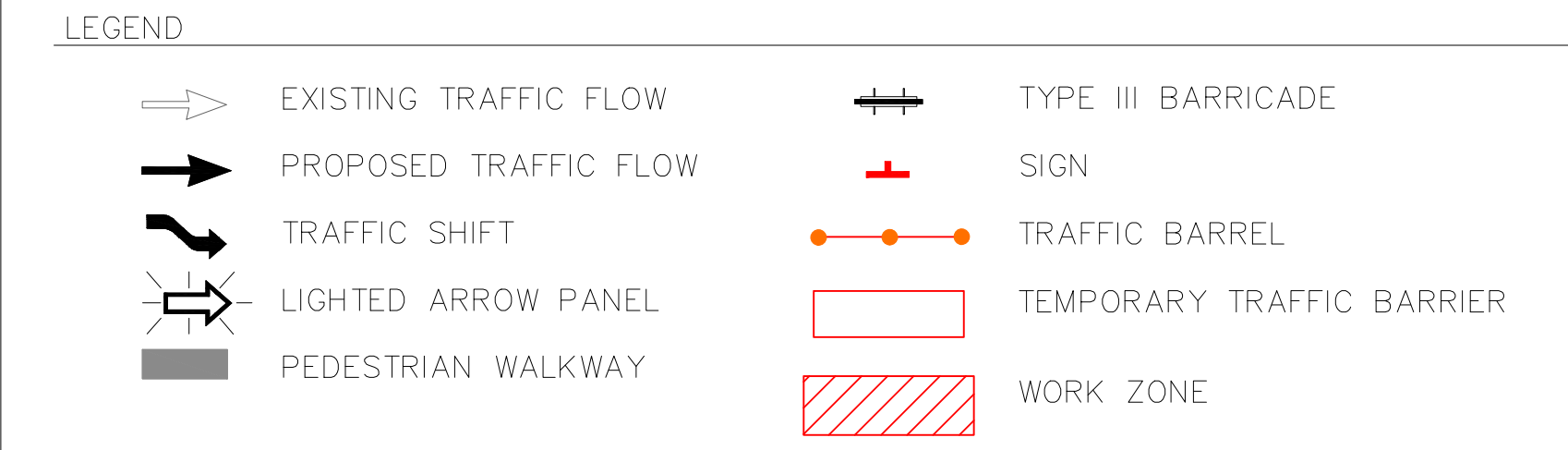

CONSTRUCTION SITE SAFETY IS THE RESPONSIBILITY OF THE CONTRACTOR. NEITHER THE OWNER NOR THE ENGINEER SHALL BE EXPECTED TO ASSUME ANY RESPONSIBILITY FOR SAFETY OF THE WORK, OF PERSONS ENGAGED IN THE WORK, OF ANY NEARBY STRUCTURES, OR OF ANY OTHER PERSONS.

STAGE 1

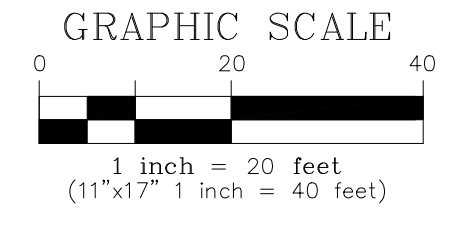
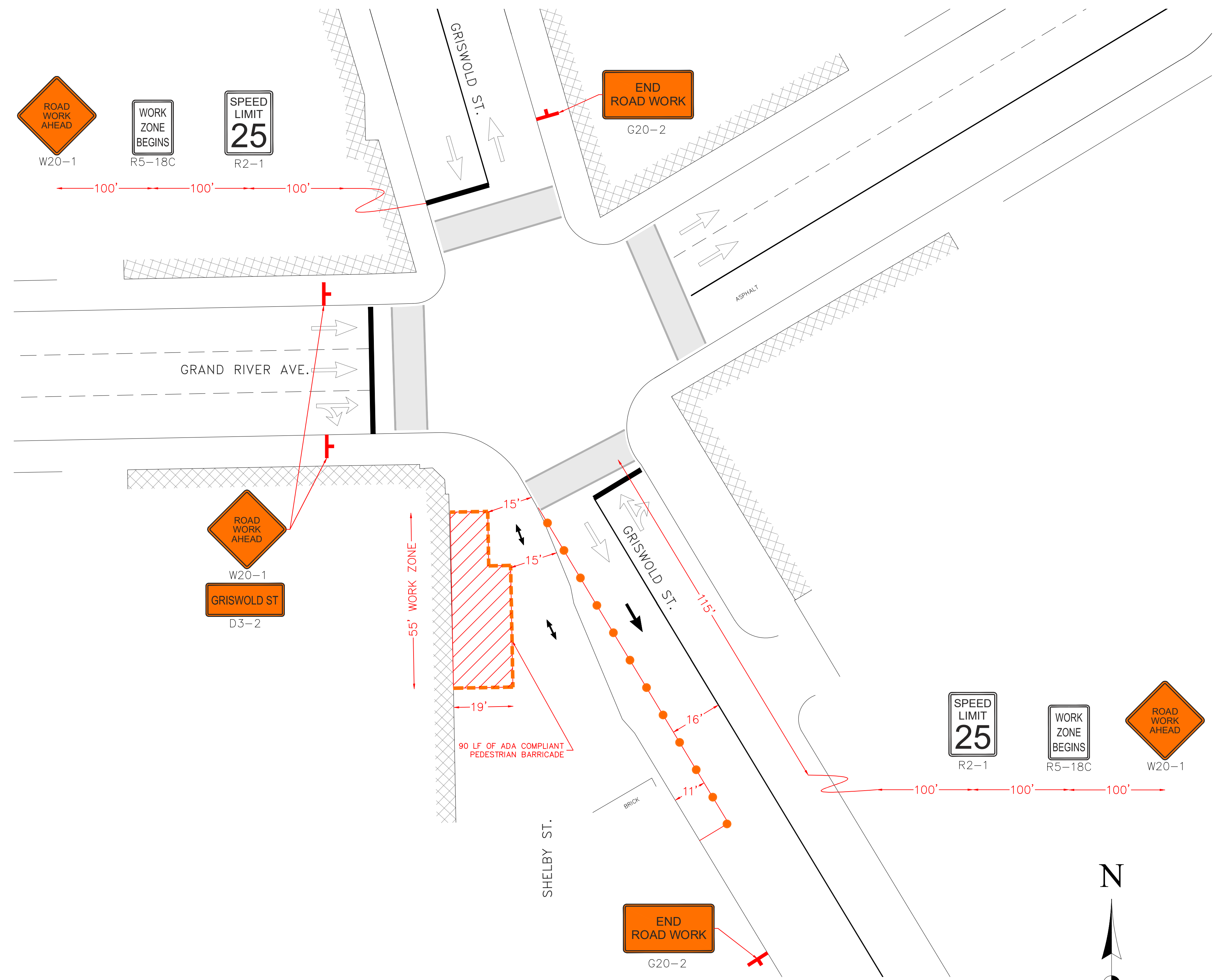

THE LOCATIONS OF EXISTING UNDERGROUND UTILITIES ARE SHOWN IN AN APPROXIMATE WAY ONLY AND HAVE NOT BEEN INDEPENDENTLY VERIFIED. THE CONTRACTOR SHALL DETERMINE THE EXACT LOCATION OF ALL EXISTING UTILITIES BEFORE COMMENCING WORK, AND AGREES TO BE FULLY RESPONSIBLE FOR ANY AND ALL DAMAGES WHICH MIGHT BE OCCASIONED BY THE CONTRACTOR'S FAILURE TO EXACTLY LOCATE AND PRESERVE ANY AND ALL UNDERGROUND UTILITIES.

ike SMART CITY

250 N HARTFORD AVE
COLUMBUS, OHIO 43222
PHONE: 614.589.0087

METRO ENGINEERING SOLUTIONS

33900 SCHOOLCRAFT RD
LIVONIA, MICHIGAN 48150
PHONE: 734.483.1427 FAX: 734.483.3431
www.metroes.net



October 7, 2021
CONTRACTOR/AS-BUILT

REV.	DATE:	ISSUED FOR:

SITE NAME:
DET-003
SHELBY & GRISWOLD

JOB: 1035-21-1595-TC
DRAW DATE: 08/30/21
PLOT DATE: 10/7/21
DRAWN BY: AMM
TITLE: M.O.T.
SHEET: 10 OF 11

K:\1035-IKE\1035-21-1595-IKE - Shelby & Griswold\DWG\1035-21-1595-TC.dwg; 10/7/2021 8:18 AM;



ADA WALL meets ADA Requirements

- MASH Tested, Passed, Eligible as Longitudinal Channelizing Device, TL-3.
- Two Step-N-Deploy Legs Make Deployment Quick, Easy and Safe
- Made of UV stabilized, high density polyethylene, the linkable ADA Walls quickly and easily link together in 6 foot sections to allow the contractor flexibility in creating a safe pedestrian pathway.
- Weighing only 23 lbs., the durable, yet lightweight design makes the ADA Wall easy to lift on and off the truck and easy to connect.
- The ten molded-in vertical windows reduce wind load, add strength and stability, and reduce overall weight of the ADA Wall. They also allow a guide dog to see what is on the other side of the wall.
- Two recessed areas measuring 8" wide x 53" long on each side of the ADA Wall accommodate reflective sheeting.
- Standard colors are orange and white. Custom colors also available upon request.
- The TraFFix ADA Wall can accommodate uneven surfaces to create a clear safe pedestrian pathway.

Blow Molded Connectors Provide Strength and Flexibility.

- MUNICIPAL PARKING WILL BE IMPEDED DURING THIS TEMPORARY TRAFFIC CONTROL MEASURE.
- PEDESTRIAN TRAVEL WILL BE IMPEDED DURING THIS TEMPORARY TRAFFIC CONTROL MEASURE.
- BUS TRAVEL WILL NOT BE IMPEDED DURING THIS TEMPORARY TRAFFIC CONTROL MEASURE.

CONSTRUCTION NOTE:
CONTRACTORS MUST PROVIDE SUPPORTING DOCUMENTS TO THE CITY ENGINEERING DIVISION TO SUBSTANTIATE THAT THE REQUESTOR HAS IN THEIR POSSESSION TO INSTALL AND MAINTAIN THE REQUIRED SIGNAGE, BARRICADES, ARROW BOARDS, ETC., FOR THE CLOSURE, PRIOR TO STARTING CONSTRUCTION.
THE CED RESERVES THE RIGHT TO MODIFY THE REQUIREMENTS, SHOULD IT BECOME NECESSARY TO ENSURE SAFETY OF VEHICULAR AND NON-VEHICULAR TRAFFIC AND EFFECTIVE TRAFFIC FLOW. THE REQUESTOR SHALL BE RESPONSIBLE FOR THE UPKEEP OF THE SIGNAGE, BARRICADES, ARROW BOARDS ETC., AT ALL TIMES DURING THE CLOSURE. REQUESTOR'S FAILURE FOR THE INSTALLATION AND IT'S MAINTENANCE WOULD RESULT IN REVOKING THE PERMITS OR OTHER CORRECTIVE MEASURES. ANY COST ASSOCIATED WITH THE CORRECTIVE MEASURES WILL BE CHARGED TO THE REQUESTOR.

LEGEND	
	EXISTING TRAFFIC FLOW
	PROPOSED TRAFFIC FLOW
	TRAFFIC SHIFT
	LIGHTED ARROW PANEL
	PEDESTRIAN WALKWAY
	TYPE III BARRICADE
	SIGN
	TRAFFIC BARREL
	TEMPORARY TRAFFIC BARRIER
	WORK ZONE

CONSTRUCTION SITE SAFETY IS THE RESPONSIBILITY OF THE CONTRACTOR. NEITHER THE OWNER NOR THE ENGINEER SHALL BE EXPECTED TO ASSUME ANY RESPONSIBILITY FOR SAFETY OF THE WORK, OF PERSONS ENGAGED IN THE WORK, OF ANY NEARBY STRUCTURES, OR OF ANY OTHER PERSONS.
COPYRIGHT © 2021 METRO ENGINEERING SOLUTIONS; ALL RIGHTS RESERVED.

THE LOCATIONS OF EXISTING UNDERGROUND UTILITIES ARE SHOWN IN AN APPROXIMATE WAY ONLY AND HAVE NOT BEEN INDEPENDENTLY VERIFIED. THE CONTRACTOR SHALL DETERMINE THE EXACT LOCATION OF ALL EXISTING UTILITIES BEFORE COMMENCING WORK, AND AGREES TO BE FULLY RESPONSIBLE FOR ANY AND ALL DAMAGES WHICH MIGHT BE OCCASIONED BY THE CONTRACTOR'S FAILURE TO EXACTLY LOCATE AND PRESERVE ANY AND ALL UNDERGROUND UTILITIES.

STAGE 2

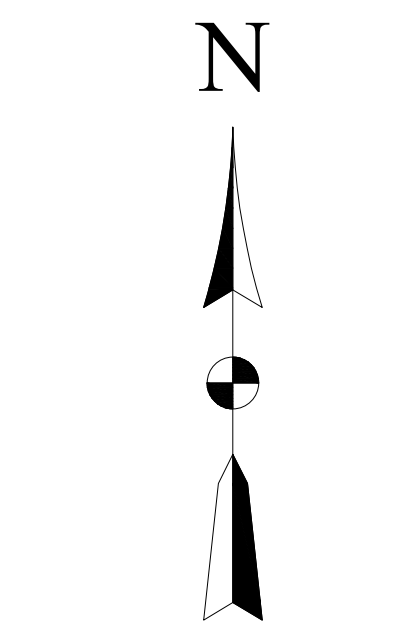
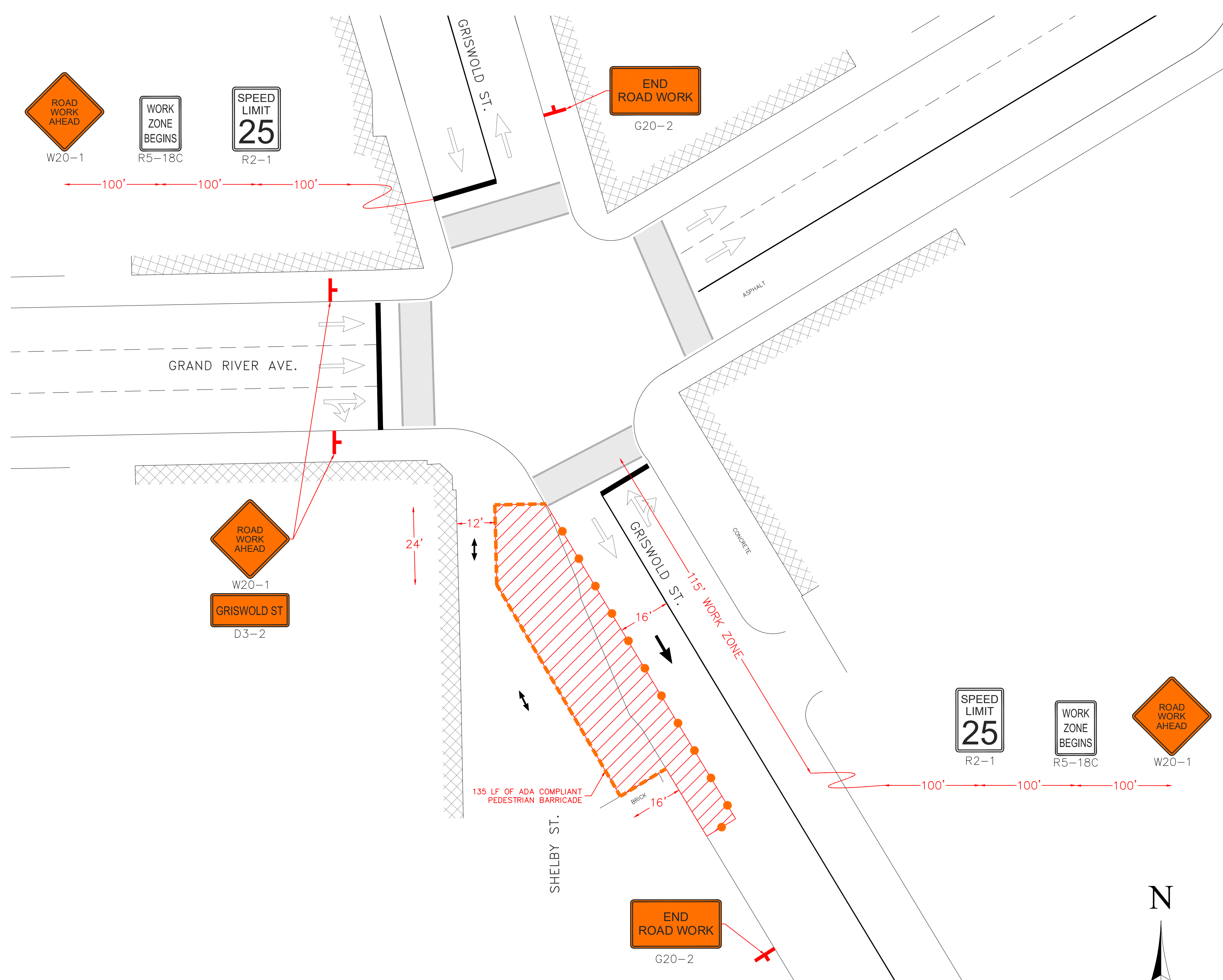

October 7, 2021
CONTRACTOR / AS-BUILT

REV.	DATE:	ISSUED FOR:

SITE NAME:
DET-003
SHELBY & GRISWOLD

JOB: 1035-21-1595-TC

DRAW DATE: 08/30/21

PLOT DATE: 10/7/21

DRAWN BY: AMM

TITLE: M.O.T.

SHEET: 11 OF 11