

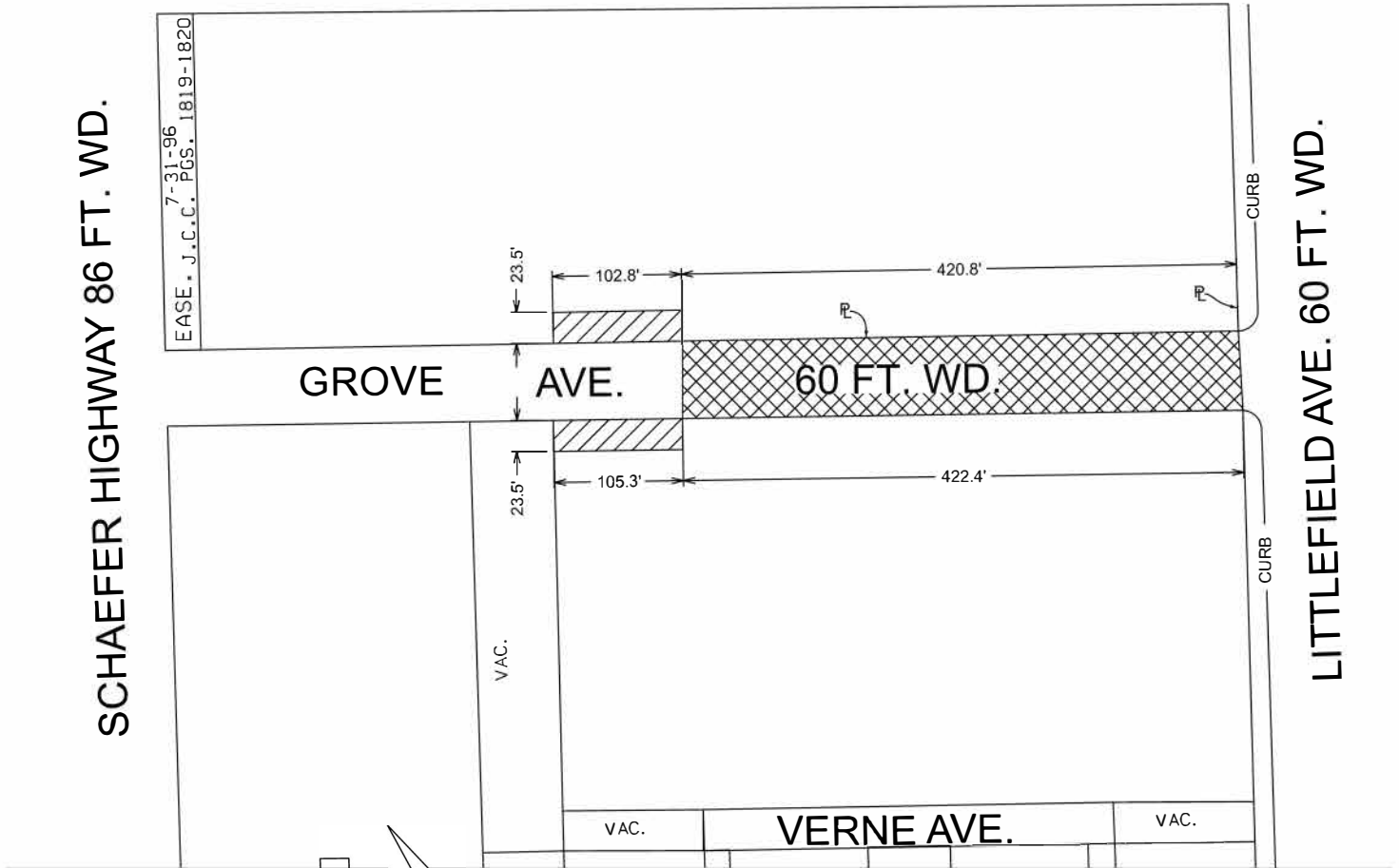

PETITION NO. 1541
 GIFFELS WEBSTER
 28 W. ADAMS, SUITE 1200
 DETROIT, MICHIGAN 48226
 PHONE NO. 313 962-4442



-  - CONVERSION TO UTILITY EASEMENT
-  - CONVERSION TO DEDICATION

(FOR OFFICE USE ONLY)

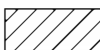
CARTO 85 A

B					
A					
DESCRIPTION	DRWN	CHKD	APPD	DATE	
REVISIONS					
DRAWN BY	SA	CHECKED	JD		
DATE	07-08-21	APPROVED			

CONVERSION TO UTILITY EASEMENT
 A PORTION OF GROVE AVE.
 BETWEEN
 SCHAEFER HIGHWAY & LITTLEFIELD AVE.

CITY OF DETROIT CITY ENGINEERING DIVISION SURVEY BUREAU	
JOB NO.	01-01
DRWG. NO.	