



June 2, 2021

Keith McCrary
DPW, City Engineering Division
200 Coleman A. Young Municipal Center
2 Woodward Avenue
Detroit, Michigan 48226

RE: Giffels Webster – Request for a vacation into the public right-of-way and the establishment of a public access easement.

Giffels Webster, 28 W. Adams, Suite 1200, Detroit, Michigan 48226 on behalf of Resendes Design Group, 7451 Third Street, Detroit, MI, 48202, respectfully requests the vacations of a portion of Grove Street (60 feet wide) in the block bounded by W McNichols Road (96 feet wide), Littlefield Street (60 feet wide), Schaefer Highway (86 feet wide), Florence Avenue (50 feet wide). The specific description of the vacation is as follows:

- Request to vacate, while maintaining a public DWSD easement, the existing Grove Street (60 feet wide) starting at the western limit of Littlefield Street (60 feet wide) and extending 420.8 feet west on the north side and 422.4 feet west on the south side.
- Request to provide a public access easement for a vehicle turnaround on either side of the Grove Street (60 feet wide) right-of-way. On the northern side of Grove Street (60 feet wide) the public access easement starts 420.8 feet west of the Littlefield Street (60 feet wide) right-of-way extending 102.8 feet further west. This easement begins at the northern Grove Street (60 feet wide) right-of-way and extends 23.5 feet into the Lincoln King Academy campus property. On the southern side of Grove Street (60 feet wide) the public access easement starts 422.4 feet west of the Littlefield Street (60 feet wide) right-of-way extending 105.3 feet further west. This easement begins at the southern Grove Street (60 feet wide) right-of-way and extends 23.5 feet into the Lincoln King Academy campus property.

These modifications to the right-of-way are necessary for the redevelopment of the Lincoln King Academy campus. Limits of the requested modifications can be found in the attachment, enclosed herein.

Giffels Webster has been asked to facilitate the requested right-of-way modifications. If you should have any questions, please do not hesitate to contact me at (P) 313.962.4442 (M) 313.980.1469 or at mmarks@giffelswebster.com.

Respectfully,

A handwritten signature in blue ink, appearing to read "Michael Marks", is written over a light blue horizontal line.

Michael Marks P.E.,
Partner
Giffels Webster

| | |
|------------------|----|
| Executive: | MM |
| Manager: | LE |
| Designer: | AG |
| Quality Control: | AN |



Know what's below.
Call before you dig.

| | |
|----------|------------------|
| DATE: | ISSUE: |
| 6/2/2021 | ROW MODIFICATION |
| | |
| | |
| | |
| | |

Developed For:
RESENDES DESIGN GROUP
7451 THIRD STREET
DETROIT, MI 48202

ROW MODIFICATION

LINCOLN KING ACADEMY



CITY OF DETROIT
WAYNE COUNTY
MICHIGAN

| | |
|----------|------------|
| Date: | 05.27.2021 |
| Scale: | 1"=70' |
| Sheet: | 1 OF 1 |
| Project: | 19777.00D |

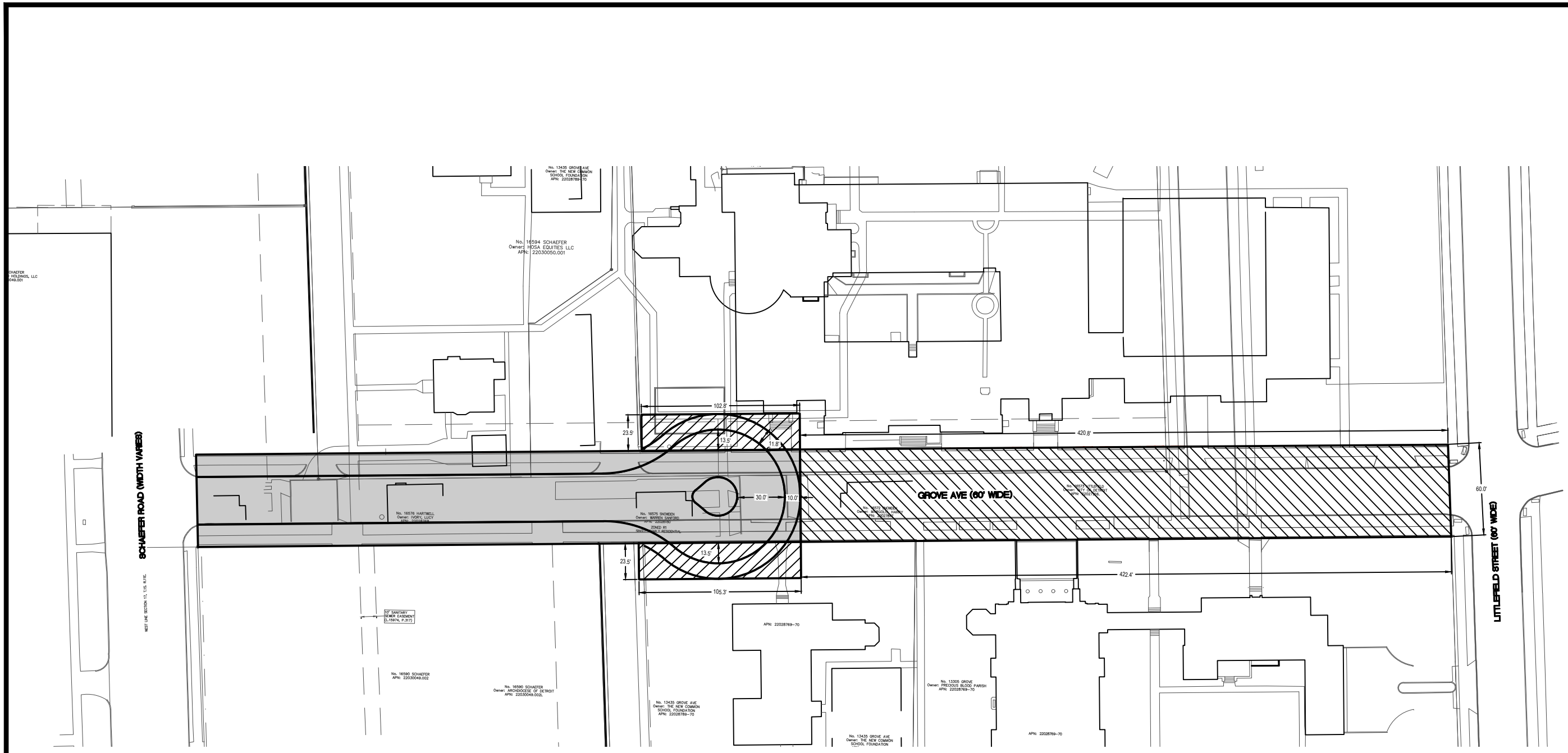
Copyright © 2021 Giffels Webster.
No reproduction shall be made without the prior written consent of Giffels Webster.

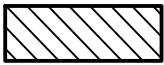

LEGEND

-  PUBLIC RIGHT-OF-WAY
-  VACATION WITH RESERVATION OF DWSD EASEMENT
-  PUBLIC ACCESS EASEMENT FOR VEHICLE TURNAROUND

