



CITY OF DETROIT
DEPARTMENT OF PUBLIC WORKS
CITY ENGINEERING DIVISION

COLEMAN A. YOUNG MUNICIPAL CENTER
2 WOODWARD AVE. SUITE 601
DETROIT, MICHIGAN 48226
PHONE: (313) 224-3949 • TTY: 711
FAX: (313) 224-3471
WWW.DETROITMI.GOV

July 13th, 2021

Honorable City Council:

RE: Petition No. 1501 – Motown Historical Museum, Inc., request for encroachment in the pedestrian sidewalk on the south side of West Grand Blvd for the installation of signs for the “Still Going On” art exhibit.

Petition No. 1501 – Motown Historical Museum, Inc., request for encroachment in the pedestrian sidewalk on the south side of West Grand Blvd, 150 ft. wide, for the installation of signs for the “Still Going On” art exhibit.

The petition was referred to the City Engineering Division – DPW for investigation and report. This is our report.

This request is being made as part of an art exhibit hosted by the Motown Historical Museum.

The request was approved by the Solid Waste Division – DPW, and City Engineering Division – DPW. The request was approved by the Traffic Engineering Division – DPW.

Detroit Water and Sewerage Department (DWSD) reports being involved, but they have no objection provided the DWSD encroachment provisions are followed. The DWSD provisions have been made a part of the resolution. DTE has reported involvement and provisions protecting DTE have been made a part of the resolution.

All other involved City Departments, including the Public Lighting Authority and Public Lighting Department; also privately owned utility companies have reported no objections to the encroachment. Provisions protecting all utility installations are part of the attached resolution.

I am recommending adoption of the attached resolution.

Respectfully submitted,

Richard Doherty, P.E., City Engineer
City Engineering Division – DPW

JMK/SW

Cc: Ron Brundidge, Director, DPW
Mayor’s Office – City Council Liaison

COUNCIL MEMBER _____

RESOLVED, that the Department of Public Works, City Engineering Division is hereby authorized and directed to issue permits to MOTOWN HISTORICAL MUSEUM, INC. or their assigns to install and maintain encroachment for the following:

Street Sign Exhibit located in 8 locations along the sidewalk on the south side of West Grand Blvd, the base of each sign being a 56" x 24" x 2" concrete slab reinforced with mesh, the sign legs being 3" thick and measuring at a height of 32", the frame of the sign pivots at a 45 degree angle and being 42.5" wide and 24.5" long. Each sign is to be located 2.5' south of the curb line northerly and adjacent to the following addresses:

1. 2648 West Grand Blvd
2. 2658 W Grand Blvd
3. 2716 West Grand Blvd
4. 2800 West Grand Blvd
5. 2894 West Grand Blvd
6. 2998 West Grand Blvd
7. 3044 West Grand Blvd
8. 6565 Woodward Avenue.

PROVIDED, that if there is any cost for the removing and/or rerouting of any utility facilities, it shall be done at the expense of the petitioner and/or property owner; and be it further

PROVIDED, that access is maintained to all fire department connections, and be it further

PROVIDED, that by approval of this petition the Detroit Water and Sewerage Department (DWSD) does not waive any of its rights to its facilities located in the right-of-way, and at all times, DWSD, its agents or employees, shall have the right to enter upon the right-of-way to maintain, repair, alter, service, inspect, or install its facilities. All costs incident to the damaging, dismantling, demolishing, removal and replacement of structures or other improvements herein permitted and incurred in gaining access to DWSD's facilities for maintenance, repairing, alteration, servicing or inspection caused by the encroachment shall be borne by the petitioner. All costs associated with gaining access to DWSD's facilities, which could normally be expected had the petitioner not encroached into the right-of-way, shall be borne by DWSD; and be it further

PROVIDED, that the necessary permits shall be obtained from the City Engineering Division – DPW and the Buildings and Safety Engineering Department. The encroachments shall be constructed and maintained under their rules and regulations; and further

PROVIDED, that all cost for the construction, maintenance, permits and use of the encroachments shall be borne by MOTOWN HISTORICAL MUSEUM, INC. or their assigns, and further

PROVIDED, that the MOTOWN HISTORICAL MUSEUM, INC. or their assigns provide as-built drawings of their installation and the relationship to other utility infrastructure to the Department of Public Works – City Engineering Division, and further

PROVIDED, that all costs incurred by privately owned utility companies and/or city departments to alter, adjust, and/or relocate their existing utility facilities located in close proximity to the

encroachments shall be borne by MOTOWN HISTORICAL MUSEUM, INC. or their assigns. Should damages to utilities occur MOTOWN HISTORICAL MUSEUM, INC. or their assigns shall be liable for all incidental repair costs and waives all claims for damages to the encroaching installations; and further

PROVIDED, that no other rights in the public streets, alleys or other public place shall be considered waived by this permission which is granted expressly on the condition that said encroachments shall be removed at any time when so directed by the City Council, and the public property affected shall be restored to a condition satisfactory to the City Engineering Division – DPW; and further

PROVIDED, that MOTOWN HISTORICAL MUSEUM, INC. or their assigns shall file with the Department of Public Works – City Engineering Division an indemnity agreement in form approved by the Law Department. The agreement shall save and protect the City of Detroit from any and all claims, damages or expenses that may arise by reason of the issuance of the permits and the faithful or unfaithful performance of MOTOWN HISTORICAL MUSEUM, INC. or their assigns of the terms thereof. Further, MOTOWN HISTORICAL MUSEUM, INC. or their assigns shall agree to pay all claims, damages or expenses that may arise out of the use, repair and maintenance of the proposed encroachments; and further

PROVIDED, that all cost for the construction, maintenance, permits and use of the encroachments shall be borne by MOTOWN HISTORICAL MUSEUM, INC. , or their assigns; and further

PROVIDED, that construction of the encroachments shall constitute acceptance of the terms and conditions as set forth in this resolution; and be it further

PROVIDED, this resolution or part thereof is revocable at the will, whim or caprice of the City Council, and MOTOWN HISTORICAL MUSEUM, INC. acquires no implied or other privileges hereunder not expressly stated herein; and further

PROVIDED, that the encroachment permits shall not be assigned or transferred without the written approval of the City Council; and be it further

PROVIDED, that the City Clerk shall within 30 days record a certified copy of this resolution with the Wayne County Register of Deeds.

Petition No. x1501
 MAP-21-18
 Motown Historical Museum, Inc

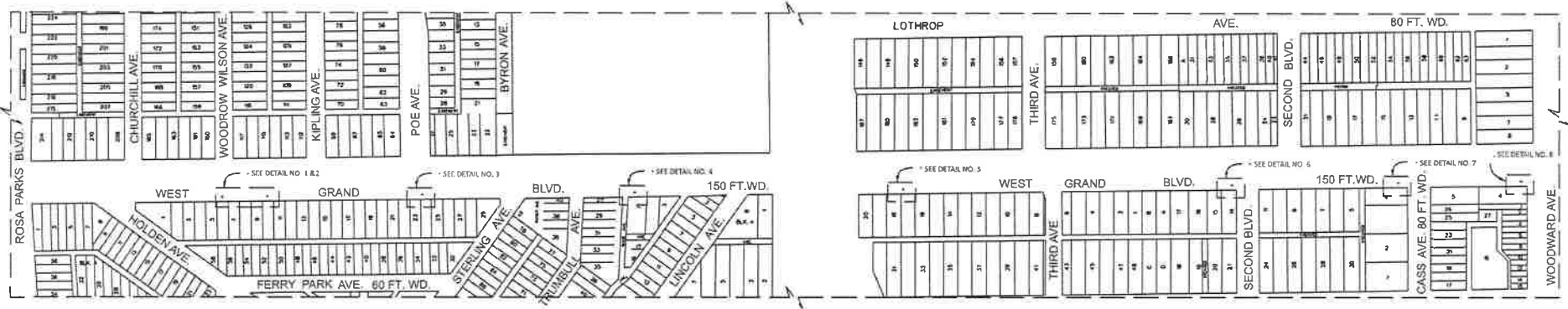
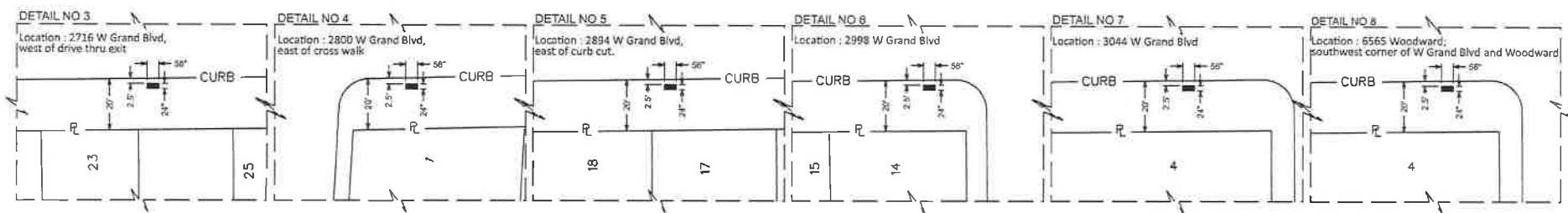
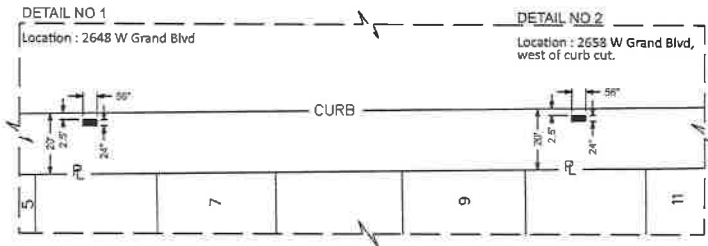

█ - REQUEST ENCROACHMENT

(FOR OFFICE USE ONLY)

CARTO
 31 B, 31 C, 31 D, 31 E

REQUEST FOR ENCROACHMENTS ON THE SOUTH SIDE OF W GRAND BLVD
 FROM HOLDEN AVE. TO WOODWARD AVE.

CITY OF DETROIT
 CITY ENGINEERING DIVISION
 SURVEY BUREAU

B					
A					
DESCRIPTION		DRWN	CHKD	APPD	DATE
REVISIONS					
DRAWN BY	SA	CHECKED		JD	
DATE	06/14/2021	APPROVED			

JOB NO. 01-01
 DRWG. NO. MAP-21-18