

DEPARTMENTAL REFERENCE COMMUNICATION

Thursday, February 25, 2021

To: The Department or Commission Listed Below

From: Janice M. Winfrey, Detroit City Clerk

The following petition is herewith referred to you for report and recommendation to the City Council.

In accordance with that body's directive, kindly return the same with your report in duplicate within four (4) weeks.

DPW - CITY ENGINEERING DIVISION PLANNING AND DEVELOPMENT DEPARTMENT

1389 *Jevona Watson, request for encroachment into West McNichols Road, adjacent to 7420 West McNichols Road, for the installation of an on-site advertising sign.*



CITY OF DETROIT
DEPARTMENT OF PUBLIC WORKS
CITY ENGINEERING DIVISION

COLEMAN A. YOUNG MUNICIPAL CENTER
2 WOODWARD AVE. SUITE 601
DETROIT, MICHIGAN 48226
PHONE: (313) 224-3949 TTY: 711
WWW.DETROITMI.GOV

To: Clerk's Office
From: The Department of Public Works
City Engineering Division
MapsandRecordsBureau@DetroitMI.Gov
(313) 224-3970

Petitioner:
Jevona Watson
Represented by Metro Detroit Signs
11444 Kaltz Avenue
Warren, MI, 48089
(586) 434-0056

On behalf of the above mentioned petitioner the Department of Public Works: City Engineering Division is submitting a petition request for the below mentioned action. The petitioner has received a project consultation from the Department of Public Works: City Engineering Division and has been advised the following:

Type of action recommended:

Petition for encroachment into West McNichols Road, adjacent to 7420 West McNichols Road, for the installation of an on-site advertising sign.

Consulted by:

Jered Dean
Manager II
Department of Public Works
City Engineering Division
313-224-3985

SGN2021-00011

South elevation non illuminated projecting sign
2.5 ' x 2.5 ' = 6.25 sq feet



SIGN DIMENSIONS

30" x 30" = 6.25 sqft

BLADE SIGN

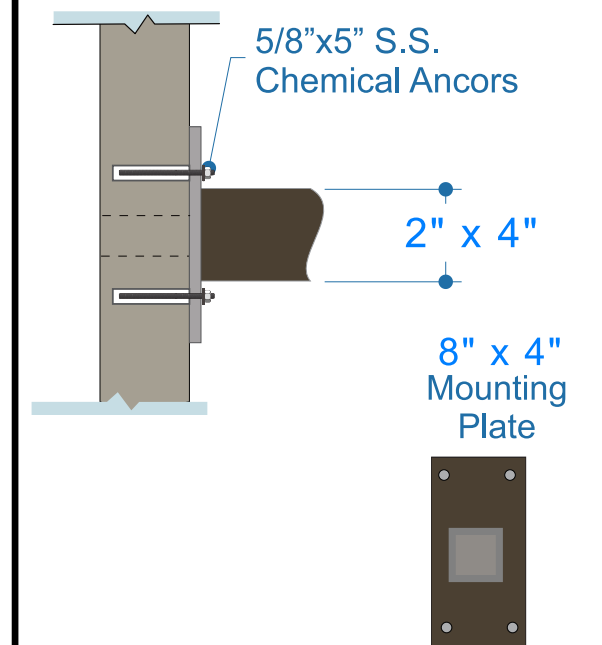

- non-illuminating blade sign
- 4" depth



Sales Person: Eric Ropelewski

Drawn By: Megan

Date: 06/17/19

File Name: Sip_Blade sign

Revision: 01/14/21 #2

This drawing and design/layout is the property of Metro Detroit Signs. The use of which in part or in whole is not permitted without prior written consent from Metro Detroit Signs. All rights reserved. Copyright 2018

Customer Signature _____

Date _____

Work Order#: XXX



11444 Kaltz Ave
Warren, MI 48089
Phone: 586-759-2700
www.metroal.com