

City of Detroit
City Engineering Division, Department of Public Works
Maps and Records Bureau

NOTICE OF PROPOSED CHANGE IN PROPERTY

Date: _____

Petition: _____

- | | |
|---|---|
| <input type="checkbox"/> AT&T Telecommunication | |
| <input type="checkbox"/> Comcast Television (CATV) | <input type="checkbox"/> Berm Use |
| <input type="checkbox"/> Detroit Edison (DTE) | |
| <input type="checkbox"/> Fire Department | <input type="checkbox"/> Conversion to Easement |
| <input type="checkbox"/> Great Lakes Water Authority | |
| <input type="checkbox"/> Land Bank Authority | <input type="checkbox"/> Dedication |
| <input type="checkbox"/> Michcon (DTE) | |
| <input type="checkbox"/> Planning & Development Department | <input type="checkbox"/> Encroachment |
| <input type="checkbox"/> Public Lighting Authority | |
| <input type="checkbox"/> Public Lighting Department | <input type="checkbox"/> Outright Vacation |
| <input type="checkbox"/> Police Department | |
| <input type="checkbox"/> Solid Waste Division, DPW | <input type="checkbox"/> Temporary Closing |
| <input type="checkbox"/> Street Design Bureau, DPW | |
| <input type="checkbox"/> Street Maintenance Division, DPW | |
| <input type="checkbox"/> Traffic Engineering Division, DPW | |
| <input type="checkbox"/> Water and Sewerage Department | |
| <input type="checkbox"/> Detroit Thermal | |
| <input type="checkbox"/> International Transmission Company (ITC) | |

A petition drawing is attached. Property shown on the attached print is proposed to be changed as indicated. Kindly report (using the back of this sheet) the nature of your services, if any affected by the proposed change and the estimated costs of removing and rerouting such services (if necessary). If a response is not received after a second notice of proposed change has been issued DPW will make the determination to move forward with the petition.

Please return one copy to City Engineering Division, DPW within two weeks of the submittal date. Retain one copy and print for you file.

Ron Brundidge, Director, Department of Public Works

By: Richard Doherty, CED DPW
City Engineer

**TO: City Engineering Division, DPW
2 Woodward Ave., Suite 642
Detroit, Michigan 48226-3462
Survey Bureau: 313-224-3970**

Petition: _____

The proposed change in property (referred to on the other side of this sheet) would affect our services as follows:

- Not Involved
- Involved; but no objections to the property change.
- Involved; objection to the property change.
- Involved; the nature of our services and the estimated costs of removing and/or rerouting such services are:

Objections, Please leave a brief explanation for any objection or the nature of an estimated cost:

(Utility or City Department)

By

Title

Date

Area code – Telephone number

DEPARTMENTAL REFERENCE COMMUNICATION

Friday, February 12, 2021

To: The Department or Commission Listed Below

From: Janice M. Winfrey, Detroit City Clerk

The following petition is herewith referred to you for report and recommendation to the City Council.

In accordance with that body's directive, kindly return the same with your report in duplicate within four (4) weeks.

PLANNING AND DEVELOPMENT DEPARTMENT DPW - CITY ENGINEERING DIVISION

1384 *Paperclip Properties, LLC, request for below-grade encroachments for existing vaults within State Street and Griswold Street, adjacent to the property known as 1150 Griswold.*



CITY OF DETROIT
DEPARTMENT OF PUBLIC WORKS
CITY ENGINEERING DIVISION

COLEMAN A. YOUNG MUNICIPAL CENTER
2 WOODWARD AVE. SUITE 601
DETROIT, MICHIGAN 48226
PHONE: (313) 224-3949 TTY: 711
WWW.DETROITMI.GOV

To: Clerk's Office
From: The Department of Public Works
City Engineering Division
MapsandRecordsBureau@DetroitMI.Gov
(313) 224-3970

Petitioner:
Paperclip Properties, LLC
Represented by Giffels Webster
28 W. Adams Avenue
Detroit, MI 48226
313-962-4442

On behalf of the above mentioned petitioner the Department of Public Works: City Engineering Division is submitting a petition request for the below mentioned action. The petitioner has received a project consultation from the Department of Public Works: City Engineering Division and has been advised the following:

Type of action recommended:

Petition for below-grade encroachments for existing vaults within State Street and Griswold Street, adjacent to the property known as 1150 Griswold.

Consulted by:

Jered Dean
Manager II
Department of Public Works
City Engineering Division
313-224-3985



January 6, 2021

Honorable Detroit City Council
C/o Detroit City Clerk
200 Coleman A. Young Municipal Center
2 Woodward Avenue
Detroit, Michigan 48226

RE: Giffels Webster – Request for below grade encroachments into of the rights-of-way within the block bounded by Michigan Avenue (120 feet wide), Woodward Avenue (120 feet wide), Griswold Street (60 feet wide), and State Street (60 feet wide).

Giffels Webster, 28 W. Adams, Suite 1200, Detroit, Michigan 48226 on behalf of PAPERCLIP PROPERTIES, LLC, 630 Woodward Avenue, Detroit, MI 48226, respectfully requests the following below grade encroachments into the rights-of-way within the block bounded by Michigan Avenue (120 feet wide), Woodward Avenue (120 feet wide), Griswold Street (60 feet wide), and State Street (60 feet wide), in the City of Detroit:

- A below grade encroachment into the 7.9 feet into the State Street (60 feet wide) for an existing underground vault with grates at sidewalk surface. This encroachment begins 1.4 feet east of the eastern Griswold Street (60 feet wide) and extends 81.5 feet east.
- A below grade encroachment into the 10.4 feet into the Griswold Street (60 feet wide) for an existing underground vault with grates at sidewalk surface. This encroachment begins 1.1 feet south of the southern State Street (60 feet wide) and extends 69.8 feet south.

The requested below grade encroachments are a critical part of the David Stott building improvements. Please refer to the attached detailed sketch for further clarification.

If you should have any questions, please do not hesitate to contact me at (P) 313.962.4442 (M) 313.980.1469 or at mmarks@giffelswebster.com.

Respectfully,

A handwritten signature in cursive script, appearing to read "Michael Marks".

Michael Marks P.E.,
Partner
Giffels Webster

attachment

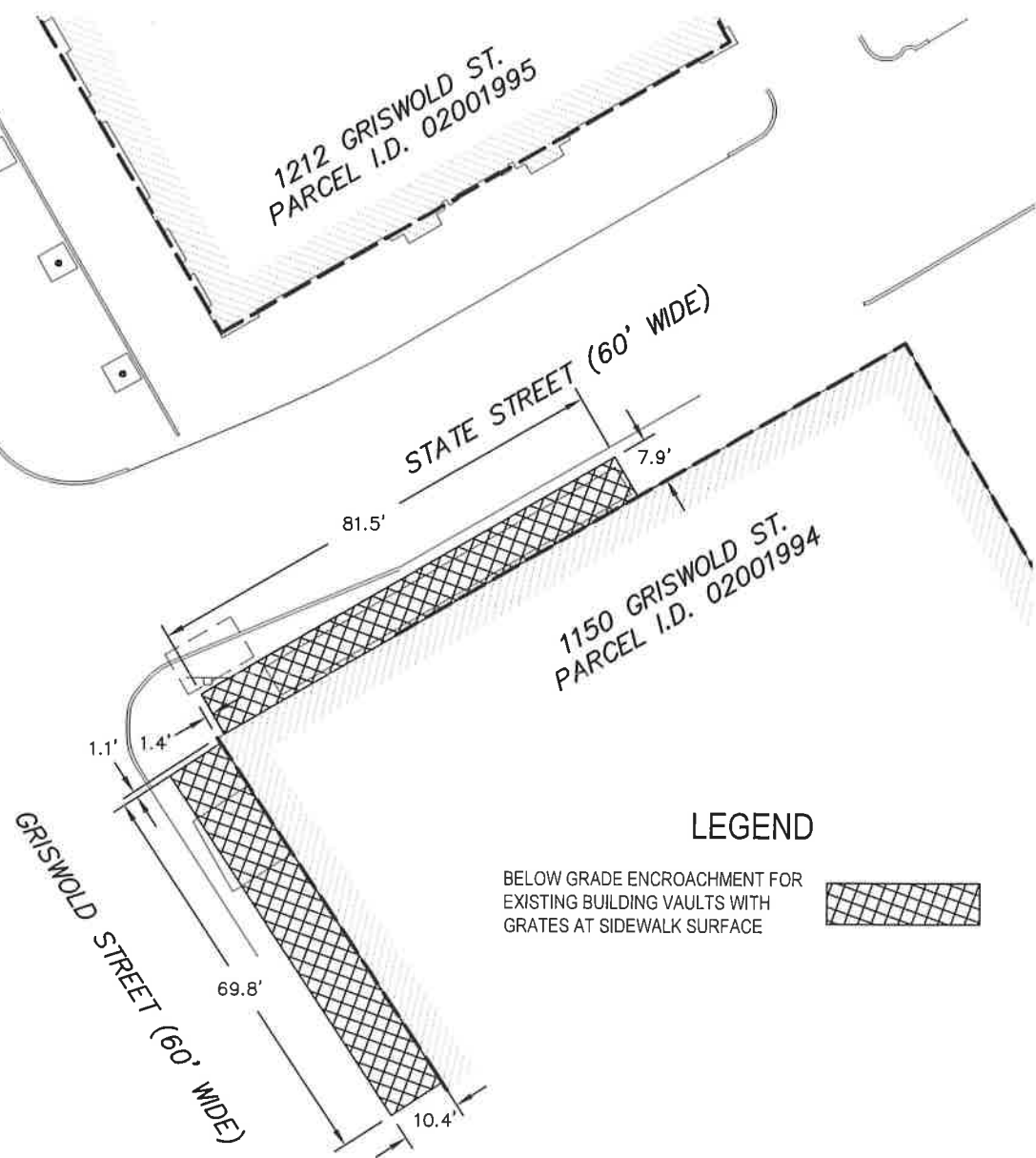
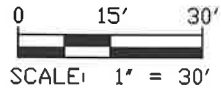
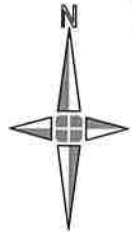

LEGEND

BELOW GRADE ENCROACHMENT FOR EXISTING BUILDING VAULTS WITH GRATES AT SIDEWALK SURFACE

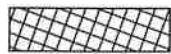

I:\genging_projects\Detroit\Projects\18949_002 David Stott DTE Energy Drain Coordination\Permits\ROW Modification\GW Petition Materials\CAD\Existing Vault Petition.dwg

DAVID STOTT BUILDING

CITY OF DETROIT, WAYNE COUNTY, MICHIGAN

ROW MODIFICATION



28 West Adams Road
 Suite 1200
 Detroit, MI 48226
 p (313) 962-4442
 f (313) 962-5068
 www.giffelswebster.com

Executive:	MM
Manager:	TT
Designer:	AG
Quality Control:	AN

Developed For:
PAPERCLIP PROPERTIES, LLC
 630 WOODWARD AVENUE
 DETROIT, MI 48226

DATE:	ISSUE:
1/6/2021	OWNER REVIEW

Date:	01.06.2021
Scale:	1"=30'
Sheet:	1 OF 1
Project:	18949.00D

Copyright © 2020 Giffels Webster.
 No reproduction shall be made
 without the prior written consent of
 Giffels Webster.

2021-02-12

1384

1384 *Petition of Paperclip Properties, LLC,
request for below-grade
encroachments for existing vaults
within State Street and Griswold
Street, adjacent to the property known
as 1150 Griswold.*

REFERRED TO THE FOLLOWING DEPARTMENT(S)

PLANNING AND DEVELOPMENT DEPARTMENT DPW -
CITY ENGINEERING DIVISION

PETITION NO. 1384

C/O MICHAEL MARKS P.E.

REPRESENTING GIFFELS WEBSTER

28 W. ADAMS, SUITE 1200, DETROIT, MICHIGAN 48226

313-962-4442 (P) 313-980-1469 (M)

MMARKS@GIFFELSWEBSTER.COM

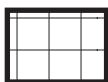
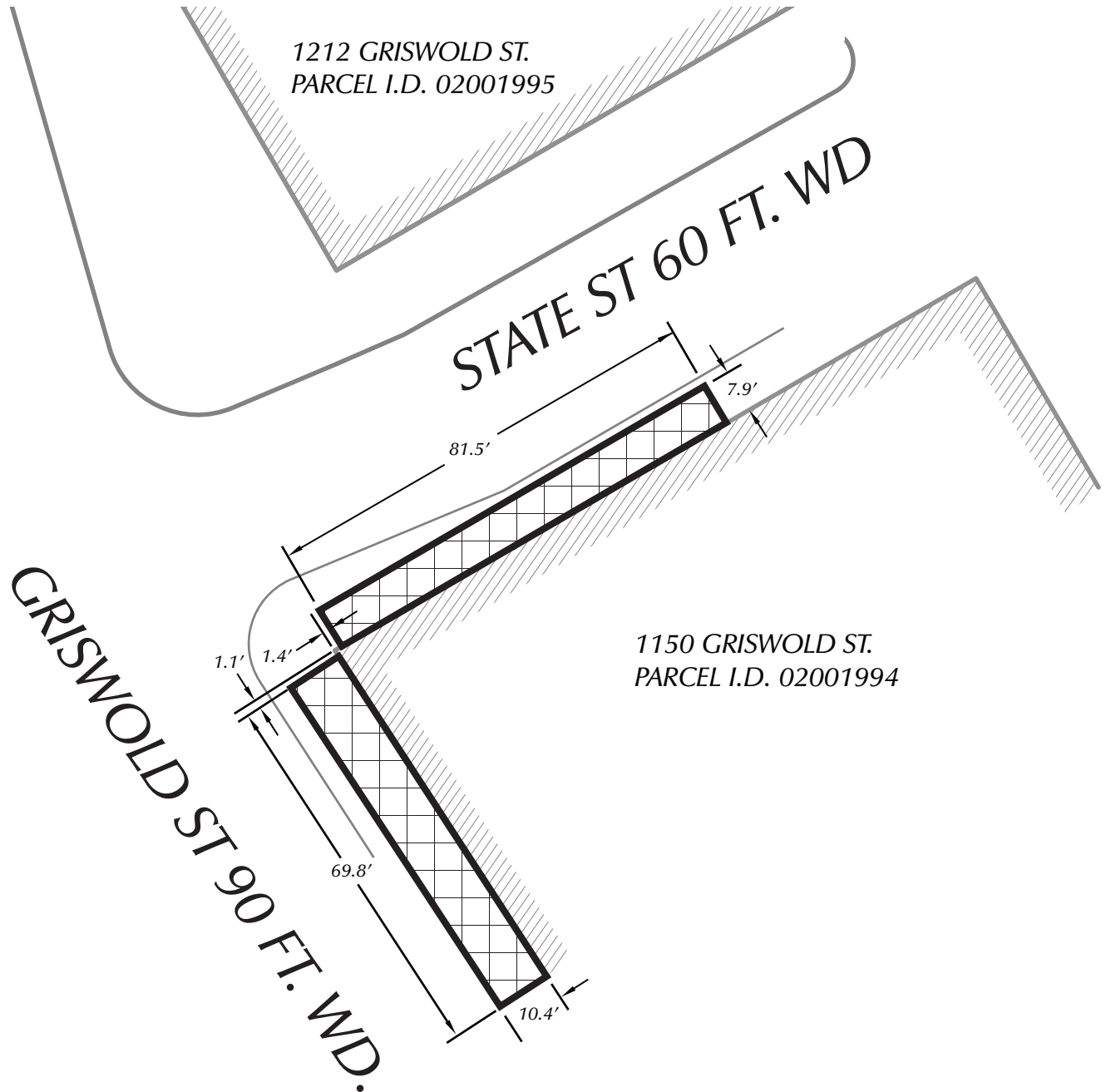

BELOW GRADE ENCROACHMENT
FOR EXISTING BUILDING VAULTS
WITH GRATES AT SIDEWALK
SURFACE

(FOR OFFICE USE ONLY)

CARTO 28 B

B					
	A				
DESCRIPTION		DRWN	CHKD	APPD	DATE
REVISIONS					
DRAWN BY		CHECKED			
DATE		APPROVED BY			
01-27-21		JD			

BELOW GRADE ENCROACHMENTS
IN THE BLOCK BOUND BY
WOODWARD AVE, MICHIGAN
AVE, GRISWOLD ST, AND STATE ST.

CITY OF DETROIT	
CITY ENGINEERING DIVISION	
SURVEY BUREAU	
JOB NO.	01-02
DRWG. NO.	X

