

DEPARTMENTAL REFERENCE COMMUNICATION

Friday, February 12, 2021

To: The Department or Commission Listed Below

From: Janice M. Winfrey, Detroit City Clerk

The following petition is herewith referred to you for report and recommendation to the City Council.

In accordance with that body's directive, kindly return the same with your report in duplicate within four (4) weeks.

PLANNING AND DEVELOPMENT DEPARTMENT

DPW - CITY ENGINEERING DIVISION

1383 *Gratiot Acquisition Partners, LLC, request for encroachment into Macomb Street, between Randolph Street and Brush Street. For the purpose of installing Bike Racks upon the sidewalk on the north side of Macomb Street*



CITY OF DETROIT
DEPARTMENT OF PUBLIC WORKS
CITY ENGINEERING DIVISION

COLEMAN A. YOUNG MUNICIPAL CENTER
2 WOODWARD AVE. SUITE 601
DETROIT, MICHIGAN 48226
PHONE: (313) 224-3949 TTY: 711
WWW.DETROITMI.GOV

To: Clerk's Office
From: The Department of Public Works
City Engineering Division
MapsandRecordsBureau@DetroitMI.Gov
(313) 224-3970

Petitioner:
Gratiot Acquisition Partners, LLC
30301 Northwestern Highway, Suite 200
Farmington Hills, MI 48334
248-672-1944

On behalf of the above mentioned petitioner the Department of Public Works: City Engineering Division is submitting a petition request for the below mentioned action. The petitioner has received a project consultation from the Department of Public Works: City Engineering Division and has been advised the following:

Type of action recommended:

Petition to encroachment into Macomb Street, between Randolph Street and Brush Street, for the purpose of installing Bike Racks upon the sidewalk on the north side of Macomb Street.

Consulted by:

Jered Dean
Manager II
Department of Public Works
City Engineering Division
313-224-3985

LIFTbuild
 UFT-BUILD
 2600 American Drive
 Southfield, Michigan
 48066-5000
 liftbuild@uft-build.com
GRATIOT EXCHANGE
 228 Gratiot Ave., Detroit, MI

GHAFARI
 1770 WASHINGTON AVE
 SUITE 400
 DETROIT, MI 48226
 TEL: 313.441.3000
 www.ghafari.com

PEA GROUP
 TROY WASHINGTON TWP
 800 WASHINGTON TWP
 1848 813 2849
 www.peagroup.com



NO.	REVISION	DATE
1	ISSUED FOR PERMIT	11/15/2017
2	REVISED PER COMMENTS	11/15/2017
3	REVISED PER COMMENTS	11/15/2017
4	REVISED PER COMMENTS	11/15/2017
5	REVISED PER COMMENTS	11/15/2017
6	REVISED PER COMMENTS	11/15/2017
7	REVISED PER COMMENTS	11/15/2017
8	REVISED PER COMMENTS	11/15/2017
9	REVISED PER COMMENTS	11/15/2017
10	REVISED PER COMMENTS	11/15/2017
11	REVISED PER COMMENTS	11/15/2017
12	REVISED PER COMMENTS	11/15/2017
13	REVISED PER COMMENTS	11/15/2017
14	REVISED PER COMMENTS	11/15/2017
15	REVISED PER COMMENTS	11/15/2017
16	REVISED PER COMMENTS	11/15/2017
17	REVISED PER COMMENTS	11/15/2017
18	REVISED PER COMMENTS	11/15/2017
19	REVISED PER COMMENTS	11/15/2017
20	REVISED PER COMMENTS	11/15/2017
21	REVISED PER COMMENTS	11/15/2017
22	REVISED PER COMMENTS	11/15/2017
23	REVISED PER COMMENTS	11/15/2017
24	REVISED PER COMMENTS	11/15/2017
25	REVISED PER COMMENTS	11/15/2017
26	REVISED PER COMMENTS	11/15/2017
27	REVISED PER COMMENTS	11/15/2017
28	REVISED PER COMMENTS	11/15/2017
29	REVISED PER COMMENTS	11/15/2017
30	REVISED PER COMMENTS	11/15/2017
31	REVISED PER COMMENTS	11/15/2017
32	REVISED PER COMMENTS	11/15/2017
33	REVISED PER COMMENTS	11/15/2017
34	REVISED PER COMMENTS	11/15/2017
35	REVISED PER COMMENTS	11/15/2017
36	REVISED PER COMMENTS	11/15/2017
37	REVISED PER COMMENTS	11/15/2017
38	REVISED PER COMMENTS	11/15/2017
39	REVISED PER COMMENTS	11/15/2017
40	REVISED PER COMMENTS	11/15/2017
41	REVISED PER COMMENTS	11/15/2017
42	REVISED PER COMMENTS	11/15/2017
43	REVISED PER COMMENTS	11/15/2017
44	REVISED PER COMMENTS	11/15/2017
45	REVISED PER COMMENTS	11/15/2017
46	REVISED PER COMMENTS	11/15/2017
47	REVISED PER COMMENTS	11/15/2017
48	REVISED PER COMMENTS	11/15/2017
49	REVISED PER COMMENTS	11/15/2017
50	REVISED PER COMMENTS	11/15/2017
51	REVISED PER COMMENTS	11/15/2017
52	REVISED PER COMMENTS	11/15/2017
53	REVISED PER COMMENTS	11/15/2017
54	REVISED PER COMMENTS	11/15/2017
55	REVISED PER COMMENTS	11/15/2017
56	REVISED PER COMMENTS	11/15/2017
57	REVISED PER COMMENTS	11/15/2017
58	REVISED PER COMMENTS	11/15/2017
59	REVISED PER COMMENTS	11/15/2017
60	REVISED PER COMMENTS	11/15/2017
61	REVISED PER COMMENTS	11/15/2017
62	REVISED PER COMMENTS	11/15/2017
63	REVISED PER COMMENTS	11/15/2017
64	REVISED PER COMMENTS	11/15/2017
65	REVISED PER COMMENTS	11/15/2017
66	REVISED PER COMMENTS	11/15/2017
67	REVISED PER COMMENTS	11/15/2017
68	REVISED PER COMMENTS	11/15/2017
69	REVISED PER COMMENTS	11/15/2017
70	REVISED PER COMMENTS	11/15/2017
71	REVISED PER COMMENTS	11/15/2017
72	REVISED PER COMMENTS	11/15/2017
73	REVISED PER COMMENTS	11/15/2017
74	REVISED PER COMMENTS	11/15/2017
75	REVISED PER COMMENTS	11/15/2017
76	REVISED PER COMMENTS	11/15/2017
77	REVISED PER COMMENTS	11/15/2017
78	REVISED PER COMMENTS	11/15/2017
79	REVISED PER COMMENTS	11/15/2017
80	REVISED PER COMMENTS	11/15/2017
81	REVISED PER COMMENTS	11/15/2017
82	REVISED PER COMMENTS	11/15/2017
83	REVISED PER COMMENTS	11/15/2017
84	REVISED PER COMMENTS	11/15/2017
85	REVISED PER COMMENTS	11/15/2017
86	REVISED PER COMMENTS	11/15/2017
87	REVISED PER COMMENTS	11/15/2017
88	REVISED PER COMMENTS	11/15/2017
89	REVISED PER COMMENTS	11/15/2017
90	REVISED PER COMMENTS	11/15/2017
91	REVISED PER COMMENTS	11/15/2017
92	REVISED PER COMMENTS	11/15/2017
93	REVISED PER COMMENTS	11/15/2017
94	REVISED PER COMMENTS	11/15/2017
95	REVISED PER COMMENTS	11/15/2017
96	REVISED PER COMMENTS	11/15/2017
97	REVISED PER COMMENTS	11/15/2017
98	REVISED PER COMMENTS	11/15/2017
99	REVISED PER COMMENTS	11/15/2017
100	REVISED PER COMMENTS	11/15/2017

SITE PLAN
 C-3.0
 11/15/2017

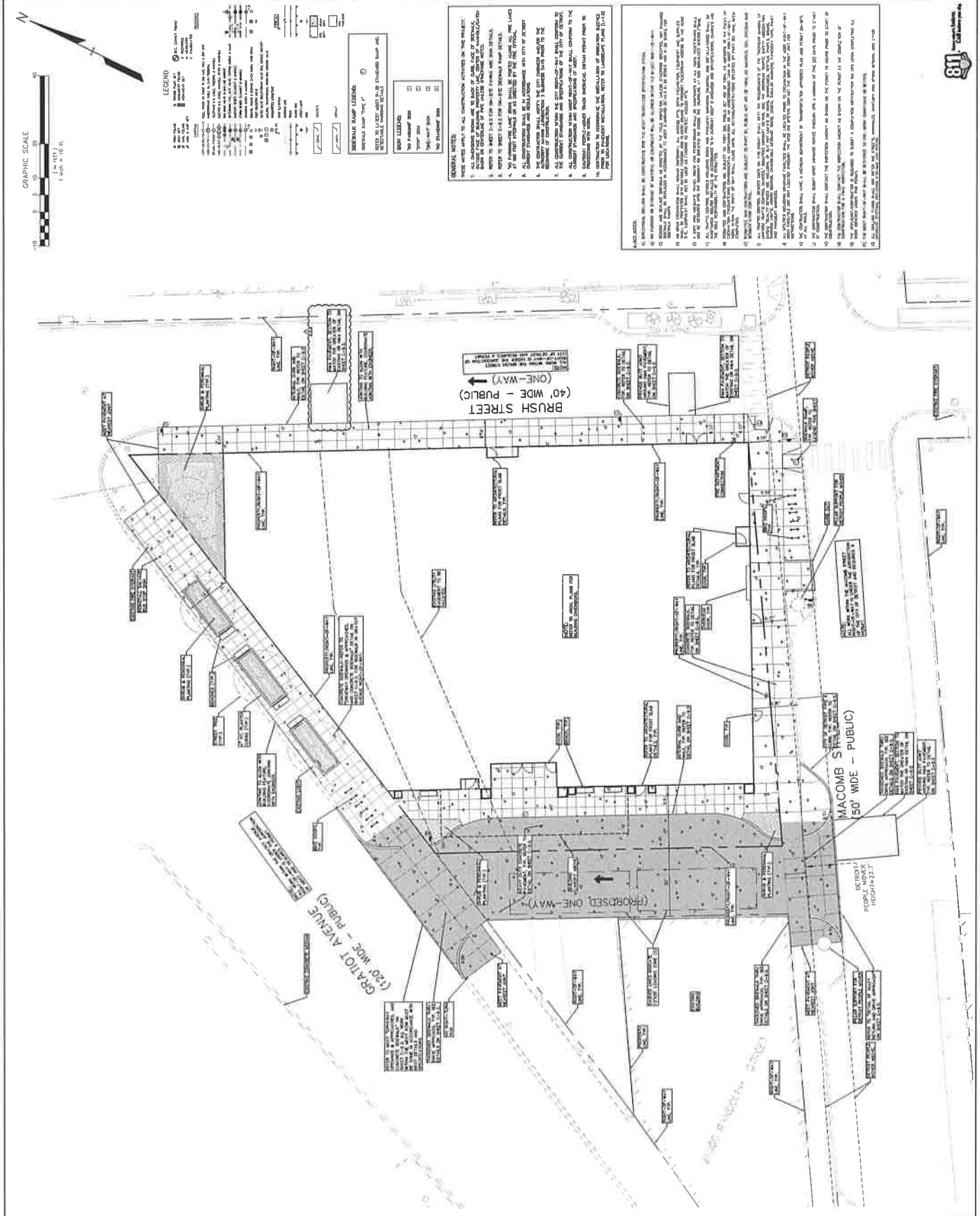

LEGEND

1. EXISTING WALL
 2. EXISTING WINDOW
 3. EXISTING DOOR
 4. EXISTING CEILING
 5. EXISTING FLOOR
 6. EXISTING ROOF
 7. EXISTING UTILITY
 8. EXISTING LANDSCAPE
 9. EXISTING PAVEMENT
 10. EXISTING CURB

11. NEW WALL
 12. NEW WINDOW
 13. NEW DOOR
 14. NEW CEILING
 15. NEW FLOOR
 16. NEW ROOF
 17. NEW UTILITY
 18. NEW LANDSCAPE
 19. NEW PAVEMENT
 20. NEW CURB

21. REMOVE WALL
 22. REMOVE WINDOW
 23. REMOVE DOOR
 24. REMOVE CEILING
 25. REMOVE FLOOR
 26. REMOVE ROOF
 27. REMOVE UTILITY
 28. REMOVE LANDSCAPE
 29. REMOVE PAVEMENT
 30. REMOVE CURB

GENERAL NOTES

1. ALL DIMENSIONS ARE TO FACE UNLESS OTHERWISE NOTED.

2. ALL DIMENSIONS ARE TO FACE UNLESS OTHERWISE NOTED.

3. ALL DIMENSIONS ARE TO FACE UNLESS OTHERWISE NOTED.

4. ALL DIMENSIONS ARE TO FACE UNLESS OTHERWISE NOTED.

5. ALL DIMENSIONS ARE TO FACE UNLESS OTHERWISE NOTED.

6. ALL DIMENSIONS ARE TO FACE UNLESS OTHERWISE NOTED.

7. ALL DIMENSIONS ARE TO FACE UNLESS OTHERWISE NOTED.

8. ALL DIMENSIONS ARE TO FACE UNLESS OTHERWISE NOTED.

9. ALL DIMENSIONS ARE TO FACE UNLESS OTHERWISE NOTED.

10. ALL DIMENSIONS ARE TO FACE UNLESS OTHERWISE NOTED.

11. ALL DIMENSIONS ARE TO FACE UNLESS OTHERWISE NOTED.

12. ALL DIMENSIONS ARE TO FACE UNLESS OTHERWISE NOTED.

13. ALL DIMENSIONS ARE TO FACE UNLESS OTHERWISE NOTED.

14. ALL DIMENSIONS ARE TO FACE UNLESS OTHERWISE NOTED.

15. ALL DIMENSIONS ARE TO FACE UNLESS OTHERWISE NOTED.

16. ALL DIMENSIONS ARE TO FACE UNLESS OTHERWISE NOTED.

17. ALL DIMENSIONS ARE TO FACE UNLESS OTHERWISE NOTED.

18. ALL DIMENSIONS ARE TO FACE UNLESS OTHERWISE NOTED.

19. ALL DIMENSIONS ARE TO FACE UNLESS OTHERWISE NOTED.

20. ALL DIMENSIONS ARE TO FACE UNLESS OTHERWISE NOTED.

GENERAL NOTES

1. ALL DIMENSIONS ARE TO FACE UNLESS OTHERWISE NOTED.

2. ALL DIMENSIONS ARE TO FACE UNLESS OTHERWISE NOTED.

3. ALL DIMENSIONS ARE TO FACE UNLESS OTHERWISE NOTED.

4. ALL DIMENSIONS ARE TO FACE UNLESS OTHERWISE NOTED.

5. ALL DIMENSIONS ARE TO FACE UNLESS OTHERWISE NOTED.

6. ALL DIMENSIONS ARE TO FACE UNLESS OTHERWISE NOTED.

7. ALL DIMENSIONS ARE TO FACE UNLESS OTHERWISE NOTED.

8. ALL DIMENSIONS ARE TO FACE UNLESS OTHERWISE NOTED.

9. ALL DIMENSIONS ARE TO FACE UNLESS OTHERWISE NOTED.

10. ALL DIMENSIONS ARE TO FACE UNLESS OTHERWISE NOTED.

11. ALL DIMENSIONS ARE TO FACE UNLESS OTHERWISE NOTED.

12. ALL DIMENSIONS ARE TO FACE UNLESS OTHERWISE NOTED.

13. ALL DIMENSIONS ARE TO FACE UNLESS OTHERWISE NOTED.

14. ALL DIMENSIONS ARE TO FACE UNLESS OTHERWISE NOTED.

15. ALL DIMENSIONS ARE TO FACE UNLESS OTHERWISE NOTED.

16. ALL DIMENSIONS ARE TO FACE UNLESS OTHERWISE NOTED.

17. ALL DIMENSIONS ARE TO FACE UNLESS OTHERWISE NOTED.

18. ALL DIMENSIONS ARE TO FACE UNLESS OTHERWISE NOTED.

19. ALL DIMENSIONS ARE TO FACE UNLESS OTHERWISE NOTED.

20. ALL DIMENSIONS ARE TO FACE UNLESS OTHERWISE NOTED.

GENERAL NOTES

1. ALL DIMENSIONS ARE TO FACE UNLESS OTHERWISE NOTED.

2. ALL DIMENSIONS ARE TO FACE UNLESS OTHERWISE NOTED.

3. ALL DIMENSIONS ARE TO FACE UNLESS OTHERWISE NOTED.

4. ALL DIMENSIONS ARE TO FACE UNLESS OTHERWISE NOTED.

5. ALL DIMENSIONS ARE TO FACE UNLESS OTHERWISE NOTED.

6. ALL DIMENSIONS ARE TO FACE UNLESS OTHERWISE NOTED.

7. ALL DIMENSIONS ARE TO FACE UNLESS OTHERWISE NOTED.

8. ALL DIMENSIONS ARE TO FACE UNLESS OTHERWISE NOTED.

9. ALL DIMENSIONS ARE TO FACE UNLESS OTHERWISE NOTED.

10. ALL DIMENSIONS ARE TO FACE UNLESS OTHERWISE NOTED.

11. ALL DIMENSIONS ARE TO FACE UNLESS OTHERWISE NOTED.

12. ALL DIMENSIONS ARE TO FACE UNLESS OTHERWISE NOTED.

13. ALL DIMENSIONS ARE TO FACE UNLESS OTHERWISE NOTED.

14. ALL DIMENSIONS ARE TO FACE UNLESS OTHERWISE NOTED.

15. ALL DIMENSIONS ARE TO FACE UNLESS OTHERWISE NOTED.

16. ALL DIMENSIONS ARE TO FACE UNLESS OTHERWISE NOTED.

17. ALL DIMENSIONS ARE TO FACE UNLESS OTHERWISE NOTED.

18. ALL DIMENSIONS ARE TO FACE UNLESS OTHERWISE NOTED.

19. ALL DIMENSIONS ARE TO FACE UNLESS OTHERWISE NOTED.

20. ALL DIMENSIONS ARE TO FACE UNLESS OTHERWISE NOTED.

GENERAL NOTES

1. ALL DIMENSIONS ARE TO FACE UNLESS OTHERWISE NOTED.

2. ALL DIMENSIONS ARE TO FACE UNLESS OTHERWISE NOTED.

3. ALL DIMENSIONS ARE TO FACE UNLESS OTHERWISE NOTED.

4. ALL DIMENSIONS ARE TO FACE UNLESS OTHERWISE NOTED.

5. ALL DIMENSIONS ARE TO FACE UNLESS OTHERWISE NOTED.

6. ALL DIMENSIONS ARE TO FACE UNLESS OTHERWISE NOTED.

7. ALL DIMENSIONS ARE TO FACE UNLESS OTHERWISE NOTED.

8. ALL DIMENSIONS ARE TO FACE UNLESS OTHERWISE NOTED.

9. ALL DIMENSIONS ARE TO FACE UNLESS OTHERWISE NOTED.

10. ALL DIMENSIONS ARE TO FACE UNLESS OTHERWISE NOTED.

11. ALL DIMENSIONS ARE TO FACE UNLESS OTHERWISE NOTED.

12. ALL DIMENSIONS ARE TO FACE UNLESS OTHERWISE NOTED.

13. ALL DIMENSIONS ARE TO FACE UNLESS OTHERWISE NOTED.

14. ALL DIMENSIONS ARE TO FACE UNLESS OTHERWISE NOTED.

15. ALL DIMENSIONS ARE TO FACE UNLESS OTHERWISE NOTED.

16. ALL DIMENSIONS ARE TO FACE UNLESS OTHERWISE NOTED.

17. ALL DIMENSIONS ARE TO FACE UNLESS OTHERWISE NOTED.

18. ALL DIMENSIONS ARE TO FACE UNLESS OTHERWISE NOTED.

19. ALL DIMENSIONS ARE TO FACE UNLESS OTHERWISE NOTED.

20. ALL DIMENSIONS ARE TO FACE UNLESS OTHERWISE NOTED.



2021-02-12

1383

1383 *Petition of Gratiot Acquisition Partners, LLC, request for encroachment into Macomb Street, between Randolph Street and Brush Street. For the purpose of installing Bike Racks upon the sidewalk on the north side of Macomb Street*

REFERRED TO THE FOLLOWING DEPARTMENT(S)

PLANNING AND DEVELOPMENT DEPARTMENT

DPW - CITY ENGINEERING DIVISION