

City of Detroit
City Engineering Division, Department of Public Works
Maps and Records Bureau

NOTICE OF PROPOSED CHANGE IN PROPERTY

Date: _____

Petition: _____

- | | |
|---|---|
| <input type="checkbox"/> AT&T Telecommunication | |
| <input type="checkbox"/> Comcast Television (CATV) | <input type="checkbox"/> Berm Use |
| <input type="checkbox"/> Detroit Edison (DTE) | |
| <input type="checkbox"/> Fire Department | <input type="checkbox"/> Conversion to Easement |
| <input type="checkbox"/> Great Lakes Water Authority | |
| <input type="checkbox"/> Land Bank Authority | <input type="checkbox"/> Dedication |
| <input type="checkbox"/> Michcon (DTE) | |
| <input type="checkbox"/> Planning & Development Department | <input type="checkbox"/> Encroachment |
| <input type="checkbox"/> Public Lighting Authority | |
| <input type="checkbox"/> Public Lighting Department | <input type="checkbox"/> Outright Vacation |
| <input type="checkbox"/> Police Department | |
| <input type="checkbox"/> Solid Waste Division, DPW | <input type="checkbox"/> Temporary Closing |
| <input type="checkbox"/> Street Design Bureau, DPW | |
| <input type="checkbox"/> Street Maintenance Division, DPW | |
| <input type="checkbox"/> Traffic Engineering Division, DPW | |
| <input type="checkbox"/> Water and Sewerage Department | |
| <input type="checkbox"/> Detroit Thermal | |
| <input type="checkbox"/> International Transmission Company (ITC) | |

A petition drawing is attached. Property shown on the attached print is proposed to be changed as indicated. Kindly report (using the back of this sheet) the nature of your services, if any affected by the proposed change and the estimated costs of removing and rerouting such services (if necessary). If a response is not received after a second notice of proposed change has been issued DPW will make the determination to move forward with the petition.

Please return one copy to City Engineering Division, DPW within two weeks of the submittal date. Retain one copy and print for you file.

Ron Brundidge, Director, Department of Public Works

By: Richard Doherty, CED DPW
City Engineer

**TO: City Engineering Division, DPW
2 Woodward Ave., Suite 642
Detroit, Michigan 48226-3462
Survey Bureau: 313-224-3970**

Petition: _____

The proposed change in property (referred to on the other side of this sheet) would affect our services as follows:

- Not Involved

- Involved; but no objections to the property change.
PDD staff involvement is ongoing with the FCA CBO and project and community planning for this area.
- Involved; objection to the property change.

- Involved; the nature of our services and the estimated costs of removing and/or rerouting such services are:

Objections, Please leave a brief explanation for any objection or the nature of an estimated cost:

(Utility or City Department)

Dregory J. Moore

By _____

Title

Date

Area code – Telephone number

Janice M. Winfrey
City Clerk

City of Detroit
OFFICE OF THE CITY CLERK

Andre P. Gilbert II
Deputy City Clerk

DEPARTMENTAL REFERENCE COMMUNICATION

Tuesday, January 19, 2021

To: The Department or Commission Listed Below

From: Janice M. Winfrey, Detroit City Clerk

The following petition is herewith referred to you for report and recommendation to the City Council.

In accordance with that body's directive, kindly return the same with your report in duplicate within four (4) weeks.

LEGISLATIVE POLICY DIVISION PLANNING AND DEVELOPMENT DEPARTMENT
LAW DEPARTMENT FINANCE DEPT/ASSESSMENTS DIVISION

1376 *FCA US LLC request to vacate and convert into a public utility various streets and alleys existing north of Carpenter Street and west of Dequindre Street, bounded by the City of Detroit City Limit and the I-75 Freeway.*



CITY OF DETROIT
DEPARTMENT OF PUBLIC WORKS
CITY ENGINEERING DIVISION

COLEMAN A. YOUNG MUNICIPAL CENTER
2 WOODWARD AVE. SUITE 601
DETROIT, MICHIGAN 48226
PHONE: (313) 224-3949 TTY: 711
WWW.DETROITMI.GOV

To: Clerk's Office
From: The Department of Public Works
City Engineering Division
MapsandRecordsBureau@DetroitMI.Gov
(313) 224-3970

Petitioner:
FCA US LLC
Represented by Dickinson Wright PLLC
200 Ottawa Avenue, N W Suite 1000
Grand Rapids, MI 49503
616-336-1060

On behalf of the above mentioned petitioner the Department of Public Works: City Engineering Division is submitting a petition request for the below mentioned action. The petitioner has received a project consultation from the Department of Public Works: City Engineering Division and has been advised the following:

Type of action recommended:

Petition to vacate and convert into a public utility various streets and alleys existing north of Carpenter Street and west of Dequindre Street, bounded by the City of Detroit City Limit and the I75 Freeway.

Reviewed by:

Jered Dean
Manager II

Maps and Records Bureau
MapsandRecordBureau@Detroitmi.gov
313-224-3970



200 OTTAWA AVENUE, NW, SUITE 1000
GRAND RAPIDS, MI 49503-2427
TELEPHONE: 616-458-1300
FACSIMILE: 844-670-6009
<http://www.dickinsonwright.com>

TIMOTHY A. STOEPKER
TStoepker@dickinsonwright.com
616-336-1060

October 14, 2020

The Honorable City Council
Attention: Janice M. Winfrey, Detroit City Clerk
City of Detroit
2 Woodward Avenue
Coleman A, Young Municipal Center, Suite 200
Detroit, Michigan 48226

Re: FCA US LLC Petition/Letter of Intent to Outright Vacate Public Right of Ways in the City of Detroit

Dear Clerk Winfrey:

On behalf of FCA US LLC ("Petitioner"), we are submitting the enclosed Petition to the Detroit City Council to outright/fully vacate the following three right of ways in the City of Detroit:

- Greeley Street, Riopelle Street, and the alley which lies adjacent to Lots 179 through 201, both inclusive within Bessenger and Moores Add. To Highland Park, according to the plat thereof recorded in Liber 26 of Plats, page 14 Wayne County Records, which lies Southerly of Dequindre Street and the Walter P. Chrysler Freeway ("Parcel 1"), as generally depicted in **Exhibit 1** to this letter.
- Riopelle Street, and the alley within Crampton's Sub., according to the plat thereof recorded at Liber 31 of Plats, page 57, Wayne County Records, which lies southerly of Dequindre Street and the Walter P. Chrysler Freeway ("Parcel 2"), as generally depicted in **Exhibit 1** to this letter.
- All that part of the South ½ of the ¼ Section 18, Ten Thousand Acre Tract, City of Detroit, Wayne County, Michigan, described as: beginning at the intersection of the Westerly Dequindre Street, 66 feet wide, with the Southerly line of Ostrander's Subdivision (Liber 26, page 72); thence along the South line of said Ostrander's Subdivision, Crampton's Subdivision (Liber 31, page 57), and Besieger and Moore's Add. (Liber 26, page 14) South 64 degrees 04 minutes West 798.00 feet; thence along the extension Southerly of the Westerly line of Greeley Ave., 50 feet wide, South 26 degrees 00 minutes 50 seconds East, 17.76 feet; thence along the North side of an existing fence, North 64 degrees 05 minutes 45 seconds East 798.00 feet; thence along the Westerly line of Dequindre Street, North 26 degrees 00 minutes 50 seconds West 18.20 feet to the point of beginning ("Parcel 3) as generally depicted in **Exhibit 1**.

Petitioner owns all of the land adjacent to Parcels 1, 2 and 3, as confirmed by deeds attached as **Exhibit 2**.

The Honorable City Council
 October 14, 2020
 Page 2

The proposed vacation of Parcels 1, 2 and 3 will not create a dead-end street or alley. (Petitioner is not seeking to vacate Dequindre Street, which is a Michigan Department of Transportation right of way.)

The vacation of Parcels 1, 2 and 3, which have not been in use by the public, are required to enable the Petitioner to expand existing parking and outdoor storage areas which are accessory to and support the adjacent Petitioner's warehouse, as generally depicted in the preliminary site plan ("Project Site Plan") attached as **Exhibit 3**.

To the extent utilities including City of Detroit utilities are present in the right of way Parcels 1, 2 & 3 said utilities are not being relocated. Accordingly, simultaneously with the vacation of the right of ways, Petitioner will execute standard/customary easement agreement the City of Detroit and the other utilities which will be recorded at the Petitioner's expense with the Wayne County Register of Deeds.

The Petitioner has been in contact with DTE Energy regarding the Petition to vacate and has confirmed with DTE that to the extent DTE has power lines and equipment in the right of ways that the Petitioner will grant DTE easements to keep the power lines and equipment as currently located.

The Petitioner's contact for purposes of the Petition to Vacate Parcels 1, 2 & 3 is:

Ronald Stallworth, Senior Manager External/Governmental Affairs
 FCA US LLC
 1000 Chrysler Dr.
 Auburn Hills, Michigan 48236
 E-mail: ronald.stallworth@fcagroup.com

If additional information is needed with regard to the Petition and this Letter of Intent, please contact either Mr. Stallworth or the undersigned.

Your cooperation in processing the Petition to Vacate Parcels 1, 2 and 3 is greatly appreciated.

Sincerely,



Timothy A. Stoepker

TAS
 Enclosure
 Cc:

EXHIBIT 1
PARCELS 1, 2 AND 3 DEPICTION

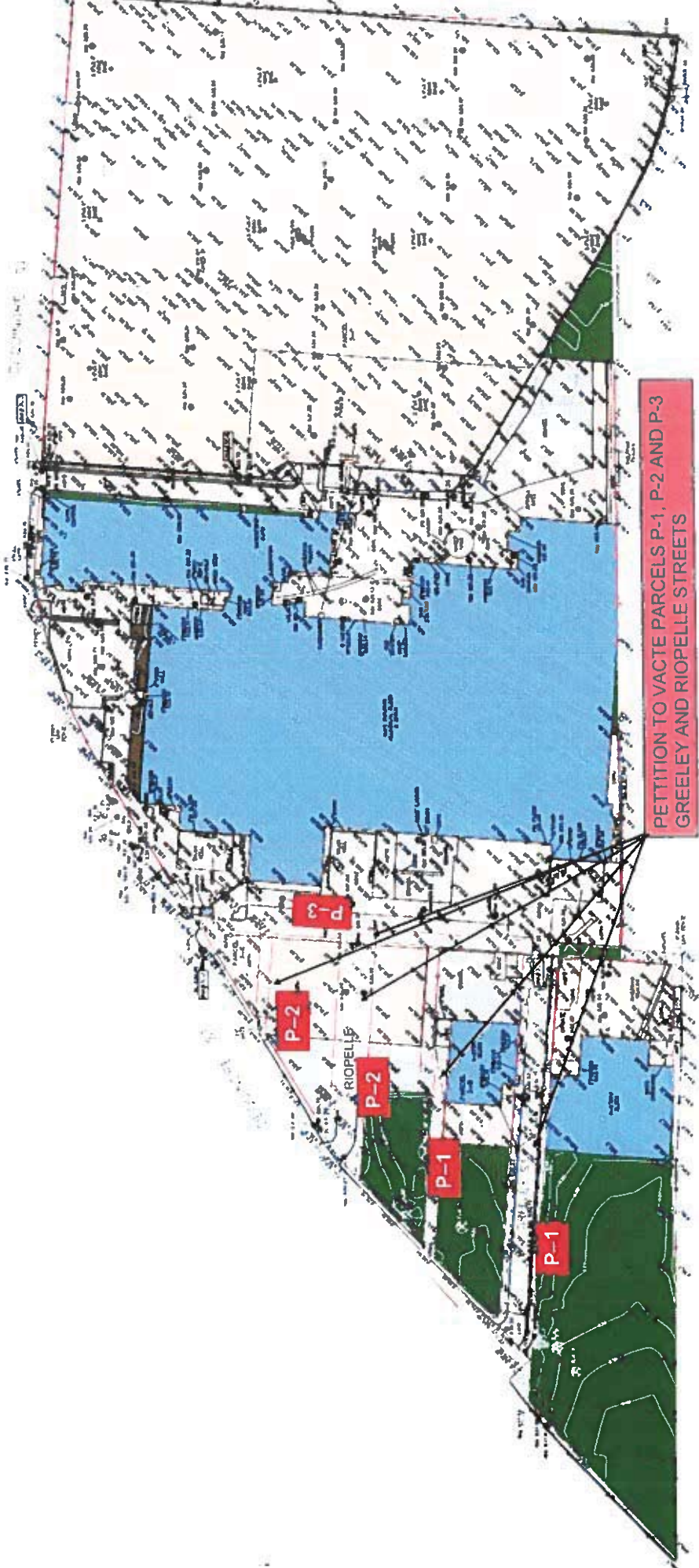

PETITION TO VACTE PARCELS P-1, P-2 AND P-3
GREELEY AND RIOPELLE STREETS

EXHIBIT 2 PETITIONER DEEDS FOR ADJACENT LAND

“The attached Quit Claim Deed (the “Deed”) evidences a conveyance of the subject property from Chrysler LLC, a Delaware limited liability company to New Carco Acquisition LLC, a Delaware limited liability company.

As the Deed notes, the conveyance was made pursuant to an Order of Sale, dated June 1, 2009, of the United States Bankruptcy Court for the Southern District of New York under section 363 of title 11 of the United States Code in the matter entitled in re Chrysler LLC, et al., Case No. 09-50002 (AJG). A copy of the Order of Sale has been recorded with the Wayne County Register of Deeds as part of this Deed and can be provided to you upon request.

Following the Order of Sale, the property came to be legally owned by FCA US LLC, a Delaware limited liability company, as a result of the following:

Following the execution of the attached Deed by Chrysler LLC to New Carco Acquisition LLC, New Carco Acquisition LLC changed its name to Chrysler Group LLC. Then on December 15, 2014, Chrysler Group LLC changed its name to FCA US LLC.”

2009 JUN 12 AM 8:40

P.A. 3270 1968
AFFIDAVIT FILED

P.A. 327 OF 1968
AFFIDAVIT FILED

Bernard J. Youngblood
Wayne County Register of Deeds
June 12, 2009 08:39 AM
Liber 47967 Page 262-518
#209231675 GCD FEE: \$783.00

QUIT CLAIM DEED

CHRYSLER LLC, a Delaware limited liability company (f/k/a DaimlerChrysler Company LLC), successor by conversion to DaimlerChrysler Corporation (f/k/a Chrysler Corporation), successor by merger to Acustar, Inc., whose address is 1000 Chrysler Drive, Auburn Hills, Michigan 48326 ("Grantor"), for One Dollar (\$1.00) and other good and valuable consideration (see Real Estate Transfer Tax Valuation filed herewith), quit claims to NEW CARCO ACQUISITION LLC, a Delaware limited liability company, whose address is 1000 Chrysler Drive, Auburn Hills, Michigan 48326 ("Grantee") all that certain real property situated in the City of Detroit, County of Wayne, State of Michigan described on Exhibit A attached hereto and made a part hereof, commonly known as 12501 Chrysler Drive, Detroit, Wayne, Michigan 48288. Parcel ID No. Ward 9, Item 19668-70; Ward 9, Item 19039-129; Ward 9, Item 9017.38; Ward 9, Item 18333-8; Ward 9, Item 18339-83; Ward 9, Item 17066-70.

Z
M
O
S
S
E
O

This conveyance is made pursuant to an Order of Sale, dated June 1, 2009, of the United States Bankruptcy Court for the Southern District of New York under section 363 of title 11 of the United States Code in the matter entitled In re Chrysler LLC, et. al., Case No. 09-50002 (AJG). A true and correct copy of said Order of Sale is attached hereto as Exhibit B.

This property may be located within the vicinity of farmland or a farm operation. Generally accepted agricultural and management practices which may generate noise, dust, odors and other associated conditions may be used and are protected by the Michigan Right to Farm Act.

Grantor grants to Grantee the right to make the maximum divisions, if any, available under Section 108 of the Land Division Act, being Act No. 288 of the Public Acts of 1967.

Fidelity National Title

[No Further Text On This Page; Signature Page Follows]

MI 0044

L 47967 - P 263

WITNESS its hand and seal this 10 day of June, 2009.

CHRYSLER LLC,
a Delaware limited liability company

By: Jan A. Bertsch
Name: Jan A. Bertsch
Its: Senior Vice President, Treasurer and
Chief Information Officer

MI 0044

STATE OF MICHIGAN)
) SS.
COUNTY OF OAKLAND)

BE IT REMEMBERED that on this 26th day of May, 2009, before me, a Notary Public, personally came Jan A. Bertsch who proved to me on the basis of satisfactory evidence to be the person whose name is subscribed as Senior Vice President, Treasurer and Chief Information Officer of Chrysler LLC, Grantor herein, and acknowledged as such officer that she did sign the company's name to the foregoing instrument and that the signing of the same is the duly authorized and voluntary act and deed of said company for the uses and purposes therein mentioned.

IN TESTIMONY WHEREOF, I have hereunto subscribed my name and affixed my official seal on the day and year last aforesaid.

Notary Public, Oakland County
State of Michigan
My Commission Expires: October 3, 2013
*Acting in
Oakland*

THIS INSTRUMENT PREPARED BY AND RETURN TO:

Scott D. Miller
Sullivan & Cromwell LLP
125 Broad Street
New York, NY 10004

MI 0044

Commitment No.: 07135044Z REV. #2

Fidelity National Title Insurance Company**LEGAL DESCRIPTION****EXHIBIT "A"**

THE LAND REFERRED TO HEREIN BELOW IS SITUATED IN THE COUNTY OF WAYNE, STATE OF MICHIGAN, AND IS DESCRIBED AS FOLLOWS:

Land Situated in the State of Michigan, County of Wayne, City of Detroit.

Parcel 1:

All of Lots 252 through 296, both inclusive, and part of Lots 248 through 251, both inclusive, and part of Lots 297 through 301, both inclusive, of Bessenger and Moore's Addition to Highland Park, 1/4 Section 18, 10,000 Acre Tract, Hamtramck, Wayne County, Michigan (now City of Detroit), recorded in Liber 26 of Plats, Page 14, Wayne County Records and described as: Beginning on the Westerly line of Greeley Avenue, 50 feet wide, at the Southeast corner of said Lot 272; thence along the Southerly line of said Lots 272 and 273, South 64 degrees 08 minutes 00 seconds West 165.50 feet; thence along the Easterly Right of Way line of Grand Trunk Railroad, 111 feet wide, North 30 degrees 34 minutes 00 seconds West 862.72 feet; thence along the Southerly Right of Way line of Walter P. Chrysler Freeway (I-75) South 73 degrees 14 minutes 56 seconds East 319.43 feet; thence along the Westerly line of said Greeley Avenue, South 25 degrees 58 minutes 00 seconds East 643.53 feet to the point of beginning.

Parcel 2:

All of Lots 187 through 200 both inclusive and parts of Lots 201, 202 and 203, Bessenger and Moore's Addition to Highland Park, 1/4 Section 18, 10,000 Acre Tract, Hamtramck, Wayne County, Michigan, Now City of Detroit, as recorded in Liber 26 of Plats, Page 14, Wayne County Records, and described as: Beginning on the Easterly line of Greeley Avenue, 50 feet wide, at the Southwesterly corner of said Lot 187; thence along the Easterly line of said Greeley Avenue, North 25 degrees 58 minutes 00 seconds West 522.23 feet; thence along the Northerly line of said Lot 203, North 63 degrees 55 minutes 00 seconds East 11.88 feet; thence along the Southerly Right of Way line of Walter P. Chrysler Freeway (I-75) South 74 degrees 48 minutes 57 seconds East 117.03 feet; thence along the Westerly line of public alley, 16 feet wide, South 25 degrees 58 minutes 00 seconds East 282.81 feet and North 83 degrees 55 minutes 00 seconds East 21.50 feet and South 25 degrees 58 minutes 00 seconds East 162.69 feet; thence along the Southerly line of said Lot 187, South 64 degrees 08 minutes 00 seconds West 121.50 feet to the point of beginning.

Parcel 3:

All of Lots 182 through 186, both inclusive, and part of Lots 179, 180 and 181 of Bessenger and Moore's Addition to Highland Park, 1/4 Section 18, 10,000 Acre Tract, Hamtramck, Wayne County, Michigan, Now City of Detroit, as recorded in Liber 26 of Plats, Page 14, Wayne County Records, and all of Lots 13 through 18, both inclusive of Crampton's Subdivision of part of 1/4 Section 18, 10,000 Acre Tract, Hamtramck, Wayne County, Michigan, Now City of Detroit, as recorded in Liber 31 of Plats, Page 57, Wayne County Records and described as: Beginning on the Westerly line of Riopelle Avenue, 50 feet wide, at the Southeasterly corner of said Lot 18; thence along the Southerly line of said Lot 18, South 64 degrees 08 minutes 00 seconds West 78.50 feet; thence along the Easterly line of public alley 16 feet wide, North 25 degrees 58 minutes 00 seconds West 181.50 feet and South 64 degrees 08 minutes 00 seconds West 21.50 feet and North 25 degrees 58 minutes 00 seconds West 250.02 feet; thence along the Southerly Right of Way line of Walter P. Chrysler Freeway (I-75) South 74 degrees 28 minutes 55 seconds East 133.49 feet; thence along the Westerly line of said Riopelle Ave., South 25 degrees 58 minutes 00 seconds East 343.27 feet to the point of beginning.

Parcel 4:

All of Lots 7, 8, 9 and 10 and part of Lots 11 and 12 of Crampton's Subdivision of part of 1/4 Section 18, 10,000 Acre Tract, Hamtramck, Wayne County, Michigan, Now City of Detroit, as recorded in Liber 31 of Plats, Page 57, Wayne County Records and part of Lots 114 and 115 of Bessenger and Moore's Addition to Highland Park, 1/4 Section 18, 10,000 Acre Tract, Hamtramck, Wayne County, Michigan, Now City of Detroit, as recorded in Liber

ALTA Commitment - 2006

L 47967 - P 267

Title No.: 07135044Z REV. #2

Locate No.:

LEGAL DESCRIPTION
(Continued)

26 of Plats, Page 14, Wayne County Records and described as: Beginning on the Easterly line of Riopelle Avenue, 50 feet wide, at the Southwest corner of said Lot 7; thence along the Easterly line of said Riopelle Avenue, North 25 degrees 58 minutes 00 seconds West 253.50 feet; thence along the Northerly line of said Lot 115, North 63 degrees 55 minutes 00 seconds East 22.54 feet; thence along the Southerly Right of Way line of Walter P. Chrysler (I-75) South 61 degrees 35 minutes 25 seconds East 132.99 feet; thence along the Westerly line of public alley 16 feet wide, South 25 degrees 58 minutes 00 seconds East 145.62 feet; thence along the Southerly line of said Lot 7, South 64 degrees 08 minutes 00 seconds West 100.00 feet to the point of beginning.

Parcel 5:

All that part of Lots 2, 3, 4, 5 and 6 of Crampton's Subdivision of part of 1/4 Section 18, 10,000 Acre Tract, Hamtramck, Wayne County, Michigan, now City of Detroit, as recorded in Liber 31 of Plats, page 57, Wayne County Records and described as: Beginning on the Easterly line of public alley, 16 feet wide, at the Southwesterly corner of said Lot 6; thence along the Easterly line of said public Alley, North 25 degrees 58 minutes 00 seconds West 123.26 feet; thence along the Southerly Right of Way line of Walter P. Chrysler Freeway (I-75) South 61 degrees 35 minutes 25 seconds East 151.86 feet; thence along the Southerly line of said Lot 6, South 64 degrees 08 minutes 00 seconds West 88.45 feet to the point of beginning.

Parcel 6:

A parcel of land being composed of parts of Lots 1, 2, 3, 6, 7 and 8 and all of Lots 4 and 5, Dequindre Industrial Subdivision, of part of the South 1/2 of quarter Section 18, 10,000 Acre Tract, Easterly of G. T. (D. G. H. & M) Railroad, as recorded in Liber 49 of Plats on Page 32; and vacated Halleck Avenue, lying West of Dequindre Avenue, resolution of the Common Council vacating this street is recorded in Liber 15514, Page 213, Wayne County Records; also part of the Southerly half of quarter Section 18, 10,000 Acre Tract, City of Detroit, Wayne County, Michigan, more particularly described as follows: Beginning at a point on the Westerly line of Dequindre Avenue (66 feet wide), said point being the Southeasterly corner of Lot 6 of said Dequindre Industrial Subdivision; thence South 64 degrees 00 minutes 00 seconds West along the Southerly line of said Lot 6, 883.25 feet to a point; thence North 22 degrees 24 minutes 00 seconds West 61.24 feet to a point of curve; Thence running in a Northerly direction of a 12 degree curve to the right 184.72 feet (measured along the length of the curve) to a point of tangent, said curve having a radius of 478.34 feet, central angle of 22 degrees 07 minutes 31 seconds, chord bearing North 11 degrees 10 minutes 40 seconds West 183.56 feet to a point; thence North 00 degrees 27 minutes 50 seconds West 61.50 feet to a point; thence North 30 degrees 35 minutes 00 seconds West 1047.76 feet to a point on the Southerly boundary line of Bessenger and Moore's Addition to Highland Park, recorded in Liber 28, Page 14 of Plats, Wayne County Records; thence North 64 degrees 04 minutes 00 seconds East, along the Southerly boundary line of above mentioned subdivision 92.74 feet to a point; thence South 26 degrees 00 minutes 50 seconds East 17.76 feet to a point; thence North 64 degrees 05 minutes 45 seconds East along the Southerly line of an alley of irregular width dedicated May 1, 1956, J.C.C., page 810-11, Street Opening Book 8 on page 221, City Engineers Records, 536.03 feet to a point on the Southwesterly line of the Chrysler Expressway Right-of-Way; Thence South 61 degrees 35 minutes 40 seconds East along said Southwesterly line of the Chrysler Expressway Right-of-Way to a point on the Northwesterly line of Lot 1 of said Dequindre Industrial Subdivision, 184.55 feet to a point; thence continuing along the Southwesterly line of said Chrysler Expressway Right-of-Way, South 61 degrees 35 minutes 40 seconds East 62.92 feet to a point of curve; thence continuing in a Southeasterly direction on a curve to the right, 126.98 feet (measured along the arc of said curve), to a point on the Northerly line of Lot 2 of Dequindre Industrial Subdivision, the above curve having a radius of 692.20 feet, chord bearing South 56 degrees 20 minutes 17 seconds East 126.81 feet to a point; thence continuing along the above mentioned curve to the right in a Southeasterly direction 143.51 feet, (measured along the arc of said curve), to a point of tangent, the above curve having a radius of 692.20 feet, chord bearing South 45 degrees 08 minutes 37 seconds East 143.25 feet to a point; thence South 39 degrees 12 minutes 18 seconds East 27.58 feet to a point on the Easterly line of Lot 3, or the Westerly line of Dequindre Avenue, (66 feet wide) as platted in Dequindre Industrial Subdivision; thence continuing Southeasterly along said Westerly line of Dequindre Avenue, South 25 degrees 58 minutes 00

ALTA Commitment - 2006

Title No.: 07135044Z REV. #2
Locate No.:

LEGAL DESCRIPTION
(Continued)

seconds East 846.85 feet to the place of beginning.

Parcel ID:

Street Address: 12501 Chrysler Drive, Detroit

ALTA Commitment - 2006

L 47967 - P 265

EXHIBIT B
ORDER OF SALE

MI 0044

UNITED STATES BANKRUPTCY COURT
SOUTHERN DISTRICT OF NEW YORK

-----X
 :
 In re : Chapter 11
 :
 Chrysler LLC, *et al.*, : Case No. 09-50002 (AJG)
 :
 Debtors. : (Jointly Administered)
 :
 -----X

ORDER (I) AUTHORIZING THE SALE OF SUBSTANTIALLY ALL OF THE DEBTORS' ASSETS FREE AND CLEAR OF ALL LIENS, CLAIMS, INTERESTS AND ENCUMBRANCES, (II) AUTHORIZING THE ASSUMPTION AND ASSIGNMENT OF CERTAIN EXECUTORY CONTRACTS AND UNEXPIRED LEASES IN CONNECTION THEREWITH AND RELATED PROCEDURES AND (III) GRANTING RELATED RELIEF

This matter coming before the Court on the motions, dated May 3, 2009 and May 22, 2009 (Docket Nos. 190 and 1742) (collectively, the "Sale Motion")¹ filed by the above-captioned debtors and debtors in possession (collectively, the "Debtors") for entry of an order (the "Sale Order"), pursuant to sections 105, 363 and 365 of the United States Bankruptcy Code, 11 U.S.C. §§ 101, *et seq.* (the "Bankruptcy Code"), Rules 2002, 6004, 6006, 9008 and 9014 of the Federal Rules of Bankruptcy Procedure (the "Bankruptcy Rules") and Rules 2002-1, 6004-1, 6006-1 and 9006-1(b) of the Local Bankruptcy Rules for the United States Bankruptcy Court for the Southern District of New York: (i) authorizing and approving the entry into, performance under and terms and conditions of the Master Transaction Agreement, dated as of April 30, 2009 (collectively with all related agreements, documents or instruments and all exhibits, schedules and addenda to any of the foregoing, and as amended, the "Purchase Agreement"), substantially

¹ Unless otherwise stated, all capitalized terms not defined herein shall have the meanings given to them in the Sale Motion and the Bidding Procedures Order (as defined below).

NY1-4178439v24

EXHIBIT 3 PROJECT PRELIMINARY SITE PLAN

4839-8985-0062 v1 [22624-1172]

DOW North Lot Repaving – Proposed Repaving of Areas A, B & D



City of Detroit

PUBLIC WORKS DEPARTMENT: CITY ENGINEERING DIVISION

Coleman A. Young Municipal Center - 6th Floor

We, the undersigned individuals owning property adjacent to the proposed right-of-way to be vacated have no objections to the request of the petitioner. This petition requires consent by 2/3 of the adjacent owners in residential areas. Commercial areas require 100% of adjacent owners to consent. Properties owned by a business or other entity must be signed by an authorized agent in order to be counted in this petition.

By signing this petition the property owner is confirming awareness of the following changes to their property:

- (1) Vacating the proposed street or alley will result in the property owner being allocated ownership of 1/2 of the street or alley (conditional to the design of the subdivision) and will cause the property assessment to be adjusted to include the increase in square footage.
- (2) Drainage fees to the property will be adjusted based on any added impervious surfaces added to the property. Please contact the Department of Water and Sewage for additional questions regarding rates.
- (3) Garages orientated toward the alley may no longer be accessible by the alley. Upon approval of this petition the alley will no longer be considered public. The property owner waves their right to access their property using the alley.

Commercial properties are subject to the conditions of their land use grant. Which may require permission from the Buildings and Safety Engineering and Environment Department or the Board of Zoning Appeals prior to changing the limits of their property.

FCA US, LLC

PRINT NAME / ADDRESS / DATE SIGNED

Gretchen S. Sonogo 1,000 Chrysler Dr., Auburn Hills, MI 48236
Director - Treasury
SIGNATURE OCTOBER, 14 2020

PRINT NAME / ADDRESS / DATE SIGNED

SIGNATURE

Gretchen Sonogo
Digitally signed by Gretchen Sonogo
DN: CN = Gretchen Sonogo, email = gretchen.
sonogo@treasury.com, C = US, O = FCA US LLC, OU = Treasury
Date: 2020.10.14 10:03:56 -0400