

City of Detroit
City Engineering Division, Department of Public Works
Maps and Records Bureau

NOTICE OF PROPOSED CHANGE IN PROPERTY

Date: _____

Petition: _____

- | | |
|---|---|
| <input type="checkbox"/> AT&T Telecommunication | |
| <input type="checkbox"/> Comcast Television (CATV) | <input type="checkbox"/> Berm Use |
| <input type="checkbox"/> Detroit Edison (DTE) | |
| <input type="checkbox"/> Fire Department | <input type="checkbox"/> Conversion to Easement |
| <input type="checkbox"/> Great Lakes Water Authority | |
| <input type="checkbox"/> Land Bank Authority | <input type="checkbox"/> Dedication |
| <input type="checkbox"/> Michcon (DTE) | |
| <input type="checkbox"/> Planning & Development Department | <input type="checkbox"/> Encroachment |
| <input type="checkbox"/> Public Lighting Authority | |
| <input type="checkbox"/> Public Lighting Department | <input type="checkbox"/> Outright Vacation |
| <input type="checkbox"/> Police Department | |
| <input type="checkbox"/> Solid Waste Division, DPW | <input type="checkbox"/> Temporary Closing |
| <input type="checkbox"/> Street Design Bureau, DPW | |
| <input type="checkbox"/> Street Maintenance Division, DPW | |
| <input type="checkbox"/> Traffic Engineering Division, DPW | |
| <input type="checkbox"/> Water and Sewerage Department | |
| <input type="checkbox"/> Detroit Thermal | |
| <input type="checkbox"/> International Transmission Company (ITC) | |

A petition drawing is attached. Property shown on the attached print is proposed to be changed as indicated. Kindly report (using the back of this sheet) the nature of your services, if any affected by the proposed change and the estimated costs of removing and rerouting such services (if necessary). If a response is not received after a second notice of proposed change has been issued DPW will make the determination to move forward with the petition.

Please return one copy to City Engineering Division, DPW within two weeks of the submittal date. Retain one copy and print for you file.

Ron Brundidge, Director, Department of Public Works

By: Richard Doherty, CED DPW
City Engineer

**TO: City Engineering Division, DPW
2 Woodward Ave., Suite 642
Detroit, Michigan 48226-3462
Survey Bureau: 313-224-3970**

Petition: _____

The proposed change in property (referred to on the other side of this sheet) would affect our services as follows:

- Not Involved
- Involved; but no objections to the property change.
- Involved; objection to the property change.
- Involved; the nature of our services and the estimated costs of removing and/or rerouting such services are:

Objections, Please leave a brief explanation for any objection or the nature of an estimated cost:

(Utility or City Department)

By

Title

Date

Area code – Telephone number

Janice M. Winfrey
City Clerk

City of Detroit
OFFICE OF THE CITY CLERK

Andre P. Gilbert II
Deputy City Clerk

DEPARTMENTAL REFERENCE COMMUNICATION

Tuesday, January 19, 2021

To: The Department or Commission Listed Below

From: Janice M. Winfrey, Detroit City Clerk

The following petition is herewith referred to you for report and recommendation to the City Council.

In accordance with that body's directive, kindly return the same with your report in duplicate within four (4) weeks.

LEGISLATIVE POLICY DIVISION PLANNING AND DEVELOPMENT DEPARTMENT
LAW DEPARTMENT FINANCE DEPT/ASSESSMENTS DIVISION

1371 *Detroit Economic Growth Corporation request to encroach into Aggregate Drive, west of Springwells Court, for the purpose of installing a tunnel below grade.*



CITY OF DETROIT
DEPARTMENT OF PUBLIC WORKS
CITY ENGINEERING DIVISION

COLEMAN A. YOUNG MUNICIPAL CENTER
2 WOODWARD AVE. SUITE 601
DETROIT, MICHIGAN 48226
PHONE: (313) 224-3949 TTY: 711
WWW.DETROITMI.GOV

To: Clerk's Office
From: The Department of Public Works
City Engineering Division
MapsandRecordsBureau@DetroitMI.Gov
(313) 224-3970

Petitioner:
Detroit Economic Growth Corporation
500 Griswold Street, Suite 2200
Detroit, MI, 48226
313-963-2940

On behalf of the above mentioned petitioner the Department of Public Works: City Engineering Division is submitting a petition request for the below mentioned action. The petitioner has received a project consultation from the Department of Public Works: City Engineering Division and has been advised the following:

Type of action recommended:

Petition for encroachment into Aggregate Drive, west of Springwells Court, for the purpose of installing a tunnel below grade.

Reviewed by:

Jered Dean
Manager II

Maps and Records Bureau
MapsandRecordBureau@Detroitmi.gov
313-224-3970

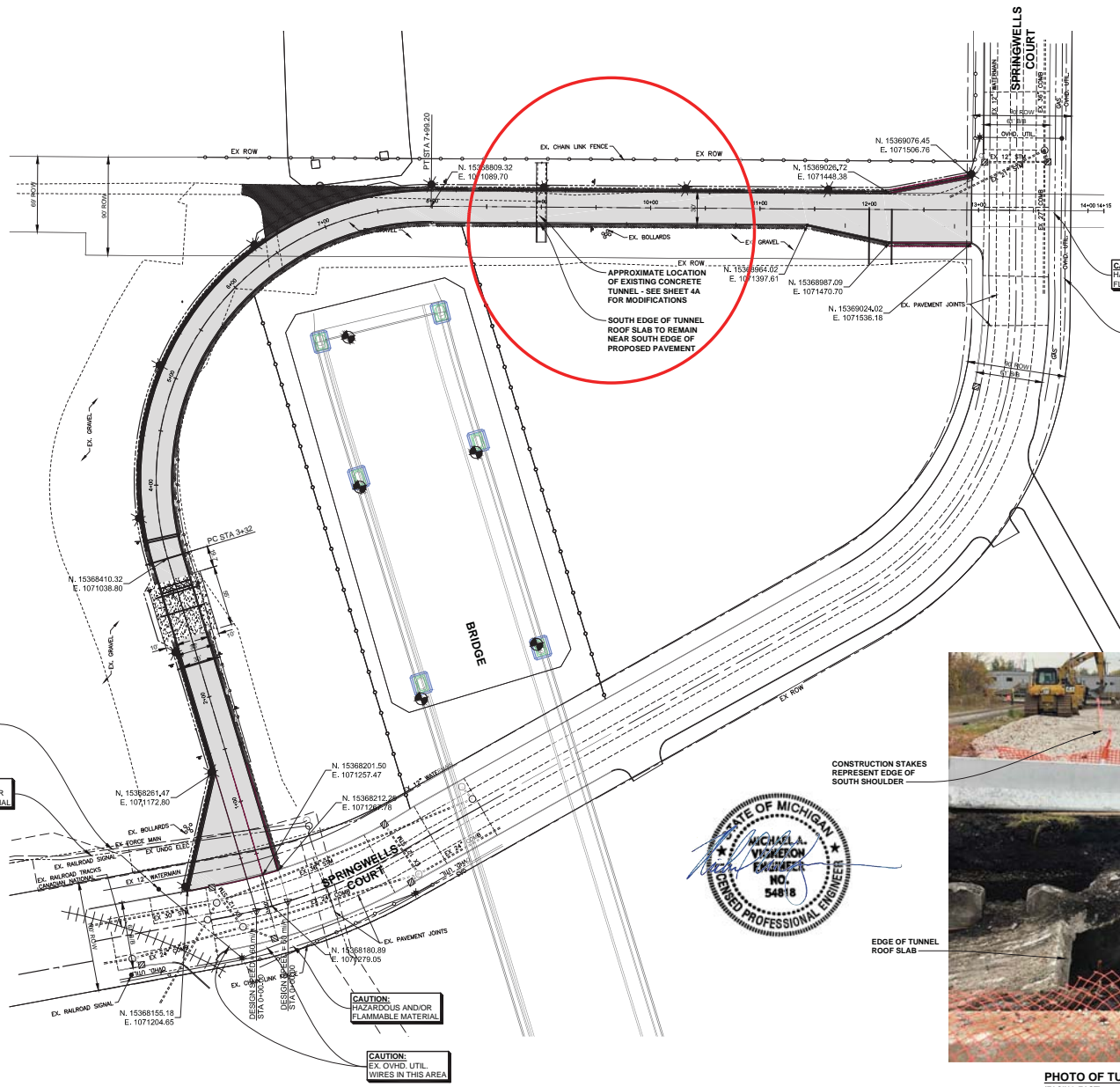
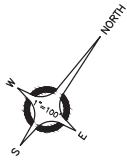

PHOTO OF TUNNEL (FACING EAST)

CLIENT

WDBA APWD
WATER DETROIT BRIDGE AUTHORITY

PROJECT Co.

BRIDGING NORTHAMERICA
CONSULTANT

ANDERSON, ECKSTEIN AND WESTRICK, INC.
CIVIL ENGINEERS SURVEYORS ARCHITECTS
51301 Schoenherr Road Phone 586 726 1234
Shady Township Fax 586 726 8730
Michigan 48315 www.aewinc.com
ENGINEERING STRONG COMMUNITIES

GORDIE HOWE INTERNATIONAL BRIDGE
1-7.5 SPUR OVER DETROIT RIVER
DESIGN UNIT: WDBA
TDC: DETROIT
CS: 803 OF 82194
JN: 1137188
MOOT STRUCTURE NUMBER: 14288
WDBA NUMBER: GOC-GHB-2025-1

UNCLASSIFIED FOR OFFICIAL USE ONLY (U//FOUO)
COPYRIGHT, CONSTRUCTION, OR DISTRIBUTION OF THIS DOCUMENT IS PROHIBITED.
The information contained in this Report/Document is subject to complete and exclusive control by the Responsibility of Government and Operations of Government under the Access to Information Act (R.S.I. 1986, Chapter A.1).
Without limitation, the Report/Document contains information that appears to be commercial in nature or is otherwise exempt from disclosure under the Access to Information Act or other regulations of Canada.

10-05-2025	QUALITY CONTROL REVIEW
DATE	SUBMITAL/REVISIONS

SPRINGWELLS COURT DETOUR

ALIGNMENT PLAN

CLIENT: BNA CONSTRUCTORS USA JV

<input type="checkbox"/> PRELIMINARY	<input type="checkbox"/> CONSTRUCTION	<input type="checkbox"/> RECORD
DRAWN BY: KES	CHECKED BY: JCV	DATE: AUGUST 2025

SCALE: 1" = 100'

811 Know what's below. Call 72 hours before you dig.

UTILITY INFORMATION, AS SHOWN, INDICATES APPROXIMATE LOCATIONS AND TYPES OF EXISTING FACILITIES ONLY. AS DISCLOSED BY RECORDS PROVIDED TO THIS FIRM FROM THE VARIOUS UTILITY COMPANIES. NO GUARANTEE IS GIVEN OR IMPLIED AS TO THE COMPLETENESS OR ACCURACY THEREOF.

PRIOR TO CONSTRUCTION, ALL LOCATING AND DEPICTING OF EXISTING OVERHEAD AND UNDERGROUND UTILITIES (ON CONTACT WITH THE CONSTRUCTION OF THESE PROPOSED IMPROVEMENTS) SHALL BE VERIFIED IN THE FIELD. DURING THE CONSTRUCTION, THE CONTRACTOR SHALL PROTECT AND SUPPORT ALL UTILITIES THAT ARE ENCOUNTERED. CALL LOGS FOR UTILITY LOCATION, VERIFICATION, SUPPORT AND PROTECTION SHALL BE INCLUDED IN THE PROPOSED PAY ITEM CONFLICTING WITH THAT UTILITY.

DURING CONSTRUCTION, THE CONTRACTOR SHALL USE EXTREME CAUTION WHEN OPERATING NEAR ANY AND ALL OVERHEAD AND / OR BURIED UTILITIES.

PROJECT NO: 1594-0001
M:\1594\1594-0001\001\GVD\GVD\10_LCONSTR.DWG
AS 10-05-2025 10:00 AM

SHEET NO: **4** DESIGN PACKAGE 45 PH2

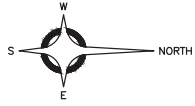

(OPTION) - REMOVE PORTIONS OF TUNNEL BEYOND TIMBER FORMED BULKHEAD

DRILL AND EPOXY GROUT #6 DOWEL X 18" LG INTO TUNNEL MAT WITH ULTRABOND 1 BY ADHESIVE TECHNOLOGIES @ 36" O.C. EACH WAY - EMBED 4" (MIN)

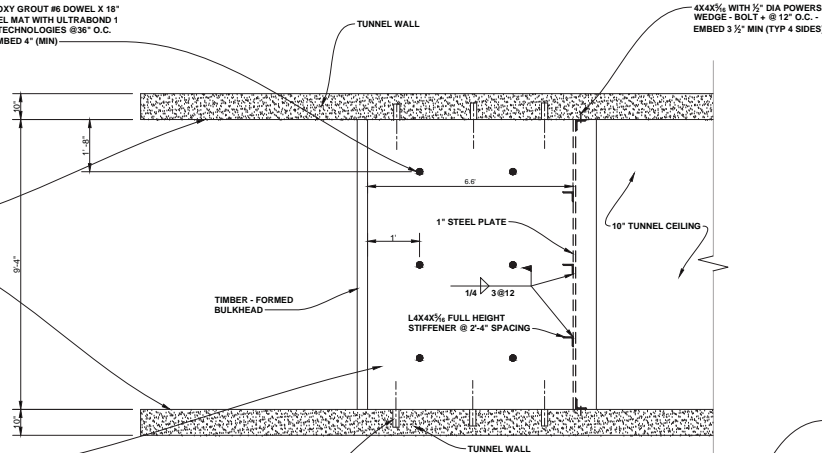

PLAN

SECTION

TUNNEL MODIFICATION DETAILS

SCALE 1"=4'

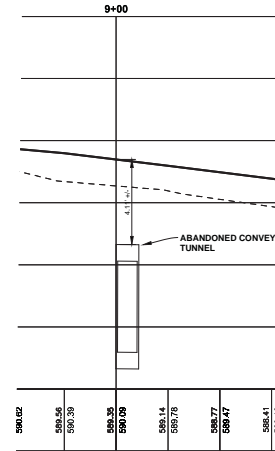

ROAD PROFILE



CLIENT



ANDERSON, ECKSTEIN AND WESTRICK, INC.

CIVIL ENGINEERS SURVEYORS ARCHITECTS
51301 Schoenherr Road Phone 586 726 1234
Shelby Township Fax 586 726 8780
Michigan 48315
www.aewinc.com
ENGINEERING STRONG COMMUNITIES

GORDIE HOWE INTERNATIONAL BRIDGE
1-75 SPUR OVER DETROIT RIVER
DESIGN UNIT: WDBA
TSC: DETROIT
CS: 803 OF 82194
JN: 1137188
MOOT STRUCTURE NUMBER: 14288
WDBA NUMBER: GOC-GHB-2025-1

UNCLASSIFIED FOR OFFICIAL USE ONLY (U)
COPYRIGHT PROTECTION ON DOCUMENTATION OF THIS DOCUMENTARY IS MAINTAINED
The information contained in this Report/Document is the property of the consultant and is not to be distributed, copied, or reproduced in any form without the prior written consent of the consultant. The consultant assumes no responsibility for the accuracy or completeness of the information provided herein. The consultant is not responsible for the consequences of any reliance on the information provided herein. The consultant is not responsible for the consequences of any reliance on the information provided herein. The consultant is not responsible for the consequences of any reliance on the information provided herein.

10-08-2025	QUALITY CONTROL REVIEW
DATE	SUBMITAL/REVISIONS

SPRINGWELLS COURT DETOUR

SHEET TITLE:
EXISTING TUNNEL MODIFICATIONS UNDER PROPOSED ROAD

CLIENT:
BNA CONSTRUCTORS USA JV

<input type="checkbox"/> PRELIMINARY	<input type="checkbox"/> CONSTRUCTION	<input type="checkbox"/> RECORD
DRAWN BY: []	CHECKED BY: []	DATE: []
SCALE: []	DATE: []	DATE: []



UTILITY INFORMATION AS SHOWN INDICATES APPROXIMATE LOCATIONS AND TYPES OF EXISTING UTILITIES ONLY AS DISCLOSED BY RECORDS PROVIDED TO THIS FIRM FROM THE VARIOUS UTILITY COMPANIES. NO GUARANTEE IS GIVEN OR IMPLIED AS TO THE COMPLETENESS OR ACCURACY THEREOF.
PRIOR TO CONSTRUCTION, ALL LOCATIONS AND DEPTHS OF EXISTING OVERHEAD AND UNDERGROUND UTILITIES (ON CONFLICT WITH THE CONSTRUCTION OF THESE PROPOSED IMPROVEMENTS) SHALL BE VERIFIED IN THE FIELD. DURING THE CONSTRUCTION, THE CONTRACTOR SHALL PROTECT AND SUPPORT ALL UTILITIES THAT ARE ENCOUNTERED. CALL COSTS FOR UTILITY LOCATION VERIFICATION, SUPPORT AND PROTECTION SHALL BE INCLUDED IN THE PROPOSED PAY ITEM CONFLICTING WITH THAT UTILITY.
DURING CONSTRUCTION, THE CONTRACTOR SHALL USE EXTREME CAUTION WHEN OPERATING NEAR ANY AND ALL OVERHEAD AND / OR BURIED UTILITIES.

PROJECT NO.: 1594-0001

PROJECT NO.: 1594-0001

DESIGN PACKAGE 45 PH2

4A

DESIGN PACKAGE 45 PH2

COPYRIGHT 2025 ANDERSON, ECKSTEIN AND WESTRICK, INC.

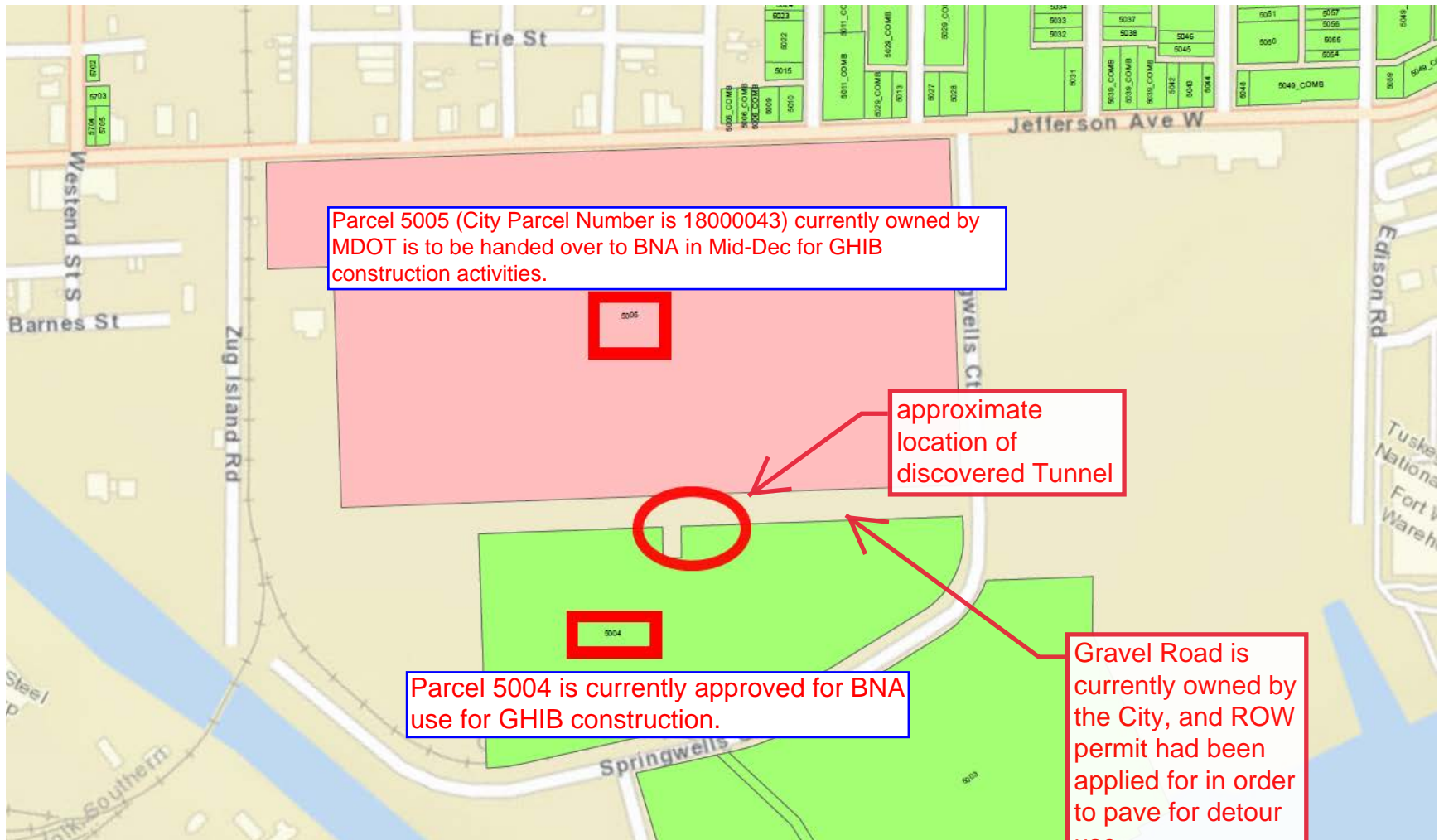

Parcel 5005 (City Parcel Number is 18000043) currently owned by MDOT is to be handed over to BNA in Mid-Dec for GHIB construction activities.

5005

approximate location of discovered Tunnel



5004

Parcel 5004 is currently approved for BNA use for GHIB construction.

Gravel Road is currently owned by the City, and ROW permit had been applied for in order to pave for detour use.