

City of Detroit
City Engineering Division, Department of Public Works
Maps and Records Bureau

NOTICE OF PROPOSED CHANGE IN PROPERTY

Date: 11.17.2020

Petition: x1347

- | | |
|--|--|
| <input type="checkbox"/> AT&T Telecommunication | <input type="checkbox"/> Berm Use |
| <input type="checkbox"/> Comcast Television (CATV) | <input type="checkbox"/> Conversion to Easement |
| <input type="checkbox"/> Detroit Edison (DTE) | <input type="checkbox"/> Dedication |
| <input type="checkbox"/> Fire Department | <input checked="" type="checkbox"/> Encroachment |
| <input type="checkbox"/> Great Lakes Water Authority | <input type="checkbox"/> Outright Vacation |
| <input type="checkbox"/> Land Bank Authority | <input type="checkbox"/> Temporary Closing |
| <input type="checkbox"/> Michcon (DTE) | |
| <input type="checkbox"/> Planning & Development Department | |
| <input type="checkbox"/> Public Lighting Authority | |
| <input type="checkbox"/> Public Lighting Department | |
| <input type="checkbox"/> Police Department | |
| <input type="checkbox"/> Solid Waste Division, DPW | |
| <input type="checkbox"/> Street Design Bureau, DPW | |
| <input checked="" type="checkbox"/> Street Maintenance Division, DPW | |
| <input type="checkbox"/> Traffic Engineering Division, DPW | |
| <input type="checkbox"/> Water and Sewerage Department | |
| <input type="checkbox"/> Detroit Thermal | |
| <input type="checkbox"/> International Transmission Company (ITC) | |

A petition drawing is attached. Property shown on the attached print is proposed to be changed as indicated. Kindly report (using the back of this sheet) the nature of your services, if any affected by the proposed change and the estimated costs of removing and rerouting such services (if necessary). If a response is not received after a second notice of proposed change has been issued DPW will make the determination to move forward with the petition.

Please return one copy to City Engineering Division, DPW within two weeks of the submittal date. Retain one copy and print for you file.

Ron Brundidge, Director, Department of Public Works

By: Richard Doherty, CED DPW
City Engineer

**TO: City Engineering Division, DPW
2 Woodward Ave., Suite 642
Detroit, Michigan 48226-3462
Survey Bureau: 313-224-3970**

Petition: x1347

The proposed change in property (referred to on the other side of this sheet) would affect our services as follows:

- Not Involved
- Involved; but no objections to the property change.
- Involved; objection to the property change.
- Involved; the nature of our services and the estimated costs of removing and/or rerouting such services are:

Objections, Please leave a brief explanation for any objection or the nature of an estimated cost:

DPW/SMD

(Utility or City Department)

Mr. Leslie R Walker

By

Supervisor

Title

11.17.2020

Date

313.224.0019

Area code – Telephone number

Janice M. Winfrey
City Clerk

City of Detroit
OFFICE OF THE CITY CLERK

Andre P. Gilbert II
Deputy City Clerk

DEPARTMENTAL REFERENCE COMMUNICATION

Friday, October 9, 2020

To: The Department or Commission Listed Below

From: Janice M. Winfrey, Detroit City Clerk

The following petition is herewith referred to you for report and recommendation to the City Council.

In accordance with that body's directive, kindly return the same with your report in duplicate within four (4) weeks.

PLANNING AND DEVELOPMENT DEPARTMENT DPW - CITY ENGINEERING DIVISION

1347 *Empire Petroleum Partners LLC, request to encroach into Fairfield Ave, W McNichols and Muirland St right-of-way for the purpose of installing a monitoring well related to the property known as 3345 W McNichols.*

2 Woodward Ave. Coleman A. Young Municipal Center Rm. 200, Detroit, MI 48226

(313) 224 - 3260 | Fax: (313) 224 - 1466



Corporate Headquarters
Lansing, Michigan
3340 Ranger Road, Lansing, MI 48906
f: 877.884.6775
t: 517.321.3931

Michigan Locations
Berkley Bay City
Grand Rapids Detroit
Chesterfield Lansing

September 9, 2020

City of Detroit City Council
Coleman A. Young Municipal Center
2 Woodward Avenue, Suite 1340
Detroit, Michigan 48226

RE: Request to Install 11 Groundwater Monitoring Wells Within the West McNichols Road Right of Ways, Fairfield Avenue Right of Ways, and Muirland Street Right of Way, Detroit, Wayne County, Michigan and to Install Two Groundwater Monitoring Wells Within the Public Alley south of 3345 West McNichols Road, Detroit, Wayne County, Michigan

To Whom It May Concern,

PM Environmental, Inc. (PM) is under contract with Empire Petroleum Partners, LLC (Owner) to investigate the extent of impact resulting from an open leaking underground storage tank (LUST) gasoline release (C-0010-20) at the Citgo gasoline dispensing station located at 3345 West McNichols Road, Detroit, Wayne County, Michigan.

PM is requesting approval, in addition to submitting a permit application, to conduct subsurface work on behalf of Empire Petroleum Partners, LLC within the West McNichols Road Right of Ways, Fairfield Avenue Right of Ways, and Muirland Street Right of Way, as well as the public alley way south of 3345 West McNichols Road, Detroit, as shown in the attached Figure 1. PM will install 13 soil borings to a total depth of 25 feet below ground surface to collect soil samples and convert the soil borings to permanent groundwater monitoring wells. The investigation will begin as soon as the permit has been granted and will continue until regulatory closure of release C-0010-20 is achieved. Following closure, all well materials will be removed from the ground and the area returned to normal conditions.

If you have any questions related to this report, please do not hesitate to contact our office at (248) 336-9988 or via email at snellenberger@pmenv.com.

Sincerely,
PM Environmental, Inc.

A handwritten signature in black ink, appearing to read 'Kayla Snellenberger', is written over a light blue horizontal line.

Kayla Snellenberger
Staff Scientist

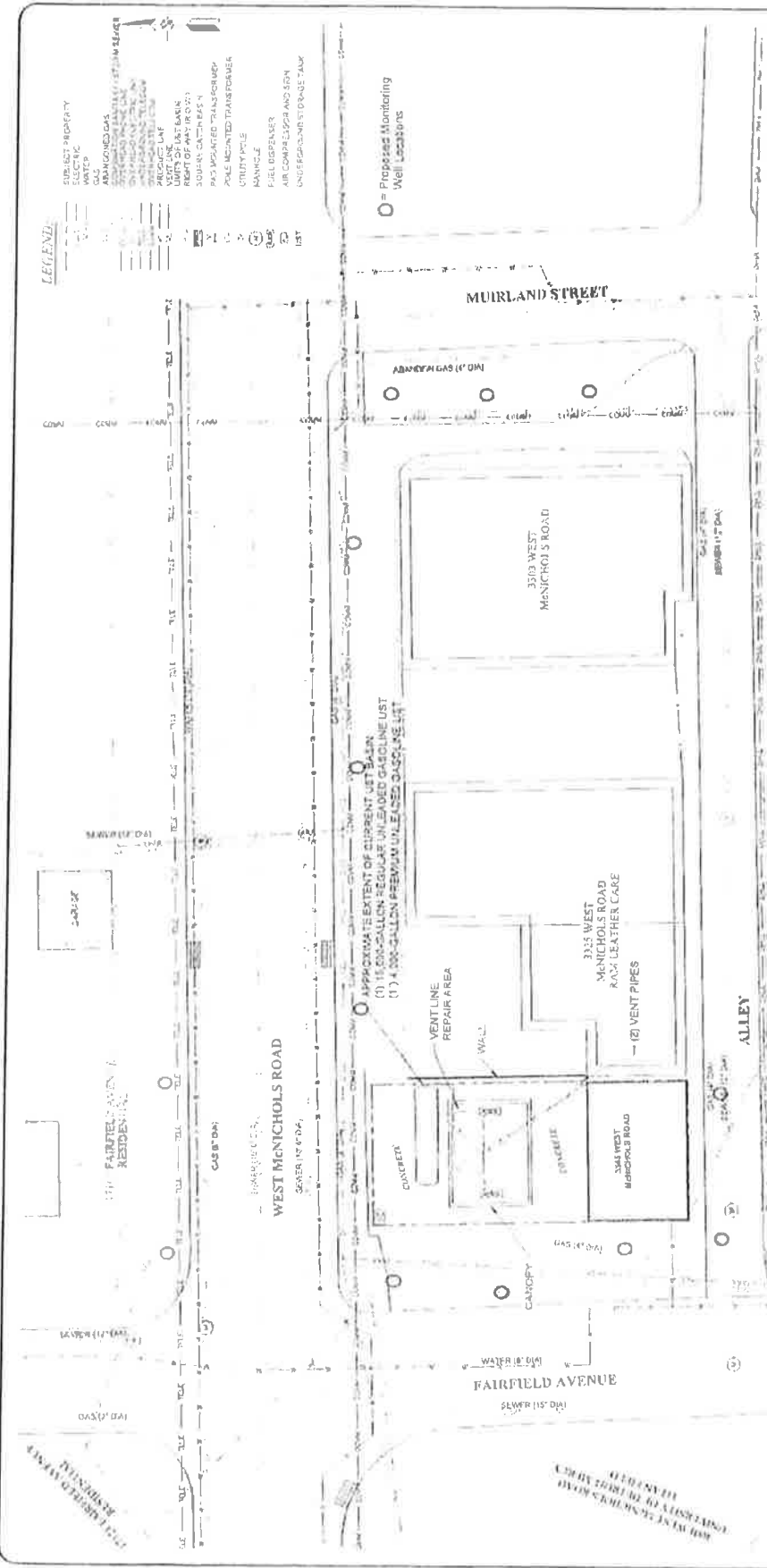

LEGEND:

- SUBJECT PROPERTY
- PUBLIC UTILITY WATER
- GLE
- UNIMPROVED GAS
- IMPROVED GAS
- APPROXIMATE EXTENT OF UST BASIN
- PROPOSED MONITORING WELL LOCATIONS
- PUBLIC UTILITY GAS
- PUBLIC UTILITY WATER
- PUBLIC UTILITY SEWER
- PUBLIC UTILITY CABLE
- PUBLIC UTILITY TELEPHONE
- PUBLIC UTILITY FIBER OPTIC
- PUBLIC UTILITY AIR CONDITIONING
- PUBLIC UTILITY HEATING
- PUBLIC UTILITY SMOKESTACK
- PUBLIC UTILITY AIR COMPRESSOR AND SOLE
- UNDERGROUND STORAGE TANK

PM Environmental & Engineering Services

FIGURE 1
GENERALIZED DIAGRAM OF THE SITE AND ADJOINING PROPERTIES

3310 WEST McNICHOLS ROAD
DETROIT, MI

DATE	10/15/2010
PROJECT	3310 WEST McNICHOLS ROAD
SCALE	AS SHOWN
BY	J. J. JONES
CHECKED BY	J. J. JONES
APPROVED BY	J. J. JONES

2020-10-09

1347

1347 *Petition of Empire Petroleum Partners LLC, request to encroach into Fairfield Ave, W McNichols and Muirland St right-of-way for the purpose of installing a monitoring well related to the property known as 3345 W McNichols.*

REFERRED TO THE FOLLOWING DEPARTMENT(S)

PLANNING AND DEVELOPMENT DEPARTMENT DPW -
CITY ENGINEERING DIVISION

PETITION NO.1346
 C/O KAYLA SNELLENBERGER
 PM ENVIRONMENTAL, INC
 REPRESENTING 2930 E GRAND, LLC
 (248) 336-9988
 SNELLENBERGER@PMENV.COM

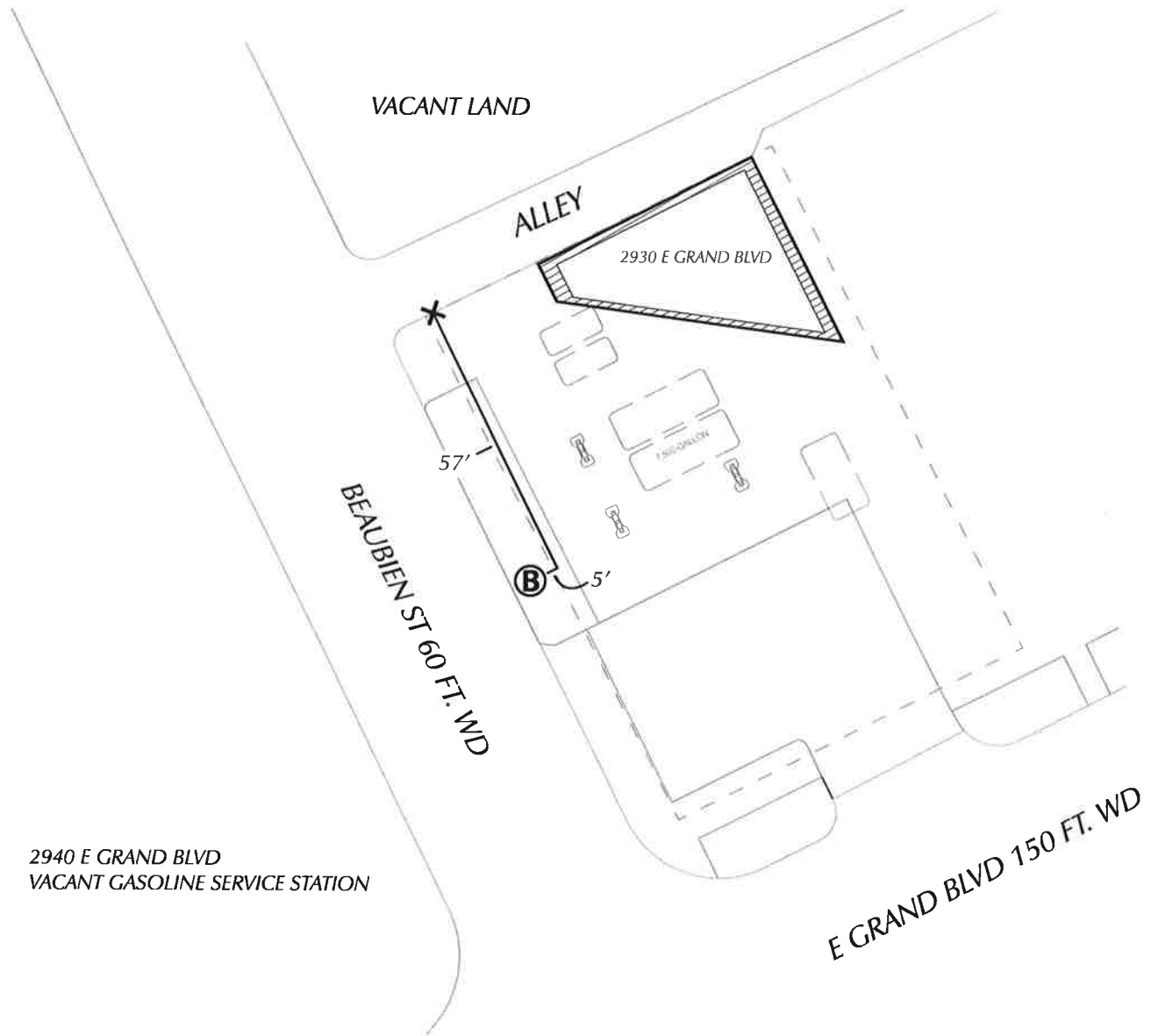

- X** - DISTANCE REFERENCE POINT
- (B)** - SOIL BORING/MONITORING WELL

(FOR OFFICE USE ONLY)

CARTO 31 A

B					SOIL BORING FOR SAMPLES IN THE BLOCK BOUND BY E GRAND BLVD., BEAUBIEN ST., HORTON ST., AND OAKLAND ST.	CITY OF DETROIT CITY ENGINEERING DIVISION SURVEY BUREAU
	A					
DESCRIPTION		DRWN	CHKD	APPD	DATE	JOB NO. 01-02
REVISIONS						
DRAWN BY KJ		CHECKED				DRWG. NO. X 1346
DATE 10-07-20		APPROVED BY JD				

City of Detroit
City Engineering Division, Department of Public Works
Maps and Records Bureau

NOTICE OF PROPOSED CHANGE IN PROPERTY

Date: _____

Petition: x1347

- | | |
|---|--|
| <input type="checkbox"/> AT&T Telecommunication | <input type="checkbox"/> Berm Use |
| <input type="checkbox"/> Comcast Television (CATV) | <input type="checkbox"/> Conversion to Easement |
| <input type="checkbox"/> Detroit Edison (DTE) | <input type="checkbox"/> Dedication |
| <input type="checkbox"/> Fire Department | <input checked="" type="checkbox"/> Encroachment |
| <input type="checkbox"/> Great Lakes Water Authority | <input type="checkbox"/> Outright Vacation |
| <input type="checkbox"/> Land Bank Authority | <input type="checkbox"/> Temporary Closing |
| <input type="checkbox"/> Michcon (DTE) | |
| <input type="checkbox"/> Planning & Development Department | |
| <input type="checkbox"/> Public Lighting Authority | |
| <input type="checkbox"/> Public Lighting Department | |
| <input type="checkbox"/> Police Department | |
| <input type="checkbox"/> Solid Waste Division, DPW | |
| <input type="checkbox"/> Street Design Bureau, DPW | |
| <input type="checkbox"/> Street Maintenance Division, DPW | |
| <input type="checkbox"/> Traffic Engineering Division, DPW | |
| <input type="checkbox"/> Water and Sewerage Department | |
| <input type="checkbox"/> Detroit Thermal | |
| <input type="checkbox"/> International Transmission Company (ITC) | |

A petition drawing is attached. Property shown on the attached print is proposed to be changed as indicated. Kindly report (using the back of this sheet) the nature of your services, if any affected by the proposed change and the estimated costs of removing and rerouting such services (if necessary). If a response is not received after a second notice of proposed change has been issued DPW will make the determination to move forward with the petition.

Please return one copy to City Engineering Division, DPW within two weeks of the submittal date. Retain one copy and print for you file.

Ron Brundidge, Director, Department of Public Works

By: Richard Doherty, CED DPW
City Engineer

Janice M. Winfrey
City Clerk

City of Detroit
OFFICE OF THE CITY CLERK

Andre P. Gilbert II
Deputy City Clerk

DEPARTMENTAL REFERENCE COMMUNICATION

Friday, October 9, 2020

To: The Department or Commission Listed Below

From: Janice M. Winfrey, Detroit City Clerk

The following petition is herewith referred to you for report and recommendation to the City Council.

In accordance with that body's directive, kindly return the same with your report in duplicate within four (4) weeks.

PLANNING AND DEVELOPMENT DEPARTMENT DPW - CITY ENGINEERING DIVISION

1347 *Empire Petroleum Partners LLC, request to encroach into Fairfield Ave, W McNichols and Muirland St right-of-way for the purpose of installing a monitoring well related to the property known as 3345 W McNichols.*

2 Woodward Ave. Coleman A. Young Municipal Center Rm. 200, Detroit, MI 48226

(313) 224 - 3260 | Fax: (313) 224 - 1466



Corporate Headquarters
Lansing, Michigan
3340 Ranger Road, Lansing, MI 48906
f: 877.884.6775
t: 517.321.3331

Michigan Locations
Berkley Bay City
Grand Rapids Detroit
Chesterfield Lansing

September 9, 2020

City of Detroit City Council
Coleman A. Young Municipal Center
2 Woodward Avenue, Suite 1340
Detroit, Michigan 48226

RE: Request to Install 11 Groundwater Monitoring Wells Within the West McNichols Road Right of Ways, Fairfield Avenue Right of Ways, and Muirland Street Right of Way, Detroit, Wayne County, Michigan and to Install Two Groundwater Monitoring Wells Within the Public Alley south of 3345 West McNichols Road, Detroit, Wayne County, Michigan

To Whom It May Concern,

PM Environmental, Inc. (PM) is under contract with Empire Petroleum Partners, LLC (Owner) to investigate the extent of impact resulting from an open leaking underground storage tank (LUST) gasoline release (C-0010-20) at the Citgo gasoline dispensing station located at 3345 West McNichols Road, Detroit, Wayne County, Michigan.

PM is requesting approval, in addition to submitting a permit application, to conduct subsurface work on behalf of Empire Petroleum Partners, LLC within the West McNichols Road Right of Ways, Fairfield Avenue Right of Ways, and Muirland Street Right of Way, as well as the public alley way south of 3345 West McNichols Road, Detroit, as shown in the attached Figure 1. PM will install 13 soil borings to a total depth of 25 feet below ground surface to collect soil samples and convert the soil borings to permanent groundwater monitoring wells. The investigation will begin as soon as the permit has been granted and will continue until regulatory closure of release C-0010-20 is achieved. Following closure, all well materials will be removed from the ground and the area returned to normal conditions.

If you have any questions related to this report, please do not hesitate to contact our office at (248) 336-9988 or via email at snellenberger@pmenv.com.

Sincerely,
PM Environmental, Inc.

Kayla Snellenberger
Staff Scientist

LEGEND

- Proposed Monitoring Well Locations
- Subject Property
- Gas (12" DIA)
- Sewer (12" DIA)
- Water (12" DIA)
- Storm Sewer (12" DIA)
- Gas (6" DIA)
- Sewer (6" DIA)
- Water (6" DIA)
- Storm Sewer (6" DIA)
- Gas (4" DIA)
- Sewer (4" DIA)
- Water (4" DIA)
- Storm Sewer (4" DIA)
- Gas (3" DIA)
- Sewer (3" DIA)
- Water (3" DIA)
- Storm Sewer (3" DIA)
- Gas (2" DIA)
- Sewer (2" DIA)
- Water (2" DIA)
- Storm Sewer (2" DIA)
- Gas (1" DIA)
- Sewer (1" DIA)
- Water (1" DIA)
- Storm Sewer (1" DIA)
- Gas (1/2" DIA)
- Sewer (1/2" DIA)
- Water (1/2" DIA)
- Storm Sewer (1/2" DIA)
- Gas (1/4" DIA)
- Sewer (1/4" DIA)
- Water (1/4" DIA)
- Storm Sewer (1/4" DIA)
- Gas (1/8" DIA)
- Sewer (1/8" DIA)
- Water (1/8" DIA)
- Storm Sewer (1/8" DIA)
- Gas (1/16" DIA)
- Sewer (1/16" DIA)
- Water (1/16" DIA)
- Storm Sewer (1/16" DIA)
- Gas (1/32" DIA)
- Sewer (1/32" DIA)
- Water (1/32" DIA)
- Storm Sewer (1/32" DIA)
- Gas (1/64" DIA)
- Sewer (1/64" DIA)
- Water (1/64" DIA)
- Storm Sewer (1/64" DIA)
- Gas (1/128" DIA)
- Sewer (1/128" DIA)
- Water (1/128" DIA)
- Storm Sewer (1/128" DIA)
- Gas (1/256" DIA)
- Sewer (1/256" DIA)
- Water (1/256" DIA)
- Storm Sewer (1/256" DIA)
- Gas (1/512" DIA)
- Sewer (1/512" DIA)
- Water (1/512" DIA)
- Storm Sewer (1/512" DIA)
- Gas (1/1024" DIA)
- Sewer (1/1024" DIA)
- Water (1/1024" DIA)
- Storm Sewer (1/1024" DIA)
- Gas (1/2048" DIA)
- Sewer (1/2048" DIA)
- Water (1/2048" DIA)
- Storm Sewer (1/2048" DIA)
- Gas (1/4096" DIA)
- Sewer (1/4096" DIA)
- Water (1/4096" DIA)
- Storm Sewer (1/4096" DIA)
- Gas (1/8192" DIA)
- Sewer (1/8192" DIA)
- Water (1/8192" DIA)
- Storm Sewer (1/8192" DIA)
- Gas (1/16384" DIA)
- Sewer (1/16384" DIA)
- Water (1/16384" DIA)
- Storm Sewer (1/16384" DIA)
- Gas (1/32768" DIA)
- Sewer (1/32768" DIA)
- Water (1/32768" DIA)
- Storm Sewer (1/32768" DIA)
- Gas (1/65536" DIA)
- Sewer (1/65536" DIA)
- Water (1/65536" DIA)
- Storm Sewer (1/65536" DIA)
- Gas (1/131072" DIA)
- Sewer (1/131072" DIA)
- Water (1/131072" DIA)
- Storm Sewer (1/131072" DIA)
- Gas (1/262144" DIA)
- Sewer (1/262144" DIA)
- Water (1/262144" DIA)
- Storm Sewer (1/262144" DIA)
- Gas (1/524288" DIA)
- Sewer (1/524288" DIA)
- Water (1/524288" DIA)
- Storm Sewer (1/524288" DIA)
- Gas (1/1048576" DIA)
- Sewer (1/1048576" DIA)
- Water (1/1048576" DIA)
- Storm Sewer (1/1048576" DIA)
- Gas (1/2097152" DIA)
- Sewer (1/2097152" DIA)
- Water (1/2097152" DIA)
- Storm Sewer (1/2097152" DIA)
- Gas (1/4194304" DIA)
- Sewer (1/4194304" DIA)
- Water (1/4194304" DIA)
- Storm Sewer (1/4194304" DIA)
- Gas (1/8388608" DIA)
- Sewer (1/8388608" DIA)
- Water (1/8388608" DIA)
- Storm Sewer (1/8388608" DIA)
- Gas (1/16777216" DIA)
- Sewer (1/16777216" DIA)
- Water (1/16777216" DIA)
- Storm Sewer (1/16777216" DIA)
- Gas (1/33554432" DIA)
- Sewer (1/33554432" DIA)
- Water (1/33554432" DIA)
- Storm Sewer (1/33554432" DIA)
- Gas (1/67108864" DIA)
- Sewer (1/67108864" DIA)
- Water (1/67108864" DIA)
- Storm Sewer (1/67108864" DIA)
- Gas (1/134217728" DIA)
- Sewer (1/134217728" DIA)
- Water (1/134217728" DIA)
- Storm Sewer (1/134217728" DIA)
- Gas (1/268435456" DIA)
- Sewer (1/268435456" DIA)
- Water (1/268435456" DIA)
- Storm Sewer (1/268435456" DIA)
- Gas (1/536870912" DIA)
- Sewer (1/536870912" DIA)
- Water (1/536870912" DIA)
- Storm Sewer (1/536870912" DIA)
- Gas (1/1073741824" DIA)
- Sewer (1/1073741824" DIA)
- Water (1/1073741824" DIA)
- Storm Sewer (1/1073741824" DIA)
- Gas (1/2147483648" DIA)
- Sewer (1/2147483648" DIA)
- Water (1/2147483648" DIA)
- Storm Sewer (1/2147483648" DIA)
- Gas (1/4294967296" DIA)
- Sewer (1/4294967296" DIA)
- Water (1/4294967296" DIA)
- Storm Sewer (1/4294967296" DIA)
- Gas (1/8589934592" DIA)
- Sewer (1/8589934592" DIA)
- Water (1/8589934592" DIA)
- Storm Sewer (1/8589934592" DIA)
- Gas (1/17179869184" DIA)
- Sewer (1/17179869184" DIA)
- Water (1/17179869184" DIA)
- Storm Sewer (1/17179869184" DIA)
- Gas (1/34359738368" DIA)
- Sewer (1/34359738368" DIA)
- Water (1/34359738368" DIA)
- Storm Sewer (1/34359738368" DIA)
- Gas (1/68719476736" DIA)
- Sewer (1/68719476736" DIA)
- Water (1/68719476736" DIA)
- Storm Sewer (1/68719476736" DIA)
- Gas (1/137438953472" DIA)
- Sewer (1/137438953472" DIA)
- Water (1/137438953472" DIA)
- Storm Sewer (1/137438953472" DIA)
- Gas (1/274877906944" DIA)
- Sewer (1/274877906944" DIA)
- Water (1/274877906944" DIA)
- Storm Sewer (1/274877906944" DIA)
- Gas (1/549755813888" DIA)
- Sewer (1/549755813888" DIA)
- Water (1/549755813888" DIA)
- Storm Sewer (1/549755813888" DIA)
- Gas (1/1099511627776" DIA)
- Sewer (1/1099511627776" DIA)
- Water (1/1099511627776" DIA)
- Storm Sewer (1/1099511627776" DIA)
- Gas (1/2199023255552" DIA)
- Sewer (1/2199023255552" DIA)
- Water (1/2199023255552" DIA)
- Storm Sewer (1/2199023255552" DIA)
- Gas (1/4398046511104" DIA)
- Sewer (1/4398046511104" DIA)
- Water (1/4398046511104" DIA)
- Storm Sewer (1/4398046511104" DIA)
- Gas (1/8796093022208" DIA)
- Sewer (1/8796093022208" DIA)
- Water (1/8796093022208" DIA)
- Storm Sewer (1/8796093022208" DIA)
- Gas (1/17592186044416" DIA)
- Sewer (1/17592186044416" DIA)
- Water (1/17592186044416" DIA)
- Storm Sewer (1/17592186044416" DIA)
- Gas (1/35184372088832" DIA)
- Sewer (1/35184372088832" DIA)
- Water (1/35184372088832" DIA)
- Storm Sewer (1/35184372088832" DIA)
- Gas (1/70368744177664" DIA)
- Sewer (1/70368744177664" DIA)
- Water (1/70368744177664" DIA)
- Storm Sewer (1/70368744177664" DIA)
- Gas (1/140737488355328" DIA)
- Sewer (1/140737488355328" DIA)
- Water (1/140737488355328" DIA)
- Storm Sewer (1/140737488355328" DIA)
- Gas (1/281474976710656" DIA)
- Sewer (1/281474976710656" DIA)
- Water (1/281474976710656" DIA)
- Storm Sewer (1/281474976710656" DIA)
- Gas (1/562949953421312" DIA)
- Sewer (1/562949953421312" DIA)
- Water (1/562949953421312" DIA)
- Storm Sewer (1/562949953421312" DIA)
- Gas (1/1125899906842624" DIA)
- Sewer (1/1125899906842624" DIA)
- Water (1/1125899906842624" DIA)
- Storm Sewer (1/1125899906842624" DIA)
- Gas (1/2251799813685248" DIA)
- Sewer (1/2251799813685248" DIA)
- Water (1/2251799813685248" DIA)
- Storm Sewer (1/2251799813685248" DIA)
- Gas (1/4503599627370496" DIA)
- Sewer (1/4503599627370496" DIA)
- Water (1/4503599627370496" DIA)
- Storm Sewer (1/4503599627370496" DIA)
- Gas (1/9007199254740992" DIA)
- Sewer (1/9007199254740992" DIA)
- Water (1/9007199254740992" DIA)
- Storm Sewer (1/9007199254740992" DIA)
- Gas (1/18014398509481984" DIA)
- Sewer (1/18014398509481984" DIA)
- Water (1/18014398509481984" DIA)
- Storm Sewer (1/18014398509481984" DIA)
- Gas (1/36028797018963968" DIA)
- Sewer (1/36028797018963968" DIA)
- Water (1/36028797018963968" DIA)
- Storm Sewer (1/36028797018963968" DIA)
- Gas (1/72057594037927936" DIA)
- Sewer (1/72057594037927936" DIA)
- Water (1/72057594037927936" DIA)
- Storm Sewer (1/72057594037927936" DIA)
- Gas (1/144115188075855872" DIA)
- Sewer (1/144115188075855872" DIA)
- Water (1/144115188075855872" DIA)
- Storm Sewer (1/144115188075855872" DIA)
- Gas (1/288230376151711744" DIA)
- Sewer (1/288230376151711744" DIA)
- Water (1/288230376151711744" DIA)
- Storm Sewer (1/288230376151711744" DIA)
- Gas (1/576460752303423488" DIA)
- Sewer (1/576460752303423488" DIA)
- Water (1/576460752303423488" DIA)
- Storm Sewer (1/576460752303423488" DIA)
- Gas (1/1152921504606846976" DIA)
- Sewer (1/1152921504606846976" DIA)
- Water (1/1152921504606846976" DIA)
- Storm Sewer (1/1152921504606846976" DIA)
- Gas (1/2305843009213693952" DIA)
- Sewer (1/2305843009213693952" DIA)
- Water (1/2305843009213693952" DIA)
- Storm Sewer (1/2305843009213693952" DIA)
- Gas (1/4611686018427387904" DIA)
- Sewer (1/4611686018427387904" DIA)
- Water (1/4611686018427387904" DIA)
- Storm Sewer (1/4611686018427387904" DIA)
- Gas (1/9223372036854775808" DIA)
- Sewer (1/9223372036854775808" DIA)
- Water (1/9223372036854775808" DIA)
- Storm Sewer (1/9223372036854775808" DIA)
- Gas (1/18446744073709551616" DIA)
- Sewer (1/18446744073709551616" DIA)
- Water (1/18446744073709551616" DIA)
- Storm Sewer (1/18446744073709551616" DIA)
- Gas (1/36893488147419103232" DIA)
- Sewer (1/36893488147419103232" DIA)
- Water (1/36893488147419103232" DIA)
- Storm Sewer (1/36893488147419103232" DIA)
- Gas (1/73786976294838206464" DIA)
- Sewer (1/73786976294838206464" DIA)
- Water (1/73786976294838206464" DIA)
- Storm Sewer (1/73786976294838206464" DIA)
- Gas (1/147573952589676412928" DIA)
- Sewer (1/147573952589676412928" DIA)
- Water (1/147573952589676412928" DIA)
- Storm Sewer (1/147573952589676412928" DIA)
- Gas (1/295147905179352825856" DIA)
- Sewer (1/295147905179352825856" DIA)
- Water (1/295147905179352825856" DIA)
- Storm Sewer (1/295147905179352825856" DIA)
- Gas (1/590295810358705651712" DIA)
- Sewer (1/590295810358705651712" DIA)
- Water (1/590295810358705651712" DIA)
- Storm Sewer (1/590295810358705651712" DIA)
- Gas (1/1180591620717411303424" DIA)
- Sewer (1/1180591620717411303424" DIA)
- Water (1/1180591620717411303424" DIA)
- Storm Sewer (1/1180591620717411303424" DIA)
- Gas (1/2361183241434822606848" DIA)
- Sewer (1/2361183241434822606848" DIA)
- Water (1/2361183241434822606848" DIA)
- Storm Sewer (1/2361183241434822606848" DIA)
- Gas (1/4722366482869645213696" DIA)
- Sewer (1/4722366482869645213696" DIA)
- Water (1/4722366482869645213696" DIA)
- Storm Sewer (1/4722366482869645213696" DIA)
- Gas (1/9444732965739290427392" DIA)
- Sewer (1/9444732965739290427392" DIA)
- Water (1/9444732965739290427392" DIA)
- Storm Sewer (1/9444732965739290427392" DIA)
- Gas (1/18889465931478580854784" DIA)
- Sewer (1/18889465931478580854784" DIA)
- Water (1/18889465931478580854784" DIA)
- Storm Sewer (1/18889465931478580854784" DIA)
- Gas (1/37778931862957161709568" DIA)
- Sewer (1/37778931862957161709568" DIA)
- Water (1/37778931862957161709568" DIA)
- Storm Sewer (1/37778931862957161709568" DIA)
- Gas (1/75557863725914323419136" DIA)
- Sewer (1/75557863725914323419136" DIA)
- Water (1/75557863725914323419136" DIA)
- Storm Sewer (1/75557863725914323419136" DIA)
- Gas (1/151115727451828646838272" DIA)
- Sewer (1/151115727451828646838272" DIA)
- Water (1/151115727451828646838272" DIA)
- Storm Sewer (1/151115727451828646838272" DIA)
- Gas (1/302231454903657293676544" DIA)
- Sewer (1/302231454903657293676544" DIA)
- Water (1/302231454903657293676544" DIA)
- Storm Sewer (1/302231454903657293676544" DIA)
- Gas (1/604462909807314587353088" DIA)
- Sewer (1/604462909807314587353088" DIA)
- Water (1/604462909807314587353088" DIA)
- Storm Sewer (1/604462909807314587353088" DIA)
- Gas (1/1208925819614629174706176" DIA)
- Sewer (1/1208925819614629174706176" DIA)
- Water (1/1208925819614629174706176" DIA)
- Storm Sewer (1/1208925819614629174706176" DIA)
- Gas (1/2417851639229258349412352" DIA)
- Sewer (1/2417851639229258349412352" DIA)
- Water (1/2417851639229258349412352" DIA)
- Storm Sewer (1/2417851639229258349412352" DIA)
- Gas (1/4835703278458516698824704" DIA)
- Sewer (1/4835703278458516698824704" DIA)
- Water (1/4835703278458516698824704" DIA)
- Storm Sewer (1/4835703278458516698824704" DIA)
- Gas (1/9671406556917033397649408" DIA)
- Sewer (1/9671406556917033397649408" DIA)
- Water (1/9671406556917033397649408" DIA)
- Storm Sewer (1/9671406556917033397649408" DIA)
- Gas (1/19342813113834066795298816" DIA)
- Sewer (1/19342813113834066795298816" DIA)
- Water (1/19342813113834066795298816" DIA)
- Storm Sewer (1/19342813113834066795298816" DIA)
- Gas (1/38685626227668133590597632" DIA)
- Sewer (1/38685626227668133590597632" DIA)
- Water (1/38685626227668133590597632" DIA)
- Storm Sewer (1/38685626227668133590597632" DIA)
- Gas (1/77371252455336267181195264" DIA)
- Sewer (1/77371252455336267181195264" DIA)
- Water (1/77371252455336267181195264" DIA)
- Storm Sewer (1/77371252455336267181195264" DIA)
- Gas (1/154742504910672534362390528" DIA)
- Sewer (1/154742504910672534362390528" DIA)
- Water (1/154742504910672534362390528" DIA)
- Storm Sewer (1/154742504910672534362390528" DIA)
- Gas (1/309485009821345068724781056" DIA)
- Sewer (1/309485009821345068724781056" DIA)
- Water (1/309485009821345068724781056" DIA)
- Storm Sewer (1/309485009821345068724781056" DIA)
- Gas (1/618970019642690137449562112" DIA)
- Sewer (1/618970019642690137449562112" DIA)
- Water (1/618970019642690137449562112" DIA)
- Storm Sewer (1/618970019642690137449562112" DIA)
- Gas (1/1237940039285380274899124224" DIA)
- Sewer (1/1237940039285380274899124224" DIA)
- Water (1/1237940039285380274899124224" DIA)
- Storm Sewer (1/1237940039285380274899124224" DIA)
- Gas (1/2475880078570760549798248448" DIA)
- Sewer (1/2475880078570760549798248448" DIA)
- Water (1/2475880078570760549798248448" DIA)
- Storm Sewer (1/2475880078570760549798248448" DIA)
- Gas (1/4951760157141521099596496896" DIA)
- Sewer (1/4951760157141521099596496896" DIA)
- Water (1/4951760157141521099596496896" DIA)
- Storm Sewer (1/4951760157141521099596496896" DIA)
- Gas (1/9903520314283042199192993792" DIA)
- Sewer (1/9903520314283042199192993792" DIA)
- Water (1/9903520314283042199192993792" DIA)
- Storm Sewer (1/9903520314283042199192993792" DIA)
- Gas (1/19807040628566084398385987584" DIA)
- Sewer (1/19807040628566084398385987584" DIA)
- Water (1/19807040628566084398385987584" DIA)
- Storm Sewer (1/19807040628566084398385987584" DIA)
- Gas (1/39614081257132168796771975168" DIA)
- Sewer (1/39614081257132168796771975168" DIA)
- Water (1/39614081257132168796771975168" DIA)
- Storm Sewer (1/39614081257132168796771975168" DIA)
- Gas (1/79228162514264337593543950336" DIA)
- Sewer (1/79228162514264337593543950336" DIA)
- Water (1/79228162514264337593543950336" DIA)
- Storm Sewer (1/79228162514264337593543950336" DIA)
- Gas (1/158456325028528675187087900672" DIA)
- Sewer (1/158456325028528675187087900672" DIA)
- Water (1/158456325028528675187087900672" DIA)
- Storm Sewer (1/158456325028528675187087900672" DIA)
- Gas (1/316912650057057350374175801344" DIA)
- Sewer (1/316912650057057350374175801344" DIA)
- Water (1/316912650057057350374175801344" DIA)
- Storm Sewer (1/316912650057057350374175801344" DIA)
- Gas (1/633825300114114700748351602688" DIA)
- Sewer (1/633825300114114700748351602688" DIA)
- Water (1/633825300114114700748351602688" DIA)
- Storm Sewer (1/633825300114114700748351602688" DIA)
- Gas (1/1267650600228229401496703205376" DIA)
- Sewer (1/1267650600228229401496703205376" DIA)
- Water (1/1267650600228229401496703205376" DIA)
- Storm Sewer (1/1267650600228229401496703205376" DIA)
- Gas (1/2535301200456458802993406410752" DIA)
- Sewer (1/2535301200456458802993406410752" DIA)
- Water (1/2535301200456458802993406410752" DIA)
- Storm Sewer (1/2535301200456458802993406410752" DIA)
- Gas (1/5

2020-10-09

1347

1347 *Petition of Empire Petroleum Partners LLC, request to encroach into Fairfield Ave, W McNichols and Muirland St right-of-way for the purpose of installing a monitoring well related to the property known as 3345 W McNichols.*

REFERRED TO THE FOLLOWING DEPARTMENT(S)

PLANNING AND DEVELOPMENT DEPARTMENT DPW -
CITY ENGINEERING DIVISION

PETITION NO.1346
 C/O KAYLA SNELLENBERGER
 PM ENVIRONMENTAL, INC
 REPRESENTING 2930 E GRAND, LLC
 (248) 336-9988
 SNELLENBERGER@PMENV.COM

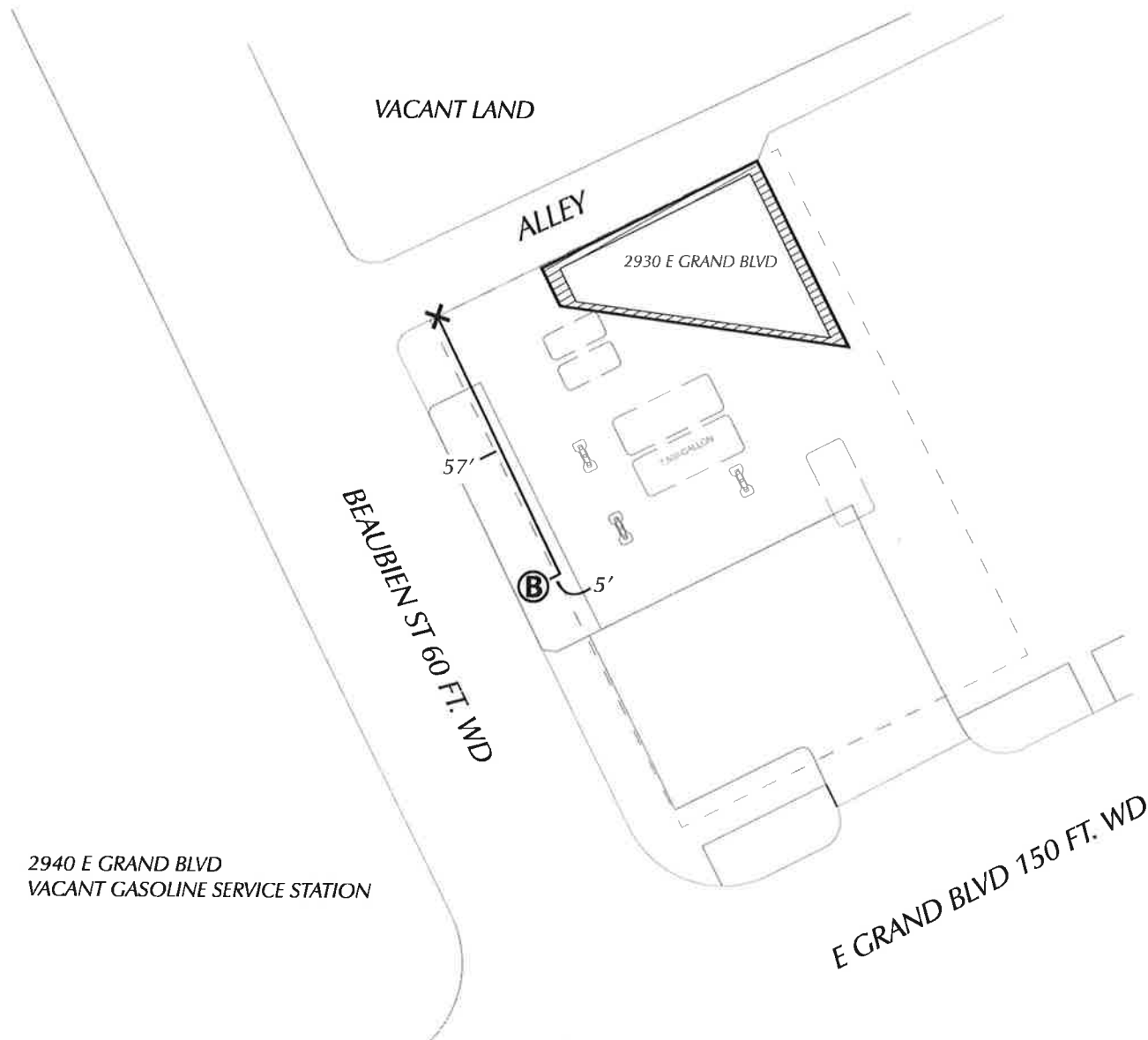

- X** - DISTANCE REFERENCE POINT
- (B)** - SOIL BORING/MONITORING WELL

(FOR OFFICE USE ONLY)

CARTO 31 A

B					
A					
DESCRIPTION	DRWN	CHKD	APPD	DATE	
REVISIONS					
DRAWN BY	KJ		CHECKED		
DATE	10-07-20		APPROVED BY	JD	

SOIL BORING FOR SAMPLES IN THE
 BLOCK BOUND BY E GRAND BLVD.,
 BEAUBIEN ST., HORTON ST., AND
 OAKLAND ST.

CITY OF DETROIT CITY ENGINEERING DIVISION SURVEY BUREAU	
JOB NO.	01-02
DRWG. NO.	X 1346