

Camilla Dean

From: Robert Seaney
Sent: Monday, October 12, 2020 9:23 AM
To: Permits Comcast
Subject: FW: City of Detroit - Right of Way Petitions - Corrected
Attachments: 2020 Petition x1332 & sketch.pdf; 2020 Petition x1333 & Sketch.pdf; 2020 Petition x1339.pdf; 2020 Petition x1339 SKETCH.PDF; 2020 Petition x1340.pdf; 2020 Petition x1340 SKETCH.PDF; 2020 Petition x1341.pdf; 2020 Petition x1341 SKETCH.PDF

From: Maps and Records Bureau <mapsandrecordsbureau@detroitmi.gov>
Sent: Wednesday, October 7, 2020 1:59 PM
To: Comcast 2 <CENHRT-MI_Comcast_RELO@comcast.com>; Robert Seaney <RSeaney@teamsigma.com>; DTE (Electric <SE_ENGINEERING@dteenergy.com>; Keith Hewlett <hewlettk@detroitmi.gov>; GLWA <permits@glwater.org>; DTE (gas <det_mappingteam@dteenergy.com>; Helen-Marie Sharpley <hsharpley@detroitmi.gov>; PLA <mpatel@pladetroit.org>; Andrew Crawford <andrewc@detroitmi.gov>; PATROL OPERATIONS BUREAU <PATROLOPSBUREAU@detroitmi.gov>; Carolyn Harper <carhar@detroitmi.gov>; Pamela Lemme <lemmep@detroitmi.gov>; Leslie Walker <walkerl@detroitmi.gov>; Sunny Jacob <sunjac@detroitmi.gov>; Gilbert Lee <Gilbert.Lee@detroitmi.gov>; ITC-1 <edavis@itctransco.com>; ITC-2 <apascaris@itctransco.com>; ITC-3 <gdenstaedt@itctransco.com>; Detroit Thermal <djablonski@detroitthermal.com>; Julie A Jozwiak <julie.jozwiak@dteenergy.com>
Subject: City of Detroit - Right of Way Petitions - Corrected

Corrected attachments

Hello,

Please see the attached documents concerning petitions x1332, x1333, x1339, x1340, and 1341. Please complete your review and respond with the attached notice of property change within 30 days. We do not record responses relied in email alone, so please return the notice of property change to be considered in this review. Responses that are not returned within the 30 day requirement will be defaulted to 'Not Involved'.

City of Detroit
Maps and Records Bureau
Department of Public Works
(313) 224-3970

CONFIDENTIALITYNOTICE: This e-mail, and any attachments, is intended only for the use of the individual or entity to which it is addressed and may contain information that is privileged, confidential or exempt from disclosure under applicable law. If the reader of this e-mail is not the intended recipient, you are hereby notified that any retention, dissemination or copying of this e-mail is strictly prohibited. If you have received this e-mail in error, please immediately notify the sender by replying to this e-mail and deleting the original e-mail and attachments from your system. Thank you.

Janice M. Winfrey
City Clerk

City of Detroit
OFFICE OF THE CITY CLERK

Andre P. Gilbert II
Deputy City Clerk

DEPARTMENTAL REFERENCE COMMUNICATION

Friday, October 2, 2020

To: The Department or Commission Listed Below

From: Janice M. Winfrey, Detroit City Clerk

The following petition is herewith referred to you for report and recommendation to the City Council.

In accordance with that body's directive, kindly return the same with your report in duplicate within four (4) weeks.

PLANNING AND DEVELOPMENT DEPARTMENT DPW - CITY ENGINEERING DIVISION

1341 *Infinity Acquisitions LLC / Mannik & Smith Group Inc., petition for various encroachments into Park Ave and W Adams adjacent to 2001 Park Ave.*



CITY OF DETROIT
DEPARTMENT OF PUBLIC WORKS
CITY ENGINEERING DIVISION

1341
COLEMAN A. YOUNG MUNICIPAL CENTER
2 WOODWARD AVE. SUITE 601
DETROIT, MICHIGAN 48226
PHONE: (313) 224-3949 • TTY: 711
FAX: (313) 224-3471
WWW.DETROITMI.GOV

To: Clerk's Office
From: The Department of Public Works
City Engineering Division
MapsandRecordsBureau@DetroitMI.Gov
(313) 224-3970

Petitioner:
Infinity Acquisitions LLC
Represented by Mannik & Smith Group, Inc.
65 Cadillac Square, Suite 3311
Detroit, MI 48226

On behalf of the above mentioned petitioner the Department of Public Works: City Engineering Division is submitting a petition request for the below mentioned action. The petitioner has received a project consultation from the Department of Public Works: City Engineering Division and has been advised the following:

Type of action recommended:

Petition for various encroachments into Park Avenue and W. Adams Avenue adjacent to 2001 Park Avenue.

Based on the scope of the project the following requirements have been outlined:

- No further requirements noted.

Sincerely,

Jered Dean
Manager II
Maps and Records Bureau



May 14, 2020

The Honorable City Council

Attn: Office of the City Clerk
200 Coleman A. Young Municipal Center
2 Woodward Avenue
Detroit, Michigan 48226

RE: Encroachment Petition for 2001 Park Avenue for Infinity Acquisitions LLC

The Honorable City Council:

On behalf of Infinity Acquisitions LLC we are petitioning the City to approve encroachments proposed for the development at 2001 Park Avenue. The existing building being redeveloped covers the entire site directly adjacent to the property lines of Park, W Adams and the alley to the north. The encroachments proposed are for exterior lighting on the building, exterior planters, entrance canopy, awnings, emergency access and exterior dining.

Attached is the encroachment plan. This plan was previously submitted and approved for the Site Plan Approval process.

Respectfully Submitted,

A handwritten signature in cursive script that reads "David A. Rzyzi".

David A. Rzyzi, P.E.
The Mannik & Smith Group, Inc.

C: J. Knoll, J. Dean

TECHNICAL SKILL.
CREATIVE SPIRIT.

	INFINITY ACQUISITIONS, LLC	2001 PARK AVENUE DETROIT, MI 48226	ENCROACHMENT PLAN	090
--	----------------------------	---------------------------------------	-------------------	-----

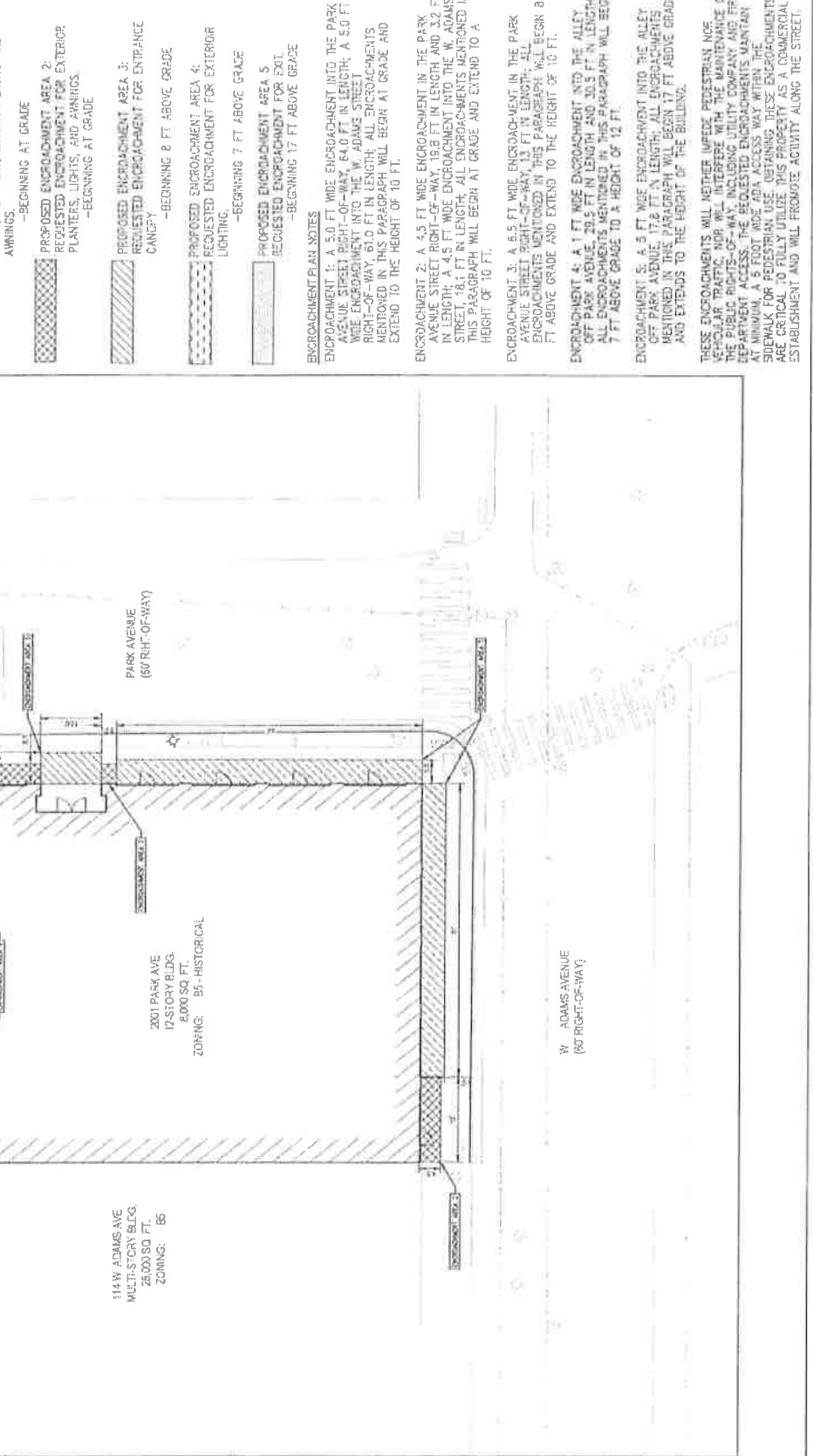

2020-10-02

1341

1341 *Petition of Infinity Acquisitions LLC / Mannik & Smith Group Inc., petition for various encroachments into Park Ave and W Adams adjacent to 2001 Park Ave.*

REFERRED TO THE FOLLOWING DEPARTMENT(S)

PLANNING AND DEVELOPMENT DEPARTMENT DPW -
CITY ENGINEERING DIVISION

City of Detroit
City Engineering Division, Department of Public Works
Maps and Records Bureau

NOTICE OF PROPOSED CHANGE IN PROPERTY

Date: _____

Petition: _____

- | | |
|-------------------------------------------------------------------|-------------------------------------------------|
| <input type="checkbox"/> AT&T Telecommunication | <input type="checkbox"/> Berm Use |
| <input type="checkbox"/> Comcast Television (CATV) | <input type="checkbox"/> Conversion to Easement |
| <input type="checkbox"/> Detroit Edison (DTE) | <input type="checkbox"/> Dedication |
| <input type="checkbox"/> Fire Department | <input type="checkbox"/> Encroachment |
| <input type="checkbox"/> Great Lakes Water Authority | <input type="checkbox"/> Outright Vacation |
| <input type="checkbox"/> Land Bank Authority | <input type="checkbox"/> Temporary Closing |
| <input type="checkbox"/> Michcon (DTE) | |
| <input type="checkbox"/> Planning & Development Department | |
| <input type="checkbox"/> Public Lighting Authority | |
| <input type="checkbox"/> Public Lighting Department | |
| <input type="checkbox"/> Police Department | |
| <input type="checkbox"/> Solid Waste Division, DPW | |
| <input type="checkbox"/> Street Design Bureau, DPW | |
| <input type="checkbox"/> Street Maintenance Division, DPW | |
| <input type="checkbox"/> Traffic Engineering Division, DPW | |
| <input type="checkbox"/> Water and Sewerage Department | |
| <input type="checkbox"/> Detroit Thermal | |
| <input type="checkbox"/> International Transmission Company (ITC) | |

A petition drawing is attached. Property shown on the attached print is proposed to be changed as indicated. Kindly report (using the back of this sheet) the nature of your services, if any affected by the proposed change and the estimated costs of removing and rerouting such services (if necessary). If a response is not received after a second notice of proposed change has been issued DPW will make the determination to move forward with the petition.

Please return one copy to City Engineering Division, DPW within two weeks of the submittal date. Retain one copy and print for you file.

Ron Brundidge, Director, Department of Public Works

By: Richard Doherty, CED DPW
City Engineer

**TO: City Engineering Division, DPW
2 Woodward Ave., Suite 642
Detroit, Michigan 48226-3462
Survey Bureau: 313-224-3970**

Petition: _____

The proposed change in property (referred to on the other side of this sheet) would affect our services as follows:

- Not Involved
- Involved; but no objections to the property change.
- Involved; objection to the property change.
- Involved; the nature of our services and the estimated costs of removing and/or rerouting such services are:

Objections, Please leave a brief explanation for any objection or the nature of an estimated cost:

(Utility or City Department)

By





Title

Date

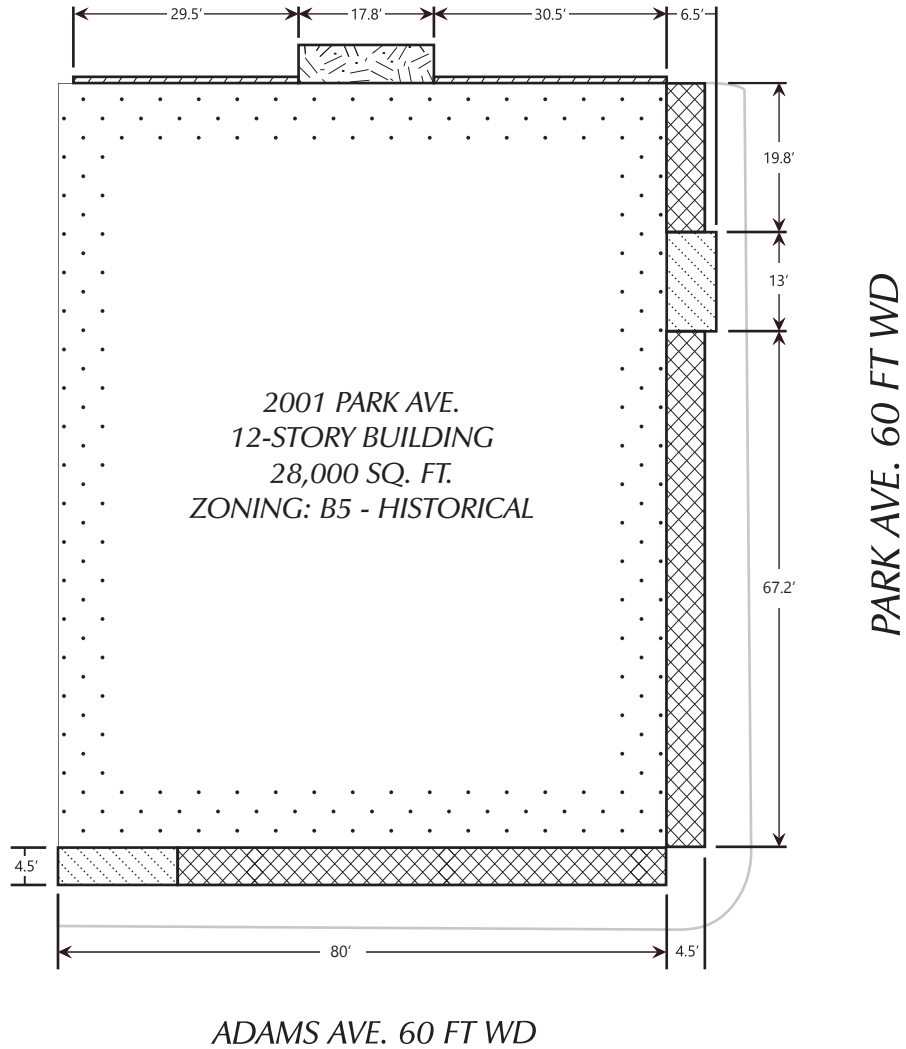
Area code – Telephone number

PETITION NO. XXXX
 DAVID A. RYZYI, FROM MANNIK-SMITHGROUP
 65 CADILLAC SQUARE, SUITE 3311
 DETROIT, MI 48226
 734-790-0645



-  - PROPOSED ENCROACHMENT AREA 1
-  - PROPOSED ENCROACHMENT AREA 2
-  - PROPOSED ENCROACHMENT AREA 3
-  - PROPOSED ENCROACHMENT AREA 4

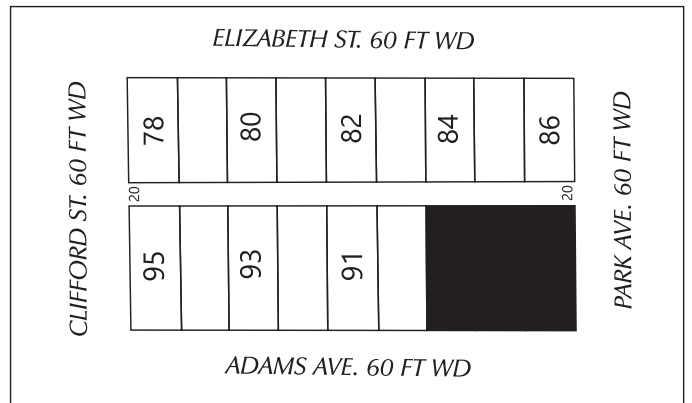

(FOR OFFICE USE ONLY)

CARTO 28

B					
A					
DESCRIPTION	DRWN	CHKD	APPD	DATE	
REVISIONS					
DRAWN BY	KJ		CHECKED		
DATE	09-25-20		APPROVED BY	JD	

REQUESTS FOR MULTIPLE
 ENCROACHMENTS, IN THE BLOCK
 BOUND BY ELIZABETH ST., PARK AVE.,
 ADAMS AVE., AND CLIFFORD ST.

CITY OF DETROIT	
CITY ENGINEERING DIVISION	
SURVEY BUREAU	
JOB NO.	01-01
DRWG. NO.	X

PETITION NO. XXXX
 DAVID A. RYZYI, FROM MANNIK-SMITH GROUP
 65 CADILLAC SQUARE, SUITE 3311
 DETROIT, MI 48226
 734-790-0645

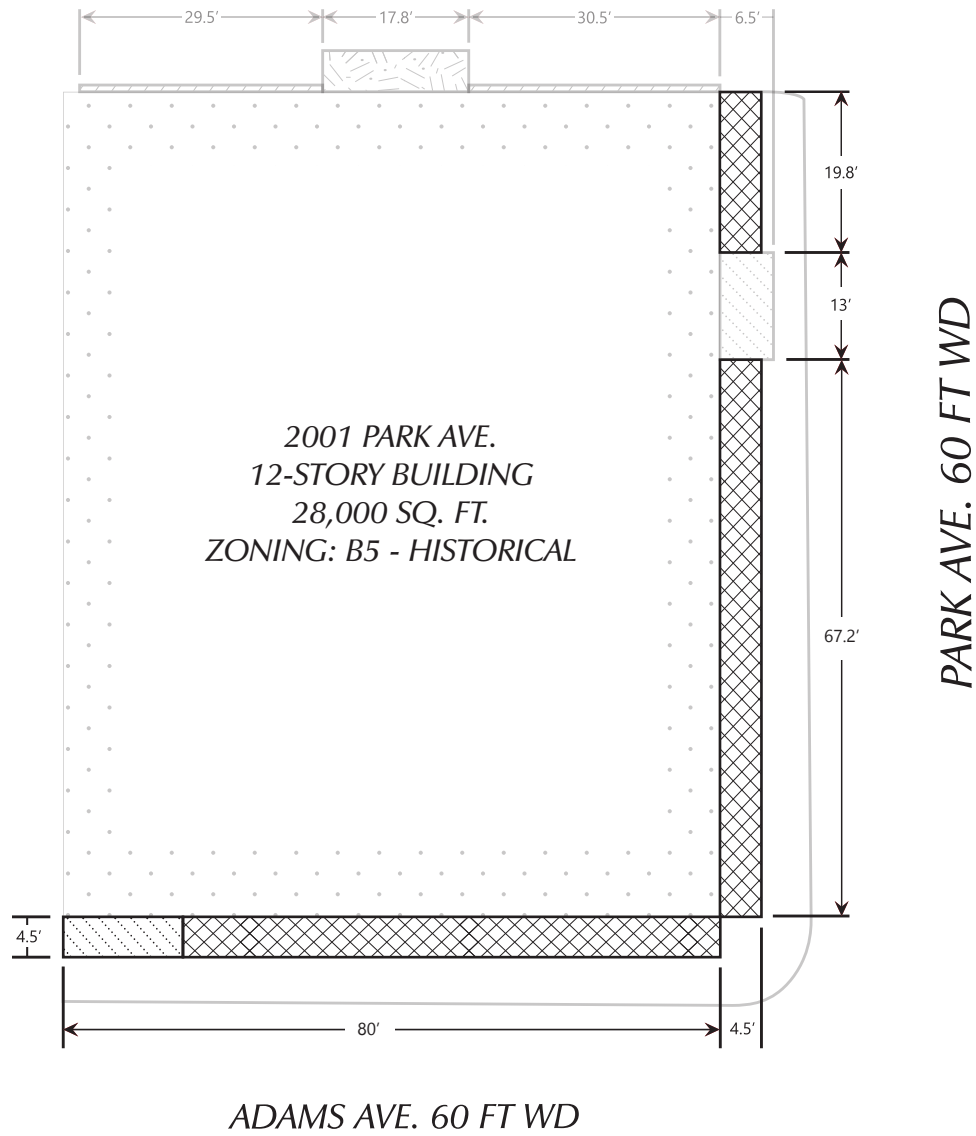

PROPOSED ENCROACHMENT AREA 1: REQUESTED ENCROACHMENT FOR EXTERIOR PLANTERS, LIGHTS, AND AWNINGS. BEGINNING AT GRADE.

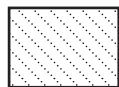

PROPOSED ENCROACHMENT AREA 2: REQUESTED ENCROACHMENT FOR ENTRANCE CANOPY. BEGINNING AT GRADE.

(FOR OFFICE USE ONLY)

CARTO 28

REQUESTS FOR MULTIPLE
 ENCROACHMENTS, IN THE BLOCK
 BOUND BY ELIZABETH ST., PARK AVE.,
 ADAMS AVE., AND CLIFFORD ST.

CITY OF DETROIT
 CITY ENGINEERING DIVISION
 SURVEY BUREAU

B					
	A				
DESCRIPTION		DRWN	CHKD	APPD	DATE
REVISIONS					
DRAWN BY		CHECKED			
DATE		APPROVED BY			
09-25-20		JD			

JOB NO. 01-02
 DRWG. NO. X

PETITION NO.XXXX
 DAVID A. RYZYI, FROM MANNIK-SMITHGROUP
 65 CADILLAC SQUARE, SUITE 3311
 DETROIT, MI 48226
 734-790-0645

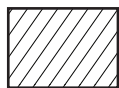
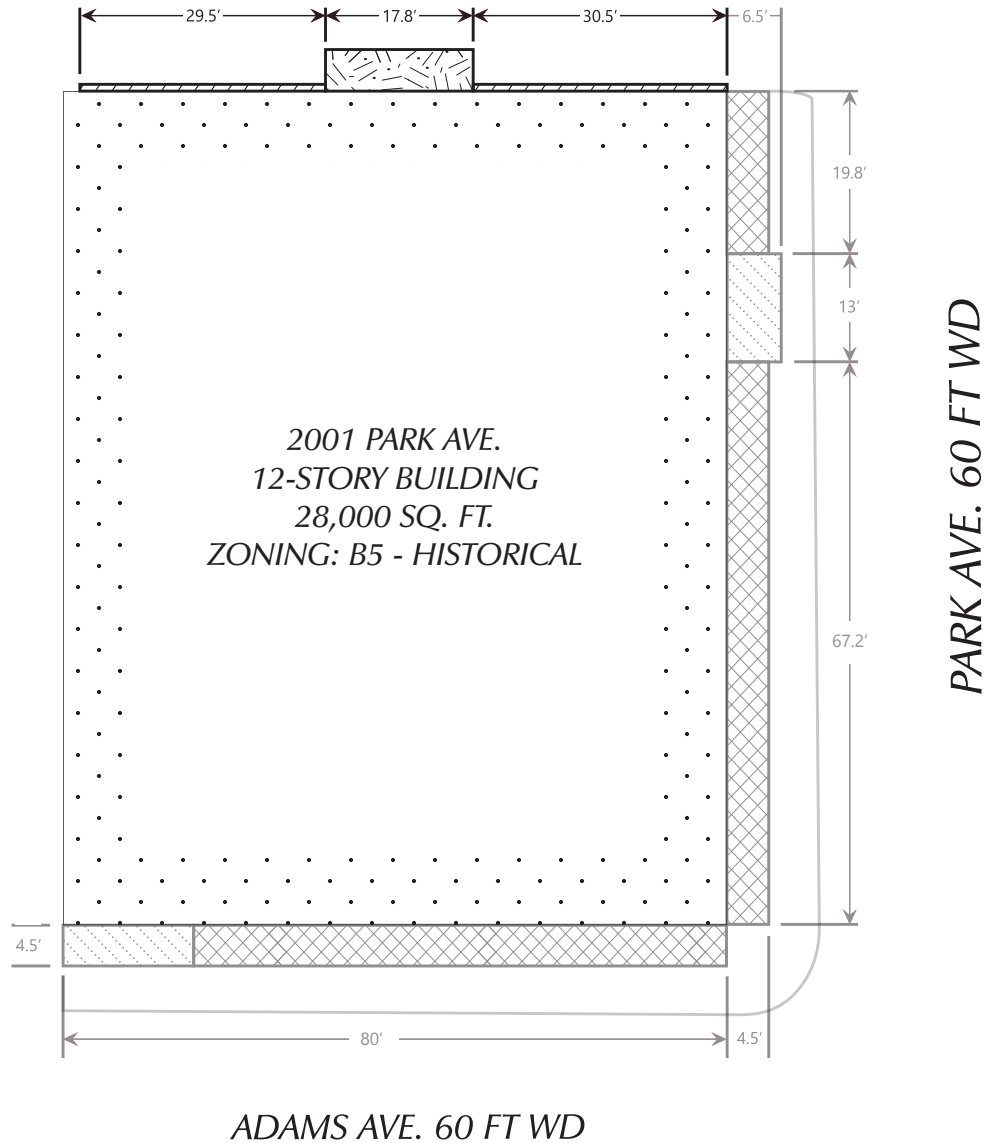

PROPOSED ENCROACHMENT AREA 3: REQUESTED ENCROACHMENT FOR EXTERIOR LIGHTING. BEGINNING 7 FT ABOVE GRADE.



PROPOSED ENCROACHMENT AREA 4: REQUESTED ENCROACHMENT FOR EXIT. BEGINNING 17 FT ABOVE GRADE.

(FOR OFFICE USE ONLY)

CARTO 28

REQUESTS FOR MULTIPLE
 ENCROACHMENTS, IN THE BLOCK
 BOUND BY ELIZABETH ST., PARK AVE.,
 ADAMS AVE., AND CLIFFORD ST.

CITY OF DETROIT
 CITY ENGINEERING DIVISION
 SURVEY BUREAU

B					
	A				
DESCRIPTION		DRWN	CHKD	APPD	DATE
REVISIONS					
DRAWN BY	CHECKED				
DATE	APPROVED BY				
09-25-20	JD				

JOB NO. 01-04
 DRWG. NO. X

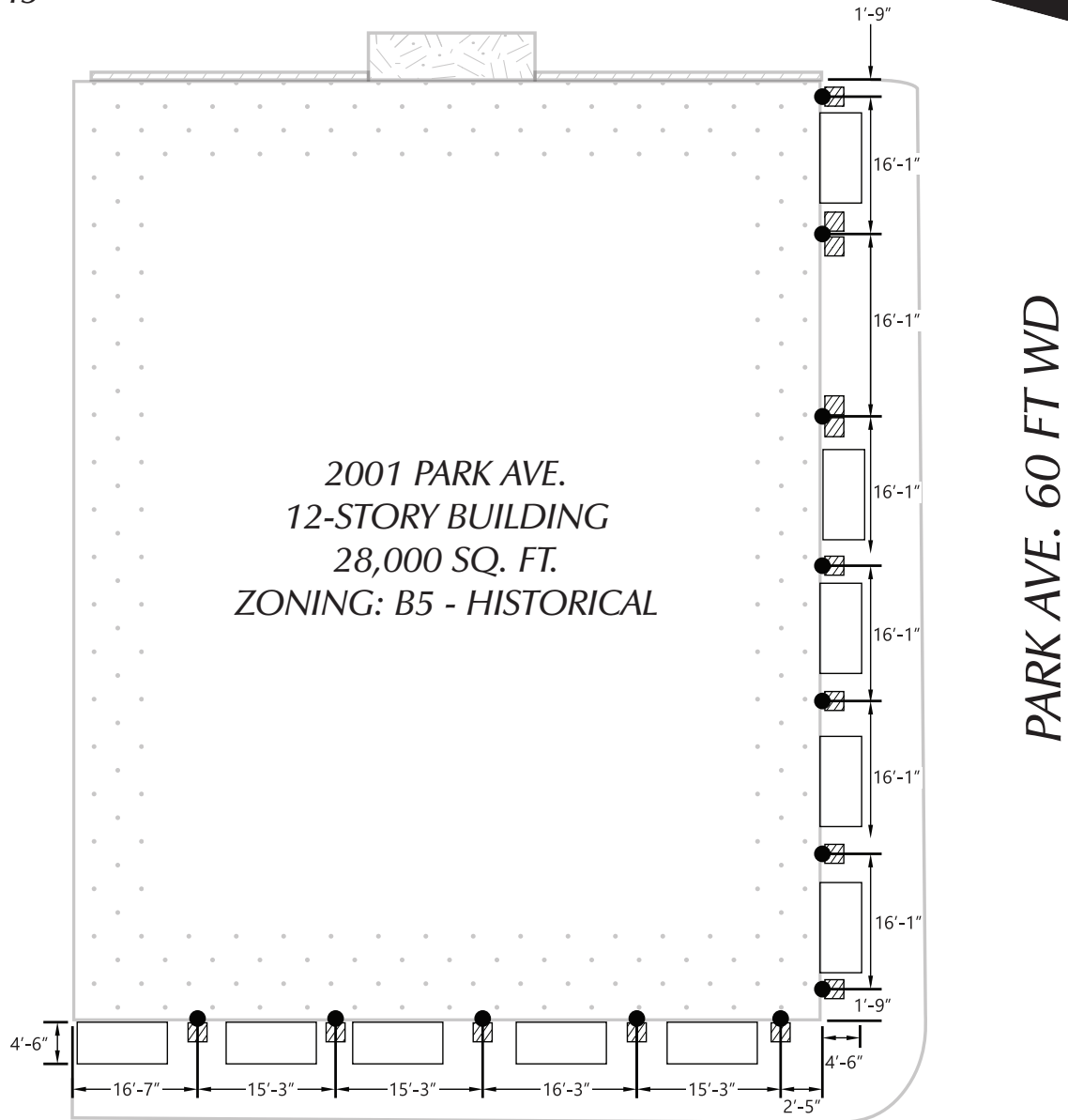

PETITION NO.XXXX
 DAVID A. RYZYI, FROM MANNIK-SMITHGROUP
 65 CADILLAC SQUARE, SUITE 3311
 DETROIT, MI 48226
 734-790-0645



2001 PARK AVE.
 12-STORY BUILDING
 28,000 SQ. FT.
 ZONING: B5 - HISTORICAL

PARK AVE. 60 FT WD

ADAMS AVE. 60 FT WD

-  - AWNING
-  - PLANTER BOX
-  - WALL SCONCE

(FOR OFFICE USE ONLY)

CARTO 28

REQUESTS FOR MULTIPLE
 ENCROACHMENTS, IN THE BLOCK
 BOUND BY ELIZABETH ST., PARK AVE.,
 ADAMS AVE., AND CLIFFORD ST.

CITY OF DETROIT
 CITY ENGINEERING DIVISION
 SURVEY BUREAU

B					
A					
DESCRIPTION	DRWN	CHKD	APPD	DATE	
REVISIONS					
DRAWN BY	KJ		CHECKED		
DATE	09-25-20		APPROVED BY	JD	

JOB NO. 01-03
 DRWG. NO. X

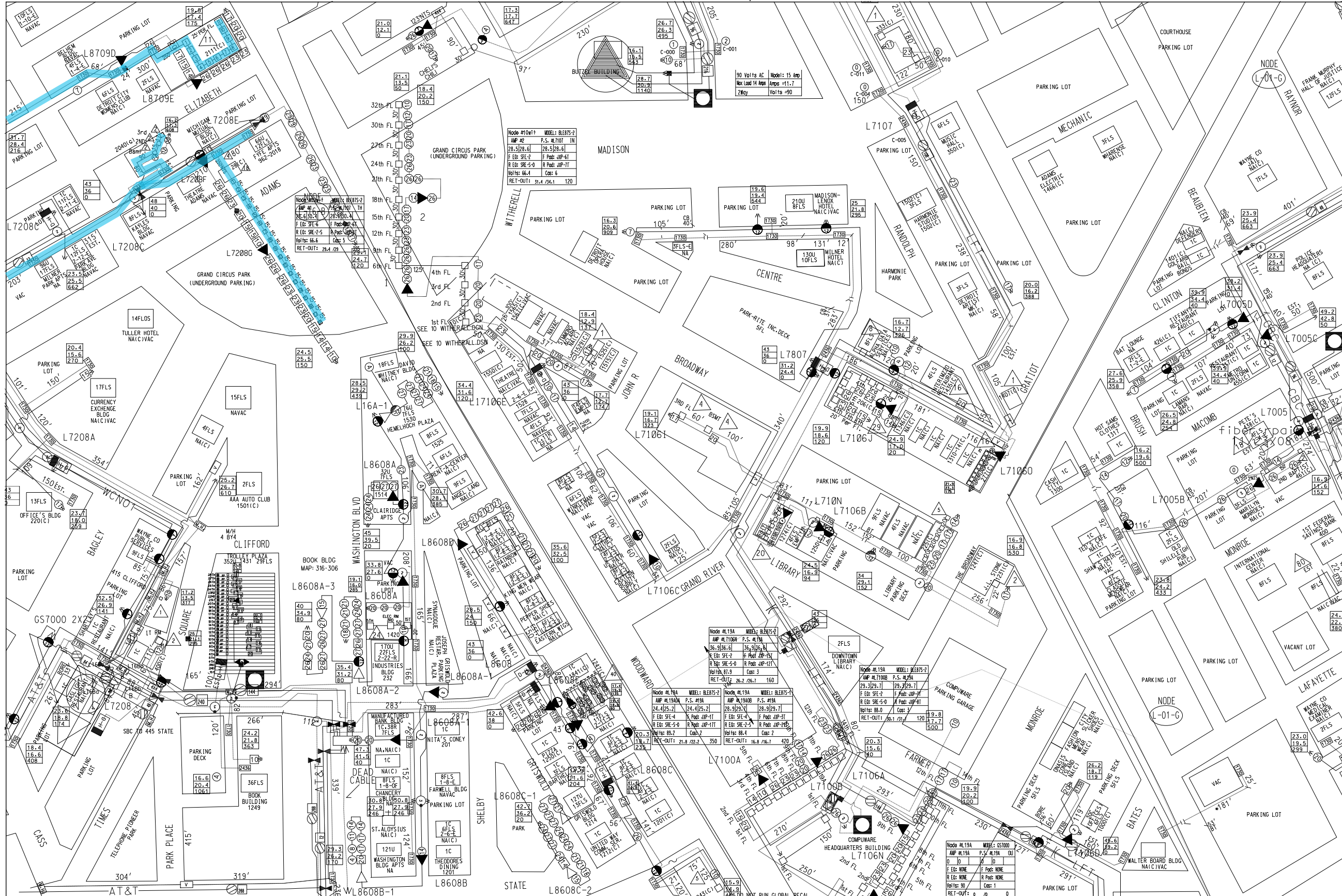

ELECTRONIC SYMBOLS		
SYMBOL	DESCRIPT.	QTY.
	TRANSMITTER	
	NODE	
	COUPLER	
	FIBER COUNT	
	SPLICE POINT	
	GROUND ENCL. STORAGE LOOP	
	LINE EXTENDER	
	LE HI-GAIN	
	TRUNK AMP	
	WITH AGC	
	L.P.I.	
	AC SUPPLY	
	2 PORT TAP	
	4 PORT TAP	
	8 PORT TAP	
	TOTAL	
	2-WAY SPLIT	
	3-WAY SPLIT	
	DIR. COUPLER	
	LINE EQ.	
	TOTAL	

AERIAL CABLE		
LINE	DESCRIP.	QTY.
	FIBER	
	.875 P3	
	.750 P3	
	.700	
	.625 P3	
	.500 MC2	
	.650 MC2	

U/G CABLE		
LINE	DESCRIP.	QTY.
	FIBER	
	.875 P3	
	.860 OR	
	.700	
	.625 P3	
	.540 OR	

07-00 CDS-ADDED F75'UG-5 VAULTS,3HC'S

COMCAST

12775 LYNDON
DETROIT, MI 48227-3982

LOCATION / TITLE:

CAD FILE:
SCALE: 1" = 100'

STRUCTURE SYMBOLS			SYMBOL DESCRIPTION			SYMBOL DESCRIPTION			SYMBOL DESCRIPTION			REVISIONS		DESIGNED BY: CDS		DATE: 11/12/02	
SYMBOL	DESCRIPTION	QTY.	SYMBOL	DESCRIPTION	QTY.	SYMBOL	DESCRIPTION	QTY.	SYMBOL	DESCRIPTION	QTY.	DATE	INITIALS	DESIGNED BY: CDS	DATE: 10/01	APPROVED BY:	DATE:
	CONCRETE POLE			CABLE BEARING STRAND FOOTAGE			APT. BOX			PEDESTAL TV 2400, 12X15 MOPED		1.26.12	WLW2012-436	343308	346308	349308	
	STEEL POLE			NON-CABLE BEARING STRAND FOOTAGE			M.D.U. BLDG.			PEDESTAL TV 106, 8X9 MOPED		3/24/10	WLW2010-1093				
	JOINT USE POLE			TOTAL AERIAL FOOTAGE			M.D.U. COUNT			VAULT 17X30		12/1/10	WLW2010-5323				
	JOINT USE POLE			TOTAL UNDERGROUND FTO			M.D.U. AERIAL FOOTAGE			VAULT 24X36		12/7/10	WLW2010-5421				
	POWER POLE			TOTAL AERIAL HOUSE COUNT			M.D.U. U/G FOOTAGE	460.91		VAULT 4X4		05.18.11	WLW2011-2781				
	TELEPHONE POLE			TOTAL U/G HOUSE COUNT			PROPOSED ROUTING FOOTAGE			VAULT 4X4		09.07.11	WLW2011-4995				
	PLD POLE (MUNICIPAL)			TOTAL COMMERCIAL COUNT			OVERHEAD GUY			LOCK BOX							
	LIGHT POLE			TOTAL HOUSE COUNT			POLE TO POLE GUY			RISER (25')		1.12.12	2012-WLW-120				