

# RONCELLI

*Dedicated to Building Excellence*



## Construction Services

### Headquarters

6471 Metro Parkway  
Sterling Heights, MI 48312  
(586) 264-2060 Phone  
(586) 979-3190 Fax

### Detroit

Guardian Building . 500 Griswold  
Suite 2440 . Detroit, MI 48226  
(313) 964-5689 Phone  
www.roncelli-inc.com

4/30/2020

Mr. Jered Dean  
Manager II – GISP  
City of Detroit Maps and Records Bureau  
Department of Public Works

### RE: New Deceleration Lane at 6836 Georgia St

Dear Mr. Dean:

Per your request please see below information regarding the new deceleration lane at 6836 Georgia St.

As previously noted, I will serve as Cedar Investment, LLC representative for this matter as it relates to construction. If direct contact is needed with owners regarding a future maintenance agreement, Dan Onifer is the appropriate person to reach at (586) 939-7000 ext 2135 or [DONifer@gocrown.ws](mailto:DONifer@gocrown.ws).

Summary of Scope of work: As per the attached drawing, we will add a deceleration lane and widen existing entrance at the Georgia Street truck entrance to the facility. This involves sawcutting and removals as needed for the new road alignment. Placement of stone base and concrete per city specifications. This will also require the relocation of existing fence and sidewalk.

Specifically Requested Dimensions: See attached pdf with dimensions requested highlighted.

Please let me know if you require any additional information.

Sincerely,

**Michael Herbon, PE, LEED AP**

Roncelli, Inc.

**(586) 879-9502 Cell**

CC: Dan Onifer- Cedar Investments, LLC

Todd Goss- Cedar Investments, LLC

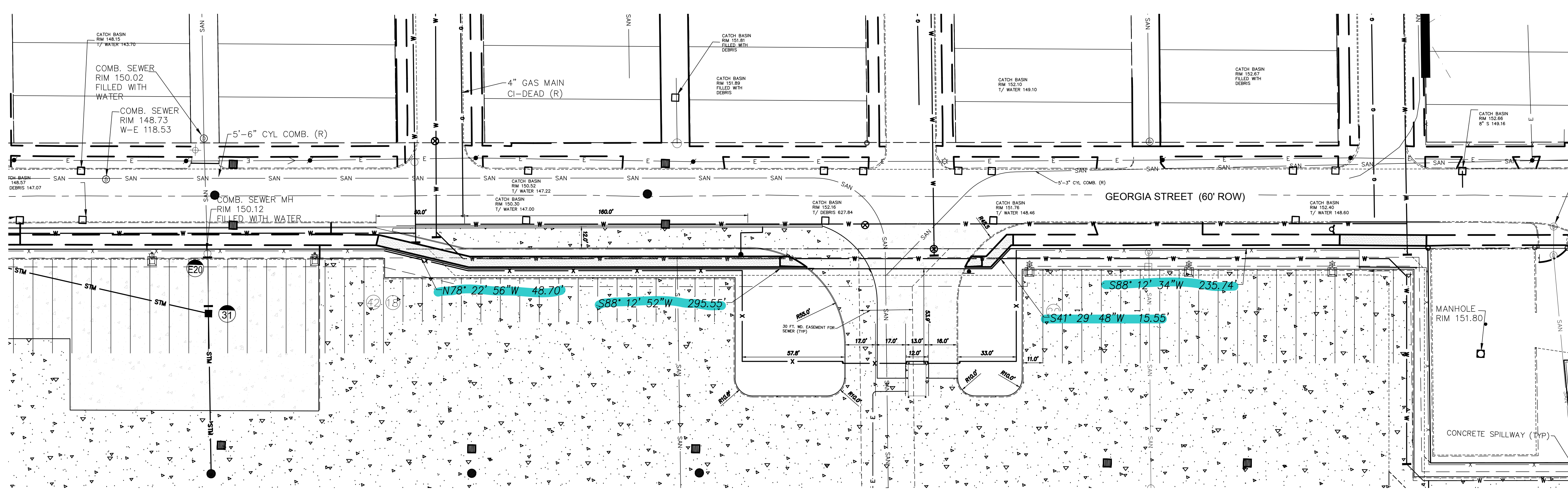

*PROPOSED ENTRANCE LAYOUT*  
(SCALE 1"=30')

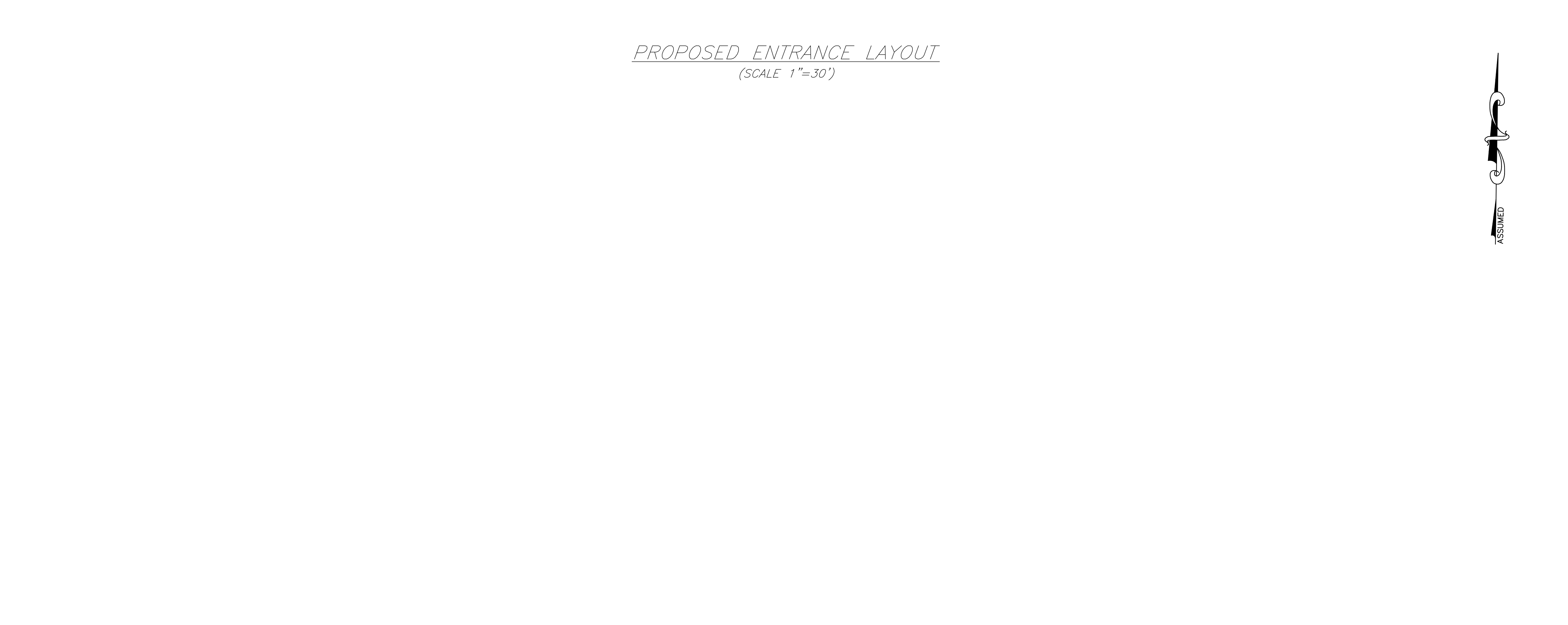

*PROPOSED ENTRANCE GRADING*  
(SCALE 1"=20')

CLIENT  
**RONCELLI**  
6471 Metro Pkwy, Sterling Heights, MI 48312

**COPYRIGHT**  
This drawing has been prepared solely for the intended use. That any reproduction or distribution for any purpose other than authorized by IBI Group is forbidden. Written dimensions shall have precedence over scaled dimensions. Contractors shall verify and be responsible for all dimensions and conditions on the job, and IBI Group shall be informed of any variations from the dimensions and conditions shown on the drawing. Shop drawings shall be submitted to IBI Group for general conformance before proceeding with fabrication.

**PLEASE CHOOSE LEGAL ENTITY**  
is a member of the IBI Group of companies

**ISSUES**

No.	DESCRIPTION	DATE
A	SITE PKG - 30% REVIEW	2019-08-07
B	SITE PKG - 60% REVIEW	2019-08-16
C	SITE PLAN	2019-08-22
D	SITE PKG - 90% REVIEW	2019-08-27
E	PERMIT	2019-09-25
F	PERMIT - REV. NO. 1	2019-10-28
G	PERMIT - REV. NO. 3	2019-10-28
H	PERMIT - REV. NO. 4	2019-11-18
I	PERMIT - REV. NO. 7	2020-01-14
J	PERMIT - REV. NO. 9	2020-02-06
K	PERMIT - REV. NO. 10	2020-03-04

CONSULTANTS

SEAL



SELECT CONSULTANT TYPE  
**IBI GROUP**  
Suite 300-25200 Telegraph Road,  
Southfield, MI 48033, USA  
Tel: 248 936 8000 fax: 248 936 8111  
ibigroup.com

PROJECT  
**FCA GEORGIA STREET PROJECT**  
6836 GEORGIA ST  
DETROIT, MI 48211

PROJECT NO:  
121872

DRAWN BY:	CHECKED BY: <b>F. KHALIL</b>
PROJECT MGR:	APPROVED BY: <b>G. TANNAR</b>

SHEET TITLE  
**ENTRANCE DETAIL**

SHEET NUMBER <b>CI-5000</b>	ISSUE
--------------------------------	-------