

Petition No. 1264  
 5725 Walnut LLC represented by Giffels Webster, Michael Marks  
 28 W. Adams, Suite 1200, Detroit, MI 48226  
 (313) 962-4442

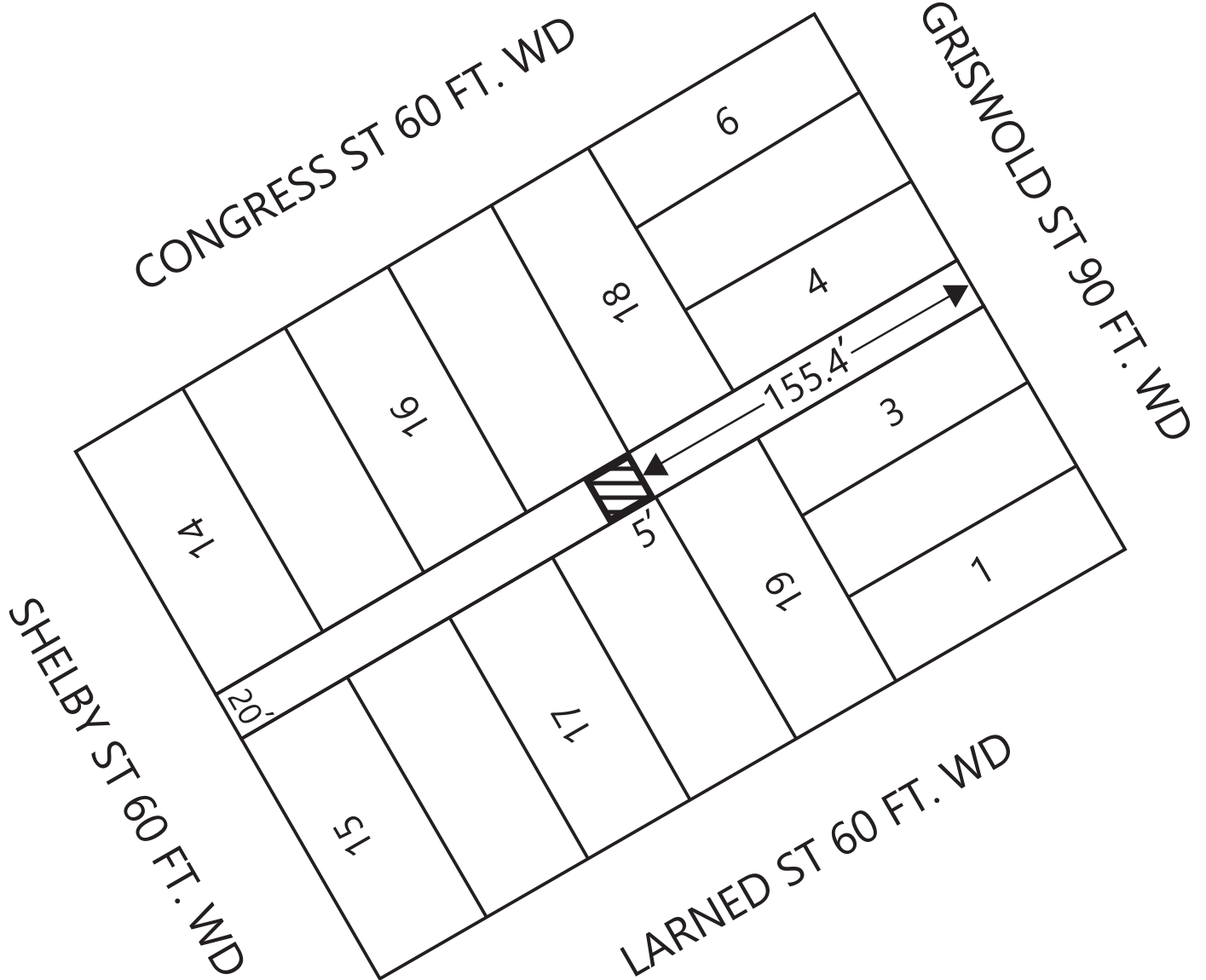

- BELOW GRADE ENCROCHMENT (10 FT. BELOW GRADE)

(FOR OFFICE USE ONLY)

**CARTO 28**

<b>B</b>					
<b>A</b>					
DESCRIPTION	DRWN	CHKD	APPD	DATE	
REVISIONS					
DRAWN BY	KJ	CHECKED	KSM		
DATE	03-29-20	APPROVED BY	JD		

10 FT. BELOW GRADE ENCROCHMENT IN  
 THE EAST/WEST PUBLIC ALLEY, 20 FT. WD.  
 IN THE BLOCK BOUND BY  
 CONGRESS ST., GRISWOLD AVE., LARNED ST,  
 AND SHELBY ST.

**CITY OF DETROIT**  
 CITY ENGINEERING DIVISION  
 SURVEY BUREAU

JOB NO. 01-01  
 DRWG. NO. X 1264