

PETITION NO. 1243
 FIRM REAL ESTATE MANAGEMENT I, LLC.
 2459 RIOPELLE ST.
 DETROIT, MI 48207
 (C/O) CHARLES E. BRODEUR
 PHONE NO. (248) 416-4020

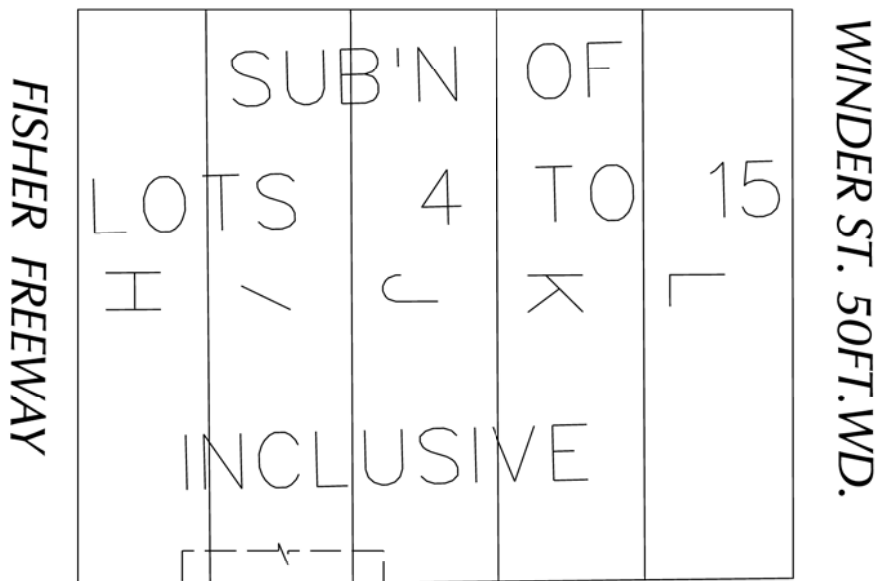

MARKET ST. 77 FT.WD.



RIOPELLE ST. 39 FT.WD.

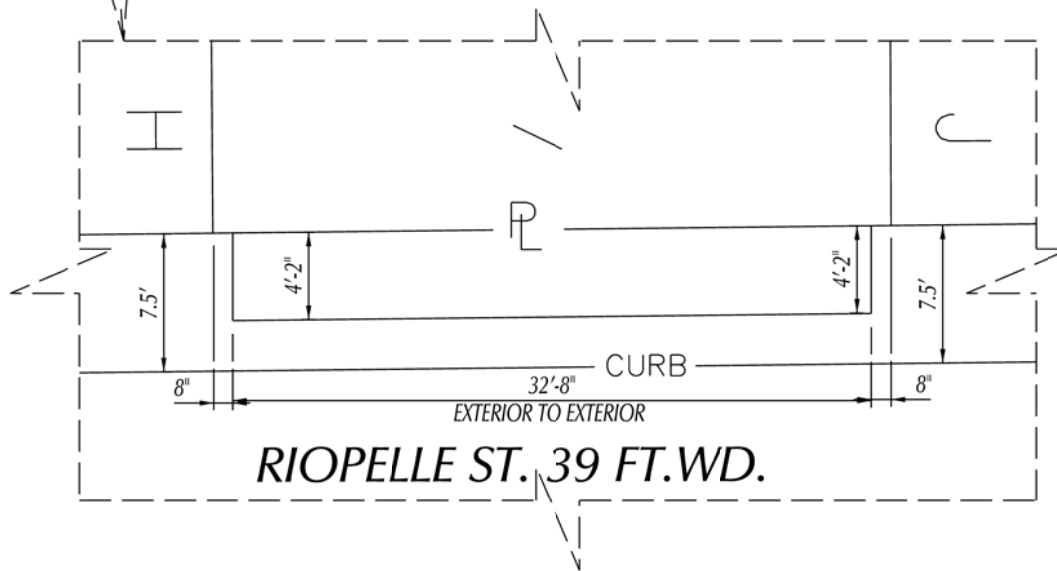

RIOPELLE ST. 39 FT.WD.

 - REQUEST ENCROACHMENT
 (FOR A PRE-EXISTING BELOW GRADE BASEMENT)

(FOR OFFICE USE ONLY)

CARTO 39 D

B					
A					
REVISIONS					
DESCRIPTION	DRWN	CHKD	APPD	DATE	
DRAWN BY SA	CHECKED	KSM			
DATE 03-17-20	APPROVED	JD			

REQUEST ENCROACHMENT
 INTO RIOPELLE ST.
 AT 2459 RIOPELLE ST.
 (FOR A PRE-EXISTING BELOW GRADE
 BASEMENT)

CITY OF DETROIT CITY ENGINEERING DIVISION SURVEY BUREAU	
JOB NO.	01-01
DRWG. NO.	X 1243