

TO: City Engineering Division, DPW
2 Woodward Ave., Suite 642
Detroit, MI 48226-3462
Survey Bureau: 313-224-3970

Petition No. 1171

The proposed change in property (referred to above) would affect our services as follows:

- () Not Involved.
- () Involved; but asking you to hold action on this petition until further notice.
- () Involved; the nature of our services, and the estimated costs of removing and/or rerouting such services are:
- (X) Involved; have no objection to request for the outright vacation of the north/south Grinnell Ave. 50 feet wide between Winfield Ave. and St. Cyril Ave. – Conversion to Easement Alleys (10 and 20 feet wide) north of Grinnell Ave. and East of Winfield Ave. as shown on drawing no. X1171 dated 01/21/2020 and revised on 01/27/2020 provided that 100% signatures of abutting property owners are secured.

Traffic Engineering Division - DPW
(Utility or City Department)

Ashok Patel

By

Sunny Jacob

City Traffic Engineer

Title

March 2, 2020

Date

313 224-1610



Area code-Telephone number

AA/aa

PETITION NO. 1171
 CHAUNCEY HITCHCOCK
 PHONE NO. (313)-567-6473
 CELL PHONE (313)-820-5954
 EMAIL: Chauncey.hitchcock@soave.com.
 C/O CASSI MEITL
 PHONE NO. (708) 212-0524

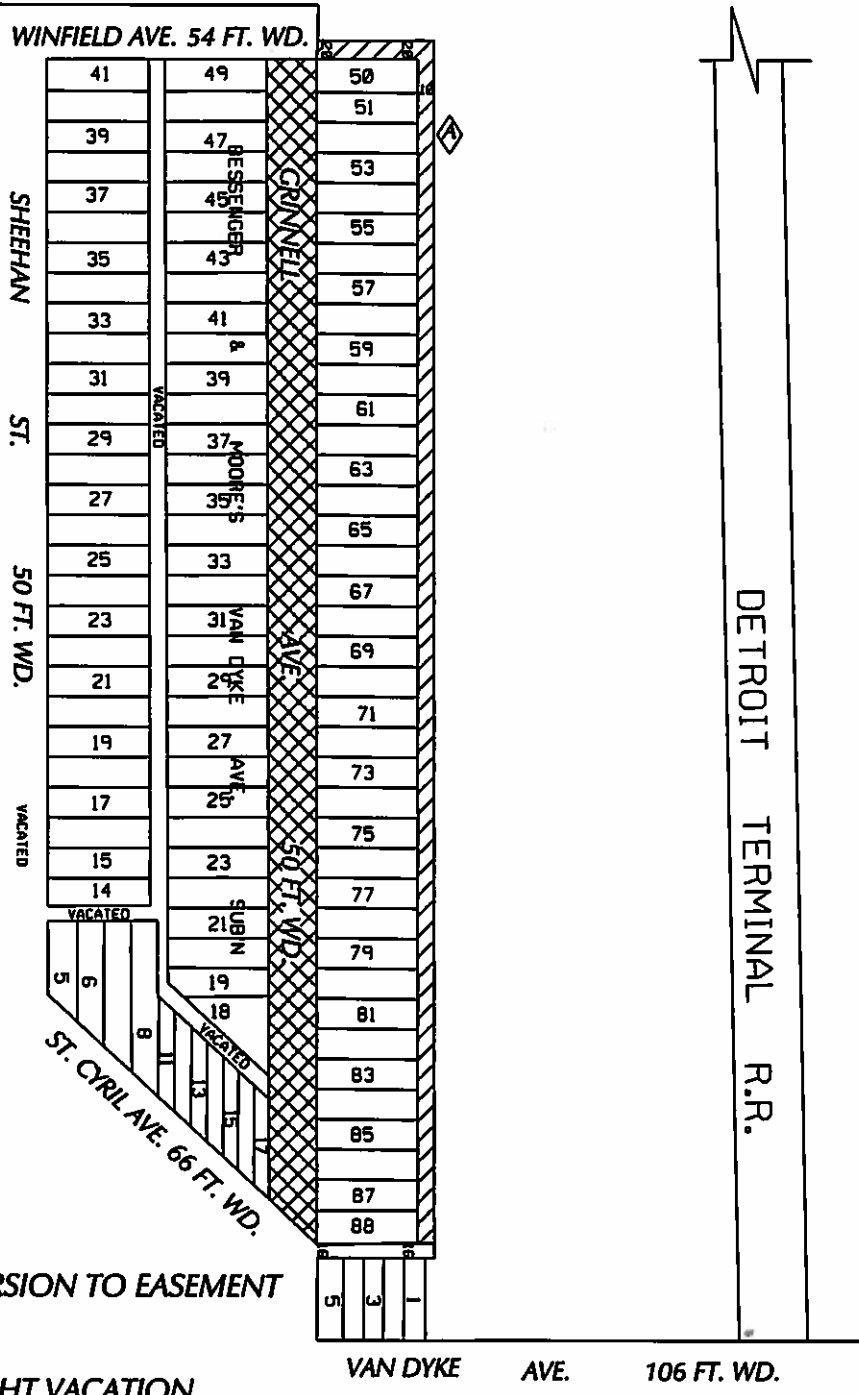
"REVISION-A"



-  - CONVERSION TO EASEMENT
-  - OUTRIGHT VACATION

(FOR OFFICE USE ONLY)

CARTO 50 A

B				
A	REVISED: CHANGING THE REQUEST OF VACATION FOR THE ALLEY NORTH OF GRINNELL AVE. FROM OUTRIGHT VACATION TO CONVERSION TO EASEMENT	SA	KSM	JD 01/27/2020
REVISIONS				
DRAWN BY	SA	CHECKED	KSM	
DATE	01-21-2020	APPROVED		

- REQUEST TO OUTRIGHT VACATE GRINNELL AVE. 50 FT. WD. BETWEEN WINFIELD AVE. AND ST. CYRIL AVE.
 - CONVERSION TO EASEMENT ALLEYS (10 AND 20 FT. WD.) NORTH OF GRINNELL AVE. AND EAST OF WINFIELD AVE.

CITY OF DETROIT CITY ENGINEERING DIVISION SURVEY BUREAU	
JOB NO.	01-01
DRWG. NO.	X 1171