

City of Detroit
City Engineering Division, Department of Public Works
Survey Bureau

NOTICE OF PROPOSED CHANGE IN PROPERTY

2nd Notice: 10/22/2019

Date: 09/23/2019

Petition: x988

- | | |
|--|--|
| <input type="checkbox"/> AT&T Telecommunication | <input type="checkbox"/> Berm Use |
| <input type="checkbox"/> Comcast Television (CATV) | <input checked="" type="checkbox"/> Conversion to Easement |
| <input type="checkbox"/> Detroit Edison (DTE) | <input type="checkbox"/> Dedication |
| <input checked="" type="checkbox"/> Fire Department | <input type="checkbox"/> Encroachment |
| <input type="checkbox"/> Great Lakes Water Authority | <input type="checkbox"/> Outright Vacation |
| <input type="checkbox"/> Land Bank Authority | <input type="checkbox"/> Temporary Closing |
| <input type="checkbox"/> Michcon (DTE) | |
| <input type="checkbox"/> Planning & Development Department | |
| <input type="checkbox"/> Public Lighting Authority | |
| <input type="checkbox"/> Public Lighting Department | |
| <input type="checkbox"/> Police Department | |
| <input type="checkbox"/> Solid Waste Division, DPW | |
| <input type="checkbox"/> Street Design Bureau, DPW | |
| <input type="checkbox"/> Street Maintenance Division, DPW | |
| <input type="checkbox"/> Traffic Engineering Division, DPW | |
| <input type="checkbox"/> Water and Sewerage Department | |
| <input type="checkbox"/> _____ | |

A petition drawing is attached. Property shown on the attached print is proposed to be changed as indicated. Kindly report (using the back of this sheet) the nature of your services, if any affected by the proposed change and the estimated costs of removing and rerouting such services (if necessary).

Please return one copy to City Engineering Division, DPW within two weeks of the submittal date. Retain one copy and print for you file.

Ron Brundidge, Director, Department of Public Works

By: Richard Doherty, CED DPW
City Engineer

TO: City Engineering Division, DPW
2 Woodward Ave., Suite 642
Detroit, Michigan 48226-3462
Survey Bureau: 313-224-3970

Petition: x988

The proposed change in property (referred to on the other side of this sheet) would affect our services as follows:

- ☐ Not Involved
- ☐ Involved; but asking you to hold action on this petition until further notice.
- ☒ Involved; but no objections to the property change.
- ☐ Involved; objection to the property change.
- ☐ Involved; but no objections to the property change...provided as easement of the full width of the public right-of-way (street, alley or other public place) is reserved.
- ☐ Involved; the nature of our services and the estimated costs of removing and/or rerouting such services are:

Fine
(Utility or City Department)

Henry Russell
By

Chief
Title

10-24-19
Date

313-224-1311
Area code – Telephone number

PETITION NO. 988
 RAINCHECK DEVELOPMENT LLC.
 59 PHILADELPHIA
 DETROIT, MICHIGAN 48202
 PHONE NO. (248) 866- 7900



WOODWARD AVE. 100 FT.WD.

PHILADELPHIA E. AVE. 60 FT.WD.

HAGUE AVE. 60 FT.WD.

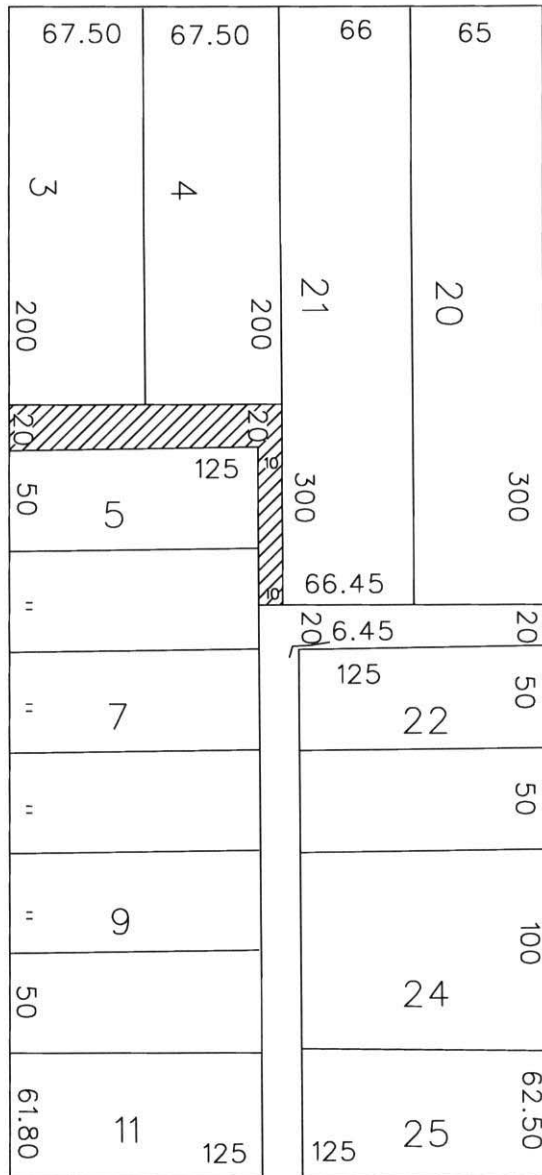

JOHN R. ST. 60 FT.WD.



- CONVERSION TO EASEMENT

(FOR OFFICE USE ONLY)

CARTO 32 F

B						CONVERSION TO EASEMENT THE SOUTH/NORTH PUBLIC ALLEY, 20 FT. WD. AND THE EAST/WEST PUBLIC ALLEY, 10 FT. WD. ADJACENT TO 59 PHILADELPHIA IN THE BLOCK BOUND BY PHILADELPHIA E. AVE., WOODWARD AVE., HAGUE AVE. AND JOHN R. ST.	CITY OF DETROIT CITY ENGINEERING DIVISION SURVEY BUREAU	
A							JOB NO. 01-01	
DESCRIPTION		DRWN	CHKD	APPD	DATE		DRWG. NO. X 988	
DRAWN BY SA		CHECKED JA						
DATE 09-17-19		APPROVED						