

City of Detroit  
**City Engineering Division, Department of Public Works  
Survey Bureau**

**NOTICE OF PROPOSED CHANGE IN PROPERTY**

Date: 05/30/2019

Petition: x882

- |  |   |
|--|---|
| <input type="checkbox"/> AT&T Telecommunication            | <input type="checkbox"/> Berm Use               |
| <input type="checkbox"/> Comcast Television (CATV)         | <input type="checkbox"/> Conversion to Easement |
| <input type="checkbox"/> Detroit Edison (DTE)              | <input type="checkbox"/> Dedication             |
| <input type="checkbox"/> Fire Department                   | <input type="checkbox"/> Encroachment           |
| <input type="checkbox"/> Great Lakes Water Authority       | <input type="checkbox"/> Outright Vacation      |
| <input type="checkbox"/> Land Bank Authority               | <input type="checkbox"/> Temporary Closing      |
| <input checked="" type="checkbox"/> Michcon (DTE)          |   |
| <input type="checkbox"/> Planning & Development Department |   |
| <input type="checkbox"/> Public Lighting Authority         |   |
| <input type="checkbox"/> Public Lighting Department        |   |
| <input type="checkbox"/> Police Department                 |   |
| <input type="checkbox"/> Solid Waste Division, DPW         |   |
| <input type="checkbox"/> Street Design Bureau, DPW         |   |
| <input type="checkbox"/> Street Maintenance Division, DPW  |   |
| <input type="checkbox"/> Traffic Engineering Division, DPW |   |
| <input type="checkbox"/> Water and Sewerage Department     |   |
| <input type="checkbox"/> _____                             |   |

A petition drawing is attached. Property shown on the attached print is proposed to be changed as indicated. Kindly report (using the back of this sheet) the nature of your services, if any affected by the proposed change and the estimated costs of removing and rerouting such services (if necessary).

Please return one copy to City Engineering Division, DPW within two weeks of the submittal date. Retain one copy and print for you file.

Ron Brundidge, Director, Department of Public Works

By: Richard Doherty, CED DPW  
City Engineer

**TO: City Engineering Division, DPW  
2 Woodward Ave., Suite 642  
Detroit, Michigan 48226-3462  
Survey Bureau: 313-224-3970**

**Petition: x882**

The proposed change in property (referred to on the other side of this sheet) would affect our services as follows:

- Not Involved
- Involved; but asking you to hold action on this petition until further notice.
- Involved; but no objections to the property change.
- Involved; objection to the property change.
- Involved; but no objections to the property change...provided as easement of the full width of the public right-of-way (street, alley or other public place) is reserved.
- Involved; the nature of our services and the estimated costs of removing and/or rerouting such services are:

DTE Gas Company  
(Utility or City Department)

Jade M. Detroyer  
By

Drafter  
Title

June 17, 2019  
Date

313.235.1783  
Area code – Telephone number



**STATE LAW ACT 174  
3 WORKING DAYS  
BEFORE YOU DIG  
DIAL TOLL FREE  
1-800-482-7171 OR 811**

**DTE Energy's  
Gas Leak Emergency  
Phone Number  
1-800-947-5000**

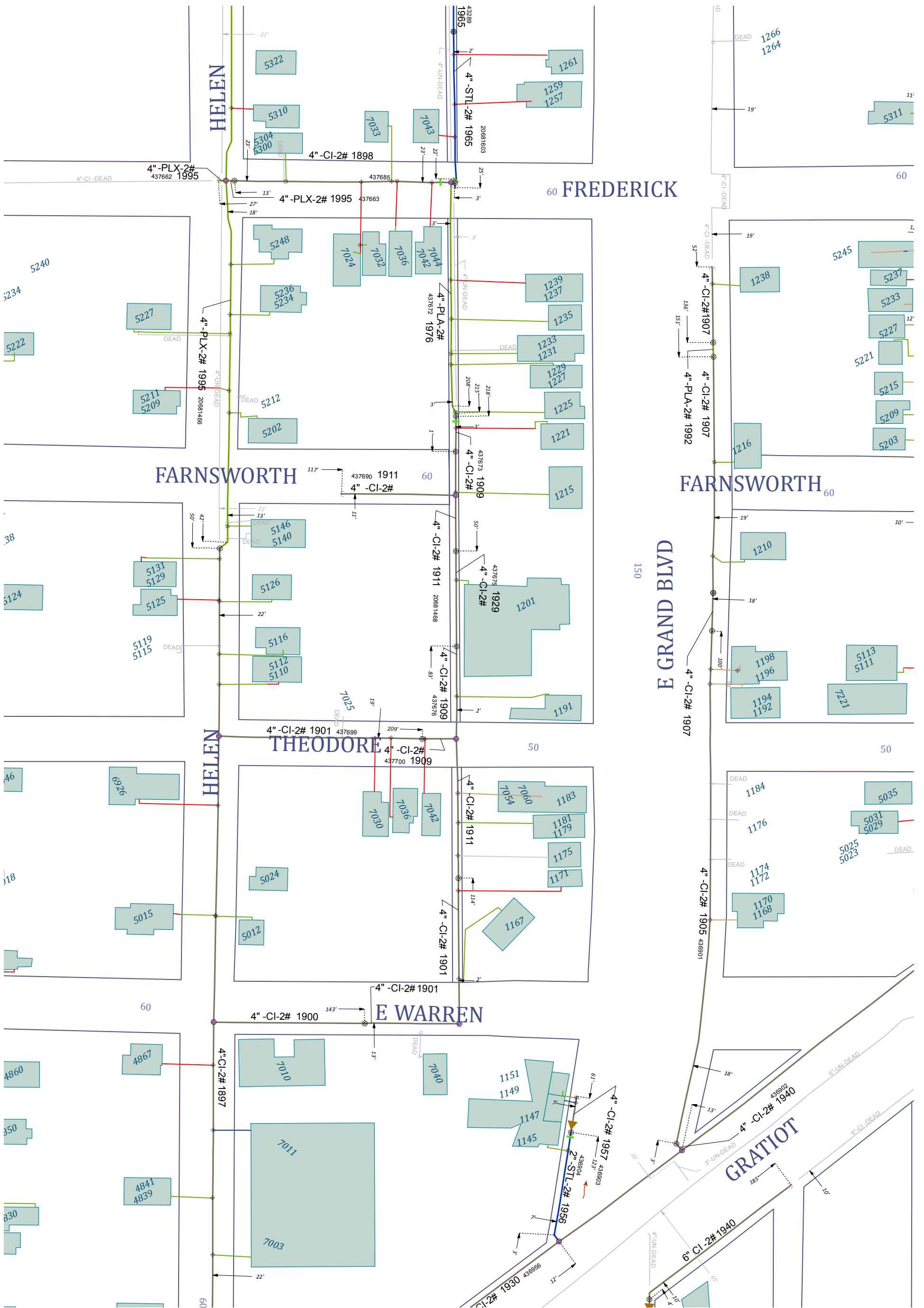

DTE GAS COMPANY FACILITIES AS SHOWN INDICATE APPROXIMATE LOCATIONS ONLY AS DISCLOSED BY THE COMPANY'S RECORDS AND NO GUARANTEE IS MADE EITHER AS TO COMPLETENESS OR ACCURACY.

**DTE GAS COMPANY**

SIGNED: */s/ Jade Detroyer* June 17, 2019

CONSTRUCTION PLANS MADE SUBSEQUENT TO THIS DATE SHOULD BE CHECKED WITH THE DTE GAS COMPANY



**STATE LAW ACT 174**  
**3 WORKING DAYS**  
**BEFORE YOU DIG**  
**DIAL TOLL FREE**  
**1-800-482-7171 OR 811**

Pipe Material		Main Line Styles	
	CU - Copper		In Design Main (Proposed)
	PLA - Plastic		Distribution Main
	STL - Bare Steel		Joint Trench
	STL - Coated Steel		Exposed Pipe
	CI - Cast Iron		Pipe Lining (CI or WI)
	WI - Wrought Iron		Transmission Main
	UN - Unknown		Subtransmission Main
	Inactive		
	Abandoned		

**WARNING**

HIGH PRESSURE MAINS ARE HIGHLIGHTED — THEY SUPPLY GAS TO A LARGE NUMBER OF HOMES AND INDUSTRIES OF DETROIT AND VICINITY

IT IS OF THE UTMOST IMPORTANCE THAT EVERY PRECAUTION BE TAKEN SO AS NOT TO ENDANGER ITS USE DURING OR FOLLOWING YOUR CONSTRUCTION

**DTE GAS COMPANY**

