

TO: City Engineering Division, DPW
2 Woodward Ave., Suite 642
Detroit, MI 48226-3462
Survey Bureau: 313-224-3970

Petition No. 867

The proposed change in property (referred to above) would affect our services as follows:

- Not Involved.
- Involved; but asking you to hold action on this petition until further notice.
- Involved; the nature of our services, and the estimated costs of removing and/or rerouting such services are:
- Involved; have no objection to the following petition requests as shown on drawing no. x867 dated on 06/03/19 and revised on 07/25/2019:
 - 1) Outright vacation of Conner Lane from Mack Ave. to its northern terminus.
 - 2) Outright vacation of Canal Street from Freud Ave. to its southern terminus
 - 3) Outright vacation of the east/west alley south of Mack Ave. and west of St. Jean
 - 4) Outright vacation of the remaining 50 feet of the east/west alley north of Kerecheval and west of St Jean
 - 5) Outright vacation of the first north/south alley west of St. Jean from the South line of E. Vernor Hwy. to the south line of 2130 Beniteau St.
 - 6) Outright vacation of the first north/south alley west of St. Jean from the south line of Goethe Ave. to the north line of Charlevoix St.
 - 7) Access encroachment into Beniteau St. between East Vernor Hwy. and Kercheval with sewer pipe

Traffic Engineering Division - DPW
(Utility or City Department)

Ashok Patel *Sunny Jacob*
By

City Traffic Engineer
Title

August 8, 2019
Date

313 224-1610
Area code-Telephone number

Aa/aa

"REVISION -A-"

PETITION NO. 867
 DPW - CITY ENGINEERING
 (C/O KEITH MCCRARY)
 COLEMAN A. YOUNG
 MUNICIPAL CENTER, SUITE 642
 DETROIT, MICHIGAN 48226
 PHONE NO. (313) 224-3970

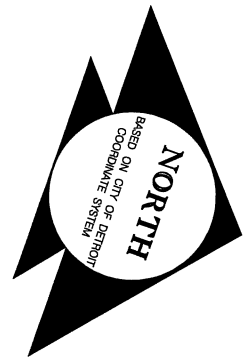
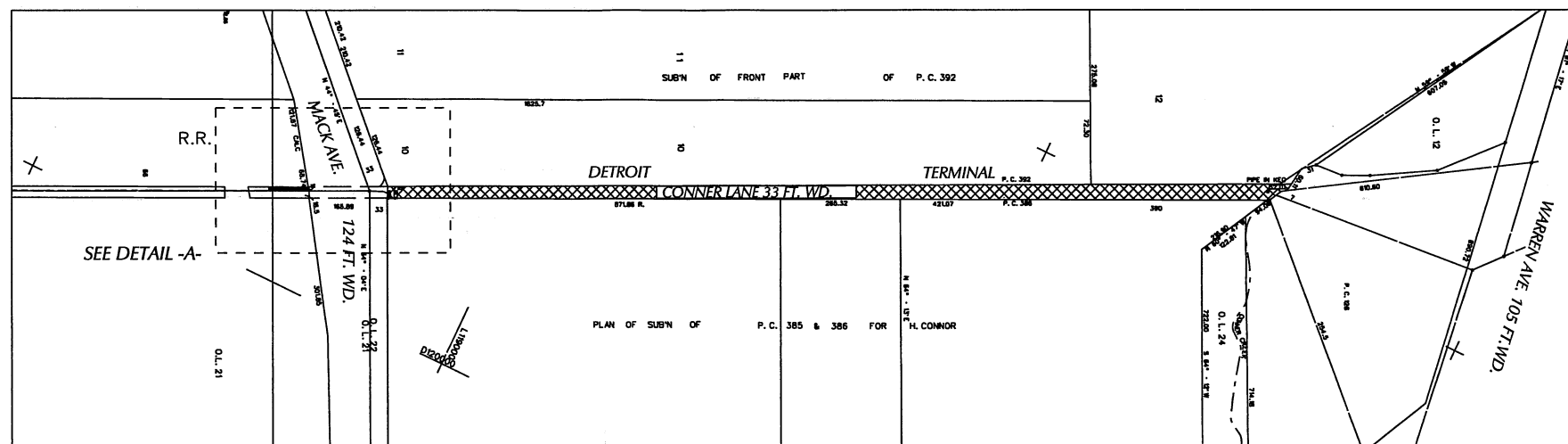
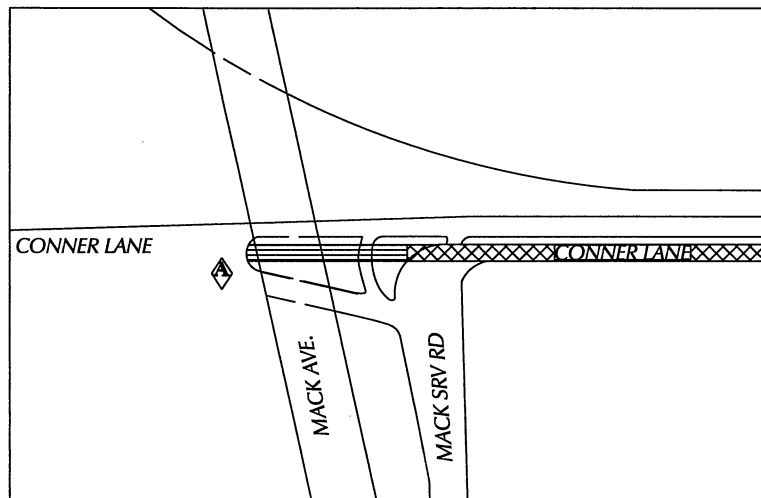
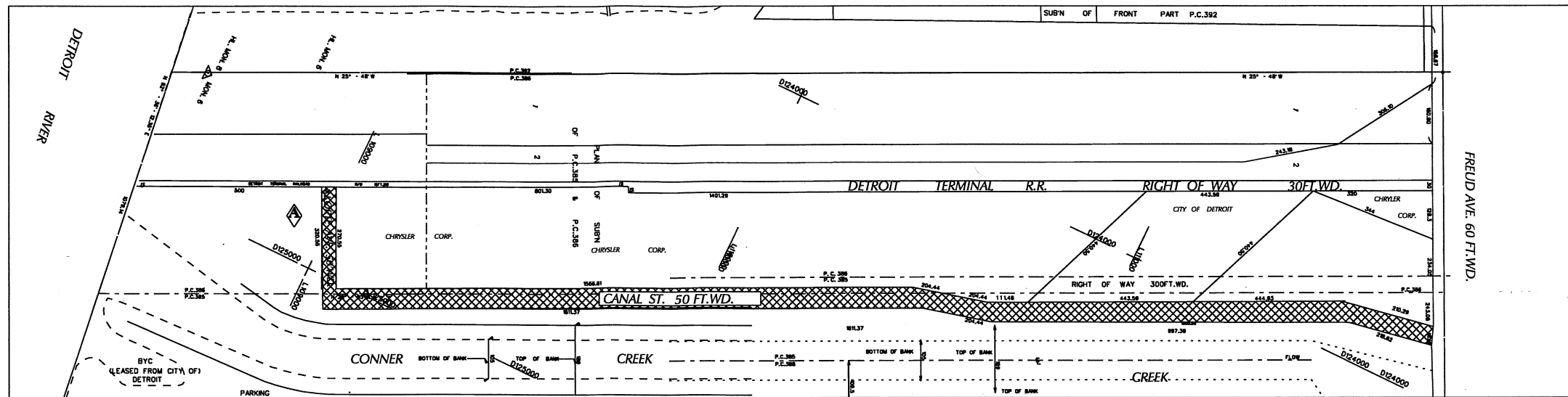

DETAIL -A-

- REQUESTED OUTRIGHT VACATION
- REQUEST ACCESS DRIVE ENCROACHMENT
- REQUEST ENCROACHMENT

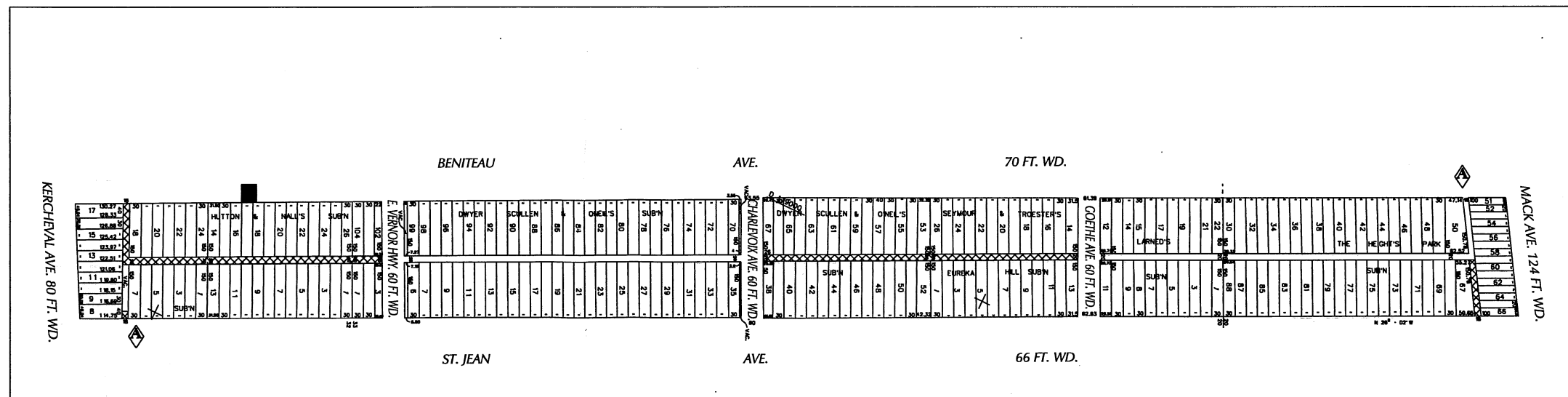

(FOR OFFICE USE ONLY)

CARTO
 54G 54F 54A 55F 55A 56F 62C 62D 61C

B				
A	CHANGING THE DESCRIPTION	SA	KSM	7/25/19
REVISIONS				
DESCRIPTION	DRWN	CHEK	APPD	DATE
DRAWN BY	SA	CHECKED	KSM	
DATE	06-03-19	APPROVED		

REQUEST TO OUTRIGHT VACATE THE FOLLOWING PUBLIC RIGHT OF WAYS :
 - CONNER LANE FROM MACK AVE. TO ITS NORTHERN TERMINUS.
 - CANAL STREET FROM FREUD AVE. TO ITS SOUTHERN TERMINUS.
 - EAST/WEST ALLEY SOUTH OF MACK AVE. AND WEST OF ST. JEAN.
 - REMAINING 50 FEET OF THE EAST/WEST ALLEY NORTH OF KERCHEVAL AND WEST OF ST. JEAN.
 - THE FIRST NORTH/SOUTH ALLEY WEST OF ST. JEAN FROM THE SOUTH LINE OF E. VERNOR HWY. ST. TO THE SOUTH LINE OF 2130 BENITEAU ST.

- THE FIRST NORTH/SOUTH ALLEY WEST OF ST. JEAN FROM THE SOUTH LINE OF GOETHE AVE. TO THE NORTH LINE OF CHARLEVOIX ST.
 # ACCESS ENCROACHMENT INTO BENITEAU ST. BETWEEN EAST VERNOR HWY. AND KERCHEVAL WITH SEWER PIPE.

CITY OF DETROIT	
CITY ENGINEERING DEPARTMENT	
SURVEY BUREAU	
JOB NO.	01-01
DRWG. NO.	X 867