

**City of Detroit**  
**City Engineering Division, Department of Public Works**  
**Survey Bureau**

**NOTICE OF PROPOSED CHANGE IN PROPERTY**

Date: 07/25/2019

Petition: x867 R.A

- |   |   |
|---|---|
| <input type="checkbox"/> AT&T Telecommunication                       | <input type="checkbox"/> Berm Use                     |
| <input type="checkbox"/> Comcast Television (CATV)                    | <input type="checkbox"/> Conversion to Easement       |
| <input type="checkbox"/> Detroit Edison (DTE)                         | <input type="checkbox"/> Dedication                   |
| <input type="checkbox"/> Fire Department                              | <input checked="" type="checkbox"/> Encroachment      |
| <input type="checkbox"/> Great Lakes Water Authority                  | <input checked="" type="checkbox"/> Outright Vacation |
| <input type="checkbox"/> Land Bank Authority                          | <input type="checkbox"/> Temporary Closing            |
| <input type="checkbox"/> Michcon (DTE)                                |   |
| <input checked="" type="checkbox"/> Planning & Development Department |   |
| <input type="checkbox"/> Public Lighting Authority                    |   |
| <input type="checkbox"/> Public Lighting Department                   |   |
| <input type="checkbox"/> Police Department                            |   |
| <input type="checkbox"/> Solid Waste Division, DPW                    |   |
| <input type="checkbox"/> Street Design Bureau, DPW                    |   |
| <input type="checkbox"/> Street Maintenance Division, DPW             |   |
| <input type="checkbox"/> Traffic Engineering Division, DPW            |   |
| <input type="checkbox"/> Water and Sewerage Department                |   |
| <input type="checkbox"/> _____  |   |

A petition drawing is attached. Property shown on the attached print is proposed to be changed as indicated. Kindly report (using the back of this sheet) the nature of your services, if any affected by the proposed change and the estimated costs of removing and rerouting such services (if necessary).

Please return one copy to City Engineering Division, DPW within two weeks of the submittal date. Retain one copy and print for you file.

Ron Brundidge, Director, Department of Public Works

By: Richard Doherty, CED DPW  
City Engineer

**TO: City Engineering Division, DPW  
2 Woodward Ave., Suite 642  
Detroit, Michigan 48226-3462  
Survey Bureau: 313-224-3970**

**Petition: x867 R.A**

The proposed change in property (referred to on the other side of this sheet) would affect our services as follows:

- Not Involved
- Involved; but asking you to hold action on this petition until further notice.
- Involved; but no objections to the property change.
- Involved; objection to the property change.
- Involved; but no objections to the property change...provided as easement of the full width of the public right-of-way (street, alley or other public place) is reserved.
- Involved; the nature of our services and the estimated costs of removing and/or rerouting such services are:

City of Detroit-Planning & Development Department  
(Utility or City Department)

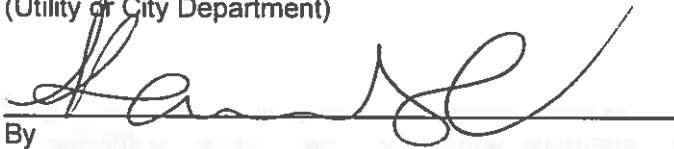
  
By

Karen Gage-Director of Zoning Innovation  
Title



7/26/19  
Date

313-224-0472  
Area code – Telephone number

# "REVISION -A-"

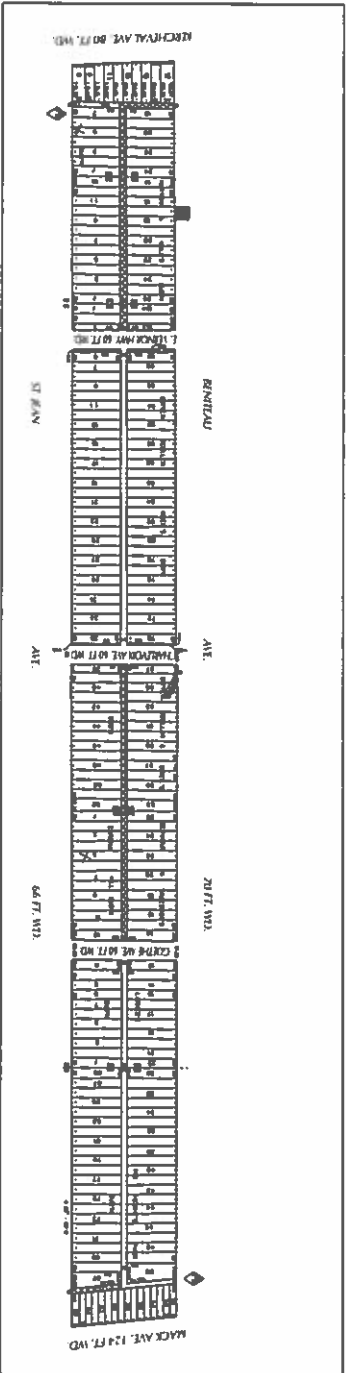
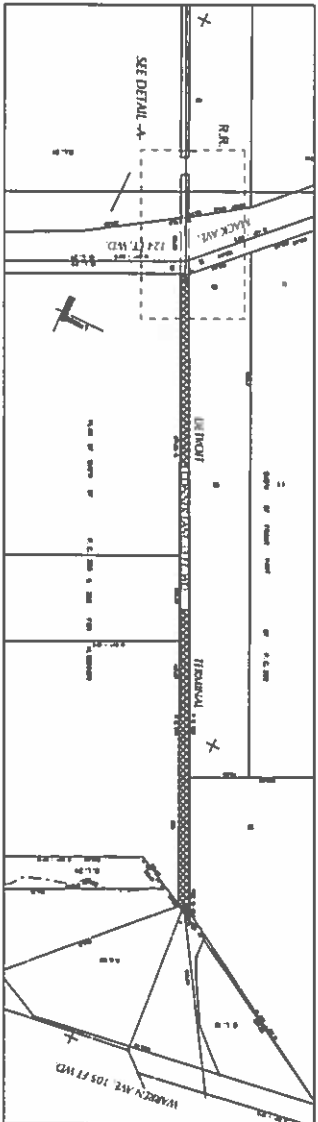
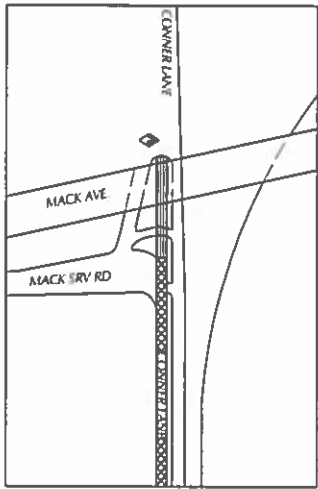
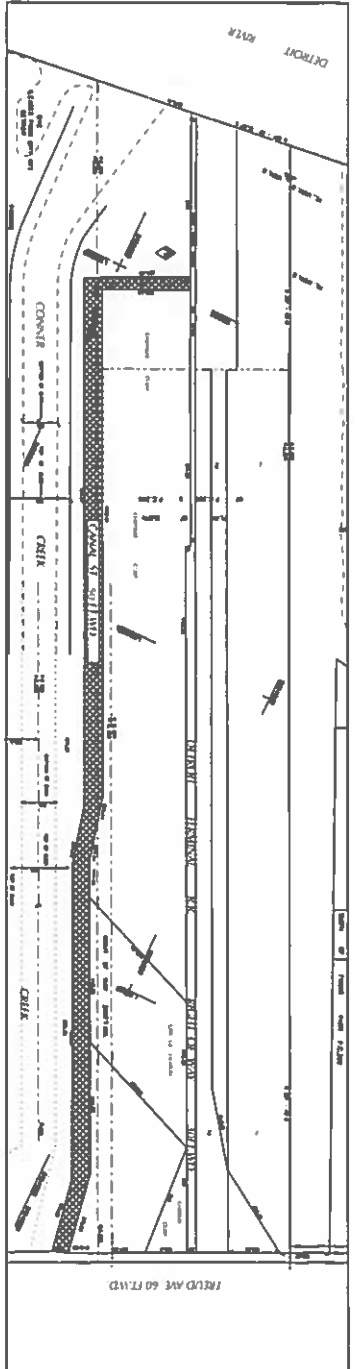
PETITION NO. 867  
 DPW - CITY ENGINEERING  
 (C/O KEITH MCCRARY)  
 COLEMAN A. YOUNG  
 MUNICIPAL CENTER, SUITE 642  
 DETROIT, MICHIGAN 48226  
 PHONE NO. (313) 224-3970



-  - REQUESTED OUTRIGHT VACATION
-  - REQUEST ACCESS DRIVE ENCROACHMENT
-  - REQUEST ENCROACHMENT

# REQUEST TO OUTRIGHT VACATE THE FOLLOWING PUBLIC RIGHT OF WAYS: - CONNER LANE FROM MACK AVE. TO ITS NORTHERN TERMINUS. - CANAL STREET FROM FRED AVE. TO ITS SOUTHERN TERMINUS. - EASTWEST ALLEY SOUTH OF MACK AVE. AND WEST OF ST. JEAN. - REMAINING 50 FEET OF THE EASTWEST ALLEY NORTH OF KERCHEVAL AND WEST OF ST. JEAN. - THE FIRST NORTHSOUTH ALLEY WEST OF ST. JEAN FROM THE SOUTH LINE OF E. VERNOR HWY. ST. TO THE SOUTH LINE OF 2130 BENEVAU ST.		# THE FIRST NORTHSOUTH ALLEY WEST OF ST. JEAN FROM THE SOUTH LINE OF GOETHE AVE. TO THE NORTH LINE OF CHARLEVOIX ST. # ACCESS ENCROACHMENT INTO BENEVAU ST. BETWEEN EAST VERNOR HWY. AND KERCHEVAL WITH SEWER PIPE.	
A. PREPARED BY: SA KSM DATE: 06-03-19	B. CHECKED BY: SA KSM DATE: 06-03-19	CITY OF DETROIT CITY ENGINEERING DEPARTMENT SURVEY BUREAU	JOB NO. 01-01 DRAWING NO. X 867

CARTO

54G 54F 54A 55F 55A 56F 62C 62D 61C

