

TO: City Engineering Division, DPW
2 Woodward Ave., Suite 642
Detroit, MI 48226-3462
Survey Bureau: 313-224-3970

Petition No. 866

- () Involved; but asking you to hold action on this petition until further notice.
- () Involved; but no objections to the property change – provided an easement of the full width of the public right-of-way (street, alley or other public place) is reserved.
- () Involved; the nature of our services, and the estimated costs of removing and/or rerouting such services are:
- (x) Involved; have no objection to the request for encroachment into Woodward Ave. at 511 Woodward Ave. as shown on drawing no. X866 dated 08/29/19 provided that the encroachment shall not extend into the 17 feet sidewalk area.

Traffic Engineering Division - DPW
(Utility or City Department)

Ashok Patel
By

Sunny Jacob

City Traffic Engineer
Title

September 26, 2019
Date

313 224-1610
Area code-Telephone number

AA/aa

PETITION NO. 866
 YAMASAKI & ICONIC-511, LLC
 3011 W. GRAND BOULEVARD, SUITE 222
 DETROIT, MICHIGAN 48202
 PHONE NO. (313) 462-4316



CONGRESS ST. 60 FT.WD.

CONGRESS ST. 60 FT.WD.

GRISWOLD ST. 90 FT.WD.

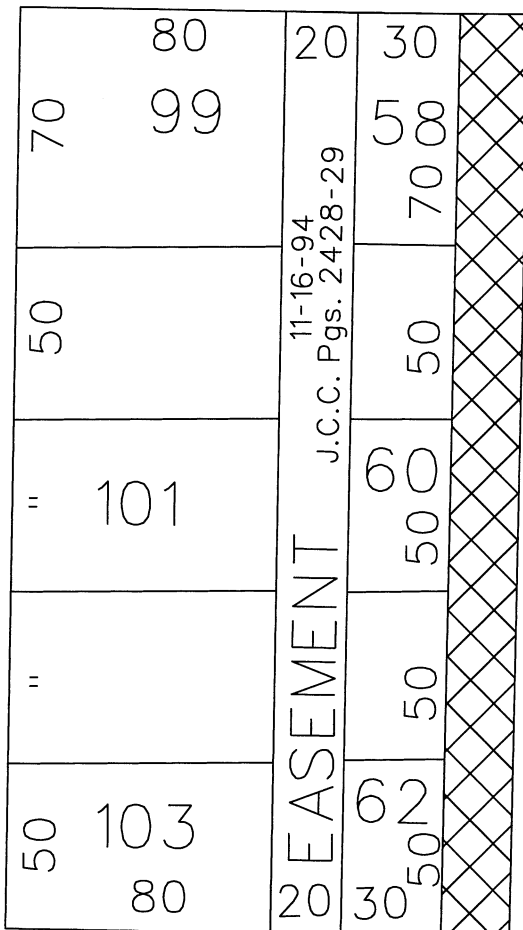

WOODWARD AVE. 190 FT.WD.

LARNED ST. 60 FT.WD.

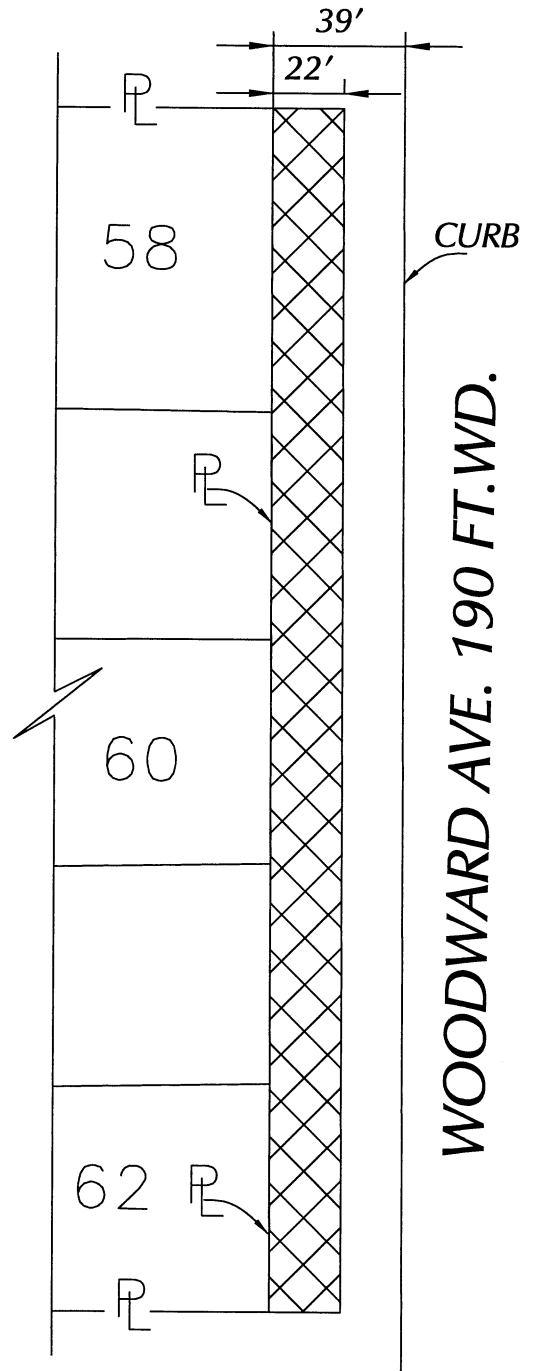

WOODWARD AVE. 190 FT.WD.

LARNED ST. 60 FT.WD.



- REQUEST ENCROACHMENT
 (WITH "ARCH. SCREEN, TRENCH DRAIN,
 TREE PLANTER, TRELLIS, CABLE RAILING,
 SEATING, FIRE PITS, PAVERS AND UMBRELLAS")

(FOR OFFICE USE ONLY)

CARTO 28 E

B					
A					
DESCRIPTION	DRWN	CHKD	APPD	DATE	
REVISIONS					
DRAWN BY	SA	CHECKED	KSM		
DATE	08-29-19	APPROVED			

**REQUEST ENCROACHMENT
 INTO WOODWARD AVE.
 AT 511 WOODWARD AVE.**

**CITY OF DETROIT
 CITY ENGINEERING DIVISION
 SURVEY BUREAU**

JOB NO. 01-01

DRWG. NO. X 866