

City of Detroit  
**City Engineering Division, Department of Public Works  
Survey Bureau**

**NOTICE OF PROPOSED CHANGE IN PROPERTY**

Date: 06/18/2019

Petition: x817

- |  |  |
|--|--|
| <input type="checkbox"/> AT&T Telecommunication            | <input type="checkbox"/> Berm Use                          |
| <input type="checkbox"/> Comcast Television (CATV)         | <input checked="" type="checkbox"/> Conversion to Easement |
| <input type="checkbox"/> Detroit Edison (DTE)              | <input type="checkbox"/> Dedication                        |
| <input type="checkbox"/> Fire Department                   | <input type="checkbox"/> Encroachment                      |
| <input type="checkbox"/> Great Lakes Water Authority       | <input type="checkbox"/> Outright Vacation                 |
| <input type="checkbox"/> Land Bank Authority               | <input type="checkbox"/> Temporary Closing                 |
| <input type="checkbox"/> Michcon (DTE)                     |  |
| <input type="checkbox"/> Planning & Development Department |  |
| <input type="checkbox"/> Public Lighting Authority         |  |
| <input type="checkbox"/> Public Lighting Department        |  |
| <input type="checkbox"/> Police Department                 |  |
| <input type="checkbox"/> Solid Waste Division, DPW         |  |
| <input type="checkbox"/> Street Design Bureau, DPW         |  |
| <input type="checkbox"/> Street Maintenance Division, DPW  |  |
| <input type="checkbox"/> Traffic Engineering Division, DPW |  |
| <input type="checkbox"/> Water and Sewerage Department     |  |
| <input type="checkbox"/> _____                             |  |

A petition drawing is attached. Property shown on the attached print is proposed to be changed as indicated. Kindly report (using the back of this sheet) the nature of your services, if any affected by the proposed change and the estimated costs of removing and rerouting such services (if necessary).

Please return one copy to City Engineering Division, DPW within two weeks of the submittal date. Retain one copy and print for you file.

Ron Brundidge, Director, Department of Public Works

By: Richard Doherty, CED DPW  
City Engineer

TO: City Engineering Division, DPW  
2 Woodward Ave., Suite 642  
Detroit, Michigan 48226-3462  
Survey Bureau: 313-224-3970

Petition: x817

The proposed change in property (referred to on the other side of this sheet) would affect our services as follows:

- Not Involved
- Involved; but asking you to hold action on this petition until further notice.
- Involved; but no objections to the property change.
- Involved; objection to the property change.
- Involved; but no objections to the property change...provided as easement of the full width of the public right-of-way (street, alley or other public place) is reserved.
- Involved; the nature of our services and the estimated costs of removing and/or rerouting such services are:

A.T&T  
(Utility or City Department)

PETER WLOTKOWSKI  
By

MGR OSP DESIGN  
Title

6/18/17  
Date

313-240-5465  
Area code – Telephone number

PETITION NO. 817  
 PREMIER GROW, LLC.  
 12747 STOUT  
 DETROIT, MICHIGAN 48223  
 DALTON BROWN  
 PHONE NO. (313) 215-0693



GLENDALE AVE. 50 FT. WD.

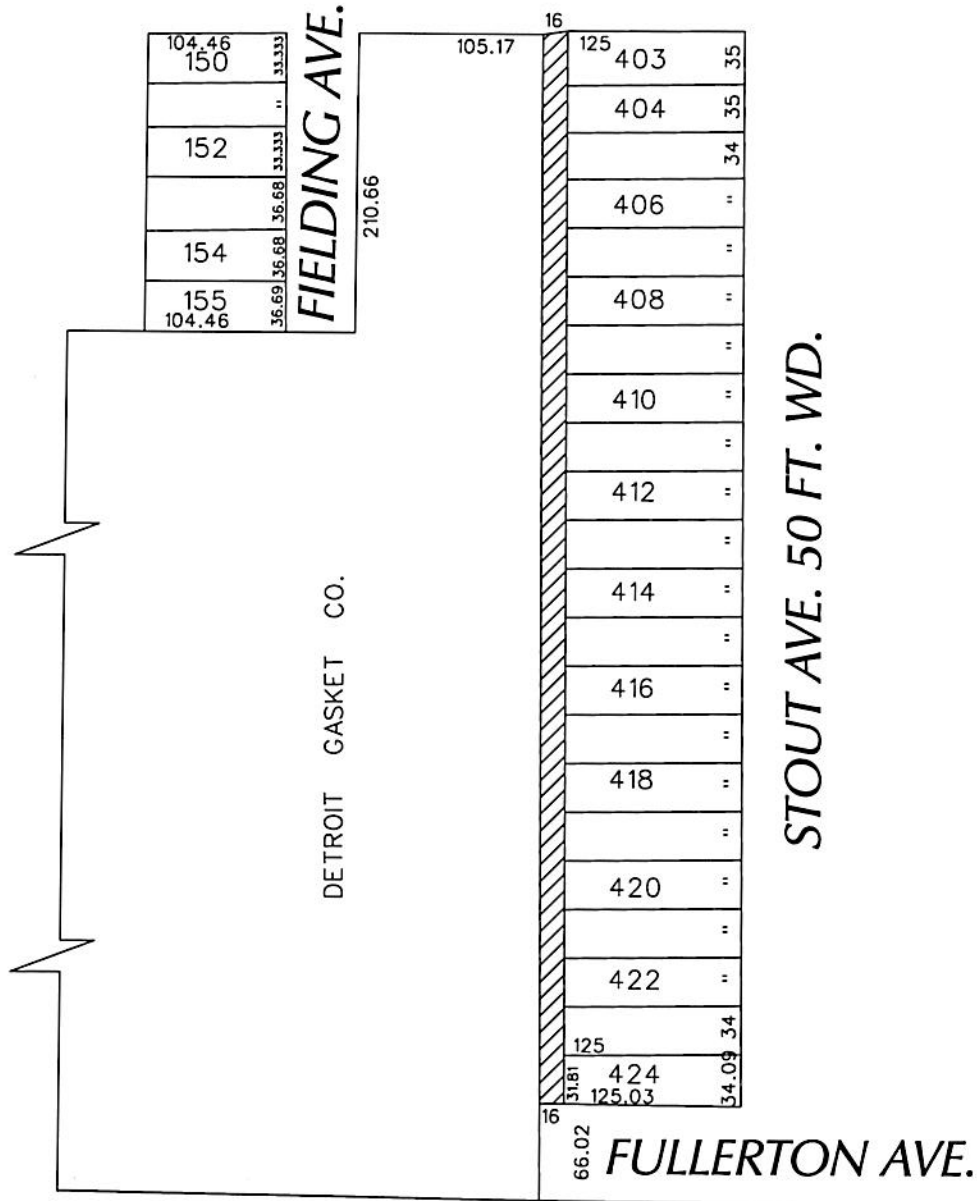

- CONVERSION TO EASEMENT

(FOR OFFICE USE ONLY)

CARTO 111 B

CONVERSION TO EASEMENT  
 THE PUBLIC ALLEY, 16 FT. WD.  
 IN THE BLOCK BOUND BY  
 FIELDING AVE., GLENDALE AVE.,  
 STOUT AVE. AND FULLERTON AVE.

CITY OF DETROIT  
 CITY ENGINEERING DIVISION  
 SURVEY BUREAU  
 JOB NO. 01-01  
 DRWG. NO. X 817

B					
A					
DESCRIPTION		DRWN	CHKD	APPD	DATE
REVISIONS					
DRAWN BY SA		CHECKED KSM			
DATE 06-18-19		APPROVED			