

**City of Detroit**  
**City Engineering Division, Department of Public Works**  
**Survey Bureau**

**NOTICE OF PROPOSED CHANGE IN PROPERTY**

Date: 05/13/2019

Petition: x799

- |   |  |
|---|--|
| <input type="checkbox"/> AT&T Telecommunication                       |  |
| <input type="checkbox"/> Comcast Television (CATV)                    | <input type="checkbox"/> Berm Use                          |
| <input type="checkbox"/> Detroit Edison (DTE)                         |  |
| <input type="checkbox"/> Fire Department                              | <input checked="" type="checkbox"/> Conversion to Easement |
| <input type="checkbox"/> Great Lakes Water Authority                  |  |
| <input type="checkbox"/> Land Bank Authority                          | <input type="checkbox"/> Dedication                        |
| <input type="checkbox"/> Michcon (DTE)                                |  |
| <input checked="" type="checkbox"/> Planning & Development Department | <input type="checkbox"/> Encroachment                      |
| <input type="checkbox"/> Public Lighting Authority                    |  |
| <input type="checkbox"/> Public Lighting Department                   | <input type="checkbox"/> Outright Vacation                 |
| <input type="checkbox"/> Police Department                            |  |
| <input type="checkbox"/> Solid Waste Division, DPW                    | <input type="checkbox"/> Temporary Closing                 |
| <input type="checkbox"/> Street Design Bureau, DPW                    |  |
| <input type="checkbox"/> Street Maintenance Division, DPW             |  |
| <input type="checkbox"/> Traffic Engineering Division, DPW            |  |
| <input type="checkbox"/> Water and Sewerage Department                |  |
| <input type="checkbox"/> _____  |  |

A petition drawing is attached. Property shown on the attached print is proposed to be changed as indicated. Kindly report (using the back of this sheet) the nature of your services, if any affected by the proposed change and the estimated costs of removing and rerouting such services (if necessary).

Please return one copy to City Engineering Division, DPW within two weeks of the submittal date. Retain one copy and print for you file.

Ron Brundidge, Director, Department of Public Works

By: Richard Doherty, CED DPW  
City Engineer

**TO: City Engineering Division, DPW  
2 Woodward Ave., Suite 642  
Detroit, Michigan 48226-3462  
Survey Bureau: 313-224-3970**

**Petition: x799**

The proposed change in property (referred to on the other side of this sheet) would affect our services as follows:

- Not Involved
- Involved; but asking you to hold action on this petition until further notice.
- Involved; but no objections to the property change.
- Involved; objection to the property change.
- Involved; but no objections to the property change...provided as easement of the full width of the public right-of-way (street, alley or other public place) is reserved.
- Involved; the nature of our services and the estimated costs of removing and/or rerouting such services are:

City of Detroit-Planning & Development Department  
(Utility or City Department)



By

Greg Moots-Lead Planner-Office of Zoning Innovation

Title

June 3, 19

Date

313-224-1358

Area code – Telephone number

PETITION NO. 799  
 BILAL MHEISEN OF ATF INVESTMENT LLC.  
 8258 MICHIGAN AVE.  
 DETROIT, MICHIGAN 48210  
 PHONE NO. (248) 933-3367

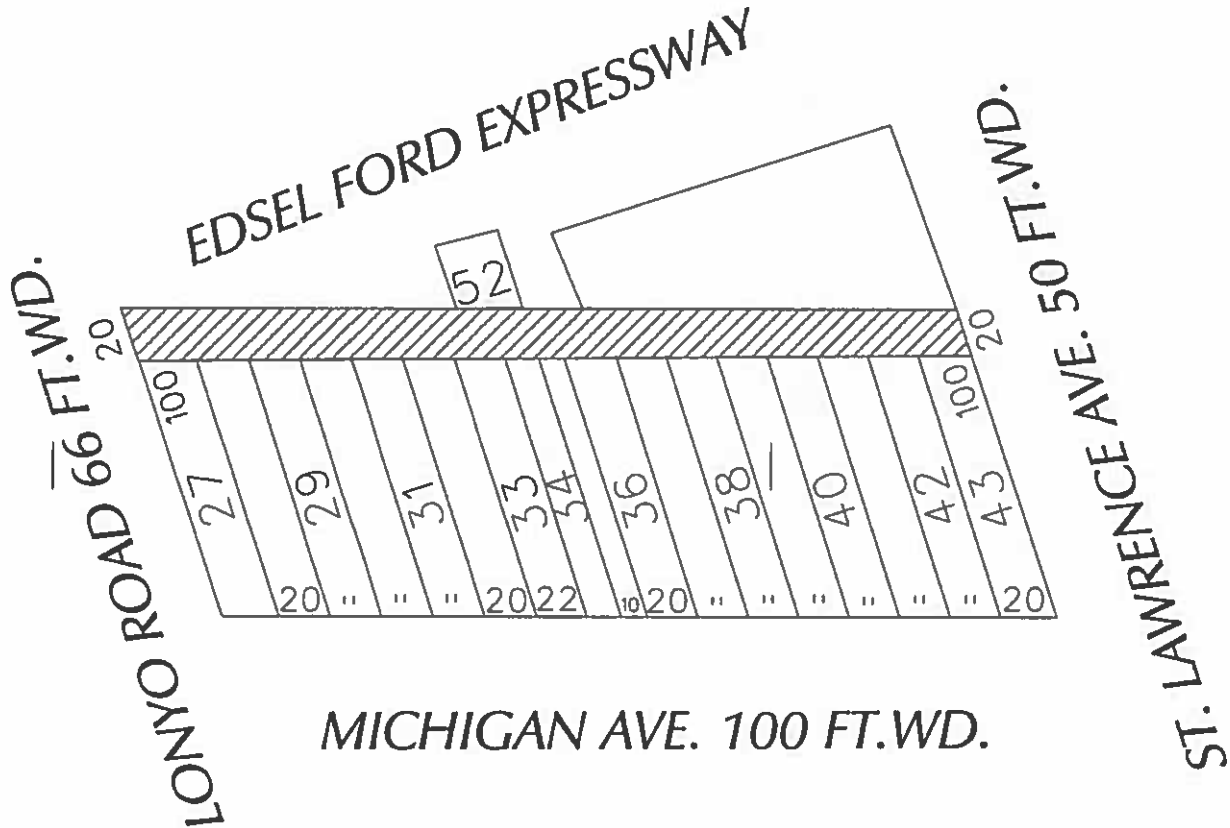

- CONVERSION TO EASEMENT

(FOR OFFICE USE ONLY)

CARTO 4 A

B						CONVERSION TO EASEMENT THE EAST/WEST PUBLIC ALLEY, 20 FT. WD. IN THE BLOCK BOUND BY LONYO ROAD, EDESEL FORD EXPRESSWAY, ST. LAWRENCE AVE. AND MICHIGAN AVE.	CITY OF DETROIT CITY ENGINEERING DIVISION SURVEY BUREAU	
A					JOB NO. 01-01			
DESCRIPTION		DRWN	CHEK	APPD	DATE			DRWG. NO. X 799
DRAWN BY SA		CHECKED KSM		DATE 05-13-19				
REVISIONS		APPROVED						