

TO: City Engineering Division, DPW
2 Woodward Ave., Suite 642
Detroit, MI 48226-3462
Survey Bureau: 313-224-3970

Petition No. 767

The proposed change in property (referred to above) would affect our services as follows:

- () Not Involved.
- () Involved; but asking you to hold action on this petition until further notice.
- () Involved; the nature of our services, and the estimated costs of removing and/or rerouting such services are:
- (X) Involved; have no objection to the requested encroachment on First St. and as shown on drawing no. x767 dated 3/28/2019 and revised on 04/22/2019 provided that a minimum 6 ft wide clear unobstructed sidewalk shall be maintained for pedestrian traffic at all times.

Traffic Engineering Division - DPW
(Utility or City Department)

Ashok Patel
By

Sunny Jacob

City Traffic Engineer
Title

May 31, 2019
Date

313 224-1610
Area code-Telephone number

MA/ma

REVISION - A -

PETITION NO. 767
 DTE ENERGY (C/O BLUE ENERGY)
 775 N. SECOND ST.
 BRIGHTON, MICHIGAN 48116
 MARK W. AITKEN
 PHONE NO. (313) 310-5450

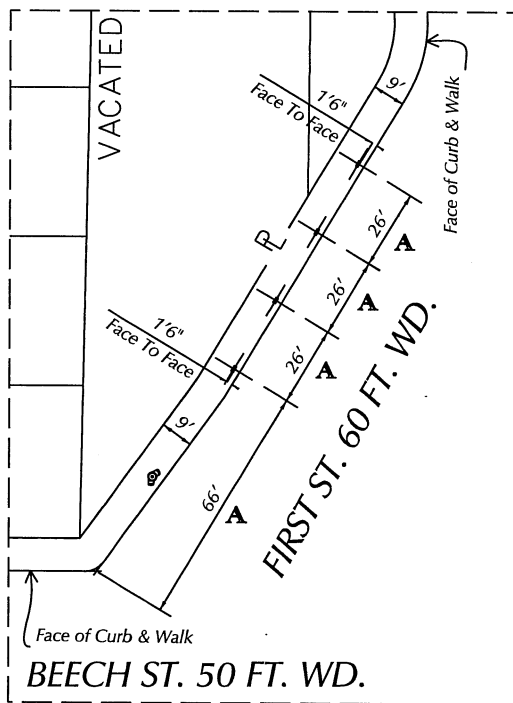
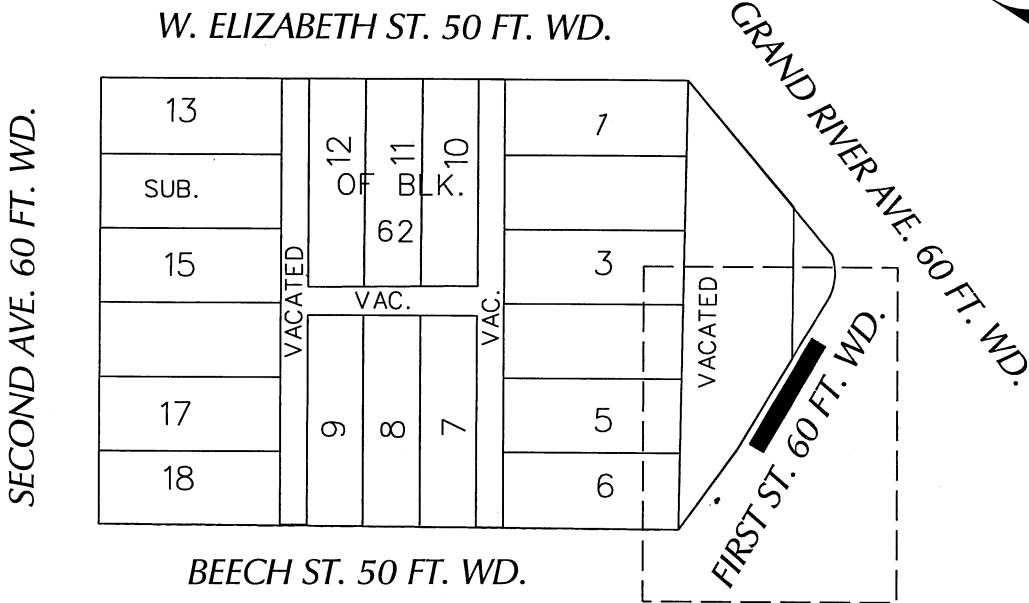

LEGEND

 EXISTING FIRE HYDRANT

 DCFC Charger
16" x 44" x 88"H

 - REQUEST ENCROACHMENT

(FOR OFFICE USE ONLY)

CARTO 28 B

| | | | | | |
|--------------------|---|-----------------|-------------|-------------|-------------|
| B | | | | | |
| A | Changing the distance between Charger machines. | SA | KSM | KSM | 4/22/19 |
| DESCRIPTION | | DRWN | CHKD | APPD | DATE |
| REVISIONS | | | | | |
| DRAWN BY | SA | CHECKED | | KSM | |
| DATE | 03-28-19 | APPROVED | | | |

REQUEST ENCROACHMENT ON FIRST STREET
 BETWEEN BEECH AND GRAND RIVER AVE.
 FOR THE INSTALLATION OF
 ELECTRIC VEHICLE CHARGING STATION.

| | |
|---------------------------|-------|
| CITY OF DETROIT | |
| CITY ENGINEERING DIVISION | |
| SURVEY BUREAU | |
| JOB NO. | 01-01 |
| DRWG. NO. | X 767 |