

**TO: City Engineering Division, DPW  
2 Woodward Ave., Suite 642  
Detroit, Michigan 48226-3462  
Survey Bureau: 313-224-3970**

**Petition: x744**

The proposed change in property (referred to on the other side of this sheet) would affect our services as follows:

- Not Involved
- Involved; but asking you to hold action on this petition until further notice.
- Involved; but no objections to the property change.
- Involved; objection to the property change.
- Involved; but no objections to the property change...provided as easement of the full width of the public right-of-way (street, alley or other public place) is reserved.
- Involved; the nature of our services and the estimated costs of removing and/or rerouting such services are:

COMCAST

\_\_\_\_\_  
(Utility or City Department)

TIFFANY FORBES

\_\_\_\_\_  
By

\_\_\_\_\_  
Title

3/27/19

\_\_\_\_\_  
Date

419-874-9262

\_\_\_\_\_  
Area code – Telephone number

DETMO01AA009		
DETMO01AP001		
MOTOAMP/MB87SXG		
23.9	21.5	
48.0	43.0	36.0
FORWARD PAD/EQ		
FP08.0FQ2.01		
RETURN PAD/EQ		
RPRQ		
INTERSTAGE PAD/EQ		
MB-SP	3	
20.0	20.0	38.4/38.7
87.7V	A	

785		
PWR:		
DETMO01AA007		
DETMO01AP001		
MOTOAMP/BLB7S-2		
29.2	30.9	
50.0	47.0	40.0
FORWARD PAD/EQ		
FP08.0FQ10.01		
RETURN PAD/EQ		
RPO9.0RQ		
INTERSTAGE PAD/EQ		
2		
20.0	20.0	28.9/27.0
87.7V	A	

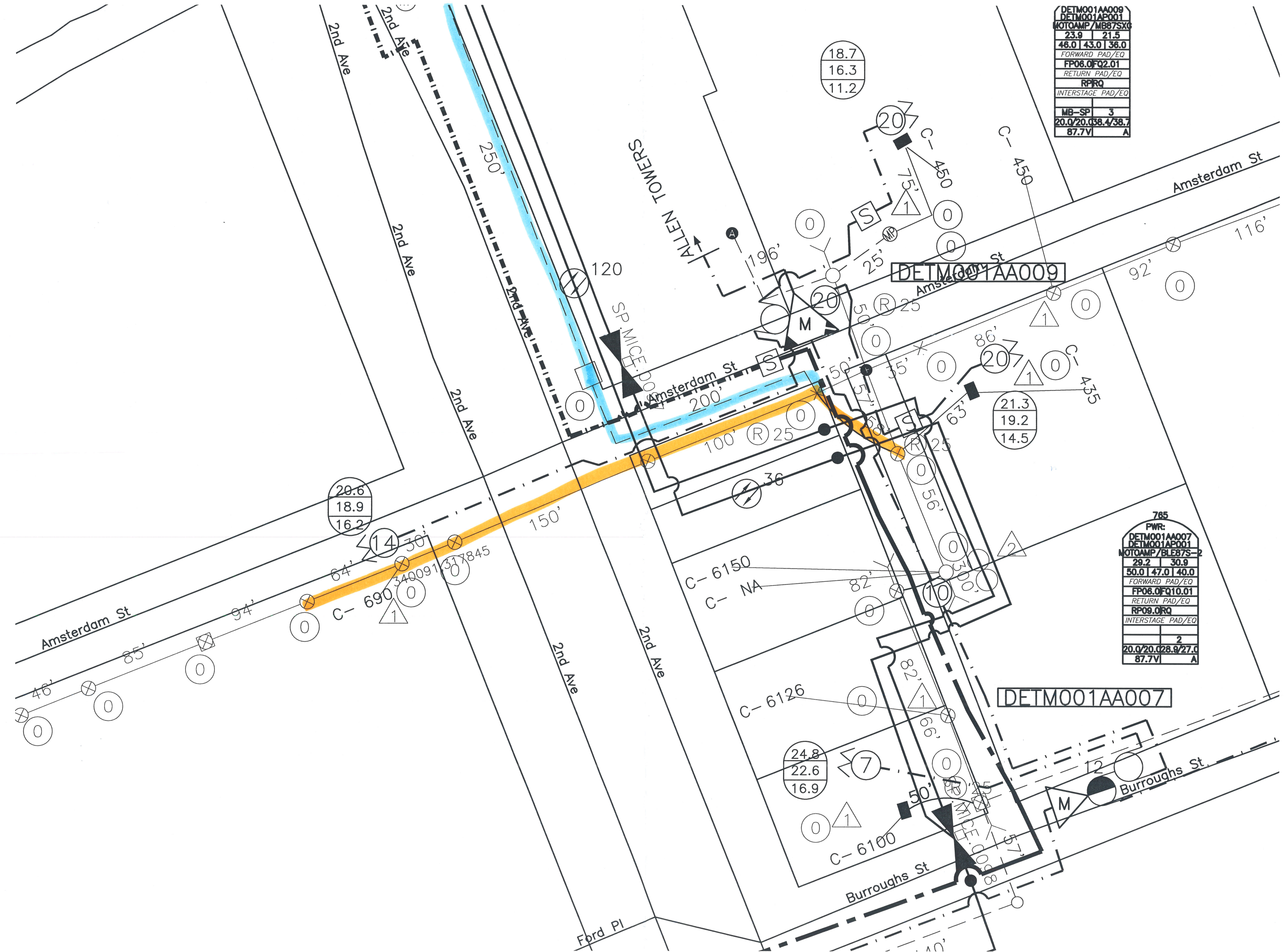

DETMO01AA009

DETMO01AA007