

**City of Detroit**  
**City Engineering Division, Department of Public Works**  
**Survey Bureau**

**NOTICE OF PROPOSED CHANGE IN PROPERTY**

Date: 03/12/2019

Petition: x742

- |   |   |
|---|---|
| <input type="checkbox"/> AT&T Telecommunication                       | <input type="checkbox"/> Berm Use               |
| <input type="checkbox"/> Comcast Television (CATV)                    | <input type="checkbox"/> Conversion to Easement |
| <input type="checkbox"/> Detroit Edison (DTE)                         | <input type="checkbox"/> Dedication             |
| <input type="checkbox"/> Fire Department                              | <input type="checkbox"/> Encroachment           |
| <input type="checkbox"/> Great Lakes Water Authority                  | <input type="checkbox"/> Outright Vacation      |
| <input type="checkbox"/> Land Bank Authority                          | <input type="checkbox"/> Temporary Closing      |
| <input type="checkbox"/> Michcon (DTE)                                |   |
| <input checked="" type="checkbox"/> Planning & Development Department |   |
| <input type="checkbox"/> Public Lighting Authority                    |   |
| <input type="checkbox"/> Public Lighting Department                   |   |
| <input type="checkbox"/> Police Department                            |   |
| <input type="checkbox"/> Solid Waste Division, DPW                    |   |
| <input type="checkbox"/> Street Design Bureau, DPW                    |   |
| <input type="checkbox"/> Street Maintenance Division, DPW             |   |
| <input type="checkbox"/> Traffic Engineering Division, DPW            |   |
| <input type="checkbox"/> Water and Sewerage Department                |   |
| <input type="checkbox"/> _____  |   |

A petition drawing is attached. Property shown on the attached print is proposed to be changed as indicated. Kindly report (using the back of this sheet) the nature of your services, if any affected by the proposed change and the estimated costs of removing and rerouting such services (if necessary).

Please return one copy to City Engineering Division, DPW within two weeks of the submittal date. Retain one copy and print for you file.

Ron Brundidge, Director, Department of Public Works

By: Richard Doherty, CED DPW  
City Engineer

**TO: City Engineering Division, DPW  
2 Woodward Ave., Suite 642  
Detroit, Michigan 48226-3462  
Survey Bureau: 313-224-3970**

**Petition: x742**

The proposed change in property (referred to on the other side of this sheet) would affect our services as follows:

- Not Involved
- Involved; but asking you to hold action on this petition until further notice.
- Involved; but no objections to the property change.
- Involved; objection to the property change.
- Involved; but no objections to the property change...provided as easement of the full width of the public right-of-way (street, alley or other public place) is reserved.
- Involved; the nature of our services and the estimated costs of removing and/or rerouting such services are:

City of Detroit-Planning & Development Department  
(Utility or City Department)

By 

Greg Moots-Lead Planner-Office of Zoning Innovation  
Title

Mar 20, 19  
Date

313-224-1358  
Area code – Telephone number

PETITION NO. 742  
 DPW - CITY ENGINEERING  
 COLEMAN A. YOUNG MUNICIPAL CENTER  
 DETROIT, MICHIGAN 48226  
 KEITH MCCRARY  
 PHONE NO. (313) 224-3970

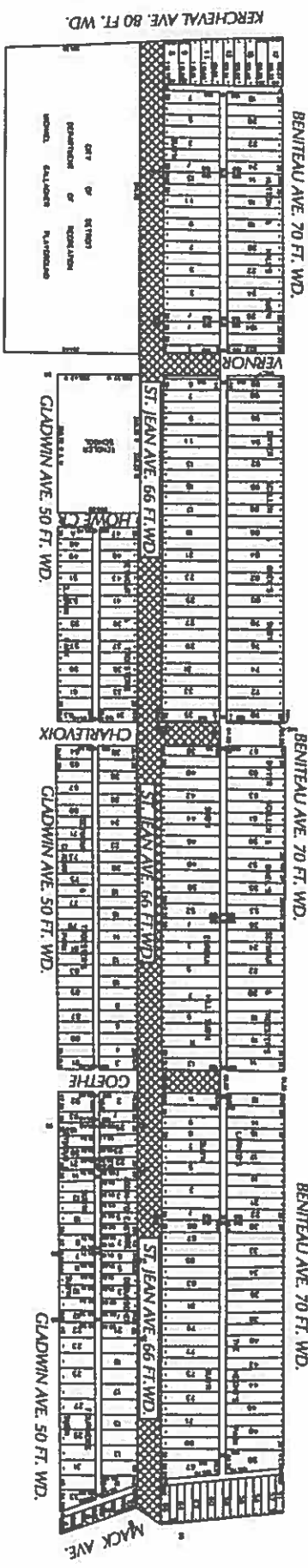
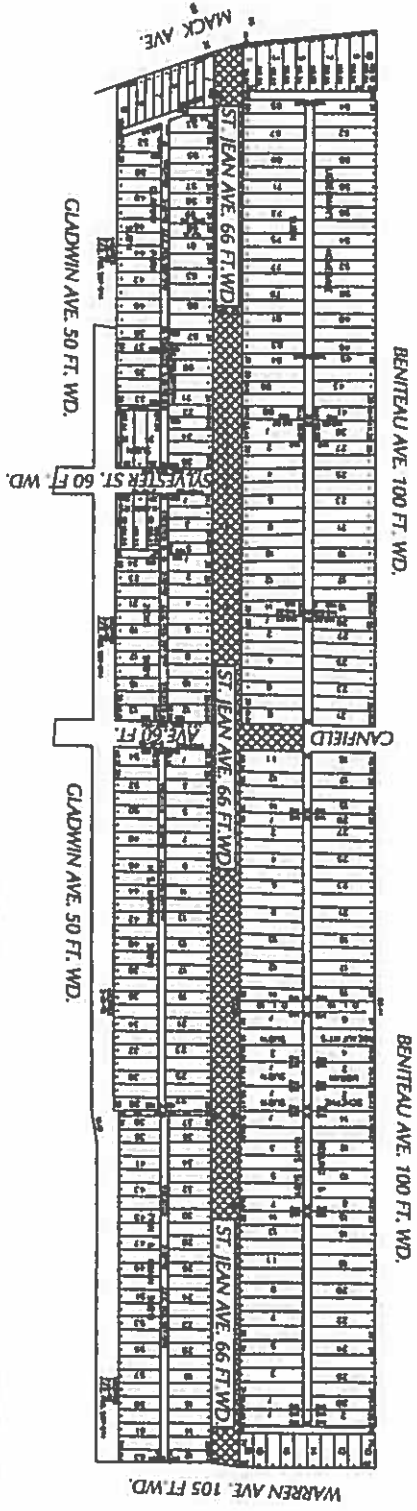

- OUTRIGHT VACATION

REQUEST TO OUTRIGHT VACATE  
 (FOR OFFICE USE ONLY)

55A & 55F & 56A & 56F

CARTO

B			
A	RECONSTRUCTION	REVISION	DATE
	SA	CHECKED	KSM
DATE	03-12-19	APPROVED	

- ST JEAN FROM THE SOUTH LINE OF E. WARREN AVE. TO THE NORTH LINE OF MACK AVE.
- ST. JEAN FROM THE SOUTH LINE OF MACK AVE. TO THE NORTH LINE OF KERCHEVAL ST.
- GOETHE AVE. FROM THE EAST LINE OF ST. JEAN TO THE EAST LINE OF THE FIRST NORTH-SOUTH ALLEY WEST OF ST. JEAN.
- CHARLEVOIX ST. FROM THE EAST LINE OF ST. JEAN TO THE EAST LINE OF THE FIRST NORTH-SOUTH ALLEY WEST OF ST. JEAN.
- E. VERNOR HWY. FROM THE EAST LINE OF ST. JEAN TO THE EAST LINE OF THE FIRST NORTH-SOUTH ALLEY WEST OF ST. JEAN.

CITY OF DETROIT	
CITY ENGINEERING DEPARTMENT	
SURVEY BUREAU	
JOB NO.	01-01
DRAWING NO.	X 742

