

City of Detroit
**City Engineering Division, Department of Public Works
Survey Bureau**

NOTICE OF PROPOSED CHANGE IN PROPERTY

Date: 10/8/2019

Petition: X 723

- | | |
|--|--|
| <input type="checkbox"/> AT&T Telecommunication | <input type="checkbox"/> Berm Use |
| <input type="checkbox"/> Comcast Television (CATV) | <input checked="" type="checkbox"/> Conversion to Easement |
| <input type="checkbox"/> Detroit Edison (DTE) | <input type="checkbox"/> Dedication |
| <input type="checkbox"/> Fire Department | <input type="checkbox"/> Encroachment |
| <input type="checkbox"/> Great Lakes Water Authority | <input type="checkbox"/> Outright Vacation |
| <input type="checkbox"/> Land Bank Authority | <input type="checkbox"/> Temporary Closing |
| <input checked="" type="checkbox"/> Michcon (DTE) | |
| <input type="checkbox"/> Planning & Development Department | |
| <input type="checkbox"/> Public Lighting Authority | |
| <input type="checkbox"/> Public Lighting Department | |
| <input type="checkbox"/> Police Department | |
| <input type="checkbox"/> Solid Waste Division, DPW | |
| <input type="checkbox"/> Street Design Bureau, DPW | |
| <input type="checkbox"/> Street Maintenance Division, DPW | |
| <input type="checkbox"/> Traffic Engineering Division, DPW | |
| <input type="checkbox"/> Water and Sewerage Department | |
| <input type="checkbox"/> _____ | |

A petition drawing is attached. Property shown on the attached print is proposed to be changed as indicated. Kindly report (using the back of this sheet) the nature of your services, if any affected by the proposed change and the estimated costs of removing and rerouting such services (if necessary).

Please return one copy to City Engineering Division, DPW within two weeks of the submittal date. Retain one copy and print for you file.

Ron Brundidge, Director, Department of Public Works

By: Richard Doherty, CED DPW
City Engineer

**TO: City Engineering Division, DPW
2 Woodward Ave., Suite 642
Detroit, Michigan 48226-3462
Survey Bureau: 313-224-3970**

Petition: X723

The proposed change in property (referred to on the other side of this sheet) would affect our services as follows:

- Not Involved
- Involved; but asking you to hold action on this petition until further notice.
- Involved; but no objections to the property change.
- Involved; objection to the property change.
- Involved; but no objections to the property change...provided as easement of the full width of the public right-of-way (street, alley or other public place) is reserved.
- Involved; the nature of our services and the estimated costs of removing and/or rerouting such services are:

DTE Gas Company
(Utility or City Department)

Jade M. Detroyer
By

Drafter
Title

October 18, 2019
Date

313.235.1783
Area code – Telephone number



**STATE LAW ACT 174
3 WORKING DAYS
BEFORE YOU DIG
DIAL TOLL FREE
1-800-482-7171 OR 811**

**DTE Energy's
Gas Leak Emergency
Phone Number
1-800-947-5000**

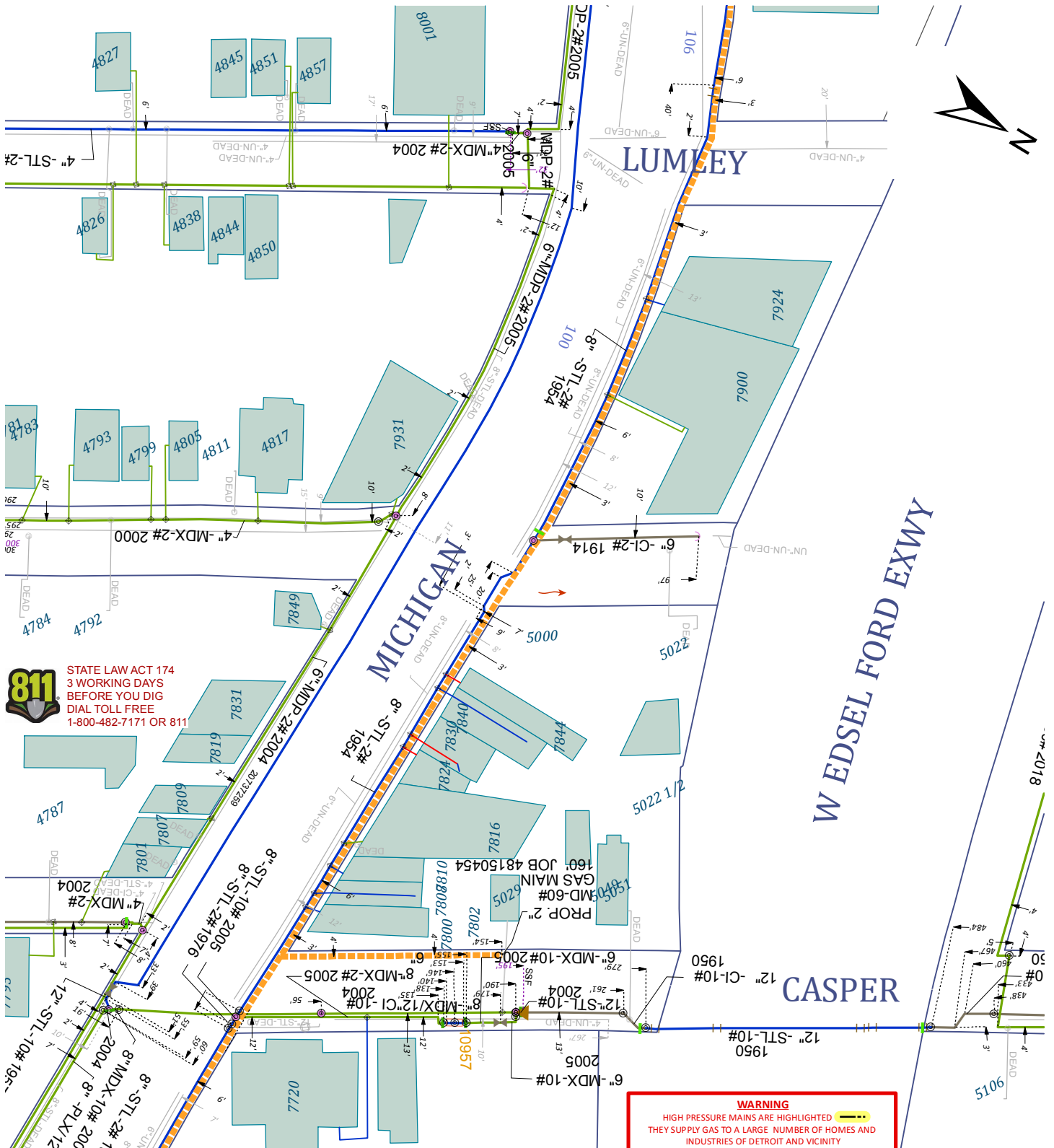

811 STATE LAW ACT 174
 3 WORKING DAYS
 BEFORE YOU DIG
 DIAL TOLL FREE
 1-800-482-7171 OR 811

DTE GAS COMPANY FACILITIES AS SHOWN
 INDICATE APPROXIMATE LOCATIONS ONLY AS DISCLOSED BY THE
 COMPANY'S RECORDS AND NO GUARANTEE IS MADE EITHER AS
 TO COMPLETENESS OR ACCURACY.

DTE GAS COMPANY

SIGNED: *David L. Gabrielse* October 18, 2019

CONSTRUCTION PLANS MADE SUBSEQUENT TO THIS DATE
 SHOULD BE CHECKED WITH DTE GAS COMPANY

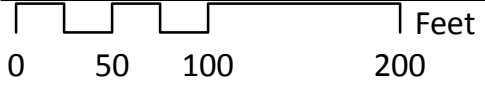

WARNING
 HIGH PRESSURE MAINS ARE HIGHLIGHTED
 THEY SUPPLY GAS TO A LARGE NUMBER OF HOMES AND
 INDUSTRIES OF DETROIT AND VICINITY

IT IS OF THE UTMOST IMPORTANCE THAT EVERY PRECAUTION
 BE TAKEN SO AS NOT TO ENDANGER ITS USE DURING OR
 FOLLOWING YOUR CONSTRUCTION
 DTE GAS COMPANY

Pipe Material

- CU - Copper
- PLA - Plastic
- STL - Bare Steel
- STL - Coated Steel
- CI - Cast Iron
- WI - Wrought Iron
- UN - Unknown
- Inactive
- Abandoned

Main Line Styles

- - - - In Design Main (Proposed)
- Distribution Main
- Joint Trench
- Exposed Pipe
- Pipe Lining (CI or WI)
- - - - Transmission Main
- - - - Subtransmission Main