

DEPARTMENTAL REFERENCE COMMUNICATION

Wednesday, February 27, 2019

To: *The Department or Commission Listed Below*

From: *Janice M. Winfrey, Detroit City Clerk*

The following petition is herewith referred to you for report and recommendation to the City Council.

In accordance with that body's directive, kindly return the same with your report in duplicate within four (4) weeks.

PLANNING AND DEVELOPMENT DEPARTMENT DPW - CITY ENGINEERING DIVISION

722

Giffels Webster, request a series of vacation & encroachments into the rights-of-way within various streets for the streetscape improvements for the Pistons Performance Facility project.

722



February 22, 2019

HAND DELIVER

Honorable Detroit City Council
C/o Detroit City Clerk
200 Coleman A. Young Municipal Center
2 Woodward Avenue
Detroit, Michigan 48226

RE: Giffels Webster – Request for a series of vacations and encroachments into of the rights-of-way within the block bounded by Amsterdam Street (50 feet wide), Second Avenue (150 feet wide), Third Street (variable width), and Baltimore Street (60 feet wide).

Giffels Webster, 28 W. Adams, Suite 1200, Detroit, Michigan 48226 on behalf of Henry Ford Health Systems, One Ford Place, Suite 4A, Detroit, MI 48202, respectfully requests the following vacations and encroachment into the rights-of-way within the block bounded by Amsterdam Street (50 feet wide), Second Avenue (150 feet wide), Third Street (variable width), and Baltimore Street (60 feet wide) in the City of Detroit:

- An above grade encroachment extending 129.0 feet along Second Avenue (150 feet wide) sidewalk for stairs, ramps, and a wall.
- An above grade CED indemnification area that extends 174.9 feet in the sidewalk along Second Avenue (150 feet wide) for maintenance of non-standard items to accommodate decorative plaques in the pavement, monuments and their foundations, etc., all of which will be maintained by Pistons Performance LLC. This CED indemnification area will extend 29.1 feet into the Second Avenue right-of-way.
- An above grade encroachment in the sidewalk along Second Avenue (150 feet wide) for monuments, decorative plaques, tree grates, etc. This encroachment area will extend 82.3 feet along Second Avenue.

The requested vacations and encroachments are critical for the streetscape improvements for the Pistons Performance Facility project. Please refer to the attached detailed sketches for further clarification.

If you should have any questions, please do not hesitate to contact me at (P) 313.962.4442 (M) 419.276.0921 or at droot@giffelswebster.com.

Respectfully,

A handwritten signature in blue ink, appearing to read "Dave Root".

Dave Root P.E.,
Project Manager
Giffels Webster

attachment

CITY CLERK 26 FEB 2019 PM 4:00

EASEMENT FOR CAFE STREETSCAPE ELEMENTS
(WALLS, FOUNDATIONS, NON-STANDARD WALKS,
TREES, TREE GRATES, MONUMENTS, ETC.) 8.5 FT
WIDE CLEAR PEDESTRIAN ACCESSWAY MAINTAINED



8 FT WIDE PEDESTRIAN EASEMENT

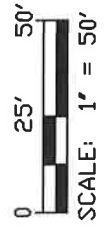
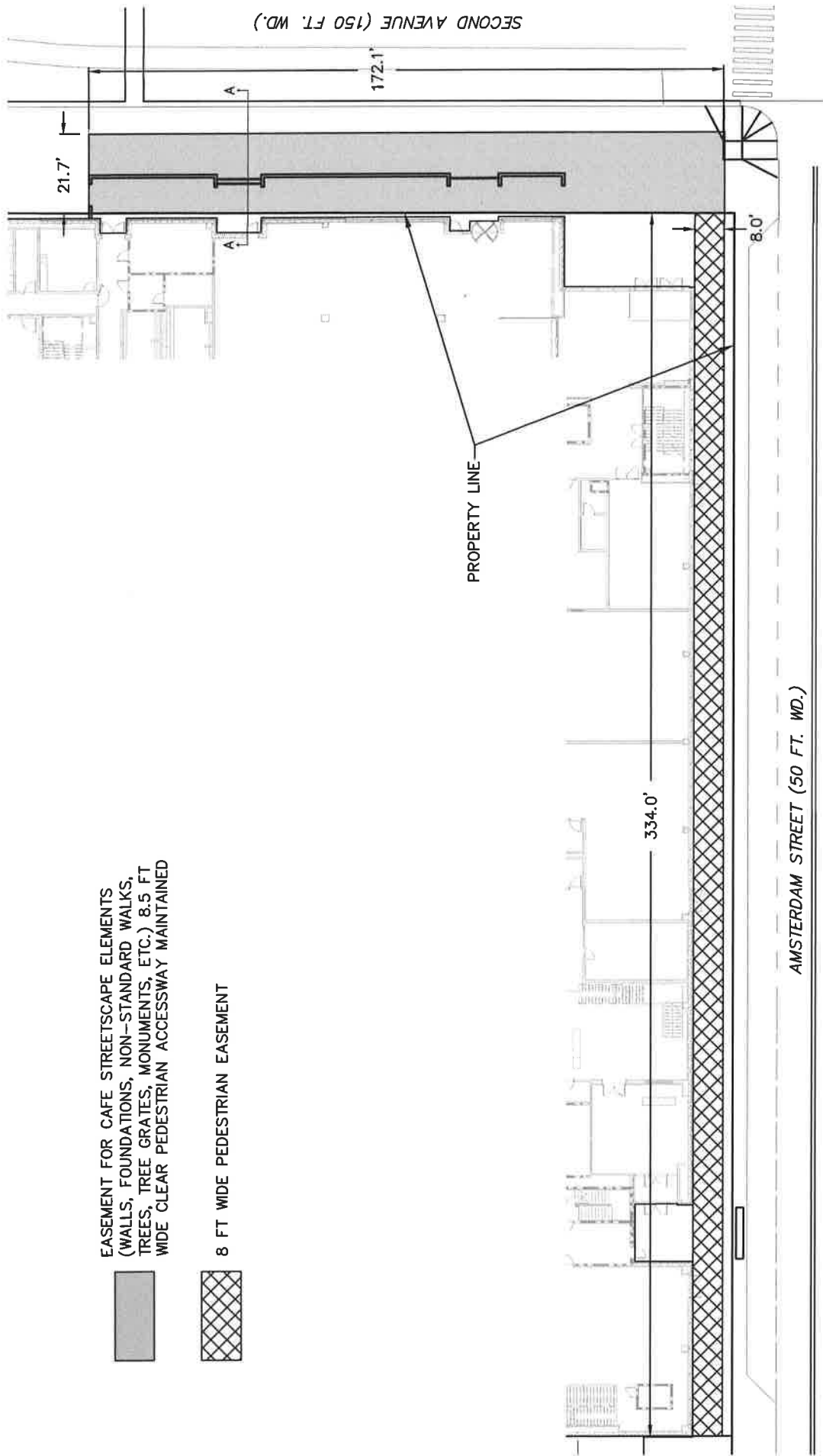

SECTION A-A

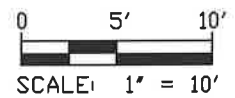
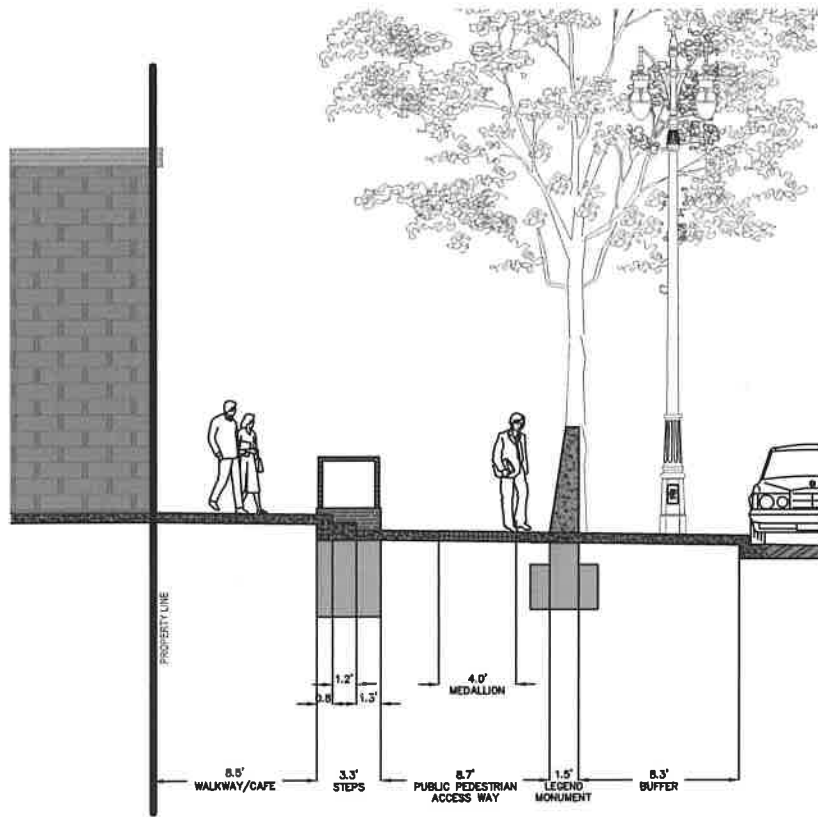

Know what's below.
Call before you dig.

PISTONS PERFORMANCE CENTER

CITY OF DETROIT, WAYNE COUNTY, MICHIGAN

SECOND AVENUE STREETSCAPE -
CROSS SECTION

**giffels
webster**
Engineers Surveyors Planners
Landscape Architects

28 West Adams Road
Suite 1200
Detroit, MI 48226
p (313) 962-4442
f (313) 962-5068
www.giffelswebster.com

Executive: **MWM**
Manager: **DLR**
Designer: **LO**
Quality Control: **TET**
Section: **PRIVATE CLAIMS**

Developed For:

PISTONS PERFORMANCE CENTER LLC

6 CHAMPIONSHIP DRIVE,
AUBURN HILLS, MI 48326

DATE:	ISSUE:

Date: 02.25.2019
Scale: 1"=10'
Sheet:
Project: 19389.00D

Copyright © 2019 Giffels Webster.
No reproduction shall be made
without the prior written consent of
Giffels Webster.

2019-02-27

722

722 *Petition of Giffels Webster, request a series of vacation & encroachments into the rights-of-way within various streets for the streetscape improvements for the Pistons Performance Facility project.*

REFERRED TO THE FOLLOWING DEPARTMENT(S)

PLANNING AND DEVELOPMENT DEPARTMENT DPW -
CITY ENGINEERING DIVISION