



PROJECT
 Storage Facility - Phase II
 1815 Mack Avenue
 Detroit, MI 48224

CLIENT
 Star Realty
 Investments, L.L.C.
 4541 South Military Drive
 Fort Worth, TX 76109

CONTACT
 Steve Nolan
 817.753.9996 - Phone
 817.752.8994 - Fax

PROJECT LOCATION
 Parcel of Property Claim 300
 City of Detroit,
 Wayne County, Michigan

DATE
 July 11, 2017

SCALE
 1" = 20'



ENGINEER
 Steve Nolan
 License No. 10000

DATE
 July 11, 2017

SCALE
 1" = 20'

DRAWN BY
 R. Johnson

CHECKED BY
 B. Bricker

DATE
 July 11, 2017

SCALE
 1" = 20'

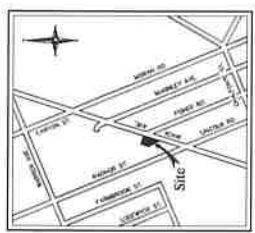

SHEET INDEX

101	PROPOSED SITE PLAN
102	PROPOSED SITE PLAN
103	PROPOSED SITE PLAN
104	PROPOSED SITE PLAN
105	PROPOSED SITE PLAN
106	PROPOSED SITE PLAN
107	PROPOSED SITE PLAN
108	PROPOSED SITE PLAN
109	PROPOSED SITE PLAN
110	PROPOSED SITE PLAN
111	PROPOSED SITE PLAN
112	PROPOSED SITE PLAN
113	PROPOSED SITE PLAN
114	PROPOSED SITE PLAN
115	PROPOSED SITE PLAN
116	PROPOSED SITE PLAN
117	PROPOSED SITE PLAN
118	PROPOSED SITE PLAN
119	PROPOSED SITE PLAN
120	PROPOSED SITE PLAN

SITE DATA

101	PROPOSED SITE PLAN
102	PROPOSED SITE PLAN
103	PROPOSED SITE PLAN
104	PROPOSED SITE PLAN
105	PROPOSED SITE PLAN
106	PROPOSED SITE PLAN
107	PROPOSED SITE PLAN
108	PROPOSED SITE PLAN
109	PROPOSED SITE PLAN
110	PROPOSED SITE PLAN
111	PROPOSED SITE PLAN
112	PROPOSED SITE PLAN
113	PROPOSED SITE PLAN
114	PROPOSED SITE PLAN
115	PROPOSED SITE PLAN
116	PROPOSED SITE PLAN
117	PROPOSED SITE PLAN
118	PROPOSED SITE PLAN
119	PROPOSED SITE PLAN
120	PROPOSED SITE PLAN

LEGAL DESCRIPTION
 Parcel of Property Claim 300
 City of Detroit,
 Wayne County, Michigan

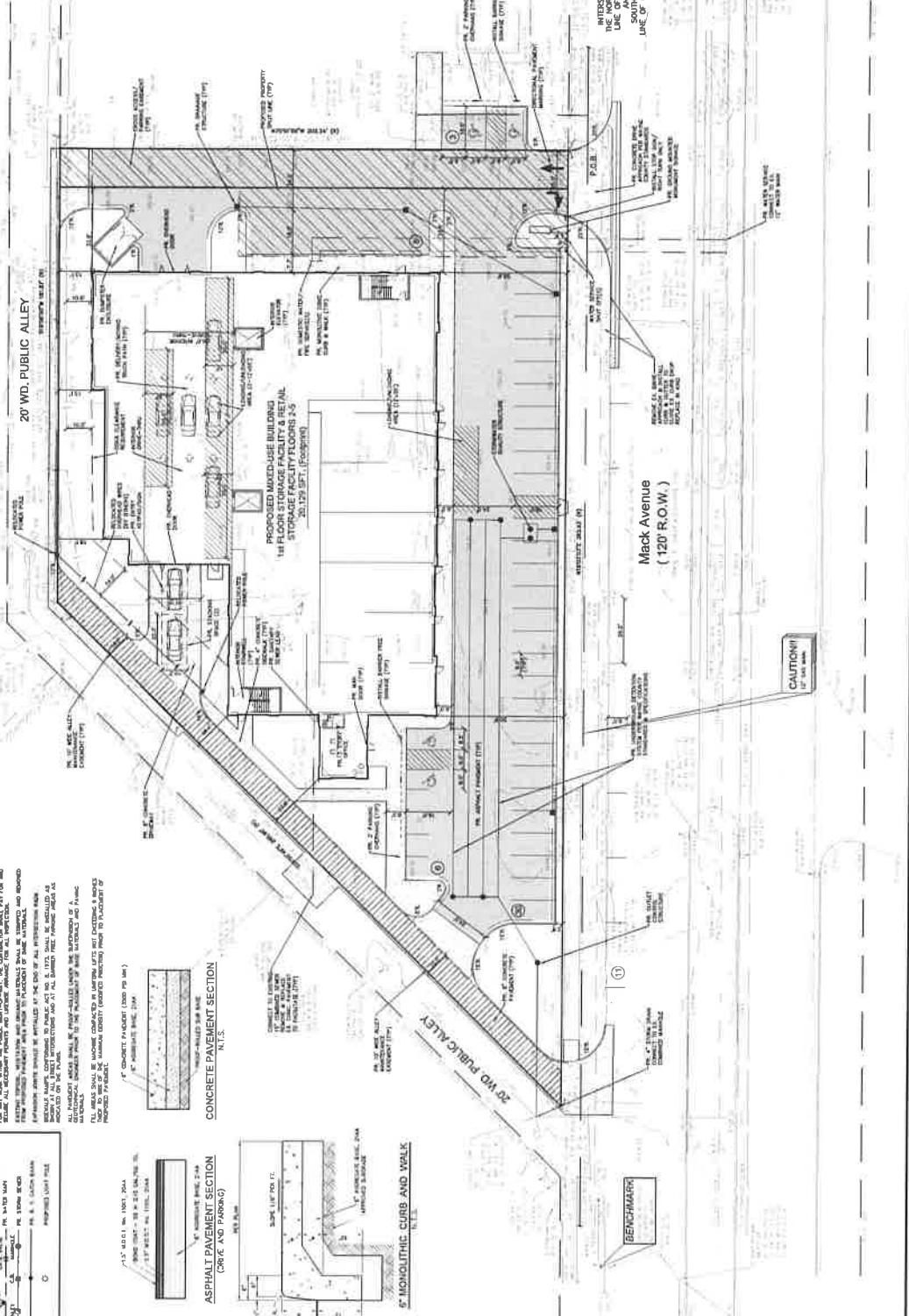
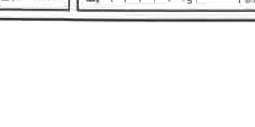
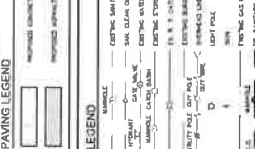
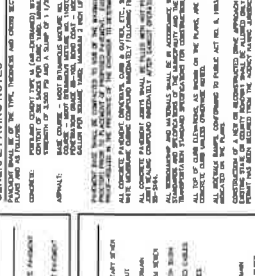
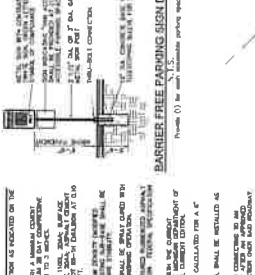
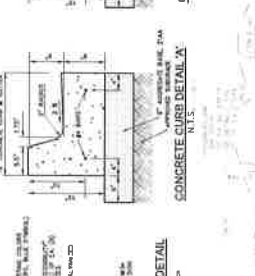
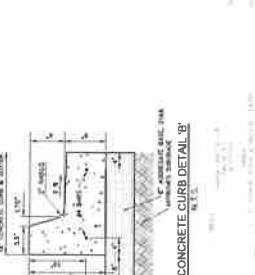

GENERAL PAVING NOTES

1. ALL PAVING SHALL BE IN ACCORDANCE WITH THE LATEST EDITIONS OF THE MICHIGAN DEPARTMENT OF TRANSPORTATION (MDOT) STANDARD SPECIFICATIONS FOR HIGHWAYS, BRIDGES AND STRUCTURES (SPECS) AND THE MICHIGAN DEPARTMENT OF TRANSPORTATION (MDOT) STANDARD SPECIFICATIONS FOR AIRPORTS AND HELIPORTS (SPECS).

2. ALL PAVING SHALL BE IN ACCORDANCE WITH THE LATEST EDITIONS OF THE MICHIGAN DEPARTMENT OF TRANSPORTATION (MDOT) STANDARD SPECIFICATIONS FOR HIGHWAYS, BRIDGES AND STRUCTURES (SPECS) AND THE MICHIGAN DEPARTMENT OF TRANSPORTATION (MDOT) STANDARD SPECIFICATIONS FOR AIRPORTS AND HELIPORTS (SPECS).

3. ALL PAVING SHALL BE IN ACCORDANCE WITH THE LATEST EDITIONS OF THE MICHIGAN DEPARTMENT OF TRANSPORTATION (MDOT) STANDARD SPECIFICATIONS FOR HIGHWAYS, BRIDGES AND STRUCTURES (SPECS) AND THE MICHIGAN DEPARTMENT OF TRANSPORTATION (MDOT) STANDARD SPECIFICATIONS FOR AIRPORTS AND HELIPORTS (SPECS).

4. ALL PAVING SHALL BE IN ACCORDANCE WITH THE LATEST EDITIONS OF THE MICHIGAN DEPARTMENT OF TRANSPORTATION (MDOT) STANDARD SPECIFICATIONS FOR HIGHWAYS, BRIDGES AND STRUCTURES (SPECS) AND THE MICHIGAN DEPARTMENT OF TRANSPORTATION (MDOT) STANDARD SPECIFICATIONS FOR AIRPORTS AND HELIPORTS (SPECS).

5. ALL PAVING SHALL BE IN ACCORDANCE WITH THE LATEST EDITIONS OF THE MICHIGAN DEPARTMENT OF TRANSPORTATION (MDOT) STANDARD SPECIFICATIONS FOR HIGHWAYS, BRIDGES AND STRUCTURES (SPECS) AND THE MICHIGAN DEPARTMENT OF TRANSPORTATION (MDOT) STANDARD SPECIFICATIONS FOR AIRPORTS AND HELIPORTS (SPECS).

6. ALL PAVING SHALL BE IN ACCORDANCE WITH THE LATEST EDITIONS OF THE MICHIGAN DEPARTMENT OF TRANSPORTATION (MDOT) STANDARD SPECIFICATIONS FOR HIGHWAYS, BRIDGES AND STRUCTURES (SPECS) AND THE MICHIGAN DEPARTMENT OF TRANSPORTATION (MDOT) STANDARD SPECIFICATIONS FOR AIRPORTS AND HELIPORTS (SPECS).

7. ALL PAVING SHALL BE IN ACCORDANCE WITH THE LATEST EDITIONS OF THE MICHIGAN DEPARTMENT OF TRANSPORTATION (MDOT) STANDARD SPECIFICATIONS FOR HIGHWAYS, BRIDGES AND STRUCTURES (SPECS) AND THE MICHIGAN DEPARTMENT OF TRANSPORTATION (MDOT) STANDARD SPECIFICATIONS FOR AIRPORTS AND HELIPORTS (SPECS).

8. ALL PAVING SHALL BE IN ACCORDANCE WITH THE LATEST EDITIONS OF THE MICHIGAN DEPARTMENT OF TRANSPORTATION (MDOT) STANDARD SPECIFICATIONS FOR HIGHWAYS, BRIDGES AND STRUCTURES (SPECS) AND THE MICHIGAN DEPARTMENT OF TRANSPORTATION (MDOT) STANDARD SPECIFICATIONS FOR AIRPORTS AND HELIPORTS (SPECS).

9. ALL PAVING SHALL BE IN ACCORDANCE WITH THE LATEST EDITIONS OF THE MICHIGAN DEPARTMENT OF TRANSPORTATION (MDOT) STANDARD SPECIFICATIONS FOR HIGHWAYS, BRIDGES AND STRUCTURES (SPECS) AND THE MICHIGAN DEPARTMENT OF TRANSPORTATION (MDOT) STANDARD SPECIFICATIONS FOR AIRPORTS AND HELIPORTS (SPECS).

10. ALL PAVING SHALL BE IN ACCORDANCE WITH THE LATEST EDITIONS OF THE MICHIGAN DEPARTMENT OF TRANSPORTATION (MDOT) STANDARD SPECIFICATIONS FOR HIGHWAYS, BRIDGES AND STRUCTURES (SPECS) AND THE MICHIGAN DEPARTMENT OF TRANSPORTATION (MDOT) STANDARD SPECIFICATIONS FOR AIRPORTS AND HELIPORTS (SPECS).